

SPECIFICATIONS

Battery: Lithium-ion

Battery Capacity: 650-mAh

Recharge Time: 15-hrs (from fully exhausted)

LEDs: 8 (2-LEDs nightlight, 6-LEDs flashlight)

Flashlight Duration: 9-hrs

Distributed by
C & A Marketing
2 Bergen Turnpike
Ridgefield Park, NJ 07660
info@myivation.com

Made in China
ivation is a trademark of
C&A IP Holdings, LLC
©2015 All right reserved



Emergency Multi-Function LED Light User Manual

- 1. SAFETY FIRST!**
 - A. Read all instructions before using the Eco-Lite.
 - B. The Eco-Lite is not a toy and is not intended for use by children.
 - C. Don't allow this appliance to get wet.
 - D. Use indoors in any wall receptacle which cannot touch bed coverings, drapes or similar items.
 - E. Do not operate the light with an extension cord.
 - F. Do not try to remove the clear top off the flashlight; there are no user-serviceable parts.

- 2. PARTS FAMILIARIZATION**
 1. 6-LED Flashlight Head
 2. Power Button
 3. Flashlight Body
 4. Charging Base
 5. Charging Base/Nightlight (bottom view)
 6. Mode Switch

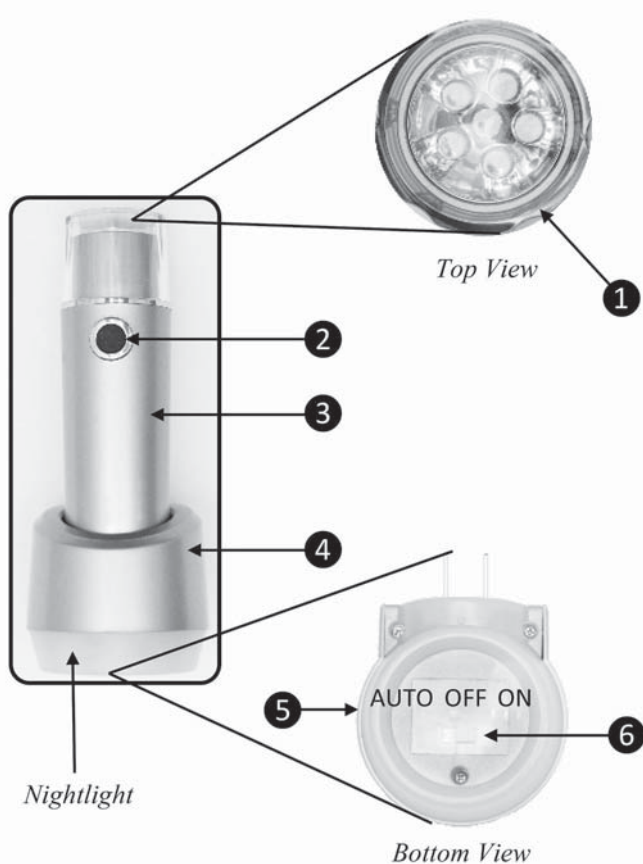

3. CHARGING AND THE MODE SWITCH

1. Locate the **Power Switch** on the underside of the **Charging Base** and push it left to the "AUTO" position.
2. Insert the **Charging Base** into a 120-volt wall outlet. **Note:** The 120-v prongs can be rotated 90° to accommodate horizontally installed receptacles .
3. Place the **Flashlight Body** into the **Charging Unit**. For its first charge, allow it to remain in the **Charging Base** overnight.
4. The **Mode Switch** can be set to "OFF" to prevent the nightlight from functioning and to "ON" to keep the nightlight on permanently (See figure labeled "Bottom View:").

4. NIGHTLIGHT & FLASHLIGHT OPERATION

1. When working properly, the Nightlight LEDs will come on when the room or hallway becomes dark and will shut off when light enters the room.
2. If your house experiences an electrical blackout, the Flashlight Head will light, and the flashlight can be operated by pressing the Power Button to run it through its three modes: pulse the light, turn the light off, and turn the light on steady.