

SEAT COVER INSTALLATION

BUCKET SEAT INSTALLATION

1. Remove and cover headrest.
2. Slide the cover evenly over the top until it reaches the bottom of the seat.
3. Pull flap through crevice.
4. Fit cover snugly over cushion seat and connect Velcro strap either under or behind the seat.
5. Wrap the elastic around the headrest holes.

BENCH SEAT INSTALLATION

1. Remove and cover headrests.
2. Pull seat forward and wrap the top over the backrest while aligning straps.
3. Wrap the bottom over the bench and pull top as well as bottom cover through the crevice evenly.
4. Attach all elastic hoops with supplied hooks.
5. Make small cuts for the seat belts and pull seat belt components through seat cover.
6. Make small cuts over the headrest support holes and insert headrests.

*If possible, removal of backseat bench will make installation easier.
 *In the rare occurrence that the bench seat belts are part of the bench and inhibits the usage of the seat covers, temporarily detach the seat belts to install. Refer to your vehicle manufacturer manual for further information. If the information isn't available, call us for further assistance.

NEEDED TOOLS



Scissor

OR



Retractable Knife

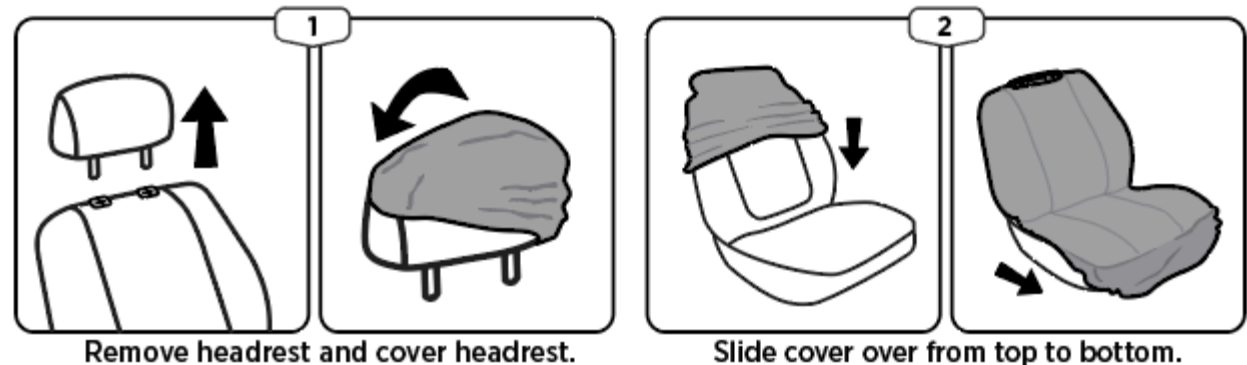

Remove headrest and cover headrest.

Slide cover over from top to bottom.

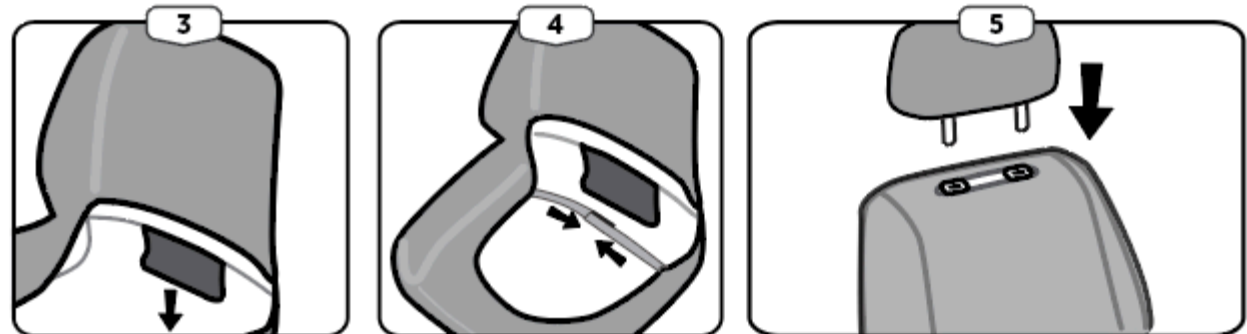

Pull flap through crevice.

Connect strap under seat.

Wrap elastic around headrest holes.

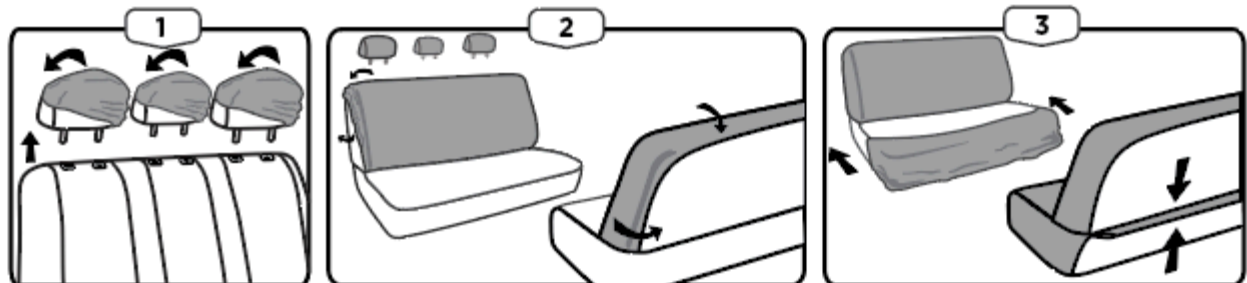

Remove headrests and cover headrests.

Pull seat forward and wrap the top over the backrest. Align straps.

Wrap bench. Pull top and bottom covers through crevice evenly.

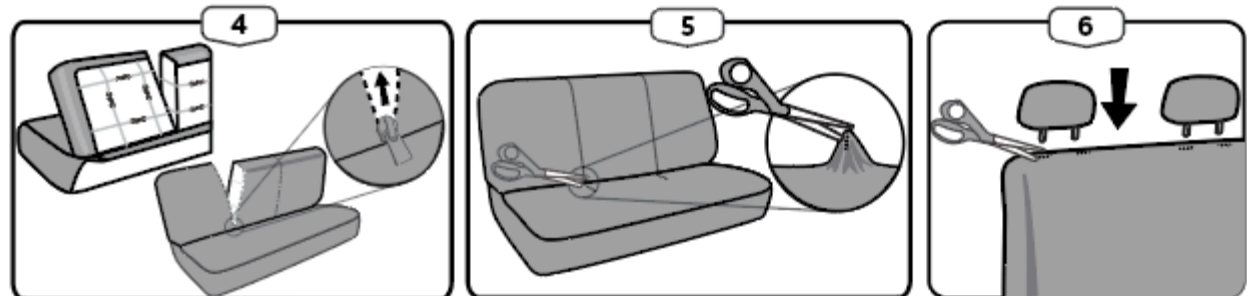

Attach all elastic with hooks. If desired, fasten 40/60 split portions separately.

Make small cuts for seat belts. Pull seat belts through cuts.

Make small cuts over headrest support holes.