

Introduction

Congratulations on your purchase of Dimmable Round type daylight. Thank you for choosing this unit. We know you will be satisfied with this new aid to your photographic creativity. This manual gives you easy to follow instructions for installing and using this unit. For best results, please read this operation instruction and keep them handy for your reference.

The impact fluorescent ring light with dimmer is a continuous light for photography and video. It casts a soft, wraparound light without the harsh shadows of conventional flashes, all the while minimizing heat so you can get close to your subject. The fluorescent lamp produces a pleasing daylight glow at 5200 K for a natural light quality, and a textured silver lining in the housing maximizes output. A user-controlled dimmer adjusts the brightness from 30%-100%.

The impact FRC-RLSL mounts to most light stands that have a 5/8" stud. A flexible mounting-arm adapter enables you to mount and bend the light into position, and an included mini ball head with L-bracket allows you to attach your point-and-shoot or mirror less camera into the center of the ring. Use the adjustable phone adapter to attach your smart phone, and the cold shoe to mount other options to your light rig.

Included diffusion and tungsten conversion panels clip easily to the housing of the ring light, with the min ball head, the L-bracket allows attachment of the mirror accessory so your model can make quick touch-ups before the next shot. Feel secure transporting everything from one location to the next with the padded carrying case.

Precautions

Please read and follow these instructions, and keep this manual in a safe place.

When you start to use the light or replace a new lamp tube, please keep using it on the status of full (100%) output for over 100hours at lease, and after that, you can rotate the dimmer and use it at any status. Otherwise, the life of the lamp tube will be shortened.

1. Be sure to look over the guide and familiar with its features before using.
2. Keep this unit away from children.
3. Clean the unit with a soft, dry cloth.
4. Appliance shall only be used with rated voltage and frequency.
5. Avoid unplugging the power by pulling the power cord and do not touch the power cord with wet hands.
6. Never attempt to insert any metal objects into the cooling holes of illuminators.
7. Avoid moving the illuminator by pulling the power cable.
8. While replacing the lamps, cut off the power, pull out the bad lamp, then mount on the new tubes.
9. Don't use or stop to use if the unit is damaged, especially the supply cord and the case. The lamp shall be changed if it has become damaged.
10. Not to be exposed dripping or splashing.
11. Waiting for the lamp cool before change the lamp.
12. Indoors use only.
13. Don't use the appliance on moisture place.
14. Professional to fix the appliance only.

15. Make sure everything is secure before proceeding.
16. Make sure the item is intact and that there are no missing parts.
17. Do not exceed the maximum load capacity.
18. All photos are for illustrative purposes only.

Light Body Diagram

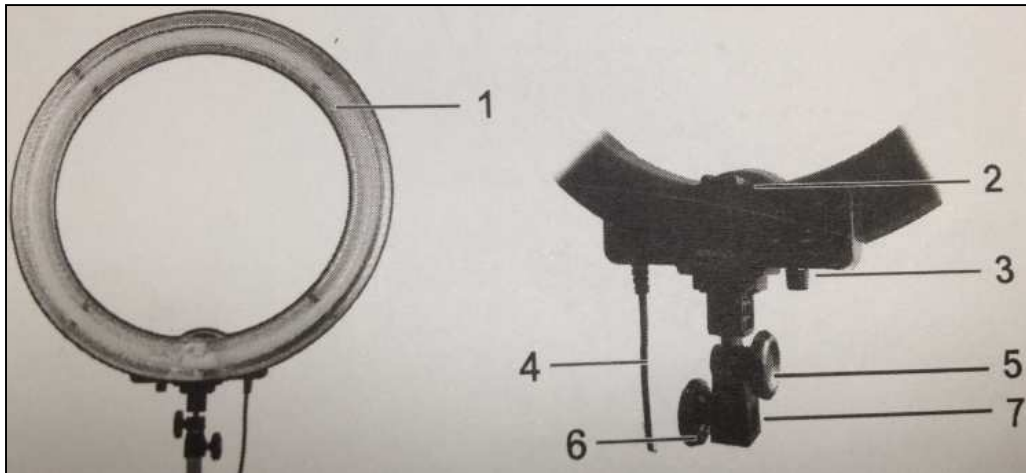

1. 75W Lamp Tube.
2. Hotshoe bracket.
3. Power & Dimmable switch (adjust from the lower to the higher clockwise).
4. Input power cable.
5. Angle Adjuster.
6. Screw Holder.
7. Stand Holder.

Packing list

Description	QTY
Light body	1
Light stand	1
Lamp tube (75W)	1
Mirror with holder	1
Gooseneck	1
Color filter (diffused/orange)	1
Clip-on diffuser panel	4
Clip-on tungsten conversion panel	4
Flexible stand mount	1
Min ball head mount	1
Cold shoe extension/smart phone cradle	1
User guide	1
Carry bag	1

Operating instructions

Mounting on a light stand

The impact ring light mounts to any standard 5/8" studded light stand. Loosen the light stand mount locking knob and seat the mounting receiver onto the stud of the light stand. Tighten the locking knob until secure, but do not over tighten.



Attaching the flexible stand mount



The flexible stand mount attaches to any standard 5/8" studded light stand. Loosen the locking knob on the flexible stand mount, and seat the mounting spigot onto the stud of the light stand. Tighten the locking knob until secure.

Loosen the ring light's stand mounting knob and seat the mounting spigot on top of the flexible stand mount. Tighten the light stand mounting knob until secure. Adjust the ring light into the

desired angle.

Connecting to a power supply

Plug the power cord into a grounded 110/120V AC power supply only.

Adjusting the light angle

Loosen the angle tilt knob and position to the desired angle. Retighten the angle tilt knob, but do not over tighten.

Switching on the power/dimmer

With the ring light facing away from you, rotate the power/dimmer knob counterclockwise until you hear a click. The lamp will take a few seconds to turn on and will be at full brightness. Within a few more seconds, it will decrease brightness to the current dimmer setting.

Adjusting the brightness

With the ring light facing away from you, rotate the power/dimmer knob to adjust the highest setting.

Attaching the mini ball head

Loosen the mounting foot at the base of the mini ball head. With the ring light facing away from you, slide the mini ball head mounting foot into the center shoe mount on the ring light housing. Rotate clockwise to tighten. It may be necessary to pull up on the mini ball head and rotate clockwise when tightening.



Attaching your camera



Align the 1/4"-20 stud on the mini ball head with the tripod mount of your camera. Rotate your camera clockwise onto the stud until secure. Use the locking thumbwheel on the ball head to tighten the attachment.



Adjusting the mini ball-head angle

Loosen the ball-head locking screw and angle it to the desired position. Retighten the ball-head locking screw so that your attached camera is secure.

Attaching the mirror

Loosen the mirror's locking screws. Slide the secure loops, which are on the back of the mirror attachment, onto the L-bracket. Make sure that the mirror will face your subject. Tighten the locking screws on the back of the mirror so that it does not move around. Remove the plastic film from the front of the mirror.

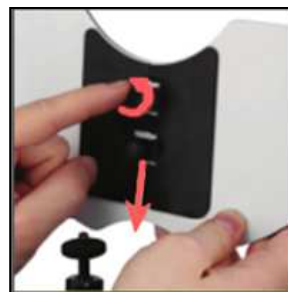

Attaching the cold shoe extension/smart phone cradle



Align the 1/4"-20 threaded socket on the bottom of the cradle with the mini ball head's 1/4"-20 stud. Rotate the cradle clockwise until secure.



Securing your smart phone on the cradle

Press the button on the side of the cradle to extend the cold shoe. The smart phone cradle is padded for no-slip security when your smart phone is inserted. Insert your smart phone, and press down on the cold shoe until your smart phone is secure.

Attaching the diffuser or tungsten conversion panels

The panels clip onto the front housing of the light ring to modify the light. Each one has tabs that clip onto the housing, and alignment lips to match up with the adjacent panels. Find the panel with the half-dome tab to align with the bottom of the lamp housing. Place and align the next panel so that one lip overlaps the next.



For the last panel, slide its alignment lip under the lip of the first panel. Firmly clip the panel onto the housing.



Changing the fluorescent lamp

When changing the fluorescent lamp, make sure to replace it with the Impact Replacement 18" Ring Lamp (FRC-RLSL LAMP).

1. Unplug the Impact Ring Light from the power supply.
2. Detach the four-pin plug from the fluorescent lamp.
3. Gently remove the lamp from each one of the four clips in the ring light housing.



4. Place the new, replacement 18" ring lamp and position it above the four clips in the ring light housing.
5. Gently clip the fluorescent lamp into each one of the four ring light housing clips.
6. Attach the four-pin plug to the ring lamp.

Technical specifications

Voltage	120V,50/60Hz / 230V,50/60Hz
Power consumption	75W
Tungsten equivalent	300W
Output	Max illuminance : 4000 lx@1m
	Min illuminance : 400 lx@1m
Light source	Fluorescent, user replaceable
Dimming	Yes
Brightness adjustable	30%-100%
Life span of lamp	If the brightness is 30%, the life span would be 6000hrs If the brightness is 100%, the life span would be 8000hrs So suggest to using the lamp in 100% brightness as many as possible
Color temperature	5500 K (±100K)
Reflector	Silver lining
CRI	Ra>90
Dimensions	Outer diameter:19"(48.3 cm)
	Middle diameter:18"(45.7cm)
	Inner diameter:14.5"(36.8 cm)
	Depth 2.75"(7 cm)
	Power cord length:7.3'(2.3m)
Weight	1.22kg
Dimension	H590mm × W490mm × L70mm