

Installing Anchors

Drywall: Refer to row one of figure one for instructions, use ¼” diameter drill bit

Brick and concrete: Refer to row two of figure one for instructions, use ¼” diameter drill bit

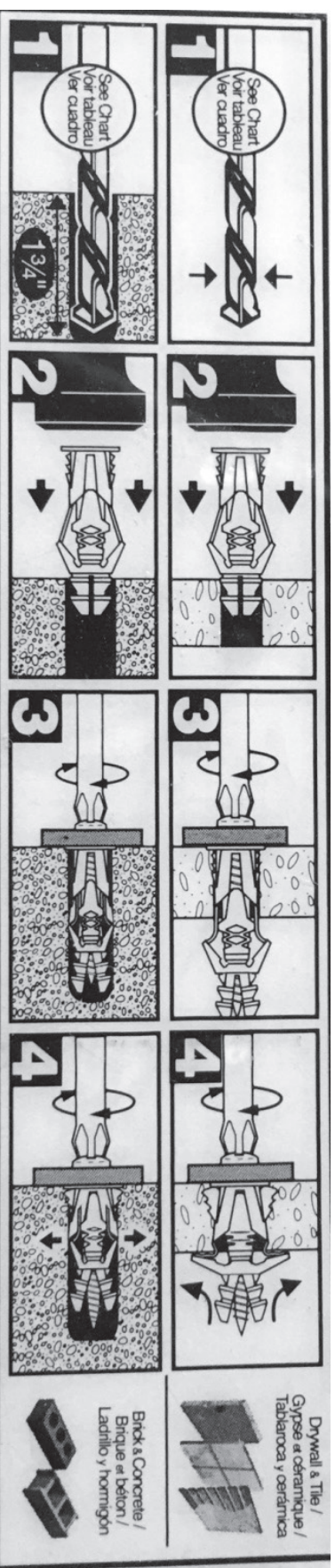

Figure one: Visual explanation of anchors (TripleGrip Image)

When using anchors only, we recommend you use one anchor for every 5 lbs. of weight applied to shelf.

For hanging shelves with heavy objects go to: <https://www.youtube.com/watch?v=c3by-3a8RfC> for further video instructions.

If you have issues finding the studs, we highly recommend this stud finder. Precision Sensors ProFinder 5000+ Professional Stud Finder with built-in bubble level and ruler. You can find it on Amazon for around \$40. It is also available at Menards for \$33. It is super easy and really does work. It's worth every penny.



FOR DECORATIVE BLACK BRACKETS:

[HTTPS://WWW.YOUTUBE.COM/WATCH?V=GSSAYOT7WU](https://www.youtube.com/watch?v=GSSAYOT7WU)

Rev 8/1/18