

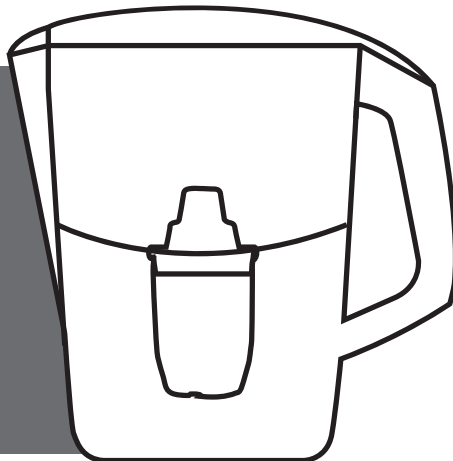

Water filter pitcher  
user manual and  
product specification



Dear customer!

Thank you for choosing our product.

We want you and your family to enjoy clean drinking water. This water filter does not require connection to water main, so you can take it to a country house, or on a trip. Before using the product, please read the manual and check that the warranty card is correctly filled out.

## Technical specification

Product model	LUNA	MAXIMA/SOLO	DUO
Volume of pitcher, L (gal)	3.5 (0.9)	5 (1.3)	5 (1.3)
Purified water volume, L (gal)	2 (0.5)	3.5 (0.9)	3.5 (0.9)
Temperature of water, °C (F)	+4...+30 (+39...+86)	+4...+30 (+39...+86)	+4...+30 (+39...+86)
WxDxH Dimensions, mm inches	275x130x235 10.8x5.1x9.3	285x170x270 11.2x6.7x10.6	285x170x270 11.2x6.7x10.6

## Preparing for use/Cartridge replacement

1. Remove the old cartridge.\*
2. Wash the filter and rinse thoroughly.
3. Dip cartridge in water for 5–10 minutes. Tap on the cartridge to make the air rise.
4. Place the cartridge in its socket.
5. Start filling the pitcher with water, then discard the first jugful of purified water. Repeat one more time.
6. The filter is ready for use.

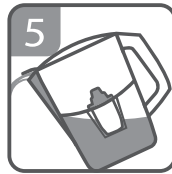
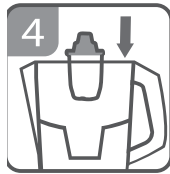
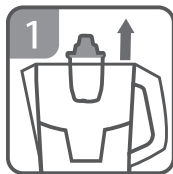

\* If your filter was already in use

## Recommendations for use

- The filter should only be used for purifying cold water.
- Use the product only as directed.
- Keep filter parts clean. Wash the filter jug and funnel with dishwashing liquid then rinse clean and wipe dry at least once a month.
- Do not expose to direct sunlight
- Do not leave the filter empty when it is in use.
- When not using the filter for more than 3 days, discard water from the jug and wipe filter parts dry.
- Repeat the procedure for preparing the filter for use after not using.

## Cartridges

Before this product was released, its designers studied thousands of water analyses to develop cartridges that are right for your type of water.

**It is recommended to replace cartridges at least once a month to obtain clean drinking water.**

Service life of cartridge should not exceed 3 month from beginning of use regardless of water usage.

Maximum storage life of cartridge is 3 years.

## R&D center

Ecosoft is a large multinational enterprise, engineering and producing a complete range of water filters.

Water filter pitchers, among hundreds of others products, were designed and tested by our own R&D center.

## Warranty card

Warranty is valid for 12 months since purchase, as long as the product is used as indicated herein. Warranty does not cover replacement cartridge, manufacturing defects that have not been claimed during warranty period, nor defects caused by improper handling of the product. Warranty claims shall be handled by seller, provided that the customer presents cash receipt/invoice and filled warranty card. Cases that are not covered by the Warranty shall be resolved under current legislation.

Warranty period is 12 months after purchase.  
Storage life of pitcher housing is 5 years.

## Warranty card

Seller's name and stamp:

Product description:

