

!!! FCC WARNING

This device complies with Part 15 of the FCC Rules. Operation is subject to the following two conditions: (1) This device may not cause harmful interference, and (2) this device must accept any interference received, including interference that may cause undesired operation.

This equipment has been tested and found to comply with the limits for a Class B digital device, pursuant to Part 15 of the FCC Rules. These limits are designed to provide reasonable protection against harmful interference in a residential installation. This equipment generates, uses and can radiate radio frequency energy and, if not installed and used in accordance with the instructions, may cause harmful interference to radio communications. However, there is no guarantee that interference will not occur in a particular installation. If this equipment does cause harmful interference to radio or television reception, which can be determined by turning the equipment off and on, the user is encouraged to try to correct the interference by one of the following measures:

- Reorient or relocate the receiving antenna.
- Increase the separation between the equipment and receiver.
- Connect the equipment into an outlet on a circuit different from that to which the receiver is connected.
- Consult the dealer or an experienced radio/TV technician for help.

FCC CAUTION:
Any changes or modifications not expressly approved by the party responsible for compliance could void the user's authority to operate this equipment. This transmitter must not be co-located or operating in conjunction with any other antenna or transmitter.

RADIATION EXPOSURE STATEMENT (TRANSMITTER):
This equipment complies with FCC radiation exposure limits set forth for an uncontrolled environment. This equipment should be installed and operated with minimum distance 20cm between the radiator & your body.

RADIATION EXPOSURE STATEMENT (RECEIVER):
This equipment complies with FCC radiation exposure limits set forth for an uncontrolled environment. This equipment should be installed and operated with minimum distance 20cm between the radiator & your body.

Note: The country code selection is for non-US model only and is not available to all US model. Per FCC regulation, all WiFi product marketed in US must fixed to US operation channels only.

!!! IC STATEMENT

This device complies with ISED's licence-exempt RSSs. Operation is subject to the following two conditions: (1) This device may not cause harmful interference, and (2) this device must accept any interference received, including interference that may cause undesired operation.

CAUTION :
(i) the device for operation in the band 5150-5250 MHz is only for indoor use to reduce the potential for harmful interference to co-channel mobile satellite systems; (ii) the maximum antenna gain permitted for devices in the bands 5250-5350 MHz and 5470-5725 MHz shall be such that the equipment still complies with the e.i.r.p. limit; (iii) the maximum antenna gain permitted for devices in the band 5725-5850 MHz shall be such that the equipment still complies with the e.i.r.p. limits specified for point-to-point and non-point-to-point operation as appropriate; and (iv) Users should also be advised that high-power radars are allocated as primary users (i.e. priority users) of the bands 5250-5350 MHz and 5650-5850 MHz and that these radars could cause interference and/or damage to LE-LAN devices.

RADIATION EXPOSURE STATEMENT:
This equipment complies with ISED radiation exposure limits set forth for an uncontrolled environment. This equipment should be installed and operated with minimum distance 20cm between the radiator & your body.

01 RECEIVER

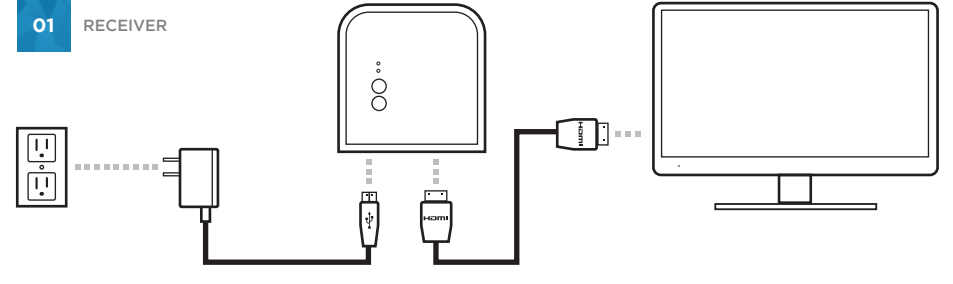

02 TRANSMITTER

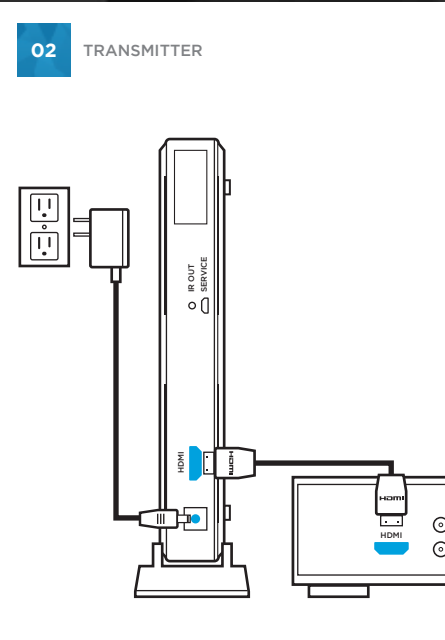

03 IR EXTENDER SETUP

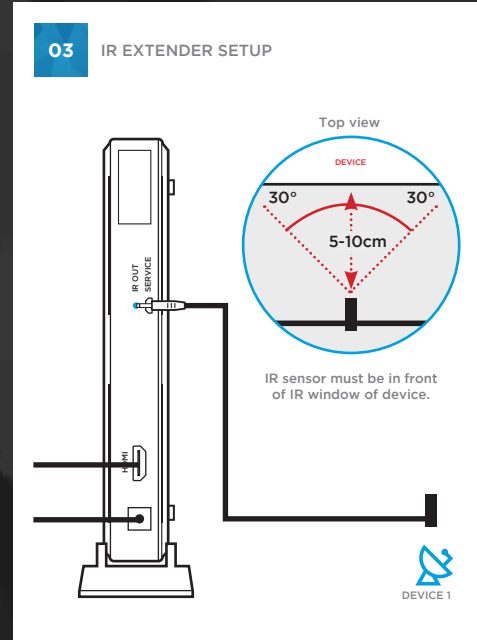

01 POWER ON TRANSMITTER

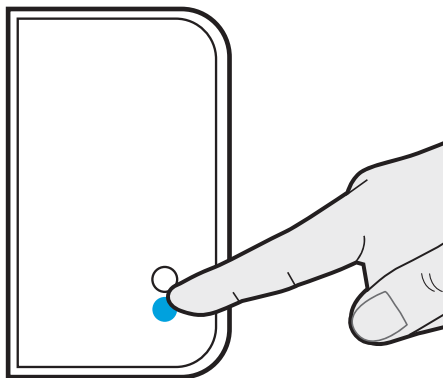

02 POWER ON RECEIVER

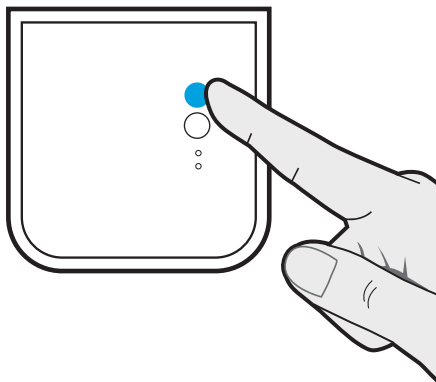

03

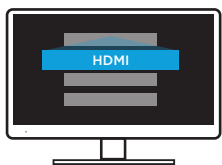

Select HDMI from your TV's source/input menu

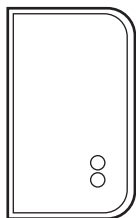

Allow 8-10 seconds to connect

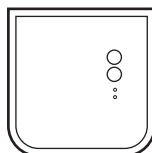

IR EXTENDER SETUP

!!! BEFORE YOU BEGIN!

WHAT IS AN IR EXTENDER CABLE?

The ARIES™ Home and Home+ come with an IR extender that allows you to control your source device with its remote from the TV's location. The remote's IR signal is transmitted by the receiver to the transmitter and then through the IR extender to the source device.

NEED HELP FINDING YOUR IR SENSOR?

Cut a piece of cardboard to the same size as the front panel of your source device and place a 1 inch hole in the middle of the cardboard. Power ON your source device and play a movie or other video content. Place the cardboard hole over the left side of the source device and using the source device's remote control directly over the cardboard hole, press the pause button repetitively while gradually moving the cardboard hole from left to right making sure to keep the remote control's beam directly over the cardboard hole. Once the source device recognizes the pause button being pressed, you have located the position of the remote control IR sensor on the source device and that is where you will place the IR Extenders sensor.

01 TRANSMITTER

1. Plug the IR Extender cable in to the IR "Out" jack of the transmitter.
2. Position the IR Extender head in front but not on the IR sensor of your HD audio/video source device(s).

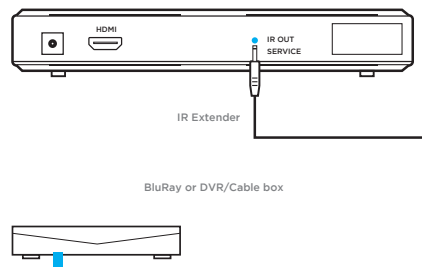

02 RECEIVER

1. Ensure the front of the NAVS500-RX is visible to receive the commands from the remote.

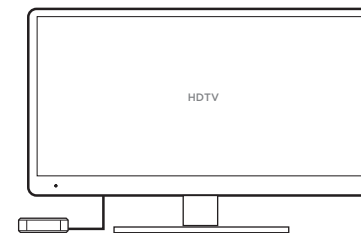

PLEASE NOTE:
Obstacles will decrease the distance of the IR extender. Transmitter and source devices connected to the Transmitter must all be in line of sight for IR control.

* Obstacles may decrease transmission distance. Interference may come from other wireless devices using 5GHz band.

For additional product information, please consult the manual at: NYRIUS.COM/SUPPORT