

# STEEL MOTORCYCLE CARRIER WITH RAMP

## OWNER'S MANUAL



### **WARNING:**

Read carefully and understand all **ASSEMBLY AND OPERATION INSTRUCTIONS** before operating. Failure to follow the safety rules and other basic safety precautions may result in serious personal injury.

Item# MCC-500

Thank you for purchasing the MCC-500 Steel Motorcycle Carrier with Ramp. For future reference, please complete the owner's record below:

Model: \_\_\_\_\_ Purchase Date: \_\_\_\_\_

Save the receipt, warranty and these instructions. It is important that you read the entire manual to become familiar with this product before you begin using it.

This equipment is designed for certain applications only. The manufacturer cannot be responsible for issues arising from modification and strongly recommends that it not be modified and/or used for any application other than that for which it was designed. If you have any questions relative to a particular application, DO NOT use the equipment until you first contact the place of purchase to determine if it can or should be performed on the product.

## TECHNICAL SPECIFICATIONS

Capacity	500 lbs. (227kg)
Usable rack size	75.7"L x 6.9"W
Ramp Size	45.5"L x 6.9"W

## GENERAL SAFETY RULES



**WARNING:** Read and understand all instructions. Failure to follow all instructions listed below may result in serious injury.



**CAUTION:** Do not allow persons to operate or assemble this steel motorcycle carrier until they have read this manual and have a thorough understanding of how the steel motorcycle carrier works.



**WARNING:** The warnings, cautions, and instructions discussed in this instruction manual cannot cover all possible conditions or situations that could occur. It must be understood by the operator that common sense and caution are factors which cannot be built into this product, but must be supplied by the operator.

## SAVE THESE INSTRUCTIONS

### WORK AREA

- **Keep work area clean**, free of clutter and well lit. Cluttered and dark work areas can cause accidents.
- **Keep children and bystanders** away while operating the steel motorcycle carrier. Distractions can cause you to lose control, so visitors should remain at a safe distance from the work area.
- **Be aware of all power lines, electrical circuits**, water pipes and other mechanical hazards in your work area, particularly those hazards below the work surface hidden from the operator's view that may be unintentionally contacted and may cause personal harm or property damage.
- **Be alert of your surroundings.** Using the steel motorcycle carrier in a confined work area may put you dangerously close to cutting tools and rotating parts.

## PERSONAL SAFETY

- **Stay alert**, watch what you are doing and use common sense when using the steel motorcycle carrier. Do not use the steel motorcycle carrier while you are tired or under the influence of drugs, alcohol or medication. A moment of inattention while operating a steel motorcycle carrier may result in serious personal injury.
- **Dress properly**. Do not wear loose clothing, dangling objects, or jewelry. Keep your hair, clothing and gloves away from moving parts. Loose clothes, jewelry or long hair can be caught in moving parts.
- **Use safety apparel and equipment**. Use safety goggles or safety glasses with side shields which comply with current national standards, or, when needed, a face shield. Use a dust mask in dusty work conditions. This applies to all persons in the work area. Also use non-skid safety shoes, hardhat, gloves, a dust collection system, and hearing protection when appropriate.

## STEEL MOTORCYCLE CARRIER USE AND CARE

- **Do not modify the steel motorcycle carrier in any way**. Unauthorized modification may impair the function and/or safety and could affect the life of the equipment. There are specific applications for which the steel motorcycle carrier was designed.
- **Always check for damaged or worn out parts before using the steel motorcycle carrier**. Broken parts will affect the steel motorcycle carrier's operation. Replace or repair damaged or worn parts immediately.
- **Do not exceed the steel motorcycle carrier load capacity**.
- **Distribute the load evenly**. Uneven loads may cause the steel motorcycle carrier to tip, resulting in personal injury to the operator or others. To minimize the effects of dynamic loading, make sure the load is centered on the carrier.
- **Use the steel motorcycle carrier on flat and level surfaces** capable of supporting the steel motorcycle carrier and its maximum load. Pulling or pushing a load on a slanted or uneven surface can result in loss of control.
- **Prior to transporting a load**, make sure the ramp of the carrier is folded and secured. The load itself must also be properly secured to the carrier.
- **Storing the steel motorcycle carrier**. When the steel motorcycle carrier is not in use, store it in a secure place out of the reach of children. Inspect it for good working condition prior to storage and before re-use.



**WARNING! Flammable cargo can ignite from exposure to heat.** Be aware of the possible fire risk and property damage resulting from the vehicle's exhaust system pointing at or running near the cargo in the carrier. Do not use if this condition exists.

## ASSEMBLY

### Carrier Assembly

For additional information regarding the parts listed in the following pages, refer to **Parts List and Assembly Diagram** in the manual. Please note that **bolts and nuts should be tightened by hand first; after all parts have been assembled, go back and tighten all hardware with a wrench.**

1. Place the Hitch Tube (15) on a solid work surface with mounting brackets facing upward.
2. Place Platform (4) across Hitch Tube (15), positioned between two middle brackets of Hitch Tube (15). Align the holes and secure with four Bolts (16) and four Nuts (8).

3. Put Cross Bars (3) on top of Platform (4) and Support Brackets (9) beneath Platform (4), aligning holes and securing with four Bolts (1) and four Nuts (8).
4. Insert Bolt (2) through middle hole of Cross Bars (3), Platform (4) and Hitch Tube (15). Secure with nut (8).
5. Slide four Bolts (7) into Platform (4) and secure with Nut (8).
6. Attach Tie Down Hook Bracket (19) onto end plate of Hitch Tube (15) using two Bolts (20) and two Nuts (18).
7. Position Ramp (21) on Hitch Tube (15), with middle rung of Ramp between mounting brackets. Secure Ramp in place using Lock Pin (17).
8. Tighten all hardware, making sure all parts are secure.

### **Mounting Carrier to Hitch Receiver**

1. Remove Hitch Pin (14) and R-Pin (13) from front of Hitch Tube (15).
2. Slide Anti-Tilt Bracket (12) over end of Hitch Tube. Make sure the large, open end of Anti-Tilt Bracket faces hitch receiver on car **and bolts (10) face downward**.
3. With assistance, lift empty Carrier and slide open end of Hitch Tube into hitch receiver. Secure with Hitch Pin (14) and R Pin (13).
4. Slide Anti-Tilt Bracket (12) up against hitch receiver. Tighten the two bolts (10) against underside of hitch receiver collar.

### **OPERATION**

1. Remove Lock Pin (17) to unlock Ramp.
2. Remove Ramp and place end rung onto hook end of Platform (4), making sure Ramp is secured to Platform. Bottom end of Ramp (21) must rest flat on solid, level surface when loading and unloading equipment.
3. Measure motorcycle wheelbase to determine correct position of bolts (7).
4. Shift motorcycle into neutral and, with another person's assistance, push up Ramp.
5. **One person MUST** support motorcycle throughout entire loading process! Push motorcycle completely onto carrier platform until front wheel rests in place between platform rungs. Install both Wheel Lock Pins (6) through motorcycle wheels and secure with R-pins (5).
6. **Note:** If front wheel cannot be secured with Wheel Lock Pins, use proper ratchet tie down straps to firmly secure it to end of platform.
7. Secure motorcycle at more tie down points using additional tie downs, ropes, etc. (not included). **Do not exceed the 500 lbs. maximum weight capacity.**
8. Return Ramp (21) to mounted position and secure with Lock Pin (17).
9. Attach any needed markers and/or lights to carrier and motorcycle as required by vehicle codes.
10. The Carrier is now ready to transport.

**IMPORTANT:** Maintain labels and nameplates on the Carrier. These contain important safety information. If unreadable or missing, contact your supplier for a replacement.



**WARNING:** NEVER impede or block vehicle exhaust. Always keep exhaust pipe and exhaust path clear.

1. This Carrier has a maximum weight capacity of **500 lbs.** Do not exceed the 500 lb capacity.
2. Do not exceed 55 MPH while the Carrier is attached.
3. Always secure the Carrier as close to your vehicle as possible, minimizing the distance of the

- Carrier and its load from your vehicle.
4. Beware of dynamic loading! Dropping or bouncing a load may briefly create excess load, causing personal injury and/or product failure.
  5. Inspect before use, including all bolts and nuts in the Carrier. Do not use if damaged.
  6. Turn off the vehicle's ignition and set the parking brake before loading an object onto the Carrier or unloading.
  7. Review and understand all instructions and warnings set forth by the manufacturer of the vehicle that the carrier will be used with.
  8. The ends of the Carrier's Ramps (21) must rest flat on a solid, level surface when loading and unloading an object.
  9. Keep the Carrier clean and dry at all times.
  10. This product is not a toy. Keep it out of reach of children.
  11. Never ride a motorized object (powered scooters, lawn tractors, ATV's, etc.) onto or off the Carrier. Only load/unload with the motorized object **empty** of cargo and people.
  12. Follow D.O.T. (Department of Transportation) guidelines for installation and use.
  13. Secure the load on the Carrier with ropes, and/or tie downs (not included) before transporting.
  14. Only use the Carrier with a properly installed **Class III or Class IV** 2 inch hitch receiver capable of supporting the Carrier and its load.
  15. The warnings, precautions, and instructions discussed in this manual cannot cover all possible conditions and situations that may occur. It must be understood by the operator that common sense and caution are factors which cannot be built into this product but must be supplied by the operator.
  16.  **WARNING! Flammable cargo can ignite from exposure to heat.** Be aware of the possible fire risk and property damage resulting from the vehicle's exhaust system pointing at or running near the cargo in the carrier. Do not use if this condition exists.

## MAINTENANCE

- **Maintain your steel motorcycle carrier.** It is recommended that the general condition of any steel motorcycle carrier be examined each time before it is used. Keep your steel motorcycle carrier in good repair by adopting a program of conscientious repair and maintenance. If any abnormal vibrations or noise occur, have the problem corrected before further use. Have necessary repairs made by qualified service personnel.
  - **BEFORE EACH USE**, inspect the general condition of the Carrier. Check misalignment, loose or damaged parts and any other condition that may affect its safe operation.
  - **BEFORE EACH USE**, make sure any dirt, debris, oil, grease, etc. are cleaned off the Carrier. Clean the Carrier with a clean, moist cloth. Do not use solvents.
  - **PERIODICALLY** check all hardware for tightness.

## DIAGRAM & PARTS LIST

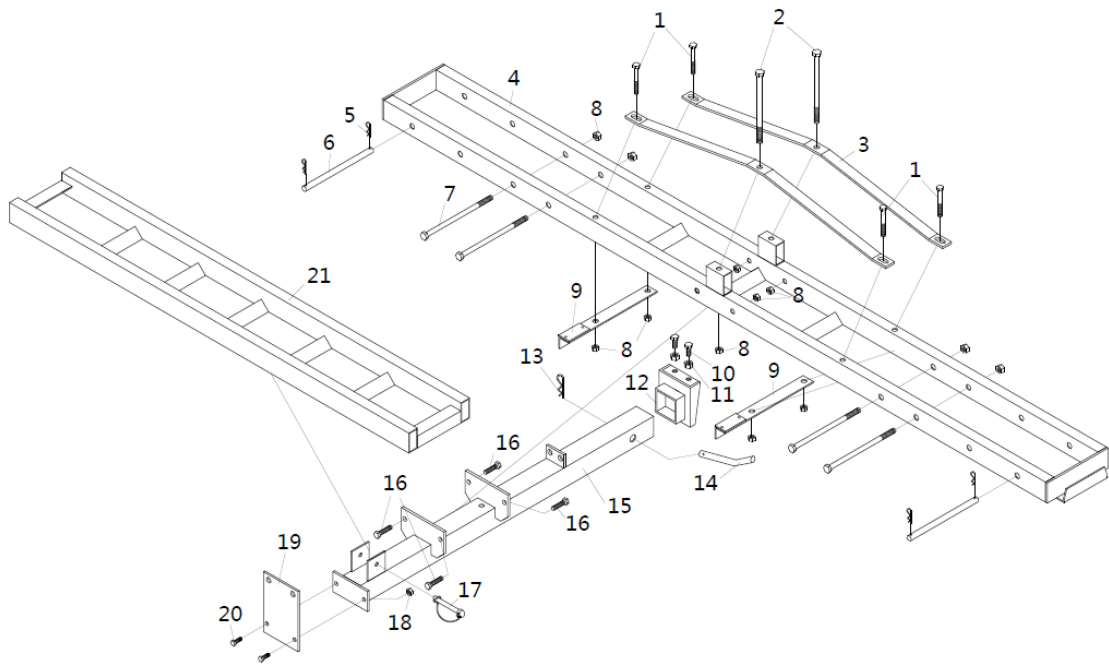

Part #	Description	Qty.
1	Bolt	4
2	Bolt	2
3	Cross Bar	2
4	Platform	1
5	R-Pin	4
6	Wheel Lock Pin	2
7	Bolt	4
8	Nut	14
9	Bracket	2
10	Bolt	2
11	Nut	2

Part #	Description	Qty.
12	Anti-Tilt Bracket	1
13	R-Pin	1
14	Hitch Pin	1
15	Hitch Tube	1
16	Bolt	4
17	Lock Pin	1
18	Nut	2
19	Tie Down Hook Bracket	1
20	Bolt	2
21	Ramp	1