

## MIPC APP WEBSITE:

[www.mipcm.com](http://www.mipcm.com)

## CAMERA SET UP VIDEO

<https://youtu.be/uF6-HcfVj28>

## SERVICE E-MAIL ADDRESS

[support@vipkamtron.com](mailto:support@vipkamtron.com)

## 1. SETTINGS FOR MOTION DETECTION

Please make sure your phone allow MIPC send notifications before you set it.

1.Enter into the APP -- click the camera -- settings -- Alarm -- Motion Detection.

Then you can set you own alarm schedule and save.

2.Go back the settings, click the Record,choose the "continuous recording" or "motion detection",turn on the "allow record" and save.

3.In the setting of the “Motion Detection”, you can adjust the “Motion detection sensitivity” according to your demands.

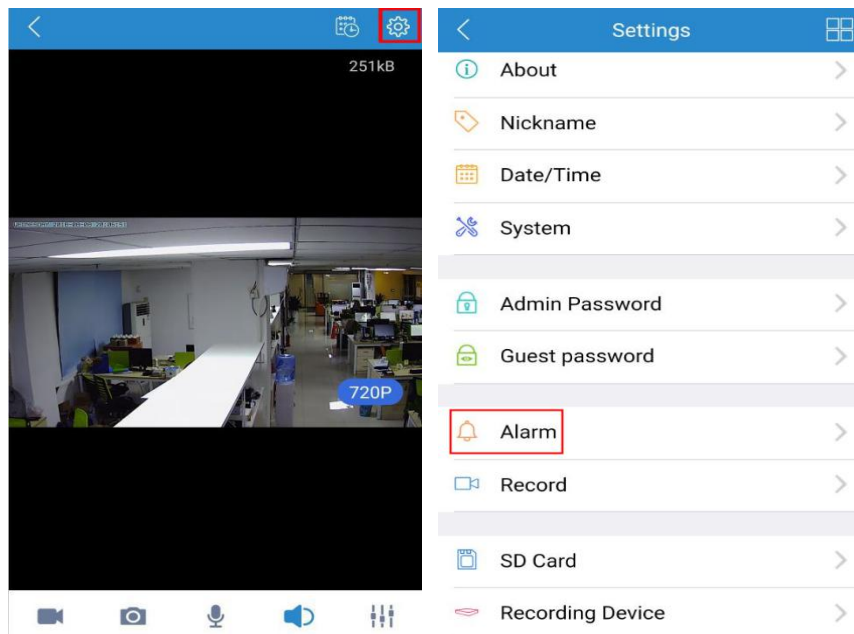

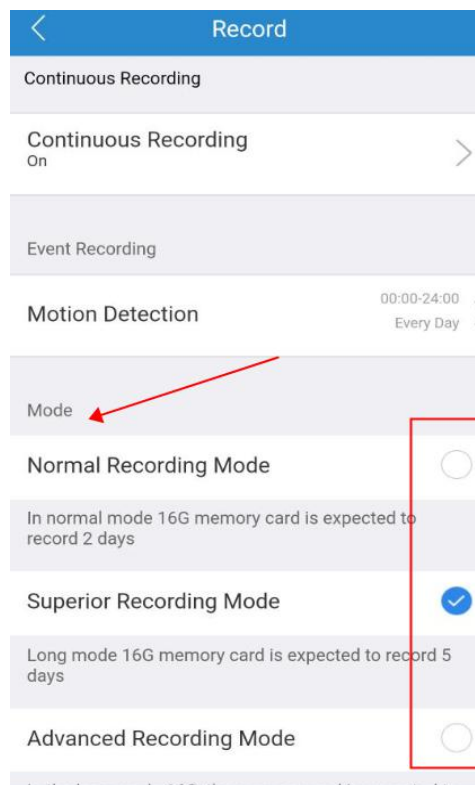
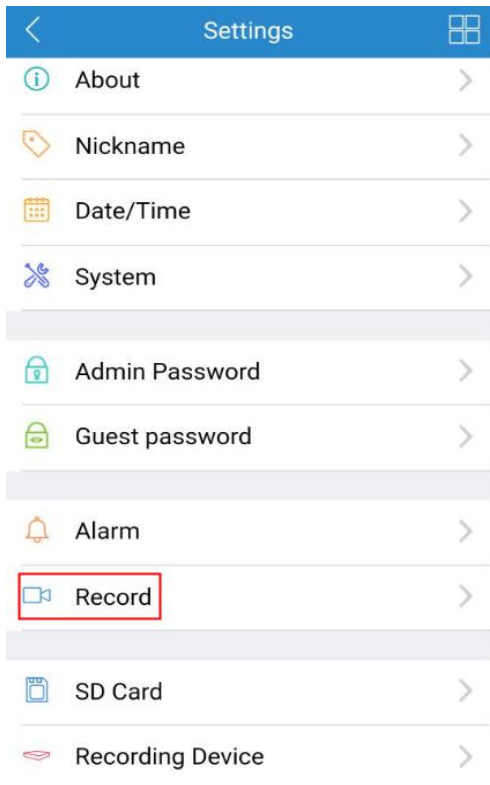
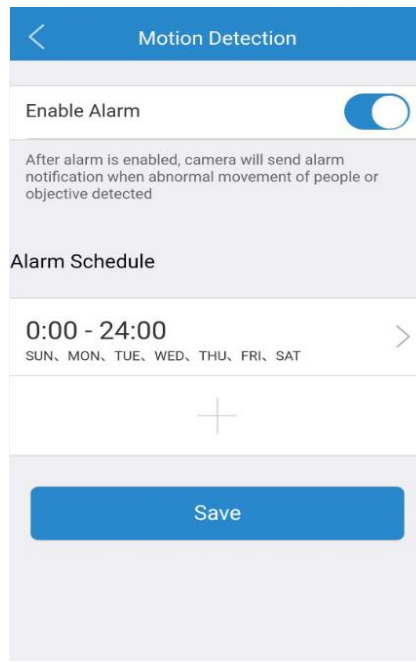
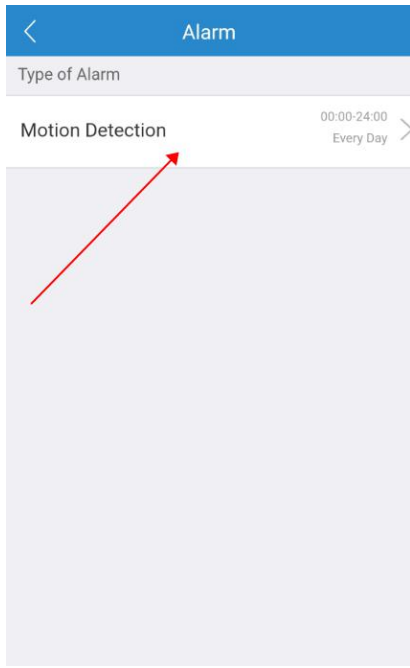

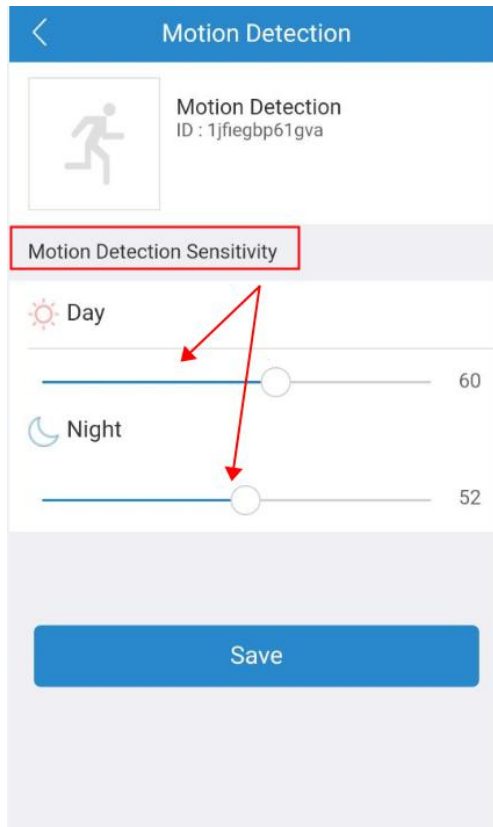

## 2. DAY/NIGHT MODE

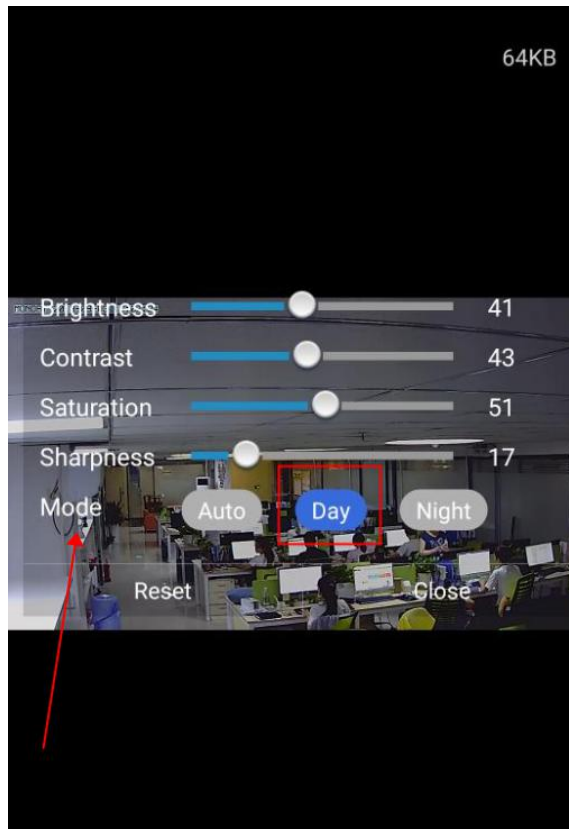
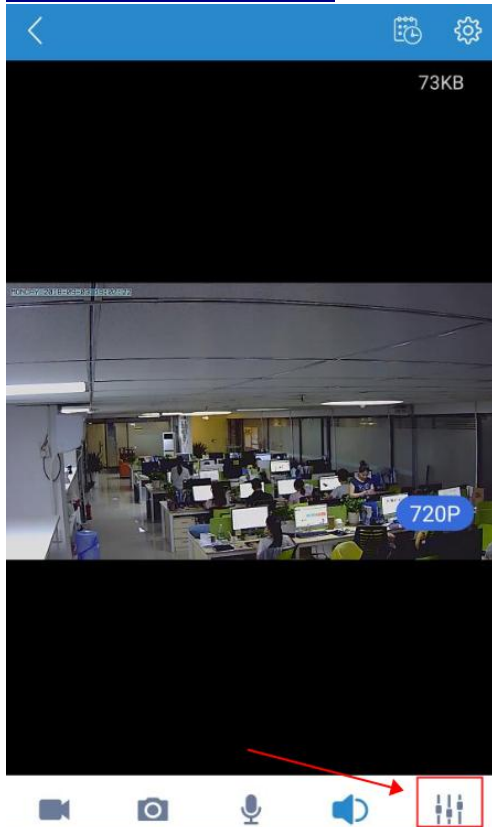

### 3. WiFi Configuration via Ethernet cable when cannot connect wifi directly

Please reset factory settings (press reset button with 15s) and try to connect with Ethernet cable to check if it could work, if so, then you could configure with wifi

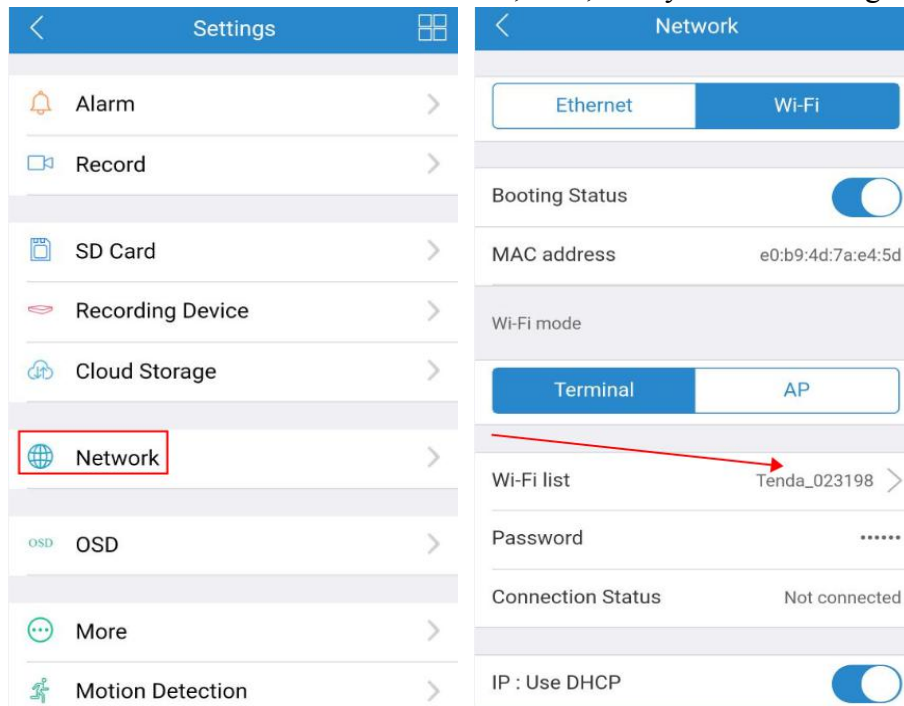

### 4. Speaker and Mic settings

Choose the camera interface and go to "Settings"->"More"-adjust the Speaker and Mic

