



INSTALLATION INSTRUCTIONS

57-3021-1
Chevrolet/GMC
Silverado/Sierra
1999-2004 V8-4.8L, 5.3L (Except 2500 models)

NOTE: This kit was not designed to fit vehicles with a body lift

TOOLS NEEDED:

Flat Blade Screwdriver
4mm Allen Wrench
10mm Wrench
Ratchet
10mm Socket
13mm Socket

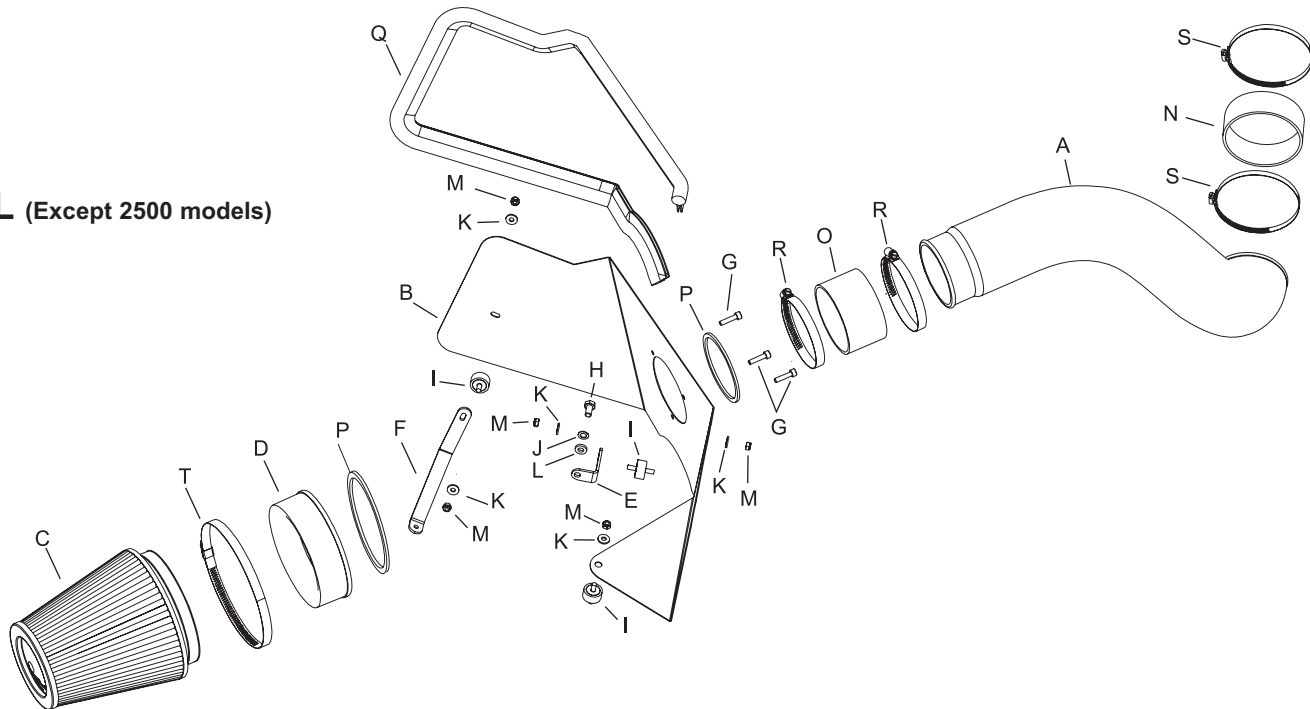

PARTS LIST:

Desc.	Part #	QTY.							
A Intake tube	08740	1	I Rubber Mntd stud	07027	3	Q Trim seal 48"	102485	1	
B Heat shield	07415	1	J Wave Washer	08239	1	R Hose clamp #60	08624	2	
C Air Filter	RF-1041	1	K 1/4"ID x 5/8"OD flat washer	08275	5	S Hose clamp #64 midi	08650	2	
D Adapter	08783	1	L 5/16"ID x 5/8"OD flat washer	08276	1	T Hose clamp #104	08697	1	
E "L" bracket	070812	1	M Nylock nut	07553	5				
F "C" bracket	070822	1	N 4"ID x 1.5"L silicone hose	08755	1				
G Allen bolt	08320	3	O 3.75"ID x 2"L silicone hose	08631	1				
H Hex bolt	07844	1	P Gasket	09033	2				

NOTE: FAILURE TO FOLLOW INSTALLATION INSTRUCTIONS AND NOT USING THE PROVIDED HARDWARE MAY DAMAGE THE INTAKE TUBE, THROTTLE BODY AND ENGINE.

TO START:

1. Turn the ignition OFF and disconnect the vehicle's negative battery cable.



2. Disconnect the mass air sensor electrical connection.



3. Loosen the hose clamp on the intake hose at the mass air sensor.



4. Loosen the hose clamp on the intake tube at the throttle body.



5) Using a flat blade screwdriver, pry the radiator hose retaining clip from the intake tube.



6. Detach the intake hose from the mass air sensor.



7. Detach the intake tube from the throttle body and remove the intake assembly.



8. Pull firmly upward and remove the airbox.
Note: K&N recommends that customers do not discard factory air intake.



9. Loosen the hose clamp and remove the mass air sensor from the airbox.

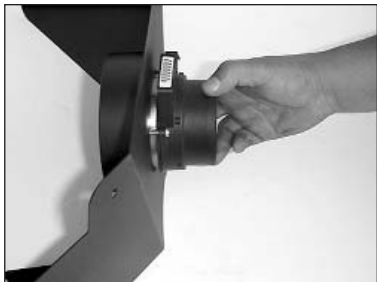

10. Assemble the mass air sensor, heat shield and adapter using the gasket and hardware provided.



11. Install the trim seal onto the heat shield as shown.
Note: Some cutting and trimming may be necessary to achieve best fit.



12. Attach the rubber mounted stud to the "C" bracket.
Note: Do not tighten completely at this time.



13. Attach the "C" bracket assembly to the heat shield as shown.
Note: Do not tighten completely at this time.



14. Attach the rubber mounted stud to the "L" bracket.
Note: Do not tighten completely at this time.



15. Attach the "L" bracket assembly to the heat shield.
Note: Do not tighten completely at this time.

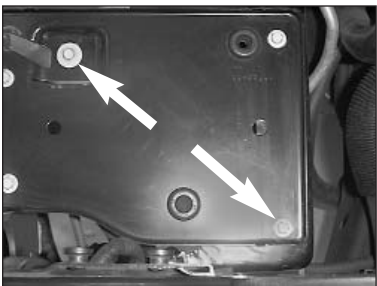

16. Loosen and remove the two bolts on the airbox mounting tray.
Note: One of these bolts will not be reused.

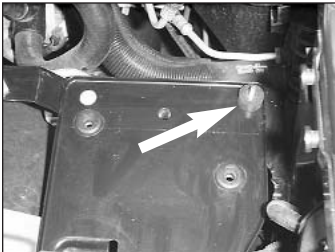

17. Install the rubber mounted stud into the threaded hole in the airbox mounting tray as shown.



18. Install the heat shield assembly.



19. Secure the "C" bracket to the threaded hole in the airbox mounting tray using the bolt removed in step 16.



20. Secure the "L" bracket to the threaded hole in the radiator core support using the hardware provided.



21. Secure the heat shield to the rubber mounted stud using the hardware provided.



22. Install the 4"ID silicone hose onto the intake tube.
Note: Do not tighten the hose clamps at this time.



23. Install the 3.75"ID silicone hose (08631) onto the intake tube.
Note: Do not tighten the hose clamps at this time.



24. Install the intake tube and tighten the hose clamp on the silicone hose at the throttle body.



25. Align the intake tube with the mass air sensor and tighten the hose clamp on the silicone hose at the mass air sensor.



26. Align and check the intake tube for clearance, tighten the hose clamp on the silicone hose at the intake tube.



27. Tighten the hose clamp on the silicone hose at the intake tube.

28. Go back and tighten the hardware that mounts the brackets and heat shield.



29. Due to production tolerances it may be necessary to mark the fan shroud as indicated, remove the intake tube and trim the fan shroud.
Note: Be sure to cover the throttle body and alternator during this process.



30. Install the Air filter element and secure with hose clamp.

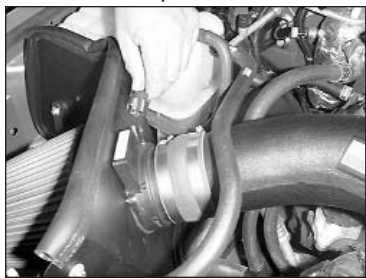

31. Reconnect the mass air sensor electrical connector.

32. Reconnect the vehicle's negative battery cable. Double check to make sure everything is tight and properly positioned before starting the vehicle.

33. The C.A.R.B. exemption sticker, (attached), must be visible under the hood, so that an emissions inspector can see it when the vehicle is required to be tested for emissions. California requires testing every two years, other states may vary.

34. It will be necessary for all FIPK's to be checked periodically for realignment, clearance and tightening of all connections. Failure to follow the above instructions or proper maintenance may void warranty.

ROAD TESTING:

1. Start the engine with the transmission in neutral or park, and the parking brake engaged. Listen for air leaks or odd noises. For air leaks secure hoses and connections. For odd noises, find cause and repair before proceeding. This kit will function identically to the factory system except for being louder and much more responsive.
2. Test drive the vehicle. Listen for odd noises or rattles and fix as necessary.
3. If road test is fine, you can now enjoy the added power and performance from your kit.
4. K&N suggests checking the Air filter element periodically for excessive dirt build-up. When the element becomes covered in dirt (or once a year), service it according to the instructions on the Recharger service kit, part number 99-5050 or 99-5000.