

How does the length setting on my Philips groomer work?

The length setting on your Philips groomer is indicated by a figure on the comb or display. This figure represents the remaining hair length after grooming. This can be the hair length in mm or inches, or a setting.

How to set your length:

- 1) Make sure you place the comb correctly
- 2) Depending on your model, adjust the length:
 - By turning the zoom wheel
 - By pressing the setting selector on the comb and sliding it to the desired setting.

How do I best use my Philips beard trimmer?

Your Philips beard trimmer should give you great results, every time. There are, however, tips and tricks to help you on your way. Just follow these simple steps.

How to use your Philips beard trimmer:

- 1) Select the right length setting; we advise to start with a higher setting if you're inexperienced
- 2) Turn on the beard trimmer
- 3) Move the beard trimmer slowly, against the direction of hair growth

Tips and tricks:

- Make sure that you place the beard trimmer on your face at the right angle
- Use the beard trimmer without the comb for contouring and for the shortest length setting
- For perfect results, move the beard trimmer in different directions over your skin

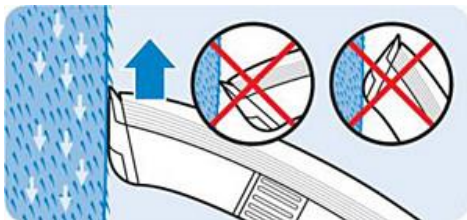

How to use my Philips groomer on different voltages

As your power plug is equipped with an automatic voltage selector, it will automatically adjust to the right voltage.

How to optimize the battery lifetime of my Philips groomer

This appliance contains Lithium-ion batteries that do not have to be charged longer the first time to reach their full capacity.

You can recharge your appliance after every use.

Unlike traditional batteries, this type of battery is not harmed by frequent recharging.

What do the numbers on my Philips groomer comb mean?

The numbers on the comb or display of your Philips groomer indicate the length setting on the device.

This can be the remaining hair length in mm or inches, or a number that corresponds to a length setting.

Can I use my Philips groomer directly from the mains?

Yes, you can use it directly from the mains.

What can I use my Philips beard trimmer for?

This appliance can be used to trim beards. Do not use it for any other purpose.

Why not?

The cutting element of a beard trimmer is usually smaller than that of a hair clipper. The comb is smaller, to allow you to easily reach under the nose. Beard hairs are usually stiffer than scalp hairs. They therefore don't need to be lifted in the same way as scalp hairs. This is reflected in the comb design.

If you use a beard trimmer to trim hair on other body parts, you may experience reduced performance or even skin damage.

Can my Philips groomer be rinsed under a tap?

Yes, you can rinse your Philips groomer under the tap.

Can I use my Philips beard trimmer on wet hair?

No, the beard should be dry during trimming.

My Philips groomer is making a strange noise

If your Philips multi groomer makes a strange noise, we can help you with some simple troubleshooting steps to solve this problem

Groomer is not assembled properly

It can be that your groomer has not been assembled properly, which is causing it to make a strange noise. We advise you to take off the attachments and reattach them as instructed in the user manual.

Groomer is dirty

Your groomer requires regular cleaning to function properly. Stuck hair in the device can affect its performance and can cause a strange sound. Please clean your groomer according to the instructions in the user manual.

While cleaning make sure you remove the cutter, as some hair can be collected under it.

Groomer is not charged

If your groomer is running low on battery, then the struggling noise of the machine may sound odd to you. Please fully recharge your device before any further use.

Groomer is not oiled

If your Philips groomer stops working, runs slowly, or makes noise, please place a drop of oil on the cutter. This oil is included in the package.

When your Philips groomer is cleaned very well, it may need a drop of oil to work properly.

Please, note: for an optimal performance, lubricate the cutting element teeth with a drop of the oil supplied every 6 weeks.

The charging light of my Philips groomer does not go on

The battery is fully charged

When the groomer is charging, the charging light or battery symbol flashes. When the battery is fully charged, the charging light or battery symbol lights up continuously. To save energy, the charging light or battery symbol goes out after approx. 30 minutes.

To check if the groomer is in energy-saving mode, please try the following:

- Remove the small plug from the groomer, or remove it from the charging stand.
- Re-insert the small plug to the groomer or place it back in the charging stand.
- The charging light or battery symbol should light up for 30 minutes before going out again.

Specification highlights

- Precision (size of steps)

From 0.2mm

- Number of length settings

17 integrated length settings

- Cutting element

Stainless steel blades

- Run time

70 minutes

- Cleaning

Fully washable

Technical Specifications

- Cutting system

Precision (size of steps)

From 0.2mm

Cutting element

Stainless steel blades

Non-scratching teeth

For more comfort

- Ease of use

Cleaning

Fully washable

Zoomring

Easily adjust length settings

Display

Battery light

Operation

Corded & Cordless use

- Power

Run time

70 minutes

Charging

1 hour full charge

Automatic voltage

100-240 V

- Create the look you want

Number of length settings

17 integrated length settings

- Accessories

Comb

- Integrated hair lift comb

- Long hair comb

- Short hair comb

Maintenance

Cleaning brush

- Design

Finishing

Chrome finish

Handle

Soft touch handle

- Service

2-year warranty

- Yes
- Plus 3-years with registration

No oil needed

Yes