

## Quick Setup Guide

This model can work both via USB cable or via bluetooth.

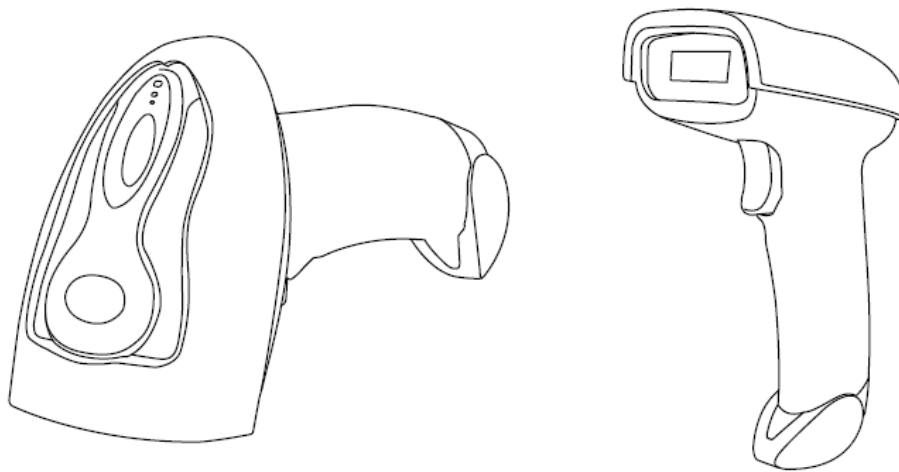

### Connection Mode

#### Working via USB cable

**Get Started:** Connect scanner with your device via USB cable. If you use US keyboard, it's a plug and play model. If you use other type of keyboard, please refer to below "keyboard language type" to set the keyboard language before use it.

#### Working via Bluetooth

**Get Started:** After you connect the bluetooth with your device (please refer to the section of "bluetooth connection" from this manual) then you can start to use it. (US keyboard by default) If you use other type of keyboard, please refer to below "keyboard language type" to set the keyboard language before use it.

**Low voltage Alarm:** Scanner will make 2x beeps to remind you that it's under low voltage. Plug the USB cable to charge power for it.

**Important Notes:** In case scanner has run out of battery during the storage, please charge power for 2-3 hours on the first time when you use it.

If you want to have other configurations please refer to below programming barcodes.

### Barcode Programming

Netum barcode scanners are factory programmed for the most common terminal and communications settings. If you need to change these settings, programming is accomplished by scanning the bar codes in this guide. An asterisk (\*) next to an option indicates the default setting.

## Bluetooth Connection

### 1. Pairing with windows XP or Windows 7/8/10

- 1) Power on the scanner , a few seconds later the blue indicator will keep flashing.
- 2) Enter the 'Control Panel' - 'Devices and Printers' - 'Add a device' – select, 'Bluetooth' to add the device to your computer
- 3) Click 'Next', the scanner will beep to indicate a successful pairing, and the light will turn to solid blue.

### 2. Android: Connect Android Device in Basic Mode

- 1) Power on the scanner. Make sure the scanner is discoverable (unpaired). a few seconds later the blue indicator will keep flashing.
- 2) Touch Home | Menu | Settings | Wireless & Networks | Bluetooth settings
- 3) Make sure the device has Bluetooth "On". Scan for devices.
- 4) In the list of found devices, select "Netum Bluetooth". Tap Pair.
- 5) The scanner will connect to the Android device.
- 6) The scanner will beep once after it has connected and is ready to scan barcodes

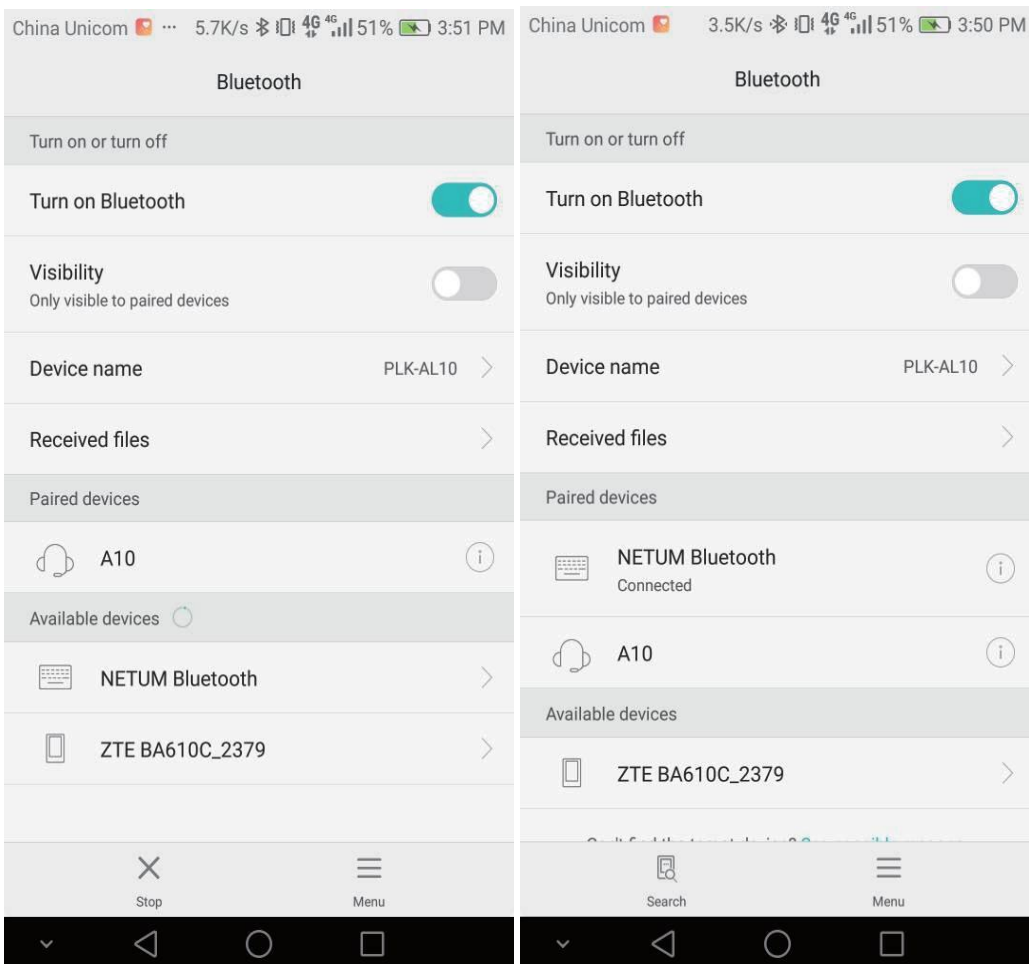

### 3. Pairing with your IOS device

- 1) Power on the scanner. Make sure the scanner is discoverable (unpaired). a few seconds later the blue indicator will keep flashing.
- 2) Click on “Bluetooth” in the left column. Your IOS device will automatically start searching for any Bluetooth Devices in the area.
- 3) Once you have identified the “Netum Bluetooth” on the screen, tap on it and you will automatically be connected. The scanner’s LED light will turn to solid blue.

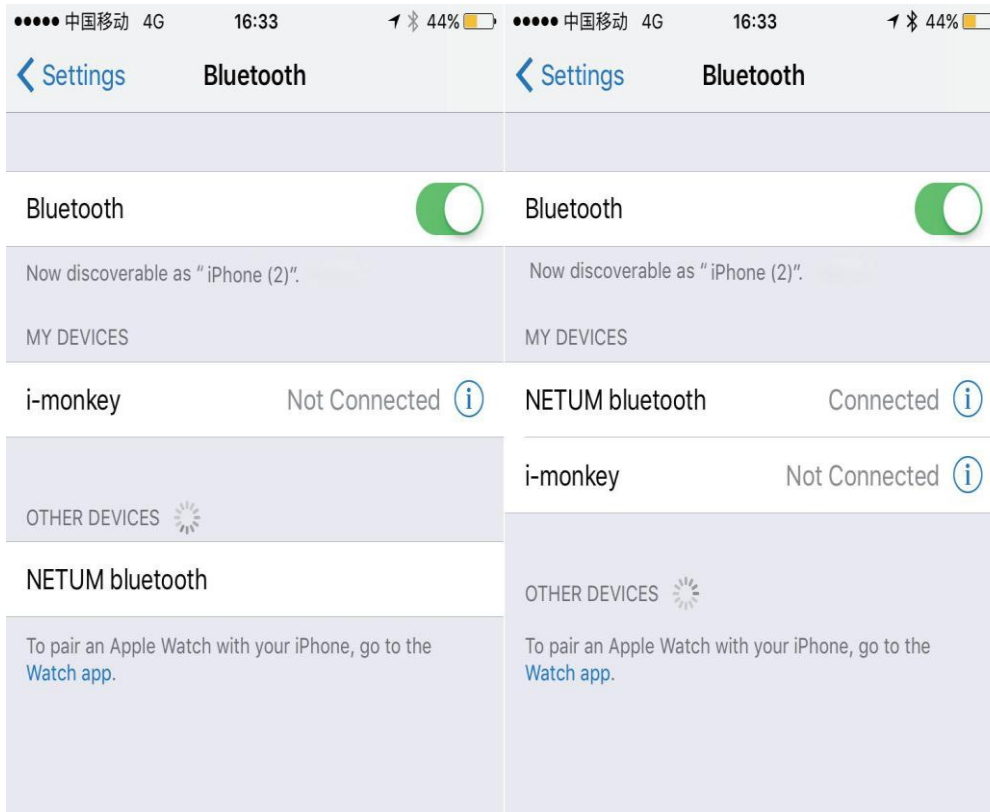

### Operation mode

#### A) BT HID Mode (Default)\*

No Software installation needed, connects to most devices with bluetooth or USB interface. In this mode, the scanner interacts with the device like a keyboard. Therefore, the scanner will work with Safari, Notes, and any other applications that supports an active cursor.



#### BT HID Mode

Note: this command barcode is only apply for Bluetooth Wireless Mode

### Keyboard Language

In order to let scanner upload the codes in a correct way, you have to set the keyboard language before you use it.

For example

If you use French Keyboard, just scan barcode of "French Keyboard", after that scanner will upload barcodes according to French keyboard layout. American Keyboard is set by default, if you use a US keyboard you can just skip this part.



American Keyboard \*



Portugal Keyboard



French Keyboard



Spanish Keyboard



Germany Keyboard



Turkey Q Keyboard



Italy Keyboard



Turkey F Keyboard

## B) Application Mode (SPP)

For Android or Windows only

Software installation is required, If you have an application that supports mobile scanners this is the mode recommended.



**BT SPP Mode**

**Note:** this command is only apply for Bluetooth Wireless Mode

## Scan Mode

### Trigger Mode (Default)

Scanning this bar code will enable the scanner to enter manual trigger mode.



### Continuous Mode

This mode enables the engine to scan/capture, decode and transmit over and over again.



### Auto Sense Mode

Scanning this bar code will enable the scanner to enter auto sense mode.



## Working Mode

If you are heading for a working area which lies outside the signal range, you may activate the offline mode of the scanner, following the steps described below. Under this enhanced offline mode, all scanned data will be stored directly into the buffer memory of the device. Furthermore, the data entries will be permanently saved in the buffer memory prior to the manual upload into the working station, so that you may upload them time and again to your liking.

1). By scanning the following barcode, the offline mode will be activated



Offline Mode

2). By scanning the following barcode, all data in the buffer memory will be deleted



Clear Memory

3).By scanning the following barcode, all data entries in the buffer memory can be manually uploaded after reconnecting to the working station (only in offline mode).



Uploading the Data

4). By scanning the following barcode, the gross quantity of the uploaded data entries will be summarised (only in offline mode).



Summarising of uploaded data entry quantity

5). By scanning the following barcode, the device leaves the offline mode, instant uploading mode will be activated. (By default)



Instant uploading mode

**Notes:** Command barcodes from Working mode section are only applied for Bluetooth wireless mode,

### Terminator

The scanner provides a shortcut for setting the terminating character suffix to CR or CRLF and enabling it by scanning the appropriate barcode below.



3030050

None

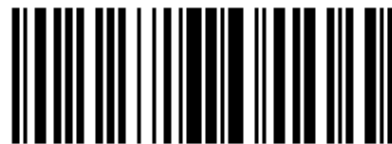

3030051

CR&LF \*



3030052

CR



3030053

TAB

## Idle Time

Scanner will stay awake during the idle time that you set for it and turn to sleep if you haven't used it during the whole idle time.



30 s



6 Mins



12 Mins



30 Mins



1Hour



2Hours

## IOS Keyboard POP UP/HIDE

During the scanning IOS keyboard can be hided or popped up by scanning below command barcode.



## Restore factory default

Scanning the following barcodes one by one to restore the scanner to factory defaults. (Four steps included)

### 1. Factory Restore



### 2. Serial Port



### 3. Baud Rate 19200



### 4. Enter+LF



## Common function Barcodes Enable/Disable UPC-E



1000021

\*Enable UPC-E



1000020

Disable UPC-E

## Enable/Disable EAN-8



1000041

\*Enable EAN-8



1000040

Disable EAN-8

## Enable/Disable EAN-13



1000031

\*Enable EAN-13



1000030

Disable EAN-13

## Enable/Disable Bookland EAN(ISBN)



1000231

Enable Bookland EAN



1000230

\*Disable Bookland EAN

## Decode UPC/EAN Supplementals UPC/EAN

Supplementals are bar codes appended according to specific format conventions (e.g. UPC A+2, UPC E+2, EAN 13+2, EAN 13+5). The following options are available:

- Do not read supplementals – The scan engine can only read the barcode no matter the barcode with supplementals or not.



2010E00

\*Ignore UPC/EAN with Supplementals

- Only read the barcode with supplementals- The scan engine can only read the barcode with supplementals.



**2010E01**

Decode UPC/EAN with Supplementals

- Auto read supplementals- The scan engine can not only read the barcode with supplementals, but also read the barcode without supplementals.



**2010E02**

Auto discriminate UPC/EAN Supplementals

### Enable/Disable Code 128



**1000101**

\*Enable Code 128



**1000100**

Disable Code 128

### Enable/Disable Code 39



**1000001**

\*Enable Code 39



**1000000**

Disable Code 39

### Enable/Disable Code 39 Full ASCII



**1020111**

Enable Code 39 Full ASCII



**1020110**

\*Disable Code 39 Full ASCII

**NOTE** Trioptic Code 39 and Code 39 Full ASCII cannot be enabled simultaneously. If you get an error beep when enabling Code 39 Full ASCII, disable Trioptic Code 39 and try again.

**Enable/Disable Code 93**



**1000111**  
Enable Code 93



**1000110**  
\*Disable Code 93

**Enable/Disable Code 11**



**1000121**  
Enable Code 11



**1000120**  
\* Disable Code 11

**Enable/Disable Interleaved 2 of 5**



**1000061**  
\*Enable Interleaved 2 of 5



**1000060**  
Disable Interleaved 2 of 5

**Enable/Disable Matrix 25**



**3030201**  
Enable Matrix 25



**3030200**  
\*Disable Matrix 25

**Enable/Disable Codabar**



**1000071**  
Enable Codabar



**1000070**  
Disable Codabar \*



**1000141**  
Enable MSI



**1000140**  
\*Disable MSI

### Enable/Disable GS1 DataBar-14



1000351

Enable GS1 DataBar-14



1000350

\*Disable GS1 DataBar-14

### Enable/Disable GS1 DataBar Limited



1000361

Enable GS1 DataBar Limited



1000360

\*Disable GS1 DataBar Limited

### Enable/Disable GS1 DataBar Expanded



1000371

Enable GS1 DataBar Expanded



1000370

\*Disable GS1 DataBar Expanded

### Enable/Disable PDF417



1000170

Disable PDF417



1000171

\*Enable PDF417

### Enable/Disable QR



1003250

Disable QRCode



1003251

\*Enable QRCode

### Enable/Disable Data Matrix(DM)



1003240

Disable DataMatrix



1003241

\*Enable DataMatrix

## **Support**

For any inquiries concerning our products, please send an email to [service@gzxlscan.com](mailto:service@gzxlscan.com), and we will respond to you as soon as possible.

## **Contact Information**

Tel.:+0086 20-6626-0708

Email:[service@gzxlscan.com](mailto:service@gzxlscan.com)

Addr.:Unit 137, The Pacific Industry Park, Xintang Town,Zengcheng District, Guangzhou,China/511340

Made in China