

## 3.5Qt. Glass Deep Fryer



Model EDF-3500GB/R/W

### **INSTRUCTION MANUAL**

Before operating your new appliance, please read all instructions carefully and keep for future reference.

# TABLE OF CONTENTS

IMPORTANT SAFEGUARDS _____	2
PARTS & FEATURES _____	4
PREPARING YOUR DEEP FRYER _____	5
OPERATING INSTRUCTIONS _____	6
FRYING GUIDE _____	7
CLEANING THE DEEP FRYER _____	8
RECIPES _____	9
WARRANTY & CUSTOMER SERVICE _____	Back

## SHORT CORD PURPOSE

- 1) A short power-supply cord is provided to reduce risks of injuring yourself from becoming entangled in or tripping over a longer cord.
- 2) Longer extension cords are available and may be used if you exercise caution during use.
- 3) If a longer cord is used please note the following:  
The marked electrical rating of the extension cord should be at least as great as the electrical rating of the appliance.  
The longer cord should be arranged so that it will not drape over the counter top where it can be pulled on by children or tripped over unintentionally.

## POLARIZED PLUG

If this appliance has a *polarized plug* (meaning one blade is wider than the other one), please follow the below instructions:

To reduce the risk of electric shock, this plug is intended to fit into a polarized outlet only in one direction. If the plug does not fit fully into the outlet, reverse the plug. If it still does not fit, contact a qualified electrician. Do not attempt to modify the plug in any way.

*This appliance is intended for Household Use Only.*

# IMPORTANT SAFEGUARDS

When using electrical appliances, basic safety precautions should always be followed, including the following:

1. Read all instructions before operating.
2. Do not touch hot surfaces. Use handles or knobs if applicable.
3. This appliance produces heat. Do not use appliance on any surface that may be sensitive to heat damage.
4. Remove all packaging plastics and other materials from unit before operating.
5. Wash all removable accessories before using for the first time.
6. To protect against electrical shock, do not immerse cord, plug or appliance itself in water or other liquids.
7. Close supervision is necessary when appliance is used by or near children.
8. Unplug from outlet when not in use and before cleaning. Allow to cool before putting on or taking off parts.
9. Do not operate any appliance with a damaged cord or plug or after the appliance malfunctions or has been damaged in any manner. Return the appliance to the nearest authorized service facility for examination, repair or adjustment.
10. The use of accessory attachments not recommended by the appliance manufacturer may cause injuries.
11. Do not use outdoors.
12. Do not let cord hang over edge of table or counter or touch hot surfaces.
13. Do not place on or near a hot gas or electric burner, or in a heated oven.
14. Always attach plug to appliance first, then plug cord into wall outlet. To disconnect, turn control(s) to OFF position, then remove plug from wall outlet.
15. Oversized foods or metal utensils must not be inserted in the appliance as they may cause a fire or risk of electrical shock.
16. A fire may occur if the appliance is covered or touching flammable material including curtains, draperies, walls and the like when in operation.
17. Do not clean with metal scouring pads. Pieces can break off the pad and touch electrical parts, involving a risk of electrical shock.
18. Extreme caution should be exercised when using containers constructed of a material other than metal or glass.
19. Do not store any materials other than manufacturer's recommended accessories in this unit when not in use.
19. Do not place any of the following materials in the unit: Paper, cardboard, plastic and / or similar non-food materials.
20. Some countertop and table surfaces, such as Corian®, wood and / or laminates, are not designed to withstand prolonged heat generated by certain appliances. It is recommended by countertop manufacturers and Maxi-Matic that a hot pad or trivet be placed under your Elite deep fryer to prevent possible damage to the surface.

## SAVE THESE INSTRUCTIONS

**THIS PRODUCT IS FOR HOUSEHOLD USE ONLY!**

# ADDITIONAL SAFEGUARDS

21. Always place the deep fryer on a stable surface and keep all flammable materials away from the unit during operation.
22. Make sure that the deep fryer is never near or on a switched-on stove or cooking surface.
23. Before you use the deep fryer it must be filled with the required amount of oil or fat. **\*\*Never use the deep fryer without oil or fat because this could damage the unit.**
24. **Never move the deep fryer during use.** The oil becomes very hot. Wait until the unit and the oil has completely cooled down before moving.
25. This deep fryer is protected with a thermal safety device which switches the machine off automatically if it over heats.
26. Never immerse the appliance in water.
27. Never leave the deep fryer unattended while in use.
28. Always ensure the safety of children if they are near the deep fryer.
29. If the deep fryer and/or cord are damaged, they must be repaired by a professional service department. Do not try to repair the unit yourself or replace the damaged cord. This requires special tools. Always contact our Customer Service Department for replacement parts.
30. Be sure not to damage the heating element. (Do not bend or dent.)
31. The electrical component is required with a safety heat switch, which ensures that the heating element can only function when the element is correctly placed on the fryer.
32. In the case of overheating, the thermal protective device will switch off the fryer automatically. This device is a small reset button (18) found either on the underside of the electrical component, or in the cord storage compartment. It can be re-activated by pushing the button in again with a pointed object (e.g. a pen). **\*\*Disconnect from power outlet before resetting!**

# PARTS & FEATURES

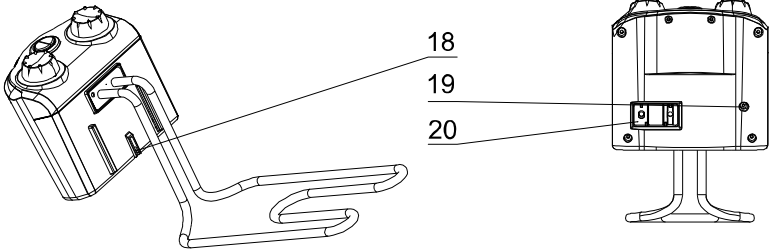
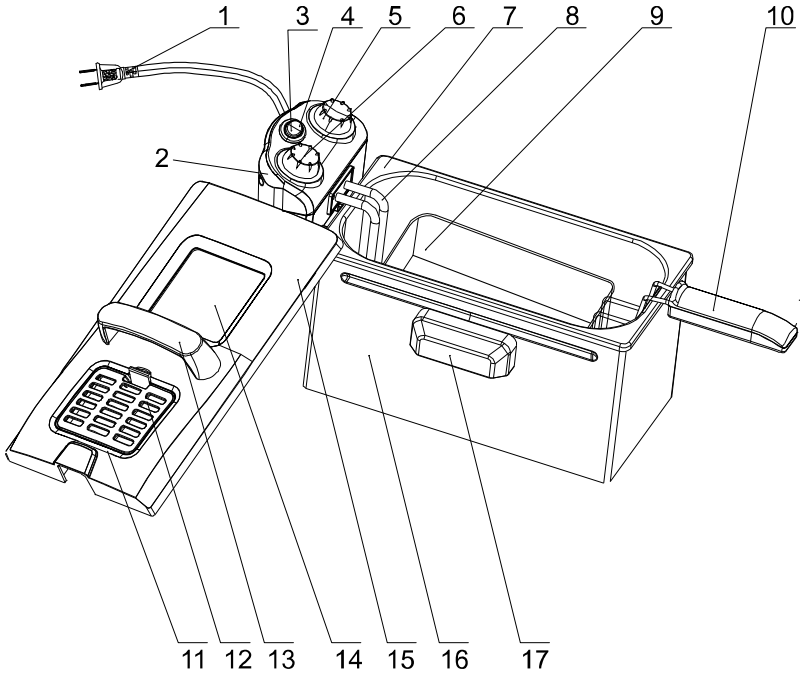

- |                                    |                               |
|------------------------------------|-------------------------------|
| 1) Power Cord                      | 11) Filter Compartment        |
| 2) Control Box                     | 12) Filter Compartment Latch  |
| 3) Temperature Ready Light (Green) | 13) Lid Handle                |
| 4) Power Indicator Light (Red)     | 14) Viewing Window            |
| 5) Timer Control Knob              | 15) Lid                       |
| 6) Thermostat Control Knob         | 16) Main Body Frame           |
| 7) Oil Container                   | 17) Body Frame Handle         |
| 8) Heating Element                 | 18) Safety Switch             |
| 9) Fryer Basket                    | 19) Reset Button              |
| 10) Basket Handle                  | 20) Magnetic Power Cord Inlet |

# PREPARING YOUR FRYER

## BEFORE USING FOR THE FIRST TIME:

- Remove all printed documents and packaging materials from the machine.
- Pull out all removable parts and wash gently with hot water.

**Do not immerse the Power Cord, Control Box Assembly or Heating Element of the deep fryer into any liquids.**

Dry all parts thoroughly before assembling.

- Do not operate the fryer without enough oil in the oil tank.
- The Deep Fryer should always be placed on a flat and stable surface where the power cord is out of reach from children and away from accidental entanglement.

## Tips:

- When you fry several different kinds of food, always fry the food that uses the lowest temperature setting first.
- Do not mix different types of oil for frying.
- Frying already pre-cooked foods may take less time to fry than completely raw food.
- Replace the oil after each 10-15 uses; or earlier if the oil becomes brown and thick.

# SAFETY TIPS

- **THIS DEEP FRYER IS ONLY SUITABLE FOR USE WITH OIL OR LIQUID FAT AND NOT FOR USE WITH SOLID FAT. IF SOLID FAT IS USED, WATER CAN BECOME TRAPPED INSIDE AND THE HOT FAT MAY SPEW OUT WITH CONSIDERABLE FORCE.**
- Never switch on the deep fryer without oil or liquid fat, as this could damage the machine. Also, do not place any other liquids such as water or other substances in the pan.
- Place the deep fryer on a dry, stable surface. Since the deep fryer becomes hot during use, make sure that it is not too close to other objects.

# OPERATING INSTRUCTIONS

## SETTING UP THE DEEP FRYER:

1. Make sure the Deep Fryer is **UNPLUGGED** when assembling.
2. Make sure the temperature control knob is set to the **OFF** or **0** position.
3. Assemble the control box (2) onto the main body frame (16). Make sure the control box is secured properly to the slots on the back of the body frame. This will properly engage the small **safety switch** (18) and ensure proper activation. Otherwise the fryer will not power on properly.
4. Remove the frying basket (9) and allow it to hang and rest on the backside of the oil pan.
5. Use only good quality frying oil such as Peanut oil, Vegetable oil, pure Corn oil, Sunflower oil, Canola oil, or Light Olive oil. (It is not recommended to mix oils).
6. Fill oil into the oil container approximately between the **MIN** marking and the **MAX** marking.
7. **Do not fill over the MAX marking or lower than the MIN marking.**

## OPERATION:

1. Attach the magnetic power cord to the inlet on the back of the control box.
2. PLUG the power cord into an outlet.
3. Move the Thermostat knob to desired temperature setting according to the particular recipe you are using. The RED and the GREEN indicator light will turn on.
4. While the oil is preheating, prepare the food that is going to be fried.
5. When the oil has reached the set temperature, the GREEN light will turn off.
6. **NOTE:** The GREEN ready light will cycle On and Off with the thermostat to maintain the set temperature. The RED power light will remain illuminated throughout use.
7. When placing the food into the basket, make sure it is as dry as possible. Do not add water, ice or wet food, it may cause HOT OIL SPLATTER.
8. When frying frozen food, clear off any ice particles and thaw food thoroughly.
9. Do not overfill the basket.
10. Lower basket of food into hot oil and cover fryer w/ lid.
11. Adjust the Timer Control Knob (5) to desired setting.

**WARNING: DO NOT TOUCH THE CONTROL KNOB DURING THE FRYING PROCESS. HOT STEAM MAY BE RELEASED AND MAY CAUSE INJURY.**

12. When food has finished frying, the Timer will have a Bell Indicator. Remove the lid. Lift the basket up slowly out of the hot oil and place the basket on the drain support located on the back of the fry basket.
13. After the excess oil has drained, place the food on a paper towel lined baking sheet to absorb excess oil.
14. If you are frying more than one batch, ensure the oil re-heats to the required temperature.
15. When frying is complete, turn control(s) to OFF position.
16. Disconnect the power cord. Allow the machine and the oil to cool completely before cleaning.

## FRYING GUIDE

The frying times given in the chart are only a guide and should be adjusted accordingly to the quantity of food being fried.

FOOD	Temp. °F	Weight (ounces)	Estimated Time
Shrimp	285°	8	3-5 minutes
Onion	285°	5	3-4 minutes
Mushrooms	285°	10.5	6-8 minutes
Fish Fillet	300°	8	5-6 minutes
Fish Fillet in batter	300°	14	6-8 minutes
Sliced Meat	340°	14	7-10 minutes
Steak	340°	14	7-10 minutes
Chicken Strips	360°	18	7-10 minutes
French Fries (1 <sup>st</sup> time)	375°	18	6-10 minutes
French Fries (2 <sup>nd</sup> time)	375°	8	3-5 minutes

\*French Fries being fried a 2<sup>nd</sup> time will be lighter and crispier.

#### **AFTER THE FOOD IS FRIED:**

- Make sure to turn the temperature control knob to the OFF position and unplug the deep fryer.
- Once food is done cooking, remove the lid, and hang the basket on the hook and let excess oil drip into the oil pot.

**Warning: Removing the lid will release hot steam. Take extreme care when handling. Keep face and bare skin clear of the steam release.**

- Remove the basket and place the food on paper towels to absorb excess oil. **Do not touch the basket while it is still hot. Always use the handle.**
- Place the basket into the deep fryer.
- Do not move the deep fryer until it is cooled entirely.
- Unplug the power cord and place into storage if necessary.

## **CLEANING THE DEEP FRYER**

1. Remove the lid and basket.  
**WARNING: Before cleaning the deep fryer, make sure that it is disconnected from the power outlet, make sure the unit and the oil has completely cooled. Oil retains its temperature for a long period after use. Do not attempt to carry or move the deep fryer while the oil is hot.**
2. Wait for the fryer to cool, lift out the Control Box Assembly & Heating element.
3. Remove the oil pot and pour out the oil. It is recommended to filter the oil after each use if you are to re-use the oil again.
4. After removing the oil pot, the fryer can be divided into separate components to clean.
5. The oil pot and the main body can be immersed into water to clean.
6. The Control Box & Heating Element should be wiped clean with absorbent paper towels. Then use a damp cloth and a mild soap to clean.  
**WARNING: NEVER immerse the Control Box & Heating Element into water to clean.**
7. Dry all parts thoroughly.  
**Note: Do not use abrasive scrubbing brushes or chemical cleaners to clean the unit.**

#### **How to replace the filters:**

Your carbon filter should be changed every 6 months. The oil filter should be changed every 12 months.

- 1) Unclip and remove the filter cover.
- 2) Take out both white and black filter pieces.
- 3) Throw out old filters and replace with new filters. Make sure the White filter piece rests on the metal surface **BELOW** the carbon filter (black piece).

**NOTE:** Filters can be gently rinsed in warm soapy water as well and reused again. But it will need to be replaced after considerable amount of usage.

## **STORING YOUR DEEP FRYER:**

Always allow the appliance to cool completely before storing. Store the appliance in a dry location. Keep the power cord out of reach of children.

# RECIPES

## **BATTER VARIETY:**

The following are a few quick recipes with different types of batter to use with a variety of foods to fry in the deep fryer for a delicious meal.

### **Beer Batter:**

Mix together 1 ½ cups of flour and 1 ½ cups of any kind of beer in a large mixing bowl. Cover the bowl after mixing and allow the batter to sit at room temperature for approximately 3 hours. When ready to fry, dip desired food into the batter and follow the directions for frying battered foods in this booklet.

### **Egg Batter:**

Combine 2 egg yolks, ¾ cup of flour, 1-½ teaspoons of vegetable oil, ½ teaspoon of salt and 1 cup of milk. Mix thoroughly. Add more milk if desired to adjust the density of the mixture. When ready to fry, dip desired food into the batter and follow the directions for frying battered foods in this booklet.

### **Egg Coating:**

Combine 2 whole eggs with 1-½ teaspoons of vegetable and a pinch of salt and pepper to taste. When ready to fry, dip desired food into the mixture and follow the directions for frying foods in this booklet.

### **Extra Crispy Coating:**

Beat together ½ cup milk and one whole egg in a small mixing bowl. In a separate bowl, mix together ½ cup of flour and any of your favorite seasonings such as salt, pepper, chili powder, garlic powder, etc. When ready to fry, dip desired food into the wet mixture first, then dip into the dry flour mixture. Then follow the directions for frying foods in this booklet.

### **Bread Crumb Coating:**

Beat together 1 ½ teaspoons of vegetable oil and 2 egg yolks in a small mixing bowl. In a separate bowl, mix together ½ cup of bread crumbs, 1/3 cup of flour plus any of your favorite seasonings such as salt, pepper, chili powder, garlic powder, etc. When ready to fry, dip desired food into the wet mixture first, then dip into the dry bread crumb mixture. Then follow the directions for frying foods in this booklet.

## **TIPS FOR FRYING FOOD WITH BATTER COATING:**

- Make sure food is always sliced thinly and evenly. This helps the food to be fried evenly.
- Shake off any excess flour or bread crumb coating to prevent any clumps from forming when frying.
- If you wish to use the basket when frying foods coated with batter, it is recommended to lower the basket into the hot oil first and then gently and carefully

place battered foods into the oil directly. This will prevent the batter from catching and sticking to the wiring of the basket.

- Never fill the basket more than 2/3 full. In order to cook evenly, the food needs space for the frying oil to fry each side.

## **FRIED CHICKEN WITH CREAMY GRAVY**

1/2 cup milk	1/4 teaspoon poultry seasoning
1 egg, beaten	1 (4 pound) whole chicken, cut into pieces
1 cup all-purpose flour	3 cups vegetable oil
2 teaspoons garlic salt	1 cup chicken broth
1 teaspoon paprika	1 cup milk
1 teaspoon ground black pepper	

- In a medium bowl, beat together 1/2 cup milk and egg.
- In a re-sealable plastic bag, mix together the flour, garlic salt, paprika, pepper and poultry seasoning.
- Place chicken in bag, seal, and shake to coat. Dip chicken in milk and egg mixture, then once more in flour mixture. (Reserve any remaining flour mixture.)
- In the deep fryer, heat oil to 365°F until ready.
- Place coated chicken in the hot oil, and brown on all sides. Reduce heat to 325°F, and continue cooking chicken until tender, about 30 minutes. Remove chicken from fryer, and drain on paper towels.
- Discard all but 2 tablespoons of the frying oil and place into a saucepan over low heat. Stir in 2 tablespoons of the reserved flour mixture. Stirring constantly, cook about 2 minutes. Whisk in chicken stock.
- Stir in 1 cup milk, and bring all to a boil over high heat, stirring constantly. Reduce heat to low, and simmer for about 5 minutes.
- Serve immediately with the chicken.

## **BEIGNETS:**

---

Vegetable oil for frying	1/3 c. butter
1 c. all-purpose flour	1/4 tsp. salt
4 tsp. sugar	1 tsp. vanilla extract
1/4 tsp. nutmeg	4 eggs, at room temp.
1 c. water or milk	

- In the deep-fat fryer, oil to 350°F degrees.
- Meanwhile, combine flour, sugar and nutmeg, set aside. In medium saucepan heat water or milk, butter and salt over medium heat until boiling and butter is melted. Add vanilla, then add flour mixture all at once.
- Stir briskly with a wooden spoon until mixture leaves sides of pan and forms a ball. Continue stirring a few minutes more until dry.
- Remove from heat and beat until slightly cooled.
- Add eggs, one at a time, beating well after each addition. Using 2 spoons, shape a generous tablespoon dough into an oblong and drop into hot oil.

- Fry 3 or 4 at a time, turning beignets as they rise to the surface. Fry 3 to 4 minutes, until golden brown.
- Drain on paper towels and sprinkle immediately with sifted confectioners' sugar. Repeat with remaining batter.
- Makes about 2 dozen beignets

## **SHRIMP EGG ROLLS:**

---

1 c. sifted flour	1/4 c. minced water chestnuts
3 eggs	1 tbsp. finely chopped onion
2 c. minced cooked shrimp	1 qt. corn oil
1 c. finely chopped celery	1/2 tsp. salt
1/4 c. minced bamboo shoots	

- Combine flour, 1-cup water and 2 eggs. Beat at low speed of electric mixer for 5 minutes. Set aside for at least 15 minutes.
- Mix shrimp, celery, bamboo shoots, water chestnuts, onion, 2 tablespoons corn oil and seasonings thoroughly.
- Heat heavy 6-inch skillet until drop of water will sizzle. Grease lightly with corn oil before cooking each skin. Hold skillet off heat; pour 2 to 3 tablespoons batter into pan, moving and tilting pan while pouring. Pour excess back into bowl of batter; return skillet to heat. Batter will set very quickly.
- Cook just until set and edge curls slightly. Turn out onto dry dishtowel until ready to roll.
- Place about 2 tablespoons filling in center of each skin; brush edge with beaten egg. Fold nearest edge over filling; fold over sides about 1 inch. Roll skin; seal with beaten egg. Pour enough of remaining corn oil into deep fryer or skillet to fill 1/3 full.
- Heat over medium heat to 375 degrees or until 1-inch square of bread turns brown in 10 seconds.
- Add several egg rolls slowly; fry until lightly browned on all sides, turning as needed. Drain on absorbent paper. Repeat with remaining rolls. Yield: 15 egg rolls.

## **FUNNEL CAKE:**

---

2 c. flour  
 1 tsp. baking powder  
 1/2 tsp. salt  
 2 eggs  
 1 1/2 c. milk

- Combine all the above ingredients in order. Mix thoroughly.
- Heat cooking oil in deep fryer until correct temperature.
- Put batter in funnel (be sure to cover hole with one finger), then, holding the funnel over hot oil (be very careful!), release some of the batter in circular motion, then criss-crossing motions to form one funnel cake.
- The funnel cake will rise quickly and expand - so be careful how much batter you use.
- Cook to light golden brown on both sides.
- Remove from oil and place on paper towels.
- Sprinkle with powdered sugar and serve warm.

## **GOLDEN FRIED ONION RINGS:**

6 med. mild white onions  
1 1/8 c. sifted flour  
1/2 tsp. salt  
1 egg, slightly beaten  
1 c. milk

- Slice onion 1/4 inch thick and separate into rings.
- Combine remaining ingredients in a bowl and stir just until dry ingredients are moistened.
- Dip onion rings into flour mixture.
- Fry several at a time in a deep fryer until golden brown. Drain on paper towel and sprinkle with salt.

## **BUFFALO WINGS:**

24 wings (4 lbs.)  
Salt & pepper (optional)  
4 c. cooking oil  
1/4 c. butter  
2 to 5 tsp. hot sauce  
1 tsp. white vinegar

- Cut off tips and separate wings at joint; sprinkle with salt and pepper, to taste.
- Heat oil in deep fat fryer or large heavy pot. When quite hot, add 12 wings and cook 10 minutes, stirring occasionally.
- When wings are golden brown and crisp, remove and drain well. Add rest of wings; repeat process.
- Meanwhile, melt butter in saucepan; add hot sauce, to taste and vinegar. Pour sauce over wings and mix well to cover.
- Serve with Blue Cheese Dressing and celery sticks.

## **CORN DOGS:**

1/2 c Yellow corn meal	6 ea Skewers or sticks
1/2 c Flour	1 tbsp Sugar
1 tsp Honey	1 tsp Baking powder
1/2 tsp Salt	1/2 c Milk
1 ea Egg, lightly beaten	1 tbsp Melted shortening
6-8 Hot Dogs / Frankfurters	

- Combine the cornmeal, flour, sugar, mustard, baking powder and salt, mixing well.
- Add the milk, egg and shortening, mixing until very smooth.
- Pour the mixture into a tall glass. Put the frankfurters on sticks.
- Dip them into the cornmeal batter to coat them evenly.
- Deep fry in oil heated to 375 degrees until golden brown, about two minutes.
- Drain on paper towels.

## **BEER BATTER FISH FILLETS**

1 cup all-purpose flour	1/2 cup milk
1 teaspoon salt	2 eggs
1 teaspoon baking powder	2 pounds cod fillets
1/2 teaspoon dried dill weed	2 quarts vegetable oil for frying
3/4 cup beer	

- In a large bowl, mix together flour, salt, baking powder, and dill. Add beer, milk, and eggs; mix well.
- Place fish fillets in batter mixture, coat well, and let stand for 15 minutes.
- Heat deep fryer to 375°F. Place fish in hot oil, and fry until golden brown.
- Cook fish in batches to maintain oil temperature. Serve.

## **FRIED GREEN TOMATOES:**

3-4 lg. green tomatoes	1 tbsp. seasoning salt
2 c. flour	2 eggs
1 tbsp. salt	2 c. milk
1 tbsp. pepper	Oil for frying

- Cut tomatoes into almost 1/2-inch thick slices.
- Mix flour, salt, pepper and seasoning salt in one bowl.
- Mix eggs and milk in another bowl. Dip each tomato slice into the milk mixture, then into the flour, back to the milk and then to the flour again, coating well.
- Heat oil in a deep fryer to 350 degrees and add battered tomato slices a few at a time, and cook for 5 minutes or until golden brown.

## **CHURROS:**

Vegetable for frying	1 cup all-purpose flour
1 cup water	3 eggs
1/2 cup margarine or butter	1/4 cup sugar
1/4 teaspoon salt	1/4 teaspoon ground cinnamon

- Prepare to fry the churros by heating oil in deep fryer to 360 degrees F.
- To make churro dough, heat water, margarine and salt to rolling boil in 3-quart saucepan; stir in flour.
- Stir vigorously over low heat until mixture forms a ball, about 1 minute; remove from heat.
- Beat eggs all at once; continue beating until smooth and then add to saucepan while stirring mixture.
- Spoon mixture into cake decorator's tube with large star tip (like the kind use to decorate cakes).
- Squeeze 4-inch strips of dough into hot oil. Fry 3 or 4 strips at a time until golden brown, turning once, about 2 minutes on each side. Drain on paper towels.
- Mix Sugar and the optional cinnamon; roll churros in sugar mixture.

## SWEET & SOUR CHICKEN:

---

### *MARINADE:*

1/2 tsp. salt  
1 1/2 tsp. soy sauce  
1 tbsp. cornstarch  
1 tbsp. cold water

### *BATTER:*

1/2 c. chicken coating mix  
1/2 c. ice water  
1 egg yolk

### *SWEET AND SOUR SAUCE:*

1/2 c. Kraft Sweet and Sour Sauce  
1/4 c. chicken broth  
1/4 c. water  
1/2 tsp. cornstarch  
1 green pepper, cut into 1 inch pieces  
1 med. carrot, sliced inch long then lengthwise  
1/2 c. sliced water chestnuts  
1 can chunk pineapple

- Combine marinade ingredients in a small bowl. Add chicken, mix well. Let stand 30 minutes.
- Combine batter ingredients in a medium bowl until just mixed. Do not stir to blend.
- Combine Sweet and Sour Sauce, chicken broth, water and cornstarch in a small bowl, set aside.
- Heat oil in deep fryer to 350 degrees
- While oil is heating, coat each piece of chicken with batter. Reduce heat to medium.
- Carefully lower coated chicken into hot oil with fryer basket.
- Deep fry chicken 3 minutes or until browned. Remove from oil.
- Turn heat up to high and heat oil to 400 degrees.
- Carefully place chicken all at once in hot oil and deep-fry until crisp, about 30 seconds.
- Remove chicken, draining well. Place on platter.
- Using a fry pan, place 2 tablespoons oil. Heat to medium. Stir-fry green peppers, carrots and water chestnuts 2 minutes.
- Add Sweet and Sour Sauce mixture. Stir in pineapple. Stir-fry until sauce has thickened. Remove from heat.
- Stir in chicken and serve immediately. Makes 4 servings.

**LIMITED WARRANTY\* ONE (1) YEAR**  
**WARRANTY IS ONLY VALID WITH A DATED PROOF OF PURCHASE**

1. Your small kitchen appliance is built with precision, inspected and tested before leaving our factory.
2. It is warranted, to the original purchaser to be free from any manufacturing defects under normal use and conditions for one (1) year, cord excluded. This Warranty applies only to the original purchaser of this product.
3. If you need to exchange the unit, please return it in its original carton, with a sales receipt, to the store where you purchased it. If you are past the store's allowed return policy period, please see the enclosed Warranty.
4. If you use your appliance for household use and according to instructions, it should give you years of satisfactory service.
5. During the one-year warranty period, a product with a defect will be either repaired or replaced with a new or reconditioned comparable model (at our option) when the product is returned to our Service Center. (See the "Returns" section below).
6. The repaired or replacement product will be in warranty for the remaining balance of the one-year warranty period and an additional one-month period.
7. **This limited warranty covers appliances purchased and used within the 50 contiguous states plus the District of Columbia and does NOT cover:**
  - Damages caused by unreasonable use, neglect, normal wear and tear, commercial use, improper assembly or installation of product.
  - Damages caused in shipping.
  - Damages caused by replacement or resetting of house fuses or circuit breakers.
  - Defects other than manufacturing defects.
  - Breakage caused by misuse, abuse, accident, alteration, lack of proper care and maintenance, or incorrect current or voltage.
  - Lost or missing parts of the product. Parts will need to be purchased separately.
  - Damages of parts that are not electrical; for example: cracked or broken plastic or glass.
  - Damage from service or repair by unauthorized personnel.
  - Extended warranties purchased via a separate company or reseller.
  - Consumer's remorse is not an acceptable reason to return a product to our Service Center.

\*One Year Limited Warranty valid only in the **50 contiguous states plus the District of Columbia, excluding** Puerto Rico and the Virgin Islands.

This warranty is effective only if the product is purchased and operated in the USA; product usage which is in violation of the written instructions provided with the unit will void this warranty.

For international warranty, please contact the local distributor.

\*\*Any instruction or policy included in this manual may be subject to change at any time.

**MAXI-MATIC, USA**

18401 E. Arenth Ave. City of Industry, CA 91748

Customer Service Dept: (626) 912-9877 Ext: 120/107 MON-FRI 8am-5pm PST

Website: [www.maxi-matic.com](http://www.maxi-matic.com) email: [info@maxi-matic.com](mailto:info@maxi-matic.com)

## **RETURN INSTRUCTIONS**

### **RETURNS:**

A. Any return of defective merchandise to the manufacturer must be processed accordingly by first contacting customer service (contact information shown below) to obtain an RA # (Return Authorization Number). We will not accept any returns of merchandise without an applicable RA #.

B. IMPORTANT RETURN INSTRUCTIONS. Your Warranty depends on your following these instructions if you are returning the unit to Maxi-Matic USA:

1. Carefully pack the item in its original carton or other suitable box to avoid damage in shipping.

2. Before packing your unit for return, be sure to enclose:

a) Your name, full address with zip code, daytime telephone number, and RA#,

b) A dated sales receipt or PROOF OF PURCHASE,

c) The model number of the unit and the problem you are having (Enclose in an envelope and tape directly to the unit before the box is sealed,) and

d) Any parts or accessories related to the problem.

3. Maxi-Matic USA recommends you ship the package U.P.S ground service for tracking purposes. We cannot assume responsibility for lost or damaged products returned to us during incoming shipment. For your protection, always carefully package the product for shipment and insure it with the carrier. C.O.D shipments cannot be accepted.

**4. All return shipping charges must be prepaid by you.**

5. Mark the outside of your package:

MAXI-MATIC USA

18401 E. ARENTH AVE.

CITY OF INDUSTRY, CA 91748

6. Once your return has been received by our warehouse, Maxi-Matic USA will repair or replace the product if it is defective in material or workmanship, subject to the conditions in paragraph B.

**7. Maxi-Matic will pay the shipping charges to ship the repaired or replacement product back to you.**

## IMPORTANTES MEDIDAS DE SEGURIDAD

Cuando use aparatos eléctricos, precauciones básicas de seguridad deberán seguirse, incluyendo las siguientes.

1. Lea todas las instrucciones cuidadosamente, antes de usar el aparato
2. No toque las superficies calientes, use el mango o las agarraderas.
3. Remueva todo material de empaque, antes de usar el aparato
4. Lave todas las partes o accesorios removibles, antes de usar por vez primera.
5. Para protegerse, de una descarga eléctrica, no sumerja el cordón, enchufe eléctrico o aparato en agua o ningún otro líquido.
6. Cercana supervisión es necesaria, cuando el aparato sea usado por o cerca de niños
7. Desconecte el aparato, cuando no esté en uso y antes de limpiarlo. Permita que se enfríe, para remover las partes o accesorios.
8. Nunca use ningún aparato con el cordón dañado, enchufe, mal funcionamiento o dañado en alguna otra forma.
9. El uso de accesorios no recomendados por el fabricante, pueden causar daños personales o al aparato.
10. No lo use a la intemperie o en lugares húmedos.
11. No deje que el cordón cuelgue de la orilla de la mesa, mostrador o toque cualquier superficie caliente.
12. No lo ponga sobre o cerca de superficies calientes como estufas y hornos
13. Siempre deberá conectar el cordón eléctrico al aparato y después al toma corriente eléctrica, si aplica.
14. Siempre deberá de apagar el aparato antes de desconectar del toma corriente.
15. Nunca introduzca utensilios de metal en el aparato, podría causar fuego, descarga eléctrica o daños personales
16. Fuego podría ocurrir, si el aparato es cubierto o toca material inflamable como cortinas alfombras y paredes cuando esté en uso.
17. Extrema precaución deberá tener cuando use depósitos contruidos de otro material que no sean de metal o vidrio, si aplica.
18. No guarde ni ponga ningún material dentro del aparato, únicamente los accesorios recomendados por el fabricante, cuando no esté en uso.
19. No ponga dentro o en la superficie exterior del aparato los siguientes materiales, papel, cartón, plásticos o algún otro material inflamable.
20. Para reducir el riezgo de una descarga eléctrica, este Aparato tiene una ploga polarizada (un lado de las navajas de la ploga es mas ancha que la otra) y esta diceñada para entrar en un reseptáculo polarizado de una sola manera..
21. No utilice este aparato para otra cosa, sino para lo que fue diceñado.
22. Nunca coloque los siguientes materiales dentro de la unidad: Papel, cartón, plásticos o materiales similares que no sean comestibles.
23. Algunos superficies de mesas y mostradores hechos o recubiertos de laminados de CORIAN, MADERA FINA O FORMICA, no estan diceñados para soportar calores prolongados generados por ciertos aparatos eléctricos de cocina. SE RECOMIENDA COLOCAR MANOPLAS DE COCINA O MANTELES RESISTENTES AL CALOR BAJO SU APARATO.

**GUARDE ESTAS INSTRUCCIONES  
ESTE PRODUCTO ES PARA USO DOMÉSTICO  
UNICAMENTE.**

# PARTES Y CARACTERÍSTICAS

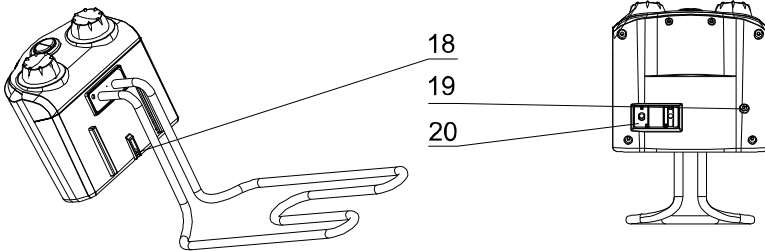
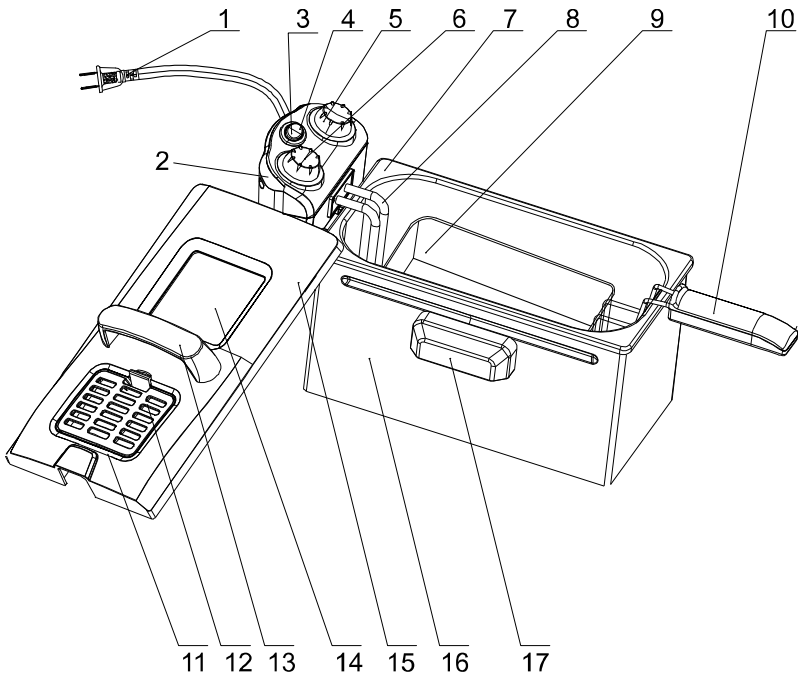

- |  |   |
|--|---|
| 1. Cordon Eléctrico                      | 11. Compartimento del Filtro                      |
| 2. Caja de Control                       | 12. Cerrojo Plástico del Compartimento del Filtro |
| 3. Luz Indicadora de Encendido (roja)    | 13. Manilla de la Tapadera                        |
| 4. Luz Indicadora de Temperatura (verde) | 14. Ventanilla                                    |
| 5. Temporizador de 30 minutos            | 15. Tapadera                                      |
| 6. Control Ajustable del Termostato      | 16. Freidora                                      |
| 7. Depósito Para Aceite                  | 17. Agarradera                                    |
| 8. Elemento Térmico                      | 18. Control de Seguridad                          |
| 9. Canasta                               | 19. Bóton de Restablecimiento                     |
| 10. Manilla de la Canasta                | 20. Enchufe Magnético                             |

## RECOMENDACIONES

1. Siempre ponga la freidora en una superficie plana y estable y mantenga todo material inflamable alejado de la unidad mientras la este utilizando.
2. Asegurese de que la freidora no este cerca o en la estufa
3. Antes de utilizar la freidora de vera de llenarse con la cantidad necesaria de aceite.  
\*\*Nunca utilize la freidora sin aceite podría dañarse la unidad.
4. **Nunca trate de mover la freidora durante su uso.** El aceite se calienta mucho, espere a que la unidad y el aceite se enfríe completamente antes de moverlo.
5. La freidora esta protegida con un interruptor térmico integrado el cual apaga la unidad si se sobrecalienta.
6. Nunca sumerja la unidad en agua o en ningún otro líquido.
7. Nunca deje la freidora desatendida mientras este en uso.
8. Siempre asegurese de la seguridad de los niños cuando esten cerca de la unidad
9. Si la freidora o el cordón eléctrico estan dañados, deberan ser reparados inmediatamente en un centro de servicio profesional, no lo trate de reparar o reemplazar el cordón eléctrico usted mismo. Se requiere herramienta especial.
10. Asegurese de no dañar el elemento térmico. No lo doble o golpee.
11. La freidora tiene un interruptor térmico que funcionara si el elemento térmico esta correctamente colocado en la freidora.
12. En caso que la freidora se sobre caliente, el interruptor térmico se activara y apagara la freidora automáticamente. Este dispositivo es un boton de color rojo que se localiza bajo el compartimento del cordón eléctrico. Puede ser reactivado con solamente presionarlo con un objeto puntiagudo como con una pluma. **\*\*Disconecte del toma corriente antes de reactivarlo.**

## COMO PREPARAR SU FREIDORA

### ANTES DE UTILIZAR POR PRIMERA VEZ:

- Quite todo material de empaque incluyendo manuales
- Lave todas las partes suavemente con agua y jabón

### **No sumerja el cordón eléctrico o elemento térmico en agua o ningn otro líquido.**

- Seque todas las partes perfectamente antes de ensamblarlas en la freidora
- No utilice la freidora sin suficiente aceite en el deposito
- La freidora siempre deve ponerla en una superficie plana y estable donde el cordón eléctrico este fuera del alcance de los niños y que se enreden en el mismo.

### **Ideas:**

- Cuando fría diferentes tipos de alimentos siempre empiese con los alimentos que se frían a mas baja temperatura.
- Nunca mezcle diferentes tipos de aceite para freir alimentos.
- Al freir alimentos pre-cocinados tomaran menos tiempo para freir que los que estan crudos.
- Reemplace el aceite despues de cada 10-15 usos; O más pronto si el aceite se torna café y espeso.

## ADVERTENCIAS PARA MAYOR SEGURIDAD

- **ESTA FREIDORA ESTA DISEÑADA PARA FREIR CON ACEITE LÍQUIDO ÚNICAMENTE. SI MANTECA O GRASA SOLIDA ES UTILIZADA VAPOR DE AGUA QUEDARA ATRAPADA Y EL ACEITE CALIENTE PODRIA SALTAR FUERA DE LA FREIDORA CON FUERZA CONSIDERABLE**
- Nunca encienda la freidora sin aceite, al acerlo podria dañar la unidad. No ponga agua u otras sustancias en el contenedor.
- Ponga la freidora en una superficie estable y plana. La freidora se calentara durante su uso, asegurese de que no este muy cerca de algún objeto y pueda causar un incendio.

## COMO UTILIZAR LA FRIDORA

- Asegurese de que la freidora este desconectada del toma corriente.
- Coloque el elemento térmico en el contenedor de aceite. Asegurese de que el elemento térmico este instalado correctamente y el interruptor (**ROJO**) de seguridad este activado. De otra manera la freidora no encendera.
- Quite la canasta freidora y cuelguela de la orilla del deposito de aceite.
- Utilize unicamente aceite de buena calidad como aceite de cacahuate, aceite vegetal, aceite de elote, aceite de girasol, aceite de canola o aceite de oliva (**se recomienda no mezclar el aceite de una clase con otro tipo**)
- Llene el contenedor con aceite entre las marcas de **MIN. y MAX.**
- **Nunca se sobrepase de la marca de MAX. O menos de MIN.**
- Asegurese de que el control de temperatura este en apagado(**OFF**).
- Conecte la unidad al toma corriente.
- Ajuste el control de temperatura a la temperatura deseada o de acuerdo a su recetario de cocina. La luz indicadora **ROJA y LA VERDE** encenderán.
- Mientras el aceite se calienta, prepare los alimentos que van a ser freídos.
- Cuando el aceite aya alcanzado la temperatura seleccionada la luz verde se apagara.  
**NOTA:** La luz verde de preparado tendra ciclos de apagado y encendido manteniendo asi la temperatura seleccionada. La luz roja se mantendra iluminada durante todo el tiempo que este en uso la freidora.
- Cuando coloque los alimentos en la canasta freidora, asegurese de que esté completamente seca. No agregue agua, hielo o alimentos mojados, **podría causar que el aceite salpicara.**
- Cuando fria alimentos congelados, limpielo de cualquier particula de hielo y descogele por completo.
- No sobre llene la canasta freidora con alimentos.
- Baje la canasta con alimentos dentro del aceite caliente
- Tape la freidora.
- Ajuste la perilla del temporizador al tiempo deseado.

**ADVERTENCIA:** NO MUEVA EL TABLERO DE CONTROL DURANTE EL PROCESO DE FREIR. VAPOR CALIENTE PODRÍA ESCAPAR Y CAUSARLE QUEMADURAS GRAVES.

- Cuando los alimentos se han terminado de freir, remueva la tapadera. Levante la canasta y saque lentamente del contenedor de aceite y coloquelo en el soporte localizado detras de la canasta freidora.
- Despues que el exeso de aceite se a drenado ponga los alimentos sobre toallas de papel para quitar el exedente de aceite.
- Si va a continuar friendo asegurese de que el aceite se recaliente otra vez a la temperatura seleccionada.

# GUIA DE COMO FREIR

Los tiempos dados en esta tabla son unicamente una guía y deberan ajustarse de acuerdo a la cantidad de alimentos que van a ser freidos.

**TABLA DE SUGERENCIAS APROXIMADAS**

TIPO DE ALIMENTO	Temp. °F	PESO EN (GRAMOS)	Estimated Time
Camarones	285°	226	3-5 minutos
Cebollas	285°	141	3-4 minutos
Hongos	285°	297	6-8 minutos
Filete de pescado	300°	226	5-6 minutos
Fish Fillet in batter	300°	396	6-8 minutos
Pastelillos o bolas de pescado	300°	396	6-8 minutos
Carne en rebanadas	340°	396	7-10 minutos
Filete de rez	340°	396	7-10 minutos
Trozos de pollo	360°	510	7-10 minutos
Papas a la francesa (1 <sup>st</sup> time)	375°	510	6-10 minutos
Papas a la francesa (2 <sup>nd</sup> time)	375°	226	3-5 minutos

\*Papas a la francesa que son refreidos por 2<sup>da</sup> vez seran mas livianos y dorados.

## DESPUES DE QUE LOS ALIMENTOS HAN SIDO FREIDOS:

1. Asegurese de poner el control de temperatura esté en apagado **OFF** y desconectado del toma corriente.
2. Una vez que haya terminado de cocinar, quite la tapadera de la freidora, cuelgue la canasta freidora para que el exeso de aceite caiga dentro del propio contenedor de aceite.

**Advertencia: Al remover la tapadera de la freidora escapara vapor caliente, tenga mucha precaucion al destaparla. Mantenga la cara y manos alejados del vapor que escapa.**

3. Saque la canasta y ponga los alimentos en servilletas de papel para que absorva el exeso de aceite. **No toque la canasta cuando este caliente. Utilize la agarradera.**
4. Despues que el exeso de aceite se a drenado, ponga los alimentos en tollas de papel para que absorva completamente el exeso de aceite.
5. Coloque la canasta dentro de la freidora.
6. No mueva o la lleve de un lugar a otro la freidora hasta que este completamente fría.
7. Desconecte la freidora del toma corriente y guarde.

## COMO LIMPIAR LA FREIDORA

8. Quite la tapadera de la freidora.  
**ADVERTENCIA: Antes de limpiar la freidora asegurese que esté desconectada del toma corriente, tambien asegurese de que la unidad y el aceite esten completamente frios. El aceite retiene su temperatura por largos periodos de tiempo despues del uso. No intente mover la freidora mientras el aceite este caliente.**
9. Espere a que la freidora enfrie, levante el elemento térmico.
10. Remueva el deposito del aceite vacie en un tazón se recomienda filtrar el aceite despues de cada uso si planea reuzar el mismo aceite otra vez.
11. Despues de remover el depósito de aceite la freidora se podra dividir en varias partes para limpiar.
12. El depocito del aceite y la base se pueden sumergir en el agua par alimpiar o lavar
13. El elemento térmico devera de ser limpiado con toallas de papel absorbente. Luego utilice un trapo húmedo con un poco de jabón para limpiarlo.  
**PRECAUCIÓN: No sumerja el elemento térmico en agua para limpiar.**
14. Seque todas las partes completamente.  
**Nota: Nunca utilice limpiadores abracivos, cepillos de alambre o químicos para limpiar la unidad.**

### COMO REMPLAZAR LOS FILTROS:

Los filtros de carbón deveran de cambiar cada 6 meses, El filtro del aceite cada 12 meses.

- 4) Quite la tapa del filtro.
- 5) Remueva los dos filtros el blanco y el negro.
- 6) Desagase de los filtros viejos y reemplace con nuevos. On.Asegurese de que el filtro blanco descanse en la superficie de metal bajo el filtro de carbon( filtro negro).

# COMO GUARDAR SU FREIDORA

Siempre permita que la freidora enfríe completamente antes de guardarla.

Guarde la freidora en un lugar seco y mantenga el cordón eléctrico fuera del alcance de los niños.

## EL USO DE UN CORDON ELECTRICO CORTO

**NOTA:** Un cordón eléctrico corto se a ensamblado en el aparato, para reducir el riezgo de daños personales como el enredarse o tropezar con el cordón eléctrico, Si un cordón eléctrico es requerido, extensiones eléctricas están disponibles para su compra en su ferreteria local y podrán ser utilizadas si se toman las devidas precauciones. Si una extensión eléctrica es utilizada:

- (1) Las especificaciones eléctricas del cordón devera cuando menos ser de las mismas especificaciones electricas o más que el aparato a utilizar:
- (2)La extensión eléctrica devera de colocarse de manera que no cuelge de la orilla de la meza donde podrán accidentalmente ser jalados por niños o mascotas.

### INSTRUCCIONES ESPECIALES:

- Para evitar la sobre carga eléctrica cuando use este producto, no utilize otro aparato de alta potencia(watage) en el mismo circuito o en el mismo receptaculo eléctrico.
- Evite el uso de extensiones eléctricas porque la extensión se podra sobrecalentar y causar riezgo de incendio.

**PRECAUCIÓN:** Este aparato esta equipado con una ploga polarizada(un lado de la navaja de la ploga es mas ancha que la otra) como una característica de seguridad para reducir el riezgo de una descarga eléctrica. Esta ploga esta diceñada para entrar de una sola manera. Esta es una característica de seguridad. Si usted no puede introducir la ploga en el enchúfe eléctrico, Haga girar la ploga 180° grados y trate de nuevo. Si el enchúfe no entra de ninguna manera, pongase en contacto con un electricista aprobado. Nunca utilice una extensión eléctrica sin que pueda introducir completamente la ploga en el receptaculo eléctrico. No altere la ploga de ninguna forma. No intente eliminar las características de seguridad de la ploga eléctrica polarizada.

Un cordón eléctrico corto a sido ensamblado en su aparato para reducir el riezgo de daños personales de enredarse o tropezar con el cordón.

Extensiones eléctricas están disponibles y pueden ser usados si toma las devidas precauciones. durante su uso.

Si una extensión eléctrica mas larga va a ser utilizada favor de tomar muy en cuenta lo siguiente:

**Las especificaciones eléctricas(voltage, watage y amperage) de la extensión eléctrica devera de ser igual o de más potencia que el aparato que se va a usar.**

***Este aparato es de uso domestico unicamente***

**GARANTÍA LIMITADA \* UN (1) AÑO**  
**GARANTIA ES VALIDA CON UNA PRUEBA DE COMPRA FECHADA**

1. Su aparato de cocina está construido con precisión, inspeccionados y probados antes de salir de nuestra fábrica.
2. Se garantiza, al comprador original, de estar libres de defectos de fabricación en condiciones de uso normales y las condiciones para un (1) año, cordones excluidos. Esta garantía se aplica sólo al comprador original de este producto.
3. Si necesita cambiar la unidad, devuélvala en su caja original, con el recibo de compra, a la tienda donde lo compró. Si usted está más allá del plazo concedido para el retorno por la política de la tienda, por favor consulte la garantía incluida.
4. Si utiliza el aparato para uso doméstico y de acuerdo con las instrucciones, debería ofrecerle años de servicio satisfactorio.
5. Durante el período de garantía de un año, un producto con un defecto será reparado o reemplazado por un modelo nuevo o reacondicionado (a nuestro criterio) cuando el producto sea devuelto a nuestro Centro de Servicio. (Consulte la sección "Devoluciones" a continuación).
6. El producto reparado o reemplazado estará garantizado por el saldo restante del período de garantía de un año y un plazo adicional de un mes.
7. **Esta garantía limitada cubre los aparatos comprados y usados en los 50 estados contiguos y el Distrito de Columbia, y no cubre:**
  - Los daños causados por el uso excesivo, negligencia, uso y desgaste normal, uso comercial, montaje o instalación incorrecta del producto.
  - Los daños causados durante el envío.
  - Los daños causados por la sustitución o reposición de fusibles o disyuntores.
  - Defectos que no sean defectos de fabricación.
  - Rotura causada por mal uso, abuso, accidente, alteración, falta de cuidado y mantenimiento, o incorrecta de corriente o voltaje.
  - Pérdida o falta alguna pieza del producto. Las piezas se deben comprar por separado.
  - Daños de piezas que no sean eléctricos; por ejemplo: agrietado o roto de plástico o de vidrio.
  - Daños por servicio o reparación por personal no autorizado.
  - Las garantías extendidas compradas a través de una empresa independiente o revendedor.
  - Remordimiento del consumidor no es una razón aceptable para devolver un producto a nuestro Centro de Servicio.

\* Un año de garantía limitada válida solamente en los 50 **estados contiguos y el Distrito de Columbia, excluyendo Puerto Rico y las Islas Vírgenes.**

Esta garantía es válida sólo si el producto es comprado y operado en los EE.UU., el uso del producto que se encuentra en violación de las instrucciones escritas proporcionadas con la unidad anulará esta garantía. Para la garantía internacional, por favor póngase en contacto con el distribuidor local.

\*\* Cualquier instrucción o política incluida en este manual puede estar sujeta a cambios en cualquier momento.

***MAXI-MATIC, EE.UU.***

18401 E. Ave Arenth. City of Industry, CA 91748

Departamento de Atención al Cliente: (626) 912-9877 Ext: 120/107 Lunes a viernes 8am-5pm PST

Sitio web: [www.maxi-matic.com](http://www.maxi-matic.com) email: [info@maxi-matic.com](mailto:info@maxi-matic.com)

## **INSTRUCCIONES DE DEVOLUCIÓN**

### **DEVOLUCIONES:**

A. Cualquier devolución de mercancía defectuosa al fabricante deben ser procesados apropiadamente contactando primero al servicio al cliente (información de contacto se muestra a continuación) para obtener un # RA (Número de autorización de devolución). No se aceptará ninguna devolución de mercancía sin un # RA aplicable.

B. INSTRUCCIONES IMPORTANTES DE RETORNO. Su garantía depende que usted siga estas instrucciones si va a devolver la unidad a Maxi-Matic EE.UU.:

1. Empaque cuidadosamente el producto en su caja original o en otra caja adecuada para evitar daños durante el envío.
2. Antes del envío de la devolución unidad, asegúrese de adjuntar:
  - a) Su nombre, dirección completa con código postal, número de teléfono durante el día, y #RA
  - b) Un recibo de compra fechado o COMPROBANTE DE COMPRA,
  - c) El número de modelo de la unidad y el problema que tiene (Encierre en un sobre y pegue directamente a la unidad antes de sellar la caja) y
  - d) Todas las piezas o accesorios relacionados con el problema.
3. Maxi-Matic EE.UU. recomienda enviar el paquete de servicio terrestre de UPS para fines de seguimiento. No podemos asumir la responsabilidad por productos perdidos o dañados devueltos a nosotros durante el transporte entrante. Para su protección, siempre cuidadosamente empaquetar el producto para su envío y asegurarlo con la compañía. Envíos C.O.D no puede ser aceptado.

**4. Todos los gastos de envío de devolución debe ser pagado por usted.**

5. Marque el exterior del paquete:

MAXI-MATIC EE.UU.  
18401 E. ARENTH AVE.  
CITY OF INDUSTRY, CA 91748

6. Una vez que su devolución ha sido recibida por nuestro almacén, Maxi-Matic EE.UU. se compromete a reparar o sustituir el producto si presenta defectos de materiales o mano de obra, sujeto a las condiciones del apartado B.

**7. Maxi-Matic pagará los gastos de envío para enviar el producto reparado o reemplazado de nuevo a usted.**