

E.FLEX

5W | 10W
Portable Solar Panel with USB Port



2775 E. Philadelphia St., Ontario, CA 91761
1-800-330-8678

Version 1.2

General Information

The E.FLEX is a sleek solar charger incorporating a simple plug-and-play feature to keep USB devices charged. Charge devices such as smartphones, tablets, and MP3 players faster and efficiently thanks to the new smart auto-optimization feature. With its ultra-lightweight and compact design, take the E.FLEX anywhere for a true on-the-go charging experience.

Key Features

- High efficient monocrystalline solar cells
- Smart auto-optimization USB charger
- ETFE material for more light absorption
- Weatherproof and durable layering
- Included carabiners for easy attachment
- Included suction cups for easy window charging

Smart Auto-Optimization Charging

When charging through solar, the charging rate changes based on the presence of clouds or shadows cast by trees and objects. This causes the solar power to underperform and reduce the rate of charge. Upon recovering the full solar charge, many chargers will not increase the charge, but instead continue to charge at their reduced levels. This means that your USB devices would be taking longer to charge and you (unknowingly) would have to disconnect the device and plug it back in to recover the lost charge. Thanks to the smart auto-optimization technology in the E.FLEX, this issue is resolved automatically giving you a worry-free charging experience.

The E.FLEX analyzes the power flow being received to make sure the USB device can charge as efficiently and as quickly as possible based on the solar power provided. This smart auto-optimization technology will be able to recover reduced power (caused by shade) by integrating a 90-second power flow check. When illumination increases, the E.FLEX will determine the power requirements of the USB devices and recover charge accordingly.



Be mindful that heat affects all electronic devices. Therefore, it is heavily recommended that charging devices not be exposed directly under the sun. Apple products are known to activate their heat protections which makes charging unstable.

Operation

To charge USB powered devices, simply unfold the unit on a nice sunny day and plug your device into. For stored charging, connect a USB powered battery to have longer-lasting power.

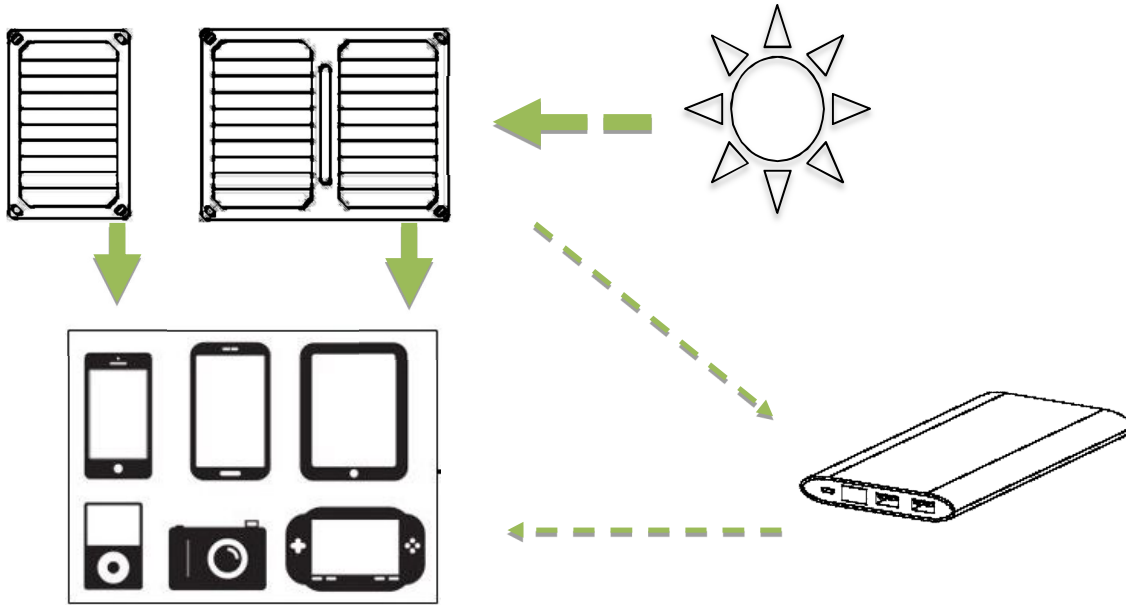

As an added bonus, turn your E.FLEX into a window charger that you can conveniently use inside your car or at your home.

!Note that this may not work with windows that have UV resistant tint

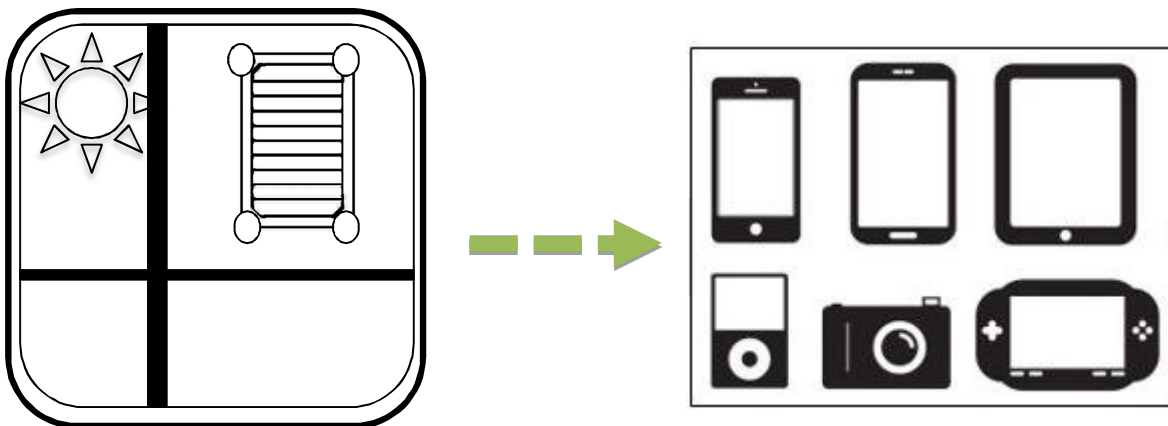

Technical Specifications

E.FLEX		
	E.FLEX5	E.FLEX10
Rated Power	5 W	10 W
Cell Type	Monocrystalline	
Cell Efficiency	22%	
USB Port	5V, 0.96A (Peak)	5V, 1.92A (Peak)
Solar Panel Surface Material	ETFE Laminated	
Fabric Material	Oxford	
Folded Dimensions	----	10.3 x 6.3 x 0.16 in
Unfolded Dimensions	10.3 x 6.3 x 0.16 in	13.4 x 10.3 x 0.08 in
Weight	5.6 oz.	11.2 oz.
Operating Temperature	-20°C to 70°C	