



# INSTALLATION INSTRUCTIONS

Accessory  
**WINDSHIELD WIPER KIT  
P/N 0SE10-HL3-500**

Application  
**SXS700/M4/M2**

Publication No.  
**MII 14607**  
Issue Date  
**August 2013**

**Honda Dealer: Please give a copy of these instructions to your customer.**

## PARTS LIST

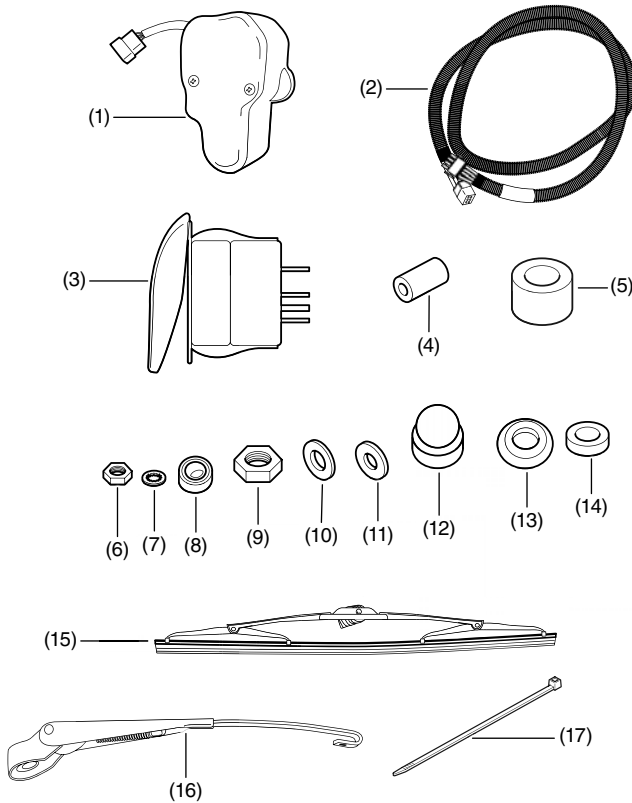

No.	Description	Qty
(1)	Motor	1
(2)	Wire harness	1
(3)	Switch	1
(4)	Small spacer	1
(5)	Large spacer	1
(6)	8 mm nut	2
(7)	Spindle arm washer	1
(8)	Spindle cap	1
(9)	Spindle nut	1
(10)	Plastic spindle washer	2
(11)	Rubber spindle washer	3
(12)	Stud cap	1
(13)	Metal stud washer	2
(14)	Rubber stud washer	2
(15)	Wiper blade	1
(16)	Wiper arm	1
(17)	Wire tie	6

## REQUIRED ACCESSORIES

**Sold separately**

The items below are required for the installation of this accessory.

- Glass Windshield - P/N 0SU95-HL3-105
- Auxiliary Wire Harness - P/N 0SA30-HL3-100

## TOOLS AND SUPPLIES REQUIRED

Wrench (13 mm)

Wrench (22 mm)

Torque wrench

Thread Lock (Loctite 242 "blue" or equivalent)

## TORQUE VALUES

Tighten all screws, bolts, and nuts to their specified torque values. Refer to the Service Manual for the torque values of the removed parts.

Item	N-m	kgf-m	lbf-ft
Step 8	4	0.41	2.95
Step 9	6	0.61	4.42
Step 13-14	25	2.55	18

## USE AND CARE INFORMATION

- Check the accessory mounts frequently and retighten if necessary.
- Replace this accessory with a new one if it is damaged or discolored excessively
- When this accessory becomes dirty, rinse it thoroughly with cool water to remove loose dirt, and then wash with warm soapy water and a clean cloth or sponge.
- Never use petroleum solvents such as gasoline, thinner, and benzene, to clean this accessory. Also do not use acid or alkaline cleaners.

## INSTALLATION

1. Install the accessory Glass Windshield and Auxiliary Wire Harness.
2. Remove plugs from the top of the glass windshield.
3. Slide the large spacer onto the motor spindle.
4. Slide the small spacer onto the motor stud.

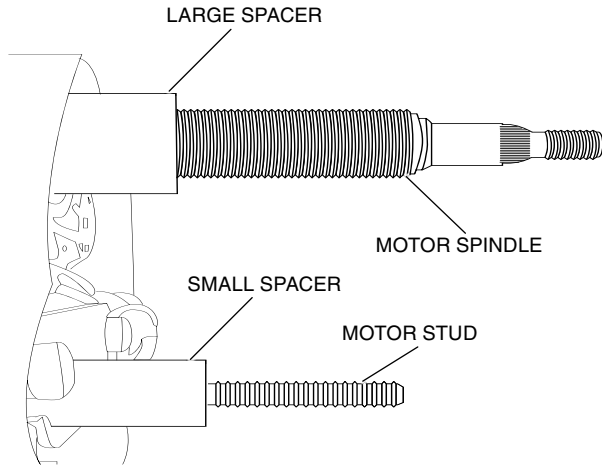

5. Slide a plastic spindle washer and then two rubber spindle washers onto the motor spindle.
6. Slide a metal stud washer and then a rubber stud washer onto the motor stud.

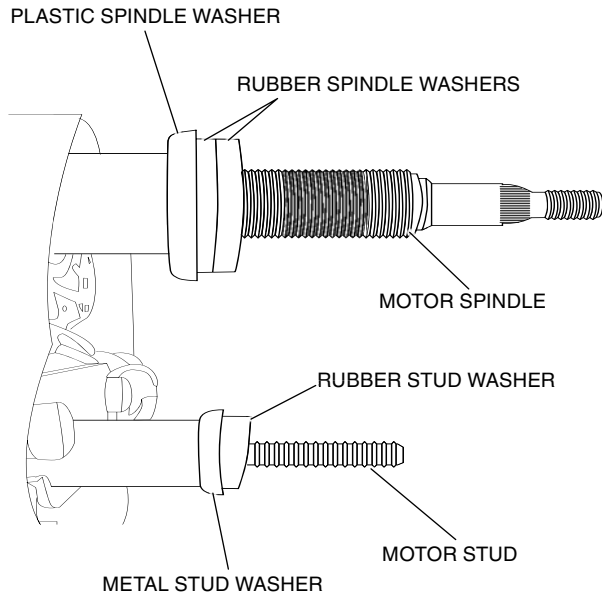

7. Insert the motor spindle and stud into the holes on the top of the windshield frame from inside the vehicle.

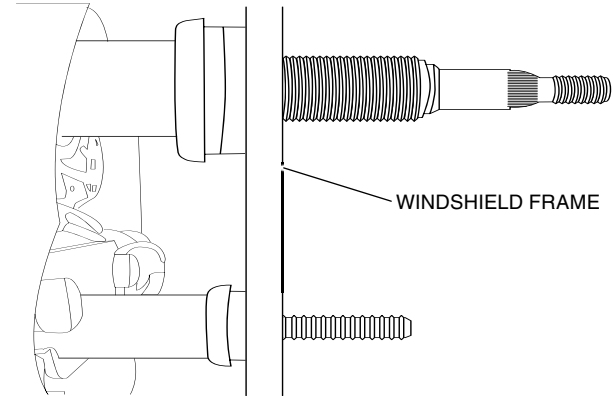

8. Slide a rubber spindle washer and then a plastic spindle washer onto the motor spindle.  
Install the spindle nut using threadlock to secure it.
  - Tighten the nut to the specified torque.
9. Slide a rubber stud washer and then a metal stud washer onto the motor stud.  
Install the 8 mm nut using threadlock to secure it.
  - Tighten the nut to the specified torque

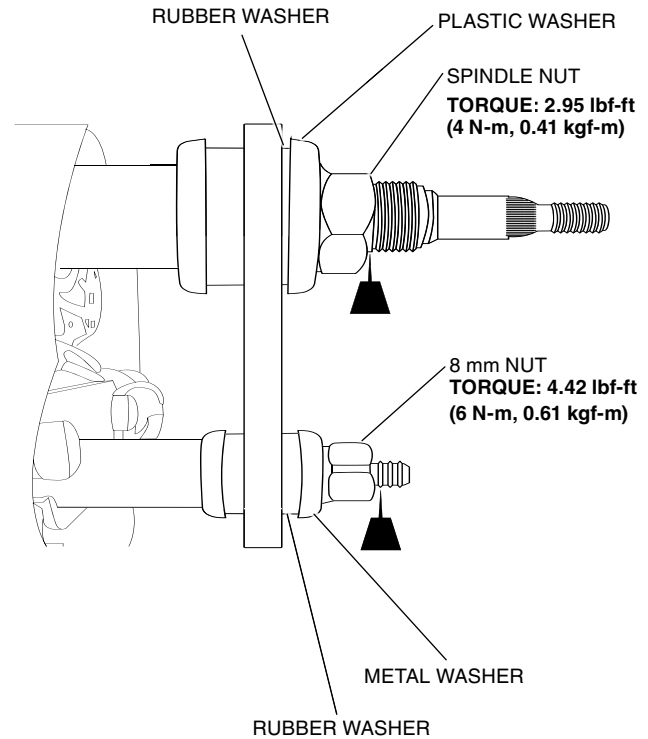

10. Press the spindle cap onto the motor spindle nut.
11. Press the stud cap onto the 8 mm nut.

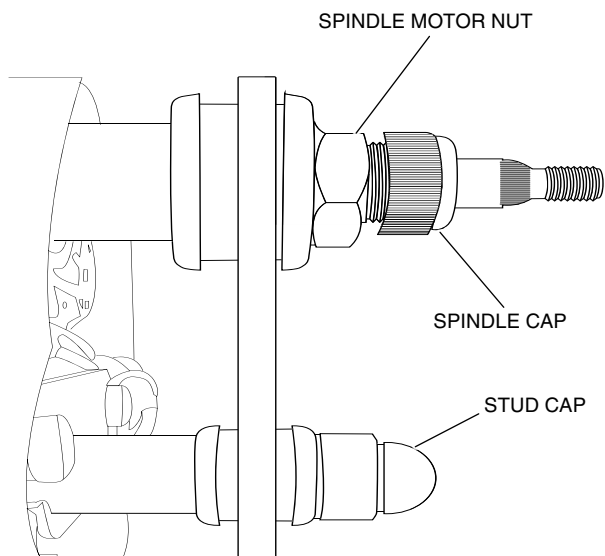

12. Assemble the wiper blade to the wiper arm. Install the assembled wiper onto the spindle and position it on the windshield, 25 mm from the seal edge (park position).

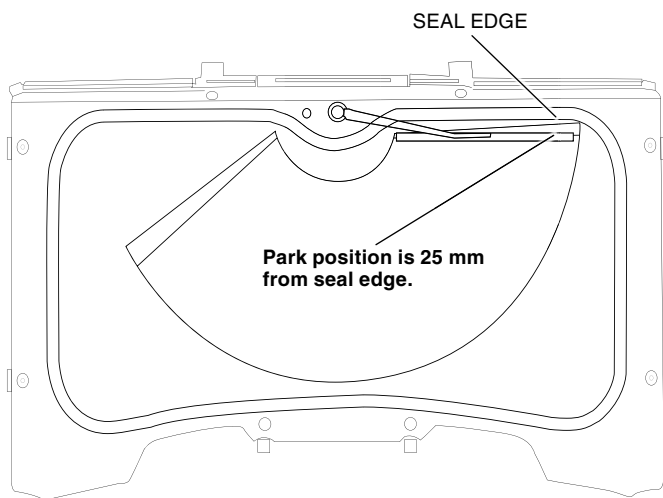

13. Install the spindle arm washer and then 8 mm nut onto the spindle. Tighten the nut to the specified torque.

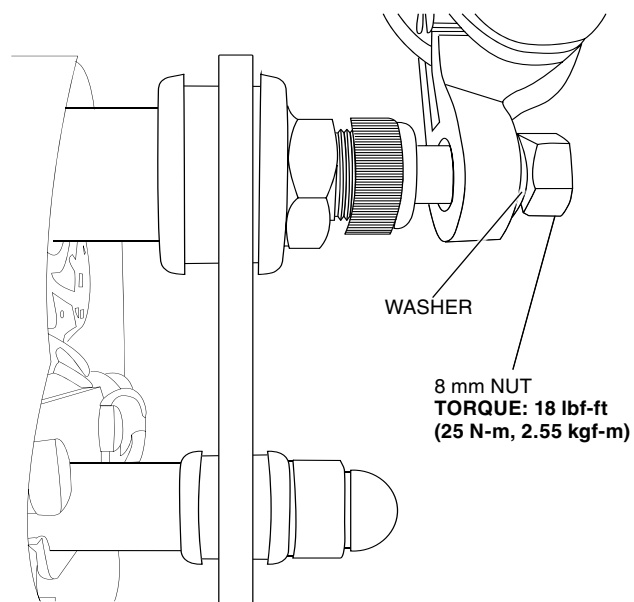

14. Wait 30 minutes and re-torque the spindle arm nut. The wiper system is now ready to run.
15. Pull the wire harness connector out to the side of the motor as shown.

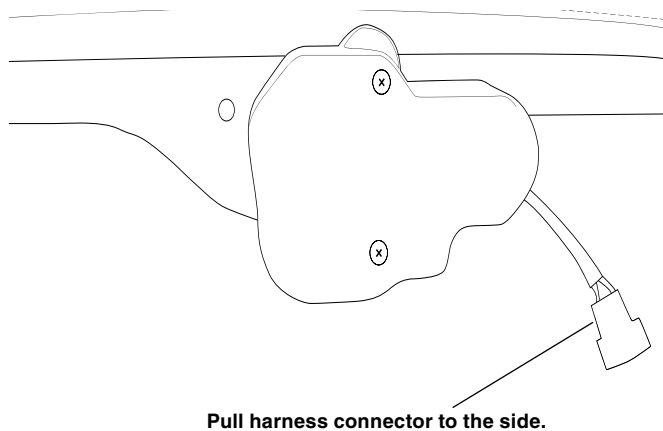

16. Connect the wire harness to the motor.  
Route the wire harness along the top of the windshield, and down the right cab frame bar.
17. Insert the wire harness through the hole in the dash along the right frame bar.

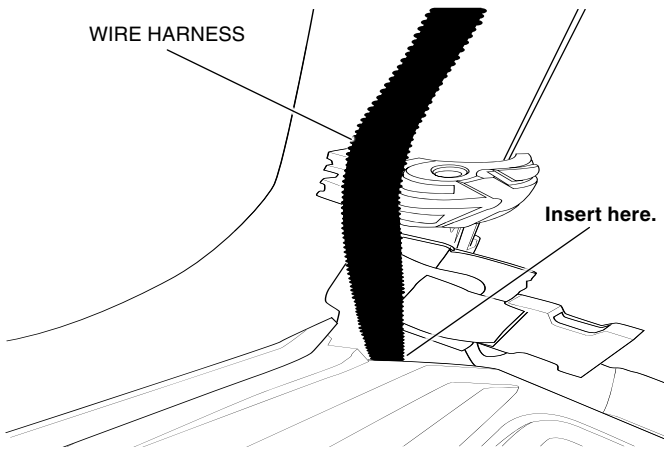

18. Pull the wire harness through the hole in the accessory fuse panel.
19. Make a mark on the wire harness outer loom at the point where it passes through the hole.
20. Trim away the excess outer loom from the marked point all the way to the connector. This will allow the wire bundle to flex enough for fuse box cover installation.
21. Connect the wire harness to the accessory fuse panel.

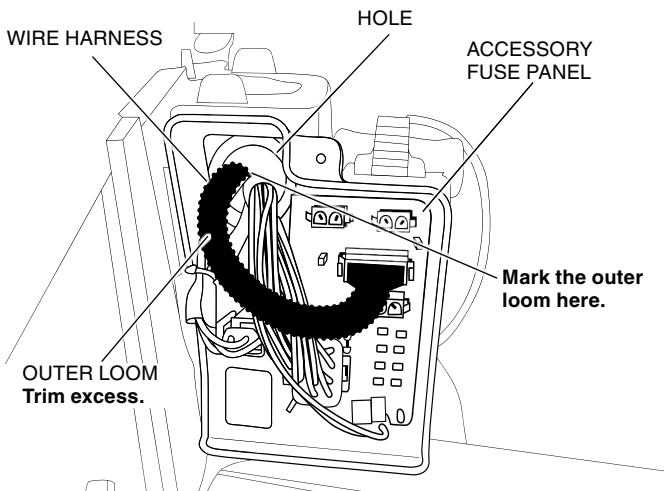

22. Install the fuse box cover.
23. Use the included wire ties to secure the wire harness to the vehicle frame at the desired locations.