

⚠ WARNING: DO NOT ATTEMPT TO REPAIR BY OPENING THE SHREDDER HEAD. THIS WILL COMPLETELY VOID THE PRODUCT WARRANTY.

No power to the shredder

1 Check power outlet

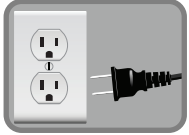

2 Check power light



1) Make sure power cord is plugged into a functioning 120V standard household power outlet.
Or, try using a different working outlet.

- 2) • Check if the green Power On icon is lit.
• Check the bin is not open.

Shredder is Jammed or runs in "reverse" mode only

1 Reverse to remove paper



2 Turn off shredder.



Apply shredder oil and wait for 30min.



3 Turn on power.



Use thick paper to push jam through



4 Reduce sheets to resume shredding



⚠ Warning:
DO NOT USE ANY SPRAY CANS OR AEROSOLS.

- 1) • Press the control button to reverse.
• Pull the paper to remove jammed paper (as much as possible).
- 2) • Turn off shredder.
• Apply **shredder oil** to the feed slot.
• Let oil soak in to paper and machine for 30 minutes.

Note: Repeat 1 & 2 steps if needed

- 3) • Press the power button to turn on shredder.
• Use thick paper stock or a greeting card to push the jam through.
- 4) • Reduce the number of sheets being fed (count pages to be sure not to exceed the maximum sheet count).
• Refeed the paper.

Shredder does not feed or shred paper

1 Overheat

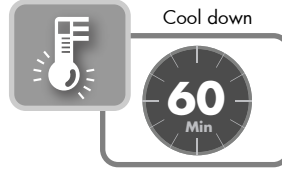

1 Overload

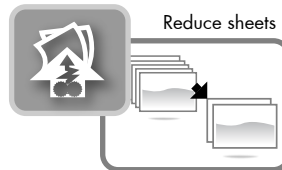

2 Door open

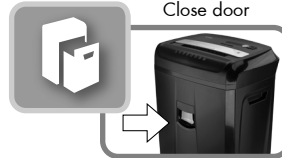

3 Power light not on



- 1) If Overheat icon is lit in red, turn shredder off and let it cool down for 60 minutes. Turn shredder on, check icon light again, and restart shredding only when icon light is not lit.
- 2) The Red LED light indicates when too much paper is inserted. Use the "Reverse" mode to back up and reduce number of sheets.
- 3) If Door Open icon is lit in red, re-close door until you feel firm click and Door Open icon is not lit.
- 4) If the LED Power On green light is not on:
• Make sure power cord is plugged into a working outlet.

Shredder does not feed or shred credit card or small piece of paper



Feed in the center

- Position credit card or small piece of paper over the credit card section of the Feeder (center position).
- Try again.

Shredder runs continuously

1 Unplug power

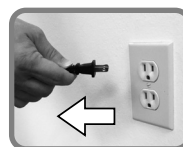

2 Clean sensor

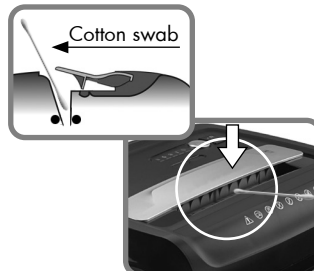

⚠ Warning:
DO NOT USE CANNED AIR.

- 1) Unplug the machine from the wall socket.
- 2) • Find the activation sensor in the center of the feed slot.
• Use a cotton swab to gently wipe away any dust or debris that has collected on the sensor.