



**ALL-IN-ONE**

# BLENDER SET

WITH **SILICONE SPATULA, TAMPER**  
& **TRAVEL CUP**

## Quick Start Guide



Read this booklet thoroughly and save these instructions.

FAQs can be found at [www.blend-works.net](http://www.blend-works.net)

Email us for any unanswered questions: [cs@blend-works.net](mailto:cs@blend-works.net)

## INCLUDED IN YOUR PURCHASE

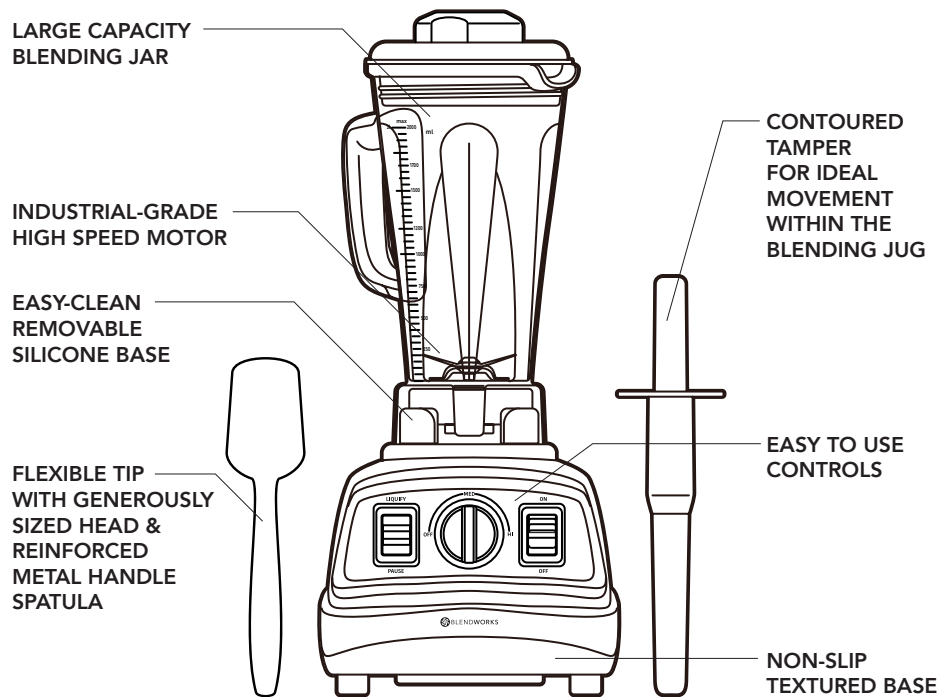

## USING YOUR MACHINE FOR THE FIRST TIME

1. Unpack the appliance and place all the parts on a horizontal surface.
2. Immerse the blender jar, jar lid, measuring cup and tamper in warm soapy water, rinse them then dry. Never immerse motor unit in water for cleaning to prevent the risk of electric shock. **Note: The blade is very sharp, please handle with care.**
3. For attaching blender jar, firstly place the jar lid and measuring cup into the blender jug, ensure the jug lid and measuring cup are placed tightly and properly with the blender jar. Then place the blender jar onto the jar support pad and fix it onto the motor unit tightly. Now, your blender is ready to use.

### NOTE:

- Before assembling the blender jug, be sure the power cable is unplugged from the power outlet, the power switch and the speed dial are both in the "OFF" positions.
- The appliance will not start to work if the blender jar is not assembled onto the motor unit properly.
- Make sure all the parts are assembled properly.
- During operation, if the mixture is too thick to be blended, turn the dial to "OFF", remove the cap and insert the tamper into the hole in the lid. Turn the dial back to "HI" and stir the contents in the blending jar with the tamper.
- Do not remove the blender jug from the motor unit during working process. If it is necessary to remove the blender jug, turn off the appliance to make it stop working and then remove it.
- The max operation time per time should not exceed 3 minutes and a minimum of 10 minutes rest time must be maintained between two consecutive cycles. The appliance must rest for at least 30 minutes every 10 cycles.
- The speed dial and power switch must be at "OFF" positions and the power outlet must be unplugged before removing the blender jug.

## RECIPES YOU CAN MAKE WITH YOUR BLENDER



SMOOTHIES



CREAMY SOUP



FROZEN DESSERTS



SAUCES, DIPS, DRESSINGS



FROZEN DRINKS



NUT-BASED MILK

## BLENDING WITH YOUR MACHINE

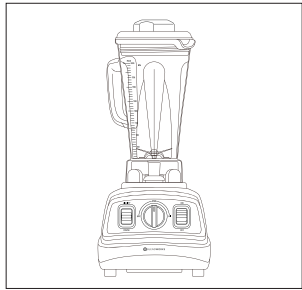

### STEP 1

Place your blender on a flat, dry surface.

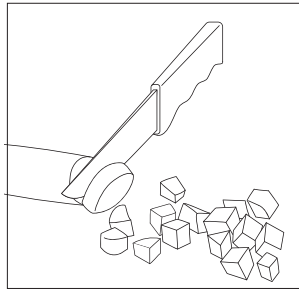

### STEP 2

Prepare the ingredients by cutting them into cubes with a size of  $\frac{5}{8}$ in x  $\frac{5}{8}$ in x  $\frac{5}{8}$ in (15mm x 15mm x 15mm). The proportion of ingredients and water is 2:3. Close the jug lid and place the blending jar in place.

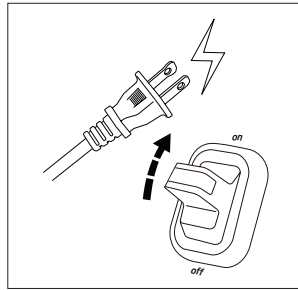

### STEP 3

Connect the appliance to a power source, and turned the machine on by flipping the switch to "ON".

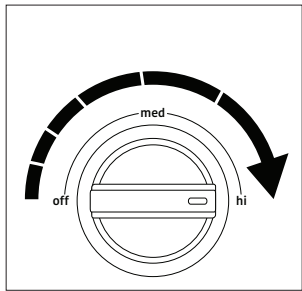

### STEP 4

Turn the dial to the "HI" speed setting and the blender will start to blend the ingredients.

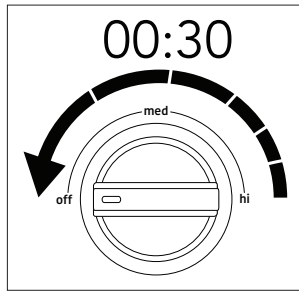

### STEP 5

After blending for about 30 seconds, turn the dial to the "OFF" position, the machine will stop blending.

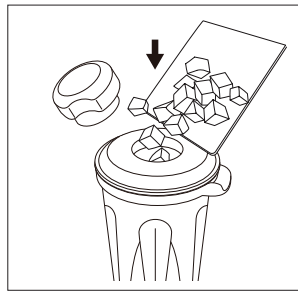

### STEP 6

To add more ingredients while blending, turn the dial to "OFF", remove the cap and add the ingredients through the opening in the lid. Replace the cap and turn the dial to "ON".

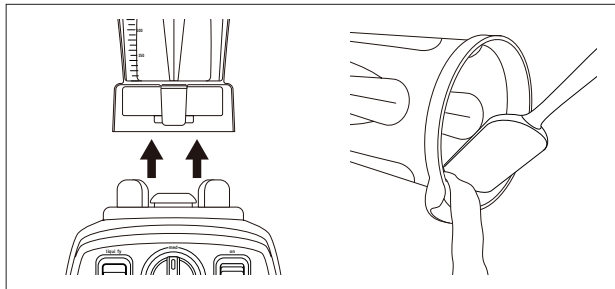

### STEP 7

Once you're done blending, remove the blending jar from the silicone base, remove the jar lid and cap, then pour and serve.

## MAKING CRUSHED ICE

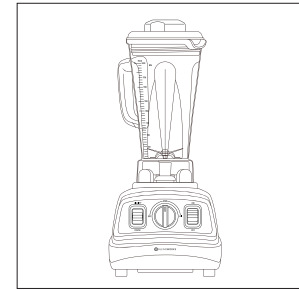

### STEP 1

Lay the appliance on the flat horizontal surface and make sure it is unplugged.

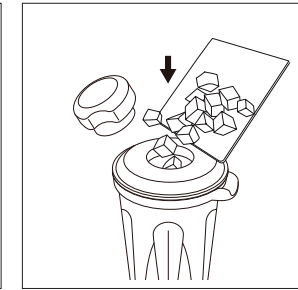

### STEP 2

Prepare some ice cubes with a size of  $\frac{5}{8}$ in x  $\frac{5}{8}$ in x  $\frac{5}{8}$ in (15mm x 15mm x 15mm). The proportion of ice and water is 2:3. Close the jug lid and place the blending jar in place.

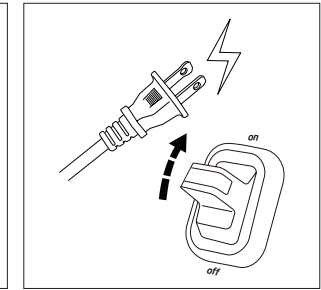

### STEP 3

Connect the appliance to a power source, and turned the machine on by flipping the switch to "ON".

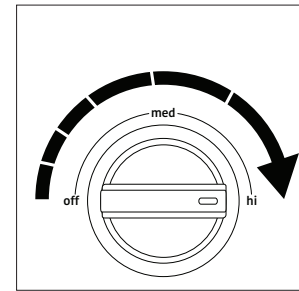

### STEP 4

Turn the dial to the "HI" speed setting and the blender will start to blend the ingredients.

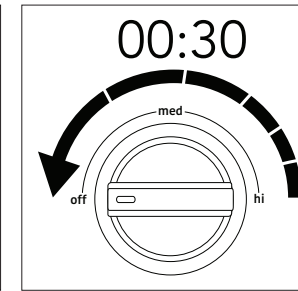

### STEP 5

After blending for about 30 seconds, turn the dial to the "OFF" position, the machine will stop blending.

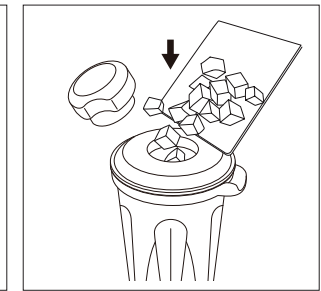

### STEP 6

To add more ice cubes while blending, turn the dial to "OFF", remove the cap and add the ice cubes through the opening in the lid. Replace the cap and turn the dial to "ON".

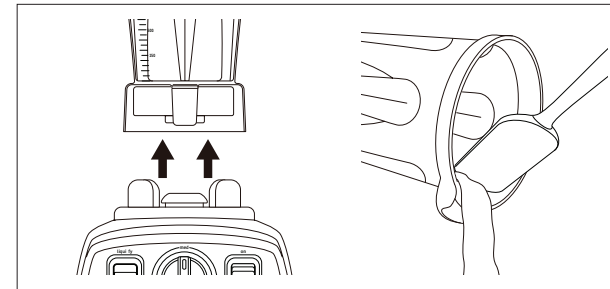

### STEP 7

Once you're done blending, remove the blending jar from the silicone base, remove the jar lid and cap, then pour and serve.

## GRINDING COFFEE BEANS

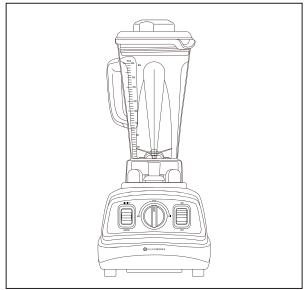

### STEP 1

Place your blender on a flat, dry surface.

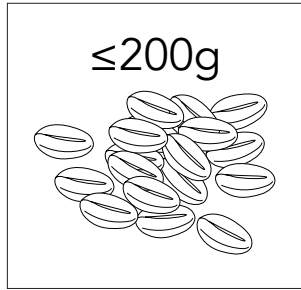

### STEP 2

Prepare 7 ounces (200g) of roasted coffee beans. The maximum capacity of food to be grinded should not exceed 200g. Close the jug lid and place the blending jar in place.

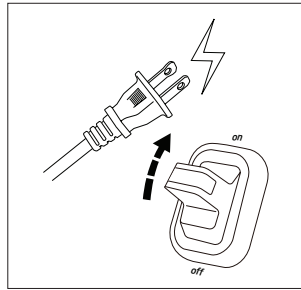

### STEP 3

Connect the appliance to a power source, and turned the machine on by flipping the switch to "ON".

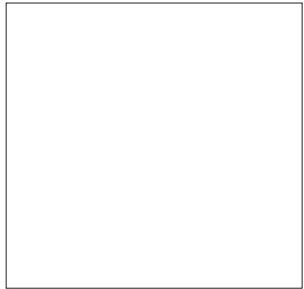

### STEP 4

Flip the switch to "PULSE" speed setting and the blender will start to grind the coffee beans.

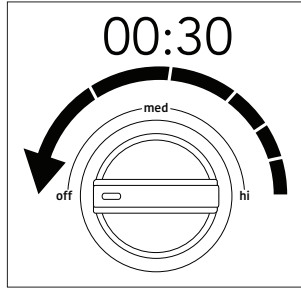

### STEP 5

After blending for about 30 seconds, turn the dial to the "OFF" position, the machine will stop blending.

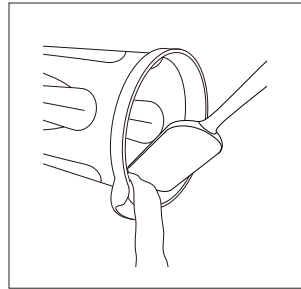

### STEP 5

Once you're done grinding, remove the blending jar from the silicone base, remove the jar lid and cap, then pour and serve.

## MAKING HOT SOUP

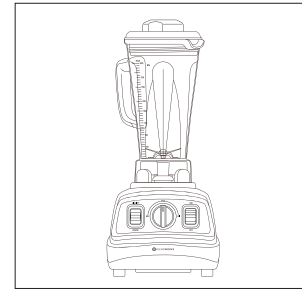

### STEP 1

Place your blender on a flat, dry surface.

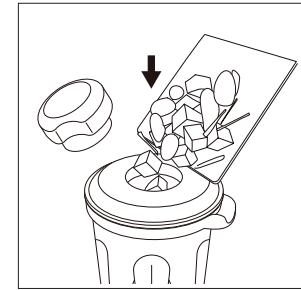

### STEP 2

Put the required ingredients into the blender jug and fill the blender jug with the appropriate amount of room-temperature purified water. The amount of mixture should not exceed 1000ml. Close the jug lid and place the blending jar in place.

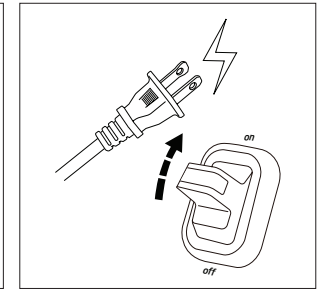

### STEP 3

Connect the appliance to a power source, and turned the machine on by flipping the switch to "ON".

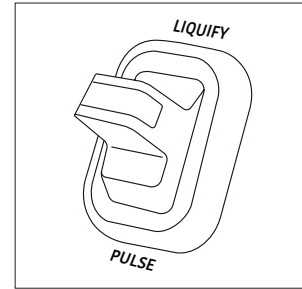

### STEP 4

Flip the switch to "LIQUIFY" speed setting and the blender will start to make the soup.

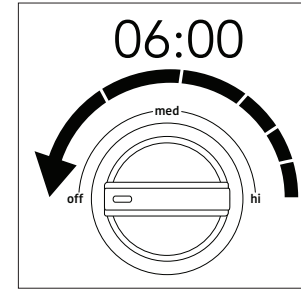

### STEP 5

After cooking for about 6 minutes, turn the dial to the "OFF" position, the machine will stop cooking.

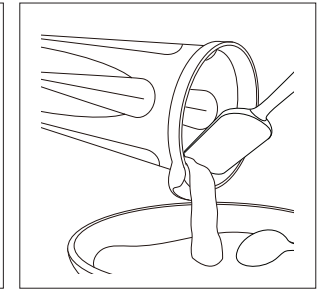

### STEP 6

Once you're done cooking, remove the blending jar from the silicone base, remove the jar lid and cap, then pour and serve.

# IMPORTANT SAFEGUARDS

**⚠ WARNING:** For your continued safety and to reduce the risk of injury or electric shock, please follow all the safety precautions listed below.

1. Read all the instructions carefully before using this appliance and keep them for future reference.
2. Before using this appliance ensures that the voltage of your electricity supply is the same as that indicated on the rating plate of the appliance.
3. Ensure that the mains cable does not touch any hot surface and that it does not overhang the edge of your work surface.
4. Do not use the appliance near a source of heat or on an unstable surface.
5. Do not operate the appliance with a damaged mains cable or mains plug or after the appliance or any attachment has been damaged. Seek qualified technicians for assistance.
6. If the mains cable is damaged it must be replaced by the manufacturer, its service agent, or similarly qualified persons in order to avoid a hazard. Please contact us at [cs@blend-works.net](mailto:cs@blend-works.net) to arrange for examination, repair or electrical or mechanical adjustment.
7. Avoid contacting moving parts.
8. Do not leave foreign objects, such as spoons, forks, knives or the measuring cup, in the blender jug as this will damage the blades and other components when starting the machine and may cause injury.
9. Do not use attachments or accessories which are not recommended by the manufacturer. They may cause malfunction or injury.
10. The blender jug should not be more than 2/3 full when the tamper is left in while blending. Do not exceed 30 seconds of continuous blending with the tamper in place.
11. When making nut butters or oil based foods, do not process for more than one minute after the mixture starts circulating. Over-processing can cause dangerous overheating.
12. When blending hot liquids or ingredients, use caution: spray or escaping steam may cause scalding and burns. Do not fill container to the maximum capacity. Always begin processing on the lowest speed setting. Keep hands and other exposed skin away from the lid opening to prevent possible burns.
13. Turn all controls to OFF and unplug the blender when it is not in use, before putting on or taking off parts, and before cleaning. 14. Never leave the appliance unattended while it is running.
15. Do not immerse the motor unit or the mains cable or plug in liquids.
16. If scraping is necessary, turn the power OFF, unplug from the electrical outlet, and use a rubber spatula only.
17. Always operate blender with lid in place.
18. Never put non-food items into the jug to blend.
19. Do not open the lid before the blade stops running completely to avoid hazard.
20. Do not place your hand in the blender jug. The sharp blade may cause injury.
21. Do not use the appliance outdoors.
22. Unplug the appliance from the mains supply when not in use, when removing or attaching attachments, and before cleaning any part of the appliance.
23. This appliance can be used by children aged from 8 years and above and persons with reduced physical, sensory or mental capabilities or lack of experience and knowledge if they have been given supervision or instruction concerning use of the appliance in a safe way and understand the hazards involved. Children shall not play with the appliance. Cleaning and user maintenance shall not be made by children without supervision. Children should be supervised to ensure that they do not play with the appliance.
24. They shall state that care shall be taken when handling the sharp cutting blades, emptying the bowl and during cleaning.
25. This appliance is for household use only. Do not use it for professional catering. Do not use the appliance for any purpose not expressly specified in this manual.

# CLEANING & MAINTENANCE

The Auto-Clean feature can help to clean the blender and blade assembly easily and rapidly in complete safety.

-After use, reassemble the blender jug and pour in about 400- 500ml of warm water and turn the speed dial to "HI" speed or push the function switch to "Pulse" position to work for a few seconds to remove the residual food.

-After stop, remove the blender jug from the motor unit and rinse the blender jug under running water.

- Wipe the outer surface of the motor unit with a damp cloth, do not use abrasive cleansers. Never immerse in water or other solution for cleaning.

-All parts except the motor unit are dishwasher-safe. You can also wash the parts, except the motor unit, in warm, soapy water.

-Dry all parts and then reassemble them again. But store the appliance with the jug lid not closed completely to allow air to circulate and prevent jug odors.

-If any problem has been encountered during use, never disassemble the Motor Unit by yourself, there are no user serviceable parts inside. Contact only the authorized service facility for examination and repair.

## WARNING:

- The blade is very sharp, handle carefully when clean.
- Do not use abrasive cleaners. Never immerse the Motor Unit in water for cleaning

# TROUBLESHOOTING YOUR MACHINE

Problem	Reason	Solution

Do not attempt to dismantle your machine. If the cause of failure is not listed above, please contact us at [cs@blend-works.net](mailto:cs@blend-works.net)

Complete user instructions, FAQ and usage tips can be found at  
**Blend-Works.net**

Email us at **cs@blend-works.net**  
for any unanswered questions

MADE IN CHINA  
© 2016



This symbol on the product or in the instructions means that your electrical and electronic equipment should be disposed at the end of its life separately from your household wares. There are separate collection systems for recycling in the EU. For more information, please contact the local authority or your retailer where you purchased the product.



**FOR HOUSEHOLD USE ONLY**  
**SÓLO PARA USO DOMÉSTICO**  
**UNIQUEMENT POUR UN USAGE À DOMICILE**  
**PARA UTILIZAÇÃO DOMÉSTICA SOMENTE**

