

Personal Audio System
SRS-XB3



The following explains how to use this speaker. Select a topic from the navigation pane.

Getting Started

What you can do with the speaker

Parts and controls

Included items

Checking the contents of the box

Power source

Connecting to an AC outlet

Turning the power on

Turning the power off

Using the BLUETOOTH standby function

Charging USB devices such as smartphones

Auto power off function

Switching the auto power off function



Making connections

BLUETOOTH

How to make a wireless connection with BLUETOOTH devices

Pairing and connecting with a BLUETOOTH device

Connecting with a paired BLUETOOTH device

Connecting with an NFC-compatible device by One-touch (NFC)

Disconnecting the NFC-compatible device by One-touch (NFC)

Switching devices by One-touch (NFC)

Pairing and connecting with a computer (Windows 8)

Pairing and connecting with a computer (Windows 7)

Connecting with a paired computer (Windows 8)

Connecting with a paired computer (Windows 7)

Connecting to a portable audio device, etc.

Listening to music

BLUETOOTH device

Listening to music of a device via BLUETOOTH connection

Selecting the wireless playback quality of the speaker

Terminating the BLUETOOTH connection (After use)

Speaker Add function

Listening to music wirelessly with two speakers (Speaker Add function)

Switching between double mode and stereo mode (Speaker Add function)

Terminating the BLUETOOTH connection (After use)

Listening to music of a portable audio device, etc.

Enjoying EXTRA BASS

Phone calls

Receiving a call

Making a call

Button functions for a phone call

Terminating the BLUETOOTH connection (After use)

Information

About the indicators

Notes on use

Precautions

Notes on charging

Notes on water resistant feature

How to care for the speaker when wet

What is BLUETOOTH wireless technology?

What is LDAC?

Trademarks

Customer support websites

Troubleshooting

What can I do to solve a problem?

Power supply

Unable to turn on the speaker or charge the built-in battery

The power suddenly turns off

Sound

No sound/Sound from only one speaker/Low sound level

Distorted sound/Humming or noise in the speaker output

BLUETOOTH

Unable to pair the speaker with a BLUETOOTH device

Unable to connect the speaker to a BLUETOOTH device with One-touch connection (NFC)

Unable to connect a BLUETOOTH device with the speaker in the Speaker Add function

No voice/Low voice from callers

Reset

Using the RESET button

Initializing the speaker

Table Of Contents

Help Guide SRS-XB3.....	i
What you can do with the speaker.....	1
Parts and controls.....	2
Checking the contents of the box.....	4
Power source.....	i
Connecting to an AC outlet.....	5
Turning the power on.....	7
Turning the power off.....	8
Using the BLUETOOTH standby function.....	9
Charging USB devices such as smartphones.....	11
Auto power off function.....	13
Switching the auto power off function.....	14
Making connections.....	ii
BLUETOOTH.....	ii
How to make a wireless connection with BLUETOOTH devices.....	15
Pairing and connecting with a BLUETOOTH device.....	17
Connecting with a paired BLUETOOTH device.....	20
Connecting with an NFC-compatible device by One-touch (NFC).....	22
Disconnecting the NFC-compatible device by One-touch (NFC).....	25
Switching devices by One-touch (NFC).....	26
Pairing and connecting with a computer (Windows 8).....	27
Pairing and connecting with a computer (Windows 7).....	35
Connecting with a paired computer (Windows 8).....	40
Connecting with a paired computer (Windows 7).....	45
Connecting to a portable audio device, etc.....	48
Listening to music.....	ii
BLUETOOTH device.....	ii
Listening to music of a device via BLUETOOTH connection.....	50
Selecting the wireless playback quality of the speaker.....	52
Terminating the BLUETOOTH connection (After use).....	54
Speaker Add function.....	ii
Listening to music wirelessly with two speakers (Speaker Add function).....	55
Switching between double mode and stereo mode (Speaker Add function).....	59
Terminating the BLUETOOTH connection (After use).....	54
Listening to music of a portable audio device, etc.....	61
Enjoying EXTRA BASS.....	63
Phone calls.....	ii
Receiving a call.....	64

Making a call.....	67
Button functions for a phone call.....	70
Terminating the BLUETOOTH connection (After use).....	54
Information.....	iii
About the indicators.....	71
Notes on use.....	iii
Precautions.....	73
Notes on charging.....	75
Notes on water resistant feature.....	76
How to care for the speaker when wet.....	78
What is BLUETOOTH wireless technology?.....	79
What is LDAC?.....	81
Trademarks.....	82
Customer support websites.....	83
Troubleshooting.....	iii
What can I do to solve a problem?.....	84
Power supply.....	iii
Unable to turn on the speaker or charge the built-in battery.....	85
The power suddenly turns off.....	86
Sound.....	iii
No sound/Sound from only one speaker/Low sound level.....	87
Distorted sound/Humming or noise in the speaker output.....	88
BLUETOOTH.....	iii
Unable to pair the speaker with a BLUETOOTH device.....	89
Unable to connect the speaker to a BLUETOOTH device with One-touch connection (NFC).....	90
Unable to connect a BLUETOOTH device with the speaker in the Speaker Add function.....	91
No voice/Low voice from callers.....	92
Reset.....	iii
Using the RESET button.....	93
Initializing the speaker.....	94

Personal Audio System
SRS-XB3

What you can do with the speaker

- One-touch connection (NFC)
- BLUETOOTH Ver. 3.0
- Compatible BLUETOOTH profiles^{*1}: A2DP, AVRCP, HFP, HSP
- By connecting the speaker with a smartphone via BLUETOOTH, you can talk hands-free using the built-in microphone and speaker.
- “Noise suppression” and “Echo cancellation” enable phone calls with high-quality sound.

Noise suppression: Noise picked up by the speaker is suppressed, so the caller will hear your voice with less noise.

Echo cancellation: By reducing sound from the speaker picked up by the speaker microphone, echoes generated by the caller's phone will be suppressed.

- You can enjoy up to about 24 hours^{*2*3} of continuous wireless music playback with the built-in lithium ion rechargeable battery.
- BLUETOOTH standby function
- External input jack: AUDIO IN
- Charging the speaker by connecting the AC adaptor supplied
- By connecting two SRS-XB3 speakers via BLUETOOTH, you can play audio in either stereo mode (stereo sound) or double mode.
- You can charge a USB device such as smartphone by connecting it to the DC OUT ONLY port (USB) of the speaker via USB cable.
- You can orient the speaker into a vertical position.
- The speaker has a water resistant specification^{*4*5} of IPX5^{*6} as specified in “Degrees of protection against ingress of water” of the IEC60529 “Ingress Protection Rating (IP Code).”

*1 BLUETOOTH standard profiles indicate the purpose of BLUETOOTH communication between devices.

*2 The battery life may vary depending on the ambient temperature or conditions of use. The method of estimating the battery life has been changed since 2015.

*3 When the specified music source is used and the volume level of the speaker is set to 10. If the volume level of the speaker is set to maximum, the usage life will be approx. 4 hours. Time may vary, depending on the temperature or conditions of use.

*4 Requires that the cap is fastened securely.

*5 The supplied accessories are not water resistant.

*6 IPX5 (Degree of protection against jets of water): The system has been tested and found to remain functional after exposure to direct jet streams of water using a nozzle of 6.3 mm (about 1/4 in) internal diameter from any direction where approximately 12.5 L/ min of water is applied for a period of more than 3 minutes from a distance of about 3 meters (about 10 ft).

Personal Audio System
SRS-XB3

Parts and controls

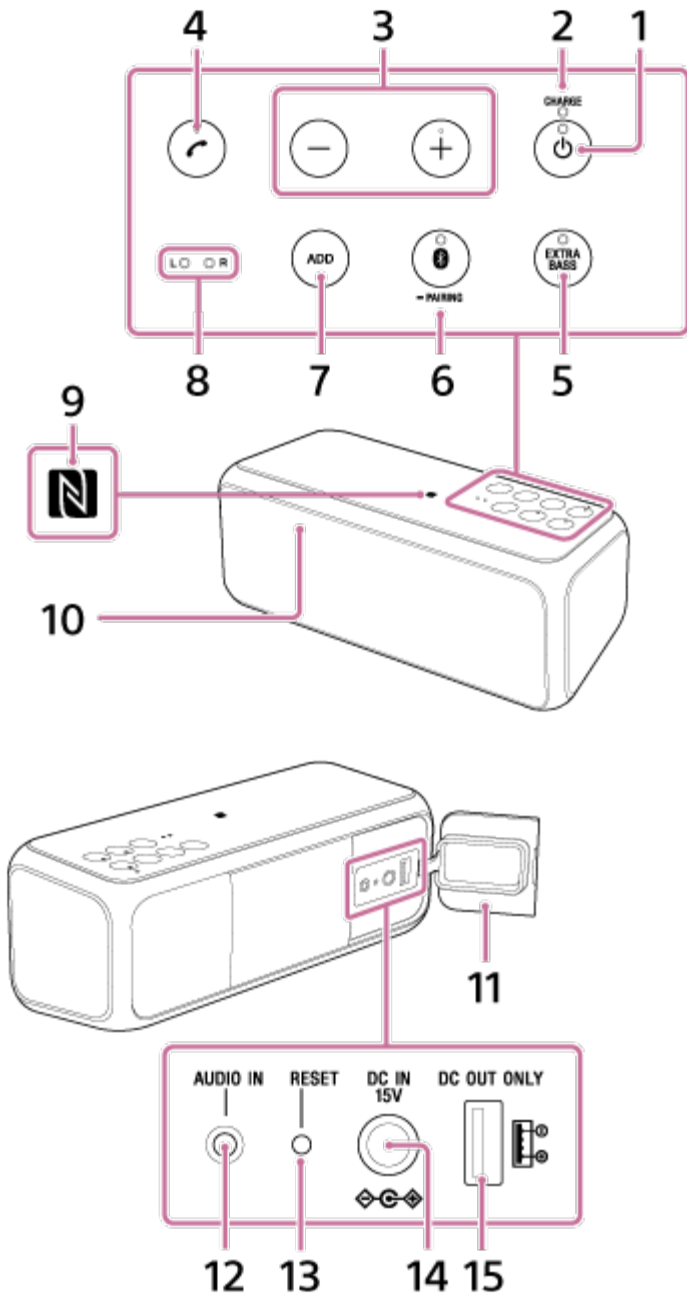

1. ⏻ (power) button/indicator
2. CHARGE indicator
3. -/+ (volume) buttons
4. 📞 (call) button
5. EXTRA BASS button/indicator
6. 📶 (BLUETOOTH) — PAIRING button/indicator

7. ADD button
 8. L (left)/R (right) indicators
 9. N-mark
 10. Microphone
 11. Cap
 12. AUDIO IN jack
 13. RESET button
 14. DC IN 15V jack
 15. DC OUT ONLY port (USB)
-

Related Topic

- [About the indicators](#)

4-587-623-11(2) Copyright 2016 Sony Corporation

Personal Audio System
SRS-XB3

Checking the contents of the box

After opening the package, check that all items in the list below are included in the package.
If any items are missing, contact your dealer.

- Personal audio system (SRS-XB3)
- AC adaptor
- Plug (depending on your region/country)
- Operating Instructions

Provides you with instructions on how to connect the speaker with BLUETOOTH devices and basic operations.

- Reference Guide

Provides you with precautions and product specifications.

- Warranty card (depending on your region/country)

Personal Audio System
SRS-XB3

Connecting to an AC outlet

The speaker can be operated by connecting it to an AC outlet via AC adaptor (supplied) or built-in battery (rechargeable). Before using the speaker for the first time, be sure to charge the battery by connecting the speaker to an AC outlet via the supplied AC adaptor.

You can operate the speaker by battery instead of the AC adaptor by charging the speaker before use.

1 Connect the supplied AC adaptor to the DC IN 15V jack.

2 Plug the AC adaptor to an AC outlet.

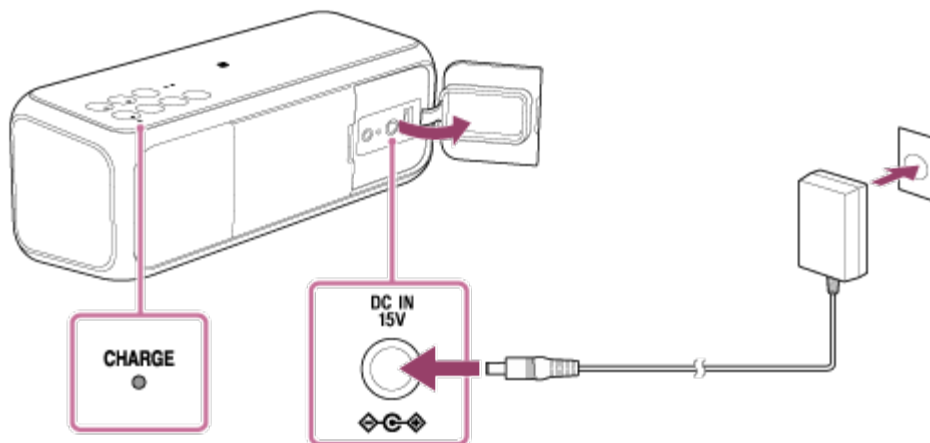

Charging starts and the CHARGE indicator lights up in orange. Charging is completed in about four hours^{*1} and the indicator turns off. Once the battery is fully charged, it will not be charged furthermore even if the speaker is kept connected to an AC outlet.

^{*1} Time that is required to charge the empty battery to its full capacity.

Battery life (when using the BLUETOOTH connection)

About 24 hours^{*2*3}.

The time stated above may vary depending on ambient temperature or conditions of use.

^{*2} The method of estimating the battery life has been changed since 2015.

^{*3} When the specified music source is used and the volume level of the speaker is set to 10. If the volume level of the speaker is set to maximum, the usage life will be approx. 4 hours. Time may vary, depending on the temperature or conditions of use.

When the battery is running low

- When the CHARGE indicator flashes slowly in orange, the battery is running low and needs to be charged. In this state, the speaker cannot supply power to other devices.
- If the CHARGE indicator flashes three times in orange and turns off when you turn on the speaker, the battery is empty and needs to be charged.

Note

- When you switch the power source between an AC outlet and battery by connecting/disconnecting the AC adaptor, the speaker may stop sound output for a short while. This is not a malfunction.
- In an extremely cold or hot environment, charging stops for safety. If charging takes a long time, it also makes charging of the speaker stop. In these conditions, the CHARGE indicator keeps flashing in orange quickly, but this is not a malfunction. To resolve these issues, unplug the AC adaptor and plug it in again within the operating temperature of between 5 °C and 35 °C (41 °F and 95 °F).
- Even if you do not intend to use the speaker for a long time, charge the battery to its full capacity once every six months to maintain its performance.

Related Topic

- [Turning the power on](#)
- [Notes on charging](#)
- [Enjoying EXTRA BASS](#)

Personal Audio System
SRS-XB3

Turning the power on

- 1 Press the  (power) button.

The  (power) indicator lights up in green.

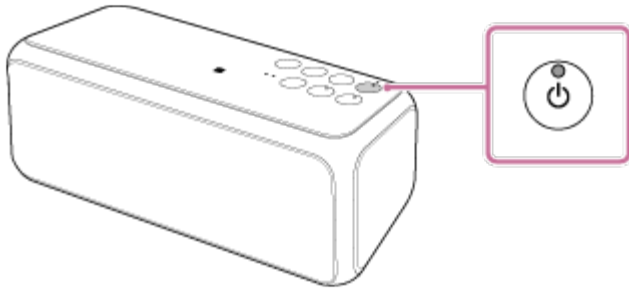

Hint

- When you turn on the speaker for the first time after purchase, the EXTRA BASS function is on, and the indicator on the EXTRA BASS button lights up in white.

Note

- If the CHARGE indicator flashes three times in orange and turns off when you turn on the speaker, the battery is empty and needs to be charged.
- When the CHARGE indicator flashes slowly in orange, the battery is running low and needs to be charged. In this state, the speaker cannot supply power to other devices.

Related Topic

- [Turning the power off](#)
- [Connecting to an AC outlet](#)
- [Enjoying EXTRA BASS](#)

Personal Audio System
SRS-XB3

Turning the power off

- 1 Press the  (power) button.

The  (power) indicator turns off.

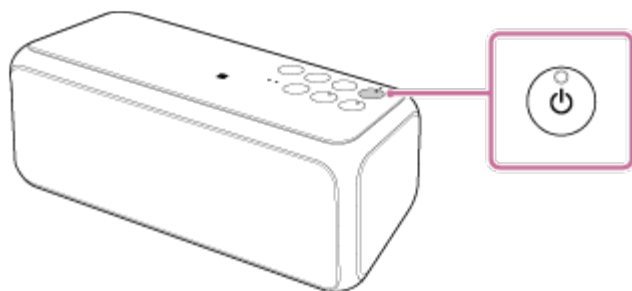

Hint

- When you turn off the speaker while the BLUETOOTH standby function is on, the  (power) indicator lights up in orange and the speaker enters the BLUETOOTH standby mode.

Related Topic

- [Auto power off function](#)
- [Using the BLUETOOTH standby function](#)

Personal Audio System
SRS-XB3

Using the BLUETOOTH standby function

When the BLUETOOTH standby function is turned on, the speaker turns on automatically by operating a BLUETOOTH device, and starts the BLUETOOTH connection.

Before operating the speaker, note the following:

- The BLUETOOTH standby function can be set only when the speaker is connected to an AC outlet via the AC adaptor. When the speaker is being powered by the built-in battery only, the BLUETOOTH standby function is not available.
- If pairing information is not stored in the speaker, such is the case when the speaker is used for the first time after purchase, the speaker will not enter the BLUETOOTH standby mode.

1 Connect the speaker to the AC outlet.

2 Turn on the speaker.

The  (power) indicator lights up in green.

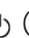
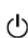
3 Press and hold the  (power) button for at least four seconds until the  (power) indicator lights up in orange.

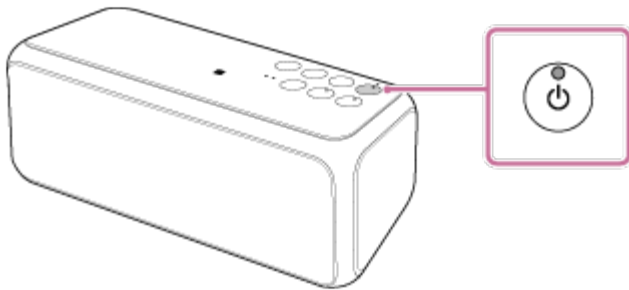

The speaker turns off and enters the BLUETOOTH standby mode.

When the speaker is accessed by a BLUETOOTH device, the speaker turns on automatically and starts the BLUETOOTH connection.

To turn off the BLUETOOTH standby function

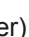
Perform step 1 to 2 above again and press and hold the  (power) button over four seconds until the  (power) indicator turns off. The BLUETOOTH standby function is turned off and the speaker will turn off.

Hint

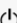
- The  (power) indicator lights up in orange while the speaker is turned off when the BLUETOOTH standby function is activated.

Related Topic

- [Connecting to an AC outlet](#)
- [Turning the power on](#)
- [How to make a wireless connection with BLUETOOTH devices](#)
- [About the indicators](#)

Personal Audio System
SRS-XB3

Charging USB devices such as smartphones

You can charge a USB device, such as a smartphone, by connecting it to the speaker with a USB cable (not supplied). Even if the speaker is not connected to an AC outlet, its built-in battery can supply power to a USB device.

- 1 Connect a USB device such as a smartphone to the DC OUT ONLY port (USB) using a USB cable (not supplied).

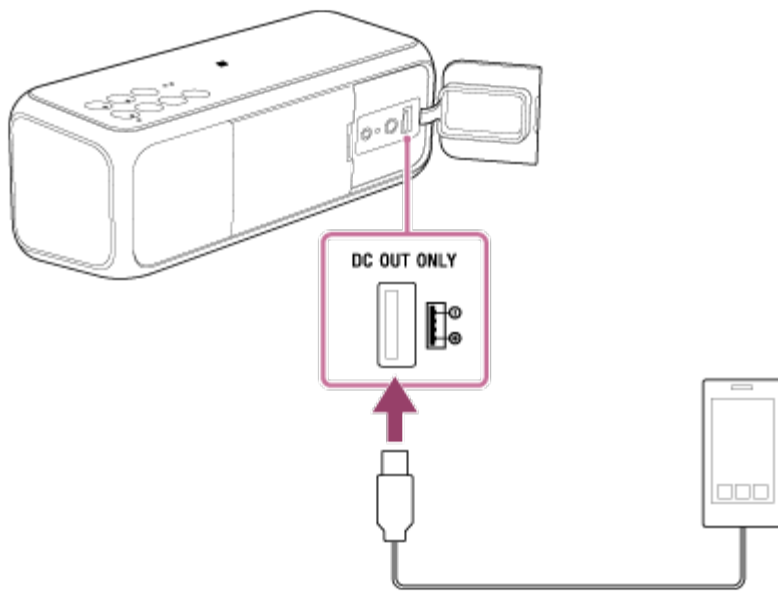

When you connect the speaker to an AC outlet via the AC adaptor (supplied), the connected USB device starts to be charged automatically.

If the speaker is being powered by the built-in battery only, proceed to step 2.

- 2 Turn on the speaker.

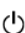
The  (power) indicator lights up in green and the USB device starts to be charged.

Note

- If the speaker is being powered by the built-in battery only, charging of the connected USB device will stop when the speaker turns off.
- When the CHARGE indicator flashes slowly in orange, the battery is running low and needs to be charged. In this state, the speaker cannot supply power to other devices.

- Music playback is not available with a USB cable.

Related Topic

- [Connecting to an AC outlet](#)
- [Turning the power on](#)

4-587-623-11(2) Copyright 2016 Sony Corporation

Personal Audio System
SRS-XB3

Auto power off function

If the speaker satisfies the following conditions for 15 minutes, it turns off automatically.

When the speaker is in BLUETOOTH mode

- No operation on the speaker.
- No BLUETOOTH connection has been established between the speaker and a smartphone or mobile phone via HFP/HSP.
HFP and HSP are types of BLUETOOTH profiles.
HSP (Headset Profile): Allows calling/cellular phone operation.
HFP (Hands-Free Profile): Allows hands-free calling/cellular phone operation.
- No music (sound) is played when the speaker is connected to a BLUETOOTH device.

When the speaker is in AUDIO IN mode

- No operation on the speaker.
- No music (sound) is played on an audio device connected to the AUDIO IN jack or the music (sound) of an audio device connected to the AUDIO IN jack is too small.
- No BLUETOOTH device is connected to the speaker via HFP/HSP.

Note

- The speaker turns off automatically if it satisfies the conditions above for 15 minutes, even if the speaker is charging a USB device that is connected to the DC OUT ONLY port (USB). If the speaker is being powered by the built-in battery only, charging will stop when the speaker turns off.

Related Topic

- [Switching the auto power off function](#)

Personal Audio System
SRS-XB3



Switching the auto power off function

You can switch the auto power off function on/off. At the time of purchase, the setting is on.

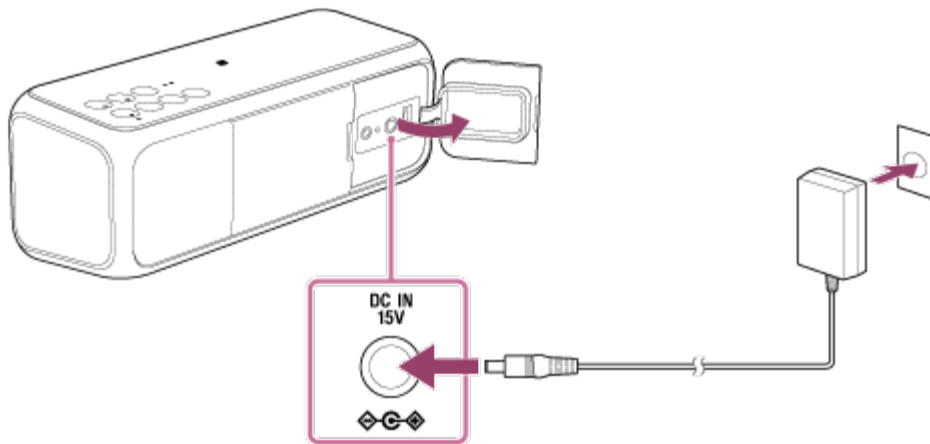
- 1 Connect the speaker to the AC adaptor, and turn off the power.



- 2 Press and hold the + button and the - button at the same time for at least five seconds.

When the auto power off function switches to off, the  (BLUETOOTH) indicator flashes three times in white.
When the function switches to on, the  (BLUETOOTH) indicator flashes twice in white.

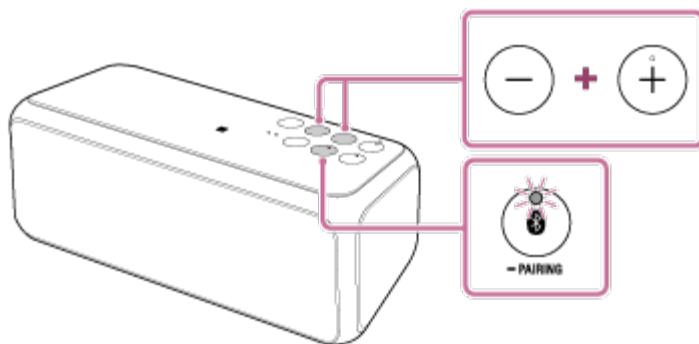

Related Topic

- [Auto power off function](#)

Personal Audio System
SRS-XB3

How to make a wireless connection with BLUETOOTH devices

You can enjoy music and hands-free calling with the speaker wirelessly by using your device's BLUETOOTH function.

Before operating the speaker, be sure to do the following:

- Place the BLUETOOTH device within 1 m (3 ft) of the speaker.
- Connect the speaker to an AC outlet or charge the battery sufficiently.
- Stop playback on a BLUETOOTH device to avoid sudden loud sound output from the speaker.
- Prepare the operating instructions supplied with the BLUETOOTH device for reference.

Pairing the speaker with a BLUETOOTH device

Pairing is the process required to mutually register the information on BLUETOOTH devices to be connected wirelessly. It is necessary to pair a device with the speaker to be able to make a BLUETOOTH connection for the first time. Select your situation from the following two connecting patterns. The method is the same, even when pairing a second device or more.

- [Pairing and connecting with a BLUETOOTH device](#)
- [Connecting with an NFC-compatible device by One-touch \(NFC\)](#)

Connecting the speaker with the paired device

Once the BLUETOOTH devices are paired, there is no need to pair them again. To connect a device already paired, refer to the following topic.

- [Connecting with a paired BLUETOOTH device](#)

Connecting the speaker with an NFC-compatible device by One-touch (NFC)

By touching the speaker with an NFC-compatible device such as a smartphone or Walkman, etc., the speaker is turned on automatically and then proceeds to pairing and making a BLUETOOTH connection. For details, refer to the following topics.

- [Connecting with an NFC-compatible device by One-touch \(NFC\)](#)
- [Disconnecting the NFC-compatible device by One-touch \(NFC\)](#)
- [Switching devices by One-touch \(NFC\)](#)

Compatible smartphones

NFC-compatible smartphones with Android 2.3.3 or later installed

Compatible Walkman models

NFC-compatible Walkman models*

* Even if your Walkman is compatible with the NFC function, it may not be able to make a BLUETOOTH connection with the speaker by one touch. For

details on the compatible models, refer to the operating instructions supplied with your Walkman.

NFC

NFC (Near Field Communication) is a technology enabling short-range wireless communication between various devices, such as smartphones and IC tags.

Thanks to the NFC function, data communication - for example, BLUETOOTH pairing - can be achieved easily by simply touching NFC-compatible devices together (i.e., at the N-mark symbol or location designated on each device).

Note

- Once the BLUETOOTH devices are paired, there is no need to pair them again, except in the following cases:
 - Pairing information has been deleted after repair, etc.
 - The speaker is already paired with eight devices and another device is to be paired.
- The speaker can be paired with up to eight devices. If a new device is paired after eight devices have already been paired, the paired device with the oldest connection time is replaced by the new one.
- — When the pairing information of the speaker has been deleted from the BLUETOOTH device.
- — When the speaker is initialized, all pairing information is deleted.
- The speaker can be paired with multiple devices, but can only play music from one paired device at a time.
- When an audio cable is connected to the speaker's AUDIO IN jack while the speaker and the BLUETOOTH device have been connected via BLUETOOTH connection, sound from the BLUETOOTH-connected device is not output from the speaker (the hands-free function is available). To listen to music from the BLUETOOTH device, disconnect the audio cable from the speaker's AUDIO IN jack.

Personal Audio System
SRS-XB3

Pairing and connecting with a BLUETOOTH device

The speaker can be paired with up to eight BLUETOOTH devices.

When pairing with two or more BLUETOOTH devices, perform the following pairing procedure for each device.

Before operating the speaker, be sure to do the following:



- Place the BLUETOOTH device within 1 m (3 ft) of the speaker.
- Connect the speaker to the AC outlet or charge the battery sufficiently.
- Stop playback on a BLUETOOTH device to avoid sudden loud sound output from the speaker.
- Prepare the operating instructions supplied with the BLUETOOTH device for reference.

1 Turn on the speaker.

The  (power) indicator lights up in green.

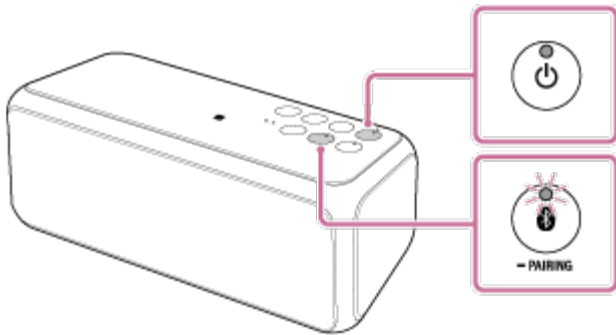
The  (BLUETOOTH) indicator begins to flash in white.



- When you turn on the speaker for the first time after purchase, the  (BLUETOOTH) indicator will begin to flash quickly in white and the speaker enters pairing mode automatically by just turning on the speaker. Proceed to step 3.
- When you turn on the speaker, the speaker tries to make a BLUETOOTH connection with the last connected BLUETOOTH device. If the device is nearby and its BLUETOOTH function is on, the BLUETOOTH connection is established automatically and the  (BLUETOOTH) indicator stays lit. When you want to connect another BLUETOOTH device, terminate the current BLUETOOTH connection by operating the currently connected BLUETOOTH device.

2 Press and hold the (BLUETOOTH) - PAIRING button until you hear beeps and the (BLUETOOTH) indicator begins to flash quickly in white.

The speaker enters pairing mode.

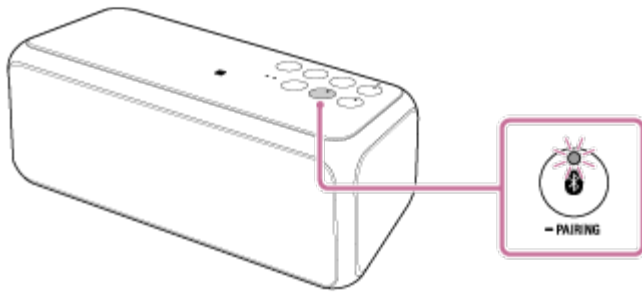

3 Perform the pairing procedure on the BLUETOOTH device to detect the speaker.

When a list of detected devices appears on the display of the BLUETOOTH device, select “SRS-XB3.”
If a passkey* is required on the display of the BLUETOOTH device, enter “0000.”

* A passkey may be called “Passcode”, “PIN code”, “PIN number” or “Password.”

4 Make the BLUETOOTH connection from the BLUETOOTH device.

When the BLUETOOTH connection is established, the  (BLUETOOTH) indicator stays lit.

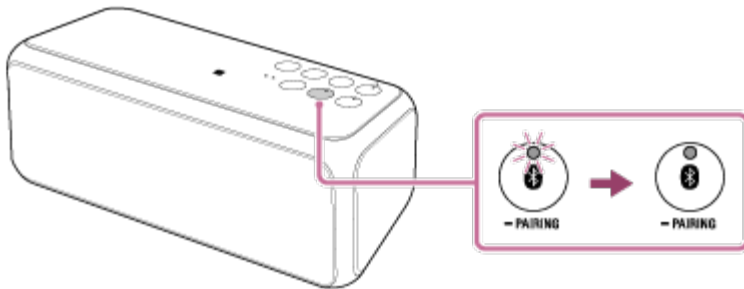

If the BLUETOOTH connection is not established, repeat from step 2.

Hint

- For details on operating a BLUETOOTH device, refer to the operating instructions supplied with the BLUETOOTH device.

Note

- The pairing mode of the speaker is released after about 5 minutes and the  (BLUETOOTH) indicator flashes slowly. However, when pairing information is not stored in the speaker, such as at the factory settings, the pairing mode is not released. If the pairing mode is released before finishing the process, repeat from step 2.
- When pairing with a BLUETOOTH device that cannot display a list of detected devices or that has no display, you may be able to pair the device by setting both the speaker and the BLUETOOTH device to pairing mode. At this time, if a passkey besides “0000” is set on the BLUETOOTH device, pairing cannot be done with the speaker.
- Once the BLUETOOTH devices are paired, there is no need to pair them again, except in the following cases:

Pairing information has been deleted after repair, etc.

- The speaker is already paired with eight devices and another device is to be paired.

The speaker can be paired with up to eight devices. If a new device is paired after eight devices have already been paired, the paired device with the oldest connection time is replaced by the new one.

- When the pairing information of the speaker has been deleted from the BLUETOOTH device.
- When the speaker is initialized, all the pairing information is deleted.
- The speaker can be paired with multiple devices, but can only play music from one paired device at a time.
- When an audio cable is connected to the speaker's AUDIO IN jack while the speaker and the BLUETOOTH device have been connected via BLUETOOTH connection, sound from the BLUETOOTH-connected device is not output from the speaker (the hands-free function is available). To listen to music from the BLUETOOTH device, disconnect the audio cable from the speaker's AUDIO IN jack.

Related Topic

- [Connecting with a paired BLUETOOTH device](#)
- [Listening to music of a device via BLUETOOTH connection](#)
- [Terminating the BLUETOOTH connection \(After use\)](#)
- [Listening to music wirelessly with two speakers \(Speaker Add function\)](#)

Personal Audio System
SRS-XB3

Connecting with a paired BLUETOOTH device

Check the following before you operate the speaker.

- If the speaker was previously paired with a different device, turn off the BLUETOOTH function for the other device.

1 Turn on the speaker.

The  (power) indicator lights up in green.

The  (BLUETOOTH) indicator begins to flash in white.

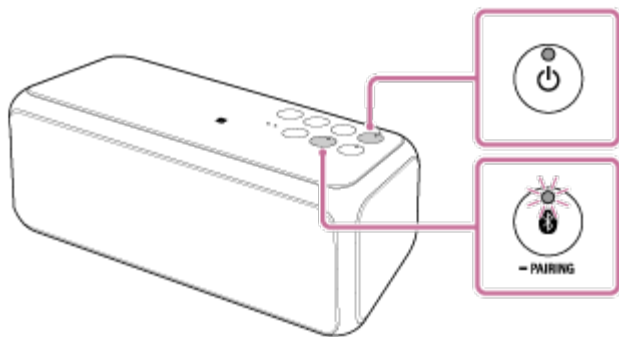

When you turn on the speaker, the speaker tries to make a BLUETOOTH connection with the last connected BLUETOOTH device. If the device is nearby and its BLUETOOTH function is on, the BLUETOOTH connection is established automatically and the  (BLUETOOTH) indicator stays lit. When you want to connect another BLUETOOTH device, terminate the current BLUETOOTH connection by operating the currently connected BLUETOOTH device.

2 Make the BLUETOOTH connection from the BLUETOOTH device.

When the BLUETOOTH connection is established, the  (BLUETOOTH) indicator stays lit.

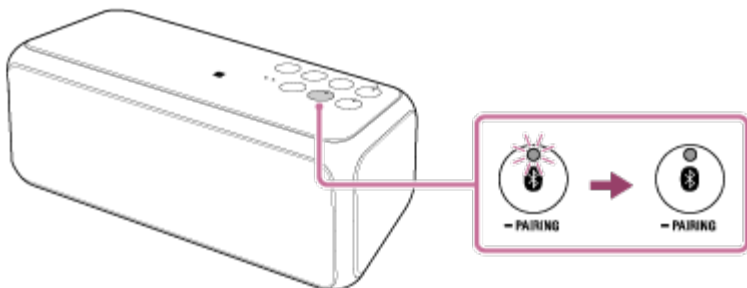

Hint

- If the devices cannot connect, enter pairing mode to connect.

(The speaker can be paired with up to eight devices. If the speaker is paired with multiple devices, it is necessary to enter pairing mode to connect.)

- When the BLUETOOTH standby function is turned on, the speaker turns on automatically by operating a BLUETOOTH device, and starts the BLUETOOTH connection.

Note

- When the speaker made a connection automatically with the last connected BLUETOOTH device, the BLUETOOTH function may not work properly. In this case, terminate the BLUETOOTH connection by operating the connected BLUETOOTH device and reestablish a connection.
- When an audio cable is connected to the speaker's AUDIO IN jack while the speaker and the BLUETOOTH device have been connected via a BLUETOOTH connection, sound from the BLUETOOTH-connected device is not output from the speaker (the hands-free function is available). To listen to music from the BLUETOOTH device, disconnect the audio cable from the speaker's AUDIO IN jack.

Related Topic

- [Pairing and connecting with a BLUETOOTH device](#)
- [Listening to music of a device via BLUETOOTH connection](#)
- [Terminating the BLUETOOTH connection \(After use\)](#)

Personal Audio System
SRS-XB3

Connecting with an NFC-compatible device by One-touch (NFC)

By touching the speaker with an NFC-compatible device such as a smartphone, the speaker turns on automatically, then proceeds to pairing and BLUETOOTH connection.

Compatible smartphones

NFC-compatible smartphones with Android 2.3.3 or later installed

Compatible Walkman models

NFC-compatible Walkman models^{*1}

^{*1} Even if your Walkman is compatible with the NFC function, it may not be able to make a BLUETOOTH connection with the speaker by One-touch. For details on the compatible models, refer to the operating instructions supplied with your Walkman.

NFC

NFC (Near Field Communication) is a technology enabling short-range wireless communication between various devices, such as smartphones and IC tags.

Thanks to the NFC function, data communication - for example, BLUETOOTH pairing - can be achieved easily by simply touching NFC-compatible devices together (i.e., at the N-mark symbol or location designated on each device).

1 Set the NFC function of the device to on.

For details, refer to the operating instructions supplied with the device.

- If your smartphone OS is Android 2.3.3 or later, and less than Android 4.1:
proceed to step 2.
- If your smartphone OS is Android 4.1 or later: proceed to step 4.
- NFC-compatible Walkman models^{*2}: proceed to step 4.

^{*2} The procedures for the NFC settings may vary depending on Walkman models. For details, refer to the operating instructions supplied with your Walkman.

2 Download and install the app "NFC Easy Connect" on the smartphone.

"NFC Easy Connect" is a free Android app you can download from Google Play.

Download the app by searching for "NFC Easy Connect" or access it by using the following two-dimensional code. A fee may be charged to download the app.

To download via the two-dimensional code, a two-dimensional code reader app is required.

Access the following Web site to search for the app:

<https://play.google.com/store/apps/details?id=com.sony.easyconnect>

Download via the two-dimensional code:



The app may not be downloadable in some countries/regions.

- 3 Start "NFC Easy Connect" on the smartphone.

Make sure that the app screen is displayed.

- 4 Touch the speaker with the device.

Unlock the screen of the device beforehand.

Keep touching the device on the N marked part of the speaker until the device responds.
If the speaker is off, it will turn on when the device touches it.

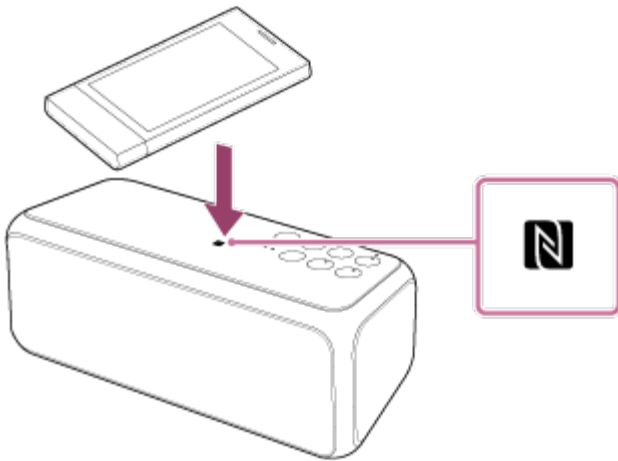

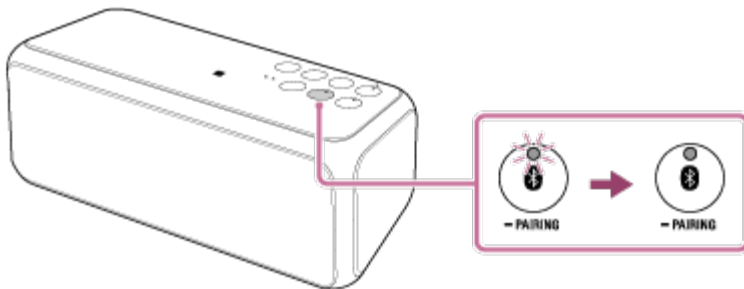

Follow the on-screen instructions to establish the connection.

When the BLUETOOTH connection is established,  (BLUETOOTH) indicator stays lit.



To disconnect, touch the speaker with the device again.

Hint

- If you cannot connect the speaker, try the following.
 - Start the app on the device and move the device slowly over the N marked part of the speaker.
 - If the device is in a case, remove the case.
 - Make sure that the app screen is displayed on the device.
- If you touch a device on the speaker, the device terminates the BLUETOOTH connection with the current device (NFC-compatible headset, etc.), and connects with the speaker (One-touch connection switching).
- When using the Speaker Add function, touch the speaker where the  (BLUETOOTH) indicator is lit. The device cannot make a BLUETOOTH connection with the speaker where the  (BLUETOOTH) indicator is turned off.

Note

- When an audio cable is connected to the speaker's AUDIO IN jack while the speaker and the BLUETOOTH device have been connected via BLUETOOTH connection, sound from the BLUETOOTH-connected device is not output from the speaker (the hands-free function is available). To listen to music from the BLUETOOTH device, disconnect the audio cable from the speaker's AUDIO IN jack.
- If your smartphone is a type that goes into standby mode in response to magnetic force, it may not be able to be connected by NFC.

Related Topic

- [Disconnecting the NFC-compatible device by One-touch \(NFC\)](#)
- [Switching devices by One-touch \(NFC\)](#)
- [Listening to music of a device via BLUETOOTH connection](#)
- [Listening to music wirelessly with two speakers \(Speaker Add function\)](#)

Personal Audio System
SRS-XB3



Disconnecting the NFC-compatible device by One-touch (NFC)

You can disconnect the speaker from the connected NFC-compatible device such as a smartphone or Walkman, etc. by touching the speaker with it.

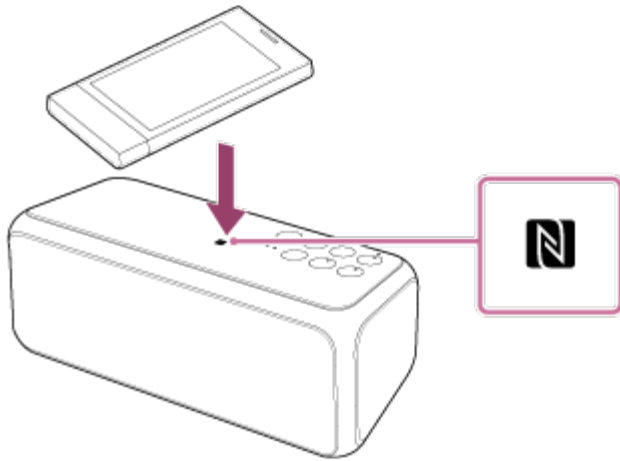
- 1 Touch the device on the N marked part of the speaker.



Hint



- After the speaker is disconnected from the device by One-touch, if no operation is performed and no sound is input for 15 minutes, the speaker turns off automatically by the auto power off function.
- If you cannot disconnect the speaker, try the following.
 - Start the app on the device, and move the device slowly over the N marked part of the speaker.
 - If the device is in a case, remove the case.
 - Make sure that the app screen is displayed on the device.
- When using the Speaker Add function, touch the speaker where the  (BLUETOOTH) indicator is lit. The device cannot be disconnected if touching the speaker where the  (BLUETOOTH) indicator is turned off.

Personal Audio System
SRS-XB3

Switching devices by One-touch (NFC)

- If you move an NFC-compatible device over the N marked part of the speaker while the speaker has been connected with the other BLUETOOTH device, the speaker disconnects from the BLUETOOTH device, then connects with the NFC-compatible device that was just touched. However, if you are talking on a BLUETOOTH mobile phone connected to the speaker, you cannot switch the BLUETOOTH connection by One-touch.
- When you touch an NFC-compatible device that has been connected with the speaker via the BLUETOOTH connection on another NFC-compatible BLUETOOTH headset or BLUETOOTH speaker, the NFC-compatible device disconnects from the speaker and connects with the BLUETOOTH device it just touched.
- If you cannot switch devices, try the following.
Start the app on the NFC-compatible device, and move the NFC-compatible device slowly over the N marked part of the speaker.
If the NFC-compatible device is in a case, remove the case.
Make sure that the app screen is displayed on the NFC-compatible device.

Hint

- When using the Speaker Add function, move the device over the N marked part of the speaker where the  (BLUETOOTH) indicator is lit. The speaker where the  (BLUETOOTH) indicator is turned off is not capable of making any BLUETOOTH connections.

Personal Audio System
SRS-XB3

Pairing and connecting with a computer (Windows 8)

The speaker can be paired with up to eight BLUETOOTH devices.
Before operating the speaker, be sure to do the following:

- Activate the BLUETOOTH wireless function* on your computer.
- Place the speaker within 1 m (3 ft) of the computer.
- Connect the speaker to the AC outlet or charge the battery sufficiently.
- Stop playback on the computer to avoid sudden loud sound output from the speaker.
- Prepare the operating instructions supplied with the computer device for reference.
- Set the computer speakers to ON mode. If the computer speakers are set to “Mute (OFF)” mode, sound will not be produced by the BLUETOOTH speakers.
 - Computer speakers in “Mute (OFF)” mode



- Computer speakers in ON mode



* If your computer does not have a BLUETOOTH wireless function, it will be necessary to connect a commercially available BLUETOOTH adaptor to the computer.

1 Prepare to search for the speaker on the computer.

1. Select [Desktop] from the Start menu.

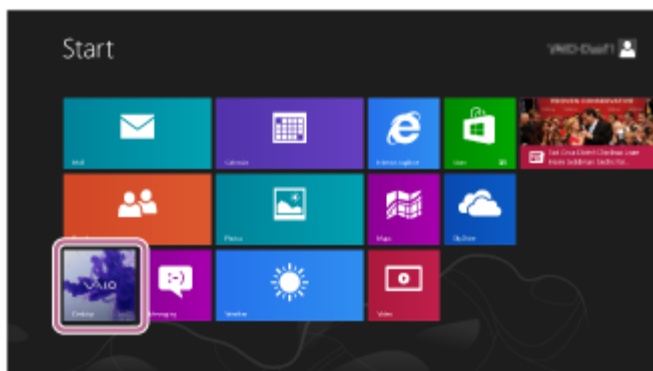

2. Align your mouse with the right side of the screen (if using a touch panel, swipe from the right edge of the screen), and select [Settings] from the charms that are displayed.



3. When the [Settings] charms are displayed, click [Control Panel].

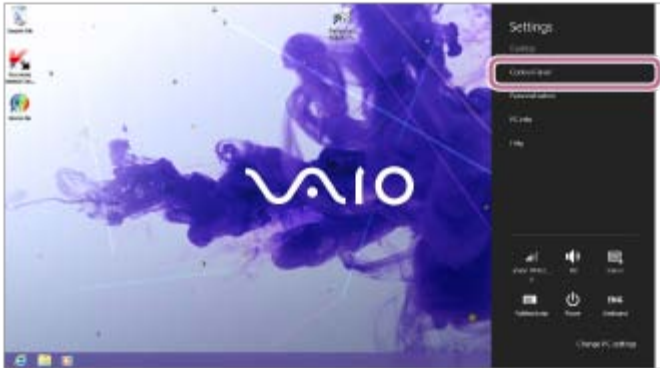

4. When [All Control Panel Items] is displayed, select [Devices and Printers].

If the [Control Panel] screen appears instead of [All Control Panel Items], select [Large icons] or [Small icons] from the [View by] menu in the top right corner of the screen.

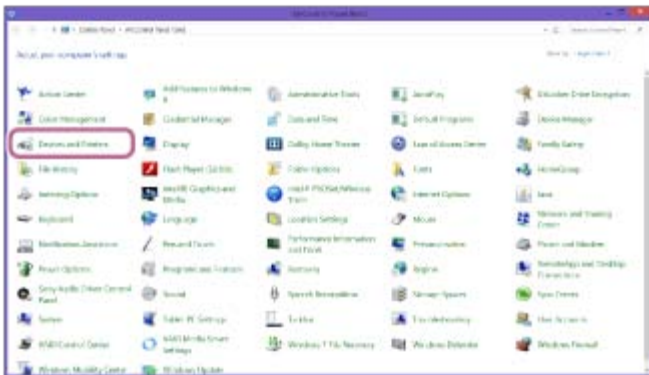

The following screen appears.

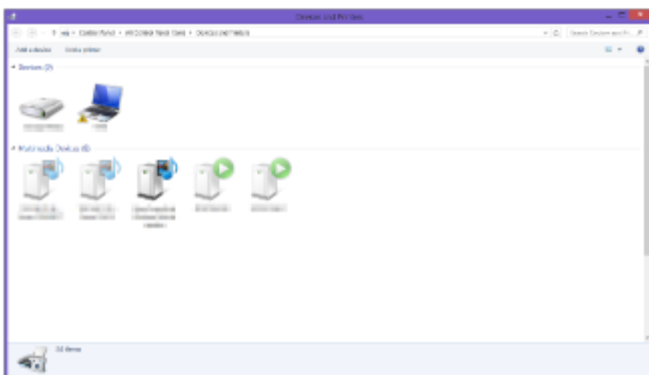



2 Turn on the speaker.

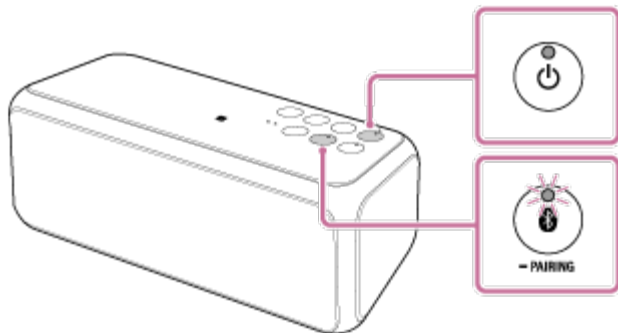

The  (power) indicator lights up green.

The  (BLUETOOTH) indicator begins to flash in white.



- When you turn on the speaker for the first time after purchase, the  (BLUETOOTH) indicator will begin to flash quickly in white and the speaker enters pairing mode automatically by just turning on the speaker. Proceed to step 3.
- When you turn on the speaker, the speaker tries to make a BLUETOOTH connection with the last connected BLUETOOTH device. If the device is nearby and its BLUETOOTH function is on, the BLUETOOTH connection is established automatically and the  (BLUETOOTH) indicator stays lit. When you want to connect another BLUETOOTH device, terminate the current BLUETOOTH connection by operating the currently connected BLUETOOTH device.

3 Initiate pairing mode on the speaker.

Press and hold the  (BLUETOOTH)  PAIRING button until you hear beeps and the  (BLUETOOTH) indicator begins to flash quickly in white.

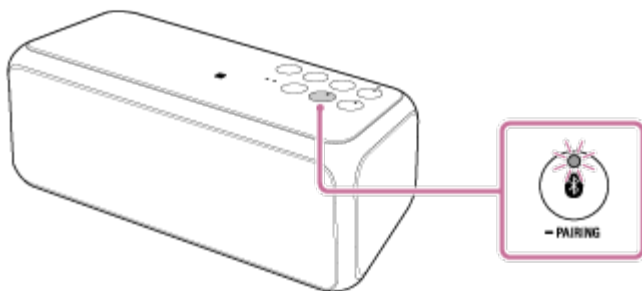

4 Perform the pairing procedure on the computer.

1. Click [Add a device].



2. Select [SRS-XB3] and click [Next].

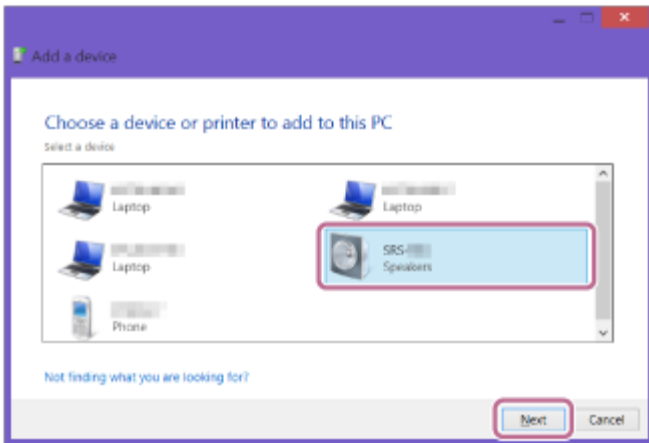

If a passkey* is required, enter "0000."

If [SRS-XB3] does not appear, perform the operation again from step 3.

* A passkey may be called "Passcode," "PIN code," "PIN number," or "Password."

3. When the following screen appears, click [Close].

The computer begins installing the driver.

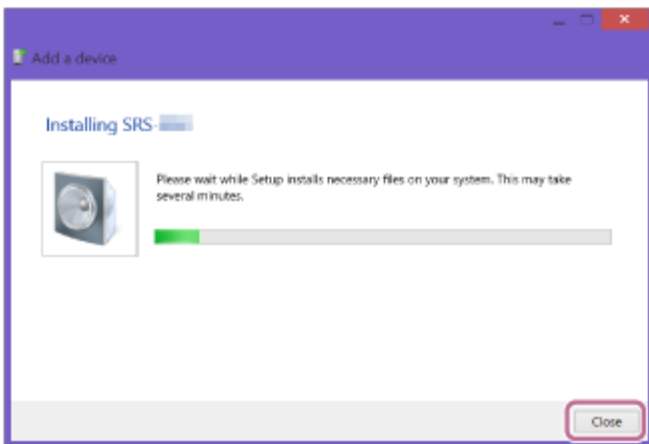

The "Ⓢ" mark will appear in the bottom left of the [SRS-XB3] icon during installation. When the "Ⓢ" mark disappears, driver installation is complete. Proceed to the next step (substep 4).



Depending on the computer, installation may take time. If driver installation takes too much time, the auto power off function of the speaker will cause it to turn off automatically. If this happens, turn the speaker on again.

4. Right-click on [SRS-XB3] in [Devices] and select [Sound settings] from the menu that appears.

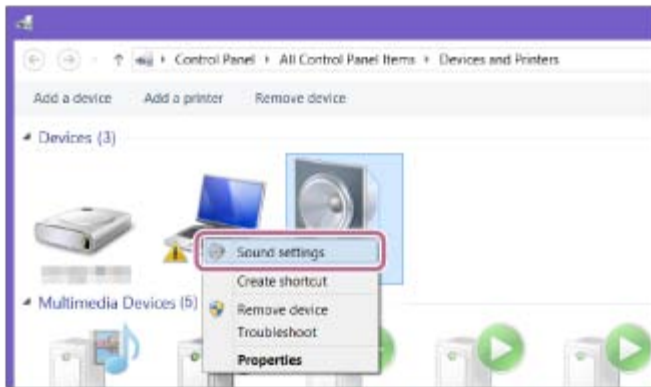

5. Confirm [SRS-XB3Stereo] on the [Sound] screen.
 - If there is a checkmark (green) on [SRS-XB3Stereo], proceed to step 5.



- If there is not a checkmark (green) on [SRS-XB3Stereo], proceed to the next step (substep 6).
- If [SRS-XB3Stereo] does not appear, right-click on the [Sound] screen, and select [Show Disabled Devices] from the menu that appears. Then proceed to the next step (substep 6).

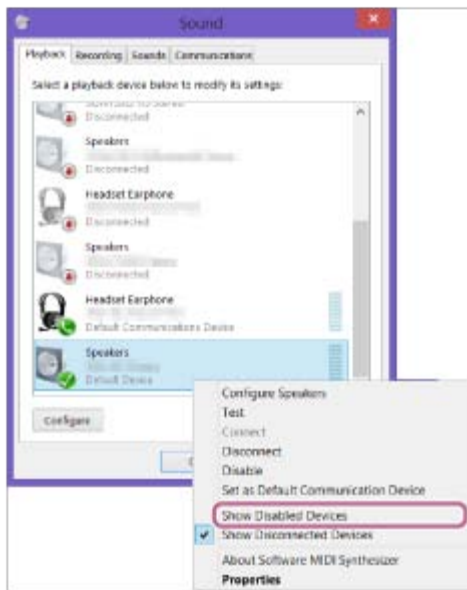

6. Right-click on [SRS-XB3Stereo], and select [Connect] from the menu that appears.

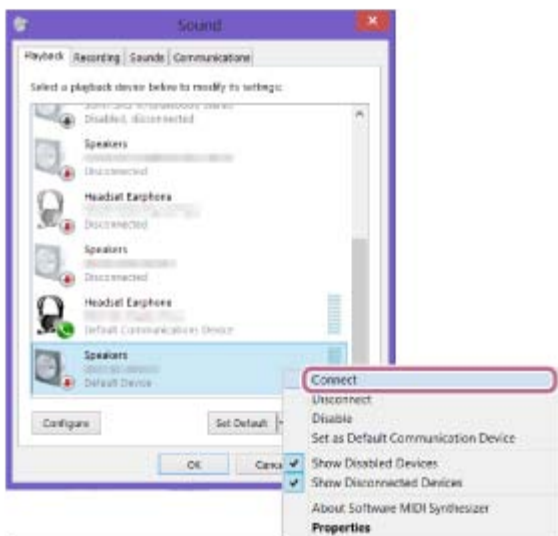

When the speaker is connected, a checkmark will appear on [SRS-XB3Stereo] on the [Sound] screen. Proceed to step 5.

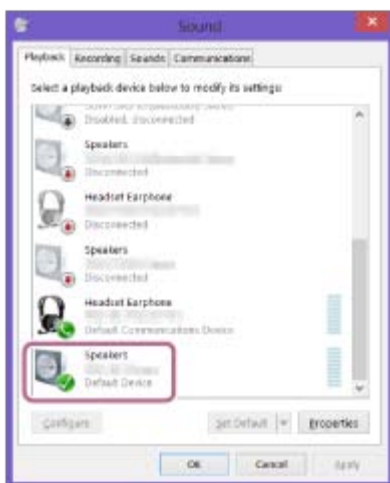



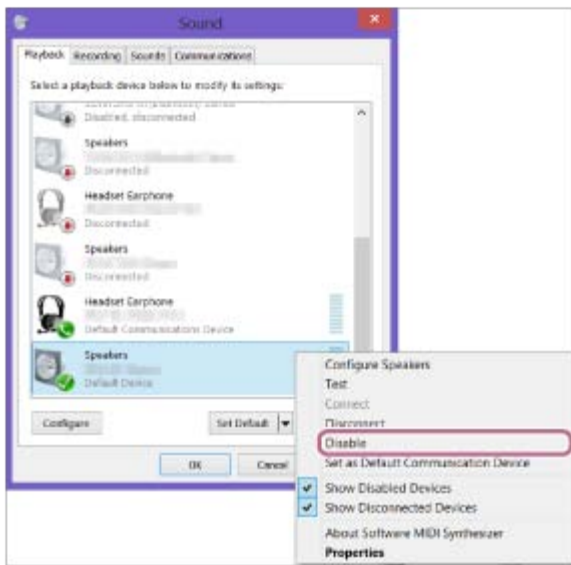

If you cannot click [Connect] for [SRS-XB3Stereo], select [Disable] for the [Default Device] that currently has a checkmark (green).

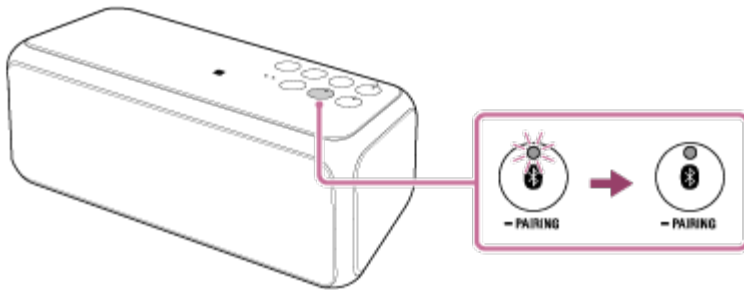

5 Check that the  (BLUETOOTH) indicator has switched from flashing to a steady light.

When the speaker is connected to the computer, the  (BLUETOOTH) indicator stays lit. You can enjoy playing back music from your computer.

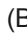

If a connection cannot be made, despite [SRS-XB3] appearing on the screen, initiate pairing mode on the speaker. Press and hold the  (BLUETOOTH)  PAIRING button until you hear beeps and the  (BLUETOOTH) indicator begins to flash quickly in white.

Hint

- For details on operating your computer, refer to the operating instructions supplied with the computer.

Note

- The pairing mode of the speaker is released after about 5 minutes and the  (BLUETOOTH) indicator flashes slowly. However, when pairing information is not stored in the speaker, such as at the factory settings, the pairing mode is not released. If the pairing mode is released before finishing the process, repeat from step 2.
- Once the BLUETOOTH devices are paired, there is no need to pair them again, except in the following cases:
 - Pairing information has been deleted after repair, etc.

The speaker is already paired with eight devices and another device is to be paired.

The speaker can be paired with up to eight devices. If a new device is paired after eight devices have already been paired, the paired device with the oldest connection time is replaced by the new one.

- When the pairing information of the speaker has been deleted from the BLUETOOTH device.
- When the speaker is initialized, all the pairing information is deleted.
- The speaker can be paired with multiple devices, but can only play music from one paired device at a time.
- When an audio cable is connected to the speaker's AUDIO IN jack while the speaker and the BLUETOOTH device have been connected via BLUETOOTH connection, sound from the BLUETOOTH-connected device is not output from the speaker (the hands-free function is available). To listen to music from the BLUETOOTH device, disconnect the audio cable from the speaker's AUDIO IN jack.

Related Topic

- [Connecting with a paired computer \(Windows 8\)](#)
- [How to make a wireless connection with BLUETOOTH devices](#)
- [Listening to music of a device via BLUETOOTH connection](#)

Personal Audio System
SRS-XB3

Pairing and connecting with a computer (Windows 7)

The speaker can be paired with up to eight BLUETOOTH devices.
Before operating the speaker, be sure to do the following:

- Activate the BLUETOOTH wireless function* on your computer.
- Place the speaker within 1 m (3 ft) of the computer.
- Connect the speaker to the AC outlet or charge the battery sufficiently.
- Stop playback on the computer to avoid sudden loud sound output from the speaker.
- Prepare the operating instructions supplied with the computer device for reference.
- Set the computer speakers to ON mode. If the computer speakers are set to “Mute (OFF)” mode, sound will not be produced by the BLUETOOTH speakers.
 - Computer speakers in “Mute (OFF)” mode



- Computer speakers in ON mode



* If your computer does not have a BLUETOOTH wireless function, it will be necessary to connect a commercially available BLUETOOTH adaptor to the computer.

1 Turn on the speaker.

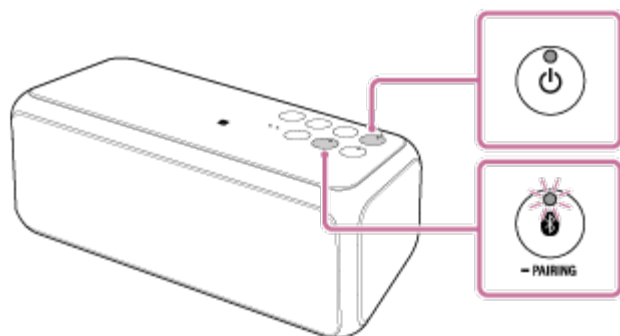

The ⏻ (power) indicator lights up green.

The 📶 (BLUETOOTH) indicator begins to flash in white.



- When you turn on the speaker for the first time after purchase, the 📶 (BLUETOOTH) indicator will begin to flash quickly in white and the speaker enters pairing mode automatically by just turning on the speaker. Proceed to step 3.
- When you turn on the speaker, the speaker tries to make a BLUETOOTH connection with the last connected BLUETOOTH device. If the device is nearby and its BLUETOOTH function is on, the BLUETOOTH connection is established automatically and the 📶 (BLUETOOTH) indicator stays lit. When you want to connect another BLUETOOTH device, terminate the current BLUETOOTH connection by operating the currently connected BLUETOOTH device.

2 Initiate pairing mode on the speaker.

Press and hold the  (BLUETOOTH)  PAIRING button until you hear beeps and the  (BLUETOOTH) indicator begins to flash quickly in white.

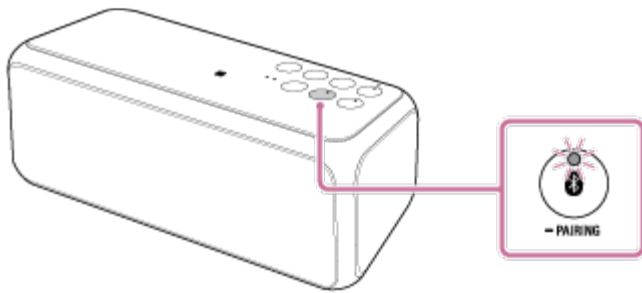

3 Perform the pairing procedure on the computer.

1. Click the [Start] button and then [Devices and Printers].
2. Click [Add a device].



3. Select [SRS-XB3] and click [Next].

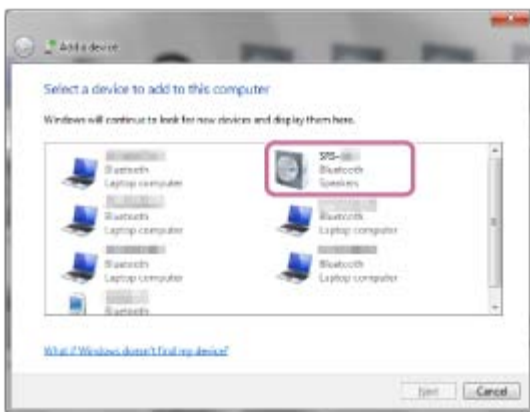

If a passkey* is required on the display of the BLUETOOTH device, enter "0000."

If [SRS-XB3] does not appear on the screen, repeat the procedure from step 2.

* A passkey may be called "Passcode", "PIN code", "PIN number" or "Password."

4. When the following screen appears, click [Close].

The computer begins installing the driver.



The “Ⓢ” mark will appear in the bottom left of the [SRS-XB3] icon during installation. When the “Ⓢ” mark disappears, driver installation is complete. Proceed to the next step (substep 5).



Depending on the computer, installation may take time. If driver installation takes too much time, the auto power off function of the speaker will cause it to turn off automatically. If this happens, turn the speaker on again.

5. Double-click on [SRS-XB3] in [Devices].



6. Click [Listen to Music].

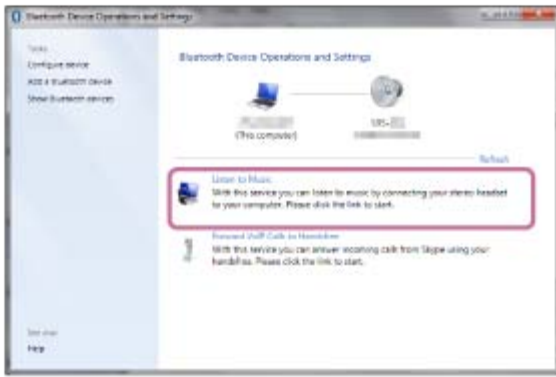

When the speaker is connected, a checkmark will appear.

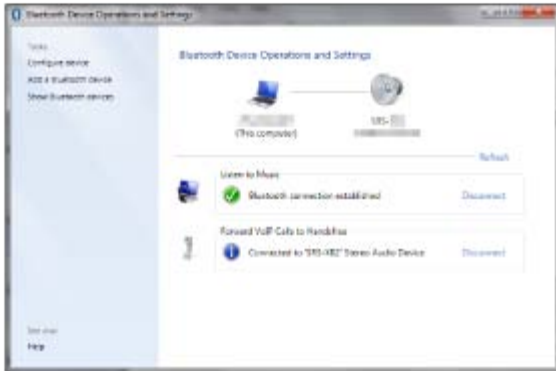

4 Check that the  (BLUETOOTH) indicator has switched from flashing to a steady light.

When the speaker is connected to the computer, the  (BLUETOOTH) indicator stays lit. You can enjoy playing back music from your computer.

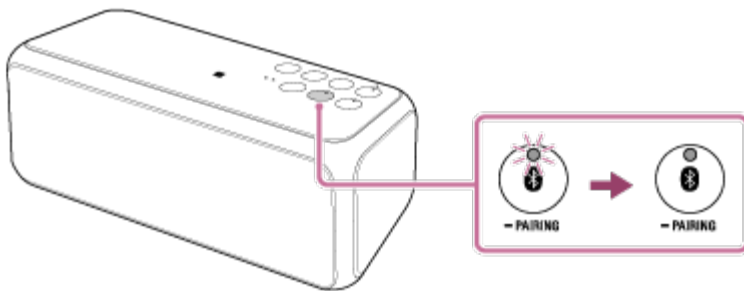

Hint

- For details on operating your computer, refer to the operating instructions supplied with the computer.

Note

-

The pairing mode of the speaker is released after about 5 minutes and the  (BLUETOOTH) indicator flashes slowly. However, when pairing information is not stored in the speaker, such as at the factory settings, the pairing mode is not released. If the pairing mode is released before finishing the process, repeat from step 2.

- Once the BLUETOOTH devices are paired, there is no need to pair them again, except in the following cases:
 - Pairing information has been deleted after repair, etc.
 - The speaker is already paired with eight devices and another device is to be paired.

The speaker can be paired with up to eight devices. If a new device is paired after eight devices have already been paired, the paired device with the oldest connection time is replaced by the new one.

- When the pairing information of the speaker has been deleted from the BLUETOOTH device.
- When the speaker is initialized, all the pairing information is deleted.
- The speaker can be paired with multiple devices, but can only play music from one paired device at a time.
- When an audio cable is connected to the speaker's AUDIO IN jack while the speaker and the BLUETOOTH device have been connected via BLUETOOTH connection, sound from the BLUETOOTH-connected device is not output from the speaker (the hands-free function is available). To listen to music from the BLUETOOTH device, disconnect the audio cable from the speaker's AUDIO IN jack.

Related Topic

- [Connecting with a paired computer \(Windows 7\)](#)
- [How to make a wireless connection with BLUETOOTH devices](#)
- [Listening to music of a device via BLUETOOTH connection](#)

Personal Audio System
SRS-XB3

Connecting with a paired computer (Windows 8)

Before operating the speaker, be sure to do the following:

- Depending on your computer, it may be necessary to turn on the built-in BLUETOOTH adaptor. For details on how to turn on a built-in BLUETOOTH adaptor, refer to the instructions manual that came with your computer.
- If the speaker was previously paired with a different device, turn off the BLUETOOTH function for the other device.

1 Turn on the speaker.

The  (power) indicator lights up in green.

The  (BLUETOOTH) indicator begins to flash in white.

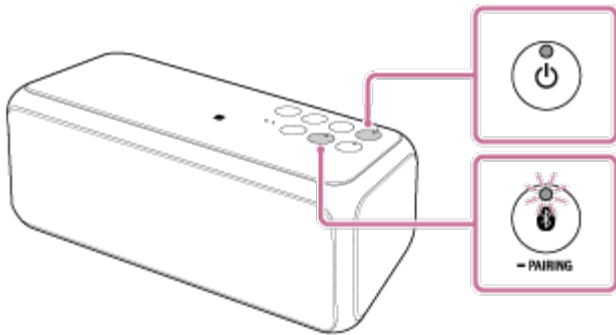

When you turn on the speaker, the speaker tries to make a BLUETOOTH connection with the last connected BLUETOOTH device. If the device is nearby and its BLUETOOTH function is on, the BLUETOOTH connection is established automatically and the  (BLUETOOTH) indicator stays lit. When you want to connect another BLUETOOTH device, terminate the current BLUETOOTH connection by operating the currently connected BLUETOOTH device.

2 Make the BLUETOOTH connection from the computer.

1. Select [Desktop] from the Start menu.

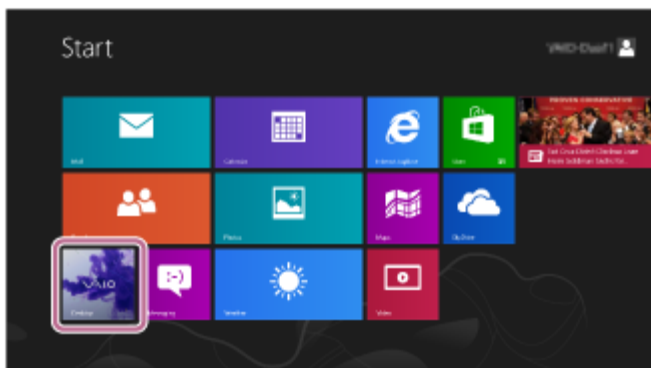

- Align your mouse with the right side of the screen (if using a touch panel, swipe from the right edge of the screen), and select [Settings] from the charms that are displayed.



- When the [Settings] charms are displayed, click [Control Panel].

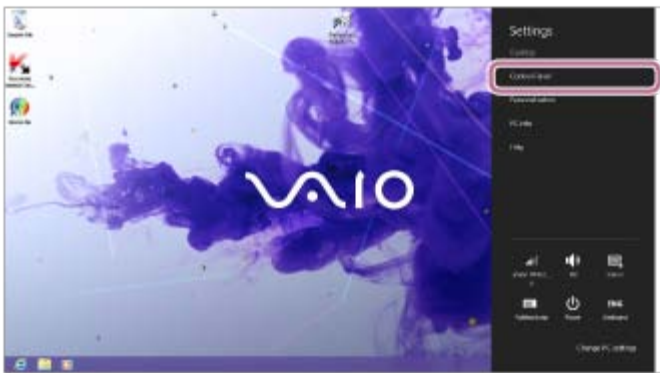

- When [All Control Panel Items] is displayed, select [Sound].

If the [Control Panel] screen appears instead of [All Control Panel Items], select [Large icons] or [Small icons] from the [View by] menu in the top right corner of the screen.

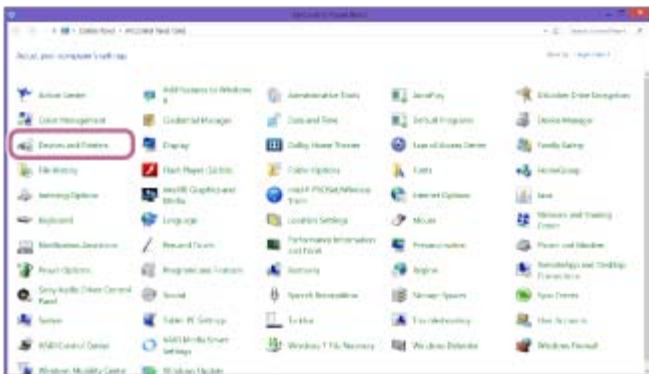

- Confirm [SRS-XB3 Stereo] on the [Sound] screen.
 - If there is a checkmark (green) on [SRS-XB3 Stereo], proceed to step 3.



- If there is not a checkmark (green) on [SRS-XB3 Stereo], proceed to the next step (substep 6).
- If [SRS-XB3 Stereo] does not appear, right-click on the [Sound] screen, and select [Show Disabled Devices] from the menu that appears. Then proceed to the next step (substep 6).

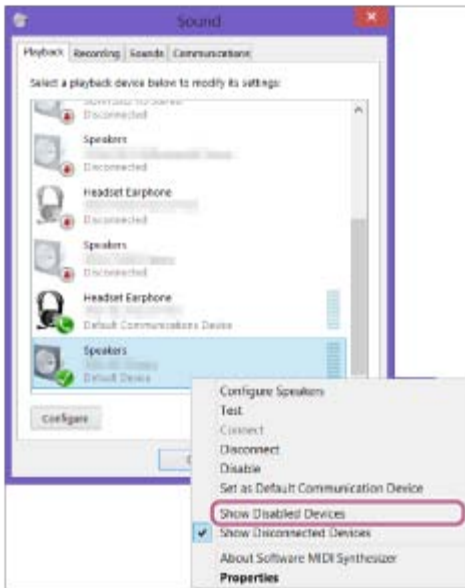

6. Right-click on [SRS-XB3 Stereo], and select [Connect] from the menu that appears.

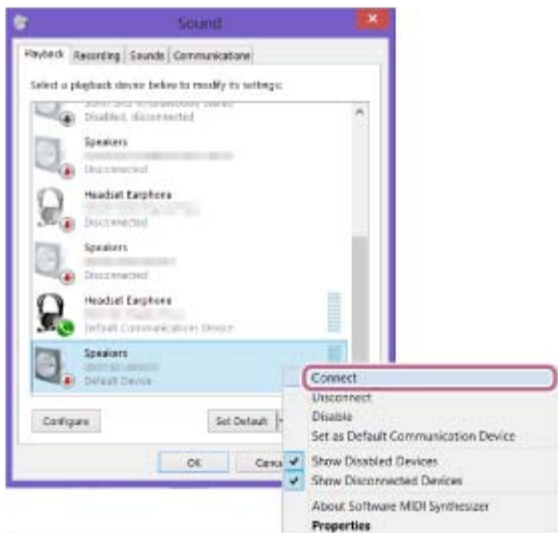



When the speaker is connected, a checkmark will appear on [SRS-XB3 Stereo] on the [Sound] screen. Proceed to step

3.

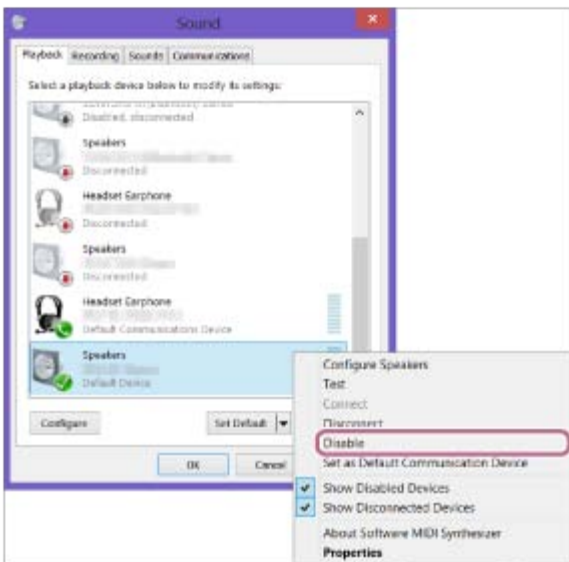

If you cannot click [Connect] for [SRS-XB3 Stereo], select [Disable] for the [Default Device] that currently has a checkmark (green).



3 Check that the  (BLUETOOTH) indicator has switched from flashing to a steady light.

When the speaker is connected to the computer, the  (BLUETOOTH) indicator stays lit. You can enjoy playing back music from your computer.

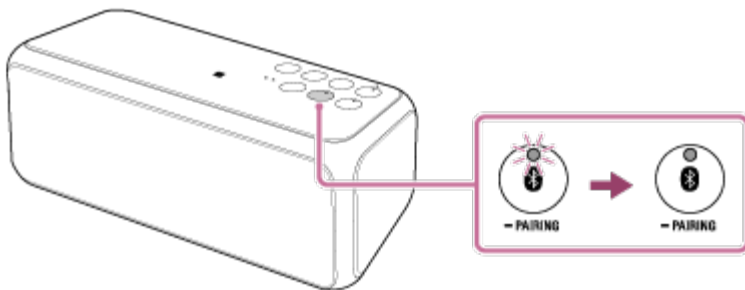

Hint

- The operation above is an example. For more details, refer to the instructions manual for your computer.
- When the BLUETOOTH standby function is turned on, the speaker turns on automatically by operating a BLUETOOTH device, and starts the BLUETOOTH connection.

Note

- When the speaker made a connection automatically with the last connected BLUETOOTH device, the BLUETOOTH function may not work properly. In this case, terminate the BLUETOOTH connection by operating the connected BLUETOOTH device and reestablish a connection.
- When an audio cable is connected to the speaker's AUDIO IN jack while the speaker and the BLUETOOTH device have been connected via a BLUETOOTH connection, sound from the BLUETOOTH-connected device is not output from the speaker (the hands-free function is available). To listen to music from the BLUETOOTH device, disconnect the audio cable from the speaker's AUDIO IN jack.

Related Topic

- [How to make a wireless connection with BLUETOOTH devices](#)
- [Pairing and connecting with a computer \(Windows 8\)](#)
- [Listening to music of a device via BLUETOOTH connection](#)
- [Terminating the BLUETOOTH connection \(After use\)](#)
- [Using the BLUETOOTH standby function](#)

Personal Audio System
SRS-XB3

Connecting with a paired computer (Windows 7)

Before operating the speaker, be sure to do the following:

- Depending on your computer, it may be necessary to turn on the built-in BLUETOOTH adaptor. For details on how to turn on a built-in BLUETOOTH adaptor, refer to the instructions manual that came with your computer.
- If the speaker was previously paired with a different device, turn off the BLUETOOTH function for the other device.

1 Turn on the speaker.

The  (power) indicator lights up in green.

The  (BLUETOOTH) indicator begins to flash in white.

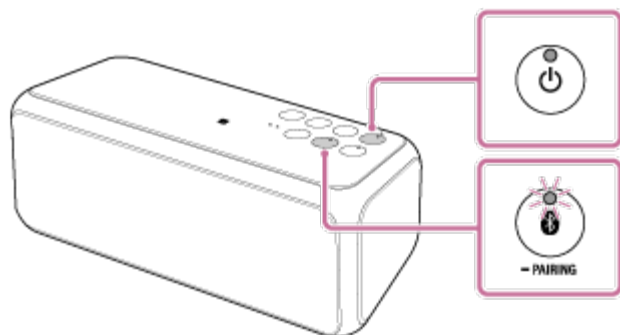

When you turn on the speaker, the speaker tries to make a BLUETOOTH connection with the last connected BLUETOOTH device. If the device is nearby and its BLUETOOTH function is on, the BLUETOOTH connection is established automatically and the  (BLUETOOTH) indicator stays lit. When you want to connect another BLUETOOTH device, terminate the current BLUETOOTH connection by operating the currently connected BLUETOOTH device.

2 Make the BLUETOOTH connection from the computer.

1. Click the [Start] button and then [Devices and Printers].
2. Double-click [SRS-XB3].



3. Confirm [Listen to Music].

- If [Listen to Music] appears: Proceed to the next step.
- If [Connecting to Bluetooth service] occurs automatically and a checkmark appears: The connection is complete. Check that the  (BLUETOOTH) indicator on the speaker is lit up in white.

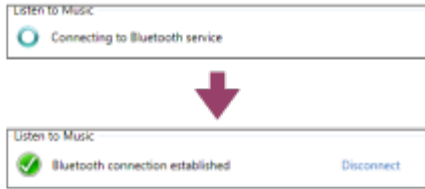

- If “Searching services,” leads to an error: The speaker is connected to a different nearby BLUETOOTH device. Disconnect by operating the connected device, and then repeat the operation from the previous step (substep 2).



4. Click [Listen to Music].

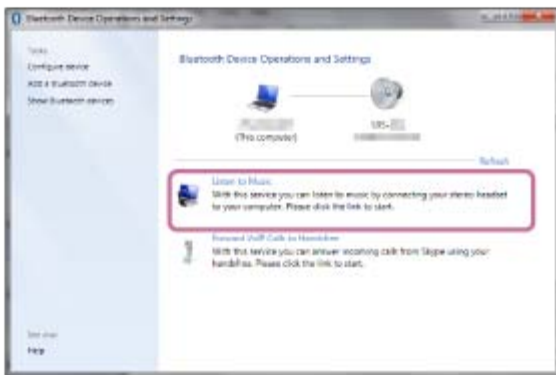

A check mark appears when the connection has been made.

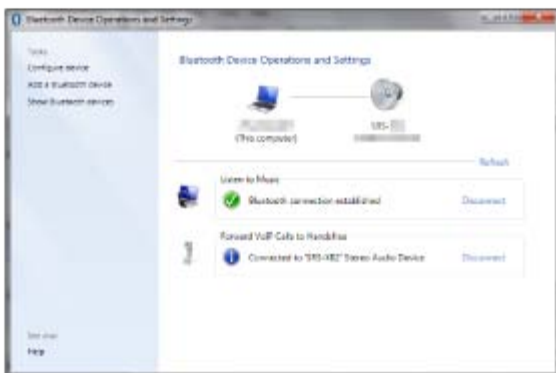

3 Check that the  (BLUETOOTH) indicator has switched from flashing to a steady light.

When the speaker is connected to the computer, the  (BLUETOOTH) indicator stays lit. You can enjoy playing back music from your computer.

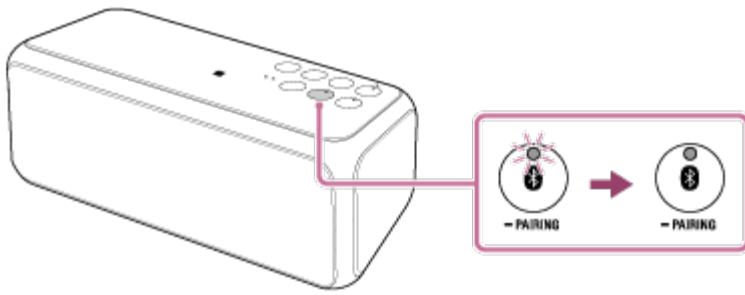

Hint

- The operation above is an example. For more details, refer to the instructions manual for your computer.
- When the BLUETOOTH standby function is turned on, the speaker turns on automatically by operating a BLUETOOTH device, and starts the BLUETOOTH connection.

Note

- When the speaker made a connection automatically with the last connected BLUETOOTH device, the BLUETOOTH function may not work properly. In this case, terminate the BLUETOOTH connection by operating the connected BLUETOOTH device and reestablish a connection.
- When an audio cable is connected to the speaker's AUDIO IN jack while the speaker and the BLUETOOTH device have been connected via a BLUETOOTH connection, sound from the BLUETOOTH-connected device is not output from the speaker (the hands-free function is available). To listen to music from the BLUETOOTH device, disconnect the audio cable from the speaker's AUDIO IN jack.

Related Topic

- [How to make a wireless connection with BLUETOOTH devices](#)
- [Pairing and connecting with a computer \(Windows 7\)](#)
- [Listening to music of a device via BLUETOOTH connection](#)
- [Terminating the BLUETOOTH connection \(After use\)](#)
- [Using the BLUETOOTH standby function](#)

Related Topic

- [Listening to music of a portable audio device, etc.](#)
- [Auto power off function](#)

4-587-623-11(2) Copyright 2016 Sony Corporation

Personal Audio System
SRS-XB3

Listening to music of a device via BLUETOOTH connection

You can enjoy listening to music of a BLUETOOTH device and operate it by the speaker via BLUETOOTH connection if it supports the following BLUETOOTH profiles.

- A2DP (Advanced Audio Distribution Profile)
Enables you to enjoy high-quality audio contents wirelessly.
- AVRCP (Audio Video Remote Control Profile)
Enables you to adjust the volume of a BLUETOOTH device.

Operations may vary depending on the BLUETOOTH device. Refer also to the operating instructions supplied with your BLUETOOTH device.

Note

- Make sure beforehand that the volume on a BLUETOOTH device is set to a moderate level to avoid sudden loud sound output from the speaker.

- 1 Connect the speaker with the BLUETOOTH device.

The  (BLUETOOTH) indicator lights up in white when the BLUETOOTH connection is established.

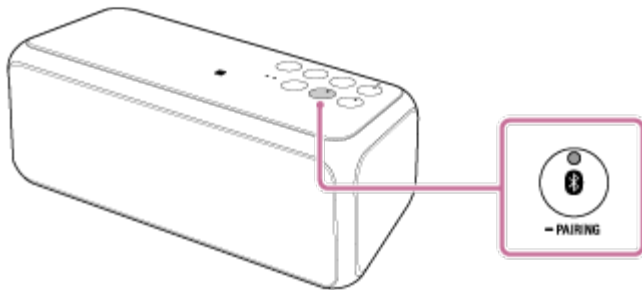

- 2 Start playback on the BLUETOOTH device.

- 3 Adjust the volume by pressing the -/+ (volume) buttons on the speaker or operating the BLUETOOTH device.

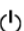
When you press the -/+ (volume) buttons on the speaker or adjust the volume on the BLUETOOTH device, the  (power) indicator flashes once in green.

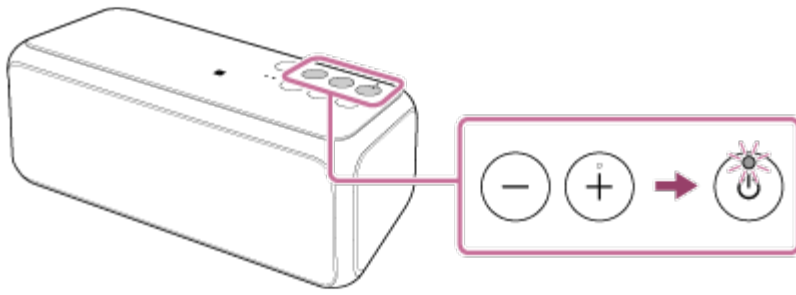

Hint

- Depending on the BLUETOOTH device, it may be necessary to adjust the volume or set the audio output setting on the connected device.
- When you set the volume to the maximum or minimum, the  (power) indicator flashes three times.
- Depending on the BLUETOOTH device, you may not be able to adjust the volume of the speaker by the connected device.

Note

- If the communication condition is poor, the BLUETOOTH device may react incorrectly against the operations on the speaker.
- When you connect a portable audio device, etc., to the speaker's AUDIO IN jack while listening to music via BLUETOOTH connection, the speaker switches to the AUDIO IN mode automatically. In this case, music of the BLUETOOTH device is not output (if the BLUETOOTH connection is active, the hands-free function is available). To listen to music from the BLUETOOTH device again, disconnect the audio cable from the speaker's AUDIO IN jack.

Related Topic

- [How to make a wireless connection with BLUETOOTH devices](#)
- [Terminating the BLUETOOTH connection \(After use\)](#)

Personal Audio System
SRS-XB3

Selecting the wireless playback quality of the speaker

The "Priority on sound quality" and "Priority on stable connection" modes are available as options for selecting the wireless playback quality of the speaker. "Priority on sound quality" enables you to playback, not only SBC, but also AAC and LDAC so that you can enjoy high quality sound via BLUETOOTH, whereas "Priority on stable connection" provides you more stable wireless playback. "Priority on sound quality" is the default setting.

Supported Codecs

- Priority on sound quality: AAC or LDAC, SBC (Default setting)
- Priority on stable connection: SBC

1 Connect the speaker to an AC outlet via AC adaptor (supplied).

Note

- Do not turn on the speaker.

2 While holding the + (volume) button, press the ⏻ (power) button until the 🔊 (BLUETOOTH) indicator flashes white.

When the setting is changed to the "Priority on stable connection" mode, the 🔊 (BLUETOOTH) indicator flashes three times in white.

When the setting is changed to the "Priority on sound quality" mode, the 🔊 (BLUETOOTH) indicator flashes twice in white.

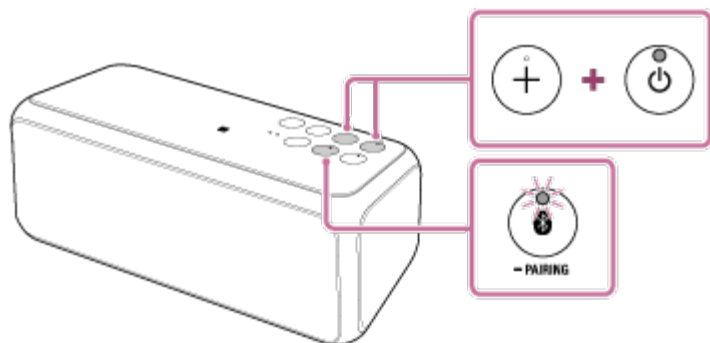

Note

- Communication may become unstable in the "Priority on sound quality" mode, depending on the setting of your BLUETOOTH device and ambient

conditions. In this case, change the speaker to the “Priority on stable connection” mode by performing steps 1 and 2 above.

Related Topic

- [Using the BLUETOOTH standby function](#)
- [What is LDAC?](#)



4-587-623-11(2) Copyright 2016 Sony Corporation

Personal Audio System
SRS-XB3

Terminating the BLUETOOTH connection (After use)

When you finish playing music with the BLUETOOTH device, perform any of the following operations to terminate the BLUETOOTH connection.

- Turn off the BLUETOOTH function on the BLUETOOTH device. For details, refer to the operating instructions supplied with the device.
- Turn off the BLUETOOTH device.
- Turn off the speaker.
- Touch the NFC-compatible device on the speaker again (if your device has the NFC function).

When using the Speaker Add function, touch the NFC-compatible device on the speaker where the  (BLUETOOTH) indicator is lit. A speaker where the  (BLUETOOTH) indicator is turned off is not capable of terminating the BLUETOOTH connection.

Hint

- The speaker turns off automatically by the auto power off function when the speaker satisfies the following conditions for 15 minutes, and the BLUETOOTH connection is terminated.
 - No operation on the speaker.
 - No BLUETOOTH connection has been established between the speaker and a smartphone or mobile via HFP/HSP.
HFP and HSP are types of BLUETOOTH profiles.
HSP (Headset Profile): Allows calling/cellular phone operation.
HFP (Hands-Free Profile): Allows hands-free calling/cellular phone operation.
 - No music (sound) is played when the speaker is connected to a BLUETOOTH device.
- When using the Speaker Add function, if you turn off one speaker, the other speaker is automatically turned off. The BLUETOOTH connection between them is disconnected.
- When you finish playing music, the BLUETOOTH connection may terminate automatically depending on the BLUETOOTH device.
- To disconnect the smartphone by One-touch (NFC), the app may need to be running on the smartphone depending on the smartphone.

Related Topic

- [Turning the power off](#)
- [Auto power off function](#)
- [Disconnecting the NFC-compatible device by One-touch \(NFC\)](#)

Personal Audio System
SRS-XB3

Listening to music wirelessly with two speakers (Speaker Add function)

By connecting two SRS-XB3 speakers via BLUETOOTH, you can select audio reproduction between stereo mode (stereo sound) and double mode (monaural sound). To use this function, two SRS-XB3 speakers are required. Select from the following two playback methods.

Double mode

Both speakers play the same sound. Double mode is the initial setting.

Stereo mode

One speaker plays the sound on the right channel (right side), while the other speaker plays the sound on the left channel (left side) for stereo playback between the speakers.

Note

- Turn off both speakers before setting up the Speaker Add function.

1 Set up the first speaker.



1. Press the  (power) button on one of the speakers to turn it on.

The  (power) indicator lights up in green.

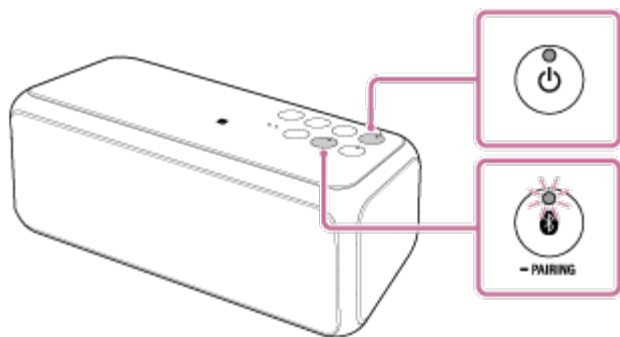
The  (BLUETOOTH) indicator begins to flash in white.



2. Press and hold the ADD button until the speaker releases a sound.

The  (BLUETOOTH) and L/R indicators flash in white. A beep will then be heard when the L/R indicators light up while the  (BLUETOOTH) indicator keeps flashing.

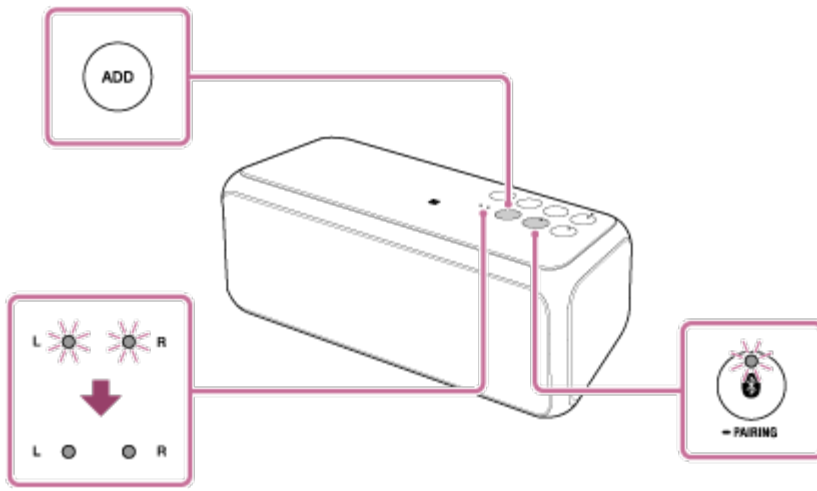

2 Set up the second speaker.

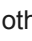

1. Press the  (power) button on the other speaker to turn it on.

The  (power) indicator lights up in green.

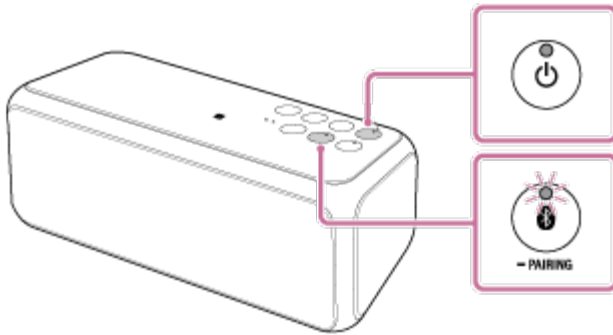
The  (BLUETOOTH) indicator of the speaker begins to flash in white.



2. Press and hold the ADD button until the speaker releases a sound.

The  (BLUETOOTH) and L/R indicators flash in white. The L/R indicators then light up while the  (BLUETOOTH) indicator turns off.

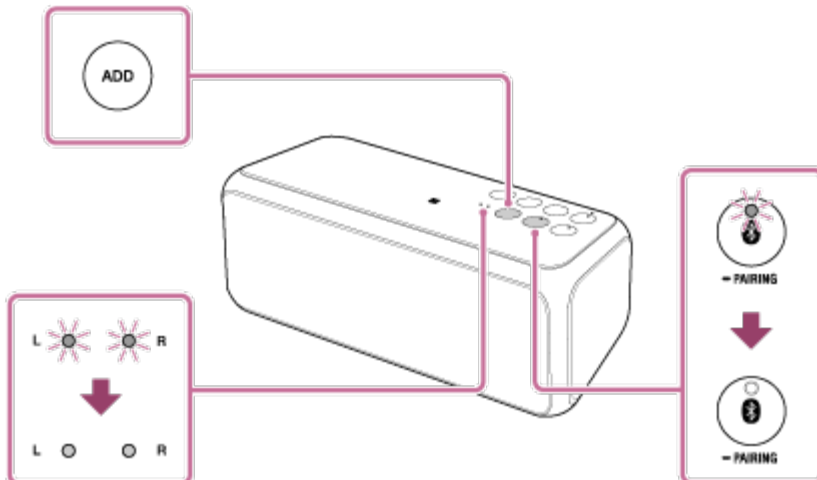

Hint

- If the two speakers quickly make a BLUETOOTH connection, the L/R indicators may light up without the  (BLUETOOTH) indicator and the L/R indicators flashing.
- Set up the second speaker within one minute. If you do not set it up within one minute, the setting of the first speaker will be canceled.

- 3 Operate the speaker where the  (BLUETOOTH) indicator is flashing to make a BLUETOOTH connection with a BLUETOOTH device.

When the  (BLUETOOTH) indicator of the speaker stops flashing and lights up, the BLUETOOTH connection is established.

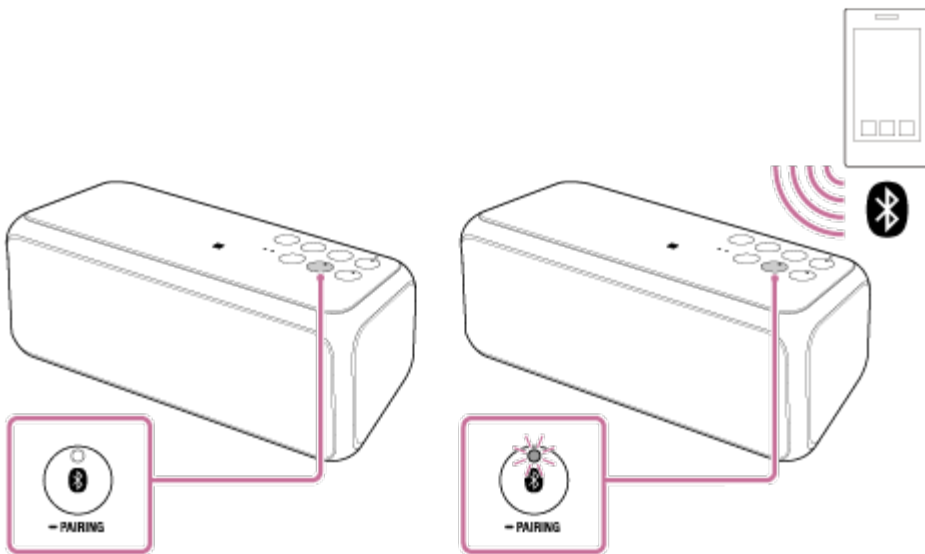

- 4 Start playback on the BLUETOOTH device, and adjust the volume to moderate level.

- 5 Press the $-/+$ (volume) buttons on one of the speakers to adjust the volume.

Volume adjustment of one speaker is reflected on the other.



Hint

- When making or receiving a call, only operate the speaker where the  (BLUETOOTH) indicator is lit.
- If a portable audio device, etc. is connected to the AUDIO IN jack, the speaker automatically switches to AUDIO IN mode, and the Speaker Add function is terminated.
- If any other BLUETOOTH device(s), such as a BLUETOOTH mouse or BLUETOOTH keyboard, is connected to the BLUETOOTH device that is connecting with the speaker, there may be distorted sound or noise in the speaker output. In this case, terminate the BLUETOOTH connection

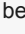
between the BLUETOOTH device and other BLUETOOTH device(s).

- To terminate the Speaker Add function while in use, press and hold the ADD button until a beep is heard.
- When the speaker, that had been used as the Speaker Add function the last time, is turned on, the speaker will try to establish the Speaker Add function with the other speaker that had been connected. If you want to use two SRS-XB3 speakers as the Speaker Add function again, turn the other speaker on within a minute, otherwise the speaker will terminate the automatic connection as the Speaker Add function.
- If you want to use the speaker that had been used as one of the speakers of the Speaker Add function by itself, press the  (power) button to turn on the speaker, then press and hold the ADD button until a beep is heard to terminate the Speaker Add function since the speaker tries to establish the last-made connection.
- When using the Speaker Add function, switch the codec to SBC.

Note

- If you reset or initialize one of the two speakers while using the Speaker Add function, make sure to turn off the other speaker. If you do not turn off the other speaker before restarting the Speaker Add function, there may be problems in making a BLUETOOTH connection and outputting sound.
- When you make a BLUETOOTH connection by One-touch (NFC), touch the speaker where the  (BLUETOOTH) indicator is lit. The device cannot make a BLUETOOTH connection with the speaker where the  (BLUETOOTH) indicator is turned off.

Related Topic

- [Switching between double mode and stereo mode \(Speaker Add function\)](#)

Personal Audio System
SRS-XB3

Switching between double mode and stereo mode (Speaker Add function)

Using two speakers, you can switch between monaural playback (double mode) and stereo playback (stereo mode).

- 1 Press the ADD button on either of the speakers to change the audio reproduction.

Each time you press the ADD button, the mode changes.

The L/R indicators on both speakers show the status of audio reproduction.

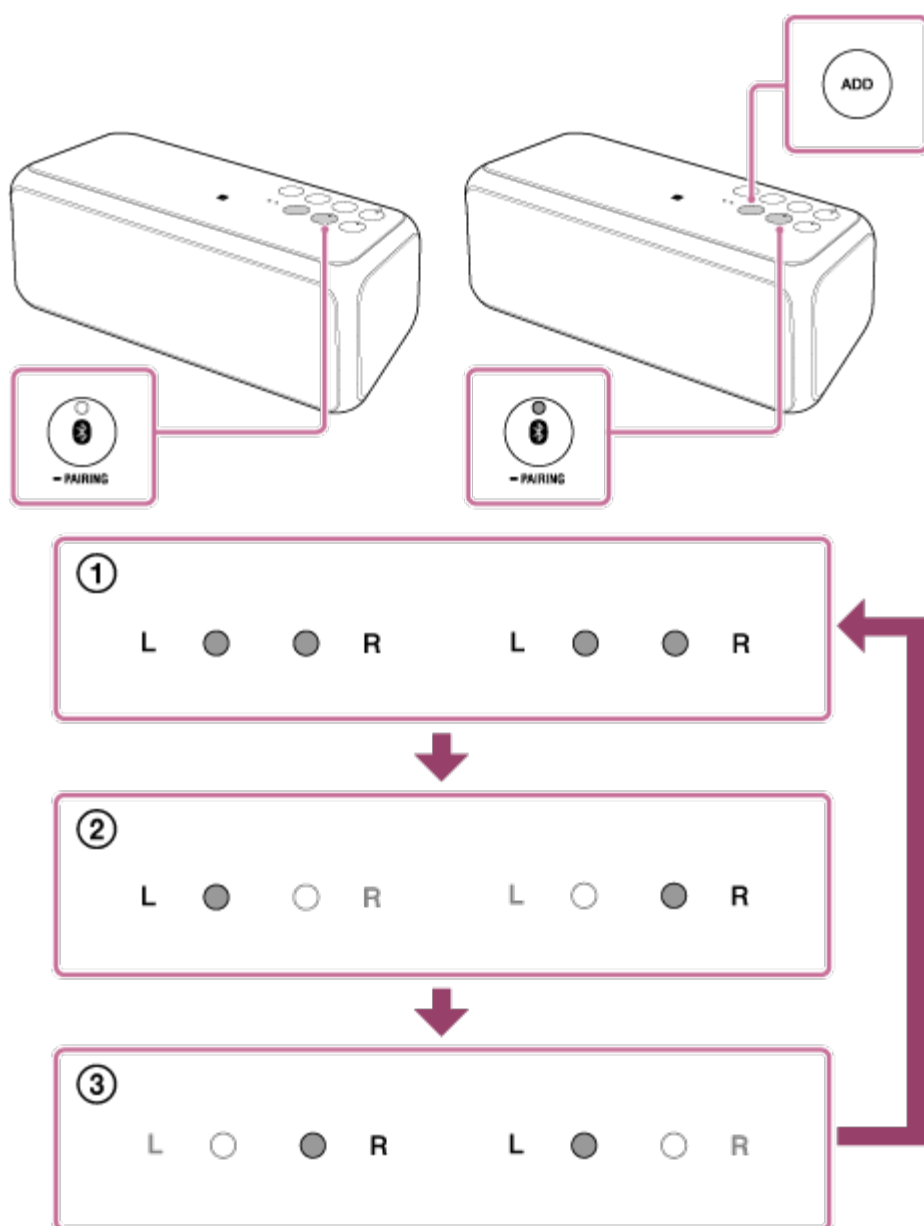

- ① Double mode: The L/R indicators on both speakers are lit up in white.

- ② Stereo mode (L ch/R ch): The L indicator on one speaker and the R indicator on the other speaker are lit up in white.
- ③ Stereo mode (R ch/L ch): The L indicator turns off, and the R indicator lights up in white on one speaker. On the other speaker, the R indicator turns off and the L indicator lights up in white.

Related Topic

- [Listening to music wirelessly with two speakers \(Speaker Add function\)](#)

Personal Audio System
SRS-XB3

Listening to music of a portable audio device, etc.

You can use the speaker as an ordinary wired speaker system by connecting a portable audio device, etc., using an audio cable (not supplied).

- 1 Connect the speaker to the device using an audio cable.

For connection, use the cable that has a stereo mini plug at both ends.

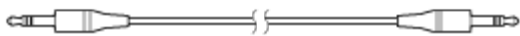

- 2 Turn on the speaker.

The  (power) indicator lights up in green.

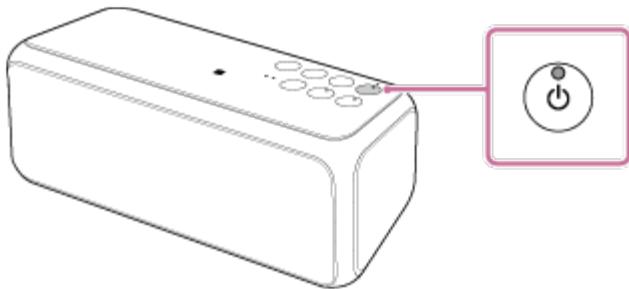

- 3 Turn on the connected device.

- 4 Start playback on the connected device and adjust the volume to a moderate level.

- 5 Press the $-/+$ (volume) buttons to adjust the volume.

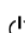
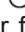
When you press the $-/+$ (volume) buttons, the  (power) indicator flashes once in green. When you set the volume to the maximum or minimum, the  (power) indicator flashes three times.

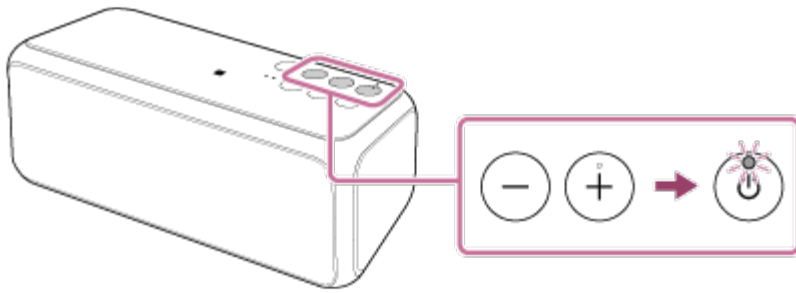

Hint

- The speaker turns off automatically by the auto power off function when the speaker satisfies the following conditions for 15 minutes, and the BLUETOOTH connection is terminated.
 - No operation on the speaker.
 - No BLUETOOTH connection has been established between the speaker and a smartphone or mobile via HFP/ HSP.
HFP and HSP are types of BLUETOOTH profiles.
HSP (Headset Profile): Allows calling/cellular phone operation.
HFP (Hands-Free Profile): Allows hands-free calling/cellular phone operation.
 - No music (sound) is played when the speaker is connected to a BLUETOOTH device.

Note

- If you connect an audio cable to the AUDIO IN jack, the output from the device connected to the AUDIO IN jack has priority, and you will not hear the sound from the BLUETOOTH device. The  (BLUETOOTH) indicator lights up or flashes in white to indicate the BLUETOOTH status. Absence of sound from the BLUETOOTH device does not indicate any trouble with the speaker.
- If the BLUETOOTH connection is active, you can use the hands-free function while listening to music of a portable audio device, etc. that is connected to the speaker's AUDIO IN jack.

Related Topic

- [Connecting to a portable audio device, etc.](#)

Personal Audio System
SRS-XB3

Enjoying EXTRA BASS

You can boost the low tones with the EXTRA BASS button.

1 Press the EXTRA BASS button.

The EXTRA BASS indicator turns on, and bass is boosted. Press the EXTRA BASS button again to turn off the setting.

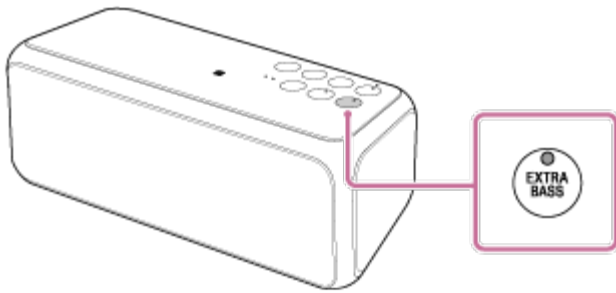

About the EXTRA BASS indicator

Lights up

You can enjoy boosted bass (Sony-recommended sound quality). This mode is set as the default setting.

Turns off

You can enjoy the natural sound quality with reduced bass. This mode is recommended when listening at low volume inside a room.

Hint

- The current bass setting is retained when the speaker is turned off.

Note

- Depending on the music, the boosted bass effects may not be so noticeable.

Related Topic

- [Listening to music of a device via BLUETOOTH connection](#)
- [Listening to music of a portable audio device, etc.](#)

Personal Audio System
SRS-XB3

Receiving a call

You can enjoy hands-free calls with a BLUETOOTH mobile phone that supports the BLUETOOTH profile HFP (Hands-free Profile) or HSP (Headset Profile) via BLUETOOTH connection.

- If your BLUETOOTH mobile phone supports both HFP and HSP, set it to HFP.
- Operations may vary depending on the BLUETOOTH mobile phone. Refer to the operating instructions supplied with your mobile phone.

About ring tones

When an incoming call arrives, a ring tone will be heard via the speaker.
The ring tone varies in the following ways, depending on your BLUETOOTH mobile phone.

- Ring tone set on the speaker
- Ring tone set on the BLUETOOTH mobile phone
- Ring tone set on the BLUETOOTH mobile phone only for a BLUETOOTH connection

1 Connect the speaker with a BLUETOOTH mobile phone.

The  (BLUETOOTH) indicator lights up in white when the BLUETOOTH connection is established.

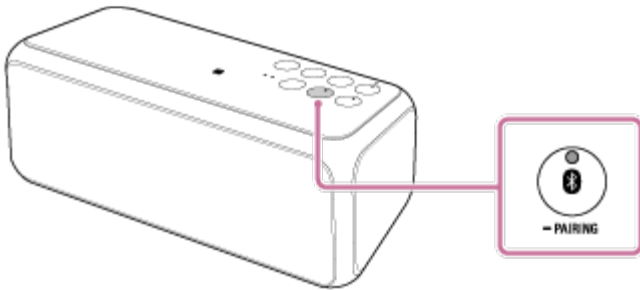

When using the Speaker Add function

- Connect to the speaker where the  (BLUETOOTH) indicator is flashing. In the following steps, operate this speaker that is connected to the BLUETOOTH mobile phone. Operation during a hands-free call is only available with this speaker.

2 Press the  (call) button when a call is received.

Talk into the microphone of the speaker.

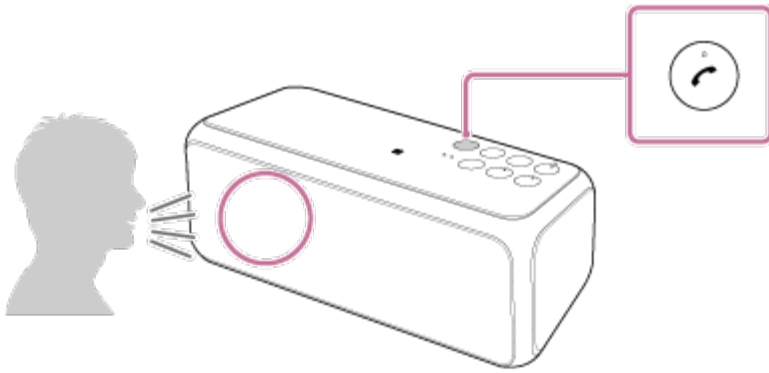

When an incoming call arrives, playback pauses and a ring tone is heard from the speaker.



If no ring tone is heard via the speaker

- The speaker may not be connected with a BLUETOOTH mobile phone with HFP or HSP. Check the connection status on the BLUETOOTH mobile phone.
- Switch the call device to the speaker by pressing and holding the  (call) button for about two seconds.

- 3** Adjust the volume by pressing the $-/+$ (volume) buttons on the speaker or operating the BLUETOOTH mobile phone.

When you press the $-/+$ (volume) buttons on the speaker or adjust the volume on the BLUETOOTH mobile phone, the  (power) indicator flashes once in green. When you set the volume to the maximum or minimum, the  (power) indicator flashes three times in green.

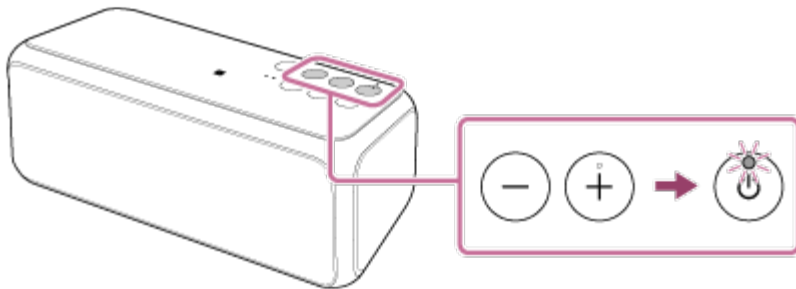

- 4** To end a call, press the  (call) button.

If you were listening to music before the call, playback will resume when the call ends.

If you end a call by operating the BLUETOOTH mobile phone, playback will also resume when the call ends if you were listening to music before the call.

Hint

- Some BLUETOOTH mobile phones have handset use priority when receiving a call. In the case of the HFP or HSP connection, switch the call device to the speaker by pressing and holding the  (call) button for about two seconds or operating your BLUETOOTH mobile phone.
- The volume of music playback and calling is set independently in the speaker.
- If the caller cannot hear or can barely hear your voice, talk more directly into the microphone of the speaker.

Note

- When using the Speaker Add function, sound of the phone call is output from only the speaker where the  (BLUETOOTH) indicator is lit.
- The sound is output from the right speaker only during a call.
- Depending on the BLUETOOTH mobile phone, playback may not pause when an incoming call arrives.
- Use a BLUETOOTH mobile phone at least 50 cm away from the speaker. Noise may result if the speaker and the BLUETOOTH mobile phone are too close.
- If an audio cable is connected to the AUDIO IN jack of the speaker, you cannot listen to music of the BLUETOOTH device. However, when the BLUETOOTH connection is active, the hands-free function is available.

Related Topic

- [How to make a wireless connection with BLUETOOTH devices](#)
- [Terminating the BLUETOOTH connection \(After use\)](#)
- [Making a call](#)
- [Button functions for a phone call](#)

Personal Audio System
SRS-XB3

Making a call

You can enjoy hands-free calls with a BLUETOOTH mobile phone that supports the BLUETOOTH profile HFP (Hands-free Profile) or HSP (Headset Profile) via BLUETOOTH connection.

- If your BLUETOOTH mobile phone supports both HFP and HSP, set it to HFP.
- Operations may vary depending on the BLUETOOTH mobile phone. Refer to the operating instructions supplied with your mobile phone.

1 Connect the speaker with a BLUETOOTH mobile phone.

The  (BLUETOOTH) indicator lights up in white when the BLUETOOTH connection is established.

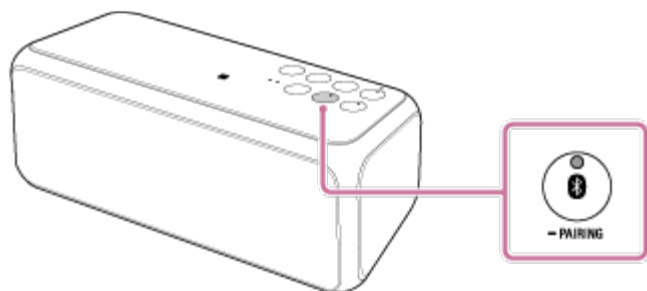

When using the Speaker Add function

- Connect to the speaker where the  (BLUETOOTH) indicator is flashing. In the following steps, operate this speaker that is connected to the BLUETOOTH mobile phone. Operation during a hands-free call is only available with this speaker.

2 Operate the BLUETOOTH mobile phone to make a call.

When you make a call, playback pauses and the dial tone is heard from the speaker. When the receiver takes the call, talk into the microphone of the speaker.

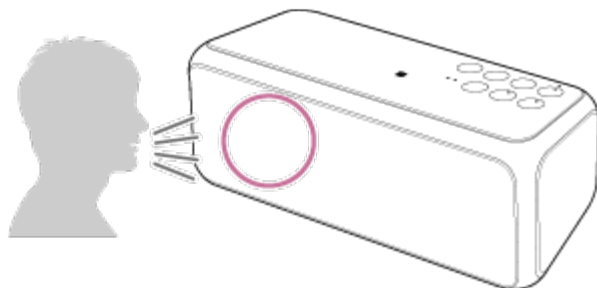



If no dial tone is heard via the speaker

- The speaker may not be connected with a BLUETOOTH mobile phone with HFP or HSP. Check the connection

status on the BLUETOOTH mobile phone.

- Switch the call device to the speaker by pressing and holding the  (call) button for about two seconds.

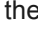
- 3 Adjust the volume by pressing the -/+ (volume) buttons on the speaker or operating the BLUETOOTH mobile phone.

When you press the -/+ (volume) buttons on the speaker or adjust the volume on the BLUETOOTH mobile phone, the  (power) indicator flashes once in green. When you set the volume to the maximum or minimum, the  (power) indicator flashes three times in green.

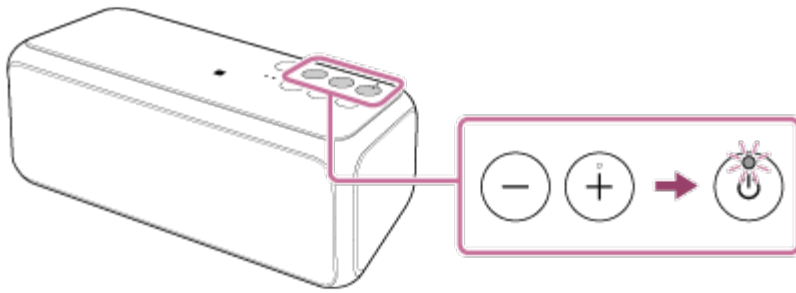

- 4 To end a call, press the  (call) button.

If you were listening to music before the call, playback will resume when the call ends.

If you end a call by operating the BLUETOOTH mobile phone, playback will also resume when the call ends if you were listening to music before the call.

Hint

- The volume of music playback and calling is set independently in the speaker.
- If the caller cannot hear or can barely hear your voice, talk more directly into the microphone of the speaker.

Note

- When using the Speaker Add function, sound of the phone call is output from only the speaker where the  (BLUETOOTH) indicator is lit.
- The sound is output from the right speaker only during a call.
- Depending on the BLUETOOTH mobile phone, playback may not pause when making a call.
- Use a BLUETOOTH mobile phone at least 50 cm away from the speaker. Noise may result if the speaker and the BLUETOOTH mobile phone are too close.
- When an audio cable is connected to the AUDIO IN jack of the speaker, you cannot listen to music of the BLUETOOTH device. However, when the BLUETOOTH connection is active, the hands-free function is available.

Related Topic



- [How to make a wireless connection with BLUETOOTH devices](#)
- [Terminating the BLUETOOTH connection \(After use\)](#)
- [Receiving a call](#)
- [Button functions for a phone call](#)

Button functions for a phone call



The available functions may vary depending on the profile supported by your BLUETOOTH mobile phone. Even if the profile is the same, functions may vary depending on the device.

Refer to the operating instructions supplied with your BLUETOOTH mobile phone.



Standby

- Press the  (call) button once to start voice-dial (voice-dial compatible mobile phones only).
- Press and hold the  (call) button for about two seconds to redial the last-dialed phone number.



Outgoing call

- Press the  (call) button once to cancel an outgoing call.
- Press and hold the  (call) button for about two seconds to change the call device between the speaker and mobile phone.

Incoming call

- Press the  (call) button once to answer a call.
- Press and hold the  (call) button for about two seconds to reject a call.

During call

- Press the  (call) button once to finish a call.
- Press and hold the  (call) button for about two seconds to change the call device between the speaker and mobile phone.

Note

- Depending on the smartphone, tablet device, or applications installed, the redial function may not work correctly.

Related Topic

- [Receiving a call](#)
- [Making a call](#)

Personal Audio System
SRS-XB3

About the indicators

CHARGE indicator (orange)

Turns off	Charging the speaker is completed.
Lights up (orange)	The speaker is being charged.
Flashes slowly (orange)	The built-in battery is running low and needs to be charged. In this state, the speaker cannot supply power to other devices.
Flashes three times (orange) and turns off	If the CHARGE indicator flashes three times in orange and goes off when you turn on the speaker, the battery is empty and needs to be charged.

Note

- In an extremely cold or hot environment, charging stops for safety. If charging takes a long time, it also makes charging of the speaker stop. In these conditions, the CHARGE indicator keeps flashing in orange quickly, but this is not a malfunction. To resolve these issues, unplug the AC adaptor and plug it in again within the operating temperature of between 5 °C and 35 °C (41 °F and 95 °F).

⏻ (power) indicator

Turns off	The speaker is turned off.
Lights up (green)	The speaker is turned on.
Lights up (orange)	The speaker is in the BLUETOOTH standby mode.
Flashes once (green)	Each time you press the -/+ (volume) button, the indicator flashes once.
Flashes three times (green)	The volume is set at the lowest or highest level.

📶 (BLUETOOTH) 🔌 PAIRING indicator (white)

Lights up (white)	The speaker is connected to a BLUETOOTH device.
Flashes quickly (white)	The speaker enters the pairing mode.
Flashes slowly (white)	The speaker is searching for a BLUETOOTH device to connect to.

L indicator (white)

Flashes	The speaker enters the Speaker Add function mode.
---------	---

Lights up	The speaker is operating as the left speaker while the stereo mode of the Speaker Add function is enabled. The speaker is operating as a monaural speaker while the double mode of the Speaker Add function is enabled.
-----------	--

R indicator (white)

Flashes	The speaker enters the Speaker Add function mode.
Lights up	The speaker is operating as the right speaker while the stereo mode of the Speaker Add function is enabled. The speaker is operating as a monaural speaker while the double mode of the Speaker Add function is enabled.

EXTRA BASS indicator (white)

Lights up	You can enjoy boosted bass (Sony-recommended sound quality). This mode is set as the default setting.
Turns off	You can enjoy the natural sound quality with reduced bass. This mode is recommended when listening at low volume inside a room.

Related Topic

- [Parts and controls](#)

Personal Audio System
SRS-XB3

Precautions

Note when using with a mobile phone

- For details on operation of your mobile phone when receiving a telephone call while transmitting the sound using the BLUETOOTH connection, refer to the operating instructions supplied with the mobile phone.

On safety

- The nameplate and important information concerning safety are located on the rear exterior of the speaker and on the surface of the AC adaptor.
- Before operating the speaker, be sure that the operating voltage of the speaker is identical with that of your local power supply.
Where purchased: all countries/regions
Operating voltage: 100 V – 240 V AC, 50 Hz/60 Hz

Notes on the AC adaptor

- When connecting or disconnecting the AC adaptor, turn off the speaker beforehand. Otherwise, it may cause a malfunction.
- Use only the supplied AC adaptor. To avoid damaging the speaker, do not use any other AC adaptor.

Polarity of the plug



- Plug the AC adaptor into a nearby wall outlet (mains). In the case of a problem, unplug it from the wall outlet (mains) immediately.
- Do not install the AC adaptor in a confined space such as a bookcase or built-in cabinet.
- To reduce the risk of fire or electric shock, do not expose the AC adaptor to dripping or splashing, and do not place objects filled with liquids, such as vases, on the AC adaptor.

On placement

- Do not set the speaker in an inclined position.
- Do not leave the speaker in a location near heat sources, in a place subject to direct sunlight, excessive dust, moisture, rain, or mechanical shock.

On operation

- Do not insert any small objects, etc., into the jacks or ventilation hole on the rear of the speaker. The speaker may short out or malfunction.

On cleaning

- Do not use alcohol, benzene, or thinner to clean the cabinet.

Others

- Two speakers are required when using the Speaker Add function. Only the SBC codec is supported while using the Speaker Add function.
- If you have any questions or problems concerning the speaker that are not covered in this Help Guide, please consult your nearest Sony dealer.

Notes on charging

Life span of the built-in lithium ion battery

- The rechargeable battery has a life span. As time passes and the number of times that the battery is used increases, the capacity of the rechargeable battery slowly decreases. When the amount of time that the battery can be used seems significantly shorter, despite having been fully charged, contact your nearest Sony dealer.
- The life span of the rechargeable battery differs depending on the usage, environment, and storage method.

Caution

When the speaker detects a problem for the following causes while charging the battery, it will stop charging even if charging is not completed, and the CHARGE indicator flashes quickly in orange.

- Ambient temperature exceeds the range of 5 °C – 35 °C (41 °F – 95 °F).
- There is a problem with the battery.

Note

- Charging time varies depending on battery usage conditions.
- Charge the speaker in an ambient temperature of between 5 °C and 35 °C (41 °F and 95 °F).
- The speaker becomes warm during charging. This is not a malfunction.
- If the speaker is not used for a long time, it may take longer to charge the battery.
- Avoid exposure to rapid temperature change, direct sunlight, moisture, sand, dust, or mechanical shock. Also, never leave the speaker in a car parked in the sun.
- In an extremely cold or hot environment, charging stops for safety. If charging takes a long time, it also makes charging of the speaker stop. In these conditions, the CHARGE indicator keeps flashing in orange quickly, but this is not a malfunction. To resolve these issues, unplug the AC adaptor and plug it in again within the operating temperature of between 5 °C and 35 °C (41 °F and 95 °F).

Personal Audio System
SRS-XB3

Notes on water resistant feature

Water resistant performance of the speaker

This speaker has a water resistant specification ^{*1*2} and IPX5^{*3} as specified in “Degrees of protection against ingress of water” of the IEC60529 “Ingress Protection Rating (IP Code).” However, this speaker is not completely water-tight.

Do not drop the speaker into hot water in a bathtub or purposely use it in water. Depending on usage, water entering the speaker may cause fire, electric shock or malfunction.

Use the speaker with full understanding of the following.

Liquids that the water resistant performance specifications apply to

Applicable : fresh water, tap water, sweat

Not applicable : liquids other than the above (soapy water, water with detergent or bath agents, shampoo, hot spring water, hot water, pool water, seawater, etc.)

*1 Requires that the cap is fastened securely.

*2 The supplied accessories are not water resistant.

*3 IPX5 (Degree of protection against jets of water): The speaker has been tested and found to remain functional after exposure to direct jet streams of water using a nozzle of 6.3 mm (about 1/4 in) internal diameter from any direction where approximately 12.5 L/ min of water is applied for a period of more than 3 minutes from a distance of about 3 meters (about 10 ft).

The water resistant performance of the speaker is based on our measurements under the conditions herein described. Note that malfunctions as a result of water immersion caused by misuse by the customer are not covered by the warranty.

To avoid the deterioration of the water resistant performance

Check the following and use the speaker correctly.

- Do not use or leave the speaker in an extremely hot or cold environment (temperature outside the range of 5 °C – 35 °C (41 °F – 95 °F)). If the speaker is used or left in outside the above range, the speaker may automatically stop to protect internal circuitry.
- Be careful not to drop the speaker or subject it to mechanical shock. Deformation or damage may cause deterioration of the water resistant performance.
- Do not use the speaker in a location where large amount of water or hot water may splash on it. The speaker does not have a design that is resistant to water pressure. Use of the speaker in the above location may cause a malfunction.
- Do not pour high-temperature water or blow hot air from a hair dryer or any other appliance on the speaker directly. Also, never use the speaker in high temperature locations such as in saunas or near a stove.
- Handle the cap ① with care. The cap plays a very important role in maintenance of the water resistant performance. When using the speaker, make sure that the cap is closed completely. When closing the cap, be careful not to allow foreign objects on the rubber seal that keep the cap from closing properly. If the cap is not closed completely the water resistant performance may deteriorate and may cause a malfunction of the speaker as a result of water entering the speaker.

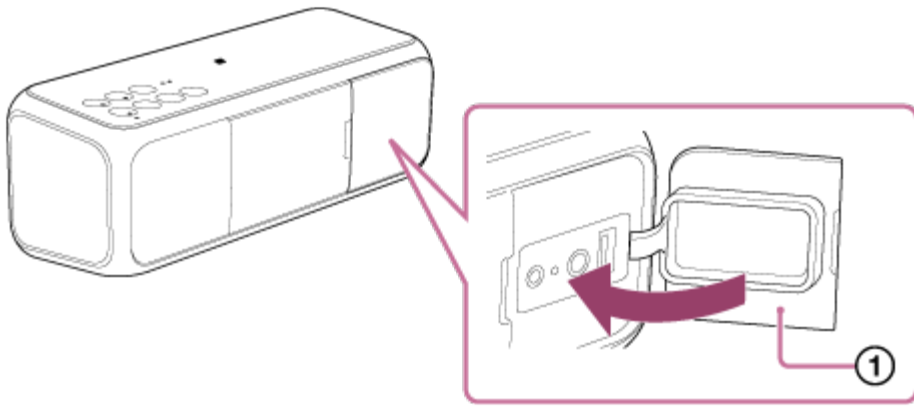

Personal Audio System
SRS-XB3

How to care for the speaker when wet

If the speaker gets wet, first remove the water from the speaker, and then wipe off the moisture on the speaker using a soft, dry cloth. Especially in cold regions, leaving moisture on its surface may cause the speaker to freeze and malfunction. Be sure to wipe off the moisture after using the speaker.

Put the speaker on a towel or dry cloth. Then leave it at room temperature and dry the speaker until no moisture remains.

Personal Audio System
SRS-XB3

What is BLUETOOTH wireless technology?

BLUETOOTH wireless technology is a short-range wireless technology that enables wireless data communication between digital devices, such as a computer and digital camera. BLUETOOTH wireless technology operates within a range of about 10 m (about 30 ft).

Connecting two devices as necessary is common, but some devices can be connected to multiple devices at the same time. You do not need to use a cable for connection, nor is it necessary for the devices to face one another (such is the case with infrared technology). For example, you can use the device in a bag or pocket.

BLUETOOTH standard is an international standard supported by thousands of companies all over the world and employed by various companies worldwide.

Maximum communication range

Maximum communication range may shorten under the following conditions.

- There is an obstacle such as a person, metal, or wall between the speaker and BLUETOOTH device.
- A wireless LAN device is in use near the speaker.
- A microwave oven is in use near the speaker.
- A device that generates electromagnetic radiation is in use near the speaker.

Interference from other devices

Because BLUETOOTH devices and wireless LAN (IEEE802.11b/g) use the same frequency, microwave interference may occur and result in communication speed deterioration, noise, or invalid connection if the speaker is used near a wireless LAN device. In such a case, perform the following.

- Use the speaker at least 10 m (about 30 ft) away from the wireless LAN device.
- If the speaker is used within 10 m (about 30 ft) of a wireless LAN device, turn off the wireless LAN device.

Interference to other devices

Microwaves emitted from a BLUETOOTH device may affect the operation of electronic medical devices. Turn off the speaker and other BLUETOOTH devices in the following locations, as it may cause an accident.

- where inflammable gas is present, in a hospital, train, airplane, or a gas station
- near automatic doors or a fire alarm

Note

- To be able to use the BLUETOOTH function, the BLUETOOTH device to be connected requires the same profile as the speaker's.
- Note also that even if the same profile exists, devices may vary in function depending on their specifications.
- Due to the characteristic of BLUETOOTH wireless technology, the sound played on the speaker is slightly delayed from the sound played on the BLUETOOTH device while talking on the telephone or listening to music.
- This speaker supports security capabilities that comply with the BLUETOOTH standard to provide a secure connection when the BLUETOOTH wireless technology is used, but security may not be enough depending on the setting. Be careful when communicating using BLUETOOTH

wireless technology.

- We do not take any responsibility for the leakage of information during BLUETOOTH communication.
- A device featuring the BLUETOOTH function is required to conform to the BLUETOOTH standard specified by Bluetooth SIG and be authenticated. Even if the connected device conforms to the above mentioned BLUETOOTH standard, some devices may not be connected or work correctly, depending on the features or specifications of the device.
- Noise or sound skips may occur depending on the BLUETOOTH device connected with the speaker, the communication environment or the usage environment.
- The device with a built-in radio or tuner cannot be connected to the speaker via BLUETOOTH since noise may occur in broadcasts.
- Locate the speaker farther away from a TV, radio or tuner, etc. since noise may occur in broadcasts.

Personal Audio System
SRS-XB3

What is LDAC?

LDAC is an audio coding technology developed by Sony that enables the transmission of High-Resolution (Hi-Res) Audio content, even over a BLUETOOTH connection. Unlike other BLUETOOTH compatible coding technologies such as SBC, it operates without any down-conversion of the Hi-Res Audio content^{*1}, and allows approximately three times more data^{*2} than those other technologies to be transmitted over a BLUETOOTH wireless network with unprecedented sound quality, by means of efficient coding and optimized packetization.

*1 excluding DSD format contents

*2 in comparison with SBC (Subband Coding) when the bitrate of 990 kbps (96/48 kHz) or 909 kbps (88.2/44.1kHz) is selected

Note

- Depending on the network environment, there may be an interruption at the high bitrate transmission.

Related Topic

- [Selecting the wireless playback quality of the speaker](#)
- [Distorted sound/Humming or noise in the speaker output](#)

Personal Audio System
SRS-XB3

Trademarks

- SONY is a trademark of Sony Corporation.
- The BLUETOOTH® word mark and logos are registered trademarks owned by Bluetooth SIG, Inc. and any use of such marks by Sony Corporation is under license.
- LDAC and LDAC logo are trademarks of Sony Corporation.
- The N-Mark is a trademark or registered trademark of NFC Forum, Inc. in the United States and in other countries.
- Android™ and Google Play™ are trademarks of Google Inc.
- iPhone, iPad and iPod are trademarks of Apple Inc., registered in the U.S. and other countries.
- Microsoft, Windows and Windows Vista are registered trademarks or trademarks of Microsoft Corporation in the United States and/or other countries.

All other product names mentioned in this Help Guide may be the trademarks or registered trademarks of their respective companies. Furthermore, ® and ™ are not mentioned in each case in this Help Guide.

Personal Audio System
SRS-XB3

Customer support websites

Please access the following support home pages to get support information about your speaker:

For customers in the USA:

<http://esupport.sony.com/>

For customers in Canada:

<http://esupport.sony.com/CA/>

For customers in European countries:

<http://www.sony.eu/support>

For customers in Latin America:

<http://www.sony-latin.com/>

For customers in other countries/regions:

<http://www.sony-asia.com/>

Personal Audio System
SRS-XB3

What can I do to solve a problem?

If the speaker does not function as expected, try the following steps to resolve the issue.

- Find the symptoms of the issue in this Help Guide and try any corrective actions listed.
- Connect the speaker to an AC outlet to charge the battery.

You may be able to resolve some issues by charging the battery.

- Push the RESET button of the speaker.
- Initialize the speaker.

This operation resets volume settings, etc., and deletes all pairing information.

- Look up information on the issue on the customer support website.

If the operations above do not work, consult your nearest Sony dealer.

Related Topic

- [Customer support websites](#)
- [Using the RESET button](#)
- [Initializing the speaker](#)

Personal Audio System
SRS-XB3

Unable to turn on the speaker or charge the built-in battery

- Charge the built-in battery.
 - Make sure the AC adaptor is firmly connected to the speaker and the AC outlet.
-

Related Topic

- [Connecting to an AC outlet](#)
- [Turning the power on](#)
- [About the indicators](#)

Personal Audio System
SRS-XB3

The power suddenly turns off

- Press the  (power) button to turn on the speaker. If the speaker does not turn on, charge the speaker by connecting the AC adaptor to a wall outlet.
 - The auto power off function may have activated. After 15 minutes in certain circumstances, such as when the volume of the audio input is low, the power will automatically turn off. Raise the volume of the connected device for use, or set the auto power function to off.
-

Related Topic

- [Connecting to an AC outlet](#)
- [Turning the power on](#)
- [Auto power off function](#)
- [Switching the auto power off function](#)

Personal Audio System
SRS-XB3

No sound/Sound from only one speaker/Low sound level

- Check that both the speaker and the connected device are turned on.
- Turn up the volume of the speaker and the connected device.
- Check that the connected device is playing.
- Make sure the audio cable is disconnected from the AUDIO IN jack during playback in BLUETOOTH mode.
- Make sure the audio cable is firmly connected to the AUDIO IN jack during playback in AUDIO IN mode.
- If you are connecting a personal computer to the speaker, make sure the audio output setting of the computer is set for a BLUETOOTH device.
- Check that the speaker has established BLUETOOTH connection with the BLUETOOTH device.
- Pair the speaker and the BLUETOOTH device again.
- If the device that is connected to the AUDIO IN jack is monaural, sound will only be output from the left speaker.

Distorted sound/Humming or noise in the speaker output





- Turn down the volume of the connected device.
 - If the connected device has an equalizer function, set it to off.
 - Keep the speaker away from a microwave oven, Wi-Fi, etc.
 - Bring the speaker and the BLUETOOTH device closer together. Remove any obstacles between the speaker and the BLUETOOTH device.
 - Switch the BLUETOOTH connection to A2DP by operating the BLUETOOTH device when HFP or HSP is set.
 - Charge the speaker if the CHARGE indicator is flashing in orange.
 - The device with a built-in radio or tuner cannot be connected to the speaker via BLUETOOTH since noise may occur in broadcasts.
 - Locate the speaker farther away from a TV, radio or tuner, etc. since noise may occur in broadcasts.
 - When using the Speaker Add function, if any other BLUETOOTH device(s) such as a BLUETOOTH mouse or BLUETOOTH keyboard is connected to the BLUETOOTH device, terminate the connection between them.
 - There are some BLUETOOTH devices that can have the wireless playback quality changed. If your device is compatible with this function, select a setting that prioritizes stable connection over sound quality. For details, refer to the operating instructions supplied with the device.
 - Select "Priority on stable connection" for the wireless playback quality of the speaker.
-

Related Topic

- [Listening to music of a device via BLUETOOTH connection](#)
- [About the indicators](#)
- [Selecting the wireless playback quality of the speaker](#)

Personal Audio System
SRS-XB3

Unable to pair the speaker with a BLUETOOTH device

- Bring the speaker and the BLUETOOTH device to within 1 m (3 ft) of each other.
 - To use the Speaker Add function, pair with the speaker where the  (BLUETOOTH) indicator flashes in white.
 - If the  (BLUETOOTH) indicator is not flashing quickly in white, press and hold the  (BLUETOOTH)  PAIRING button until you hear beeps and the  (BLUETOOTH) indicator begins to flash quickly in white.
 - Connect the speaker to an AC outlet or charge the battery of the speaker sufficiently.
 - Once the speaker is initialized, an iPhone/iPad/iPod may not be able to connect to the speaker. In this case, delete pairing information on the iPhone/iPad/iPod then pair them again.
-

Related Topic

- [How to make a wireless connection with BLUETOOTH devices](#)
- [About the indicators](#)

Personal Audio System
SRS-XB3

Unable to connect the speaker to a BLUETOOTH device with One-touch connection (NFC)

- Keep the NFC-compatible device close to the speaker until the device reacts. If you fail to connect, move the device slowly over the N marked part of the speaker.
 - Check that the NFC function of the device is set to on.
 - If the device is in a case, remove it.
 - NFC reception sensitivity varies depending on the device. If you repeatedly fail to connect the speaker with a device by one touch, connect it to the speaker by on-screen operation.
 - Check that your device is compatible with NFC. Look up information on the issue on the customer support website.
 - To use the Speaker Add function, pair with the speaker where the  (BLUETOOTH) indicator flashes in white.
-

Related Topic

- [Connecting with an NFC-compatible device by One-touch \(NFC\)](#)

Personal Audio System
SRS-XB3

Unable to connect a BLUETOOTH device with the speaker in the Speaker Add function

- After connecting two SRS-XB3 speakers, perform the pairing procedure between a BLUETOOTH device and the speaker where the  (BLUETOOTH) indicator is flashing in white. Then make a BLUETOOTH connection.

Personal Audio System
SRS-XB3

No voice/Low voice from callers

- Check that both this speaker and the connected device are turned on.
 - Turn up the volume of the speaker and the connected device.
 - Check that output of the BLUETOOTH mobile phone is set for the speaker.
 - Select an HFP or HSP BLUETOOTH connection by operating the BLUETOOTH device.
-

Related Topic

- [How to make a wireless connection with BLUETOOTH devices](#)
- [Receiving a call](#)
- [Making a call](#)

Personal Audio System
SRS-XB3

Using the RESET button

If the speaker cannot be operated despite being turned on, push the RESET button on the rear side with a pin or other pointed object while the speaker is on. The speaker is reset and turns off.

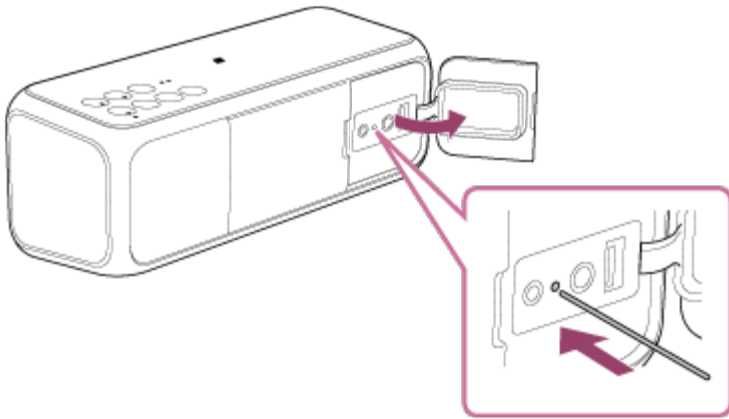

After pushing the RESET button, turn on the speaker. If it does not turn on, consult your nearest Sony dealer.

Note

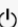
- The speaker cannot be reset while the power is off.
- Pairing information is not deleted by pushing the RESET button.
- To reset the speaker while it is being powered by the built-in battery, push and hold the RESET button until the  (power) indicator turns off.
- After resetting, the volume, function, and EXTRA BASS settings may be different.

Personal Audio System
SRS-XB3

Initializing the speaker

With the speaker turned on, press and hold the – (volume) button and the ⏻ (power) button at the same time for more than five seconds until the speaker turns off.

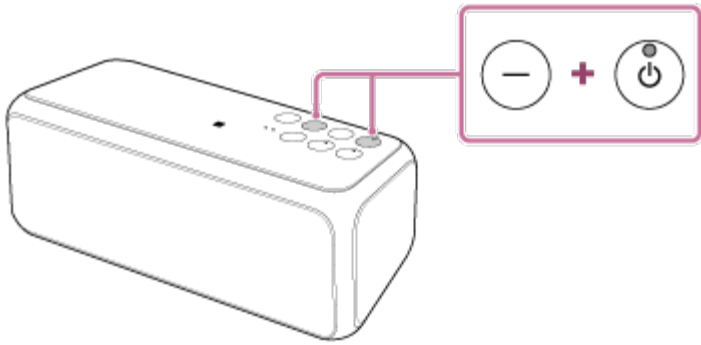

The speaker is initialized. Settings such as volume, etc., are restored to the factory default settings, and all pairing information is deleted.