

**Model No. CZHD20**



# Portable Ultrasonic Cool Mist Humidifier



Water Bottle Not Included

## **INSTRUCTION MANUAL**

**PLEASE SAVE THESE INSTRUCTIONS**



# IMPORTANT INSTRUCTIONS:

Thank you for choosing an Comfort Zone® humidifier. To ensure the best performance from your product, please read and save these instructions.

100-240 Volts, 50-60Hz • 12 Watts • Max Water Bottle: 20 Fl. Oz. (591mL)

WHEN USING ELECTRICAL APPLIANCES, BASIC PRECAUTIONS SHOULD ALWAYS BE FOLLOWED TO REDUCE THE RISK OF FIRE, ELECTRIC SHOCK AND INJURY TO PERSON, INCLUDING THE FOLLOWING:

- This humidifier is for indoor use only. Do not use in wet or damp locations such as bathrooms, laundry areas or other similar indoor locations. Never locate humidifier where it may fall into a bathtub or other water container.
- Do not use this product if parts are missing. Do not use this unit if the power cord shows signs of damage or wear or if the unit has been dropped or misused.
- Use this unit on a flat, level surface only. If unit is placed on a non-level surface, this unit may not function properly or water may overflow from the water reservoir.
- **Place this humidifier on a water-resistant surface.**
- **Be sure to turn off and unplug this unit when not in use or when cleaning.**
- Never move or tip this appliance while it is operating or while water is in the reservoir or bottle.
- This humidifier is not to be serviced or repaired by anyone except the manufacturer or service/repair facilities authorized by the manufacturer. Never disassemble your humidifier. Doing so will void your warranty and possibly allow water to get into sealed parts.
- Use this humidifier in the manner described in this operations manual only. Not following this manual may cause damage to the humidifier, may create a fire hazard, electrical shock, or injury to persons or property.
- Do not place this humidifier near furnaces, heaters, stoves, or any other source of heat. Do not operate humidifier near heating/cooling vents.
- Position this humidifier out of the reach of children and pets.
- **This humidifier requires periodic maintenance.** Refer to those instructions in this manual.
- **DO NOT use anything other than water in this appliance. Do not use additives or medications.**
- Never block the humidifier or mist outlet. Never point mist outlet at furniture or walls.
- Do not cover any part of this humidifier. Do not insert any object into any area of this humidifier.
- Do not fill liquid directly into humidifier reservoir, bottle must be used.
- Never soak humidifier in water.

## SET UP

1. Fill bottle with water (max water bottle size: 20 fl. oz. (591mL))
2. Press bottle cap adapter on to open water bottle. Be sure the bottle is pressed on tightly to ensure a good seal.
3. Place capped bottle on to top of humidifier and press down fully to seat the capped bottle in to the opening. You will see bubbles come in to the bottle as the reservoir fills.
4. Place output mist nozzle on to humidifier. Note; opening should face away from bottle.
5. Insert DC plug in to humidifier and plug in to power outlet.
6. Turn humidifier on by rotating on/off mist control dial from off position to desired mist output level.
7. Blue light visible through output mist nozzle shows that the unit has water in the tank and is operating properly.

## OPERATION

The best working environment for humidifier is between the temperatures of 41°F (5°C) and 104°F (40°C) and relative humidity is lower than 60%RH. Use the ON/OFF/Mist Control Dial on the side of the unit to turn it on or off or adjust mist output. The top of the tank has a directional mist output nozzle, simply turn the nozzle to the desired direction away from the bottle. Do not operate the humidifier without the water bottle and reservoir cover in place.

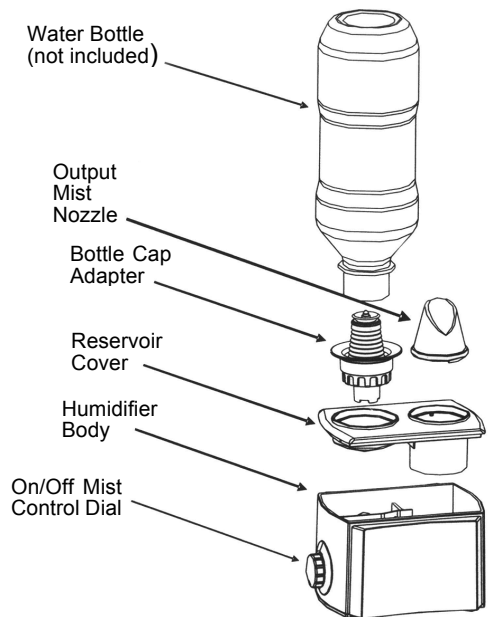

## **EMPTY WATER BOTTLE**

When the bottle is empty and the water reaches a minimum level in the reservoir, the unit will automatically shut down and stop producing moisture.

The blue color light visible through the mist output nozzle will turn to red indicating that the reservoir is empty and needs to be filled.

To refill the humidifier, simply turn the unit off and unplug the unit from the wall and follow set up instructions above.

## **CLEANING THE HUMIDIFIER**

It is strongly recommended you clean your humidifier at least once a week or more often if you

- Have hard water.
- Notice a buildup of impurities on or in the tray, etc.
- Notice an unpleasant odor.

Always turn off and unplug the humidifier before cleaning.

Periodically wipe the outside of the humidifier with a soft damp or wet cloth. Never submerge the housing in liquid or pour liquid in or on the housing. Doing so may damage the humidifier and cause injuries.

Do not use any cleaning oil, harsh, abrasive or alkaline type cleaner in this unit. Use a soft cloth to wipe out never use metal or any sharp object to clean this product.

To clean the inside of the humidifier:

1. Remove water bottle with cap adapter from humidifier.
2. Remove reservoir cover from tank.
3. Clean metal transducer with included cotton swab.
4. Wipe inside of reservoir with a soft cloth.

**Warning:** If liquid cleaner is to be used on this unit, never allow it to fill the entire reservoir, only up to fill line indicated on the pour side of the reservoir. Doing so can allow water to get inside the unit and cause damage or injury.

## **END OF SEASON CARE AND STORAGE**

Empty the tank and tray of water. Clean all surfaces as described in this manual. When completely dry, store the humidifier in its original carton, in a cool, dry, clean location. Remember to clean and inspect your humidifier before using it the next season.

## Troubleshooting

Abnormal symptom	Cause	Solution
Indicator not illuminated and no mist	<ul style="list-style-type: none"> <li>• The power cord is not properly plugged in or the power switch is not turned on</li> </ul>	<ul style="list-style-type: none"> <li>• Plug the power cord properly into a working outlet, turn on the power switch</li> </ul>
No mist	<ul style="list-style-type: none"> <li>• Dirt or debris on surface of metal transducer</li> <li>• The On/Off Mist Control Dial is not turned up</li> <li>• Water bottle is empty</li> </ul>	<ul style="list-style-type: none"> <li>• Clean metal transducer.</li> <li>• Turn Mist Control Dial clockwise</li> <li>• Fill water bottle</li> </ul>
Mist with odor	<ul style="list-style-type: none"> <li>• The water in the reservoir is not clean</li> </ul>	<ul style="list-style-type: none"> <li>• Open and clean the water reservoir</li> </ul>
Indicator is illuminated with no mist	<ul style="list-style-type: none"> <li>• The water level in the water reservoir is too high</li> </ul>	<ul style="list-style-type: none"> <li>• Remove some water in the unit's water reservoir</li> </ul>
Reduced mist output	<ul style="list-style-type: none"> <li>• There is scale formation on the transducer in the reservoir</li> <li>• The water is dirty or has been stored too long</li> </ul>	<ul style="list-style-type: none"> <li>• Clean the transducer</li> <li>• Replace with clean water</li> </ul>

## **LIMITED WARRANTY**

Products manufactured by Comfort Zone® are warranted to the original consumer to be free of defects in material and workmanship for twelve (12) months from the original date of purchase. The warranty does not cover products modified outside our factory, damage or failure caused by acts of God, abuse, misuse, abnormal usage, faulty installation, failure to follow suggested maintenance procedures enclosed with this product (as defined by Magnuson-Moss Warranty-Federal Trade Commission Improvement Act) This unit is guaranteed to the original retail purchaser against defects in quality or workmanship for a period of one year from the date of original purchase. If this unit fails because of a manufacturing defect within 30 days of purchase, return the unit, with your receipt, to the retailer. After 30 days, but within the warranty period, if the unit was purchased within the continental United States, return it, freight prepaid, to Comfort Zone®. for repair or replacement. If the unit was purchased outside the continental United States, return the unit to the place of purchase. This warranty does not cover damage due to accidents, operation on other than 120 volts, 60 hertz, AC. current, or any other abuse. All implied warranties, including the warranties of merchantability and of fitness of purpose, if applicable, are hereby limited in duration to the period of one year from the date of original retail purchase. Some states do not allow limitations on how long an implied warranty lasts, so the above limitations may not apply to you. Incidental or consequential damages arising from a breach of either express or implied warranties are hereby disclaimed and excluded. Some states do not allow the exclusion of limitation of incidental or consequential damages, so this limitation or exclusion may not apply to you.

This warranty gives you specific legal rights, and you may also have other rights, which vary from state to state. No informal dispute settlement mechanisms are available. This limited warranty is given in lieu of all other warranties.

Manufactured for:  
Comfort Zone®  
324A Half Acre Rd.  
Cranbury, NJ 08512 USA  
800-221-6895  
[www.comfortzoneforyou.com](http://www.comfortzoneforyou.com)

Rev. 081514