

Install Smart Lock Pro, 3rd Gen Technology

What's in the box



Smart Lock Pro
(4 AA batteries included)



Mounting Plate



3 Adapters



Adhesive Strip

What you'll need to provide



Phillips Screwdriver

1. Prepare your existing deadbolt

Use the supplied adhesive strip to hold the keyed side of the lock in place.



2. Remove your existing thumb-latch

Unscrew and remove the screws from your existing deadbolt thumb-latch. If there is an additional back plate, remove that as well. Be sure to unlock your deadbolt before removing the thumb-latch entirely.





3. Prepare the Mounting Plate

The included mounting plate has two adjustable screw-holes that can be repositioned as needed. Remove the screws from the thumb-latch and insert them into the front of the mounting plate.













4. Attach the Mounting Plate

Tighten the screws by hand until the mounting plate is settled securely against the door.



5. Choose your adapter

Deadbolt Compatibility Chart

BRAND	ADAPTER
Baldwin - Estate/Images*	
Baldwin Reserve/Prestige	
Defiant	
Emtek	
Kwikset*	
Omnia**	
Schlage***	
Weiser	
Weslock	

* Baldwin and Kwikset Deadbolts installed before 1997 have unique installation requirements, please contact us at 844-AUGUST1 (284-8781) and we will walk you through installation.

** Compatible only with non-mortise, standard Omnia deadbolts.

*** Commercial grade Schlage B560 deadbolts require supplemental screws. If your Schlage screws are too short please contact us at support@august.com

Select your adapter from the Compatibility Chart above.

If your lock brand is not in the chart, slide each adapter onto the tailpiece to find the right one. The correct adapter will have the small nub pointing up.

NOTE: The adapters can be placed in the mounting plate backwards. So if the shape is correct, but it seems backwards, try flipping the adapter around.

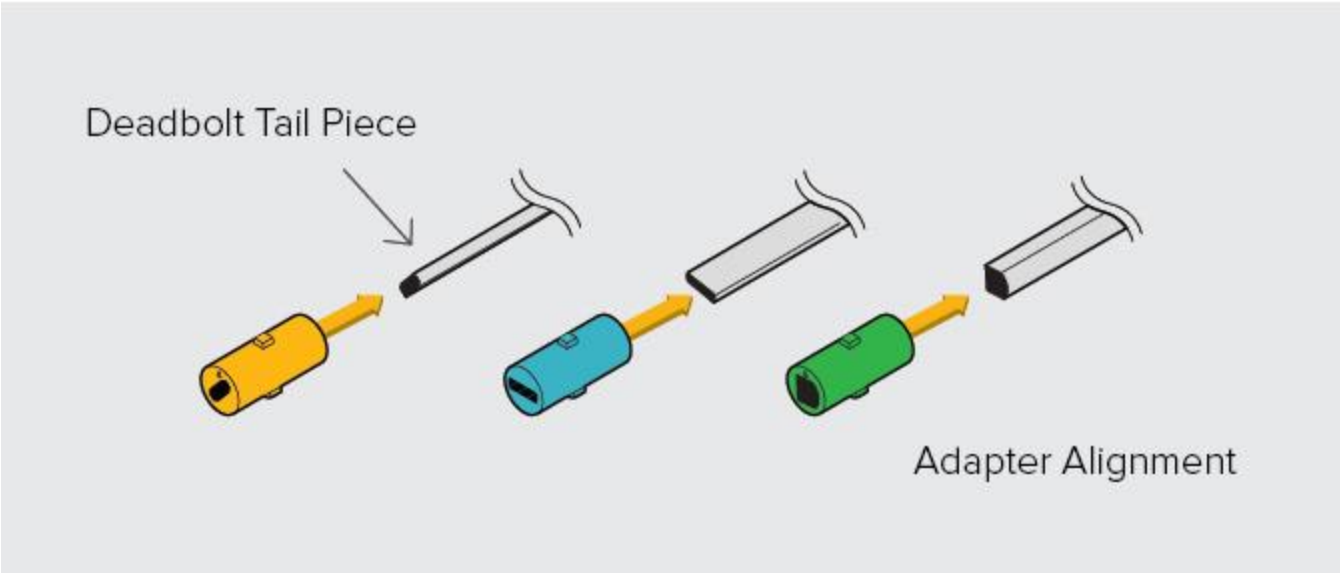

6. Attach the Correct Adapter

Place the correct adapter onto the tail piece with the small nub pointing up



7. Open the wing latches

Pull out both side wing latches to prepare for mounting.



8. Attach the August Smart Lock Pro

Slide the August Smart Lock Pro over the tailpiece and attach it to the mounting plate. Make sure the back of the lock is flush with the door. To secure the August Smart Lock Pro, clamp down both side wing latches to the mounting plate completely.





9. Remove the faceplate

Press down on the August logo located at the bottom of the face plate. Grab the top of the faceplate and remove it.



10. Remove the battery tab

While holding the batteries in place, remove the plastic battery isolation tab. Make sure that the battery is properly seated in its compartment.



11. Replace the faceplate

Place the faceplate back onto the August Smart Lock Pro, with the August logo at the bottom



12. Install DoorSense™

DoorSense™ enables your lock to know when the door is open and closed. For instructions on installing DoorSense™, please see: [DoorSense™ Installation Guide for August Smart Lock Pro](#)

13. Use the August Home app to complete setup

Download and install the August Home app. Select "Get Started" from the home screen, or, if already logged in to the app, select "Set Up a Lock" from the main menu.



Deadbolt Parts

The **thumb-latch** (or **thumbturn**) is the part of your deadbolt inside your home that you use to lock and unlock your deadbolt.



The **deadbolt** is the piece of the lock that secures your door shut.



The **turnpiece** (also known as a **tailpiece**) is the portion of your lock that extends through your door from the outer key cylinder to the inside of your door. The thumb latch connects to turn piece in order to operate your lock. Your August lock will attach to this in place of the thumb latch.



The **keyhole** is where your keys operate your deadbolt.



None of the mounting plates fit the screws for my lock

If you would like to confirm if your deadbolt is compatible with August, please check the compatibility diagrams or send a picture of both sides of the lock, and a side view of your door to photos@august.com.

X

Deadbolt Compatibility

The August Smart Lock is designed to work with Single Cylinder deadbolts, which are the most popular door locks sold today. Mortise, Integrated Lock & Handle, and Rim Cylinder deadbolts are not compatible.



Single Cylinder

Deadbolt is mounted and operates independently of the door handle



Mortise

An integrated door handle and deadbolt in a single metal unit



Integrated Lock & Handle

Handle and lock turn-latch are both mounted together on a metal plate



Rim Cylinder

Mounted on the inside, on top of the door and door jamb

If you are not sure whether your existing lock is compatible, please send photos of the inside, outside, and side view of your lock to photos@august.com.