



arlo™

Arlo Baby
Quick Start Guide



Welcome

Thank you for choosing Arlo Baby.
Getting started is easy.

What's Included



Arlo Baby camera



USB power cable



USB power adapter



Quick Start Guide



Wall-mount plate



Mounting screws

Plug In Your Camera

Connect one end of the USB power cable to the port on the camera.

Caution: You must use an Arlo Baby power cable and adapter to charge the camera battery. Do not try to power the camera or charge the camera battery with any power adapter other than the one provided with the Arlo Baby camera.

Plug the other end of the USB cable into the power adapter.

Plug the USB power adapter into a wall socket and wait for the camera LED to blink amber.

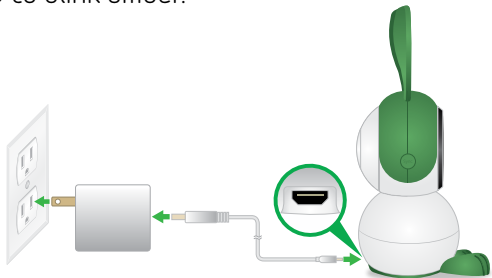

Get the App

For the best experience, download the Arlo app for your smartphone by scanning this QR code or searching for Arlo in the app store.



arlo.netgear.com



Note: If you already use the Arlo app, make sure that you are using the latest version. To find out if an update is available, go to the app store and search for Arlo.

Get a New Account or Log In

➤ To create a new Arlo account:

1. Launch the Arlo app from your smartphone, tap **New to Arlo?**, and select **Arlo Baby**.

If you are using a computer, visit arlo.netgear.com.

2. Follow the onscreen instructions.

➤ To add an Arlo Baby camera to an existing Arlo account:

1. If you already set up an Arlo account, log in and click or tap **Add Device**.
2. Follow the onscreen instructions.

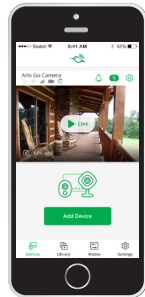
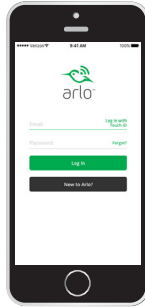

Connect Your Camera

Follow the onscreen instructions either in the Arlo app or from a computer to connect your camera to your router.

Note: If you own an Arlo Wire-Free system, do not connect your Arlo Baby camera to the Arlo base station.

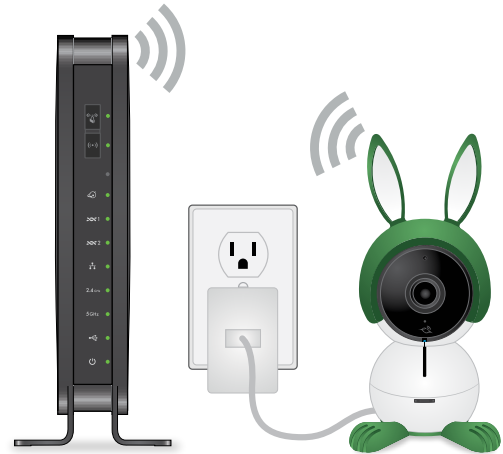

Place Your Camera

You can place your camera on a shelf or other flat surface, or you can mount it on the wall.

Note: Do not cover or obstruct the inlet holes for the sensors.



STRANGULATION HAZARD – Children have STRANGLED in cords. Keep cord out of the reach of children (more than 3ft (.9m) away).

If you are mounting the camera on a wall, place the wall plate and secure it with the included screws.

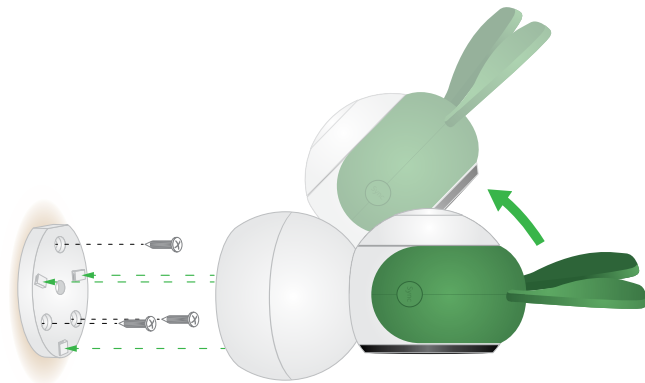

Align the wall plate with the holes on the base of the camera and rotate the base until it snaps into place.

Use Arlo Baby's tilt and swivel functions to position the camera so that it captures the area that you want to monitor.

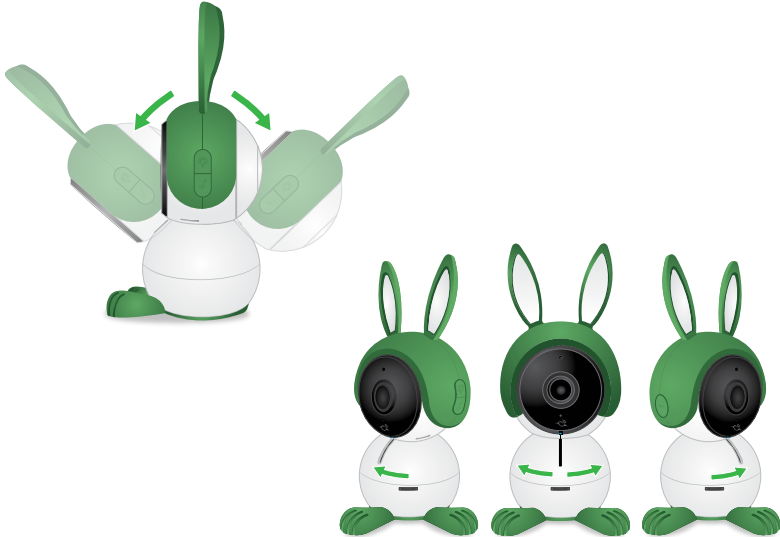

You're Done!

Congratulations! Your Arlo Baby camera is set up and ready to go.

To view useful tutorial videos, find troubleshooting tips, or get support, visit support.arlo.com.

Arlo Baby Features

➤ Rechargeable Battery

Your Arlo Baby camera includes a built-in rechargeable battery and can work for several hours at a time without being plugged in. You can place the camera in locations where you cannot connect it to a power outlet.

Use the switch on the bottom of the camera to power the Arlo Baby camera's battery off. The camera's battery is on when the green color is visible.

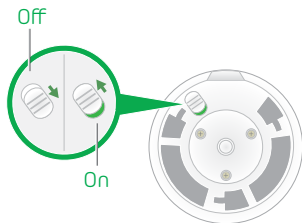

If the camera is unplugged and you don't want the battery to lose its charge, set the switch to off.

➤ Night Light

Use the app or the top button on the right side of the camera to turn the night light on and off.

➤ Music

Use the app or the bottom button on the right side of the camera to play and pause music.



Arlo Baby Characters

Arlo Baby cameras come with a bunny character set. You can remove the bunny character set and replace it with other Arlo Baby characters.

- Pull the character ears up to remove them.
- To install character ears, align the ears with the camera lens and press them onto the camera.
- Rotate the character feet and pull them off to remove them.
- To install character feet, align the foot plate with the holes on the bottom of the camera and rotate the foot plate until it clicks into place.

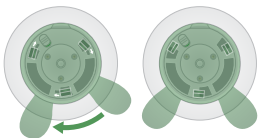

Camera LED Guide



- Solid blue**
The camera is powered on and is connected to the Internet.
- Solid purple**
The camera is connected to a WiFi network. However, it is not connected to the Internet.
- Solid amber**
The camera is booting.
- Fast blinking blue**
The camera is connecting to the Internet.
- Blinking purple**
The camera is too far away from the router.
- Double blink amber every 10 seconds**
The camera battery charge is low.
- Fast blinking blue for three seconds**
The camera was connected to a charger.
- Blinking blue and amber**
A firmware update is in progress. DO NOT TURN OFF THE CAMERA.
- Off**
The camera is powered off.
- Fast blinking amber**
The camera is not connected to a WiFi network.

©NETGEAR, Inc., NETGEAR, the NETGEAR Logo, and Arlo are trademarks of NETGEAR, Inc.

Compliance

For the current EU Declaration of Conformity, visit
kb.netgear.com/app/answers/detail/a_id/11621/.

For regulatory compliance information, visit
netgear.com/about/regulatory/.

NETGEAR®

350 East Plumeria Drive
San Jose, CA 95134, USA



201-21289-06



NETGEAR INTL LTD

Building 3, University Technology Centre
Curraheen Road, Cork, Ireland

April 2017

Two thick, curved green lines at the bottom of the page, one above the other, curving from left to right.