

COSORI

ORIGINAL

Coffee Warmer

Model No.: CO194-CW

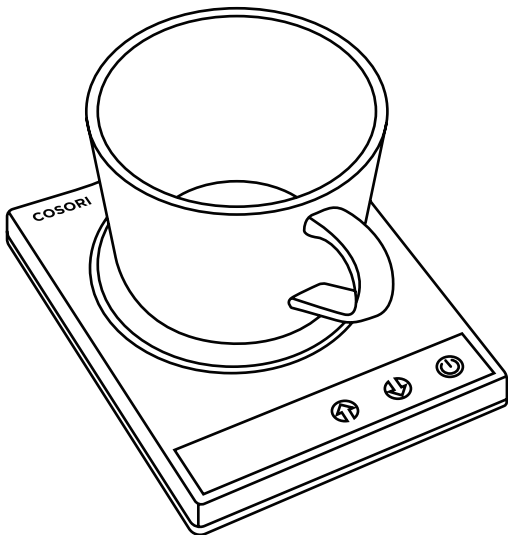

COSORI SUPPORT:

Mon - Fri 9:00 AM - 5:00 PM PST
(888) 402-1684 | support@cosori.com

With Heartfelt Thanks

We thank you for purchasing a new Original Coffee Warmer, and we're excited to see what you'll be drinking very soon.

We're looking forward with you to preparing many fresh meals in your kitchen with minimal operation or effort. And when we say "with you," we mean it—our helpful customer support team is available by phone at 888-402-1684 or by email at support@cosori.com. We're here to lend an ear to your questions and concerns (or your joy over a successful recipe). Happy cooking!

Table of Contents

Keeping Things Safe	5
Getting to Know Your Coffee Warmer	6
How Does It Work?	7
Care & Maintenance	8
Warranty	9
Customer Support	10
Connect With Us	11

Package Contents

- 1 x Coffee Warmer
- 1 x User manual

Specifications

AC Adapter	
Input:	AC 100-240V, 50-60Hz
Output:	12V, 3A

Warmer	
Input:	DC 12V, 3A
Rated Power:	24W
Temperature Range:	77°-230°F (25°-110°C)
Dimensions (L x W x H):	4.2" x 5.3" x 0.7"

Keeping Things Safe

IMPORTANT SAFEGUARDS

Please read, understand, and comply with all the instructions provided in this manual before using the device. Failure to comply with the instructions given in this manual and/or using the device in ways other than the ones mentioned in this manual may result in serious injury and/or damage to the product.

- **DO NOT** touch hot surfaces. Always use caution when near or working with a hot surface.
- To protect against electric shock, do not immerse the coffee warmer or AC/DC adapter in water or any other liquid.
- Close supervision is necessary when this appliance is being used by or near children. **DO NOT** allow children to play with this device.
- This appliance is not intended for use by persons (including children) with reduced physical,

sensory or mental capabilities, or lack of experience and knowledge, unless they have been given supervision or instruction by a responsible person.

- Always unplug the coffee warmer when it is not being used.
- Allow the warmer to completely cool down before cleaning or storing.
- **DO NOT** operate this appliance if the cord, plug, or the appliance itself is damaged in any way. Contact customer service if your coffee warmer has been damaged.
- **DO NOT** attempt to repair or take apart the coffee warmer for any reason. Doing so will void your warranty.
- **DO NOT** use replacement parts from other coffee/mug warmers to repair this appliance.
- Always use extreme caution when moving cups containing hot liquids.

Getting to Know Your Coffee Warmer

- **DO NOT** cook foods on this appliance, as it does not reach safe temperatures for proper food preparation.
- **DO NOT** use this appliance outdoors; it is only intended to be used indoors.
- **DO NOT** place this appliance on or near a hot gas or electric stove or inside a heated oven.
- **DO NOT** let the cord hang over the edge of a table or counter or near a hot surface.
- To prevent electric shock, always connect the AC/DC adapter to the coffee warmer first, then plug the adapter into a wall outlet.
- **DO NOT** use this appliance for anything other than its intended use.

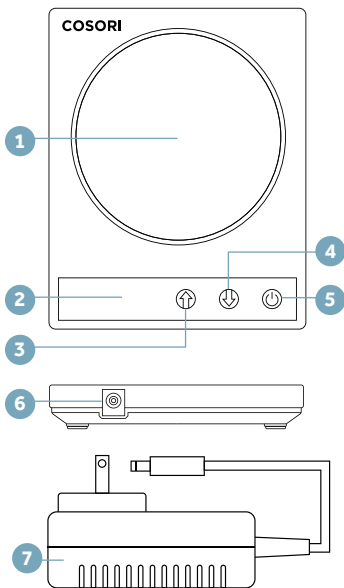

1. Heating Surface
2. Temperature display
3. Increase temperature
4. Decrease temperature
5. Power button
6. DC in-port
7. AC/DC adapter

SAVE THESE INSTRUCTIONS

How Does It Work?

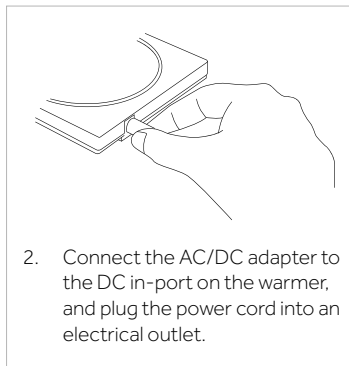
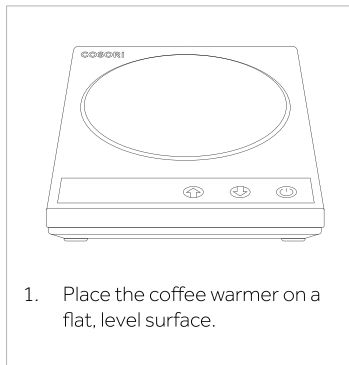

3. Press the power button to turn on the warmer. the warmer will begin to heat up.

4. (Optional) You can program a custom temperature using the '↑' and '↓' buttons. The temperature can be set anywhere from 77° to 230°F (25° to 110°C). Once you have set your desired temperature, the display will flash 3 times and the warmer will begin to heat up.

NOTE:

The temperature on the display shows the temperature of the heating plate, not the actual temperature of the liquid in your cup. Please note that the actual temperature of the liquid is affected by the thickness of your cup. For best results, use heat-safe cups that are thin and have a flat bottom.

5. (Optional) To change temperature units, press and hold '⬆️' and '⬇️' simultaneously for 3 seconds. The units will change from "°F" to "°C."

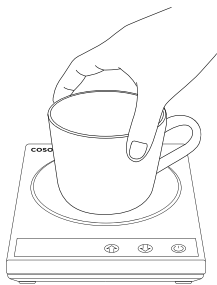

6. Place a heat-safe mug or container of your choice directly onto the heating surface.



7. Press the power button to turn off the warmer when you are finished.

Care & Maintenance

- Unplug the warmer and allow the heating surface to completely cool down before cleaning.

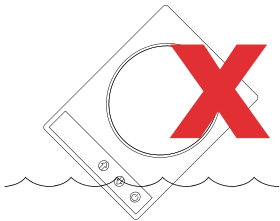

- **DO NOT** immerse the warmer in water or liquids.
- Use a damp cloth to wipe down the surface of the warmer. Dry immediately with a clean dry cloth.

Warranty

Terms & Policy

Cosori warrants all products to be of the highest quality in material, craftsmanship and service for a minimum of 1 year, effective from the date of purchase. Warranty lengths may vary between product categories. Cosori will replace any product found to be defective due to manufacturer flaws based on eligibility; refunds are available within the first 30 days of purchase. This warranty extends only to personal use and does not extend to any product that has been used for commercial, rental, or any other use in which the product is not intended for. There are no warranties other than the warranties expressly set forth with each product.

This warranty is non-transferrable. Cosori is not responsible in any way for any damages, losses or inconveniences caused by equipment failure or by user negligence, abuse, or use noncompliant with the user manual or any additional safety, use, or warnings included in the product packaging and manual.

This warranty does not apply to the following:

- Damage due to abuse, accident, alteration, misuse, tampering or vandalism.
- Improper or inadequate maintenance.
- Damage in return transit.
- Unsupervised use by children under 18 years of age.

Cosori and its subsidiaries assume no liability for damage caused by the use of the product other than for its intended use or as instructed in the user manual. Some states do not allow this exclusion or limitation of incidental or consequential losses so the foregoing disclaimer may not apply to you. This warranty gives you specific legal rights and you may also have other rights which may vary from state to state.

ALL EXPRESSED AND IMPLIED WARRANTIES, INCLUDING THE WARRANTY OF MERCHANTABILITY, ARE LIMITED TO THE PERIOD OF THE LIMITED WARRANTY.

Should your product prove defective within the specified warranty period, please return the defective unit in its original packaging with (1) an original copy of the invoice, (2) your order confirmation number, (3) and your warranty ID number.

To find out more about extending your warranty, visit www.cosori.com/warranty or contact customer support.

Date of Purchase:

Purchased From:

Order Number:

We're One Call (or Email) Away!

Should you encounter any issues or have any questions regarding your new product, feel free to contact our helpful Customer Support Team. Your satisfaction is our goal!

CUSTOMER SUPPORT

Cosori Corporation
1202 N. Miller St. Suite A
Anaheim, CA 92806

Phone: (888) 402-1684
Email: support@cosori.com

SUPPORT HOURS

Monday - Friday: 9:00 am - 5:00 pm PST

*Please have your order confirmation number ready before contacting customer support.

Show Us What You're Making

We hope this has been helpful to you. We can't wait to see your beautiful results, and we think you'll want to share glam shots! Others already in the community await your uploads—just pick your platform of choice below. Snap, hashtag, and tag away, Cosori chef!

#iCookCosori



@cosoricooks



Cosori Appliances

Considering what to cook? Many recipe ideas are available, both from us and the Cosori community.

More Cosori Products

Lastly, if you're happy with this pressure cooker, the line doesn't stop here. Check out www.cosori.com for a line of all our beautiful and thoughtfully designed cookware. They might be right at home in your kitchen, too!

COSORI

COSORI SUPPORT:

Mon - Fri 9:00 AM - 5:00 PM PST

(888) 402-1684 | support@cosori.com