

# SIMWAY D400-1

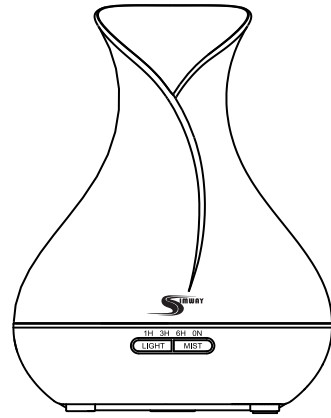

**Aroma Diffuser**

Aroma Diffuser

User Manual

Thank you for purchasing SIMWAY aroma diffuser. Enjoy aromatherapy with soothing LED changing light with one click of your finger tip.

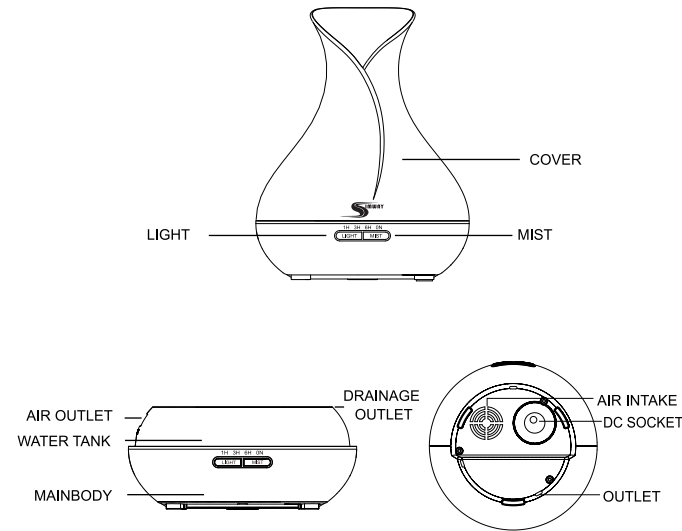

Aroma Diffuser

User Manual

## OPERATION

- Keep the product on a flat surface. Remove the cover in vertical direction. (Refer to **Figure 1**)
- Connect the AC adaptor to the base of DC socket. (Refer to **Figure 2**)
- Fill the water tank with clean tap water by using the measuring cup. Ensure the water does not exceed the maximum waterline (400mL). DO NOT spill any water outside the tank. DO NOT add water when diffuser is operating. Add 2-3 drops essential oil is recommended for maximum amount of water. (Refer to **Figure 3**)
- Put the cover back in position. DO NOT slide or lean the product because it may cause short circuit if water accidentally drips to the circuit board. (Refer to **Figure 4**)
- Connect the product to the power supply.
- Press the "MIST" button to choose the timer for 1 hour, 3 hours, 6 hours, or ON for continuous mist until the water runs out. Another press on "MIST" after ON mode will switch OFF the mist. Hold the "MIST" button to select 6 hours High Mist Mode (1 beep) and 12 hours Low Mist Mode (2 beeps). The diffuser will automatically turn off when there is no sufficient water in the water tank. (Refer to **Figure 5**)
- Press the "LIGHT" button to illuminate the LED color. The LED light changes the color in order of red, orange, yellow, green, cyan, blue, and magenta. Another few presses of the "LIGHT" button will set the color, and enable to adjust the light intensity. (Refer to **Figure 6**)



Figure 1



Figure 2



Figure 3

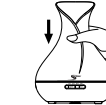

Figure 4



Figure 5



Figure 6

Aroma Diffuser

User Manual

## ACCIDENTAL LEKAGE

In the event of the unit being knocked over or tipped during use, please follow the steps as below to avoid malfunction:

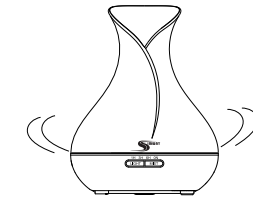

- Unplug the unit and remove the cover.
- Pour out any remaining water from the water tank.
- Hold the unit up side down and shake away the water drops. Then keep the unit in ventilated area until it dries.

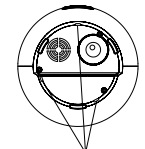
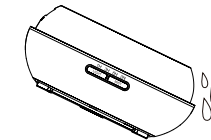

OUTLET

Aroma Diffuser

User Manual

## MAINTENANCE

After using 5-6 times, or 3-5 days, please clean the product as follow:

- Disconnect the AC adaptor from the power supply, take off the cover while keeping the unit stable on a line.
- If there's water left in the tank, pour it from the drain side. DO NOT pour from the air inlet side or else water may flow in the unit.
- Disconnect the DC plug from the unit.
- Use a gentle diluted kitchen detergent on a damp cloth to remove any fragrance oil residue, ensuring no detergent remains.  
**IMPORTANT:** DO NOT press heavily or scratch the ultrasonic mechanism in the water tank during cleaning.
- Add water into the tank with the water cup, activate the unit to operate for 30 minutes. Clean it after pouring out the remaining water.
- Please keep the unit in a dry and cool place if it is not going to be used for a period of time. Clean it with neutral detergent before reusing.

Aroma Diffuser

User Manual

## PRECAUTIONS

Please check below to avoid malfunction of the unit:

- Do not fill over 400mL of water at any time.
- Do not turn on the unit when the water tank is empty.
- Do not turn touch the ultrasonic vibration plate.
- Clean regularly as per Maintenance instructions to avoid malfunction.
- Always unplug from power supply before maintenance.
- For hygiene reasons, pour away remaining water from the "DRAIN SIDE" of the tank after use, and wipe with a clean dry cloth.
- Essential oil may stain. In the event of spillage, please wipe away with a soft cloth.
- Please only use the measuring cup to add water into the water tank.
- Do not let mist vent directly to furniture, clothing, wall etc.
- Keep away the unit from direct sunshine, heat sources, and air conditioners.
- Always keep the unit on a stable and flat surface. Do not place the unit on carpet, duvet or unstable area.
- Keep away the unit from other electronic devices.
- Do not tip the unit, which may cause water flows to the circuit board and cause malfunction.
- Use tap water only. Do not use mineral water or sparkling water etc.
- Do not move the unit when operating.
- Do not use the product with wet hands.
- Keep away from children and pets.
- Keep cord pathways clear, and do not pull forcefully at any point.
- Unplug the unit from power supply immediately if smoke or burning smell is detected.

Aroma Diffuser

User Manual

## TROUBLESHOOTING

Please refer to the table below in the event the product operates abnormally.

| If product doesn't work well, please refer to the following points before requesting repairs: |   |
|---|---|
| Will not switch on or switch off  | <ul style="list-style-type: none"> <li>Is there enough water in the tank?<br/>--Please add water into the tank.</li> <li>Is the power cord connected properly?<br/>--Please disconnect, check cables and re-connect carefully.</li> </ul>   |
| No mist or abnormal mist  | <ul style="list-style-type: none"> <li>Not enough water? or too much water?<br/>--Please add suitable amount of water in the tank, water must never be filled over 400mL (MAX) line.</li> <li>Dirt on the ultrasonic plate?<br/>--Please follow the steps in the maintenance instructions to clean the product.</li> <li>Dirt on the air suction port on the underside of the base?<br/>--Too much duct in the air suction port may block the air flows into the product to fan the mist out of the unit. Please clean the dust from the air suction port before use it.</li> </ul> |
| Water leakage   | <ul style="list-style-type: none"> <li>Outer and inner covers are not installed properly?<br/>--Remove the cover, and reattach the inner cover and outer cover correctly to ensure the mist can flow through the vent.</li> <li>Low temperature or high humidity?<br/>--Under these conditions, the mist may condense quickly into water droplets.</li> </ul>   |

Aroma Diffuser

User Manual

## SPECIFICATIONS

|                            |  |
|----------------------------|--|
| Size                       | Approximate 6.63 x 8.46in.             |
| Weight                     | Approximate 1lb.                       |
| Input Power / Output Power | AC100-240V 50/60Hz DC24V 650mA         |
| Power Cord Length          | Approximate 5.58ft.                    |
| Electric Consumption       | Approximate 14W                        |
| Mode                       | 1H / 3H / 6H / ON                      |
| Water Tank Capacity        | 400mL                                  |
| LED Light                  | 3 Pieces                               |
| Material                   | PP, ABS, PC                            |
| Accessories                | AC Adaptor, Water Cup, and User Manual |
| Ultrasonic Frequency       | 2.4MHz                                 |

Aroma Diffuser