

**nutriChef**TM
Convenient kitchen style

ELECTRIC MULTI ROASTER



USER MANUAL

MODEL: **PKFG14**

FEATURES

- Perfect for Fish, Seafood, Meats, & Vegetables
- Top & Bottom Panel Heating Element Cookers
- No Need for Turning or Flipping Your Food
- Built-in Filter Reduces Smoke & Odors
- Add Water to Steam Your Food
- Extra-Wide Cooking / Roasting Rack
- Adjustable Time Settings
- Convenient 'Ding' Timer Alarm
- Auto Power-Off Safety Function
- Grease & Oil-Catching Drip Tray
- Removable & Washable Oven Cover & Cook Tray
- Safe Placement on Any Kitchen Table or Countertop
- Easy-to-Clean Metal Housing
- Includes Roasting Grill Rack

SPECIFICATIONS

Heating Element Power: 800 Watt

Maximum Time Setting: 30 Minutes

Housing Material: Carbon Steel

Power Cord Length: 3.9' ft.

Power: 120V

Roasting Rack Size (L x W): 13.8" x 7.3"

Unit Dimensions (L x W x H): 18.9" x 10.7" x 7.9"

Weight: 8.81 lbs.

IMPORTANT SAFEGUARDS

1. When using electrical appliances, basic safety precautions should always be followed, including the following:
2. Read all instructions carefully.
3. Before using the unit, check if the voltage indicated corresponds with the convenience outlet (120V AC)
4. Before using the unit, move it two to four inches away from the wall. Remove any object that may have been on top of the unit.
5. Do not use any appliance with a damaged cord or plug. If the cord is damaged it should be replaced with the same type and size or bring the unit to the nearest authorized service center.
6. Do not use a two-way socket with other high-energy appliances.
7. Do not place on or near gas stove, electric stove or in a heated oven.
8. Do not touch hot surfaces, use handles or knobs.
9. This appliance is not intended for use by persons (including children) with reduced physical, sensory or mental capabilities, or lack of experience and knowledge, unless they have been given instruction concerning use of the appliances by a person responsible for their safety.
10. Children should be supervised to ensure that they do not play with the appliance.
11. Do not use accessories not recommended or sold with this unit.
12. Keep curtains, furniture, flammable materials, etc. away from the unit and from the convenience outlet where the unit is plugged.
13. Extreme caution must be taken in moving an appliance containing hot oil or liquids.
14. Do not use this unit for anything other than its intended use.
15. Do not use metal scouring in cleaning the unit.
16. **CAUTION:** Never leave the unit unattended while cooking.
17. To protect against electric shock, do not immerse the unit in water.
18. Save this instruction manual for future reference.
19. For household use only, not for industrial use.

ASSEMBLY

1. Place the unit on a flat stable surface.
2. Insert the Oil Drip Tray on the Base with Heating Element. Be sure that it is properly fixed.
3. Place the Filter on the smoke vent.
4. Put the Filter Cover on top of the Filter and slide it to the right until you hear a click sound.
5. Insert the Cover Assembly on Top Heating Element. Be sure that it is properly fixed.

DESCRIPTION OF PARTS:

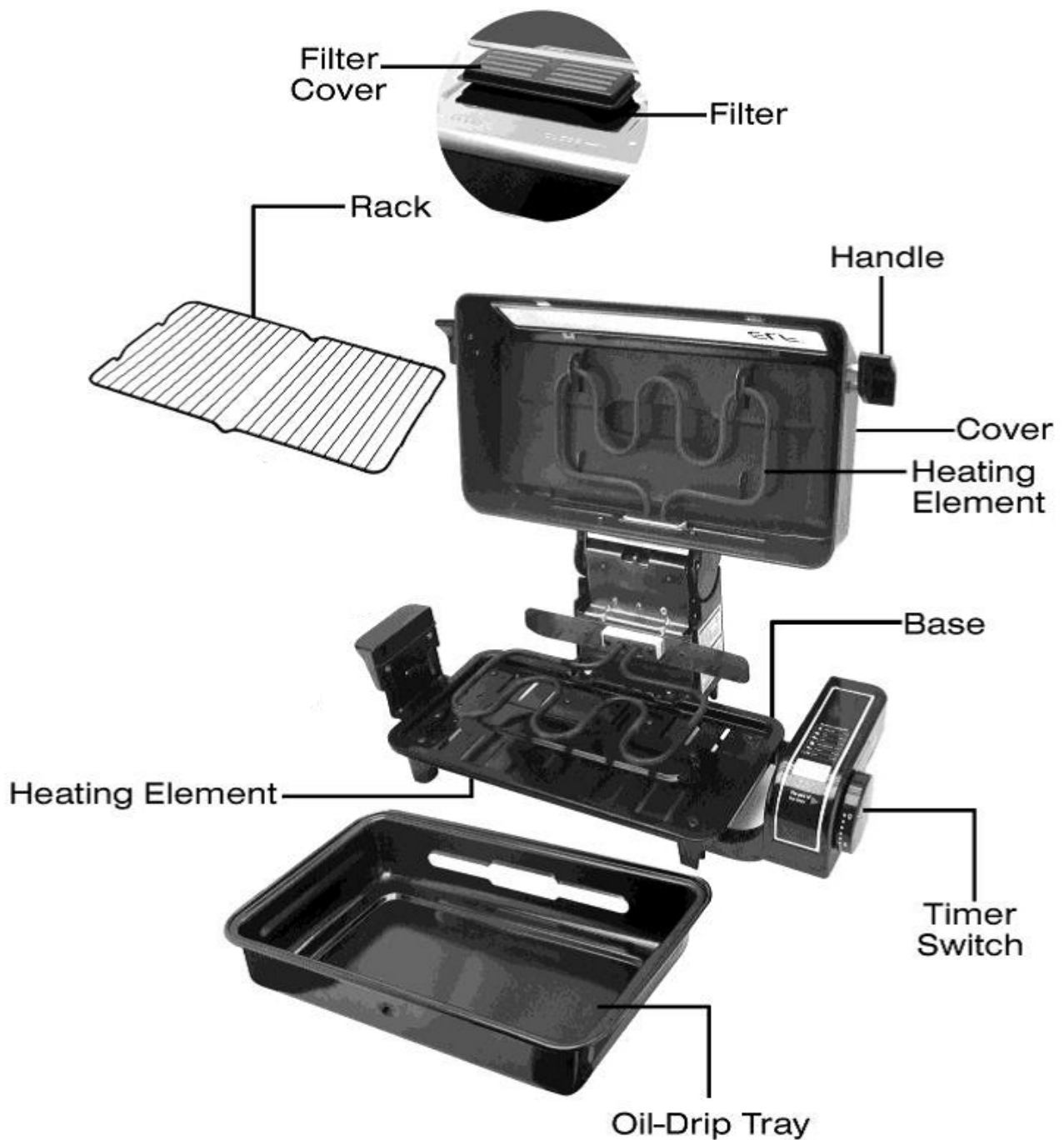

HOW TO USE

1. Plug the unit into the convenience outlet.
2. Pull out Oil Drip Tray and pour (0.3 - 0.6L) water to reduce smoke while cooking. Do not pour water on the Heating Element.
3. Put the food on the non-stick rack.
- 4 Set the timer to desired cooking time.
5. Turn **OFF** after use.

NOTE: For initial use, some smoke may be observed when the unit is turned **ON**, this is normal. Please keep it in start-up for 5 minutes before use.

COOKING TABLE

Squid	7-10 min
Fish	9-12 min
Meat	10-15 min
Shrimp	12-15 min
Chicken	20-25 min
Potato	27-30 min

Note: Cooking time may vary on type and the amount of food to be cooked.

SAFE USE



Don't clean it with volatile substances.

It may lead to damage or fading of the exterior

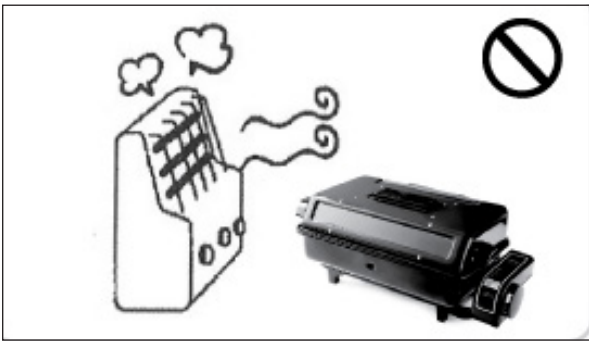

Keep the unit away from other heated objects.

It may lead to fire if the external plastic melts



Don't splash water on the device while in use.

It may lead to failure or an electric shock

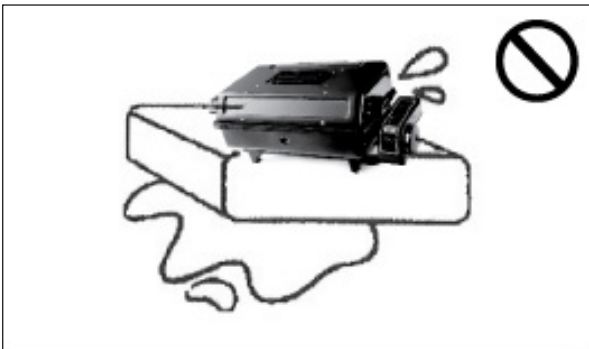

Don't keep the unit in a watery environment.

It may lead to rust or failure.



Please confirm whether some heavy have or time overstock

It may lead to fire or short circuit.

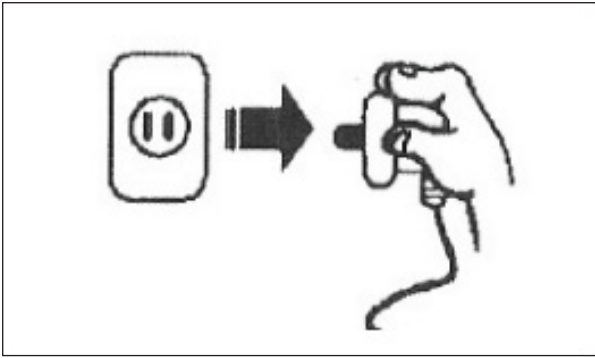

Don't cut off the power supply by pulling out the plug with the electric wire.

It may lead to the wire becoming damaged.



Please pull out the plug if unused.

It may lead to failure.



Don't touch the plug if there is gas leaking.

It may lead to an explosion or fire.



After a thorough cleaning out, the unit and its parts should be dried separately before re-assembly.

It may lead to failure and/or short circuit.

** This device is only intended for domestic use.*

CLEANING AND MAINTENANCE

It is important to thoroughly clean the unit after each use to avoid the buildup of food residue.

1. Turn **OFF** and unplug the unit from the convenience outlet.
2. Allow the unit to cool before putting **ON** or taking **OFF** parts and before cleaning.
3. Cover, Rack, Filter, Filter Cover, and Oil Drip Tray are washable with soap and water.
4. Do not immerse the Base with Heating Element in water. Wipe it with damp cloth.
5. Do not use abrasive materials to avoid scratches.



Do not dispose of electrical appliances as unsorted municipal waste, use separate collection facilities.

