

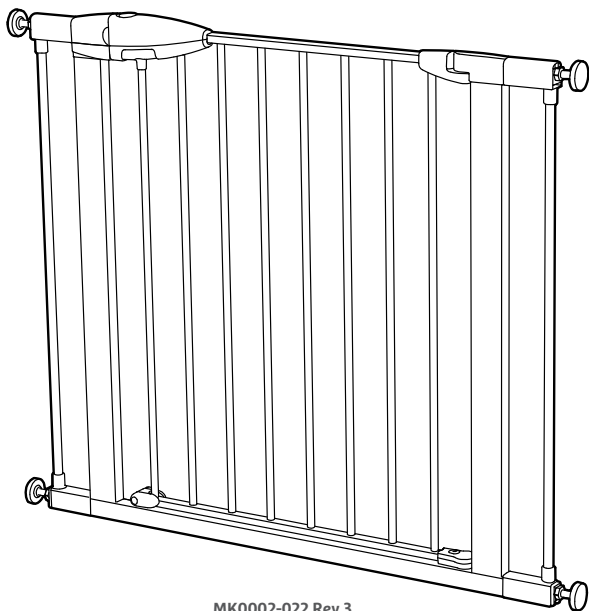





munchkin
Easy Close™ Gate



MK0002-022 Rev 3

KEEP FOR FUTURE REFERENCE

Please read the instructions carefully before installing this gate. For additional help, installation videos are available at www.munchkin.com

-  **IMPORTANT INFORMATION**
- Introduction..... 3
- Disclaimers 3
- Warnings 3
-  **GETTING STARTED**
- Included Parts..... 4
- Step 1: Identify Gate Placement 5
-  **TO INSTALL**
- Step 2: Verify Proper Width..... 6
- Step 3: Remove Extension..... 7
- Step 4: Install Wall Cups..... 8
- Step 5: Mount Your Gate 10
- Extension Configuration..... 14
-  **HOW TO USE**
- Opening Your Gate 12
- Closing Your Gate..... 12
- Adjusting The Swing Guard..... 13
- Cleaning Your Gate..... 13
-  **CUSTOMER SERVICE**
- One Year Limited Warranty 15
- Contact Us 16

INTRODUCTION

Thank you for choosing a Munchkin safety gate to help protect your family. Your gate stays in place by creating pressure between two opposing surfaces.

For maximum security, DO NOT use this gate in any location without installing all 4 wall cups, sticky pads, and screws provided. In some opening only 2 top wall cups can be fitted.

Please inspect your gate immediately. If you see any damage, do not attempt installation. Check page 4 of this manual for information on damaged products.

Assemble the gate away from small children. Some of the parts may present a choking hazard when loose.

PLEASE NOTE: There is a gap between your gate frame and handle. This is not a defect. This gap will close once your gate is properly installed. Please check the gate on a regular basis to ensure that all parts are in proper working condition.

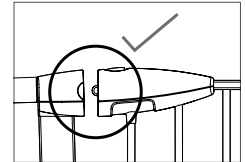

DISCLAIMERS

Any misuse, abuse, abnormal use, excessive wear and tear, improper assembly, negligence, environmental exposure, accident or alteration of the gate, as well as removal or alteration of its serial number, invalidates any and all claims against the manufacturer. Any damage to property during installation is the sole responsibility of the end user.

WARNING:

- To prevent serious injury or death, securely install gate or enclosure and use according to manufacturer's instructions.
- Never use with a child able to climb over or dislodge the gate or enclosure.
- This product will not necessarily prevent all accidents.
- Never leave child unattended.
- Use only with the locking mechanism securely engaged.
- Intended for use with children from 6 months through 24 months of age.
- Stop using gate if any parts are missing or become damaged.
- Periodically check all fasteners to be sure they are tight and secure.
- Adult Assembly Required.
- Safety barriers complies with ASTM F1004.

INCLUDED PARTS

If any parts are missing or damaged, please contact our Customer Satisfaction Team at **1-800-344-2229**.

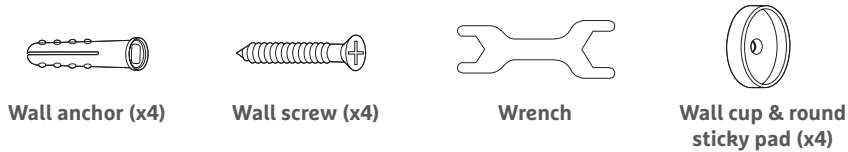
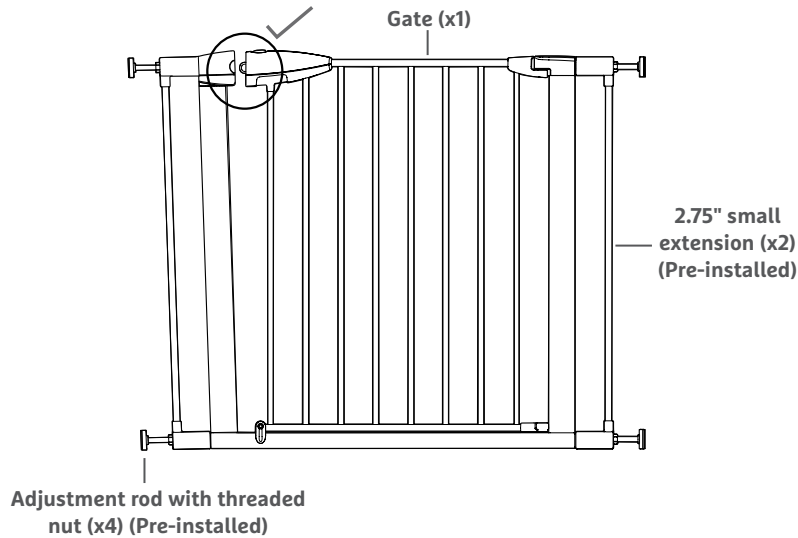

TOOLS NEEDED:

- Drill
- Phillips screwdriver
- Flathead screwdriver
- Pencil
- Tape measure

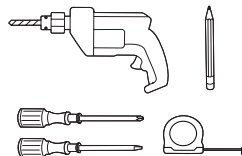

STEP 1: IDENTIFY GATE PLACEMENT

For maximum security, **DO NOT** use this gate in any location without installing all 4 wall cups, sticky pads and screws provided. In some openings only 2 top wall cups can be fitted. The gate must be installed between two structurally sound surfaces.

GATE IS SUITABLE FOR:

TOP OF STAIRS

If installing the gate at the top of stairs, it **MUST** be placed on the top landing and only swing away from the stairs.

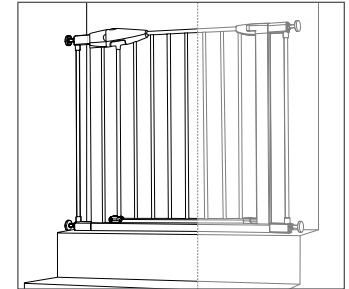

BOTTOM OF STAIRS

If installing the gate at the bottom of stairs, we recommend placing it on the floor. If the gate must be placed on the lowest stair, position it toward the front of the step.

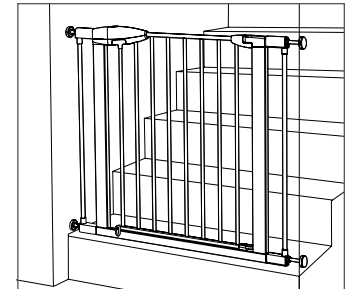

HALLWAYS AND DOORWAYS

Be sure that the gate is resting on the floor. The gate should **NOT** be raised above the floor.

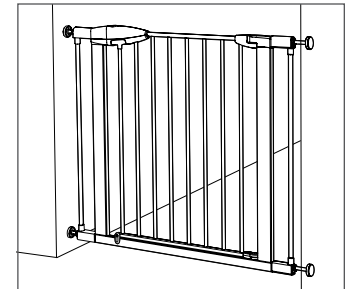

STEP 2: VERIFY PROPER WIDTH

Measure the width of the opening where the gate will be installed. Be sure to measure at the narrowest point between the walls. For example, include any baseboards in your measurement. Then, see below for the proper gate configuration for your opening.

TOOLS NEEDED:
Tape measure



35.4" - 37.8" (89.9CM - 96CM)
Skip to page 8.

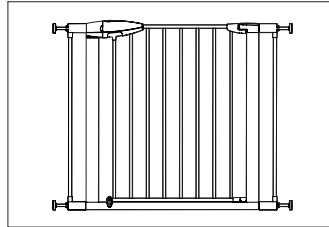
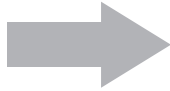

33" - 35" (83.8CM - 88.9CM)
Proceed to page 7.

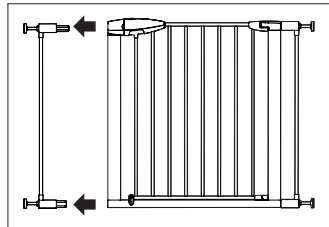
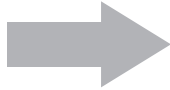

Remove 1 small extension

29.5" - 32.5" (75CM - 82.5CM)
Proceed to page 7.

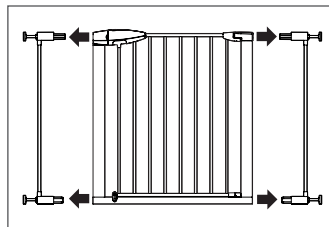

Remove 2 small extensions

Please see page 14 for additional extension configurations.

STEP 3: REMOVE EXTENSION

TOOLS NEEDED:
Flathead screwdriver

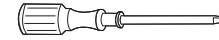

1. Remove the adjustment rods and plugs from the upper and lower side of the gate you are removing the pre-installed extension from. You may need to use a flathead screwdriver to remove the plugs.

2. Remove the pre-installed extension by pulling out the upper and lower extension adapters away from the gate. Store the extension in a safe place in case you move the gate to a wider opening in the future.

3. Reinsert the plugs and adjustment rods you removed earlier back into the gate. Please be sure the slot on the plug is facing down towards the floor. Adjustment rods slide into the plug holes. They **DO NOT** screw.

PLEASE NOTE: For opening 29.5" - 32.5" (75cm-82.5cm), repeat these steps on the other side of the gate to remove the second extension. To add an extension, simply reverse the instructions.

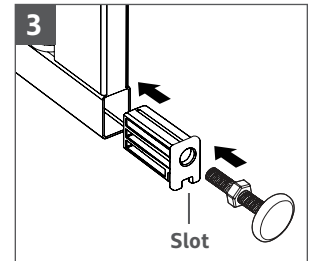
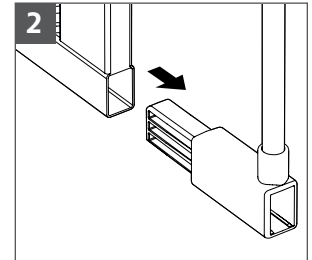
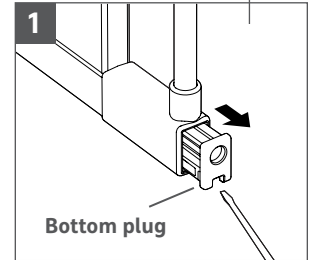
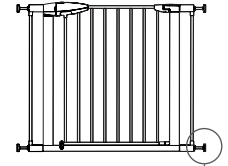

STEP 4: INSTALL WALL CUPS

TOOLS NEEDED:

- Drill
- Phillips Screwdriver
- Pencil

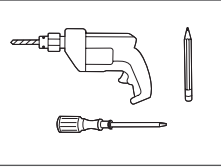

1. Ensure the wall cups are on the end of 4 adjustment rods.
2. Temporarily place the gate where you want to install it, flush against the floor. Pull the adjustment rods out until they reach the walls and trace the position of each wall cup with a pencil.
3. Retract the adjustment rods and set the gate aside for now.
4. Hold the wall cup in position and mark the center with a pencil. Then put the cup aside.
5. Determine whether there is a stud behind the drywall where you will install each wall cup. Proceed to either **6a** or **6b**.

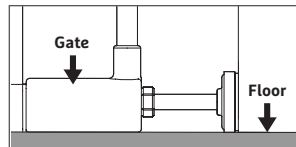
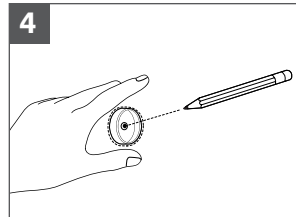
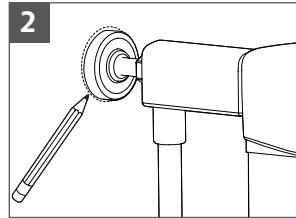

PLEASE NOTE: The gate should be resting on the floor. DO NOT allow a gap of more than 0.196" (5mm) between the gate and the floor.

6a. For Drywall Without Stud / Plasterboard:

Drill a 7/32" (5.5mm) hole into the drywall at the center mark. Insert a drywall anchor.

Peel the back off the sticky pad that is attached to the wall cup. Then stick the wall cup onto the wall to fit your pencil marks.

Use a screwdriver or drill to insert the screw through the center of wall cup into the drywall anchor.

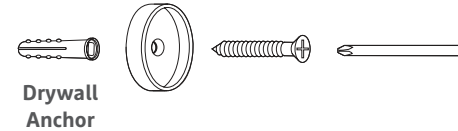

Drywall Anchor

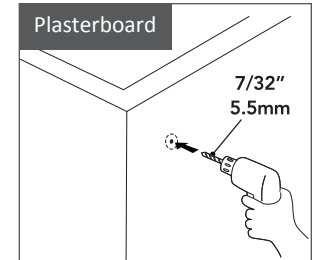
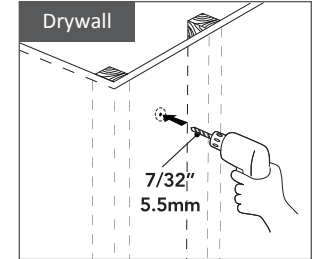

6b. For Drywall with Stud:

Drill a 5/64" (2mm) pilot hole into the stud (no anchor needed).

Peel the back off the sticky pad that is attached to the wall cup. Then stick the wall cup onto the wall to fit your pencil marks.

Use a screwdriver or drill to insert the screw through the center of the wall cup into the stud.

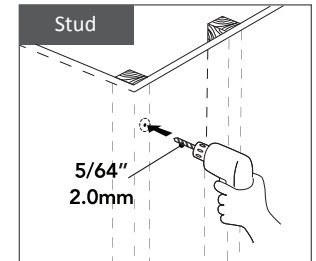
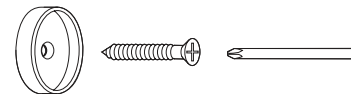

STEP 5: MOUNT YOUR GATE

1. Place the gate where you want to install it, then extend all 4 adjustment rods until they reach the walls. Ensure that the ends of the adjustment rods are seated inside the cups.

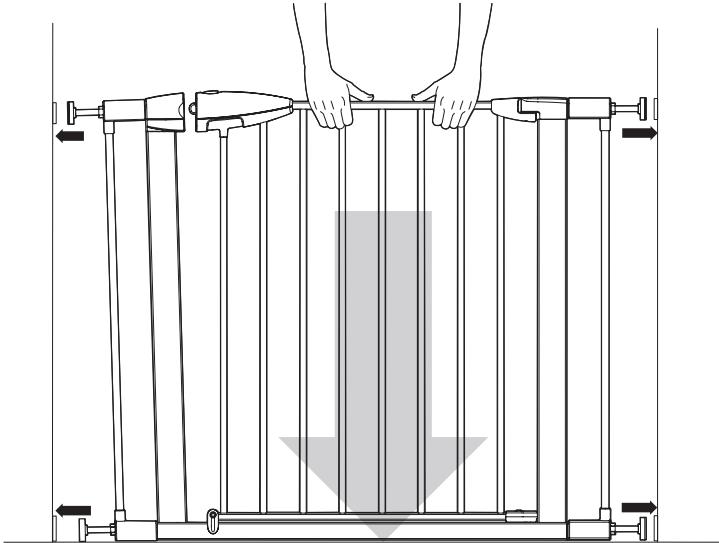

TOOLS NEEDED:
Wrench

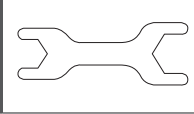

2. Use the wrench to tighten the nuts on all 4 threaded adjustment rods until the gate is secure. Tighten each nut a little at a time, starting at the bottom of the gate, then move to the upper hinge-side, and lastly the upper handle side.

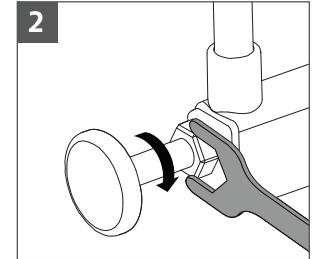

3. The nuts should be tightened until the handle latch locks into the frame.

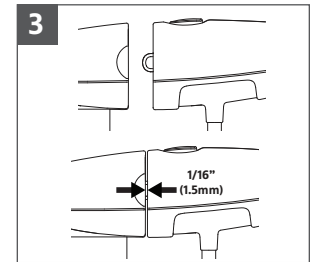

PLEASE NOTE: DO NOT overextend the adjustment rods. If the gate is more than 2.5" from the wall, you must add an extension. See page 14 for additional extension configurations.

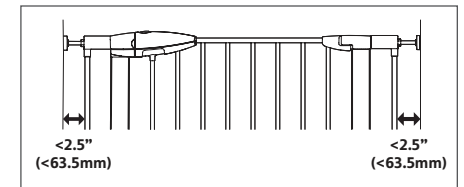

OPENING YOUR GATE

Push the button on top of the handle with your thumb, then squeeze the trigger on the handle's underside at the same time. Pull the handle upward to swing the gate open.

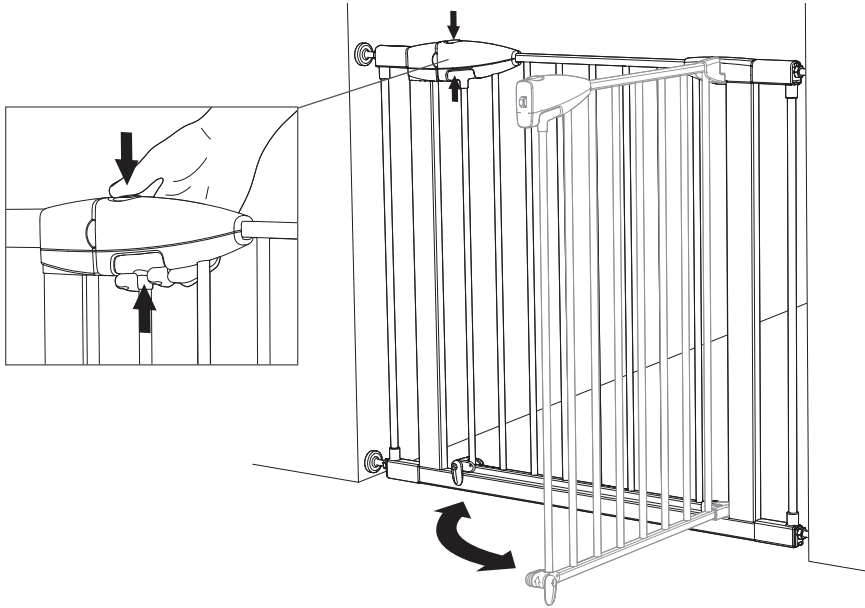

CLOSING YOUR GATE

Your gate has an easy-close feature. You can leave the gate in the open position and when ready, simply push the gate door closed until it clicks.

PLEASE NOTE: Always check the handle to make sure that the gate is securely locked and never leave your child unattended.

ADJUSTING THE SWING GUARD

If the gate is placed at the top or bottom of stairs, always lower the swing guard into its locked position on the opposite side of the gate from the stairs. This prevents the gate from opening into the stairway.

In other locations, be sure to lower the swing guard into its locked position on the side of the gate that the child occupies.

To fully lock, lower the swing guard to the locked position on both sides of the gate.

CLEANING YOUR GATE

Use mild soap and wipe with a damp cloth. Be careful NOT to wash or wipe the stickers on the base of the gate.

Removing or damaging the stickers will void the warranty.

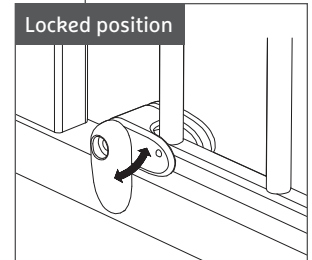
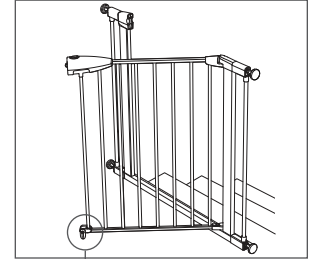

EXTENSION CONFIGURATIONS

Additional extensions can be purchased at www.munchkin.com

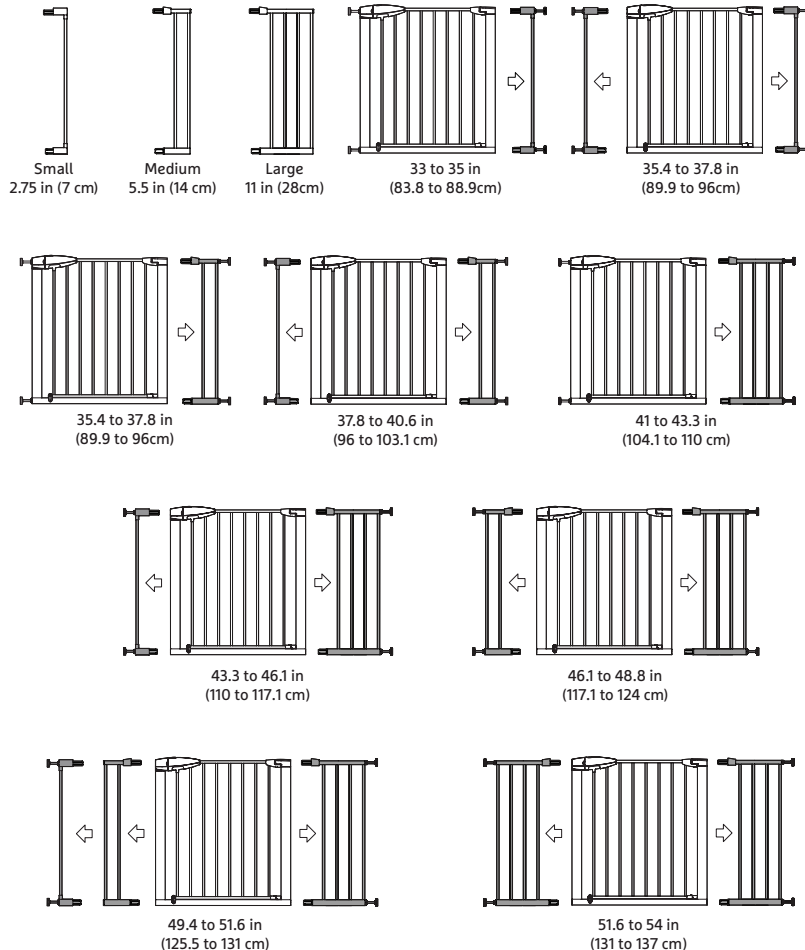

ONE-YEAR LIMITED WARRANTY

A. Munchkin, Inc.'s safety gates include a one-year limited warranty from the date of purchase.

POLICY: In the event of a malfunction or defect during the in-warranty period, Munchkin, Inc., at its option, will replace or repair a gate under warranty. Munchkin, Inc.'s limited warranty extends only to the gate's original purchaser.

PROCEDURE: We ask that you contact Munchkin, Inc. to provide all pertinent information relating to any issues you are experiencing with your safety gate. Munchkin, Inc.'s Customer Satisfaction Team can be reached at **1-800-344-2229** Monday through Friday from 8am to 5pm (Pacific Time) or by email at **cserv@munchkin.com**. The following information, when applicable, is required for all warranty claims:

- Gate Name
- Model Number
- Date Code
- Receipt Copy

This may be faxed, emailed, or sent via mail to Munchkin, Inc. to the attention of Customer Satisfaction.

ATYPICAL ISSUES: For atypical issues that require physical review, Munchkin, Inc. will request that you return your gate to its Quality Assurance department. Munchkin, Inc. will compensate you for shipping costs by providing a complimentary gift equal in value to the expense incurred in shipping the product. Alternatively, Munchkin, Inc. at its option, may issue a UPS call tag in order to expedite receipt of the defective product for review.

B. Conditions that void Munchkin, Inc.'s one-year limited warranty.

POLICY: Munchkin, Inc.'s one-year limited warranty does not cover a defect that has been caused by misuse, abuse, abnormal use, excessive wear and tear, improper assembly, negligence, environmental exposure, alteration or accident. Important Note: A safety gate that has had its batch code altered or removed invalidates any and all claims against the manufacturer.



C. CONSUMER REIMBURSEMENT: Munchkin, Inc. does not provide refunds as a remedy for defective or nonconforming safety gates. Nor does Munchkin, Inc. offer cash back for returned product purchased through any of Munchkin, Inc.'s safety gate websites. Exception: Munchkin, Inc. will provide cash back refund on purchases made through any of Munchkin, Inc.'s safety gate websites ONLY if there was a processing or shipping error made by Munchkin, Inc. Contact Customer Satisfaction Team with any questions at **1-800-344-2229**.

CONTACT US

If you have any questions about installing your gate, or if you wish to provide comments about this product, feel free to contact our Customer Satisfaction Team at **1-800-344-2229** (M-F from 8:00am-5:00pm PST) or visit our website at **www.munchkin.com**

