



Installation instructions for part 95-2001

GM Multi Kit 1990-2012 95-2001

KIT FEATURES

- ISO DDIN radio provision



KIT COMPONENTS

- A) Radio trim plate • B) Radio brackets • C) Spacers • D) (3) #8 x 1 Phillips screws • E) (3) #8 Speed clips

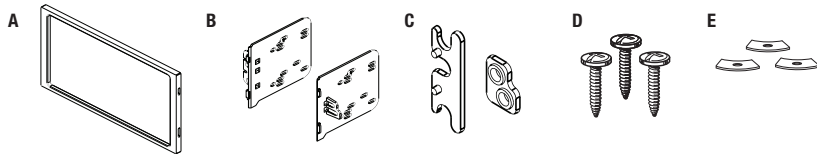

WIRING & ANTENNA CONNECTIONS (sold separately)

Wiring Harness: • Please visit metraonline.com for more information

Antenna Adapter: • 40-GM10 • 40-CR10

TOOLS REQUIRED

Phillips screwdriver • Socket set

Table of Contents

– See Pages 2 & 3

CAUTION! Metra recommends disconnecting the negative battery terminal before beginning any installation, unless the vehicle manufacturer recommends against so. Please check with your local Dealership for more information. All accessories, switches, climate controls panels, and especially air bag indicator lights must be connected before reconnecting the battery or cycling the ignition. Also, do not remove the factory radio with the key in the on position, or the vehicle running. It would be best to remove the key from the ignition and then wait a few seconds before removing the factory radio.

Applications

Buick

Century.....	1997-2005
Le Sabre.....	1995-2005
Park Avenue.....	1995-2005
Rainier.....	2004-2007
Regal.....	1995-2004
Rendezvous.....	2002-2007
Riviera.....	1996-1999
Roadmaster.....	1995-1996
Skylark.....	1996-1998

Cadillac

Escalade, Escalade ESV & EXT.....	2003-2006
--------------------------------------	-----------

Chevrolet

Avalanche.....	2003-2006
Blazer.....	2002-2005
Cavalier.....	2000-2005
Colorado.....	2004-2012
Express Van (full size)....	2001-2007
Impala.....	2000-2005
Kodiak.....	2003-2009
Malibu.....	2001-2003
Malibu Classic.....	2004-2005
Monte Carlo.....	2000-2005
S-10.....	
(with double DIN radio) ..	2002-2004

Chevrolet (continued)

Silverado.....	2003-2006
Silverado Classic.....	2007
Suburban.....	2003-2006
Tahoe.....	2003-2006
Trailblazer.....	2002-2009
Venture.....	2000-2005

GMC

Canyon.....	2004-2012
Envoy.....	2002-2009
Savanna.....	2001-2007
Sierra.....	2003-2006
Sierra Classic.....	2007
Sonoma.....	
(with double DIN radio) .	2002-2004
TopKick.....	2005-2009
Yukon.....	2003-2006

Hummer

H2.....	2003-2007
---------	-----------

Isuzu

Ascender.....	2003-2008
H-Series.....	2003-2008
I-290/I370.....	2007-2008
I-280/I350.....	2006

Oldsmobile

Achieva.....	1996-1998
Alero.....	1999-2004
Aurora.....	1995-2003
Bravada.....	1998-2004
Cutlass.....	1997-1999
Cutlass Supreme.....	1995-1997
Eighty-Eight.....	1994-1999
Intrigue.....	1998-2002
LSS.....	1996-1999
Ninety-Eight.....	1994-1996
Regency.....	1997-1998
Silhouette.....	2000-2004

Pontiac

Aztec.....	2001-2005
Bonneville.....	2000-2005
Grand Am.....	2001-2005
Montana.....	2000-2005
Sunfire.....	2000-2005

Table of Contents

Dash Disassembly

- Buick Century 1997-2005.....	3
- Buick Le Sabre 1995-2005.....	4
- Buick Park Avenue 1995-2005.....	4
- Buick Rainier 2004-2007.....	11
- Buick Regal 1995-2004.....	3
- Buick Rendezvous 2002-2007.....	4
- Buick Riviera 1996-1999.....	5
- Buick Roadmaster 1995-1996.....	5
- Buick Skylark 1996-1998.....	6
- Cadillac Escalade, Escalade ESV & EXT 2003-2006.....	6
- Chevrolet Avalanche 2003-2006.....	6
- Chevrolet Blazer 2002-2005.....	6
- Chevrolet Cavalier 2000-2005.....	7
- Chevrolet Colorado 2004-2008.....	7
- Chevrolet Express Van (full size) 2001-2002.....	8
- Chevrolet Express Van (full size) 2003-2007.....	8
- Chevrolet Impala 2000-2005.....	9
- Chevrolet Kodiak 2003-2009.....	6
- Chevrolet Malibu 2001-2003.....	9
- Chevrolet Malibu Classic 2004-2005.....	9
- Chevrolet Monte Carlo 2000-2005.....	9

Table of Contents

- Chevrolet S-10 (with double DIN radio) 2002-2004	6	- Oldsmobile Alero 1999-2004.....	13
- Chevrolet Silverado/Classic 2003-2007	6	- Oldsmobile Aurora 1995-2003	13
- Chevrolet Suburban 2003-2006	6	- Oldsmobile Bravada 1998-2001	6
- Chevrolet Tahoe 2003-2006	6	- Oldsmobile Bravada 2002-2004	11
- Chevrolet Trailblazer 2002-2009.....	10	- Oldsmobile Cutlass 1997-1999	13
- Chevrolet Venture 2000	10	- Oldsmobile Cutlass Supreme 1995-1997	13
- Chevrolet Venture 2001-2005.....	10-11	- Oldsmobile Eighty-Eight 1994-1999.....	13
- GMC Canyon 2004-2008	7	- Oldsmobile Intrigue 1998-2002.....	14
- GMC Envoy 2002-2007	11	- Oldsmobile LSS 1996-1999	14
- GMC Savanna 2001-2002	8	- Oldsmobile Ninety-Eight 1994-1996.....	14
- GMC Savanna 2003-2007	8	- Oldsmobile Regency 1997-1998	14
- GMC Sierra/Classic 2003-2007	6	- Oldsmobile Silhouette 2000.....	10
- GMC Sonoma (with double DIN radio) 2002-2004.....	6	- Oldsmobile Silhouette 2001-2004.....	10-11
- GMC TopKick 2005-2009	6	- Pontiac Aztec 2001-2005	14
- GMC Yukon 2003-2006	6	- Pontiac Bonneville 2000-2005.....	15
- Hummer H2 2003-2007	12	- Pontiac Grand Am 2001-2005	15
- Isuzu Ascender 2003-2005	11	- Pontiac Montana 2000	10
- Isuzu H-Series 2003-2008	6	- Pontiac Montana 2001-2005.....	10-11
- Isuzu I-290/I370 2007-2008	7	- Pontiac Sunfire 2000-2005	15
- Isuzu I-280/I350 2006.....	7		
- Oldsmobile Achieva 1996-1998.....	12-13	Kit Assembly	16

Buick Century 1997-2005 Buick Regal 1995-2004

1. Remove the plastic trim piece to the left of the glove box and (1) Phillips screw exposed.
2. Unsnap the top edge of the knee bolster panel.
3. Remove (1) Phillips screw from the panel.
4. Remove the ashtray cluster and (2) Phillips screws from each side.
5. Unclip the entire dash trim bezel and remove.
6. Open doors and unsnap end caps from each side of dash.
7. Unsnap and remove radio/instrument cluster panel.
8. Remove (3) screws in order to remove radio.

Continue to kit assembly

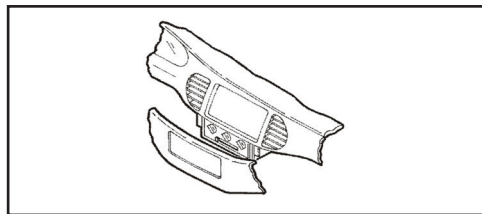

(Figure A)

Buick Le Sabre/Buick Park Avenue 1995-1999

1. Unsnap the climate control trim panel (from door to door) and remove (4) Phillips screws exposed. (Figure A)
2. Pop out the a/c vents and remove (1) Phillips screw exposed in each vent cavity. (Figure A)
3. Unclip the radio trim bezel and remove.
4. Remove the screws securing the factory head unit and disconnect the wiring.

Continue to kit assembly

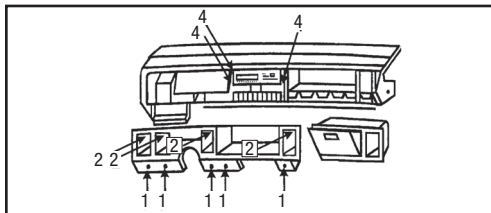

(Figure A)

Buick Le Sabre/Buick Park Avenue 2000-2005

1. Open drivers door and unsnap and remove dash end cap.

Buick Le Sabre/Buick Park Avenue 2000-2005

2. Unsnap and remove trim along center of dash (one piece on right and one on left of wheel).
3. Unsnap and remove radio/instrument bezel.
4. Remove (2) screws in order to remove radio.

Continue to kit assembly

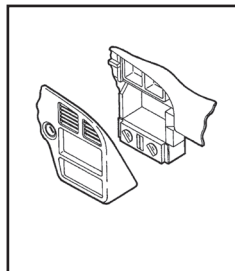

(Figure A)

Buick Rendezvous 2002-2007

1. Open center console and remove (2) screws at front of console opening. (Figure A)
2. Remove liners from cup holders and storage pocket next to cup holders, then remove screws. Unsnap and remove panel. (Figure B)
3. Remove (2) screws from bottom of radio/climate control bezel, unclip and remove. (Figure C)

Buick Rendezvous 2002-2007

4. Remove (3) 9/32" hex-head screws to remove radio. (Figure D)

Continue to kit assembly

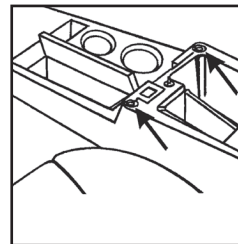

(Figure A)

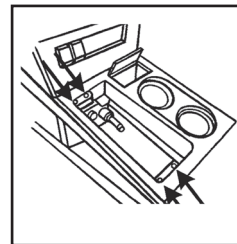

(Figure B)

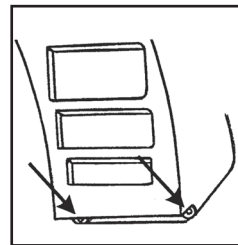

(Figure C)

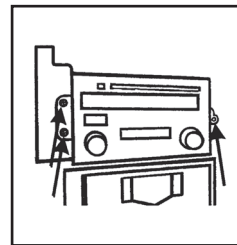

(Figure D)

Buick Riviera 1996-1999

1. Unsnap left side panel exposing (1) Phillips screw to remove.
2. Remove (1) Phillips screw and unsnap right side panel to expose (1) Phillips screw beneath panel and remove.
3. Unsnap underside of overhanging dash to unsnap (6) plastic rivets and remove panel.
4. Remove (5) hex-head screws now exposed under overhang.
5. Unsnap bottom edge of trim bezel, then while holding overhang up, unsnap and remove trim bezel by removing any necessary harnesses.
6. Remove (3) Phillips screw to remove climate control.
7. Remove (2) Phillips screws to remove rear support and (3) 9/32" *Continue to kit assembly*

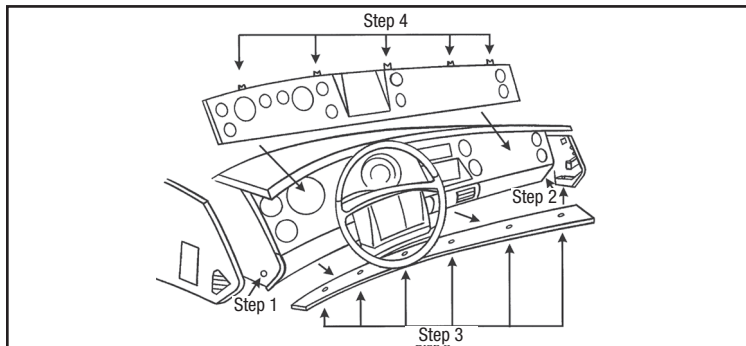

(Figure A)

Buick Roadmaster 1995-1996

1. Unclip dash panel sides and remove.
2. Unclip panel below steering column and remove.
3. Remove (2) 7mm screws above instrument cluster.
4. Set parking brake, turn car on, and move shifter to the lowest gear. Tilt steering wheel down then unsnap entire instrument cluster/radio panel and remove.
5. Remove (3) 7mm screws to remove radio.

Continue to kit assembly

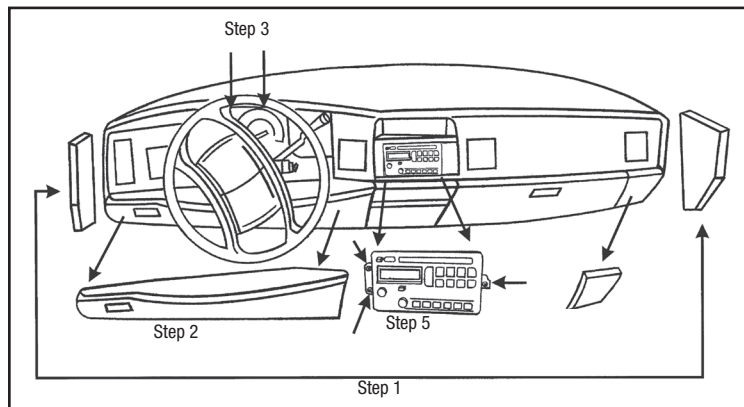

(Figure A)

Buick Skylark 1996-1998

1. Remove (6) 9/32" screws inside glove box.
2. Under glove box and drivers knee bolster, remove (2) plastic panels by turning (2) 1/4 turn fasteners per side.
3. Remove (4) 9/32" screws revealed (2 per side).
4. Unsnap panel from driver's side to passenger's side.
5. Remove (3) 9/32" screws.

Continue to kit assembly

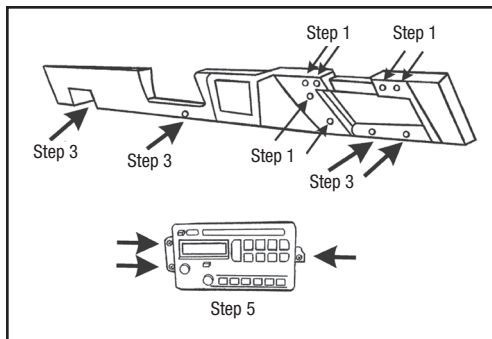

(Figure A)

Cadillac Escalade, Escalade ESV & EXT 2003-2006, Chevrolet Avalanche/Suburban/Tahoe 2003-2006, Chevrolet Kodiak 2003-2009, Chevrolet Silverado/Classic 2003-2007, GMC Sierra/Classic 2003-2007, GMC TopKick 2003-2009, GMC Yukon/Denali/XL 2003-2006, Isuzu H-Series 2003-2008

1. Unsnap and remove dash bezel.
2. Remove (3) 9/32" screws and remove radio.

Continue to kit assembly

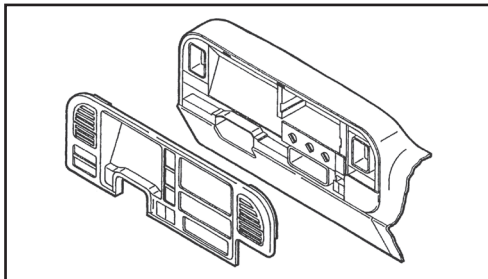

(Figure A)

Chevrolet Blazer 2002-2005, S-10/GMC Sonoma (with double DIN radio) 2002-2004, Oldsmobile Bravada 1998-2001

1. Remove (2) 9/32" hex-head screws from the knee bolster panel.
2. Pull down on the panel and remove the 9/32" hex-head screws exposed on the bottom of the dash trim bezel.
3. Remove (1) Phillips screw above the instrument cluster.
4. Unclip the dash trim bezel and remove.
5. Remove (2) 9/32" hex-head screws securing the factory head unit and disconnect the wiring.

Continue to kit assembly

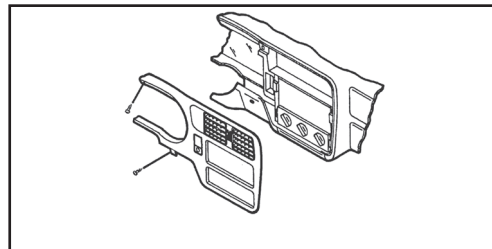

(Figure A)

Chevrolet Cavalier 2000-2005

1. Open drivers door and remove fuse panel on end of dash.
2. Open passenger door and remove panel on end of dash.
3. Remove (1) Phillips screw from each side exposed.
4. Remove (3) screws from top of glove box liner.
5. Remove (2) screws from the top-left corner of the glove box cavity.
6. Remove (1) Phillips screw from the defroster duct.
7. Remove the ductwork and (1) Phillips screw exposed.
8. Remove the dash pad and (3) Phillips screws exposed at the top of the radio trim bezel.

Continue to kit assembly

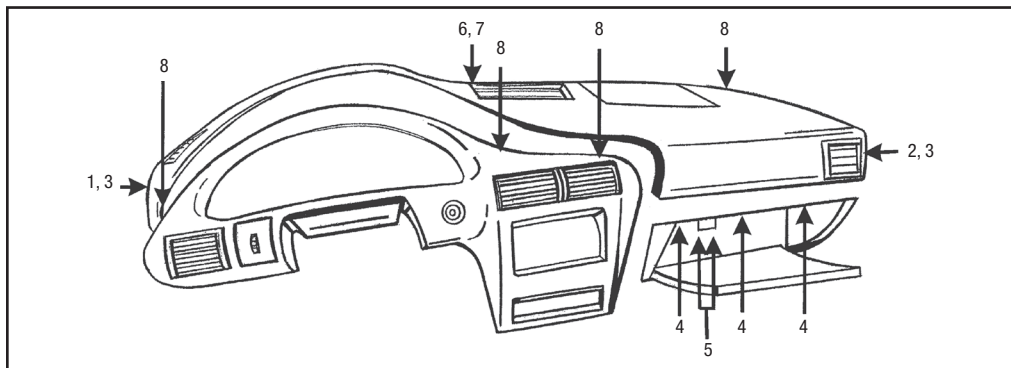

(Figure A)

Chevrolet Colorado 2004-2008, GMC Canyon 2004-2008, Isuzu I-290/I-370 2007-2008, Isuzu I-280/I-350 2006

1. Unsnap and remove the entire panel surrounding the radio and A/C controls. (Figure A)
2. Remove (3) 9/32" screws securing the radio to remove. (Figure B)

Continue to kit assembly

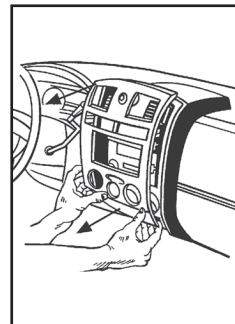

(Figure A)

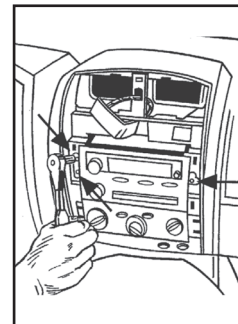

(Figure B)

Chevrolet Express Van 2001-2002, GMC Savanna 2001-2002

1. Unsnap and remove small trim panel below steering column. (Figure A)
2. Unsnap radio/climate/instrument panel. (Figure B)
3. Move shift lever to first gear position.
4. Rotate panel counterclockwise to lift over steering column and remove.
5. Remove (3) 9/32" hex-head screws to remove radio. (Figure C)

Continue to kit assembly

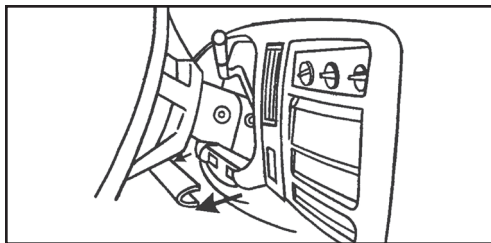

(Figure A)

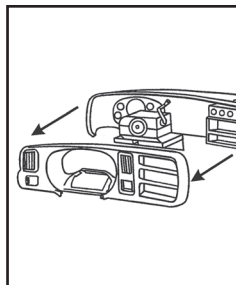

(Figure B)

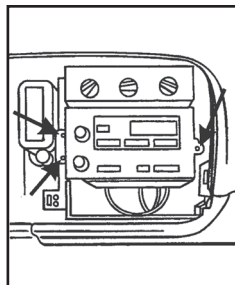

(Figure C)

Chevrolet Express Van 2003-2007, GMC Savanna 2003-2007

1. Remove (2) 10mm bolts from below knee bolster under steering column and remove panel. (Figure A)
2. Remove (2) 10mm bolts from panel below passenger dash airbag and remove panel. (Figure B)
3. Remove (2) 10mm nuts from inside center pocket between power outlets. (Figure C)
4. Unsnap and remove radio and instrument cluster

panel. (May not be necessary to completely remove radio and instrument cluster panel to access radio.)

5. Remove (3) 9/32" bolts to remove radio. (Figure D)
Continue to kit assembly

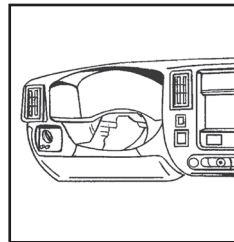

(Figure A)

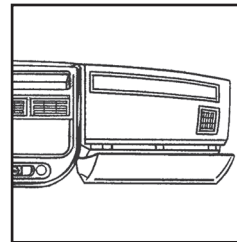

(Figure B)

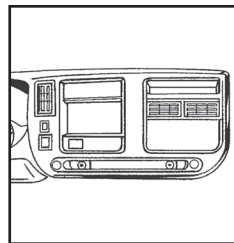

(Figure C)

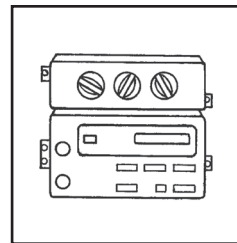

(Figure D)

Chevrolet Impala 2000-2005

1. Unclip each side of the dash trim bezel (fuse access) and remove (1) Phillips screw exposed on each side.
2. Remove (2) Phillips screws under the instrument cluster.
3. Unclip the trim panel above the pedals.
(It is not necessary to remove the panel it can be left hanging).
4. Remove (2) Phillips screws from the knee panel.
5. Unclip the knee panel and remove (1) Phillips screw exposed on the right side of the steering column.
6. Unclip and remove the entire dash trim bezel.

Continue to kit assembly

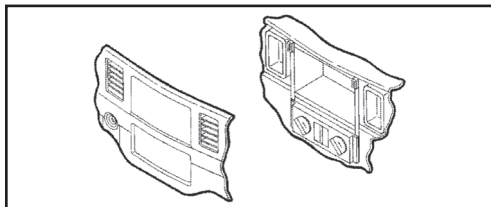

(Figure A)

Chevrolet Malibu 2001- 2003, Chevrolet Malibu Classic 2004-2005

1. Unsnap and remove radio bezel.
2. Remove (3) bolts and remove radio.

Continue to kit assembly

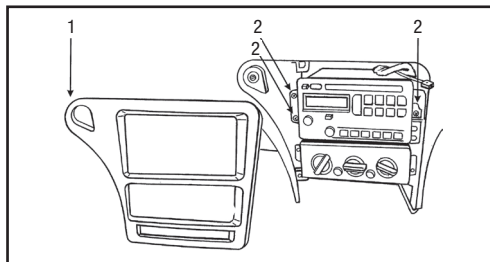

(Figure A)

Chevrolet Monte Carlo 2000-2005

1. Unclip the trim panel above the pedals.
(It is NOT necessary to remove the panel it may be left hanging.)

2. Remove (2) 9/32" screws from the knee panel and unclip the panel.
3. Unsnap the driver's side fuse panel cover and remove (1) 9/32" screw.
4. Open the glove box and remove (1) 9/32" screw from the upper left corner.
5. Remove (3) 9/32" screws securing the factory radio and disconnect the wiring.

Continue to kit assembly

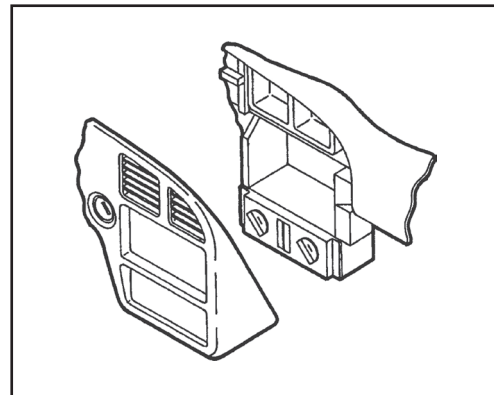

(Figure A)

Chevrolet Trailblazer 2002-2009

1. Remove (2) Phillips screws inside instrument cluster.
2. Remove (1) Phillips screw under climate controls to the left of the power outlet.
3. Remove (2) 7mm hex-heads from under steering column and lower the panel. Remove (3) Phillips screws around steering wheel.
4. Unsnap and remove bezel. (Use caution pulling over hazard switch.) Remove (3) 7mm hex-head screws to remove radio.

Continue to kit assembly

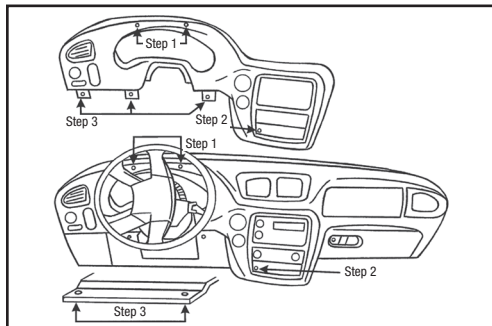

(Figure A)

Chevrolet Venture 2000, Oldsmobile Silhouette 2000, Pontiac Montana 2000 (Except SV6)

1. Remove the ashtray and (1) Phillips screw exposed in the ashtray cavity.
2. Remove (1) Phillips screw from the cigarette lighter compartment.
3. Remove (2) Phillips screws securing the factory head unit and disconnect the wiring.

Continue to kit assembly

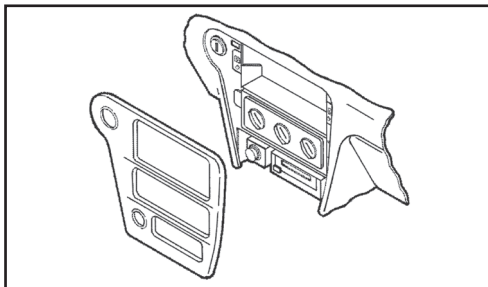

(Figure A)

Chevrolet Venture 2001-2005, Oldsmobile Silhouette 2001-2004 Pontiac Montana 2001-2005 (Except SV6)

1. Open cup holders and remove (2) Phillips 7mm screws. (Figure A)
2. Unsnap and remove dual power outlet assembly from lower storage.
3. Open lower storage door and remove (2) 7mm screws inside.
4. Models with DVD - Remove DVD player and remove (2) 7mm screws from behind and (2) 7mm screws near the floor.
5. Remove lower storage compartment. (Figure B)
6. Remove (2) 7mm screws (facing up) from under cup holder. (Figure C)
7. Remove (3) 7mm hex-head screws and remove radio.

Continue to kit assembly



Dash Disassembly

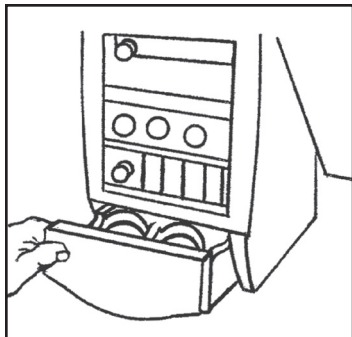

(Figure A)

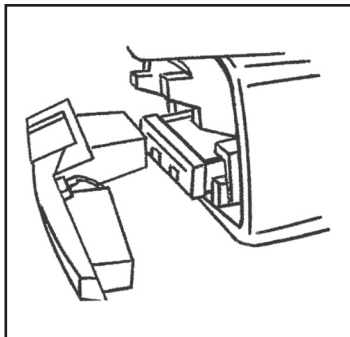

(Figure B)

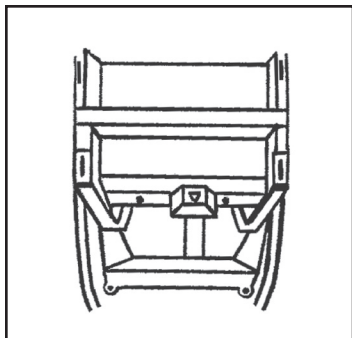

(Figure C)

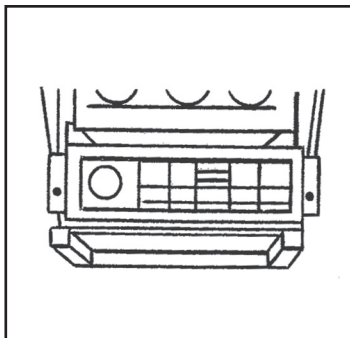

(Figure D)

GMC Envoy 2002-2007, Isuzu Ascender 2003-2005, Oldsmobile Bravada 2002- 2004, Buick Ranier 2004-2007

1. Remove (4) Phillips screws, (2) from left and (2) from right of carpeted panel. (Figure A)
2. Slide carpeted panel down and backwards to reveal (2) Phillips screws and remove. (Figure B)
3. Unsnap radio bezel and unplug cigarette lighter and accessories. (Figure C)
4. Remove (3) screws and remove radio. (Figure C)

Continue to kit assembly

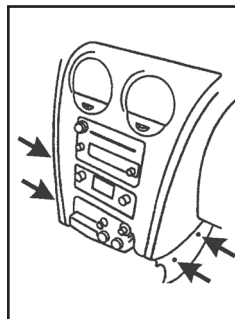

(Figure A)

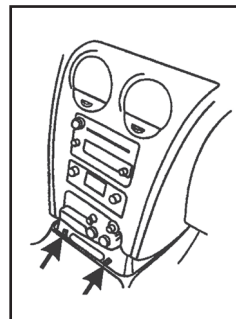

(Figure B)

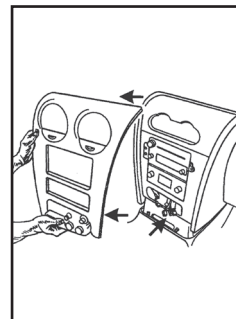

(Figure C)

Hummer H2 2003-2007

1. Open center console and remove (4) 9/32" screws from console box and remove box. (Figure A)
2. Remove (4) Phillips screws from hinge on console door inside console and remove door. (Figure B)
3. Loosen (1) T-15 torx on forward facing side of shift lever and pull up to remove. (Figure C)
4. Unclip cup holder/shifter trim assembly and remove. (Figure D)
5. Remove (6) Phillips screws from top of center console. (Figure F)
6. Remove (2) Phillips screws from inside pocket on back of center console, then unclip and remove. (Figure E)
7. Remove (1) 10mm bolt to right of shift lever. (Figure E)
8. Remove (2) Phillips screws from under console box on drivers side and (2) Phillips screws from under console trimtop on passenger side. (Figure F)
9. Slide control assembly rearwards. (Figure F)
10. Remove (2) T-30 torx bolts from top of rado/climate control trim and unclip and remove. (Figure G)
11. Remove (3) 9/32" screws that hold the radio in. (Figure G)

Continue to kit assembly

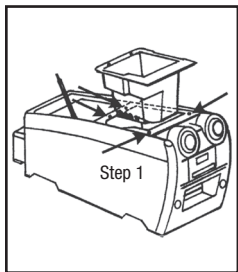

(Figure A)

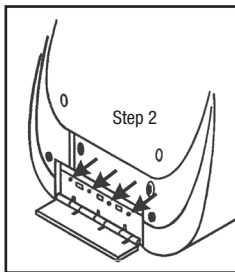

(Figure B)

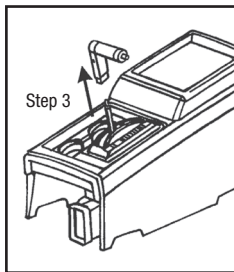

(Figure C)

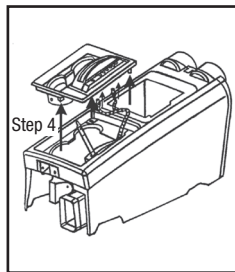

(Figure D)

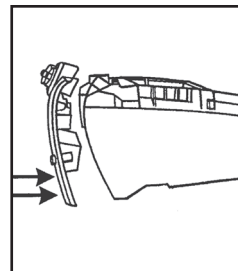

(Figure E)

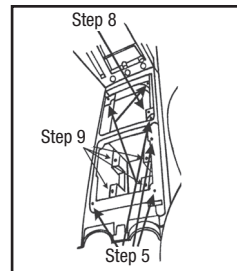

(Figure F)

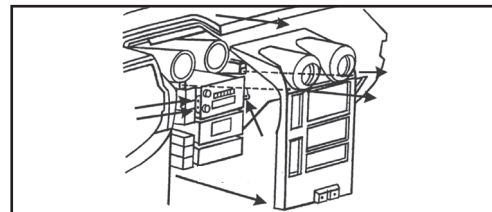

(Figure G)

Oldsmobile Achieva 1996-1998

1. Open the glove box, press inward on the walls of the glove box liner and remove the liner.

- Remove (10) torx-head screws from the glove box location.
- Remove (2) 9/32" hex-head screws under the steering column.
- Unclip the dash trim bezel. (Figure A)
- Remove the screws securing the factory head unit and disconnect the wiring.

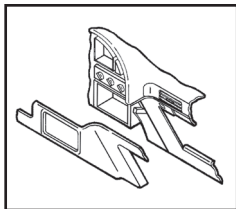

(Figure A)

Continue to kit assembly

Oldsmobile Alero 1999-2004

- Remove shift knob by using a small screwdriver to remove U-clip from front of shifter and pull upward.
- Unclip and remove shifter trim panel.
- Unclip and remove radio and climate control panel by pulling from bottom. (Figure A)
- Remove (3) 9/32" screws from radio and remove.

Continue to kit assembly

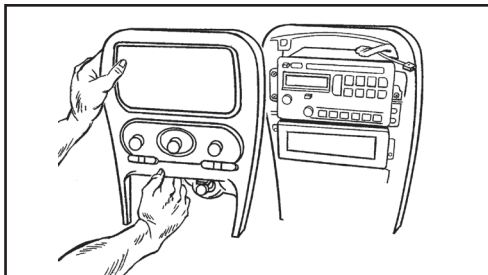

(Figure A)

Oldsmobile Aurora 1995-2003

- Unclip the radio trim bezel and remove the bezel. (Figure A)
- Remove (2) 7mm screws securing the factory head unit and disconnect the wiring.

Continue to kit assembly

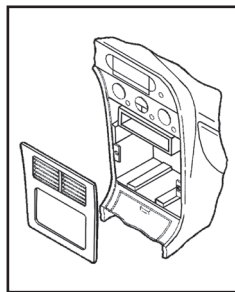

(Figure A)

Oldsmobile Cutlass 1997-1999, Oldsmobile Cutlass Supreme 1995-1997

- Unclip the radio trim bezel and remove. (Figure A)
- Remove (2) 9/32" hex-head screws securing the factory head unit and disconnect the wiring.

Continue to kit assembly

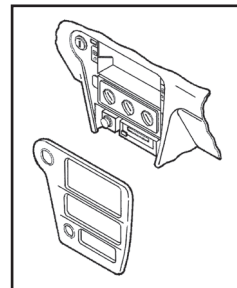

(Figure A)

Oldsmobile Eighty-Eight 1994-1999

- Unclip the radio trim bezel and remove.
- Remove (2) 9/32" hex-head screws securing the factory head unit and disconnect the wiring.

Continue to kit assembly

Oldsmobile Ninety-Eight 1994-1996

1. Open the glove box and remove (2) hex-head screws securing the wood trim.
2. Unsnap the wood trim and remove.
3. Remove (2) hex-head screws below the radio trim bezel.
4. Lift up on the bezel and remove.
5. Remove (3) Phillips hex-head screws securing the factory head unit and disconnect the wiring.

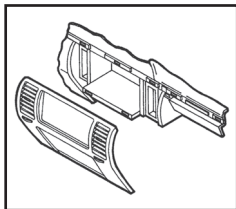

(Figure A)

Continue to kit assembly

Oldsmobile Intrigue 1998-2002

1. Open the center console storage compartment and remove (2) 9/32" hex-head screws exposed.
2. Remove the center console.
3. Unclip the radio trim bezel and remove.

4. Remove (2) 9/32" hex-head screws securing the factory head unit and disconnect the wiring.

Continue to kit assembly

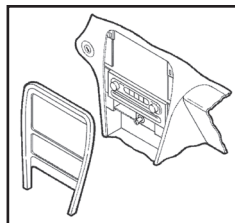

(Figure A)

Oldsmobile L55 1996- 1999/Regency 1997-1998

1. Open glove box and remove two-center trim bezels attached by screws. (Figure A)
2. Unsnap and remove radio trim bezel. (Figure A)

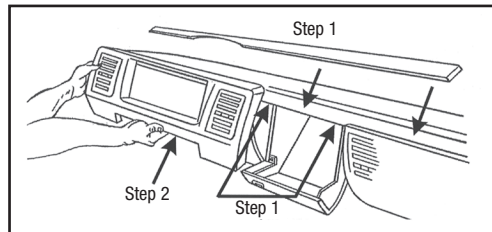

(Figure A)

3. Remove (3) 9/32" hex-head screws and remove radio. (Figure B)

Continue to kit assembly

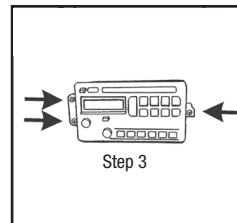

(Figure B)

Pontiac Aztec 2001-2005

1. Pull out cup holder inserts.
2. Remove (1) Phillips screw exposed inside bottom cup holder.
3. Unsnap and remove shifter trim with cup holders.
4. Remove (2) #15 torx at bottom of radio/climate bezel.

Continue to kit assembly

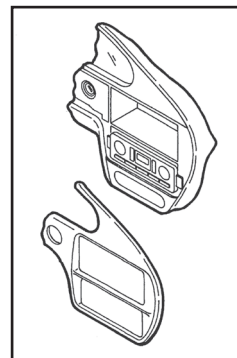

(Figure A)

Pontiac Bonneville 2000-2005

1. Remove (2) Phillips screws from the instrument cluster. (Figure A)
2. Unclip the ignition trim and remove. (Figure B)
3. Unclip the climate control/radio trim bezel and remove.
4. Depress the spring clips on each side of the factory head unit and remove. (Figure C)

Continue to kit assembly

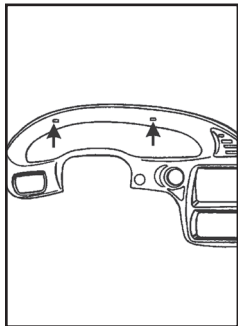

(Figure A)

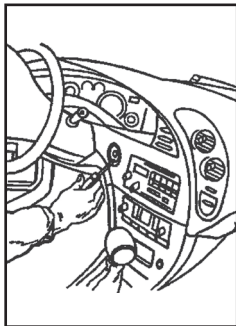

(Figure B)

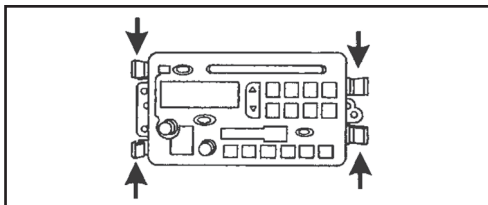

(Figure C)

Pontiac Grand Am 2001-2005

1. Unsnap and remove radio trim bezel. (Figure A)
2. Remove (3) 9/32" screws from radio brackets and remove radio. (Figure A)

Continue to kit assembly

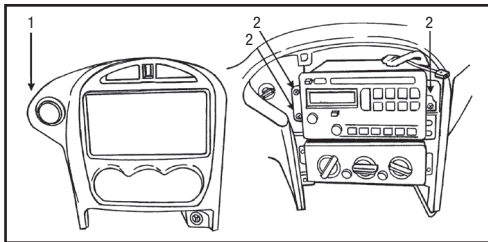

(Figure A)

Pontiac Sunfire 2000-2005

1. Open the glove box and remove (2) Phillips screws exposed on the right edge of the radio trim bezel.
2. Unclip the bezel and remove.
3. Remove (2) 7mm hex-head screws securing the factory head unit and disconnect the wiring.

Continue to kit assembly

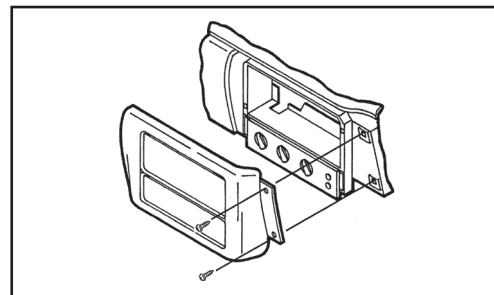

(Figure A)



Installation instructions for part 95-2001



Kit Assembly

All vehicles - ISO DDIN radio provision

1. Attach the *radio brackets* to the inside edge of the *radio trim plate*. (Figure A)
2. Slide the radio into the completed assembly and secure the radio to the assembly using the screws supplied with the radio. (Figure B)
3. Locate the factory wiring harness in the dash. Metra recommends using the proper mating adapter from Metra or AXCESS. Re-connect the negative battery terminal and test the unit for proper operation.
4. Reassemble dash in reverse order of disassembly.

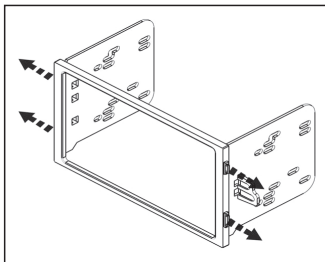

(Figure A)

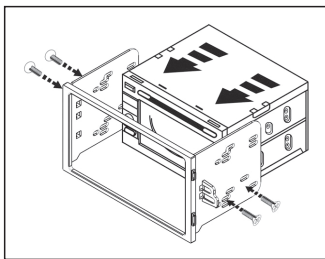

(Figure B)

Note #1: *The spacers included in the kit may be necessary to adapt to the slight differences from one vehicle to another. If the kit/radio assembly does not meet the backside of the factory radio opening, use the spacer to eliminate that space.*

Note #2: *For the Buick Le Sabre, Oldsmobile Aurora and the Pontiac Bonneville the (3) speed clips and screws provided with the kit will need to be installed into the sub-dash where the screw holes line up on the kit.*

IMPORTANT

If you are having difficulties with the installation of this product, please call our Tech Support line at **1-800-253-TECH**. Before doing so, look over the instructions a second time, and make sure the installation was performed exactly as the instructions are stated. Please have the vehicle apart and ready to perform troubleshooting steps before calling.



KNOWLEDGE IS POWER

Enhance your installation and fabrication skills by enrolling in the most recognized and respected mobile electronics school in our industry. Log onto www.installerinstitute.com or call 800-354-6782 for more information and take steps toward a better tomorrow.



Metra recommends MECP certified technicians