

D-Link®



AC5300 Ultra Wi-Fi Router
Quick Install Guide

DIR-895L

Package Contents



DIR-895L AC5300 Ultra Wi-Fi Router



Wi-Fi Configuration Card



Power Adapter



Quick Install Guide



Ethernet Cable

If any of the above items are missing, please contact your reseller.

Minimum Requirements

Network Requirements:

- An Ethernet-based broadband modem

Web-based Configuration Requirements

Computer with the following:

- Windows® or Mac OS® X operating system
- An installed Ethernet adapter or wireless adapter
- Internet Explorer® 9 or higher, Safari® 5.1 or higher, Firefox® or Chrome™

mydlink Requirements

- For mydlink and mydlink app requirements refer to: <http://www.mydlink.com>

Antenna Orientation

The DIR-895L is designed to give you the fastest, most stable network connection possible. In order to maximize performance, orient the antennas at an angle, pointing outward and away from the base unit.

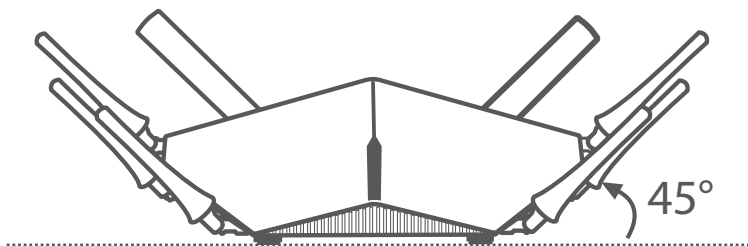

Hardware Overview

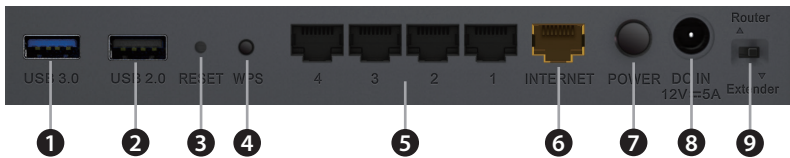

1	USB 3.0 Port	Connect a USB 3.0 flash drive or external hard drive to share content throughout your network.
2	USB 2.0 Port	Connect a USB 2.0 flash drive or external hard drive to share content throughout your network.
3	Reset Button	Press and hold the reset button with a paper clip for six seconds to reset the router to the factory default settings.
4	WPS Button	Press to start the WPS process. Both wireless LEDs will start to blink.
5	LAN Ports (1-4)	Connect Ethernet devices such as computers, switches, and game consoles.
6	Internet Port	Connect your broadband modem to this port using an Ethernet cable.
7	Power Button	Press to power the router on and off.
8	Power Port	Connect the supplied power adapter.
9	Mode Switch	Select Router (left) or Extender mode (right). To change modes, move the switch to the desired position and after five seconds the router will reboot into the desired mode. Router is the default mode. For information on how to use the router in Extender mode, refer to the user manual located at http://support.dlink.com .

LED Behavior



1	Power LED	A solid white light indicates a proper connection to the power supply. The light will be solid orange during boot-up.
2	Internet LED	A solid white light indicates a connection to the Internet port. If the LED is orange, the connection is good but the router cannot connect to the Internet.
3	2.4GHz Wireless LED	A solid light indicates the 2.4GHz wireless function is working properly. During the WPS process, this light will blink.
4	5GHz Wireless LED	A solid light indicates the 5GHz wireless function is working properly. During the WPS process, this light will blink.
5	USB 2.0	A solid light indicates a USB 2.0 device is connected.
6	USB 3.0	A solid light indicates a USB 3.0 device is connected.

Before You Start

- **Users with DSL providers** - If you are using a PPPoE connection, you will need your PPPoE user name and password. If you do not have this information, contact your Internet provider. Do not proceed until you have this information.
- **Users with Cable providers** - Make sure you unplug the power to your modem. In some cases, you may need to turn it off for up to five minutes.
- **Advanced Users** - If your ISP provided you with a modem/router combo, you will need to set it to "bridge" mode so the DIR-895L router can work properly. Please contact your ISP or refer to the user manual for your modem/router device.

Note: If you experience issues registering this device with your mydlink account, or if you purchased an open box or resold unit, perform a hard reset by pressing and holding the reset button on the device for 10 seconds while the device is powered on. If you are returning the device, please perform the hard reset procedure to clear the device of any personal data.

Connect your Router

- 1 Attach the eight antennas to the router by twisting them on clockwise.

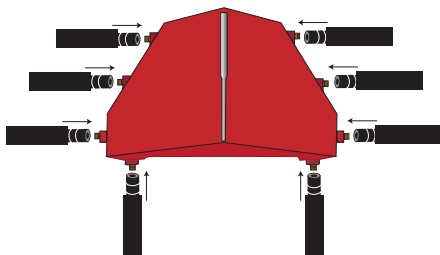

- 2 Unplug the power to your DSL or Cable modem.

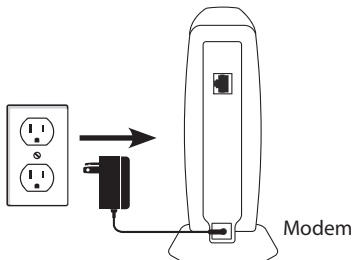

- 3** Unplug the power to your DSL or Cable modem. Connect an Ethernet cable from the Internet port of the router to the Ethernet port on your DSL or Cable modem.

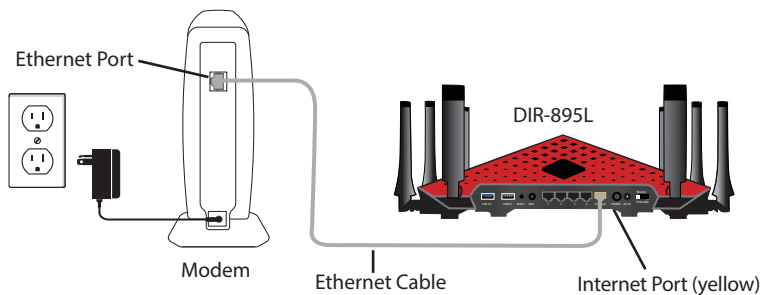

- 4** Connect another Ethernet cable from the Ethernet port on your computer to one of the LAN ports on the router. You can also connect wirelessly to the router with your computer. Use the supplied Wi-Fi Configuration Card for the Wi-Fi network name (SSID) and Wi-Fi password of the router. Complete steps 5 and 6 before attempting to connect.

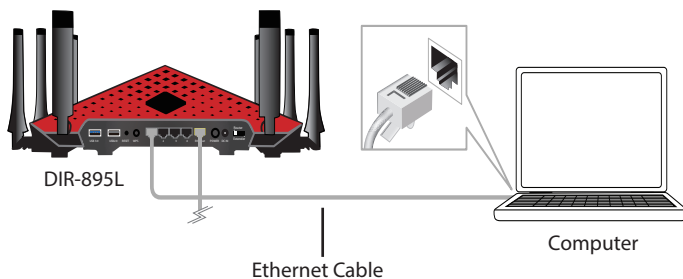

- 5** Plug the power back into your DSL or cable modem. Please wait about one minute before continuing.

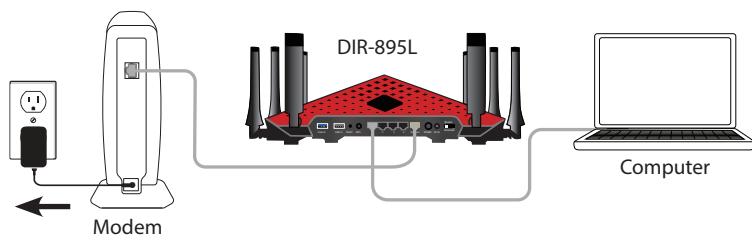

- 6 Plug the power adapter into your router and connect to an available power outlet or surge protector. If the Power LED does not light up, press the Power button on the back of the router.

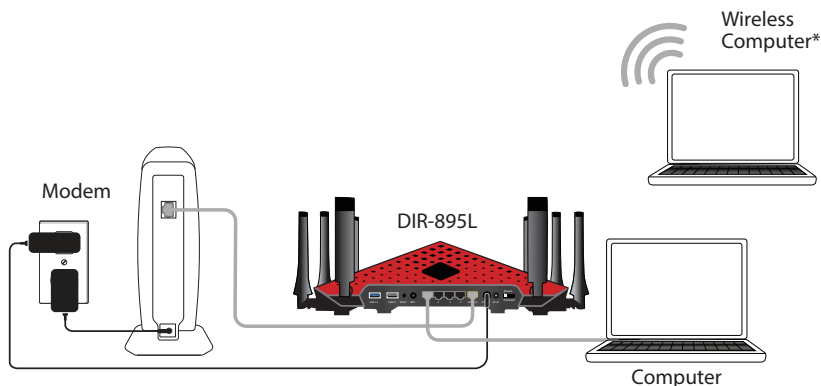

* If you are connecting wirelessly, you may now connect to the router using the supplied Wi-Fi Configuration Card for the Wi-Fi network name (SSID) and Wi-Fi password.

- 7 After the router has powered up, verify that the Power (white) and Internet (orange or white) LEDs are both lit. Proceed with router configuration.

Configuration

There are two ways to configure your router:

- Web Browser** - Use a web browser from your computer.
- QRS Mobile app** - Use a mobile device with the D-Link QRS Mobile app. Refer to the *QRS Mobile Setup* section for more information.

A. Web Browser Configuration

- 1 Open a web browser (e.g., Internet Explorer, Chrome, Firefox, or Safari) and enter **http://dlinkrouter.local./** or enter the IP address of the router (**192.168.0.1**).

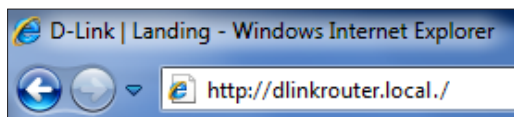

2 Select a language and click **Next** to continue.

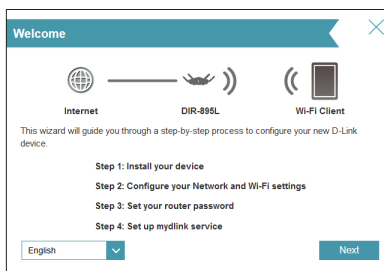

3 The router may automatically detect your Internet connection type. If this happens, skip to step 6. If not, then select your Internet connection type and click **Next** to continue.

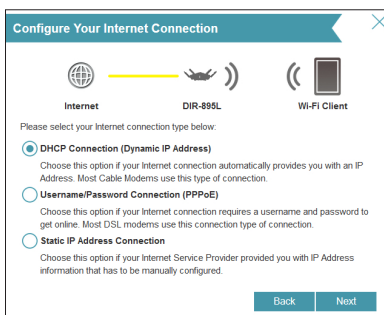

4 DSL (PPPoE) users enter your PPPoE user name and password supplied by your ISP (Internet Service Provider). Click **Next** and skip to step 6.

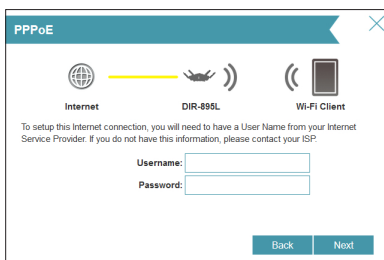

- 5 If you have a Static IP connection, enter the IP information and DNS settings supplied by your ISP. Click **Next** to continue.

The screenshot shows the 'Static IP' configuration screen. At the top, there is a teal header with the text 'Static IP' and a close button. Below the header, there is a diagram showing 'Internet' (globe icon) connected to 'DIR-895L' (router icon) which is connected to 'Wi-Fi Client' (smartphone icon). A yellow line connects Internet to DIR-895L, and a grey line connects DIR-895L to Wi-Fi Client. Below the diagram, there is a paragraph of text: 'To set up this connection you will need to have a complete list of IP information by your Internet Service Provider. If you have a Static IP connection and do not have this information, please contact your ISP.' Underneath, there are five input fields labeled 'IP Address:', 'Subnet Mask:', 'Gateway Address:', 'Primary DNS Address', and 'Secondary DNS Address'. At the bottom right, there are two buttons: 'Back' and 'Next'.

- 6 For both the 2.4GHz and 5GHz bands, create a name for your Wi-Fi Network and a password. Your wireless devices (i.e., tablets, smartphones, and laptops) will need to have this information entered to be able to connect to your wireless network. Click **Next** to continue.

The screenshot shows the 'Wi-Fi Settings' configuration screen. At the top, there is a teal header with the text 'Wi-Fi Settings' and a close button. Below the header, there is a diagram showing 'Internet' (globe icon) connected to 'DIR-895L' (router icon) which is connected to 'Wi-Fi Client' (smartphone icon). A grey line connects Internet to DIR-895L, and a yellow line connects DIR-895L to Wi-Fi Client. Below the diagram, there is a paragraph of text: 'To setup a Wi-Fi network you will need to give your Wi-Fi network a name (SSID) and password.' Underneath, there is a text input field labeled 'Wi-Fi Network Name:' with the value 'DIR-895L' entered. Below that, there is another paragraph: 'The Wi-Fi Network Name is up to 32 characters. You will need to join your Wi-Fi network using this Network Name (SSID).' Underneath, there is another text input field labeled 'Wi-Fi Password:' with the value 'dinkdinkdinkdink' entered. Below that, there is another paragraph: 'The password must contain at least 8 characters. You will need to join your Wi-Fi network using this password.' At the bottom right, there are two buttons: 'Back' and 'Next'.

- 7 Continue with the Setup Wizard to finish configuring your DIR-895L router. When you see the summary screen, make a note of your settings.

Note: Setting up “mydlink” is optional and not required for the router to function.

Congratulations! You have completed the router installation.

After you complete the configuration process, the Internet LED will turn white indicating that your router is connected to the Internet.

B. QRS Mobile Setup

- 1 Scan the code below or search "QRS Mobile" (App Store or Google Play) to download the QRS Mobile App to your iPhone, iPad, or Android device.



iOS



Android



QRS Mobile App

- 2 Once your app is installed, you may now configure your router. Connect to the router wirelessly by going to your wireless utility on your device. Scan for the wireless network name as listed on the supplied Wi-Fi Configuration card/sticker. Select the network and then enter the Wi-Fi Password.



D-Link Wi-Fi Configuration Card	
Default Configuration	Wi-Fi Name(SSID) 2.4GHz:
Wi-Fi Name(SSID) 2.4GHz: dlink-xxxx	Wi-Fi Password:
Wi-Fi Name(SSID) 5GHz: dlink-xxxx-5GHz Password: xxxxxxxx	Wi-Fi Name(SSID) 5GHz *:
	Wi-Fi Password *:
To configure your router, go to: http://dlinkrouter.local Or http://192.168.0.1 Username: "Admin" Password: "" (leave the field blank)	Your configuration Username: "Admin" Password:
	*For applicable models
	DCW10W1010

- 3 Once you connect to the router, tap on the **QRS Mobile** icon from your mobile device, then tap **Start** to continue. Follow the on-screen instructions to complete the setup.

- 4 After the *Setup Complete* screen appears, click **Save** and write down the new Wi-Fi Network name and password on your companion card for future reference.

Note: To reconnect to your router, launch your wireless utility, select the new Wi-Fi Network you created, and then enter your new Wi-Fi password.

Troubleshooting

How do I connect my wireless devices to the DIR-895L router?

1. Open your wireless network utility that displays available wireless networks.
2. Select the Wi-Fi Network name you assigned in the wizard and connect.

Note: If you did not run the setup wizard or you reset the router to its default settings, refer to the Wi-Fi Configuration Card included for the default Wi-Fi Network Name and Wi-Fi Password.

You can also connect wireless devices to the DIR-895L router using WPS:

1. Press the WPS button on the DIR-895L for a minimum of three seconds.
2. Within one minute press the WPS button on your wireless device.
3. Allow up to two minutes to connect.

Note: Some devices may require you to log in to a utility to start the WPS process. Refer to the user manual of the device you want to connect to the router if you do not know how to start the WPS process.

How do I change the wireless settings on the DIR-895L router?

1. Open a web browser (e.g., Internet Explorer, Chrome, Firefox, or Safari) and enter **http://dlinkrouter.local/**. You can also enter the IP address of the router (**192.168.0.1**).
2. At the login screen, enter the router password you created in the wizard (the password is blank by default).
3. From the navigation bar at the top of the Home page, go to **Settings** > **Wireless** to create a new Wi-Fi network name (SSID) and Wi-Fi password.

What can I do if I forget my password?

If you forget your password, you must reset your router. Unfortunately, this process will change all your settings back to factory default.

To reset the router, locate the reset button (hole) on the bottom of the unit. With the router powered on, use an unfolded paper clip to press and hold the button down for about 10 seconds. Release the button and the router will go through its reboot process. Wait about 30 seconds to access the router.



Documentation available at <http://www.dlink.com/DIR-895L>.

GPL Code Statement

This D-Link product includes software code developed by third parties, including software code subject to the GNU General Public License ("GPL") or GNU Lesser General Public License ("LGPL"). As applicable, the terms of the GPL and LGPL, and information on obtaining access to the GPL code and LGPL code used in this product, are available to you at:

<http://tsd.dlink.com.tw/GPL.asp>

The GPL code and LGPL code used in this product is distributed WITHOUT ANY WARRANTY and is subject to the copyrights of one or more authors. For details, see the GPL code and the LGPL code for this product and the terms of the GPL and LGPL.

Written Offer for GPL and LGPL Source Code

Where such specific license terms entitle you to the source code of such software, D-Link will provide upon written request via email and/or traditional paper mail the applicable GPL and LGPL source code files via CD-ROM for a nominal cost to cover shipping and media charges as allowed under the GPL and LGPL.

Please direct all inquiries to:

Email:

GPLCODE@dlink.com

Snail Mail:

Attn: GPLSOURCE REQUEST
D-Link Systems, Inc.
17595 Mt. Herrmann Street
Fountain Valley, CA 92708

GNU GENERAL PUBLIC LICENSE

Version 3, 29 June 2007

Copyright (C) 2007 Free Software Foundation, Inc. <<http://fsf.org/>>

View the full GPL Code Statement at **<http://www.gnu.org/licenses/gpl.html>**

Technical Support

Having trouble installing your new product? D-Link's website contains the latest user documentation and software updates for D-Link products. U.S. and Canadian customers can contact D-Link Technical Support through our website.

United States

Internet: <http://support.dlink.com>

Canada

Internet: <http://support.dlink.ca>

D-Link®

Version 1.00
October 19, 2015

D-Link and the D-Link logo are trademarks or registered trademarks of D-Link. All other third-party marks mentioned herein may be trademarks of their respective owners. Maximum wireless signal rate derived from IEEE Standard 802.11ac, 802.11g, and 802.11n specifications. Actual data throughput will vary. Network conditions and environmental factors, including volume of network traffic, building materials and construction, and network overhead, lower actual data throughput rate. Environmental conditions will adversely affect wireless signal range. Product specifications, size and shape are subject to change without notice, and actual product appearance may differ from that depicted on the packaging. This publication may not be reproduced, in whole or in part, without prior express written permission from D-Link Systems, Inc. Visit www.dlink.com for details.

© 2015 D-Link. All Rights Reserved.