

English p. 1
 Français p. 9
 Español p. 17

EN
 FR
 ES



Réalisation : Espace Graphique

KRUPS



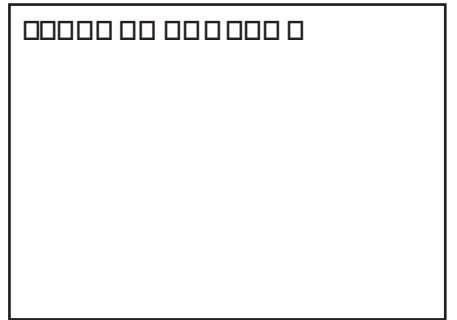
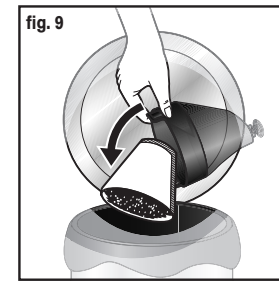
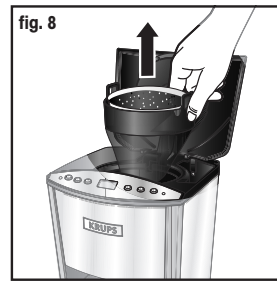
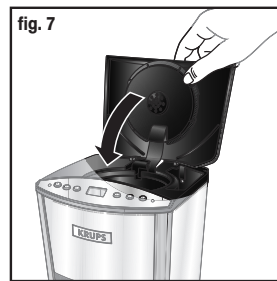
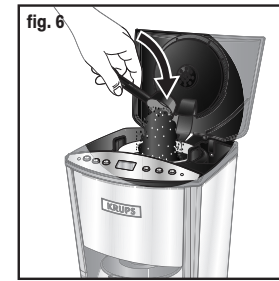
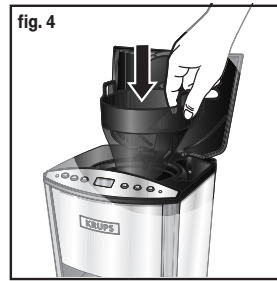
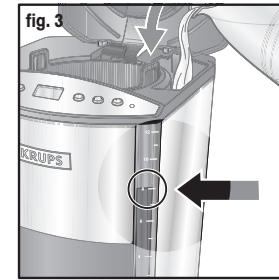
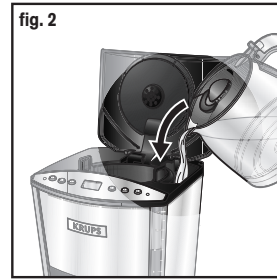
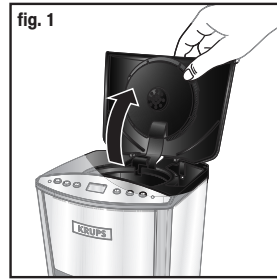

CANADA	GROUPE SEB CANADA 345 Passmore Avenue Toronto, ON M1V 3N8	MEXICO	Groupe SEB MEXICO S.A. de C.V. Goldsmith 38 Desp. 401 Col. Polanco Delegacion Miguel Hidalgo 11 560 Mexico D.F. MEXICO	U.S.A.	GROUPE SEB USA 2121 Eden Road Millville, NJ 08332
	1-800-418-3325		01800 1128325		800-526-5377

TABLE OF CONTENTS

1. DESCRIPTIONp. 3
2. PRIOR TO USEp. 3
3. MAKING COFFEEp. 3
4. AROMA FUNCTIONp. 5
5. PROGRAMMING YOUR COFFEE MAKERp. 5
6. CLEANINGp. 6
7. DESCALINGp. 6
8. MANUFACTURER'S WARRANTYp. 7

IMPORTANT SAFEGUARDS

When using electrical appliances, basic safety precautions should always be followed to reduce the risk of fire, electric shock, and/or injury to persons including the following :

1. Read all instructions prior to first use.
2. Do not touch hot surfaces. Do not touch the heating plate or bottom of the carafe when the keep warm function is on. Use handles or knobs.
3. To protect against fire, electric shock and injury to persons, do not immerse cord, plugs or machine in water or other liquid.
4. Not intended for use by children.
5. Close supervision is necessary when any machine is used near children. Keep machine out of reach of children.
6. This appliance is not designed to be used by children or people without knowledge or experience with the product, unless they are supervised or given prior instructions concerning the use of the appliance by someone responsible for their safety.
7. Children must be supervised to ensure that they do not play with the appliance.
8. Burns can occur from touching hot plate, hot water or steam. Exercise caution.
9. Unplug machine from outlet when not in use and when cleaning. Allow to cool before putting on or taking off parts, before cleaning the machine, and before storing.
10. All machines are subject to stringent quality control. Practical tests using machines taken at random are conducted and this may explain any slight marks or coffee residue prior to use.
11. Do not operate any machine with a damaged cord or plug or after the machine malfunctions, or has been damaged in any manner. Return machine to the nearest Krups Service Center for examination, repair or adjustment or your respective countries Consumer Service Department.
12. To reduce the risk of injury do not drape cord over the counter top or table top where it can be pulled on by children or tripped over accidentally.
13. Do not let cord hang over edge of table or counter, or touch hot surfaces.
14. The use of accessory attachments not recommended by Krups may result in fire, electric shock or injury to persons.
15. Do not use outdoors.
16. Do not place on or near hot gas or electric burner, or in a heated oven.
17. To disconnect the machine, turn the control to "off" then remove plug from wall outlet. Do not yank cord, instead grasp plug and pull to disconnect.
18. Do not use the machine for other than intended use.
19. Do not pour liquids other than water and descaling solutions specified in this manual into the water tank.
20. Protect the machine against humidity and freezing.
21. This machine is for household use only.

SAVE THESE INSTRUCTIONS
CAUTION

This machine is intended for household use only. Any servicing other than cleaning and user maintenance should be performed by the nearest authorized Krups Service Center. Visit our website at www.krupsusa.com in the USA or www.krups.ca in Canada or contact your respective country's Consumer Service department for the service center nearest to you.

To reduce the risk of fire or electric shock, do not attempt to disassemble the machine. Repair should be done by an authorized Krups Service Center only.

SHORT CORD INSTRUCTIONS

- A.** We do not recommend using an extension cord with this device. A short power cord or a detachable power cord is provided to reduce the risk of becoming entangled in or tripping over a longer cord accidentally.
- B.** If an extension cord is absolutely necessary,
 - 1) the marked electrical rating of the extension cord should be at least as great as the electrical rating of the machine,
 - 2) the longer cord should be arranged so that it will not drape over the counter top or table top where it can be pulled on by children or tripped over.
- C.** This machine has a polarized plug (one blade is wider than the other). To reduce the risk of electric shock, this plug is intended to fit into a polarized outlet only one way. If the plug does not fit fully into the outlet, reverse the plug. If it still does not fit, contact a qualified electrician. Do not attempt to modify the plug in any way.

In the interest of improving products, Krups reserves the right to change specifications without prior notice.

1. DESCRIPTION

- | | |
|--------------------------------|---|
| a Main body | j Green Auto On LED |
| b Top lid | k Auto On brewing selection button |
| c Water tank | l Minutes setting button |
| d Water level indicator | m Hours setting button |
| e Carafe lid | n Display |
| f Carafe handle | o Programming button |
| g Carafe | p Aroma function |
| h Heating plate | q On/Off |
| i Filter basket | r Red On LED |

2. PRIOR TO USE

- Operate your coffee maker for the first time without coffee using 1 liter of water to rinse the circuit.

3. MAKING COFFEE

(Follow the illustrations 1 to 9)

- 1- Place the coffee maker on a hard, flat surface. With the coffeemaker turned off, plug into a 120V outlet.
- 2- Fill the carafe with fresh, cold water (preferably bottled or filtered water). Open the hinged cover and pour the water into the water tank. The number of cups is shown by the water level indicator. Do not exceed the 12-cup level. We do not recommend making less than 4 cups **Fig. 1, 2 and 3**.

Notes:

- There is a drip hole on the back of the water tank to prevent exceeding the capacity of the coffee maker. If you add too much water, it will leak out from the back of the unit.
 - The amount of brewed coffee will be less than the water placed in the coffeemaker since about 10% is absorbed by the coffee grounds and the filter.
- 3- Place the carafe with the lid on it on to the heating plate making sure it is fully seated on the heating plate to activate the pause-n-serve mechanism.



CAUTION: To avoid filter basket overflow, the carafe must fit securely into the coffeemaker with the lid on. If not properly positioned on the heating plate, it could cause hot water or hot coffee to overflow.

- 4- With the reservoir cover in the full opened position, insert a standard #4 cone filter into the filter basket holder, folding the seamed edges to insure a snug fit in the basket. Use a fresh filter for each carafe of coffee **Fig. 4 and 5**.
- 5- Add about 2 ounces of ground coffee for 12 cups. If you prefer stronger coffee, we recommend the European method, which produces rich, full-bodied flavor. Experiment with the amount of coffee used in order to adjust the flavor to your taste. Do not exceed the 12 cup level **Fig. 6**.
- 6- Make sure the filter basket is securely pushed down and locked in place in the filter basket holder.
- 7- Close the top lid making sure it is securely closed **Fig. 7**.
- 8- With the top lid firmly closed and the carafe securely in place, press the On button. The red On LED will light up to indicate the brew cycle has started.

Note: When the brewing process ends and the water level indicator is empty, there will still be hot liquid in the filter basket. Wait a few minutes for the rest of the liquid to drip through into the carafe.

- 9- After coffee grounds have cooled, open the top lid and carefully remove the filter basket by grasping the tabs on each side of the filter basket, and lifting straight up from the filter basket holder. Discard the used coffee filter and grounds **Fig. 8 and 9**.



CAUTION: The coffee maker becomes very hot during the brew cycle. Please handle with extreme care.

Notes:

- The keep warm plate will operate, up to two hours, as long as the on/off button is on (red LED is lit).
- Always switch the coffeemaker to Off when the carafe is empty or you no longer want to keep coffee hot.
- If two or more pots of coffee are to be made it is recommended that the coffeemaker be allowed to cool for 10 minutes between each brewed pot. The filter basket should also be rinsed out after each brew cycle.

Auto Shut-Off

As a convenience, your coffee maker has been designed with an Auto Shut-Off feature. When the brewing cycle is completed, the coffee maker will shut off automatically after 2 hours.

4. AROMA FUNCTION

To ensure optimum flavor, the AROMA button allows you to adjust the intensity of the coffee prepared:

- Follow the directions for MAKING COFFEE until step 7.
- Press AROMA button to select a stronger strength of brew.
- Press the On button. The red On LED will light up to indicate the brew cycle has started.

Note: This function will slow down the flow of water into the filter basket. It will provide a rich coffee flavor.
- When the brewing process ends and the water level indicator is empty, there will still be hot liquid in the filter basket. Wait a few minutes for the rest of the liquid to drip through into the carafe.

Note: To deactivate the AROMA function, press the AROMA button again.

5. PROGRAMMING YOUR COFFEE MAKER

Setting the clock

- You may set the clock any time before or after brewing.
- Press the HOUR button and then the MIN button to set the current time. Press and hold the buttons to scroll through numbers quickly. When the number displayed approaches the desired setting, press and release the button to advance one digit at a time.

Note: AM is indicated in the upper left hand corner of the display and PM in the lower left hand cover.

Setting the auto brew start time

- 1- To set the desired auto brew start time press the PROGRAM button. The word PROGRAM will begin flashing on the display to indicate an auto brew start time is being set.
- 2- Set the time you want coffee to begin brewing by using the Hour and Minutes buttons following the same directions for setting the clock.

Note: After setting the auto brew start time the PROGRAM indicator will automatically stop flashing after a few seconds, and the display will return to the current time.

- 3- To confirm your auto brew start time simply press the PROGRAM button and the pre-set time will be displayed for a few seconds on the LCD display. The PROGRAM indicator will continue to flash while confirming the pre-set auto brew time. It will automatically return to the current time after a few seconds.
- 4- After setting the auto brew start time, prepare coffee following the directions for MAKING COFFEE until step 7.
- 5- Press the AUTO ON button. A green LED will light up and the word AUTO will be displayed in the upper right hand corner of the display.
- 6- Your coffeemaker will automatically begin brewing at the pre-set time. When the brew cycle begins, the Auto icon will go out and the red on LED will come on to indicate the coffeemaker is in operation.

Note: To re-set the auto brew time for the same pre-set time for the next day simply press the AUTO ON button. The green LED light will light up and the word AUTO will again be displayed in the upper right hand corner of the LCD display.

English

Pause & serve

- Allows you to interrupt the brewing cycle and pour a cup of coffee before the entire carafe is finished brewing.



CAUTION: While this will temporarily stop the coffee from dripping into the carafe, it does not stop the brewing cycle. After serving, the carafe should be immediately returned to the carafe plate to prevent the filter basket from overflowing. Make sure the carafe is positioned firmly against the back of the coffee maker.

NOTE: While the pause and serve is a convenient way to pour a cup of coffee mid-cycle, we recommend you wait until the completion of the brew cycle as the strength and flavor of coffee poured mid-cycle will vary from the finished brew.

6. CLEANING

- To remove the used coffee, remove the filter holder from the coffeemaker. **Fig 8.**
- Unplug the appliance.
- Do not clean the appliance when it is still hot.
- Wash carafe, carafe lid and removable filter basket in hot, soapy water or place in top rack of the dishwasher.
- Clean with a soft cloth or a damp sponge.
- For hard to remove stains, use a plastic mesh pad or cloth damped in vinegar.
- Do not immerse the appliance in water or place it under running water.

7. DESCALING

- Calcium build-up frequently occurs in drip coffeemakers. This build-up is normal and is caused by minerals commonly found in drinking water. Periodically, your coffeemaker will need cleaning to remove calcium or mineral deposits that may form. You will know when your unit will need descaling when you notice an obvious slow down in brewing time.
- We recommend descaling your unit with a solution of white vinegar and cold water or a suitable descaling agent. A solution of two tablespoons of white vinegar to one carafe of cold water works best. Pour this solution into the water tank, and follow your normal operating instructions, without a filter in the filter basket.
- When the brew cycle is finished, empty the carafe and rinse with water. Refill the water reservoir with cold water only and repeat the brew cycle with water only, twice more. This will rinse out any remaining vinegar solution. We recommend you do this 4 times a year.

8. MANUFACTURER'S WARRANTY

 : www.krups.com

With a strong commitment to the environment, most of Krups products are repairable during and after the warranty period. Before returning any defective products to the point of purchase, please call Krups consumer service directly at the phone number below for repair options.

Your help to sustain the environment is appreciated!

After sales service

The appliance isn't user-serviceable. If it's not working properly, check that:

- You've followed the instructions correctly;
- The main supply fuse/circuit breaker hasn't blown/tripped.

If it still doesn't work, consult your retailer.

The Warranty

This product is guaranteed by Krups for a period of **2 years** against any manufacturing defect in materials or workmanship, starting from the initial date of purchase.

The manufacturer's warranty by Krups is an extra benefit which does not affect consumer's Statutory Rights.

The Krups warranty covers all costs related to restoring the proven defective product so that it conforms to its original specifications, through the repair or replacement of any defective part and the necessary labor. At Krups's choice, a replacement product may be provided instead of repairing a defective product. Krups's sole obligation and your exclusive resolution under this warranty are limited to such repair or replacement.

Conditions & Exclusions

The Krups warranty only applies within USA, Canada & Mexico, and is valid only on presentation of a proof of purchase. The product can be taken directly in person to an authorized service centre or must be adequately packaged and returned, by recorded delivery (or equivalent method of postage), to a Krups authorized service centre. Full address details for each country's authorized service centre are listed on the Krups website (www.krups.com) or by calling the appropriate telephone number listed below to request the appropriate postal address.

Krups shall not be obliged to repair or replace any product which is not accompanied by a valid proof of purchase.

This warranty will not cover any damage which could occur as a result of misuse, negligence, failure to follow Krups instructions, use on current or voltage other than as stamped on the product, or a modification or unauthorized repair of the product. It also does not cover normal tear and wear, maintenance or replacement of consumable parts, and the following:

- using the wrong type of water
- scaling (any de-scaling must be carried out according to the instructions for use);
- ingress of water, dust or insects into the product;

English

- mechanical damages, overloading
- damages or bad results due to wrong voltage or frequency
- accidents including fire, flood, lightning, etc
- professional or commercial use
- damage to any glass or porcelain ware in the product

This warranty does not apply to any product that has been tampered with, or to damages incurred through improper use and care, faulty packaging by the owner or mishandling by any carrier.

The Krups manufacturer's warranty applies only for products purchased and used in USA, Canada & Mexico. Where a product purchased in one country and then used in another one:

- a) The Krups guarantee duration is the one in the country of usage of the product, even if the product was purchased in another listed country with different guarantee duration.
- b) The Krups guarantee does not apply in case of non conformity of the purchased product with the local standards, such as voltage, frequency, power plugs, or other local technical specifications
- c) The repair process for products purchased outside the country of use may require a longer time if the product is not locally sold by Krups
- d) In cases where the product is not repairable in the new country, the Krups guarantee is limited to a replacement by a similar product or an alternative product at similar cost, where possible.

Consumer Statutory Rights

This Krups manufacturer's warranty does not affect the statutory rights a consumer may have or those rights that cannot be excluded or limited, nor rights against the retailer from which the consumer purchased the product. This warranty gives a consumer specific legal rights, and the consumer may also have other legal rights which vary from State to State or Country to Country or Province to Province. The consumer may assert any such rights at his sole discretion.

Additional information

Accessories, Consumables and end-user replaceable parts can be purchased, if locally available, as described in Krups internet site.

CANADA	GROUPE SEB CANADA 345 Passmore Avenue Toronto, ON M1V 3N8	MEXICO	Groupe SEB MEXICO S.A. de C.V. Goldsmith 38 Desp. 401 Col. Polanco Delegacion Miguel Hidalgo 11 560 Mexico D.F. MEXICO	U.S.A.	GROUPE SEB USA 2121 Eden Road Millville, NJ 08332
	1-800-418-3325		01800 1128325		800-526-5377



: www.krups.com