

CREATIVE

SOUND  
**BLASTER**  
PRO-GAMING

**X**<sup>®</sup>  
**H7**



# User's Guide

Model No: GH0330

# Introduction

---

Congratulations on your purchase of Sound BlasterX<sup>®</sup> H7! Featuring dual-mode USB/analog functionality and large, responsive 50mm FullSpectrum drivers, the headset works with the powerful and versatile BlasterX Acoustic Engine Pro to deliver customizable, best-in-class 7.1 surround sound audio for absolute gaming immersion. Forged with a reinforced steel and aluminum architecture, and a lightweight, ergonomically tested design, the Sound BlasterX H7 promises not only comfort during long gaming sessions, but also the durability to withstand abuse. Step it up with the Sound BlasterX H7 – gaming will never sound the same again.

## Package Checklist

Your Sound BlasterX H7 package comes with the following:

- The Sound BlasterX H7
- Micro USB-to-USB cable - Length: 1.5 m (4.9 ft)
- 3.5 mm (1/8") 4-pole stereo cable - Length: 0.8 m (2.6 ft)
- Quick Start leaflet

## Minimum System Requirements

### For Windows<sup>®</sup> OS

- Intel<sup>®</sup> Core™2 Duo or AMD equivalent processor, 2.8 GHz or faster recommended
- Intel, AMD or 100% compatible motherboard
- Microsoft<sup>®</sup> Windows 10 32-bit or 64-bit, Windows 8.1 32-bit or 64-bit, Windows 8 32-bit or 64-bit, Windows 7 32-bit or 64-bit, Windows Vista<sup>®</sup> 32-bit or 64-bit (Service Pack 1 or higher)
- 1 GB RAM
- >600 MB of free hard disk space
- Available USB 2.0/3.0 port

### For Mac<sup>®</sup> OS

- Mac OS X<sup>®</sup> 10.8 or higher
- 1 GB RAM
- >600 MB of free hard disk space
- Available USB 2.0/3.0 port

## Registering Your Product

Registering your product ensures you receive the most appropriate service and product support available. You can register your product during installation or at [register.creative.com](http://register.creative.com).

Please note that your warranty rights are not dependent on registration.

## More Help

For the latest news and products, please visit [www.creative.com](http://www.creative.com). The site also includes information on making purchases, technical help and the latest software updates.

# About Your Hardware

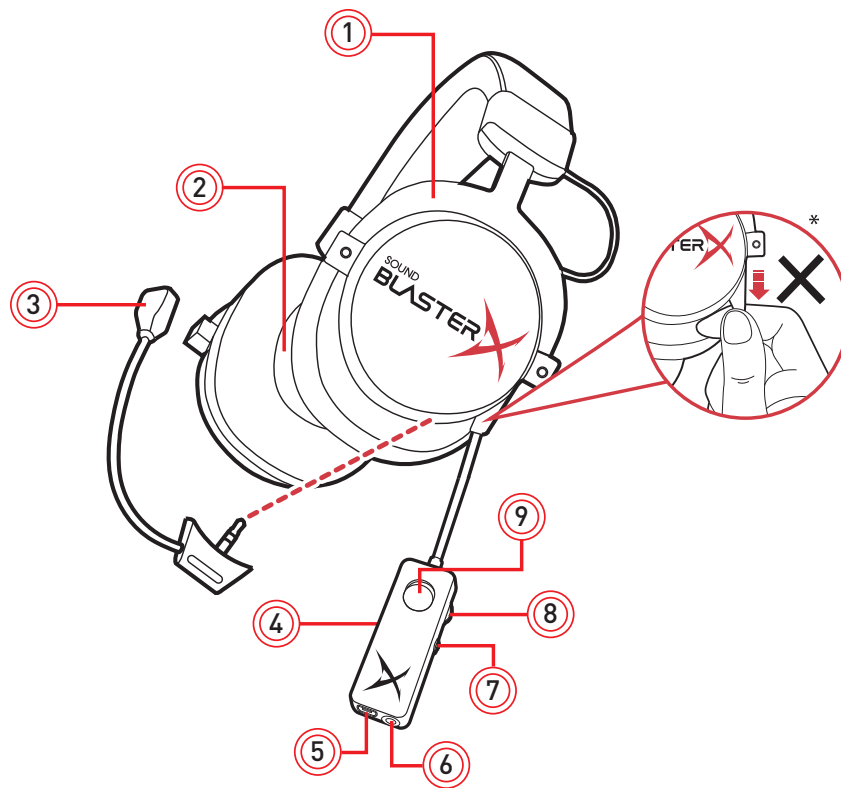

**CAUTION:**

\* Non-detachable. Do not pull.

1	Reinforced steel and aluminum architecture
2	50 mm FullSpectrum drivers
3	Detachable noise reduction microphone
4	Inline remote control
5	4-pole analog jack
6	Micro USB port
7	Multifunction button <ul style="list-style-type: none"> <li>• Press once to pause playback</li> <li>• Press again to resume playback</li> </ul> <p style="text-align: center;">OR</p> <ul style="list-style-type: none"> <li>• Press once to answer an incoming call</li> <li>• Press again to end a call</li> </ul>
8	Volume control
9	Mic mute switch

## **Dual Sound Signature**

In an unprecedented move, the Sound BlasterX H7 comes out of the box with 2 unique sound signatures – perfect for gaming as well as for enjoying music and movies.

### **Analog Mode: Dynamic Sound Signature**

Experience immersive gaming with dynamic sound in analog connection. Professionally-tuned to deliver superior soundstage and imaging, enhancements are added across high, mid, and low frequencies without overemphasizing any particular frequency domain to reproduce a solid natural sound with enhanced clarity and precision.

### **USB Mode: X-Plus Signature**

Designed for the discerning competitive gamer, the Sound BlasterX H7 comes with an enhanced hardware-based X-Plus mode when connected via USB. It ramps up audio cues that matter most and clamps down on other not-so-crucial sounds – delivering precision sound and accurate directional cues for the added advantage in competitive games. Once the Sound BlasterX H7 is configured with your desired X-Plus game profile, you can enjoy the same enhanced audio signature at any tournament venue – no driver or application installation required. See **Using the Creative Software Suite – X-Plus Configurator**

# Using Your Sound BlasterX H7

---

## Step 1: Wearing the Headset

Adjust the headband so that the headset rests lightly on your head. Do not tighten excessively.

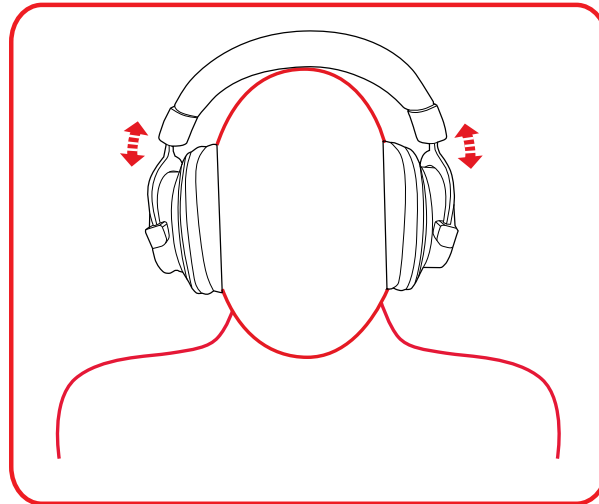

## Step 2: Adjusting the Volume

**WARNING:**

- Set the volume control at minimum level before connecting.
- Do not listen to audio at high volumes for prolonged periods of time to avoid impairing your hearing.

The Volume Control on the inline remote control can be used to adjust your headset volume to a comfortable level.

You can also adjust the volume via the software or the built-in volume settings on your computer.

## Step 3: Connecting the headset

### Connecting to a computer / PS4™ via USB

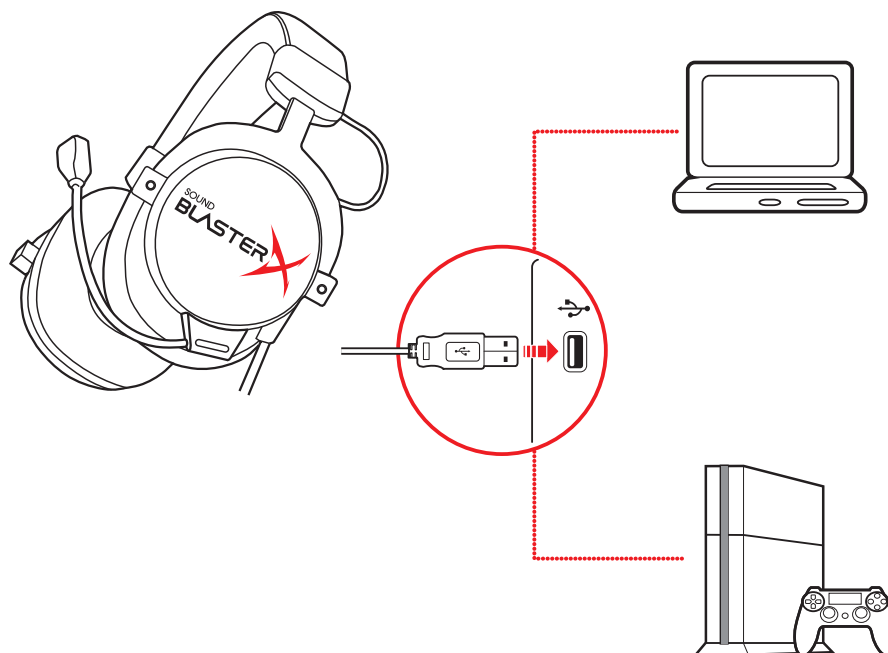

- (a) Micro USB-to-USB cable
- (b) Computer
- (c) PS4

### X-Plus Signature

Configure the X-Plus Signature of your Sound BlasterX H7 with your desired game audio profile to enjoy the same enhanced audio signature anywhere – no driver or application installation required. See **Using the Creative Software Suite – X-Plus Configurator**

### BlasterX Acoustic Engine Pro

Enhance audio playback with BlasterX Acoustic Engine Pro enhancements such as 7.1 surround sound, Scout Mode, immersion control, dynamic range restoration, low-frequency boost, dialog boost, and automatic volume levelling. See **Using the Creative Software Suite – BlasterX Acoustic Engine Pro**.

#### Note:

*X-Plus Signature and BlasterX Acoustic Engine Pro settings cannot be used together at the same time.*

*If your computer is installed with both the **X-Plus Configurator** and **BlasterX Acoustic Engine Pro** applications, your headset audio settings will switch according to the last application launched. A balloon notification will pop up to indicate the current active mode.*

## Connecting to a mobile device / Xbox® via analog cable

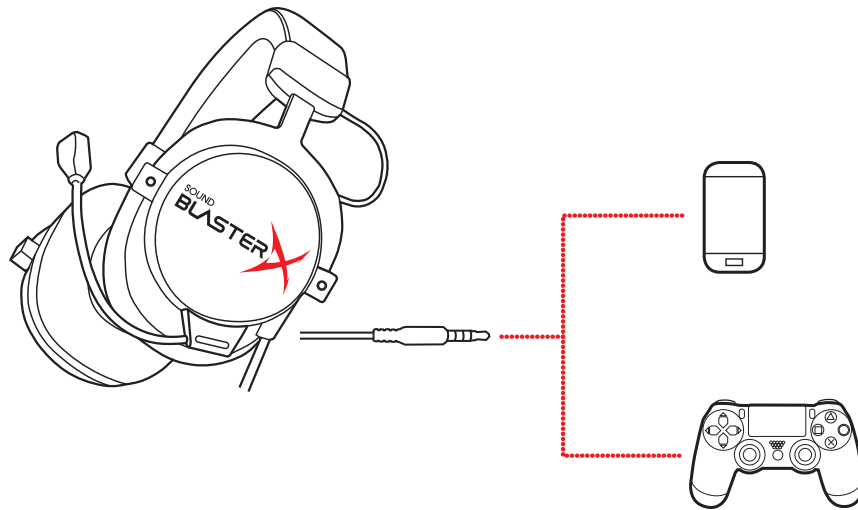

- (a) 3.5 mm 4-pole analog cable
- (b) Mobile device
- (c) Xbox controller

## Playing audio

Connect your Sound BlasterX H7 to your computer via USB to enjoy the ultimate gaming audio experience with BlasterX Acoustic Engine Pro.

You can also connect it directly to a PS4 via USB for high resolution audio playback.

Alternatively, you may also connect via the analog cable to portable gaming devices to enjoy powerful gaming audio on the go.

### Multifunction button

- Press once to pause playback
- Press again to resume playback

## Answering calls

### Mobile communication

When there's an incoming call from your mobile device while you are listening to music, the music fades out and the ringtone will gradually be heard.

### Multifunction button

- Press once to answer an incoming call
- Press again to end a call

The music will resume after the call has ended.

### Desktop communication

Use the Sound BlasterX H7 to enjoy outstanding acoustic performance in popular VoIP applications like Ventrilo® and TeamSpeak®. Hear and be heard clearly by teammates during multiplayer games to get the tactical edge.

You may choose to morph your voice with special effects with the Voice FX too! See **Having Fun with Voice FX**.

When there's an incoming call, click on the answer call button prompted on the computer screen to enter voice communication.

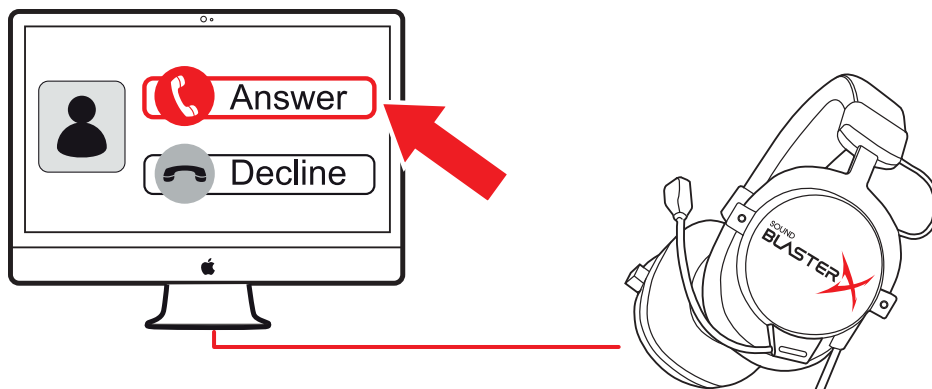

# Installing and Uninstalling Software

---

## **(For Windows Only)**

To take full advantage of your Sound BlasterX H7 audio device, you need to install device drivers and applications. At times, you may also need to uninstall some or all of the device drivers and applications to correct problems, change configurations, or upgrade outdated drivers or applications.

## **Installing Drivers and Applications**

**Ensure that your audio device is connected before proceeding. For instructions on connecting your audio device, consult your Quick Start leaflet.**

After you have connected your audio device, turn on your computer. Windows automatically detects your audio device and searches for device drivers.

1. Using a standard web browser, visit [www.creative.com/support/BlasterXH7](http://www.creative.com/support/BlasterXH7).
2. Locate **Sound BlasterX H7** and the software package(s) for your Windows operating system.
3. Download the package(s) into your local hard disk.
4. Locate and launch the software package(s).
5. Follow the on-screen instructions to complete the installation.
6. When prompted, restart your computer.

### **Note:**

*Depending on your operating system, model and software version, the user interface or color theme may differ.*

## **Uninstalling Drivers and Applications**

In the event that an uninstallation is required (such as for upgrades), please follow the following procedure.

**Before you begin, close all running audio applications. Applications that are still running during uninstallation will not be removed.**

1. From the **Control Panel**, click **Uninstall a program**.
2. Select Sound BlasterX H7.
3. Click the **Uninstall** button or option.  
If the **User Account Control** dialog box appears, click the **Continue** button.
4. Click the **Yes** button.
5. When prompted, restart your computer.

# Using the Creative Software Suite

---

A software suite for the Sound BlasterX H7 is developed to provide additional enhancements to the audio and voice inputs and outputs of the product.

## Applications

For Windows

- BlasterX Acoustic Engine Pro
- X-Plus Configurator
- Creative ALchemy
- Host OpenAL + EAX 5 HD
- Creative Online Registration
- Creative System Information

## Bonus Pack Software (for Windows only)

Various other bonus Creative applications are also compatible for your audio device.

Visit [www.creative.com/support/BlasterXH7](http://www.creative.com/support/BlasterXH7) and navigate to the relevant product page to view and download these applications:

- Creative WaveStudio
- Creative Smart Recorder

## Automatic Software Update

Locating, downloading and installing updates for your Creative product is now simpler and faster with the in-app Automatic Software Update system.

1. Connect your product to your computer.
2. Launch the **BlasterX Acoustic Engine Pro** application.
3. Click  to go to the settings menu, and then select **Software Update**.
4. Follow the instructions on the screen.

### Note:

*An Internet connection is necessary. Ensure that your system is connected to the Internet before you perform the check for software updates.*

# BlasterX Acoustic Engine Pro

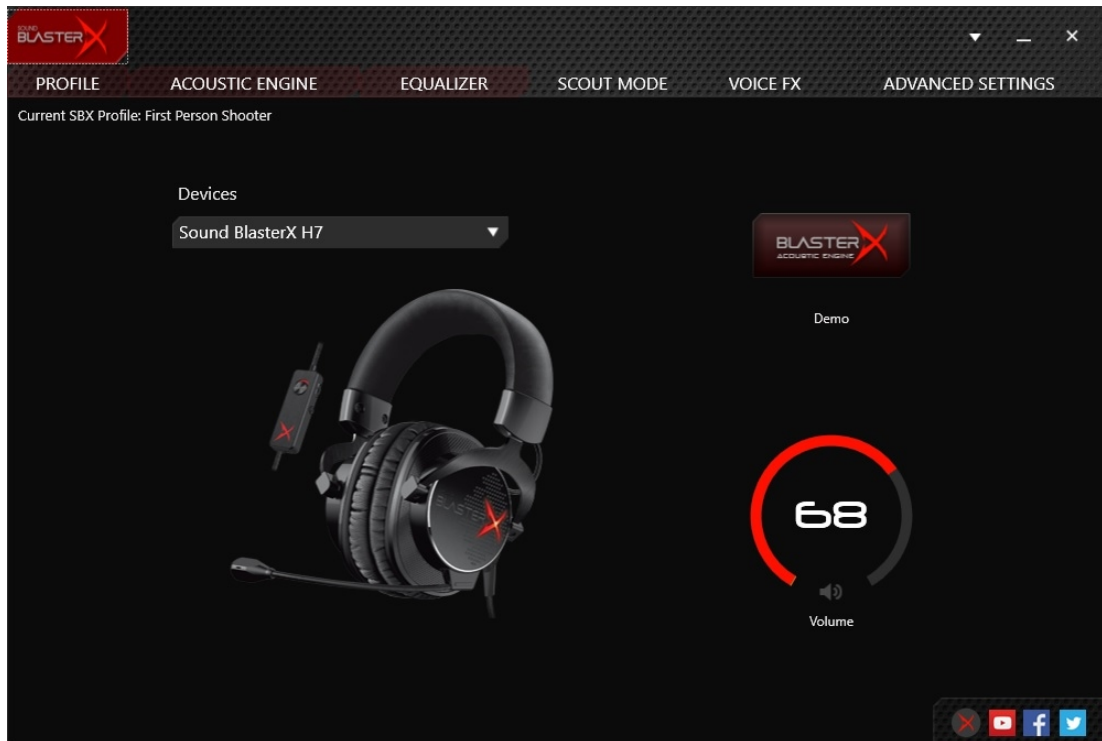

## Configuring Your Software Settings

Click each feature to access its settings page. More information on each feature can be found in their respective sections in this manual.

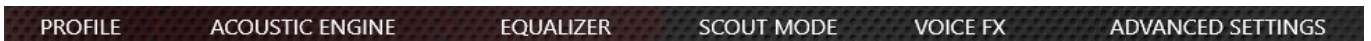

### Note:

*X-Plus Signature settings will be disabled when BlasterX Acoustic Engine Pro is launched. To use X-Plus Signature, launch the **X-Plus Configurator** application.*

# Profile

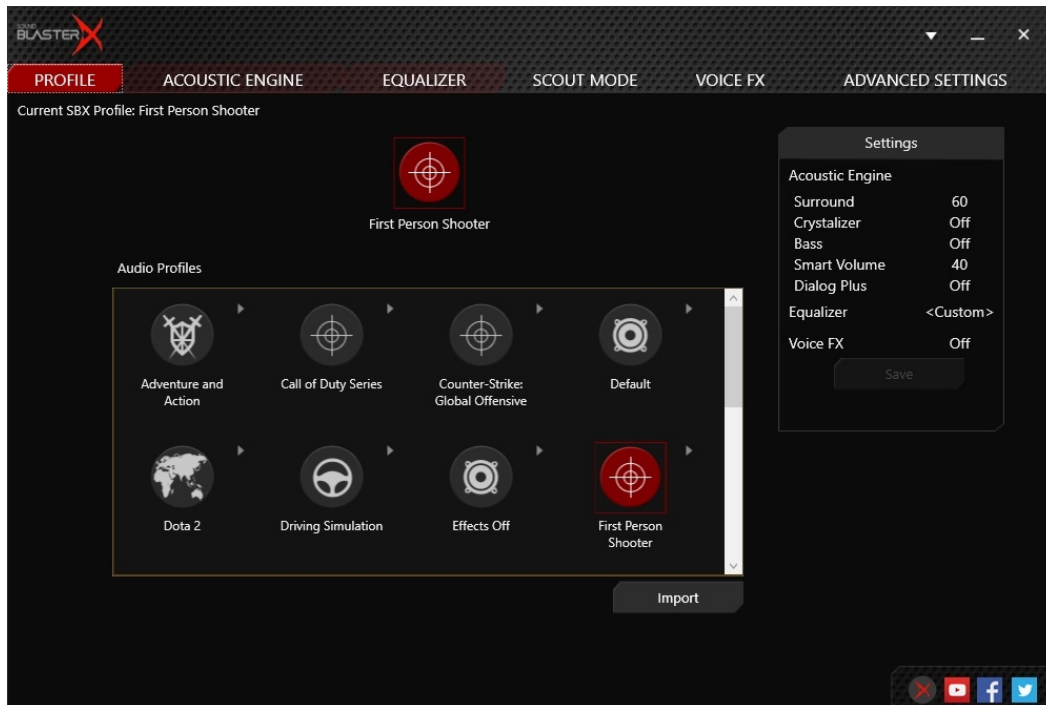

## Preset Audio Profiles

Select from 6 preset profiles to enhance essential audio details in your game, movie or music.

- **Adventure and Action** enhances clarity of audio details for a cinematic experience and a gaming edge, allowing you to hear your enemies to evade capture or set-up an ambush.
- **Driving Simulation** magnifies details such as tire noises as the car races along — enabling you to hear subtle differences and cues you in on how your car is behaving on the road while racing.
- **First Person Shooter** increases spatial reality and perception with virtual surround for enhanced situational awareness — important in close-quarter firefights.
- **Movies** adds more immersion and depth to make movies come alive while boosting the clarity of voices in movies for clearer dialog over explosive sounds.
- **Music** restores the dynamic range that is lost in compressed music files and adds warmth for long hours of music listening without fatigue.
- **Real Time Strategy** boosts audio clarity of elements that are key in allowing gamers to pickup points while reducing distractions — letting you stay focused when pitched against time.

## Editing Profile

1. Go to the **ACOUSTIC ENGINE**, **EQUALIZER** and/or **VOICE FX** tab to adjust the audio enhancement levels.
2. Return to the **PROFILE** tab, and then click **Save** to save your settings as a new audio profile. The newly saved profile should appear in the Audio Profiles section.

## Acoustic Engine Settings

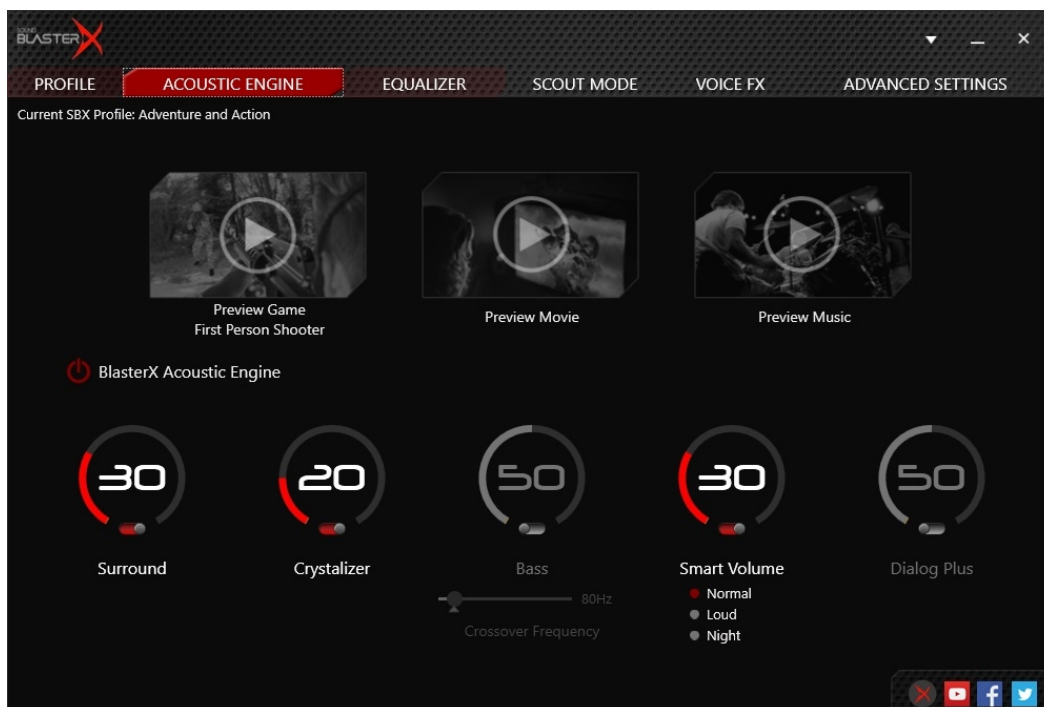

### Enhancing Your Listening Experience

You can adjust the amount to apply for each enhancement by dragging its slider counterclockwise to decrease or clockwise to increase.

To test the effects of the audio enhancements, click .

- **Surround** provides immersion control of sounds not just around you, but also above and below for a full 3D audio experience. Hear the natural sense of audio depth, spaciousness and stunning 3D surround effects from your audio content. Enjoy an unbelievably true-to-life audio experience, whether it's over stereo speakers or headphones.
- **Crystalizer** restores the dynamic range that is lost when iTunes and MP3 music gets compressed. This makes the music sound as good as the artist originally intended, and adds an enhanced level of realism for movies and games.
- **Bass** fills in the low frequency tones and gives the extra impact for a better entertainment experience. It dramatically improves the sound experience without a subwoofer.  
**Crossover Frequency** determines the frequencies to be redirected to the subwoofer.
- **Smart Volume** addresses the problem of abrupt volume level changes during playback and between songs by automatically and continuously measuring volume, and intelligently applying gain and attenuation to compensate for those changes.
- **Dialog Plus** enhances the voices in movies for clearer dialog, allowing the listener to hear the dialog over the rest of the soundtrack and over ambient noise in the listening environment.

# Equalizer Settings

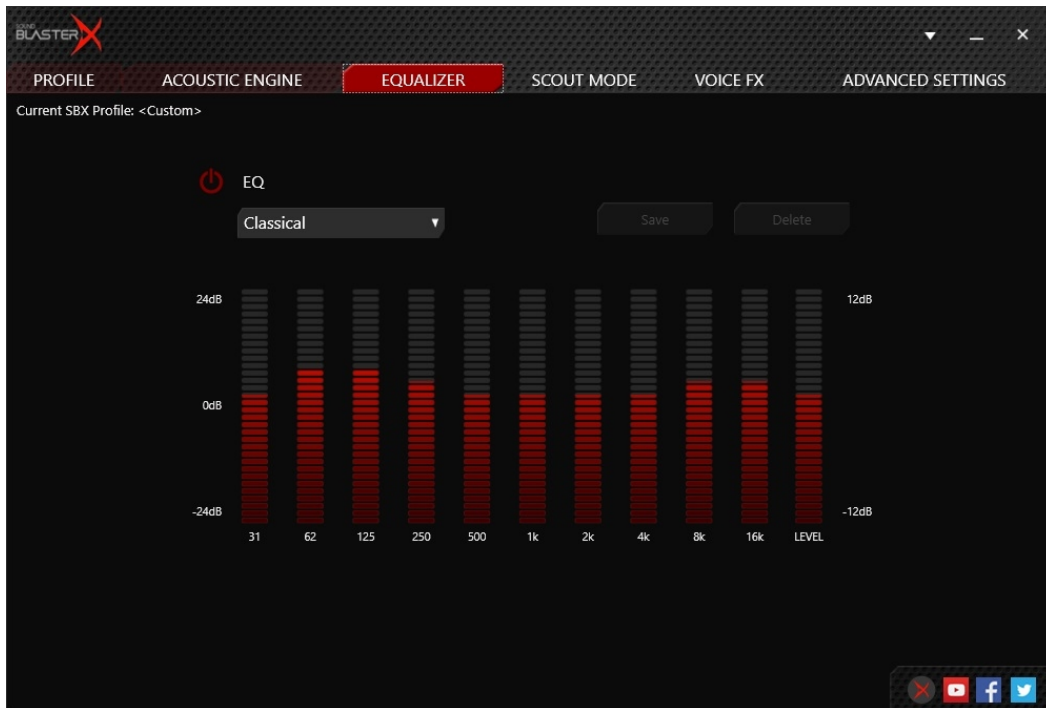

## Customizing Your EQ Settings

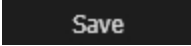
1. Click  to enable this feature, then click the EQ drop-down arrow and select a preset from the list.
2. Selecting a preset will move the EQ sliders to the appropriate values. You can then adjust the equalizer setting by dragging the sliders up or down to the desired level.
3. Click  to save the new configuration as a new preset.

### Note:

*The list of default EQ presets cannot be deleted or overwritten.*

## Scout Mode

Scout Mode delivers audio realism that enables you to hear your opponents from further away, giving you a distinct tactical advantage in combat.

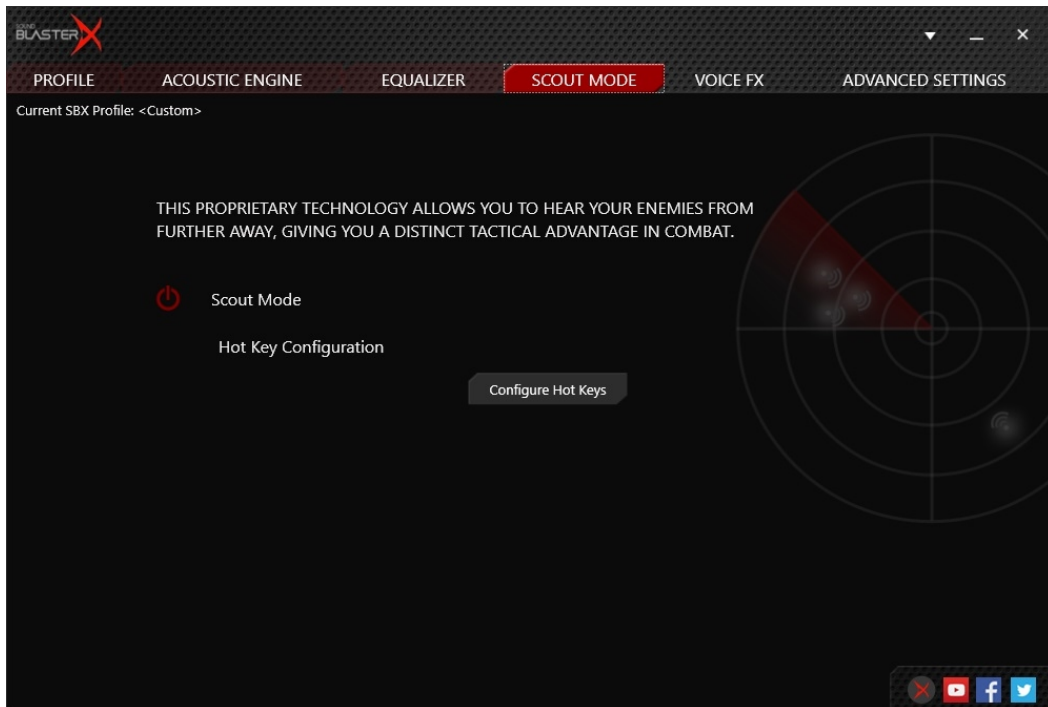

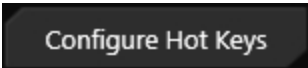

1. Click  to enable this feature.
2. Click  to configure hotkeys for turning on and turning off Scout Mode.

## Voice FX Settings

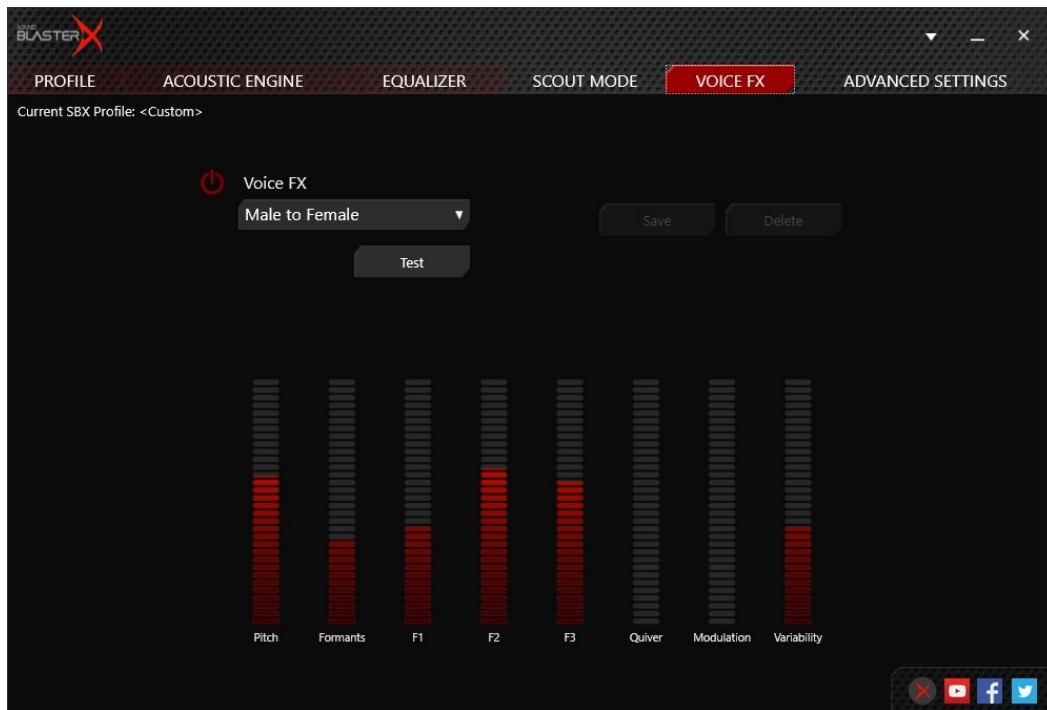
Voice FX enables the speaker's voice to be altered with a variety of effects, which can be used to enhance the tone of the speaker's voice, create interesting accents or to sound like a completely different person.

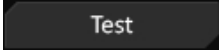

### Having Fun with Voice FX

1. Click  to enable this feature, then click the Voice FX drop-down arrow and select a preset from the list.
2. Selecting a preset will move the Voice FX sliders to the appropriate values. You can then adjust the Voice FX setting by dragging the sliders up or down to the desired level.
3. Click  to save the new configuration as a new preset.
4. To test the effects of the audio enhancements, click  and speak into your microphone.

## Headphones Settings

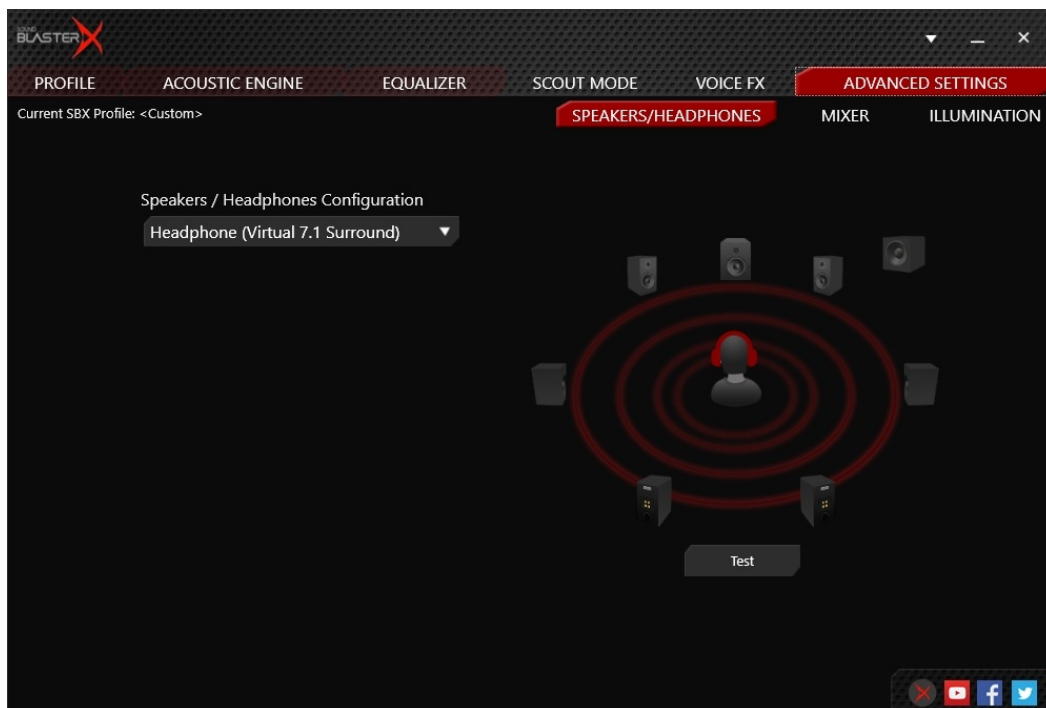

The BlasterX Acoustic Engine Pro enables you to enjoy audio with 7.1 channel virtual surround sound from your Sound BlasterX H7.

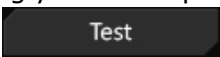

1. Speakers/Headphones Configuration  
Shows your current physical speakers or headphones configuration.
2. Testing your audio playback  
Click  to hear a sample audio clip being played back through your setup.

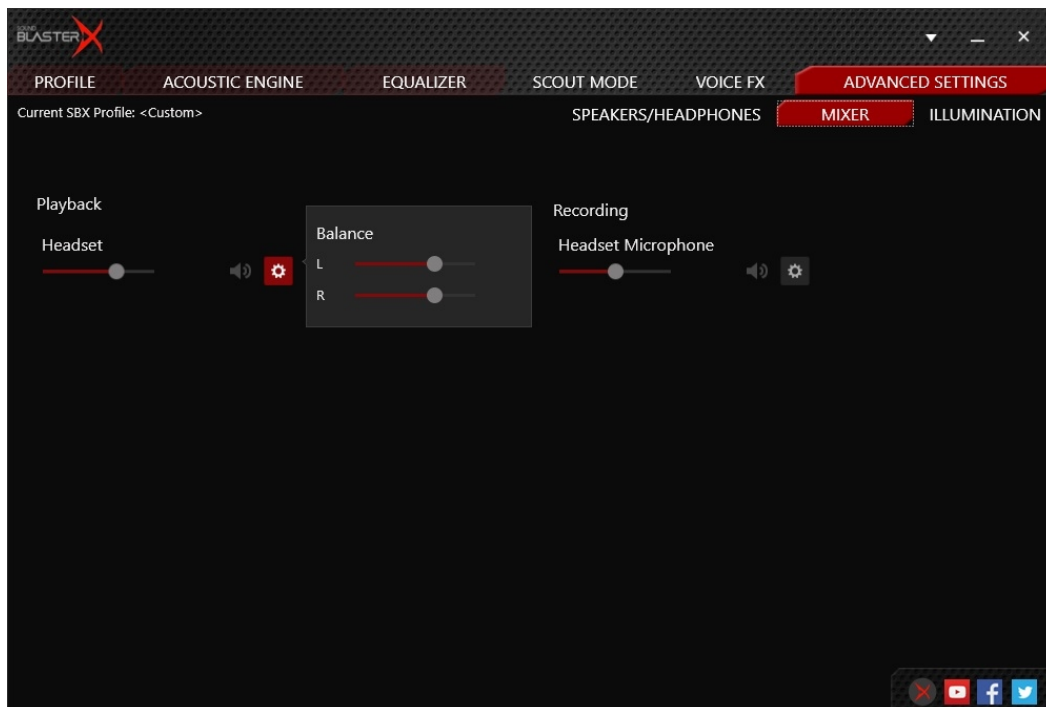
## Mixer Settings



1. Volume sliders  
Under **Playback**, adjust your playback volumes, or to mute/unmute them.  
Under **Recording**, adjust your recording volumes or to mute/unmute them.
2. Mixer settings  
Click the  icon to mute/unmute the input/output.  
You can click the  icon to adjust more settings for your input/output.

## Illumination Settings

Adjust the intensity and pulsation effect of the "X" logo on your Sound BlasterX H7 earcups.

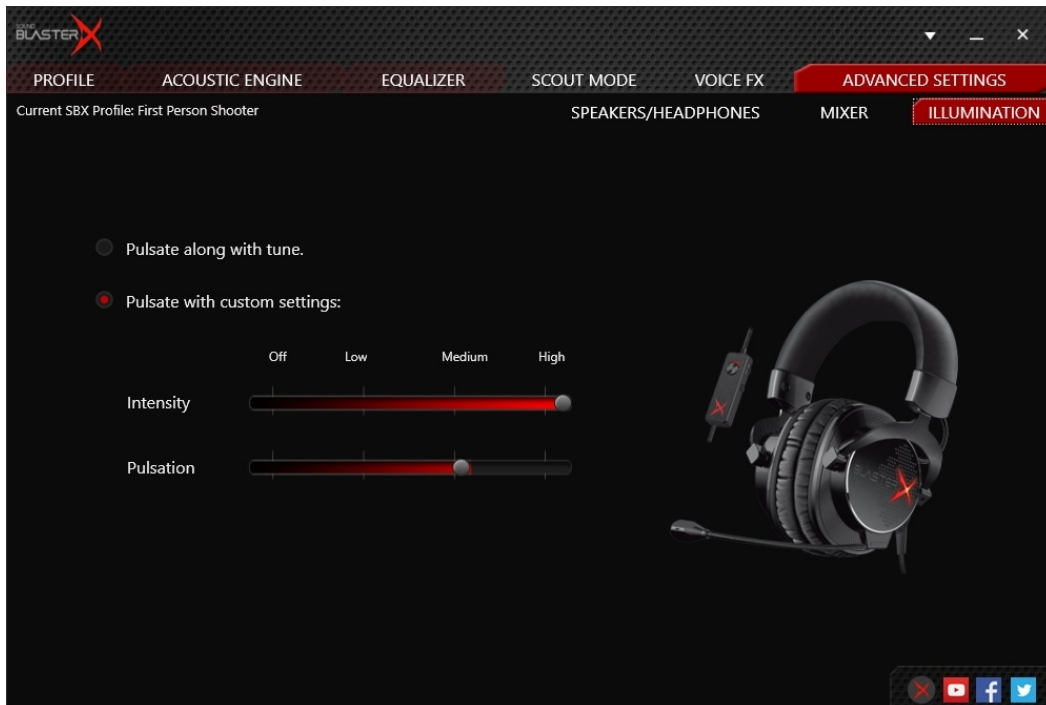

### 1. Pulsate along with tune

Select to set the illumination effect following the beat of your audio.

### 2. Pulsate with custom settings

Select to adjust the illumination effect to the desired level.

You can disable or adjust the intensity and pulsation levels by dragging the sliders left to decrease or right to increase.

## X-Plus Configurator

Configure your Sound BlasterX H7 with your desired game audio profile to enjoy the same enhanced audio signature anywhere – no driver or application installation required.

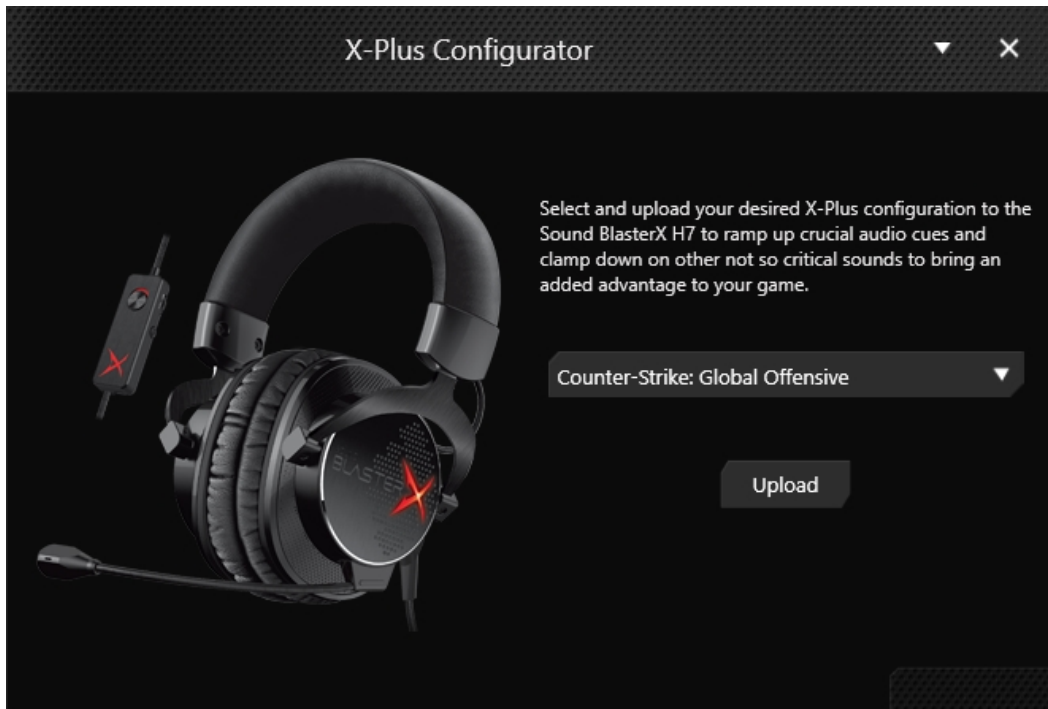

1. Download and install the **X-Plus Configurator** application to configure the X-Plus audio signature of your headset.
2. Connect your Sound BlasterX H7 to the computer.
3. Launch the **X-Plus Configurator** application.
4. Select your desired X-Plus audio profile, and click **Upload**.
5. To change the audio signature, repeat step 4 to select another game profile.

### Note:

*BlasterX Acoustic Engine Pro settings will be disabled when X-Plus Configurator is launched. To further enhance and customize your audio, launch the **BlasterX Acoustic Engine Pro** application.*

# General Specifications

---

## Connectivity

- 3.5 mm (1/8") 4-pole jack for connection to mobile devices
- Micro USB port for connection to computers and PS4

## Physical Specifications

- Weight: Approx. ~291 g

## Technical Specifications

- **Headphone**
  - Driver: 50 mm Neodymium magnet
  - Frequency response: 20 Hz ~ 20 kHz
  - Impedance: 32  $\Omega$
  - Sensitivity: 118 dB/mW @ 1 kHz
  - USB Input: 5 V
- **Microphone**
  - Type: Unidirectional noise-reduction
  - Frequency response: 100 Hz ~ 15 kHz
  - Impedance: <2.2 k $\Omega$
  - Sensitivity: -40 dB @ 1 kHz

# Troubleshooting and Support

---

This section provides solutions to problems you may encounter during installation or normal use.

## Problems with Sound

### No sound from the headphones.

Check the following:

- The headset is properly connected.
- Ensure the volume control of the Sound BlasterX H7 is not at minimum level.
- Ensure the volume setting in the BlasterX Acoustic Engine Pro is not muted.
- Ensure the volume on your connected device or the media player is not muted.
- There is no hardware conflict between the headset and a peripheral device.
- The headset is selected as the default audio device. Ensure that existing analog headset is disconnected.

### There is clipping/distortion during audio playback.

Check the following:

- Your computer system should be running in high performance mode. You may need to disable any power saving features.
- The music source may be distorted. Ensure that the music played has no distortion.
- Ensure that the software graphical equalizer or sound processing effects found in third party media players are disabled.

### Low microphone level on PS4.

Do the following:

1. Go to the PS4 **Home Screen**.
2. Scroll up from the Home Screen to the **Home Menu** and select **Settings**.
3. Select **Devices**.
4. Select **Audio Devices**.
5. Select **Adjust Microphone Level**.
6. Speak into the headset's microphone and adjust the **Microphone Level** to the appropriate level and save the setting.

### X-Plus Signature or BlasterX Acoustic Engine Pro settings are not functioning

Check the following:

- Your headset may be in BlasterX Acoustic Engine Mode or X-Plus Mode. X-Plus Signature and BlasterX Acoustic Engine Pro settings cannot be used together at the same time. Launch X-Plus Configurator or BlasterX Acoustic Engine Pro to enable the respective settings.

### Some features are disabled when playing certain games.

When playing games that use DirectSound3D or OpenAL sound engines, certain audio features will be disabled automatically. This is to avoid distorting the environmental audio cues present in the game. These features will be re-enabled automatically when you exit the game.

## Additional guide for Mobile Users

Generally a 4-pole stereo cable bundle allows you to connect your headset to your iPhone / Android phone / tablet. However, some phone / tablet's 4-pole female jack has different configuration and this cable is unable to support if the configuration is different from the jack (bundled) as illustrated below:

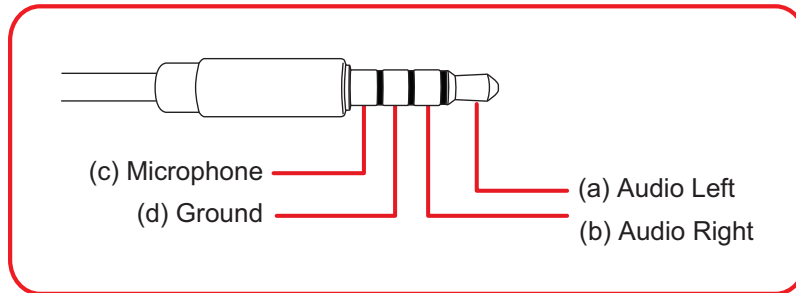

Should you be keen to connect your headset to an MP3 Player, you will need to check if the configuration of its 4-pole female jack is compatible.

## Additional Support

If you encounter any other issues or have any other enquiries about your Sound BlasterX H7 or any other Creative products, please visit our comprehensive knowledge base at [support.creative.com](http://support.creative.com) for additional information.

# Safety Information

---

Refer to the following information to use your product safely, and to reduce the chance of electric shock, short-circuiting, damage, fire, hearing impairment or other hazards. Improper handling may void the warranty for your product. For more information, read the warranty available with your product.

- Do not dismantle or attempt to repair your product.  
**Refer all servicing to authorized repair agents.**
- Do not expose your product to temperatures outside the range of 0°C to 45°C (32°F to 113°F).
- Do not pierce, crush or set fire to your product.
- Keep your product away from strong magnetic objects.
- Do not subject your product to excessive force or impact.
- Do not expose your product to water or moisture.  
If your product is moisture-resistant, take care not to immerse your product in water or expose it to rain.

## Earphones

- Do not listen to audio on your earbuds or headphones at high volume for prolonged periods of time as hearing loss may result. For users in the United States, go to [www.hei.org](http://www.hei.org) for more information.
- Do not listen to your audio device at high volume when driving, cycling or crossing the road, especially in heavy traffic or any other traffic condition where such use will hinder safe travel on the roads. We recommend that consumers be extremely cautious when using this device on the road.



## Avoid Hearing Damage

Permanent hearing loss may occur if the headphone is used at high volume. Set the volume to a safe level. You can adapt over time to a higher volume of sound that may sound normal but can be damaging to your hearing. If you experience ringing in your ears or muffled speech, stop listening and have your hearing checked. The louder the volume, the less time is required before your hearing could be affected. Hearing experts suggest that to protect your hearing:

- Limit the amount of time you use the headphone at high volume.
- Avoid turning up the volume to block out noisy surroundings.
- Turn the volume down if you can't hear people speaking near you.

## **IMPORTANT — A LIRE AVEC ATTENTION**

Ecouter de manière prolongée, à un très haut volume sonore de la musique (au dessus de 80 decibels), aumoyen d'un casque ou d'écouteurs, peut entraîner une détérioration irréversible et définitive de vos facultés auditives. L'usage répété et habituel d'un casque ou d'écouteurs à un niveau de volume sonore trop élevé peut donner l'impression à l'utilisateur que le volume sonore émis par l'appareil n'est pas suffisant. L'utilisateur sera tenté d'augmenter, petit à petit, son réglage habituel, risquant ainsi d'atteindre un niveau dangereux pour ses oreilles. Afin de protéger votre santé, et vos oreilles, veillez à maintenir le volume de la sortie casque de votre appareil à un niveau adapté et à interrompre son utilisation régulièrement et particulièrement si des symptômes, comme des troubles de l'ouïe, se manifestent.

N'utilisez pas le casque ou les écouteurs pendant la conduite d'une voiture, d'une bicyclette ou de tout autre véhicule motorisé, afin d'éviter tout accident de la circulation. En outre, il est interdit dans certains pays d'utiliser un casque ou des écouteurs en conduisant. Il peut être également dangereux d'écouter à volume élevé tout en marchant, spécialement aux passages piétons. Soyez toujours extrêmement prudent et cessez d'utiliser cet appareil dans les situations présentant des risques d'accident.

Evitez d'utiliser le casque ou les écouteurs à volume élevé. Les médecins spécialistes de l'audition déconseillent une écoute continue à volume trop élevé. Si vous percevez un sifflement dans les oreilles, réduisez le volume ou cessez l'écoute.

Maintenez un volume d'écoute modéré. Vous pourrez ainsi entendre les sons extérieurs et être attentif aux gens qui vous entourent.

Votre produit Creative accompagné des écouteurs fournis, est conforme à la réglementation française concernant les baladeurs musicaux (Arrêté du 24 Juillet 1998). Les caractéristiques techniques de ces écouteurs se trouvent dans le manuel en ligne et/ou sur le site internet de Creative. Si vous choisissez d'utiliser un autre casque ou d'autres écouteurs, veuillez vous assurer au préalable que leurs caractéristiques techniques soient les mêmes.

# Regulatory Information

---

## Notice for Canada

This Class B digital apparatus complies with Canadian ICES-003.

Cet appareil numérique de la classe B est conforme à la norme NMB-003 du Canada.

**CANADIAN CLASS B STATEMENT:** This digital device does not exceed the Class B limits for radio noise emissions from digital apparatus as set out in the interference-causing equipment statement entitled "Digital Apparatus", ICES-003 of the Department of Communications.

Cet appareil numérique respecte les limites de bruits radioélectriques applicables aux appareils numériques de Class B prescrites dans la norme sur le matériel brouilleur. "Appareils Numériques," NMB-003 édictée par le ministre des Communications.

**MODIFICATION:** Any changes or modifications not expressly approved by the grantee of this device could void the user's authority to operate the device.

Toute modification non approuvée explicitement par le fournisseur de licence de l'appareil peut entraîner l'annulation du droit de l'utilisateur à utiliser l'appareil.

# DECLARATION OF CONFORMITY

According to the FCC96 208 and ET95-19

Manufacturer/Importer's Name: **Creative Labs, Inc.**

Manufacturer/Importer's Address: **1901 McCarthy Boulevard  
Milpitas, CA. 95035  
Tel: (408)428-6600**

*declares under its sole responsibility that the product*

Trade Name: **Creative**

Model Number: **GH0330**

*has been tested according to the FCC / CISPR22 requirement for Class B devices and found compliant with the following standards:*

***EMI/EMC: ANSI C63.4 FCC Part 15 Subpart B  
Complies with Canadian ICES-003 Class B standards***

*This device complies with part 15 of the FCC Rules.*

*Operation is subject to the following two conditions:*

- (1) This device may not cause harmful interference, and*
- (2) this device must accept any interference received, including Interference that may cause undesirable operation.*

*Ce matériel est conforme à la section 15 des règles FCC.*

*Son Fonctionnement est soumis aux deux conditions suivantes :*

- (1) Le matériel ne peut être source D'interférences et*
- (2) Doit accepter toutes les interférences reçues, Y compris celles pouvant provoquer un fonctionnement indésirable.*

Supplementary Information:

Compliance Manager  
Creative Labs, Inc.  
November 2015

## European Compliance

This product conforms to the following:



EMC Directive.

RoHS Directive.

Mains operated products for the European market comply with Low Voltage Directive and Commission Regulation(s) Implementing Directive.

Communication/RF wireless products for the European market comply with R&TTE Directive.

**CAUTION:** To comply with the Europe CE requirement, this device must be installed with CE certified computer equipment which meet with Class B limits.

All cables used to connect this device must be shielded, grounded and no longer than 3m in length. Operation with non-certified computers or incorrect cables may result in interference to other devices or undesired effects to the product.

**MODIFICATION:** Any changes or modifications not expressly approved by Creative Technology Limited or one of its affiliated companies could void the user's warranty and guarantee rights.

## Conformité européenne

Ce produit est conforme aux normes suivantes :

Directive sur les émissions électromagnétiques.

Directive RoHS.

Les produits secteur pour le marché européen sont conformes à la Directive sur la faible tension et à la réglementation de la Commission exécutant la Directive.

Les produits de communication/sans fil RF destinés au marché européen sont conformes à la directive R&TTE.

**ATTENTION :** pour respecter les critères CE d'Europe, cet appareil doit être installé avec du matériel informatique certifié CE respectant les limites de la classe B.

Tous les câbles utilisés pour connecter cet appareil doivent être blindés, reliés à la terre et ne pas faire plus de 3 m de long. L'utilisation d'ordinateurs non certifiés ou de câbles inappropriés peut entraîner des interférences avec d'autres appareils ou des effets indésirables sur le produit.

**MODIFICATION :** toute modification non approuvée explicitement par Creative Technology Limited ou l'une de ses sociétés affiliées peut entraîner l'annulation de la garantie et des droits de garantie de l'utilisateur.

## Conformità alle normative europee

Questo prodotto è conforme alla seguente normativa:

Direttiva EMC.

Direttiva RoHS.

I prodotti che funzionano con corrente di rete per il mercato europeo sono conformi alla direttiva bassa tensione e alla direttiva di implementazione nelle normative europee.

I prodotti di comunicazione/wireless RF per il mercato europeo sono conformi alla Direttiva R&TTE.

**ATTENZIONE:** ai fini della conformità con i requisiti del marchio CE europeo, il dispositivo deve essere installato in un computer certificato CE conforme ai limiti di Classe B.

Tutti i cavi usati per collegare il dispositivo devono essere schermati, dotati di idonea messa a terra e avere una lunghezza massima di 3 metri. L'uso del dispositivo con computer non certificati o cavi non idonei può provocare interferenze ad altri dispositivi nonché danneggiare il prodotto stesso.

**MODIFICHE:** eventuali modifiche o alterazioni non espressamente approvate da Creative Technology Limited o dalle sue società controllate possono rendere nulli la garanzia e il diritto dell'utente a utilizzare il prodotto.

## Einhaltung der europäischen Bestimmungen

Dieses Produkt erfüllt die folgenden Bestimmungen:

EMC-Richtlinie.

RoHS-richtlinie.

Netzbetriebene Produkte für den europäischen Markt erfüllen die Niederspannungsverordnung und der Commission Regulation(s) Implementing-Verordnung.

Drahtlose Kommunikationsgeräte/Funksender und -empfänger für den europäischen Markt erfüllen die R&TTE-Richtlinie.

**ACHTUNG:** Um die Anforderungen der europäischen CE-Norm zu erfüllen, muss dieses Produkt an einem CE-geprüften Computer der Klasse B angeschlossen werden.

Alle Verbindungskabel zu diesem Gerät müssen abgeschirmt und geerdet sein und dürfen nicht länger als 3 m sein. Der Betrieb mit nicht zertifizierten Computern oder nicht ordnungsgemäßen Kabeln kann zu Störungen anderer Geräte oder unerwünschten Auswirkungen auf das Produkt führen.

**MODIFIZIERUNG:** Jegliche Änderung oder Modifizierung des Produkts, die nicht ausdrücklich von Creative Technology Limited oder einer der zugehörigen Firmen genehmigt worden ist, kann für den Benutzer zum Erlöschen der Garantie und der Gewährleistungsrechte führen.

## Homologación para Europa

Este producto cumple:

La Directiva de compatibilidad electromagnética.

Directiva RoHS.

Los productos funcionando con corriente eléctrica cumplen con la Directiva de baja tensión y con la implementación de los requisitos de la Comisión para la directiva.

Los productos inalámbricos de comunicación o frecuencias de radio para el mercado europeo cumplen la Directiva de equipos de radio y terminales de telecomunicaciones.

**ATENCIÓN:** para cumplir con los requisitos de Homologación para Europa, este dispositivo debe instalarse con un equipo informático con certificación CE que cumpla los límites de la Clase B. Todos los cables utilizados para conectar este dispositivo deben estar protegidos, conectados a tierra y no tener más de 3 m de longitud. El funcionamiento del dispositivo con equipos no certificados o cables incorrectos podría provocar interferencias a otros dispositivos o efectos no deseados al producto.

**MODIFICACIÓN:** los cambios o modificaciones no aprobados expresamente por Creative Technology Limited o una de sus empresas afiliadas podrían invalidar la garantía del usuario y los derechos de la garantía.

## Europese naleving

Dit product voldoet aan de volgende voorschriften:

EMC-richtlijn.

RoHS-richtlijn.

Electrische producten voor de Europese markt voldoen aan de Laagspanningsrichtlijn en EC and Verordening(en) voor uitvoering van Richtlijn.

Communicatie- of draadloze RF-producten voor de Europese markt voldoen aan de richtlijn R&TTE.

**LET OP:** Om te voldoen aan de Europese CE-norm, moet dit apparaat zijn geïnstalleerd in computerapparatuur die CE-gecertificeerd is voor de Klasse B-limieten.

Alle kabels die worden gebruikt om dit apparaat aan te sluiten, moeten zijn afgeschermd en geaard, en mogen niet langer dan 3 meter zijn. Gebruik met niet-gecertificeerde computers of incorrecte kabels kan leiden tot interferentie van andere apparaten of ongewenste effecten op het product.

**AANPASSING:** Alle wijzigingen of modificaties die niet uitdrukkelijk zijn goedgekeurd door Creative Technology Limited of een van de gelieerde maatschappijen, kunnen ertoe leiden dat de rechten van de gebruiker met betrekking tot garantie en vrijwaring vervallen.

## Conformidade Europeia

Este produto está em conformidade com a seguinte regulamentação:

Directiva EMC.

Directiva RoHS.

Os produtos com ligação à rede destinados ao mercado europeu estão em conformidade com a directiva de baixa voltagem. Directiva de Implementação do(s) Regulamento(s) da Comissão.

Os produtos de comunicação/radiofrequência sem fios destinados ao mercado europeu estão em conformidade com a directiva R&TTE.

**ATENÇÃO:** De modo a cumprir com os requisitos da marca CE Europeia, este dispositivo deve ser instalado com equipamento informático com certificação CE que cumpra com os limites de Classe B limits.

Todos os cabos usados para ligar este dispositivo devem ser blindados, ligados à terra e não devem exceder os 3m de comprimento. O funcionamento com computadores não certificados ou cabos incorrectos pode resultar em interferências em outros dispositivos ou provocar efeitos indesejados no produto.

**MODIFICAÇÃO:** Quaisquer alterações ou modificações que não sejam expressamente aprovadas pela Creative Technology Limited ou por uma das suas afiliadas, pode anular a garantia do utilizador e os direitos inerentes à mesma.

## Europeisk efterlevnad

Denna produkt uppfyller följande:

EMC-direktivet.

RoHS Direktivet.

Produkter för den europeiska marknaden som drivs via elnätet uppfyller Lågspänningsdirektivet och Kommissionens regleringsimplementeringsdirektiv.

Trådlösa kommunikations/RF-produkter för den europeiska marknaden uppfyller R&TTE-direktivet.

**WARNING:** För att uppfylla CE-kraven i Europa måste denna produkt installeras med CE-certifierad datorutrustning som uppfyller gränsvärdena för klass B.

Alla kablar som används för anslutning av denna produkt måste vara avskärmade, jordade och får inte vara längre än 3 m. Användning med icke certifierade datorer eller felaktiga kablar kan leda till interferens på annan utrustning eller oönskade effekter på produkten.

**MODIFIERING:** Alla förändringar och modifieringar som inte är uttryckligen tillåtna av Creative Technology limited eller något av dess filialföretag kan göra användarens garanti och garantirättigheter ogiltiga.

## Europeisk samsvar

Dette produkt er i samsvar med følgende:

EMC-direktivet.

RoHS-Direktivet.

Elektriske produkter til det europeiske markedet er i samsvar med Lavspenningsdirektivet og Økodesigndirektivet.

Kommunikasjon/RF trådløse produkter til det europeiske markedet er i samsvar med R&TTE-direktivet.

**ADVARSEL:** For å overholde det europeiske CE-kravet må denne enheten installeres med CE-sertifisert datautstyr som tilfredsstillende klasse B-grensene.

Alle kabler som kobles til enheten må være skjermet, jordet og ikke lenger enn 3 m i lengde. Bruk av ikke-sertifiserte datamaskiner eller feil kabler kan føre til forstyrrelse av andre enheter eller uønsket effekt på produktet.

**MODIFIKASJON:** Eventuelle endringer eller modifikasjoner som ikke uttrykkelig er godkjent av Creative Technology Limited eller et av dets tilknyttede selskaper, kan ugyldiggjøre garantien eller garantirettighetene.

## Overholdelse af Europæiske regler og standarder

Dette produkt overholder følgende:

EMC-direktivet.

RoHS-Direktivet.

Produkter til det Europæiske marked, skal overholde Lavspændingsdirektivet og Kommissionens forordninger for implementering af direktivet.

Kommunikations- / RF-trådløse produkter til det Europæiske overholder R&TTE-direktivet.

**ADVARSEL:** For at overholde Europe CE-kravet, skal denne enheden installeres med CE-certificeret computerudstyr, der opfylder klasse B-grænserne.

Alle kabler der anvendes til at tilslutte enheden skal være skærmede, jordforbundne og ikke længere end 3 m lange. Drift med ikke-certificerede computere og ukorrekte kabler kan medføre interferens for andre enheder eller uønskede effekter på produktet.

**MODIFIKATION:** Enhver ændring eller modifikation, der ikke er udtrykkeligt godkendt af Creative Technology Limited eller et associerede selskab, vil gøre brugerens garanti og garanterede rettigheder ugyldig.

## Eurooppalainen yhdenmukaisuus

Tämä tuote täyttää seuraavat tuotemääritykset:

TEMC-direktiivin.

RoHS-direktiivin.

Euroopan markkinoiden verkkovirtaa käyttävät tuotteet ovat matalajännitedirektiivinmukaisia. Euroopan parlamentin ja neuvoston ohjaava direktiivi.

Euroopan markkinoiden tietoliikenne- ja langattomat radiotaajuustuotteet noudattavat R&TTE-direktiiviä.

**VAROITUS:** Jotta tämä laite noudattaisi Euroopan CE-vaatimuksia , tämä laite on asennettava CE-sertifioituun tietokoneeseen, joka noudattaa luokan B rajoituksia.

Kaikki tämän laitteen liittämiseen käytetyt kaapelit tulee suojata ja maadoittaa eivätkä ne saa olla 3 m pidempiä. Luokan rajoituksia noudattamattoman tietokoneen tai vääränlaisten kaapeleiden käyttäminen voi aiheuttaa häiriöitä muihin laitteisiin tai haitata itse laitteen toimintaa.

**MUOKKAUKSET:** Muutokset tai muokkaukset, joita Creative Technology Limited tai sen tytäryhtiöt eivät nimenomaisesti ole hyväksyneet, voivat mitätöidä tuotteelle annetun takuun.

## Evropská shoda

Tento výrobek splňuje následující směrnice:

Směrnice EMC.

Směrnice RoHS.

Výrobky napájené z elektrické zásuvky pro evropský trh splňují směrnici o nízkém napětí a směrnici komise o zavádění předpisů.

Komunikační / vysokofrekvenční bezdrátové výrobky pro evropský trh splňují směrnici R&TTE.

**UPOZORNĚNÍ:** Aby toto zařízení splňovalo evropský požadavek CE, musí být nainstalováno s počítačovým vybavením s certifikátem CE, které splňuje limity pro zařízení třídy B.

Veškeré kabely používané pro připojení tohoto zařízení musí být stíněné, uzemněné a nesmí být delší než 3 metry. Při používání s necertifikovanými počítači nebo nesprávnými kabely může dojít k rušení jiných zařízení nebo k nežádoucím vlivům na produkt.

**ÚPRAVY:** Jakékoli změny nebo úpravy, které nebyly vysloveně schváleny společností Creative Technology Limited nebo některou z jejích dceřiných společností, mohou způsobit propadnutí záruky uživatele a záručních práv.

## Zgodność z przepisami europejskimi

Urządzenie jest zgodne z dyrektywą EMC.

Dyrektywa RoHS.

Urządzenia zasilane z sieci elektrycznej przeznaczone na rynek europejski muszą być zgodne z dyrektywą dotyczącą urządzeń niskonapięciowych oraz z dyrektywą wdrażającą komisji regulacyjnej.

Urządzenia komunikacyjne / bezprzewodowe wykorzystujące transmisję radiową przeznaczone na rynek europejski spełniają warunki dyrektywy RTTE.

**UWAGA:** Aby uzyskać zgodność z wymogami europejskiej normy CE urządzenie musi być zainstalowane wraz ze sprzętem komputerowym mającym certyfikat CE z ograniczeniami klasy B.

Wszystkie przewody używane do podłączania niniejszego urządzenia muszą być ekranowane, uziemione i nie dłuższe niż 3 metry. Użytkowanie z komputerami nie posiadającymi certyfikatów lub wykorzystanie niewłaściwych przewodów może powodować zakłócenia pracy innych urządzeń lub opisywanego urządzenia.

**MODYFIKACJE:** Dokonanie jakichkolwiek zmian lub modyfikacji, na które firma Creative Technology Limited lub spółki z nią stowarzyszone nie udzielają wyraźnej zgody, może doprowadzić do unieważnienia praw gwarancji i rękojmi użytkownika.

## Соответствие европейским нормам

Данное изделие соответствует следующим стандартам:

EMC Директива.

Продукция с питанием от сети, поставляемая на европейский рынок, соответствует Директиве по низковольтному оборудованию и Имплементирующей директиве постановления (-й) комиссии.

Коммуникационное/радио- беспроводное оборудование, поставляемое на европейский рынок, соответствует Директиве по окончному радио- и телекоммуникационному оборудованию.

**ВНИМАНИЕ!** Для обеспечения соответствия европейским требованиям CE, это устройство должно устанавливаться с компьютерным оборудованием, сертифицированным по стандарту CE и удовлетворяющим нормам класса B.

Все кабели, используемые для подключения данного устройства, должны быть экранированы, заземлены и иметь длину не более 3 м. Работа с несертифицированными компьютерами или неподходящими кабелями может привести к возникновению помех другим устройствам или негативному влиянию на работу самого изделия.

**ИЗМЕНЕНИЯ КОНСТРУКЦИИ** Любые изменения конструкции, на которые не было получено прямое разрешение компании Creative Technology Limited или ее дочерней компании, может привести к аннуляции гарантии и связанных с ней прав.

## Ευρωπαϊκή συμμόρφωση

Εξαιτίας της συμμόρφωσης με τα παρακάτω:

Από την ηλεκτρομαγνητική συμβατότητα, RoHS.

Από την Ευρωπαϊκή περιοχή για τα ηλεκτρικά προϊόντα που συμμορφώνονται με τις απαιτήσεις που ορίζονται στην οδηγία σχετικά με την ηλεκτρομαγνητική συμβατότητα.

Από την οδηγία σχετικά με την ηλεκτρομαγνητική συμβατότητα.

Από την Ευρωπαϊκή περιοχή για τα ηλεκτρικά προϊόντα που συμμορφώνονται με τις απαιτήσεις που ορίζονται στην οδηγία σχετικά με την ηλεκτρομαγνητική συμβατότητα.

**FIGYELEM!** Az európai CE követelmények teljesítéséhez ezt a készüléket a B kategóriájú értékeknek megfelelő, CE minősítésű számítógéppel együtt kell telepíteni.

A készülék csatlakoztatására használt valamennyi kábelnek árnyékoltnak és földeltnek kell lennie, továbbá hosszúsága nem haladhatja meg a 3 métert. A nem hitelesített számítógépekkel vagy helytelen kábelekkal való használat más készülékek zavarását vagy a termék nem kívánatos befolyásolását okozhatja.

**ΜΟΔΟΣΙΤΑΣ:** Minden módosítás vagy változtatás, amit kifejezetten nem hagyott jóvá a Creative Technology Limited vagy valamelyik leányvállalata, érvénytelenítheti a készülék garanciáját és felhasználó garanciális jogait.

## Ευρωπαϊκή συμμόρφωση

Το παρόν προϊόν συμμορφώνεται με τα παρακάτω:

Οδηγία ΗΜΣ.

Οδηγία RoHS.

Τα προϊόντα που λειτουργούν με ρεύμα για την ευρωπαϊκή αγορά συμμορφώνονται με την Οδηγία περί χαμηλής τάσης και τους κανονισμούς της επιτροπής που υλοποιούν την οδηγία.

Τα ασύρματα προϊόντα επικοινωνιών / RF για την ευρωπαϊκή αγορά συμμορφώνονται με την οδηγία R&TTE.

**ΠΡΟΣΟΧΗ:** Για τη συμμόρφωση με τις απαιτήσεις του ευρωπαϊκού CE, αυτή η συσκευή θα πρέπει να εγκατασταθεί σε εξοπλισμό υπολογιστή με πιστοποίηση CE ο οποίος πληροί τα όρια της κατηγορίας B.

Όλα τα καλώδια που χρησιμοποιούνται για τη σύνδεση της συσκευής θα πρέπει να είναι θωρακισμένα, γειωμένα και να μην υπερβαίνουν σε μήκος τα 3μ. Η λειτουργία με μη πιστοποιημένους υπολογιστές ή λάθος καλώδια μπορεί να οδηγήσει σε παρεμβολές με άλλες συσκευές ή ανεπιθύμητες επιδράσεις στο προϊόν.

**ΤΡΟΠΟΠΟΙΗΣΗ:** Οι όποιες αλλαγές ή τροποποιήσεις που δεν έχουν εγκριθεί ρητά από την Creative Technology Limited ή κάποια από τις θυγατρικές της ενδέχεται να ακυρώσουν την εγγύηση του χρήστη και τα δικαιώματα που απορρέουν από αυτήν.

## Europos Sąjungos atitiktis

Šis gaminys atitinka šiuos reikalavimus:

„Elektromagnetinės atitikties“ („EMC“) direktyva.

RoHS direktyva.

Produktai, kurie veikia maitinami iš elektros tinklo, skirti Europos rinkai, atitinka Žemos įtampos direktyvą.

Komisijos reglamentas(-ai) dėl Direktyvos įgyvendinimo.

Europos Sąjungos rinkai skirti ryšių / radijo dažnių bevieliai gaminiai atitinka direktyvą „Dėl radijo ryšio įrenginių ir telekomunikacijų galinių įrenginių bei abipusio jų atitikties pripažinimo“.

**ATSARGIAI:** Tam, kad šis prietaisas atitiktų Europos Sąjungos „CE“ reikalavimus, jis turi būti įdiegtas į „CE“ sertifikuotą kompiuterinę įrangą, atitinkančią „B“ klasės ribas. Visi su šiuo prietaisu naudojami laidai turi būti ekranuoti, izeminti ir nevirsyti 3 m ilgio. Nesertifikuotų kompiuterių ar netinkamų laidų naudojimas gali tapti trikdžių kitiems prietaisams arba nepageidaujamų šio gaminio veikimo pasekmių priežastimi.

**MODIFIKAVIMAS:** Bet kokie pakeitimai ar modifikavimai neturint aiškiai patvirtinto „Creative Technology Limited“ ar vienos iš su ja susijusių bendrovių leidimo gali panaikinti vartotojo garantiją ir garantijos teises.

## Dođržiavanie predpisov Európskej únie

Tento výrobok splna nasledujúce normy:

Smernica EMC.

Smernica RoHS.

Výrobky napájané zo siete určené na európsky trh sú v súlade so smernicou o harmonizácii právnych predpisov členských štátov týkajúcich sa elektrického zariadenia určeného na používanie v rámci určitých limitov napätia a s nariadeniami Komisie, ktorými sa vykonáva smernica.

Bezdrôtové komunikacné/RF výrobky určené na európsky trh sú v súlade so smernicou R&TTE.

**VAROVANIE:** Toto zariadenie musí byť nainštalované s počítačovým zariadením s certifikáciou CE, ktoré splna limity triedy B, aby bolo v súlade s európskymi požiadavkami CE.

Všetky káble použité na pripojenie tohto zariadenia musia byť tienené, uzemnené a nie dlhšie ako 3 m. Prevádzka pomocou necertifikovaných počítačov alebo nesprávnych káblov môže mať za následok rušenie iných zariadení alebo nežiaduce účinky na výrobok.

**ÚPRAVY:** Akékoľvek zmeny alebo úpravy, ktoré neboli výslovne odsúhlasené spoločnosťou Creative Technology Limited alebo jednou z jej sesterských spoločností, môžu zrušiť platnosť záruky a záručných práv používateľa.

## Avrupa Uyumu

Bu ürün ařađıdakilere uygundur:

EMC (Elektromanyetik Uyumluluk) Yönetmeliđi.

RoHS (Tehlikeli Maddelerin Kısıtlanması) Yönetmeliđi

Avrupa piyasasına yönelik, elektrik řebekesi tarafından alıřtırılan ürünler Alak Gerilim Yönetmeliđi (LVD) ve Enerji ile İlgili Ürünlerin evreye Duyarlı Tasarımına İliřkin Yönetmeliđe uygundur.

Avrupa piyasasına yönelik İletişim / RF kablosuz ürünleri R ve TTE Yönetmeliđi ile uyumludur.

**DİKKAT:** Avrupa CE gereksinimleriyle uyumlu olması için bu cihazın, B Sınıfı sınırlarına uygun olan CE sertifikalı bilgisayar donanımları ile birlikte kurulması gerekir.

Bu cihazı bağlamak için kullanılan tüm kabloların koruyuculu ve topraklanmış olması ve 3 metreden uzun olmaması gerekir. Sertifikalı olmayan bilgisayarlarla veya yanlış kablolarla birlikte kullanılması, diđer cihazların düzgün alıřmamasına veya üründe istenmeyen etkiler görülmesine neden olabilir.

**DEĐİŐİKLİKLER:** Creative Technology Limited veya bađlı řirketlerinden biri tarafından açıka onaylanmamıř tüm deđiřiklikler kullanıcının garanti ve teminat haklarını geçersiz kılabilir.

## Ukraine RoHS Statement

Обладнання відповідає вимогам Технічного регламенту щодо обмеження використання деяких небезпечних речовин в електричному та електронному обладнанні, затвердженого постановою Кабінету Міністрів України від 3 грудня 2008 № 1057

## Notice for Korea

### B급 기기

(가정용 방송통신기자재 )

Class B Equipment

(For Home Use Broadcasting & Communication Equipment)

이 기기는 가정용 (B급) 전자파적합기기로서 주로 가정에서 사용하는 것을 목적으로 하며, 모든 지역에서 사용할 수 있습니다.

This equipment is home use (Class B) electromagnetic wave suitability equipment and to be used mainly at home an it can be used in all areas.

## Vietnam RoHS Statement

This product is in compliance with Circular 30/2011/TTBCT of the Ministry of Trade of the Socialist Republic of Vietnam ("Circular"), it does not contain the following substances in concentration greater than the Maximum Limit value as specified in the Circular.

<b>Substance</b>	<b>Maximum Limit (ppm) <sup>1, 2</sup></b>
• lead	1000
• mercury	1000
• cadmium	100
• hexavalent chromium	1000
• polybrominated biphenyls (PBB)	1000
• polybrominated diphenyl ethers (PBDE)	1000

<sup>1</sup> Maximum Limit does not apply to applications exempted from the Circular.

<sup>2</sup> Maximum Limit refers to concentration by weight in homogeneous materials.

# License and Copyright

---

Information in this document is subject to change without notice and does not represent a commitment on the part of Creative Technology Ltd. No part of this manual may be reproduced or transmitted in any form or by any means, electronic or mechanical, including photocopying and recording, for any purpose without the written permission of Creative Technology Ltd.

© 2016 Creative Labs Pte. Ltd. All rights reserved. Creative, the Creative logo, Sound Blaster, the BlasterX logo and Creative ALchemy are trademarks or registered trademarks of Creative Technology Ltd. in the United States and/or other countries. Intel and Intel Core are trademarks of Intel Corporation in the U.S. and/or other countries. AMD is a registered trademark of Advanced Micro Devices, Inc. Microsoft, Windows and Windows Vista are either registered trademarks or trademarks of Microsoft Corporation in the United States and/or other countries. Mac and OS X are trademarks of Apple Inc., registered in the U.S. and other countries. Other trademarks and trade names are those of their respective owners. All specifications are subject to change without prior notice. Use of this product is subject to a limited hardware warranty. Actual contents may differ slightly from those pictured. The software included in this packaging may not be used separately from the hardware. Before using the software, you must agree to be bound by the terms and conditions of the end user license agreement.

Version 1.1

March 2016