

**Package Includes • Inclus dans l'emballage • El paquete incluye**

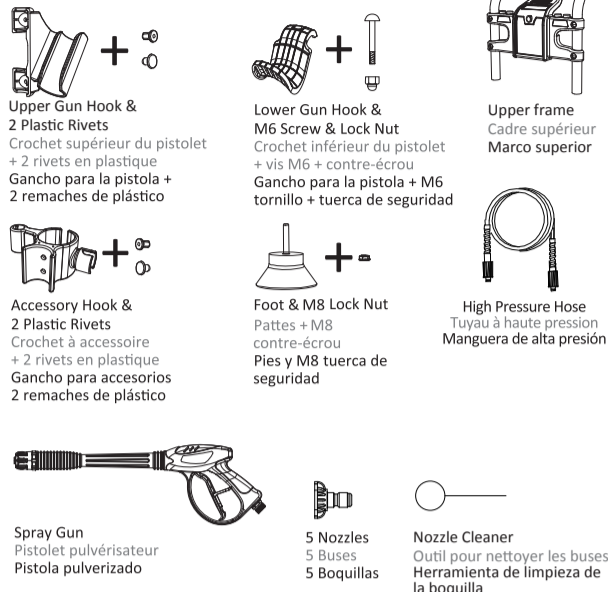

**What you will need: Vous aurez besoin de: Usted necesitará:**

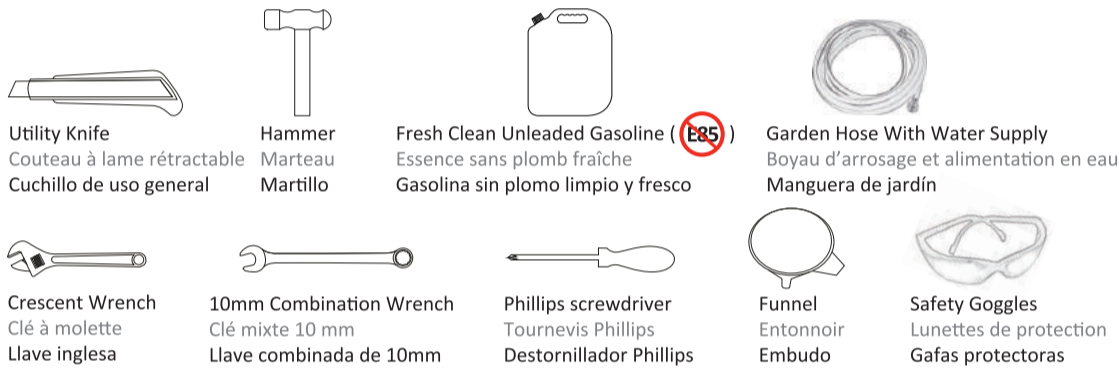

**Note:** Failure to read and follow the instructions in user manual(s) could result in death, bodily injury, and/or property damage.  
**Note:** Vous risquez la mort, des blessures et des dommages matériels si vous ne lisez pas et ne respectez pas les consignes du guide de l'utilisateur.  
**Nota:** El no leer y seguir las instrucciones de este manual(es) puede causar la muerte, lesiones corporales y/o daños materiales.

**1** Attach the foot, install M8 lock nut, wrench tighten until the nut is snug, do not over tighten.

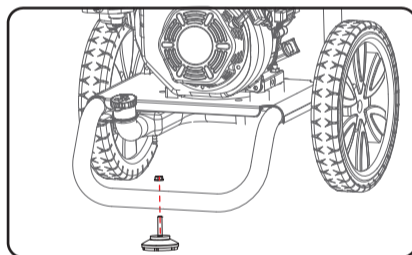

**2** Install upper frame (handle) onto the lower frame by sliding the handle over the two upright tubes on the lower frame and pressing down firmly until the handle is seated and the two detent pins snap in place.

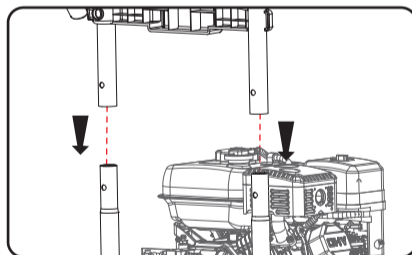

**3** Attach the upper gun hook, install two plastic rivets, until the plastic rivets are snug, you may need to tap with a mallet or small hammer to seat the lock pin. Attach the lower gun hook, install the M6 screw & lock nut, wrench tighten until the nut is snug, do not over tighten.

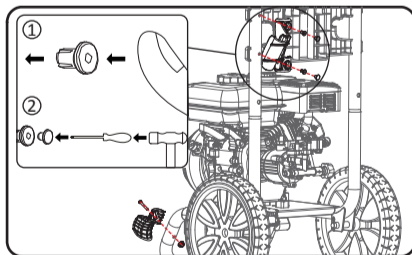

**4** Attach the accessory hook, install two plastic rivets, until the plastic rivet is snug, you may need to tap with a mallet or small hammer to seat the lock pin. After each use of the nozzle cleaner, place it back in the accessory hook for storage.

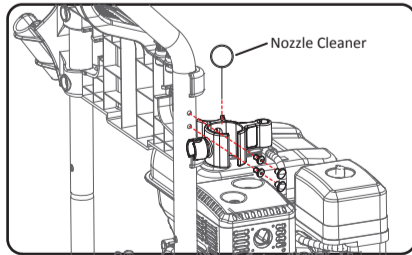

**5** Attach high pressure hose to the gun hand tighten.

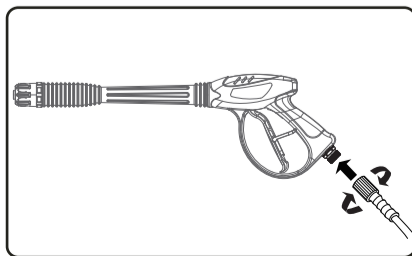

**6** Install the lance to the spray gun and select and install the spray nozzle to be used for the task. Install the nozzle by pulling the quick connect sleeve (locking collar) back and inserting the nozzle fully and release the sleeve. Tug on the nozzle to insure it is fully locked in place.

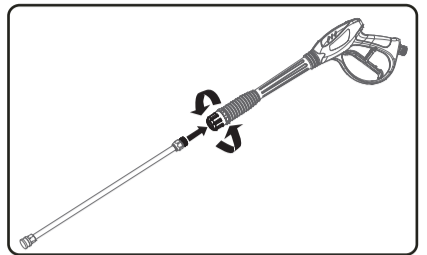

**7** Connect the garden hose to the water supply and turn on the water for a few seconds to flush out any debris that may have collected in the hose.

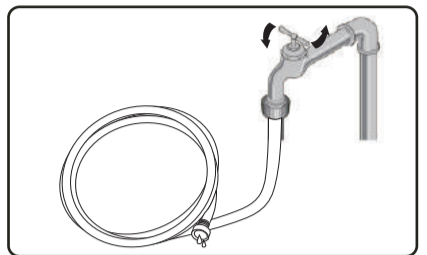

**8** Connect the garden hose to the pump inlet ensuring the inlet screen and washer are present.

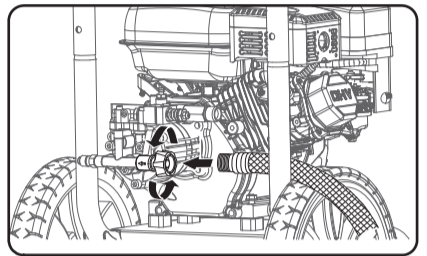

**9** Attach the opposite end of the high pressure hose to the pump outlet.

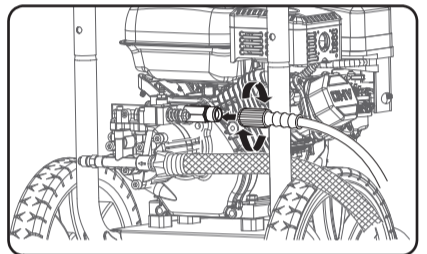

**10** Turn on the water supply fully and squeeze the trigger of the spray gun to purge out any air in the system. (You can do this again just before starting the engine)

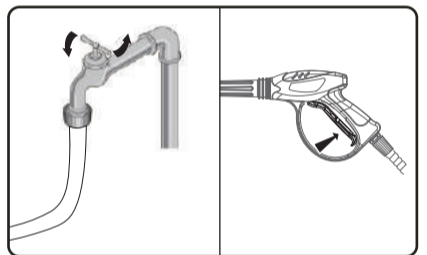

**11** Carefully add between 520ml (17.6 oz) of 4-cycle engine oil (SAE10W30) to empty reservoir until oil reaches the outer edge of the oil fill hole (crankcase dipstick hole).

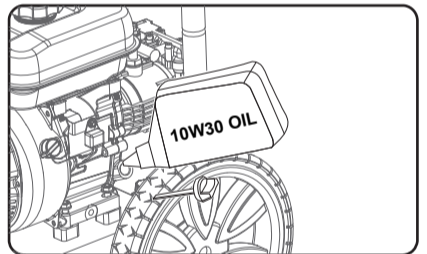

**12** Insert a funnel into the fuel tank and carefully pour gasoline into the tank until fuel level reaches about 1.5 inches below the top of the neck.

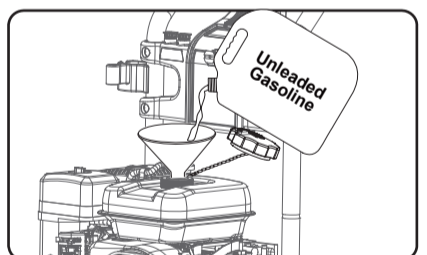

**13** Slide fuel valve to the "ON" Position. Slide the choke lever to the "CHOKE" position. Turn the engine OFF/ON switch to the "ON" position.

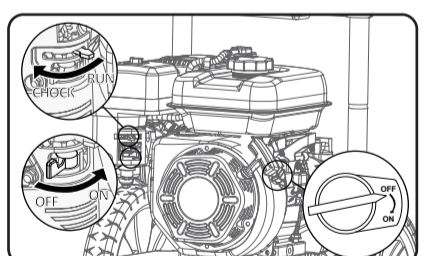

**14** Holding the machine with your hand, start engine by pulling cord slowly until resistance is felt, and then pull rapidly to avoid kickback. Slide choke lever to "RUN" position as the engine is warm enough to run.

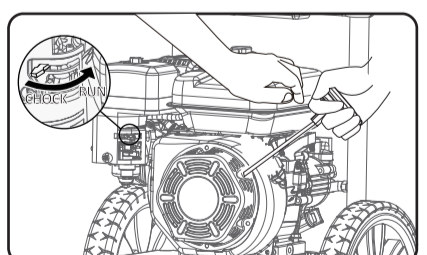

**15** If the engine fails to start release the pressure by squeezing the trigger of the spray gun before attempting to pull the recoil handle again



Questions, problems? Before returning to your retailer, please contact our customer service department at 1-800-629-4329.

Des questions? Des problèmes? Avant de rapporter l'appareil au détaillant, contactez notre service à la clientèle au 1-800-629-4329.

¿Preguntas, problemas? Antes de volver a su vendedor, por favor póngase en contacto con nuestro departamento de servicio al cliente en el 1-800-629-4329.