

Roomba™

Intelligent FloorVac

iRobot and Roomba are trademarks of iRobot Corporation.

© 2002 iRobot Corporation.
All rights reserved.
Patents Pending.

Made & Printed in China.

To order extra Battery Packs, Virtual Wall Units,
Replacement Filters or the Rapid Charger,
visit www.RoombaVac.com.

iRobot™

Owner's Manual



Contents

IMPORTANT SAFETY INSTRUCTIONS.....	1
INTRODUCING YOUR ROOMBA FLOORVAC.....	2
GETTING STARTED.....	3
• Unpacking the Box.....	3
• FloorVac Description	4
• Installing the Battery Pack	5
• Removing the Battery Pack	5
• Charging the Battery Pack	5
• Battery Life Indicator.....	6
USING YOUR ROOMBA.....	6
• Set Up the Room for Cleaning	6
• Starting and Stopping Roomba.....	7
• Room Confinement (Using Your Virtual Wall Unit).....	8
• Roomba Care Hints	9
CARING FOR YOUR ROOMBA.....	10
• Emptying the Particle Bin	10
• Cleaning the Vacuum Filter	11
• Replacing the Vacuum Filter	11
• Cleaning the Vacuum Inlet	12
• Cleaning the Brushes.....	12
REFERENCE INFORMATION.....	13
• Troubleshooting Tips	13
• Frequently Asked Questions	15
• Limited Warranty.....	17

BEFORE USING YOUR ROOMBA, THOROUGHLY READ THE SAFETY INSTRUCTIONS.

iRobot™
www.RoombaVac.com

Important Safety Instructions

CAUTION: TO REDUCE THE RISK OF ELECTRIC SHOCK, DO NOT REMOVE COVER OF EITHER ROOMBA OR THE BATTERY CHARGER. NO USER SERVICEABLE PARTS INSIDE. REFER SERVICING TO QUALIFIED SERVICE PERSONNEL.

ALWAYS BE CAREFUL WHEN USING YOUR ROOMBA. TO REDUCE THE RISK OF INJURY OR DAMAGE, KEEP THESE SAFETY PRECAUTIONS IN MIND WHEN SETTING UP, USING AND MAINTAINING YOUR EQUIPMENT.

GENERAL

- Read all safety and operating instructions before operating Roomba.
- Retain the safety and operating instructions for future reference.
- Heed all warnings on Roomba, Battery Pack, Battery Charger and Owner's Manual.
- Follow all operating and use instructions.
- Do not attempt to service Roomba yourself. Refer all non-routine servicing to qualified service personnel.

ROOMBA USE

- This is an indoor device *only*.
- Do not use Roomba on wet surfaces or where contact with or immersion in water is a possibility.
- Before using this device, pick up objects like clothing, loose papers, pull cords for blinds or curtains, power cords, and any fragile objects. If the device passes over a power cord and drags it around, there is a chance an object could tumble off a table or shelf.
- Roomba is not a toy. Do not sit or stand on this device. Small children and pets should be supervised if Roomba is in use.
- Keep loose clothing, hair, fingers, feet and all parts of the body away from Brushes and moving parts.
- Do not use this device to pick up anything that is burning or smoking, such as cigarettes, matches, or hot ashes.
- Do not use this device to pick up flammable or combustible liquids such as gasoline.
- Do not use this device without the Particle Bin in place. See page 8 for proper installation of the Particle Bin.
- If the room to be cleaned contains a balcony, a physical barrier should be used to prevent access to the balcony and ensure safe operation.

ROOMBA BATTERY AND CHARGING

- Operate your Roomba only from the type of power source indicated on the marking label. If you are not sure of the type of power supplied to your home, consult your appliance dealer or local power company.
- Use only the Battery Pack supplied by the manufacturer to power this device.
- Use only the Battery Charger supplied by the manufacturer to recharge this device.
- Do not use a Battery Charger with a damaged cord or plug.
- Charge indoors only.
- Never handle Plug, Power Cord or Battery Charger with wet hands.
- Always remove Battery Pack and disconnect Roomba from Battery Charger before cleaning Roomba.

Introducing Your Roomba FloorVac

Congratulations on the purchase of Roomba™ Intelligent FloorVac.

Your Roomba FloorVac is an automated floor-cleaning device that helps keep your floors clean between periodic deep cleanings. With a vacuum and agitator brush design, this device diligently cleans common household floor surfaces including hardwood, linoleum, tile and low- to medium-pile carpets.

When Roomba starts cleaning it travels around the floor in a spiral pattern (see Figure 1, below). Its Non-Marring Bumper will contact a wall, or it may try to find a wall after spiraling for a while. Roomba follows the wall for a short period of time, utilizing its Spinning Side Brush to move objects away from the wall and into the Vacuum's path. After cleaning along a portion of the wall or other object, Roomba criss-crosses the room in straight lines. Roomba repeats this cleaning pattern until its cleaning time has elapsed.

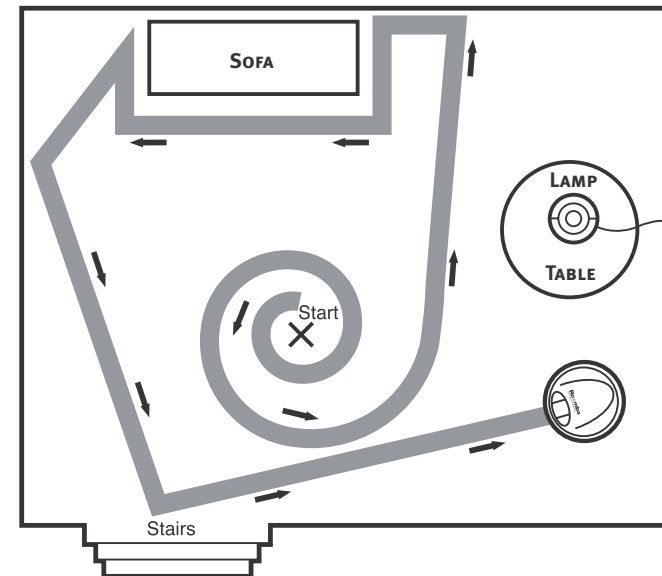

FIGURE 1: A TYPICAL ROOMBA CLEANING PATTERN.

ROOMBA STANDARD CHARGER
UL 1310 APPROVED
CLASS 2 SWITCHING POWER SUPPLY
INPUT: 90-264VAC 47-440Hz
OUTPUT: 24VDC 1A



THIS DEVICE COMPLIES WITH PART 15 OF THE FCC RULES.
OPERATION IS SUBJECT TO THE FOLLOWING CONDITIONS:
(1) THIS DEVICE MAY NOT CAUSE HARMFUL INTERFERENCE, AND
(2) THIS DEVICE MUST ACCEPT ANY INTERFERENCE RECEIVED, INCLUDING INTERFERENCE THAT MAY CAUSE UNDESIRED OPERATION.

Getting Started

UNPACKING THE BOX

Once you have unpacked your Roomba, check to make sure that you have all the parts shown here:

- A. Roomba Intelligent FloorVac
- B. Rechargeable NiMH Battery Pack
- C. Battery Charger with AC Adapter
- D. Virtual Wall Unit – requires two (2) D-size batteries (not included)
- E. Two (2) Replacement Filters
- F. Owner's Manual (not shown)
- G. Insert sheet entitled “Roomba Care Hints” (not shown)

FIGURE 2: CONTENTS OF PACKAGE.

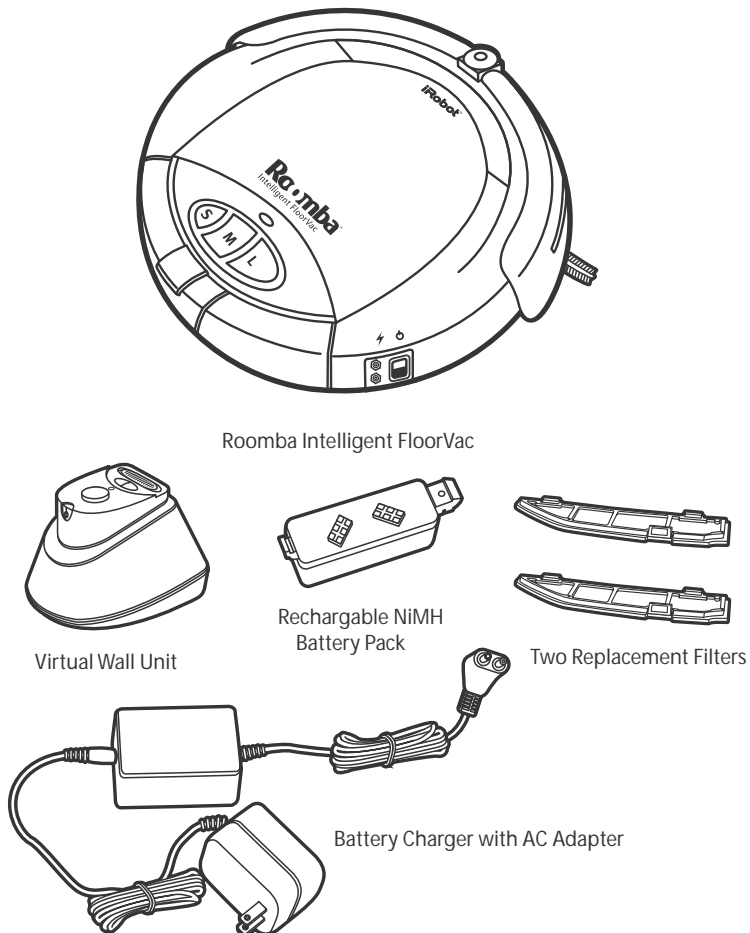

FLOORVAC DESCRIPTION

Your Roomba was designed and engineered using the latest technology and includes the following special features:

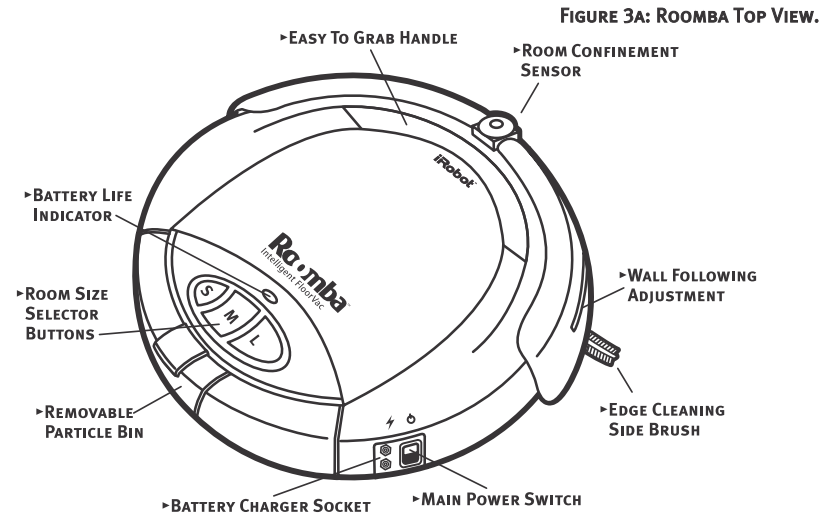
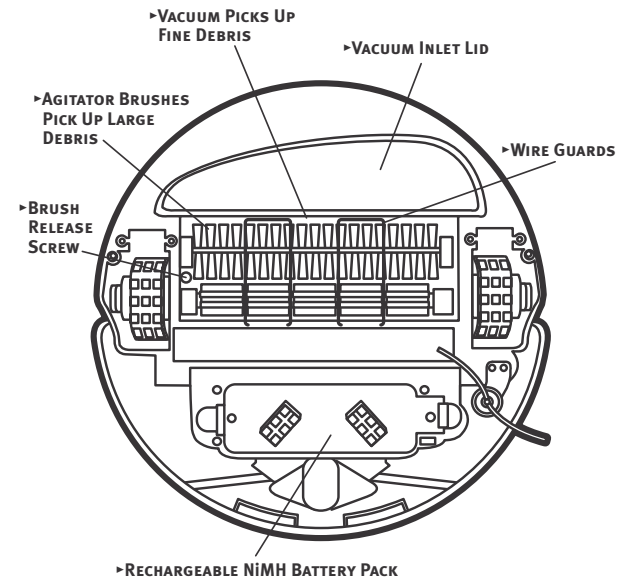

FIGURE 3B: ROOMBA BOTTOM VIEW – CLEANING SIDE UP.



INSTALLING THE BATTERY PACK

1. Turn Roomba's Main Power Switch to the Off position.
2. If you have used Roomba before, make sure that the Particle Bin is empty, then place Roomba upside down (with Cleaning Brushes showing) on a flat surface.
3. Guide the Battery Pack into the Battery Compartment using your index fingers as shown in Figure 4.
4. The Battery Pack will click into place when properly seated in Roomba.

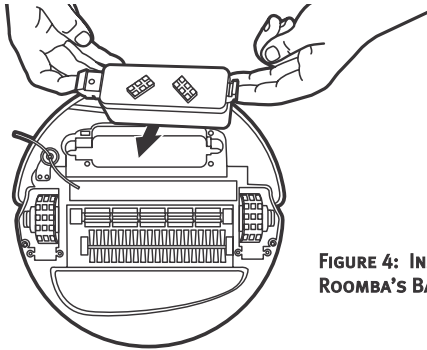

FIGURE 4: INSTALLING ROOMBA'S BATTERY PACK

REMOVING THE BATTERY PACK

1. Repeat Steps 1 and 2 from above.
2. Place your index fingers under the Guide Tabs on the Battery Pack, then pull upward to release the Battery Pack.

CHARGING THE BATTERY PACK

Please note that before first use of Roomba, you must charge the Battery Pack.

1. Turn Main Power Switch to the Off position. Make sure that the Battery Pack is inserted in Roomba.
2. Connect the Battery Charger to the Battery Charger AC Adapter, and insert the Battery Charger's Charge Plug into Roomba's Battery Charger Socket as shown in Figure 5. The Charge Plug will only fit into socket in the proper orientation.
3. The Charge Indicator Light on the Battery Charger should illuminate. If this fails to occur, remove and reinstall the Battery Pack.
4. The Charge Indicator Light will turn off when the Battery Pack is fully charged (approximately twelve hours for a fully discharged Battery Pack).

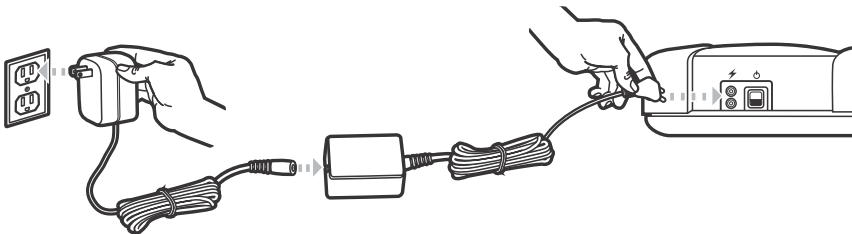

FIGURE 5: THE BATTERY CHARGER IS CONNECTED TO THE BATTERY CHARGER AC ADAPTER, AND THEN INSERTED INTO ROOMBA'S CHARGE SOCKET.

BATTERY LIFE INDICATOR

THE BATTERY LIFE INDICATOR IS FUNCTIONAL ONLY WHEN ROOMBA'S MAIN POWER SWITCH IS TURNED ON. Turn the Main Power Switch off when Roomba is not in use. To activate Roomba's Battery Life Indicator for the first time, start Roomba (see Starting Roomba on Page 7).

COLOR OF BATTERY LIFE INDICATOR	BATTERY STATUS
GREEN	FULLY CHARGED
AMBER	PARTIALLY CHARGED
RED	ALMOST DISCHARGED
FLASHING RED	FULLY DISCHARGED

BATTERY LIFE NOTES:

1. Roomba can run between about 60 minutes (on medium pile carpet) to about 90 minutes (on hard floor surfaces) on one full charge. In other words, Roomba can clean 2-3 medium-sized rooms on a single charge.
2. If cared for properly, the Rechargeable Battery Pack should last for a long time. Like all rechargeable batteries, eventually the Battery Pack will wear out and should be replaced. When this happens, the Battery Pack may be disposed of in the regular trash.
3. Additional Battery Packs can be obtained by visiting www.RoombaVac.com.

Using Your Roomba

SET UP THE ROOM FOR CLEANING

1. For optimal cleaning performance, clear your floor of objects just as you would before using a regular vacuum cleaner. Do not leave the following items on the floor: clothing, loose papers, pull cords for blinds or curtains, power cords, or any fragile items. In addition, because Roomba contacts walls, furniture and other objects as it cleans, please remove any items that may be pushed and knocked over by light contact from Roomba.

AVOID USING ROOMBA ON CARPETS WITH TASSELS OR FRINGE EDGES.

NOT RECOMMENDED FOR USE ON SHAG OR DEEP-PILE CARPETS.

2. Roomba is designed to clean one room at a time. Confine Roomba to the room you want cleaned by closing all doors and use the Virtual Wall Unit to block all open door ways. See below for instructions on using the Virtual Wall Unit.

OBSERVE ROOMBA THE FIRST TIME IT CLEANS A ROOM TO CONFIRM IT DOES NOT GET WEDGED UNDER OR STUCK ON TOP OF UNEVEN SURFACES.

ROOMBA AUTOMATICALLY SENSES STAIRS AND TURNS AWAY FROM THEM. HOWEVER, IF THE ROOM TO BE CLEANED CONTAINS A BALCONY, A PHYSICAL BARRIER SHOULD BE USED TO PREVENT ACCESS TO THE LEDGE AND ENSURE SAFE OPERATION.

STARTING ROOMBA

1. Always empty the Particle Bin before use.
2. Place Roomba on the floor in the middle of an open area in the room.
3. Turn on the Main Power Switch, located on the right side of the device (see Figure 3A).
4. Select your room size according to the chart below. Press the S, M, or L Button (these are the Room Size Buttons).

SELECT	FOR ROOMS MEASURING APPROXIMATELY
S	10' x 12'
M	14' x 16'
L	15' x 20'

Roomba will beep several times and then start cleaning.

5. Once you start Roomba, you only need to supervise it the first time it cleans a room. Identify areas where it gets stuck, then move problem objects out of the room or modify them or block them with the Virtual Wall Unit provided. Please refer to the illustration entitled "Roomba Care Hints" on Pages 9-10, as well as Troubleshooting Tips on Page 13 to help identify and easily fix problem areas. After this first use, there is no need to supervise the device unless you are operating it around small children or pets.
6. When Roomba is finished cleaning it will beep periodically to let you know that it is done.

STOPPING ROOMBA

1. To stop Roomba at any time, simply press any of the Room Size Buttons or pick Roomba up by its handle.
2. To restart Roomba, place it on the floor and press the flashing Room Size Button.

ROOM CONFINEMENT (USING YOUR VIRTUAL WALL UNIT)

The Roomba Virtual Wall Unit keeps Roomba in the room or area you want cleaned. It blocks up to 13+-foot-wide open doorways. Use the Virtual Wall Unit to block open doorways or clean one portion of a large room.

BATTERY INSTALLATION OF THE VIRTUAL WALL UNIT

1. Open the Battery Door located on the bottom of the unit by first loosening the screw.
2. Insert 2 new "D" size alkaline batteries by following the "+" and "-" symbols.
3. Replace the Battery Door and tighten the screw.

CAUTION:

To ensure proper function and avoid battery leakage:

1. Do not mix old and new batteries.
2. Do not mix alkaline, standard or rechargeable batteries.
3. Batteries should be installed by an adult.
4. Non-rechargeable batteries are not to be recharged.
5. Rechargeable batteries are to be removed from the product before being charged.
6. Only batteries of the same or equivalent type as recommended are to be used.
7. Batteries are to be inserted with the correct polarity.
8. Exhausted or dead batteries are to be removed from the product.
9. The supply terminals are not to be short circuited.
10. Always use alkaline batteries.
11. Remove batteries before storing.

FIGURE 6A: CLOSE-UP OF THE VIRTUAL WALL UNIT.

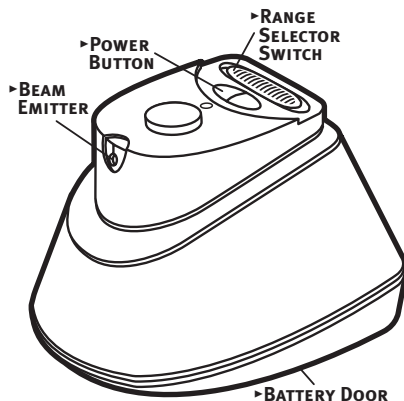

TO OPERATE VIRTUAL WALL UNIT

1. Press the Virtual Wall Unit's Power Button to turn the unit On. The Power Light will illuminate.
2. Move the Range Selector Switch to the room opening size you are blocking. The range numbers shown are in feet.
3. Place the Virtual Wall Unit on the floor at either edge of the doorway or by the wall. Make sure that the Unit's Beam Emitter points across the opening to ensure Roomba does not cross the invisible beam.
4. The Virtual Wall Unit automatically turns Off after an hour, or you can press the Power Button again to turn Off.

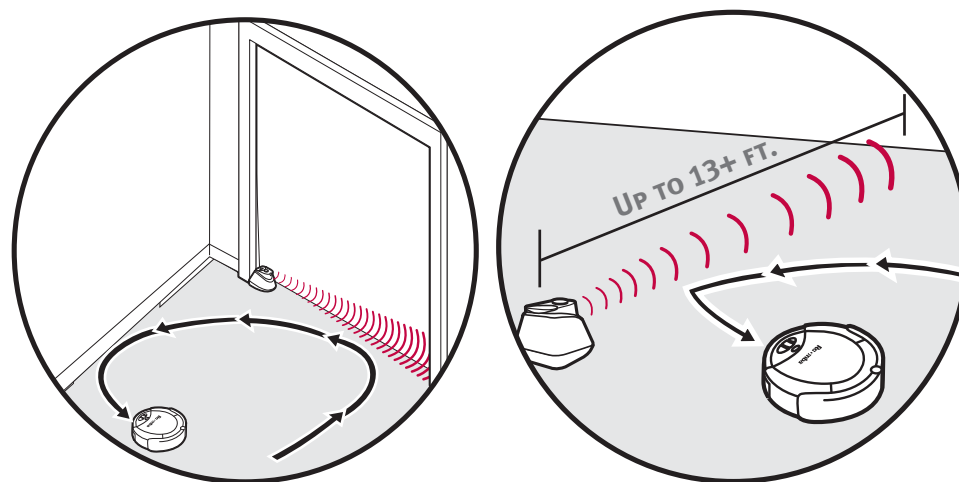

FIGURE 6B: TO BLOCK AN OPENING, PLACE THE VIRTUAL WALL UNIT ON THE FLOOR WITH THE BEAM EMITTER AIMED ACROSS THE OPENING.

Caring for Your Roomba

Your Roomba requires very little maintenance; however, after each use, you should empty Roomba's Particle Bin and clean the Vacuum Filter. You can also clean the Vacuum Inlet and Cleaning Brushes on an as-needed basis.

EMPTYING THE PARTICLE BIN

1. Turn Roomba's Main Power Switch to the Off position.
2. Press down on the Release Tab while simultaneously pulling the Particle Bin straight back. (see Figure 7A-B).
3. Empty the Particle Bin into a trash receptacle.
4. To reinstall the Particle Bin, slide it into Roomba. The Particle Bin will click when it is properly seated.

NOTE: ALWAYS CARRY ROOMBA BY ITS HANDLE AND NEVER TILT IT FORWARD, AS DEBRIS MAY SPILL OUT OF THE PARTICLE BIN.

ROOMBA CARE HINTS

4 Easy Tips to Keep Your Roomba Cleaning and Productive

TIP 1: IN A PINCH

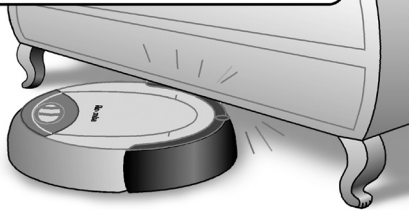

Occasionally Roomba may encounter a piece of furniture like this dresser that's just right for Roomba to get pinched underneath, and stuck.

If Roomba can't get out, it will beep to let you know and shut down to make sure it doesn't waste battery power.

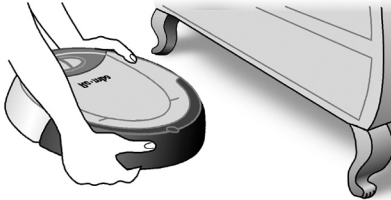

Just pull Roomba out and set it to work again.

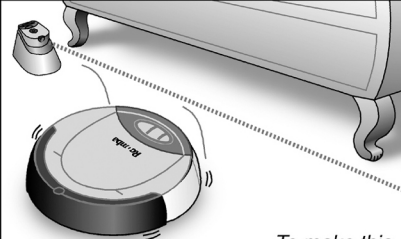

To make this area "Roomba-friendly," just place the Virtual Wall Unit to beam in front of the wedge area, and Roomba will steer clear.

Or, you can put a small plant in front of it, or even elevate the dresser on casters or blocks, so Roomba can clean under it.



There are many easy ways to make your home Roomba-friendly!

TIP 2: THE LOBSTER TRAP

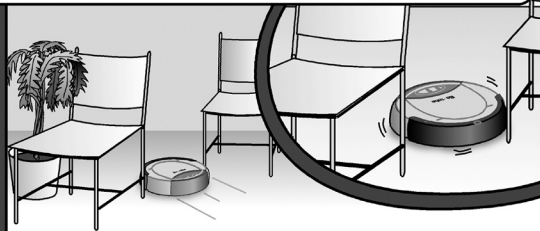

Sometimes Roomba can get trapped behind furniture because the entrance to an area is just barely big enough for Roomba to fit through.

Moving a Chair or plant just a little bit can solve the problem so Roomba doesn't get stuck any more.



TIP 3: AVOIDING A SPILL



Sometimes Roomba can bump into small items that can spill and make a mess.

To make sure Roomba can clean the whole floor, please pick up small items – just like you do before you vacuum!

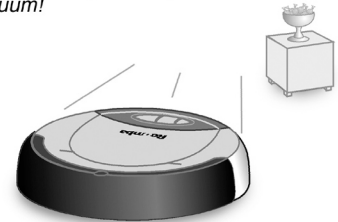

TIP 4: RUG TASSELS

If your rug has tassels or fringe on the end, they might get stuck in Roomba's Cleaning Rollers. If they do, Roomba will give a whimper beep and shut safely off.

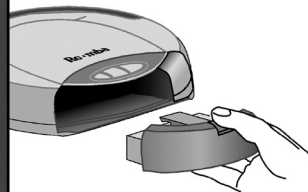
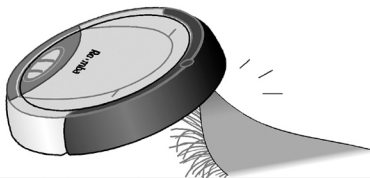

If this happens, please empty Roomba's Particle Bin (always a good idea before you might need to turn Roomba over).



Then, firmly but gently pull the tassels out from Roomba's Cleaning Brushes.

To make this rug Roomba-friendly, just fold the tassels under the edge of the rug.

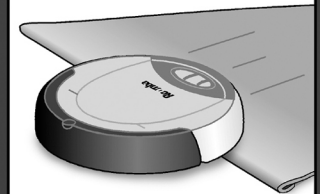

Ahhh!
That's better.

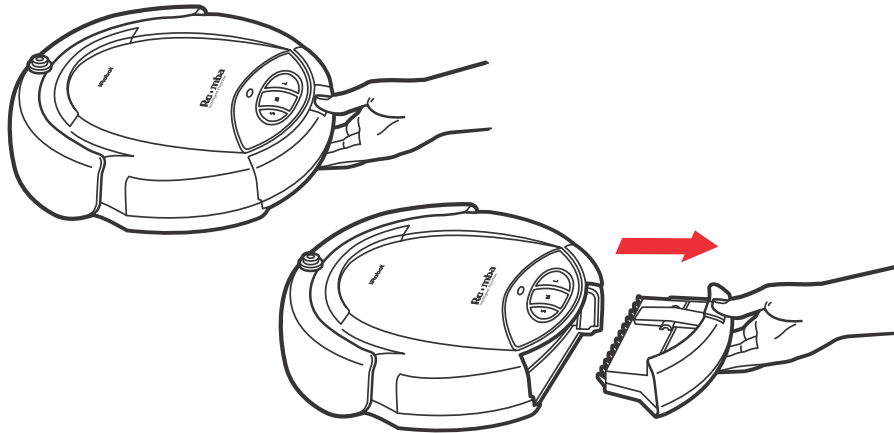

FIGURE 7A-B: EMPTYING ROOMBA'S PARTICLE BIN. PRESS THE RELEASE TAB (FIGURE 7A) AND PULL THE PARTICLE BIN OUT (FIGURE 7B).

CLEANING THE VACUUM FILTER

1. After the removable Particle Bin has been emptied, flip the Particle Bin over to access the Filter.
2. Release the small Tab on the Filter Door and pull the Filter Door upward. See Figure 8.
3. Empty the Filter's debris into a trash receptacle.
4. To reinstall the Filter Door, slide the Filter Door into place. The Filter Door will click when it reattaches itself to the Particle Bin.

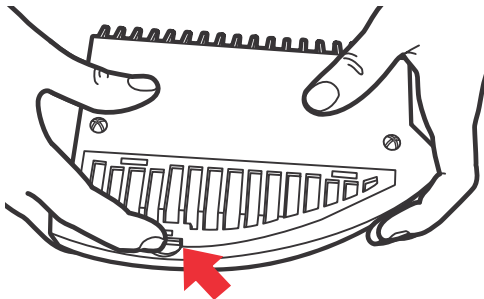

FIGURE 8: ACCESSING THE VACUUM FILTER. RELEASE THE SMALL TAB ON THE BOTTOM OF THE PARTICLE BIN TO OPEN THE VACUUM FILTER DOOR.

REPLACING THE VACUUM FILTER

1. Repeat Steps 1 & 2 from above.
2. Unclip the old Filter from the Filter Door, and clip the Replacement Filter into place.
3. To reinstall the Filter Door, slide the Filter Door into place. The Filter Door will click when it reattaches itself to the Particle Bin.

The Filter needs to be replaced if it becomes punctured or if you notice a decline in the cleaning performance of Roomba. To order replacement filters visit www.RoombaVac.com.

CLEANING THE VACUUM INLET

Over time, debris will accumulate in the Vacuum Inlet. Periodically empty the Vacuum Inlet to keep air flowing through it, especially if you notice a decline in the cleaning performance of Roomba.

1. Turn Roomba's Main Power Switch to the Off position.
2. Place Roomba upside down (cleaning surface up) on a flat surface.
3. Insert a finger into the Release Tab and pull upward to remove the Lid. See Figure 9.
4. Shake the debris into a trash receptacle.
5. Turn the vacuum impeller, the cone-shaped mechanism on the left side of the vacuum inlet, with your finger to make sure that it spins freely.
6. Replace the vacuum inlet lid.

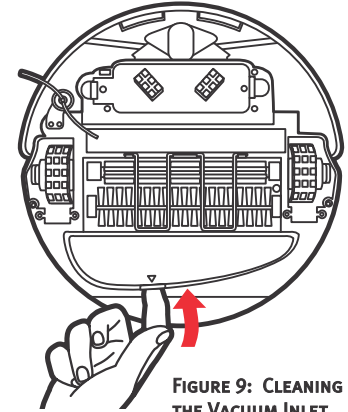

FIGURE 9: CLEANING THE VACUUM INLET.

CLEANING THE BRUSHES

1. Turn Roomba's Main Power Switch off and place Roomba upside down (cleaning surface up) on a flat surface, with the Front Bumper facing away from you.
2. Cut hair or other objects wound around the Cleaning Brushes with a pair of scissors. Avoid cutting the bristles of the Bristle Brush or pulling with excessive force on objects wound around the Brushes, as this may damage the Brushes.
3. If the objects do not detach themselves from the Brushes, unlatch the Wire Guards that cover the Brushes by pushing the Release Tab backward (see Figure 10a). Pull the rear of the hinged Wire Guards up and out of their slots, and then swing them up toward the front of the device (Figure 10b).
4. Unscrew the screw located on the right side of the Self-Adjusting Cleaning Deck with a Phillips-head screwdriver (Figure 10c). Remove the screw and pull up the plastic Brush Coupler. The Brushes will come up with the Brush Coupler.
5. Pull the Brush Coupler off the end of the Brushes, then pull the Brushes to the right and up, free of the device (Figure 10d).
6. Clean the objects off the Brushes.

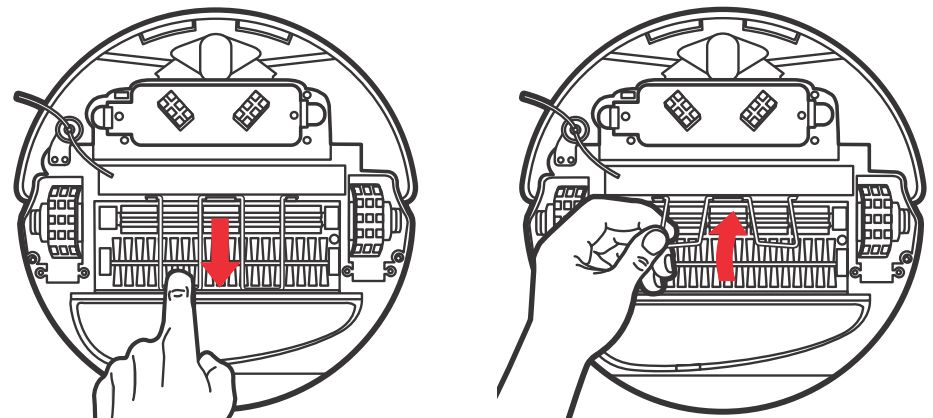

FIGURE 10A-B: UNLATCH THE WIRE GUARDS BY PUSHING THE RELEASE TAB BACKWARD AND SWING THE WIRE GUARDS UP, EXPOSING THE BRUSHES.

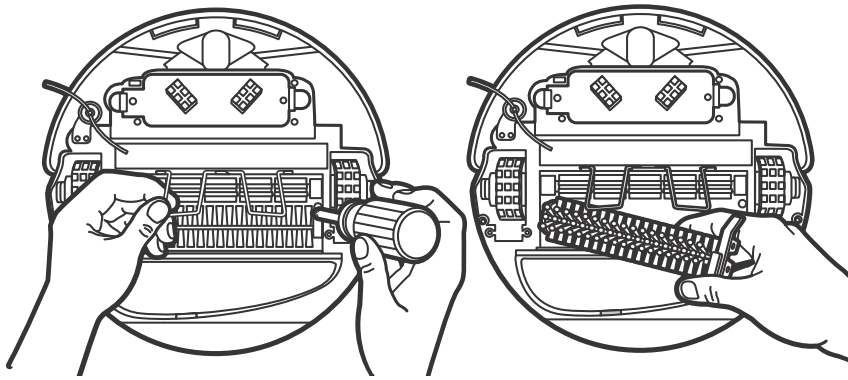

FIGURE 10C-D: REMOVE THE SCREW ON THE SELF-ADJUSTING CLEANING DECK AND PULL OUT THE PLASTIC BRUSH COUPLER AND THE TWO BRUSHES.

REASSEMBLING THE BRUSHES

1. Put the Self-Adjusting Cleaning Deck back together by inserting the ends of the two Brushes into the square sockets in the Cleaning Deck.
2. Insert the other ends of the Brushes into the small holes in the Brush Coupler.
3. Lower the Brush Coupler into its slot and screw in the screw.
4. Swing the Wire Guards back in place and snap them down into their slots.

Reference Information

TROUBLESHOOTING TIPS

MY ROOMBA GETS STUCK

Your Roomba may occasionally get stuck, especially in rooms that it has not cleaned before. If it does get stuck, Roomba will try to free itself by turning in different directions. If it cannot get free, it will automatically turn off its motors. Roomba will beep intermittently to let you know it is stuck.

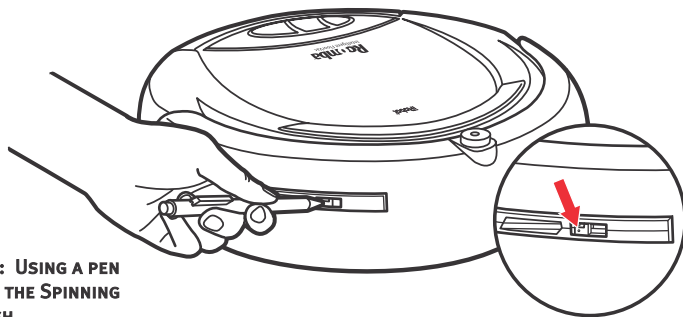

FIGURE 11: USING A PEN TO ADJUST THE SPINNING SIDE BRUSH.

Your Roomba might get stuck for several reasons.

1. It is wedged or pinned between or under narrowly spaced objects.
2. A cord, string, rug fringe or carpet tassel is wound around its Brushes or Wheels.
3. One of the Wheels is no longer in contact with the ground.
4. Roomba bumps into objects and repositions them in such a way that an exit path no longer exists.

Move or block any object that Roomba gets stuck on or under. Please refer to the illustration entitled “Roomba Care Hints” on Pages 9-10 to help identify and easily fix these problem areas.

Once the problem areas have been amended, begin a new cleaning cycle by turning the Main Power Switch off then on again. Select your room size to start cleaning by pressing the S, M, or L Room Size Button.

MY ROOMBA MOVES TOO CLOSE OR FAR FROM MY WALLS

1. If the Spinning Side Brush does not clean close enough to the wall, use a pen to push the Adjustment Tab towards the rear of the Bumper. This will make Roomba follow closer to walls. See Figure 11.
2. If the Spinning Side Brush is bumping into the wall, use a pen to push the Adjustment Tab toward the center of the Bumper. This will make Roomba follow further away from walls.

MY ROOMBA IS NOT WORKING OR THERE HAS BEEN A DECREASE IN THE CLEANING PERFORMANCE

1. Ensure that the Battery Pack is properly seated and charged.
2. Check that the Particle Bin, Filter, and Vacuum Chamber are empty.
3. Check there is nothing wound around the Brushes or Wheels.

MY VIRTUAL WALL UNIT IS NOT WORKING

1. Check that new batteries are installed.
2. Make sure the Beam Emitter is pointed across the opening you want to block.
3. If that does not work, turn the Virtual Wall Unit’s Range Selector Switch up to the maximum setting for large openings.
4. Some large openings require that more than one Virtual Wall Unit be used. You may purchase extra Virtual Wall Units by going to www.RoombaVac.com.

ROOMBA BATTERY PACK WILL NOT CHARGE

1. Insure that the Battery Pack is properly seated in Roomba.
2. Check that the Battery Charger is properly connected to the Battery Charger AC Adapter. Make sure Battery Charger is properly connected to Roomba, and that the Battery Charger AC Adapter is plugged in.

Additional Troubleshooting Tips may be found by visiting www.RoombaVac.com

FREQUENTLY ASKED QUESTIONS

Q: Why doesn't my Roomba clean my floor in straight lines?

A: Roomba uses an algorithm-based cleaning pattern to clean your home most efficiently. When Roomba starts cleaning it travels around the floor in a spiral pattern (see Figure 1 on Page 2). Its Non-Marring Bumper will contact a wall, or it may try to find a wall after spiraling for a while. Roomba follows the wall for a short period of time, utilizing its Spinning Side Brush to move objects away from the wall and into the Vacuum's path. After cleaning along a portion of the wall or other object, Roomba criss-crosses the room in straight lines. Roomba repeats this cleaning pattern until its cleaning time has elapsed.

Q: Are pets and children safe around Roomba?

A: Roomba has been designed with a number of safety features, including automatically shutting off when it is picked up or gets stuck. Children and pets should always be supervised around Roomba for optimum safety and cleaning performance.

Q: Does Roomba clean corners and along the walls?

A: Roomba has a Spinning Side Brush that cleans next to walls, most corners and other tough to reach places.

Q: Will it go under kickboards, beds, and furniture?

A: Roomba has been designed to fit under the kickboards in your kitchen. If your bed or furniture is more than 4" off the floor, Roomba will happily clean underneath.

Q: What powers Roomba?

A: Roomba is powered by a NiMH Rechargeable Battery Pack.

Q: How long will the Battery Pack's charge last?

A: The life of a fully-charged Battery Pack is dependent on the floor surface to be cleaned. A single charge can last from about 60 minutes (on medium pile carpet) to about 90 minutes (on hard floor surfaces).

Q: How many rooms will Roomba clean before the Battery Pack needs to be recharged?

A: Again, it depends on the floor surface to be cleaned. For typical operation, Roomba cleans three 14' x 16' medium-size rooms.

Q: How long does it take to recharge the Battery Pack?

A: The Battery Charger that comes with Roomba takes up to 12 hours to recharge the battery. You can also purchase the Rapid Charger accessory that recharges the battery pack in only 2 hours. To purchase a Rapid Charger, visit www.RoombaVac.com.

Q: How does the Virtual Wall Unit work?

A: The Virtual Wall Unit is used to block open doorways and confine Roomba in a room. The Unit can also be used to divide a large room and force Roomba to clean just one side of the room. The Virtual Wall Unit sends a harmless, invisible beam across the opening, keeping Roomba where you want it.

Q: Will the Particle Bin need to be emptied? Does the Filter need to be cleaned? How often?

A: Debris from the Particle Bin and Filter Compartment should be emptied after each use. See Caring for Your Roomba on Page 8 for more information.

Q: How can I get extra Replacement Filters?

A: The Filter needs to be replaced if it becomes punctured or if you notice a decline in the cleaning performance of Roomba. Two spare Replacement Filters are included with your original Roomba purchase. To order more Replacement Filters, visit www.RoombaVac.com.

Q: Will Roomba clean all floor surfaces?

A: Roomba cleans hardwood, linoleum, tile, and low- to medium-pile carpets. The device is not designed to operate on deep-pile carpets or carpets with tassels or fringe.

Q: Do I need to change the floor adjustment when changing floor surfaces?

A: Roomba's Self-Adjusting Cleaning Head automatically traverses uneven floor transitions as it cleans carpet, hardwood, linoleum, and tile.

Q: Will Roomba sweep water from the floor?

A: No, Roomba should not be used to pick up any liquid including water.

Q: Will Roomba fall down stairs or into a step-down room?

A: Roomba automatically senses stairs and turns away from them. However, if the room to be cleaned contains a balcony, a physical barrier should be used to prevent access to the balcony and ensure safe operation.

Q: If Roomba gets stuck, what should I do?

A: Help Roomba get unstuck, then press the flashing Room Size Button to restart the Cleaning Cycle. Please refer to the illustration entitled "Roomba Care Hints" on Pages 9-10, as well as Troubleshooting Tips on Page 13 for more hints.

Q: Is Roomba safe to use when I leave my home?

A: Roomba can operate unattended, so long as small children and pets are not present to interfere with Roomba's operation, and loose objects have been picked up.

LIMITED WARRANTY TO ORIGINAL PURCHASER

This Roomba brand product, as supplied and distributed by iRobot Corporation, and delivered new, in the original carton to the original customer purchaser, is warranted by iRobot Corporation against manufacturing defects in materials and workmanship for the qualifying limited warranty period as follows:

NINETY (90) DAYS LABOR AND PARTS

This limited warranty begins on the original date of purchase, and is valid only on products purchased and used in the United States, and does not include installation, removal or reinstallation. Warranty repairs must be performed by iRobot Corporation's authorized service center. To receive warranty service, the original dated bill of sale must be presented upon request as proof of purchase to iRobot Corporation's authorized service center. To obtain warranty service, support, or other information, please visit our website at www.RoombaVac.com. If you do not have web access, please call (877) 855-8593.

iRobot Corporation will repair or replace this product, at our option and at no charge with new or reconditioned parts, if found to be defective during the limited warranty period specified above. To request service, the purchaser must contact iRobot Corporation for problem determination and service procedures. iRobot Corporation does not warrant uninterrupted or error-free operation of the product. All replaced parts and products become the property of iRobot Corporation and must be returned to iRobot. Replacement parts and products assume the remaining original warranty, or sixty (60) days, whichever is longer.

This limited warranty covers manufacturing defects in materials and workmanship encountered in normal, and, except to the extent otherwise expressly provided in this statement, noncommercial use of this product and shall not apply to the following, including, but not limited to: damage which occurs in shipment; applications and uses for which this product was not intended; failures or problems which are caused by products or equipment not supplied by iRobot Corporation; accidents, misuse, abuse, neglect, misapplication, fire, water, lightning or other acts of nature; incorrect electrical line voltage, fluctuations or surges; damage caused by improper installation; product alteration or modification; improper or unauthorized repair; exterior finish or cosmetic damage; failure to follow operating instructions, customer adjustments, maintenance and environmental instructions that are covered and prescribed in the instruction book; use of non-iRobot or unauthorized parts, supplies, accessories or equipment which damage this product or result in service problems; failures or problems due to incompatibility with other equipment.

THERE ARE NO EXPRESS WARRANTIES OTHER THAN THOSE LISTED AND DESCRIBED ABOVE, AND NO WARRANTIES WHETHER EXPRESS OR IMPLIED, INCLUDING, BUT NOT LIMITED TO, ANY IMPLIED WARRANTIES OF MERCHANTABILITY OR FITNESS FOR A PARTICULAR PURPOSE, SHALL APPLY AFTER THE EXPRESS WARRANTY PERIOD STATED ABOVE, AND NO OTHER EXPRESS WARRANTY OR GUARANTEE GIVEN BY ANY PERSON, FIRM OR CORPORATION WITH RESPECT TO THIS PRODUCT SHALL BE BINDING ON IROBOT CORPORATION. IROBOT CORPORATION SHALL NOT BE LIABLE FOR LOSS OF REV-

ENUE OR PROFITS, FAILURE TO REALIZE SAVINGS OR OTHER BENEFITS, OR ANY OTHER SPECIAL, INCIDENTAL OR CONSEQUENTIAL DAMAGES CAUSED BY THE USE, MISUSE OR INABILITY TO USE THIS PRODUCT, REGARDLESS OF THE LEGAL THEORY ON WHICH THE CLAIM IS BASED, AND EVEN IF IROBOT HAS BEEN ADVISED OF THE POSSIBILITY OF SUCH DAMAGES. NOR SHALL RECOVERY OF ANY KIND AGAINST IROBOT CORPORATION BE GREATER IN AMOUNT THAN THE PURCHASE PRICE OF THE PRODUCT SOLD BY IROBOT CORPORATION AND CAUSING THE ALLEGED DAMAGE. WITHOUT LIMITING THE FOREGOING, PURCHASER ASSUMES ALL RISK AND LIABILITY FOR LOSS, DAMAGE OR INJURY TO PURCHASER AND PURCHASER'S PROPERTY AND TO OTHERS AND THEIR PROPERTY ARISING OUT OF THE USE, MISUSE OR INABILITY TO USE THIS PRODUCT SOLD BY IROBOT CORPORATION NOT CAUSED DIRECTLY BY THE GROSS NEGLIGENCE OF IROBOT CORPORATION. THIS LIMITED WARRANTY SHALL NOT EXTEND TO ANYONE OTHER THAN THE ORIGINAL PURCHASER OF THIS PRODUCT, IS NONTRANSFERABLE AND STATES YOUR EXCLUSIVE REMEDY.

Some states do not allow limitations on how long an implied warranty lasts, or the exclusion or limitation of incidental or consequential damages, so the above limitations or exclusions may not apply to you. This warranty gives you specific legal rights and you may also have other rights which vary from state to state.