

# EZ-Store™ Rotisserie

## QUICK SET-UP GUIDE

1. REMOVE PACKING TAPE: After you've unpacked your Rotisserie make sure you've removed all of the packing tape used to secure the Rotisserie during shipment.
2. DEPLOY REAR LEGS: The legs can be extended by pushing the small RELEASE BUTTON located on the right side of the Rotisserie. You will need to tilt the Rotisserie towards you so the legs can fully extend.

**Helpful Hint** -For your safety, the Rotisserie will only power on if the legs are in the UP-RIGHT position AND the DRIP TRAY is properly inserted.

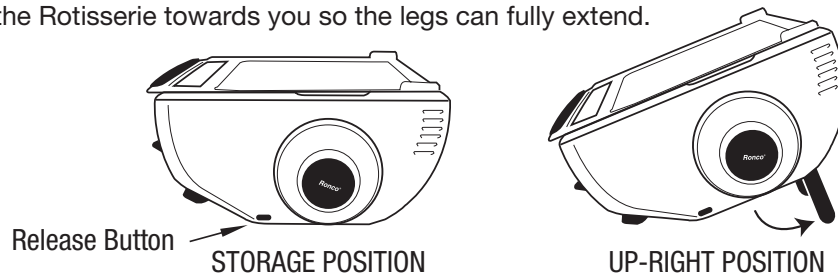

3. INSTALL GLASS LID/TOP: The lid comes packed and nested for storage. To assemble, turn lid right-side-up and insert the LID PINS into the PIVOT HOLES in the Rotisserie base as shown. You can now close the lid.

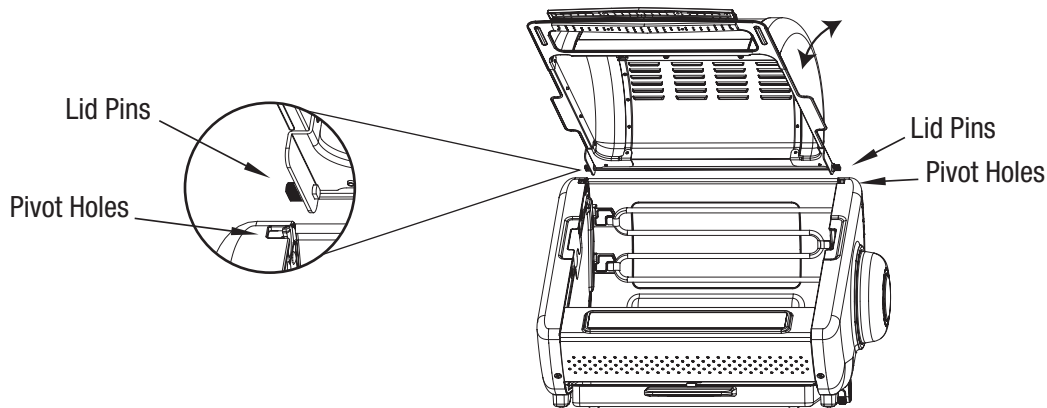

4. PROPER DRIP TRAY & HEAT SHIELD INSTALLATION: The DRIP TRAY must be properly inserted and in place before the Rotisserie will power on. After each use, PRESS the DRIP TRAY LATCH down to remove tray and empty grease. Never operate without the HEAT SHIELD in place behind the heating element. To access the HEAT SHIELD for cleaning, you must first remove the GLASS LID. Then slide the HEAT SHIELD out from the top of the Rotisserie.

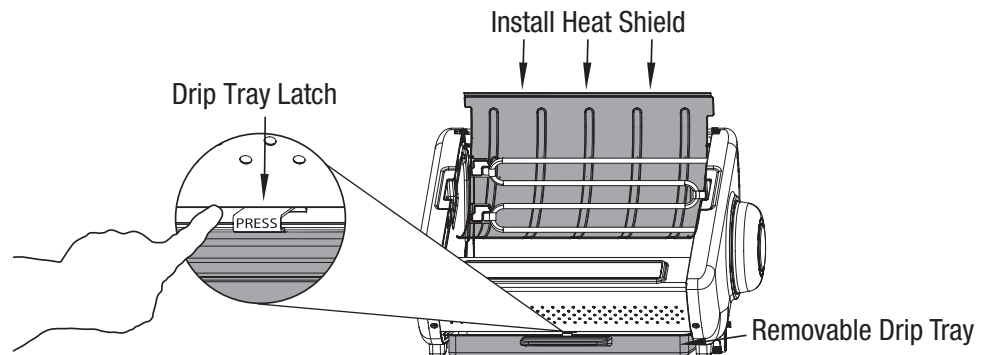

### IMPORTANT:

For your safety, the Rotisserie will only power ON if the legs are in the UP-RIGHT position AND the DRIP TRAY is properly inserted.

5. SPIT ROD ASSEMBLY: One end of the spit rod is held in place by a WIRE CLIP installed on Gear Wheel A. Insert the notched end of the SPIT ROD into Gear Wheel A while squeezing the WIRE CLIP together. The SPIT ROD is secure when the WIRE CLIP snaps into the notch. Repeat with second SPIT ROD. Insert pointed ends of SPIT RODS into Gear Wheel B. Place SPIT ROD ASSEMBLY inside the Rotisserie base.

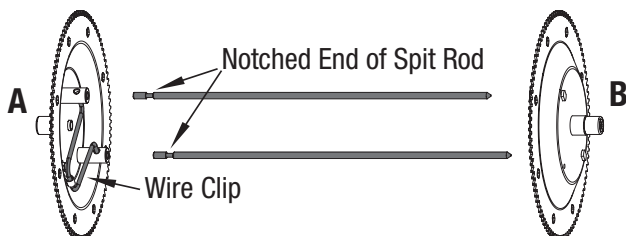

6. START COOKING: See instruction manual for detailed instructions and reference page 17 for cook times.

### Customer Care

Should you ever require assistance from our Customer Care Department, we suggest that you call us (any time M-F 8:30 - 5:30 CST) 1-855-85-RONCO (76626), email product concerns to [support@ronco.com](mailto:support@ronco.com), or visit our support site on line at <http://support.ronco.com>.