

Wireless-N Repeater Installation Guide



Model: WG-N300R
REV1.1
Support Email: aigital@163.com

Product Overview

This Wireless-N Repeater is designed specifically for small business, office and home network requirement which has combined wired and wireless network connection. It complies with the IEEE802.11N standard. It also works well with other wireless products with IEEE802.11b/g/n protocol. It creates instant WiFi Hot-spot at any location where you have internet connection.

Main Features:

Comply with IEEE802.11B/G/N standards;
Supports Repeater Mode, AP Mode, Router Mode;
Compact and portable, provide powerful wireless signal;
Travel size design, ideal for home and travel use.

Package Contains:

- 1*WiFi Range Extender
- 1*Quick Installation Guide

Appearance

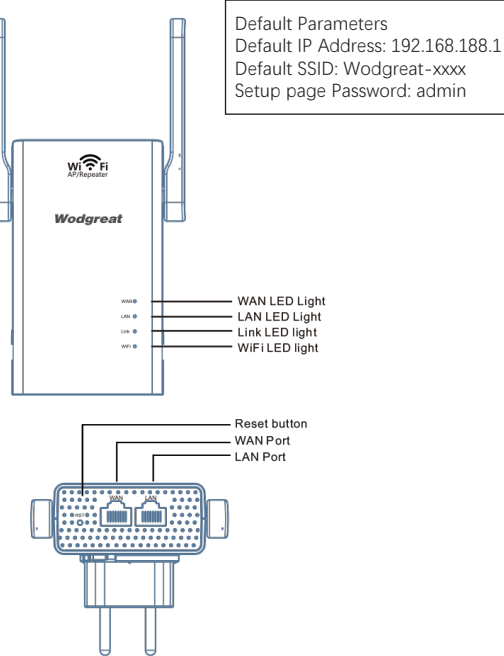

Status of Indicator Lights:

Indicator LED	Color	Status	State Description
WAN	Green	Flashing	The WAN port is connected to the device
		OFF	The WAN port is not connected
LAN	Green	Flashing	The LAN port is connected to the device
		OFF	The LAN port is not connected
Link	Green	ON	Normal communication of external network of the equipment and normal data transmission
		OFF	Abnormal external network communication or failed network connection
WiFi	Green	Flashing	Normal wifi emission of the equipment with data transmission
		OFF	Abnormal wifi of the equipment or un-launched wifi

Select a Best Working Method for you:

- 1.Repeater Mode: Wirelessly connect to home wifi, extend existing wifi range to cover larger areas
- 2.AP Mode: Wired connect to home router via Ethernet Cable, create a wireless access point
- 3.Router Mode: Wired connect to home modem via Ethernet cable, create an available network.

Router Mode
AP Mode

Repeater Mode

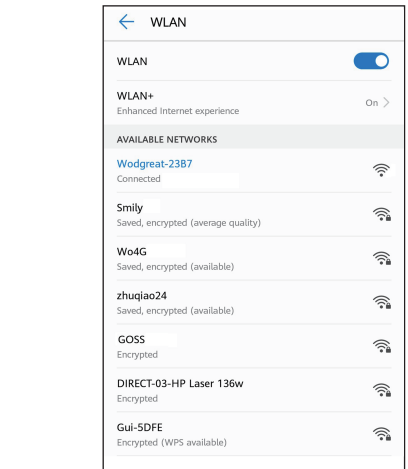
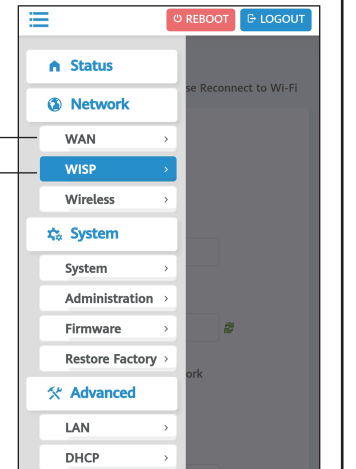

Connection and Configure:

Let's start to configure this Wireless-N Repeater from here:

- S1: Connect to WiFi: On your phone or computer connect to the wifi named "Wodgreat_xxxx"
Note: xxxx is the last four digits of the equipment MAC address.

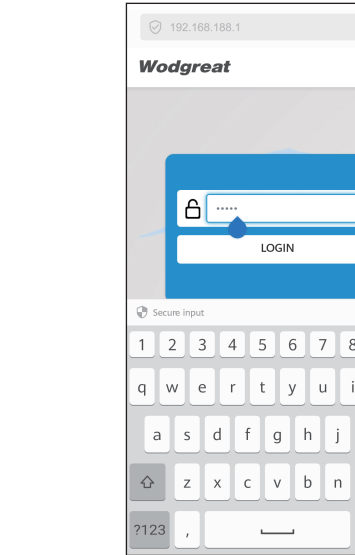

S2: Log into admin page: Open the browser and type the IP address: 192.168.188.1 in the address bar, password is < admin >.

After login, the coming page is Repeater Mode (WISP) setup page:

Repeater Mode

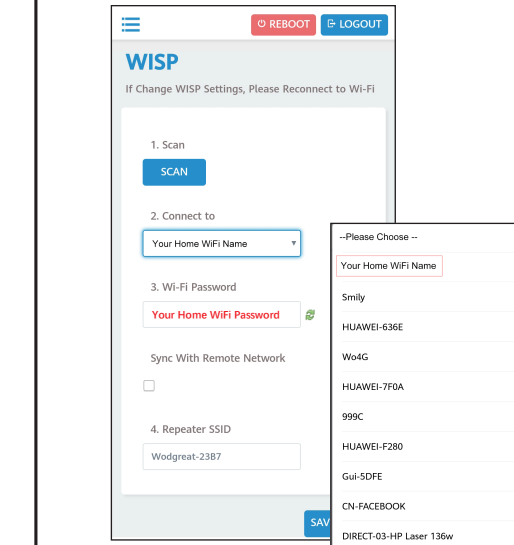

- S3.1: Click < SCAN >
S3.2: Click < Connect to > column, your available network list will appear, Please select your home wifi name, the one you need to extend.

S3.3: Type your home wifi password in < Wi-Fi Password > column.

S3.4(Optional): You can change the Repeater SSID to a new name. If you select "Sync With Remote Network", this wifi repeater will combine to your home wifi and use a same SSID.

S3.5: Click< SAVE & APPLY >

【Remind】

After you click < SAVE & APPLY > for about 10 seconds, the setup has finished. Please manually open your phone wifi list and choose the new wifi to connect and get access into internet.

NOTE: If no internet connection, please enter the setup page < 192.168.188.1 > to check whether you have typed a correct password.