

LCD Handheld Digital Endoscope

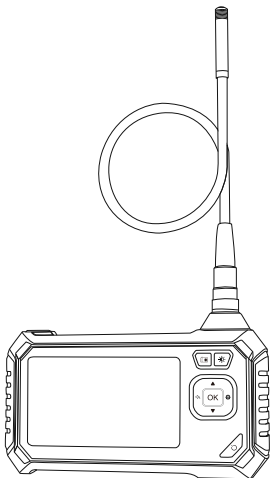

User manual

EN

Customer Service: foclen@outlook.com

SAFETY WARNING:

WARNING! Read and understand all instructions. Failure to follow all instructions listed below may result in electric shock, fire and/or serious personal injury

WELCOME:

Welcome to buy this product. Before use, please read the instructions carefully. This product is a utility class equipment with the function of real-time video viewing, video recording and picture capturing, etc.. which is suitable for usage in narrow area and the area which cannot be observed by sight, such as: vehicle repair, sewer inspection/maintenance, etc

FEATURES:

1. 4.3-inch full color LCD screen for real-time viewing of test videos
2. Resolution up to 1080P for image capture, video recording
3. 360° image rotation
4. TF card can be installed to achieve file storage function
5. 8.0 mm diameter high-sensitivity waterproof camera with clear picture quality for different working environments

6. Special technology with a focal length of 4 cm - 500 cm
7. Screen separation control port, making it easy for customers to apply to different locations.
8. Auxiliary light source, 6 adjustable LED lights and a flashlight for easy use in dark environments
9. IP67 waterproof



Video



Take photo



HD pixel



TF card



Rotate



IP67



6 LED lights



USB

APPLICATION:

1. **Tubular/Water Pipe Cleaning:** It helps to clean, rust, corrosion, dust and crack after the pipe is inspected
2. **Shipbuilding industry:** used to inspect boilers, steam turbines, diesel engines, pipelines
3. **Industrial machinery:** used to check for engine scars or wear, gearboxes, hydraulic systems, greatly reducing downtime

4. **Electronics, electronics industry:** used to confirm the wiring status of the product, check the working condition of the machine, etc

ACCESSORIES LIST:

1. LCD Digital endoscope
2. User's Guide
3. USB data cable
4. Accessories - hooks, magnets, side mirrors, protective cap

FEATURES:

(1) Part name and function

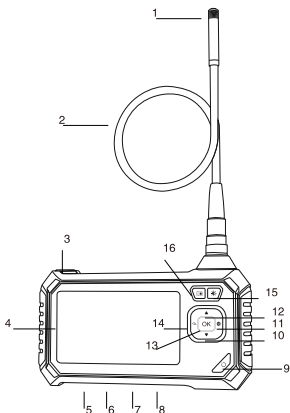

- | | |
|----------------------------|---------------------------------------|
| 1 Camera | 9 Power button |
| 2 Hose | 10 Down button |
| 3 Flashlight switch | 11 Setting button |
| 4 4.3 inch display | 12 Up button |
| 5 Reset button | 13 OK button |
| 6 DC 5V input | 14 Return key |
| 7 Indicator light | 15 LED light adjustment button |
| 8 MicroTF card slot | 16 Capture button |

(2) Function introduction

1. Micro TF card slot: supports up to 64GB MicroTF card, Only supports TF cards with class 10 or higher FAT32 format(not equipped with this unit)

Micro seat: 5V power supply

2. Switch button: long press for 3 seconds
3. Photo button: short press to take a photo, long press the video, then press once to stop

5. Menu button: Short press to enter the menu page, where you can set the resolution / date / time / date label / brightness / formatting / language settings / default settings / version

6. Up button: Photo mode, up and down. Other modes, move up or left

7. Down button: Photo mode, rotate left and right. Other modes, move down or right

8. OK button: short press to confirm
9. Back button: short press to return to the previous menu
10. LED brightness adjustment button: camera brightness is divided into three levels of adjustment
11. Indicator light: The charging indicator on the left is always red when charging, and automatically turns off when fully charged. On the right is the power-on indicator, and the blue light is on after the power is turned on
12. Flashlight power button: short press to turn on the flashlight, then press once to turn off

INSTALLATION NOTES:

(1) Installation hose

Install the flexible tube onto the handle by first making sure that the hose arrow is aligned with the arrow groove of the handle and forcibly connecting the two parts

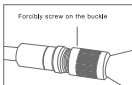
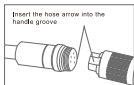

(2) Installation accessories

How to install the three accessories - the hook, the side mirror and the magnet are the same

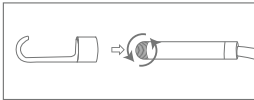

magnet



Hook



Mirror



Protective cap

STEPS FOR USAGE:

(1) Basic operation

1. Insert the MicroTF card (not equipped with this unit) into the MicroTF card slot; press gently until the card is locked (note: the class 10 MicroTF card must be inserted to record and store pictures and videos)

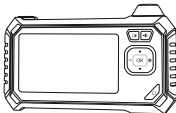

TF card

2. Press and hold the on/off button (add the switch icon), the camera light will illuminate, and press the LED brightness adjustment button to adjust the brightness of the camera light
3. Short press take a photo , long press record video, press again to stop recording
4. Turn on the flashlight switch to provide an auxiliary light source for use in night environments

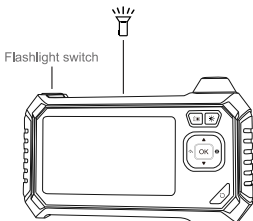

CHARGING:

1. Dual power supply mode, 18650 battery can be used for power supply or connected to power supply

A.18650 battery powered

Please use the standard 18650 battery, put the device into the 18650 battery box correctly, and use it directly when the battery is fully charged

When the battery is weak, insert the small end of the power adapter into the DC 5V-in port on the bottom of the panel, then plug the other end of the power adapter into the standard AC socket to charge the battery. At this time, the charging indicator on the panel is solid red. When the battery is fully charged, the battery indicator LED will go out, Unplug the power cord

B.Direct power supply:

Without the 18650 battery, Plug the small end of the power adapter into the DC 5V-in port at the bottom of the panel. Then plug the other end of the power adapter into a standard AC outlet and supply power directly

When charging in the power-on state, the device will automatically shut down, and you can re-use it after long press the power switch

TECHNICAL PARAMETERS:

Model	Inskam113
Monitor	4.3-inch color LCD
Camera resolution	1920*1080P
Horizontal viewing angle	70 °
Language	English, German, Simplified Chinese, Spanish, French, Russian, Japanese
Line length	1m, 3m, 5m, 10m optional
Focal length	4CM—500CM
Waterproof level	IP67 (only for lens/lamp)
Lens diameter	8mm
Battery capacity	2600mAh
Battery endurance	About 4 hours

TROUBLESHOOTING:

Problem	Solution
Device cannot be turned on	<ol style="list-style-type: none">1.Does the battery have electricity?2.Has the power been successfully connected?
TF card reading is unsuccessful	<ol style="list-style-type: none">1.Is the memory card format correct? (this device only supports FAT32 file format)2.Re-insert the TF card after removing it
After the device is connected to the PC, the TF card cannot be read.	<ol style="list-style-type: none">1.Reconnect the device and PC2.Confirm whether to enter the Mass Storage mode
Device crash	<ol style="list-style-type: none">1.Plug in the USB data cable to charge, automatically shut down, then press the power button to reset
Smudged or smeared on the screen	<ol style="list-style-type: none">1.Carefully clean the screen with a soft cloth
The battery indicator LED is not red or the battery is not charging even if the power adapter is connected and plugged into the outlet	<ol style="list-style-type: none">1.Confirm that the display is connected to the handle2.Plug in the DC input port of the device to ensure that the outlet is powered and not faulty.3.If the outlet is connected to a wall switch, make sure the switch is turned on

FCC INFORMATION:

This device complies with Part 15 of the FCC Rules.

Subject to the following two conditions:

(1) This device does not cause harmful interference

(2) This device must accept any interference received, including interference that may cause undesired operation. Changes or modifications not expressly approved by the party responsible for compliance could void the user's authority to operate the equipment

EU ENVIRONMENTAL PROTECTION:

Waste electrical products should not be disposed of with household waste

Please consult your local government or retailer for recycling advice

If the number contained in the user manual has any minor changes without prior notice

EU ENVIRONMENTAL PROTECTION

Waste electrical products should not be disposed of with household waste.

Please consult your local government or retailer for recycling advice



*There are any minor changes to the numbers included in the user manual without prior notice