

YAUFHEY

Home Dehumidifier

Before operating this product, please read the instructions carefully and save this manual for future use.

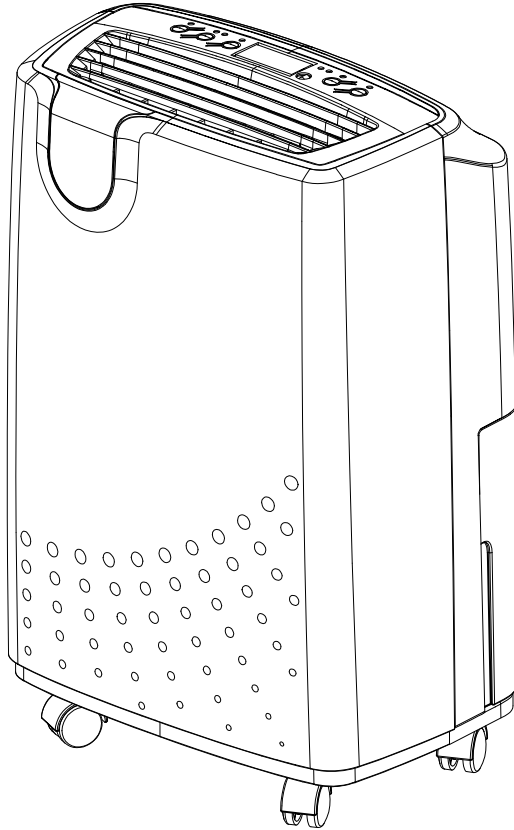

MANUAL

PD161D

BEFORE FIRST USE:

To prevent any internal damage, it is very important to keep refrigeration units (like this one) upright throughout their journey. Please leave it standing upright and outside the box for **24 HOURS** before plugging it in.

TABLE OF CONTENTS

1. Important Safety Instructions	1
2. Parts Description	3
3. Operation	4
4. Care & Cleaning	9
5. Troubleshooting	10
6. Technical Specifications	11
7. Warranty	12
8. Warning	12
9. Contact Us	12

Important Safety Instructions



IMPORTANT NOTICE FOR FIRST USE

To prevent injury to the user or other people and property damage, the following instructions must be followed when using the Dehumidifier. Incorrect operation due to ignoring of instructions may cause harm or damage. This instructions is for household use only.

1. Make sure to turn off and unplug the dehumidifier before cleaning.
2. Do not touch the plug with wet hands.
3. Do not operate or turn off the dehumidifier by plugging in or unplugging the device. Use the control panel instead.
4. Be sure to run the water hose sloping downward to let the water flow out smoothly.
5. Do not use if the power cord is broken or damaged.
6. Do not place the dehumidifier in places where it may be splashed by water.
7. Do not place the dehumidifier near a heat source.
8. Do not install the dehumidifier in a location that may be exposed to combustible gas.
9. Do not use the dehumidifier near flammable gas or combustibles, such as gasoline, benzene, thinner, etc.
10. Do not use in areas where chemicals are handled.
11. Do not climb on or place objects on the dehumidifier.
12. Do not place a heavy object on the power cord and make sure that the cord is not compressed.
13. Place the dehumidifier on a level, sturdy section of the floor, and avoid placing on uneven or tilted section.
14. Disconnect the power if strange sounds, smell, or smoke comes from the dehumidifier.
15. Do not take the water bucket out while the dehumidifier is working.
16. Do not cover the intake or exhaust openings with cloths or towels.
17. Care should be taken when using the dehumidifier in a room with the following persons: infants, children, the elderly and people not sensitive to humidity.
18. Never insert your finger or other foreign objects into grills or openings. Take special care to warn children of these dangers.
19. You should never try to take apart or repair the dehumidifier by yourself.

Important Safety Instructions

20. Do not drink or use the water drained from the dehumidifier.
21. Always insert the filters securely. Make sure to clean the filter once every month.
22. Do not use the dehumidifier in very small spaces.
23. If water enters the dehumidifier, please turn the dehumidifier off and disconnect the power, contact Yaufey Customer Service at 858-703-0089 or support@yaufey.com in order to avoid a hazard.

CAUTION

- If the dehumidifier is knocked over during use, turn off the dehumidifier and unplug it from the main power supply immediately. Visually inspect the dehumidifier to ensure there is no damage. If you suspect the dehumidifier has been damaged, contact Yaufey Customer Service at support@yaufey.com for repair or replacement.
- Do not operate dehumidifier with a damaged cord or plug. Please contact Yaufey Customer Service at support@yaufey.com for repair or replacement.
- To reduce the risk of fire or electric shock, do not use this dehumidifier with any solid-state speed control device.
- The dehumidifier shall be installed in accordance with national wiring regulations.
- Be sure the dehumidifier is properly grounded. To minimize shock and fire hazards, proper grounding is important. This power cord is equipped with a three-prong grounding plug for protection against shock hazards.
- Your dehumidifier must be used in a properly grounded wall socket. If your wall socket is not adequately grounded or protected by a time delay fuse or circuit breaker, have a qualified electrician install the proper socket.
- Avoid fire hazard or electric shock. Do not use an extension cord or an adapter plug. Do not remove any prong from the power cord.

Parts Description

FRONT

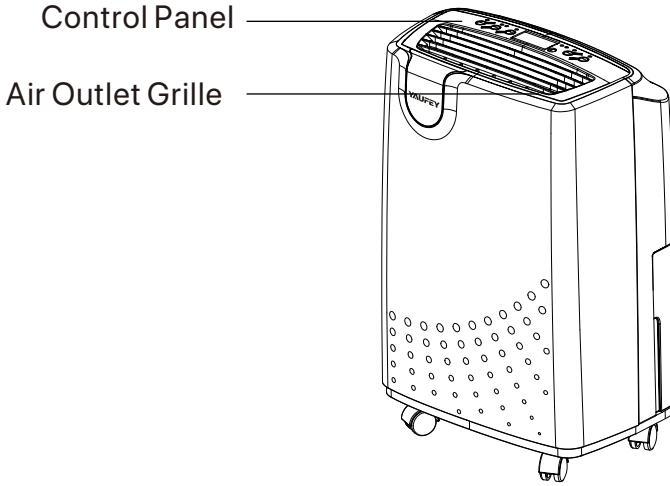

REAR

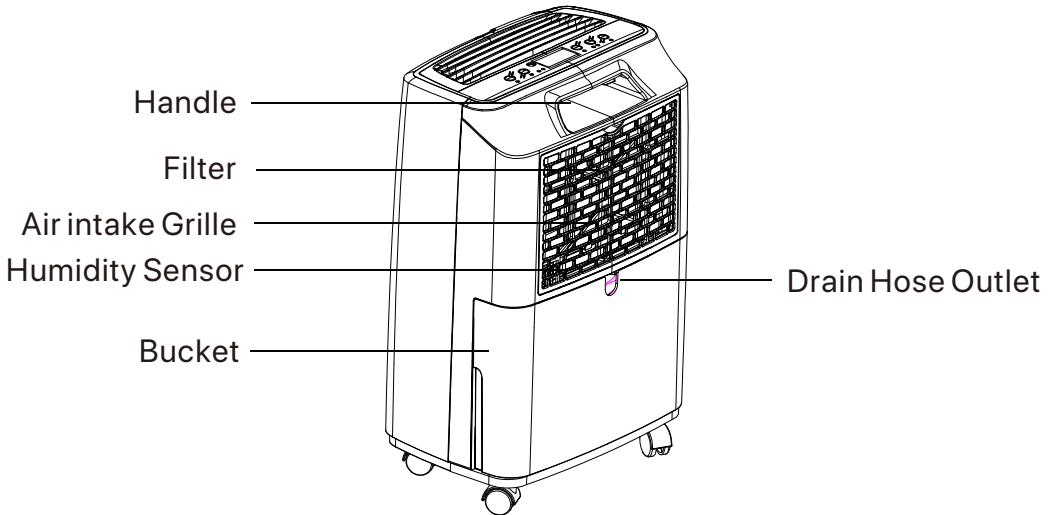

Operation

PLACE CORRECTLY

- This unit may have been tilted or placed upside down during shipping. To ensure this device works properly, please ensure this unit is upright for at least 24 hours before initial use.
- This dehumidifier is designed to operate with a working environment between 41°F (5°C) and 100°F (38°C).

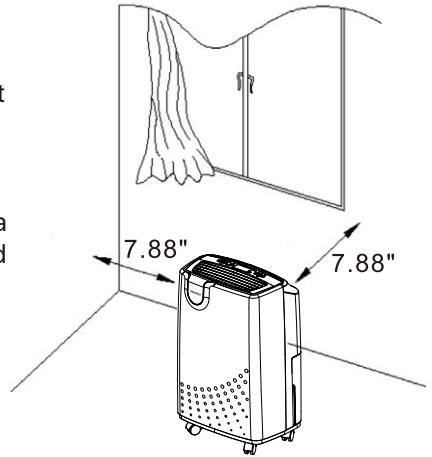

CONTROL PANEL

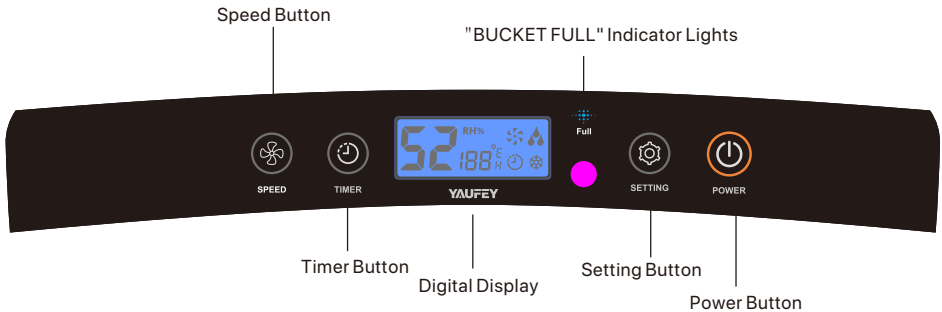

1. Power Button

Press to turn the dehumidifier on and off.

2. Setting Button

The humidity level can be set within a range of 30%RH to 80%RH in 5% increments. When it start work, it will first automatically detect and show the humidity (and temperature) in the room, then you can press or hold the Setting Buttons to change the humidity selection in 5% increments. (After you have set the desired humidity, the readout will display the actual room humidity.) When the room humidity level overtake or drops to the level you set, the dehumidifier will automatically begin working or stop. When the humidity level is set at 30%RH, the dehumidifier will be at CONTINUOUS dehumidifying mode.

3. Timer Button

The TIMER function enables you to either Delay Start or Delay Stop the unit in the choice from 1 hour to 24 hours. If the unit is running, then selecting Timer will turn the unit off in the hours that will be set (Delay Stop). If the unit is off, then selecting Timer will turn the unit on in the hours that will be set (Delay Start).

TIMER setting: Pressing or holding the Timer Button to change the delay timer at 1 hour increments, up to 24 hours. After TIMER setting finishes, the control will display the time remaining (8,7,6, etc.) until the unit either starts or stops. If then pressing TIMER button again, the control will display the room temperature like before. After that, pressing TIMER button again at any time will stop the TIMER function. For the Delay Start, the fan speed and humidity maintained will be the same as previous setting. Adjusting the timer setting to 0.0 will cancel the Auto Start/Stop function.

NOTE

- Before entering TIMER setting, make sure power is being supplied to the unit.
- Before entering TIMER setting, make sure pressing Setting Button sets one desired room humidity first.

4. Speed Button

Control the fan speed. Press to select either High or Normal fan speed. A higher fan speed will result in quicker moisture removal. Set the fan control to High for maximum moisture removal. When the humidity has been reduced and quiet operation is preferred, set the fan control to Normal.

5. "BUCKET FULL" Indicator Lights

When the bucket is full, the light will flash and the machine will automatically shut off. After the water in the bucket is emptied, put the bucket back in place, then the indicator will go out, and the machine will restart.

6. Auto Defrost Feature

When the dehumidifier is running at a lower temperature, the system will automatically determine if there is frost, and if frost is present, it will automatically defrost.

Defrost action: The fan runs at high wind speed while the compressor stops, and the LED screen display the defrosting symbol.

Action Description

Power on:

Compressor start after fan work a few seconds.

Power off:

Compressor shut down at once, after a few seconds, the fan stop (when other malfunctions occurs or humidity reached the desired level, the fan will stop after tens of seconds).

Tips: The compressor features "3 minutes delay protection" function —— While the dehumidifier is powered, the compressor can only start again three minutes after its last shutdown.

Operation

Fault & Protection Codes:

Number	Fault code	Name of the fault
1	E1	Humidity sensor error
2	E2	Defrost temperature sensor error
3	E4	Temperature sensor error
4	E7	Bucket is full. Empty the bucket.

NOTE

- If the display reads "E1", "E2" or "E4" error codes, please turn off and unplug the unit, and check for any obstructions. Plug it in again and restart the dehumidifier, if the malfunction is still present, please contact Yaufey Customer Service at support@yaufe.com for repair and/or replacement.
- When one of the above malfunctions occurs, the buzzer will alarm for a few seconds. Press any key during the alarm to release the alarm sound.

REMOVING THE COLLECTED WATER

There are two ways to remove collected water:

1. Use the bucket

When the bucket is full, remove the bucket and empty it.

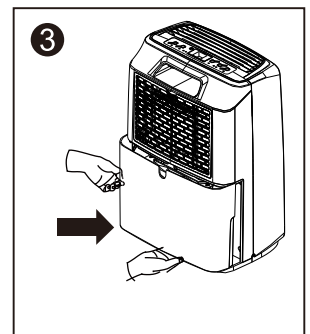
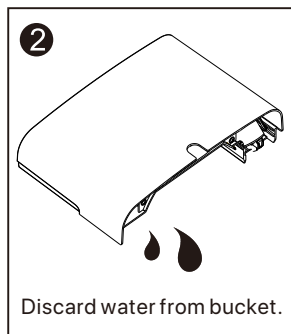
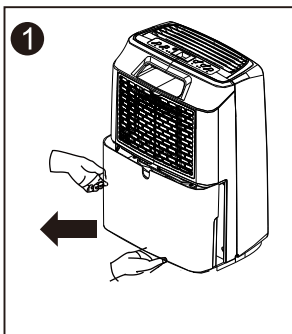

Operation

⚡ NOTE

- Replace the empty bucket back into the unit and once seated correctly, the unit will start up again.
- You should hear a click when the bucket is in the correct position.
- Do not remove the float in the bucket, otherwise the sensor will not be able to sense the water level properly, so that the water will overflow from the bucket when the bucket is full.

2. Continuous draining

Water can be automatically be emptied into a floor drain by attaching the dehumidifier to a drain hose. (It may be helpful to remove the bucket so you can see the connection better.)

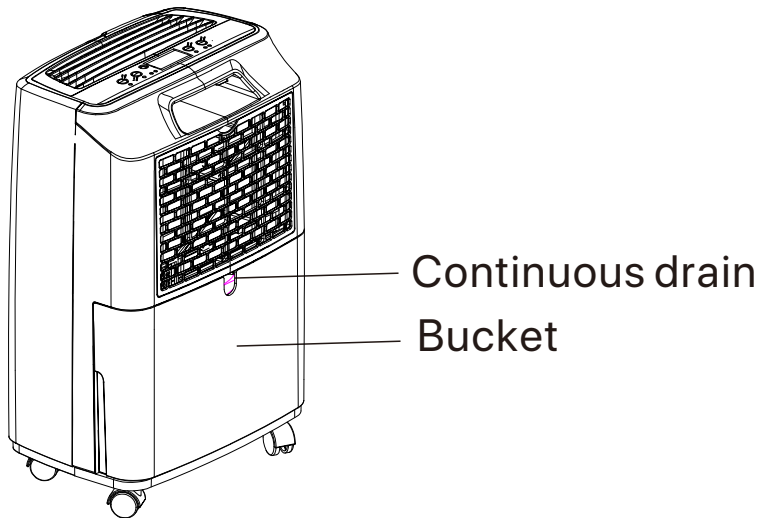

⚡ NOTE

- Make sure the connection is tight and there is no leaking.
- Lead the water hose to the floor drain or a suitable drainage facility, the drainage facility should be lower than the drain outlet of the dehumidifier.
- Be sure to run the water hose sloping downward to let the water flow out smoothly.
- When the continuous drain feature is not being used, remove the drain hose from the outlet.

Care & Cleaning

CARE AND CLEANING OF THE DEHUMIDIFIER

WARNING:

Turn the dehumidifier off and remove the plug from the wall outlet before cleaning.

1. Clean the bucket

Clean the bucket with water every two (2) weeks.

2. Clean the air filter

Clean the filter with clean water at least once every 30 days.

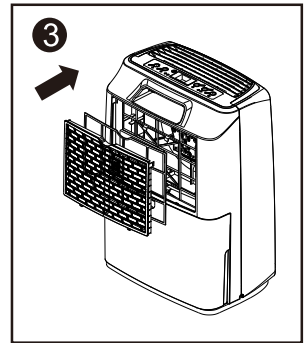
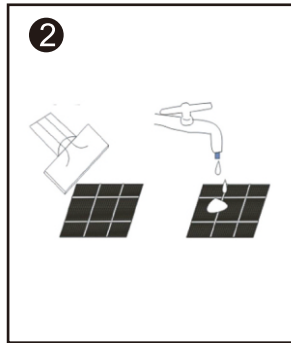
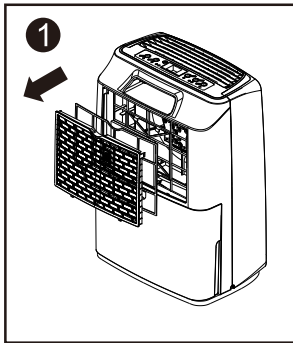

3. Storing the dehumidifier

When not using the dehumidifier for long time periods

- After turning off the dehumidifier, wait one day before emptying the bucket.
- Clean the main dehumidifier, bucket and air filter.
- Wrap the cord and bundle it with the band.
- Cover the dehumidifier with a plastic bag.
- Store the dehumidifier upright in a dry, well-ventilated place.

CAUTION:

DO NOT operate the dehumidifier without a filter. Because dirt and lint will clog it and reduce performance.

Troubleshooting

Before calling Yaufey customer service, review this list. It may save you time and expense. This list includes the most common occurrences that are not the result of defective workmanship or materials in this dehumidifier.

PROBLEM	CAUSE
Dehumidifier does not start	<ul style="list-style-type: none">- Make sure the dehumidifier's plug is inserted completely into the outlet.- Check the house fuse/circuit breaker box.- Dehumidifier has reached its preset level or bucket is full.- Bucket is not in the proper position.- Room temperature is between 41°F (5°C) and 68°F (20°C). Auto-defrost is in progress. The unit can't be started temporarily.
Dehumidifier does not dry the air as it should	<ul style="list-style-type: none">- Did not allow enough time to remove the moisture.- Make sure there are no curtains, blinds or furniture blocking the front or back of the dehumidifier.- The humidity selector may not be set low enough.- Check that all doors, windows and other openings are securely closed.- Room temperature is too high or too low, above 100°F (38°C) or below 41°F (5°C).- There is a kerosene heater or something giving off water vapor in the room.
The dehumidifier makes a loud noise when operating	<ul style="list-style-type: none">- The air filter is clogged.- The dehumidifier is tilted instead of upright as it should be.- The floor surface is not level.

Please contact Yaufey Customer Service at support@yaufey.com if dehumidifier operates abnormally or does not operate, and the solutions above are not useful.

Technical specifications

Model Name	Dehumidifier
Part No.	PD161D
Voltage/Frequency	110V ~ 60Hz
Humidity removal(27°C/60%RH)	15.8Pints/Day
Humidity removal(30°C/80%RH)	25.3Pints/Day
Humidity removal(35°C/90%RH)	32.7Pints/Day
Rated input power(27°C/60%RH)	173W
High temperature power (30°C/80%RH)	210W
Max Power(35°C/90%RH)	260W
Air circulation	3884.6cuft/h
Refrigerant/quantity	R134a/4.23oz
Protection type of preventing electric shock	I
IP Level	IP20
Max allowable pressure of Heat exchanger	2.5MPa
Max allowable pressure of Air-in/Air-out side	0.7MPa/2.0MPa
Max allowable pressure of high/low pressure side	2.5MPa
Bucket capacity	3.8Pints
Dimensions	12.2" x 8.27" x 18.9"
Weight	23.8lbs

Warranty

Yaufey offers a 12-month warranty on all of our products purchased new and unused from Yaufey Technologies Co., Ltd. or an authorized reseller, with an original proof of purchase and where a defect has arisen, wholly or substantially, as a result of faulty manufacturing, parts or workmanship during the Warranty Period. The warranty does not apply where damage is caused by other factors, including without limitation: (a) normal wear and tear; (b) abuse, mishandling, accident or failure to follow operating instructions; (c) exposure to liquid or infiltration of foreign particles; (d) servicing or modification of the product other than by Yaufey. These are our general terms for the warranty service, but we always urge our customers to reach out to us with any issue, regardless of warranty terms. If you experience an issue with a Yaufey product, please contact us at support@Yaufey.com or (858) 703-0089, and we will do our best to resolve it for you.

WARNING

This manual is to be used with all items with the model numbers

PD 161D
HD 163A

WARNING: Keep all plastic bags away from children.

Manufacturer, distributor, importer and seller are not liable for ANY damage caused by improper use, storage, care or failure to follow warnings associated with this product.

Contact Us

 OFFICIAL WEBSITE

<https://yaufey.com/>

 CALL US

858-703-0089

 EMAIL US

support@yaufey.com

YAUFEY

Home Dehumidifier

support@yaufey.com

Contact us on Facebook: