



Wansview HD

IP Camera

Q3(720P)/Q1/3S(1080P)

User Manual



We keep improving the app, if the app interface is not accordance with the instructions, please go to wansview website: <http://www.wansview.com> for the latest instructions.

Revised on 1st January 2018

[www.wansview.com](http://www.wansview.com)



# CONTENT

<b>Welcome</b> .....	5
<b>Important Security Warning</b> .....	5
<b>Important Safeguards and Warnings</b> .....	5
1. Features and Specifications .....	7
2. 1.1 Product Profile .....	7
1.2 Features .....	8
1.3 Uses .....	8
1.4 Specifications .....	8
1.5 System Requirements .....	9
3. Camera Management with Smartphones/Tablets .....	10
Wansview App for iOS and Android .....	10
2.2 Live Streaming .....	13
2.3 Local Picture and Record .....	15
2.4 SD/TF Record and Playback .....	16
2.5 Alarm Setting .....	18
2.6 Advanced Settings .....	20
2.6.1 WiFi Setting .....	20
2.6.2 User Setting/Management .....	21
2.6.3 Time Setting .....	22
2.6.4 SD/TF Setting .....	23
2.6.5 Misc Setting .....	23
2.6.6 Maintenance .....	25
2.6.7 About Camera .....	25
2.7 Start Video .....	26
2.8 Delete device .....	26
2.9 Message .....	27
2.10 More .....	27
4. PC Client Software .....	29
3.1 Add Camera .....	29
3.1.1 Add camera in Lan .....	29
3.1.2 Manually add camera (suitable for outside network) .....	
30 3.2 Play/Stop Video .....	
30 3.2.1 Play Video .....	30
3.2.2 Stop Video .....	31
3.2.3 Video Interface .....	32

3.3 Camera Settings .....	32
3.3.1 Edit Device .....	32
3.3.2 Advanced Settings .....	33
3.3.2.1 Device Info .....	33
3.3.2.2 Time Setting .....	33
3.3.2.3 User Setting .....	34
3.3.2.4 WiFi Setting .....	35
3.3.2.5 SD/TF Setting .....	35
3.3.2.6 Other Setting .....	36
3.3.3 Alarm Setting .....	37
3.3.3.1 Motion Detection .....	38
3.3.3.2 Audio Detection .....	38
3.3.3.3 Linkage Alarm .....	39
3.3.3.4 Alarm Time .....	41
3.3.4 Web Access .....	41
3.4 Multi-View .....	42
3.5 Local Setting .....	42
3.6 Scheduled Recording .....	43
3.7 Playback .....	44
3.7.1 Playback Local Record .....	44
3.7.2 SD Card Record .....	45
3.8 Lock .....	46
4. Manage Camera with other Apps and Software .....	
Add Camera to iSpy Connect .....	48
5. Web Access .....	48
5.1 Settings .....	48
5.1.1 Plugin installation .....	48
5.1.2 View Video-Mode 1 - Complete Camera Management .....	49
5.1.3 View Video- Mode 2 – Limited Camera Management .....	49
5.2 Live Streaming and Recording on PC .....	49
5.3 Playback Video(function disabled in this model) .....	50
5.4 Set Up .....	51
5.4.1 System .....	51
5.4.2 Network .....	53
5.4.3 Video and Audio .....	57
5.4.4 Security .....	59
5.4.5 Alarm - Motion and Audio Detection .....	60
5.4.6 Storage(function disabled in this model) .....	63
5.4.7 Log .....	64

**Welcome**

Thank you for purchasing Wansview Q3(720P)/Q3S(1080P) Full HD IP Camera.

For any question and product updates please contact us:

1: By email:

US/CA: [service@wansview.com](mailto:service@wansview.com)

[service2@wansview.com](mailto:service2@wansview.com)

UK: [service3@wansview.com](mailto:service3@wansview.com)

2: By Skype:

US/CA: [service2@wansview.com](https://www.skype.com/add?contact=wansview.com)

UK: [service3@wansview.com](https://www.skype.com/add?contact=wansview.com)

check the FAQ's on wansview website: <http://www.wansview.com/Service/faq/>

3: Contact us by Facebook

 [www.facebook.com/WansviewClub/](https://www.facebook.com/WansviewClub/)

4: Contact us by [https://www.youtube.com/channel/UCPRXQcIkLsMAWQtPqGxVx\\_jw](https://www.youtube.com/channel/UCPRXQcIkLsMAWQtPqGxVx_jw) Or

scanning the QR code to enter our Youtube channel.

**Important Security Warning**

In order to keep your Wansview camera secure and prevent unauthorized access, please make sure to follow the steps below:

1. The camera has always the latest firmware installed. If we update the firmware, we upload it on [www.wansview.com/Service/download/](http://www.wansview.com/Service/download/)
2. Change the default password for your camera. We suggest that your password is more than 8-10 characters and contains a combination of lowercase characters, uppercase characters and numbers.

**Important Safeguards and Warnings****1. Electrical Safety**

All installation and operation should conform to your local electrical safety codes.

We assume no liability or responsibility for any fires or electrical shock caused by improper handling or installation.

**2. Transportation Safety**

Heavy stress, violent vibrations, and excess moisture should not occur during transportation, storage, and installation of the device.

**3. Installation**

Handle the device with care. Keep the device right side up.

Do not apply power to the camera before completing installation.

Do not place objects on top of the camera.

**4. Repair Professionals**

All inspection and repair work should be done by qualified service engineers.

We are not liable for any problems caused by unauthorized modifications or user-attempted repair.

## 5. Environment

The camera should be kept in a cool, dry place away from direct sunlight, flammable materials, explosive substances, etc.

This product should be transported, stored, and used only in the specified environments as stated above.

Do not aim the camera at a strong light source, as it may cause overexposure of pictures, and may affect the longevity of the camera's sensors.

Ensure that the camera is placed in a ventilated area to prevent overheating.

## 6. Operation and Maintenance

Do not touch the camera sensor or lens directly.

To clean dust or dirt off of the lens, use an air blower or a microfiber cloth.

## 7. Accessories

Be sure to use only the accessories recommended by the manufacturer.

Before installation, please open the package and check to ensure that all of the components are included.

Contact us if anything is broken or missing in the package.

## 8. Battery Drainage and Data Consumption

Please remember to exit the app after use, to prevent battery drainage and data consumption.

## 9. Compliance

FCC, CE, ROHS

## 1. Features and Specifications

The Wansview Full HD IP Camera is an integrated indoor IP Camera developed specifically for network video applications.

### 1.1 Product Profile

Front View



The Wansview Full HD IP Camera comes with 4 PCS IR LED, a CMOS Sensor, Wi-Fi Antenna, and built-in Speaker and Microphone. It supports up to 128 GB SD cards for recording. The camera also has a Pan and Tilt function, with 350° horizontal pan and 67° vertical tilt.

Rear View



Bottom View



## 1.2 Features

- Full HD Video
- Live Streaming
- Pan and Tilt, 4x digital zoom
- Night Vision distance up to 25 feet
- 2 Way Audio with built-in microphone and speaker
- Support Wi-Fi connection
- Multi-App/Software Compatibility
- Support Micro SD card storage up to 128GB
- Mountable on walls and ceilings

## 1.3 Uses

- Home Security
- Business Security
- Entryway Monitoring
- Baby Monitoring
- Pet Monitoring
- Elderly Parents

## 1.4 Specifications

CAMERA-VIDEO	Q3	Q3S
Resolution	720	1080
Effective Pixels	1280*720/640*360/320*180	1920*1080/640*360/320*180
Max Video Resolution	1280*720	1920*1080
Maximum Frame Rate(FPS)	25	
IR Cut Filter (DAY/NIGHT)	YES	
Infrared LED	4 pieces	
Night Vision Range (feet)	25 feet	25 feet
Video Compression	H.264/MJPEG	
PTZ	Pan:350° Tilt: 76° Zoom:4X	
LENS		
Lens Focal Length (mm)	3.6 MM	3.6 MM
Filed of View	65°	65°
AUDIO		
Interface	Built-in Microphone and Speaker	
Two Way Audio	YES	
NETWORK		
Ethernet	RJ-45	
WiFi	IEEE802.11b/g/n 2.4GHz	
Recommended Distance from Router	15m/50ft	
Protocol	Onvif, TCP/IP, UDP, SMTP, NTP, HTTP, DHCP, DDNS, FTP	
WPS	WPS Push wireless connection	
Encryption	64/128-bit WEP, WPA/WPA2-PSK	
Max User Access	4 users at the same time	
RECORDING		
Storage type	PC/Phone	
AUXILIARY INTERFACE		
Micro SD card Slot	Micro SD, Max 128GB	
MOTION DETECTION		
Notifications	YES, MAIL/FTP	YES, MAIL/FTP
Schedule recording	YES	YES
CAMERA MANAGEMENT		
Smartphone/Tablet	Wansview app for iOS/Android	
Web Browser	E	
Account Permission	YES	
Compatible Apps/Software	Blue Iris, Tinycam Monitor, iSpy, Sighthound	
OPERATION AND CONVENIENCE		
Wall/Ceiling mountable	Yes	
Power Cord Length	8 feet	
Power Supply	5V 1.5A	
Power Switch	No	
Material	Plastic	
Certification	CE FCC ROHS	CE FCC ROHS

### 1.5 System Requirements

Position your camera in 50ft/15m distance from the router and close to an DC Plug. The included power cord is 8 ft long. If you need a longer power cord, it should be within 16 ft, if longer, the voltage will not be stable. Users can extend Wi-Fi signal with Wi-Fi extenders and get a longer power cord, if needed. Check the quality of the video before final mounting. In indoor installations, the range might be less if metal objects or thick walls and ceilings are between the camera and the router. Quality is affected also by the number of devices connected to the network and by interferences from other networks/devices. If video quality is not good, we advise to position the camera closer to the router or reduce resolution and the frame rate (fps).

Users can place indoor cameras in protected outdoor areas (such as a covered porch) as long as it remains dry and within its operating temperature range of -10 to 50 degrees C. The camera is not waterproof and any exposure to moisture and/or temperatures outside the operating range will void our one-year limited warranty. Users can guard outdoors by placing the camera behind a window, making sure to disable IR Leds and open the outdoor lights.

The Wansview Camera is a P2P camera as long as the camera is connected to the internet. Users can view the camera from smartphones/tablets or PC, wherever they are using cellular data or Wi-Fi connections. If users don't want to use the internet to access the camera, and choose to access only in their own private network/LAN, we can supply a tool which can disable P2P and DDNS functionalities. Please contact our customer service.

## 2. Camera Management with Smartphones/Tablets

### 2.1 Wansview App for iOS and Android

#### Cable Setup

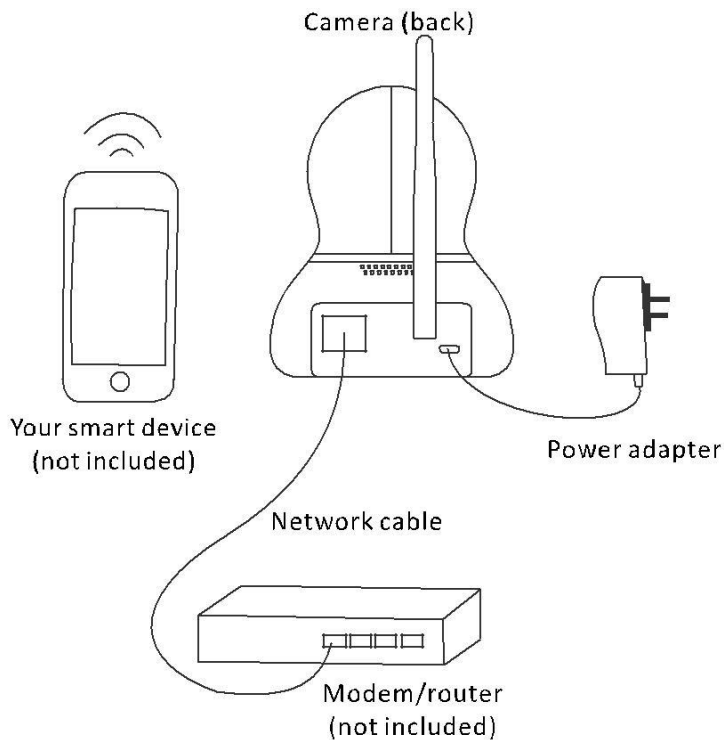

## Download Wansview App

Go to App store or Google Play and install the “Wansview” app to your supported device.

## Power on Camera

Power for the camera with the included power supply and place it near your router.

## Connect to Network

Launch the Wansview app, click “+” to access Add Camera page.

And then there are three methods to add the camera and connect camera to internet.

**Note: Before set up WiFi, make sure your WiFi is 2.4G, wansview camera cannot work with 5Ghz WiFi.**

**And special characters “ ” and “ & ” cannot be supported, if your WiFi has the two special characters, please try to create a Guest WiFi in your router for the camera, so camera can be connected to the Guest WiFi, and other WiFi devices at home don't need to reconnect.**

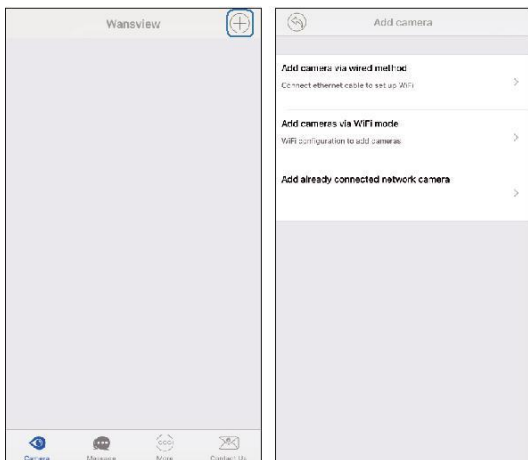

### 1: “Add camera via wired method”

User can connect the camera with Ethernet cable to view the camera, and can set up WiFi using this method. Follow the wizard on app step by step.

### 2: “Add camera via WiFi Mode”

Using this method, there is no need to connect camera with ethernet cable, user can set up the camera with WiFi within 5 minutes of powering the camera on (Blue light still blinks) by sonic wave from your phone. Follow the wizard on app step by step.

### 3: "Add Already Connected Network camera"

This is suitable for camera that is already connected with internet. Such as add the camera to a second phone, or share the camera to other person.

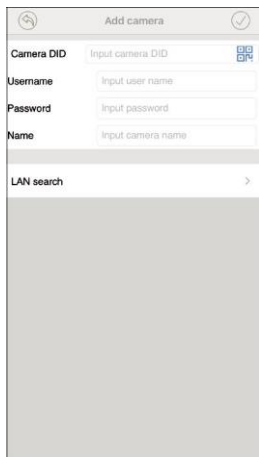

User can use the below ways to add the camera:

1: If camera is on your hand , you can tap  to scan the **Camera's QR code** to get the camera information.

2: If the mobile device and the camera are in the same WiFi network, user can use "**Lan Search**" to search the connected camera.

### 3: Manually input camera information:

Camera DID can be found from the camera's stickers



or Wansview app ,



Default Username/Password is

admin/123456; Name can be any information.

**Attention: Please remember tap  to save all the settings.**

When the camera shows "Online", tap ">" to Advanced Settings > User Setting to change the default User name and Password. This process is outlined in 2.6.2 User Setting.

## 2.2 Live Streaming

Each camera can be accessed by up to 4 users at the same time. The administrator can setup 3 different levels of access: administrator, operator and viewer. Please refer to Page 22.

Viewing Camera on a Single Window

Tap  to enter the live feed and do more operations.

Tap the monitoring screen to see the video menu.

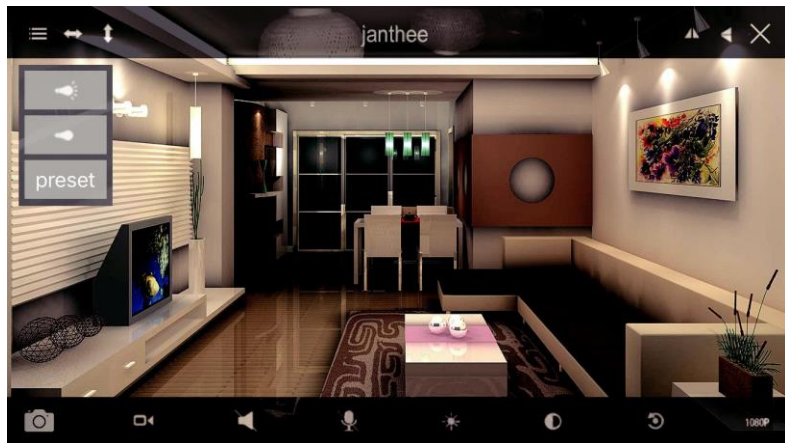

 **Snapshot:** User can save snapshot picture to the mobile phone storage, and can check the snapshot from More-Pictures or from Local Picture/Record.

 **Record:** User can record video to the mobile phone, and check it from More-Records or Local Picture/Record. The record will stop if you leave the live video screen.

 **Listen:** When the Listen is on, user can listen what happening on the camera end.

 **Talk:** When enabled the Talk, user can hold the "Hold Talk" to communicate with the people/pets on the camera end.

 **Restore:** To restore the Contrast and Brightness to default value.

 **Resolution:** Switch between 1080P and 480P. When the network is not good, try lower down the resolution to 480P to get a smooth video feed.

 **Cruise Vertically/Horizontally :** Max 10 cruise, default 1 cruise, user can set up from camera's web page: Set Up-System-Pan & Tilt.

 **IR Auto:** IR Led switches on at night when the luminosity is under 5 lux, if the camera has no night vision, tap here to enable the IR led.

 **IR OFF:** Tap here to turn off the IR light, if disabled, camera has no night vision.

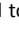

**Preset:** The Preset function allows user to set up to 8 spots on the video and recall them quickly, first select Set and choose the spot, then press 1, when you call, select “Call” and press Spot number.

**Flip/Mirror:** If the live video is upside down because of the installation, tap  and  to make it right.

**Exit:** Turn off the live feed screen.

### Viewing Camera on Multi-View

User can monitor several cameras (Max. 4 )at the same time on Multi-View.

- 1: Tap “More” and select “Multi-View” Click on cameras on the list to add the view on the main screen.
- 2: Tap  to hide the camera’s list
- 3: Tap  to exit multi-view mode
- 4: Press  to play camera, Tap again to stop the video.

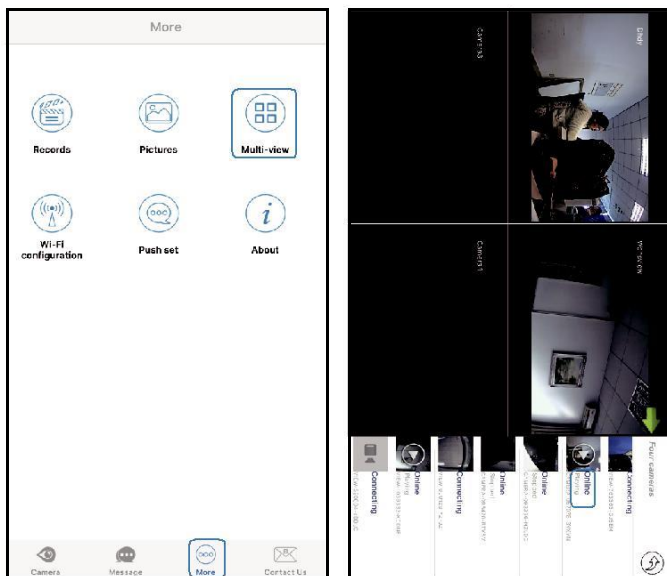

### 2.3 Local Picture and Record

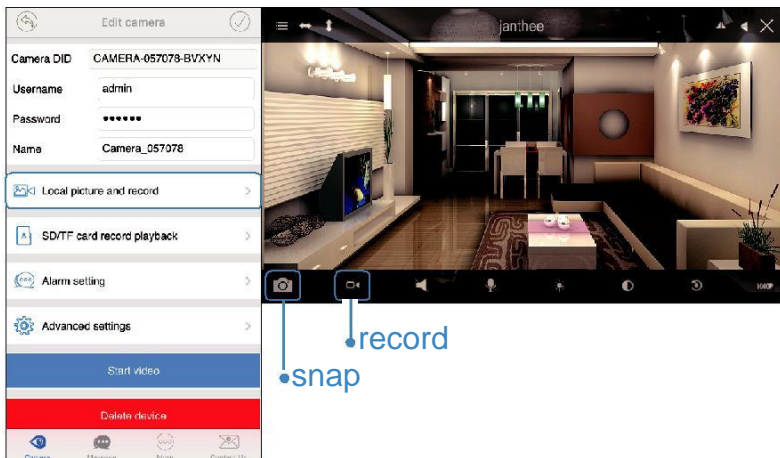

During live streaming, user can take snapshots by tapping on Snapshot to phone and Record to phone. To stop recording, tap again or exit from the live streaming. In Local Picture and Record, User can find all the pictures and videos taken manually.

#### Share pictures and records

To share pictures and records, follow the steps indicated in the screenshots. Tap to share the pictures, and to delete pictures.

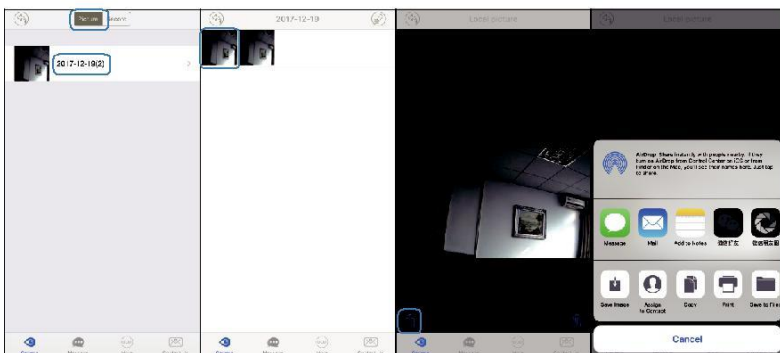

### Save records to phone and delete records

Select the videos recorded, click to save videos in the mobile phone; to share the video, please go to mobile phone Photo directory to share it; click to delete videos.

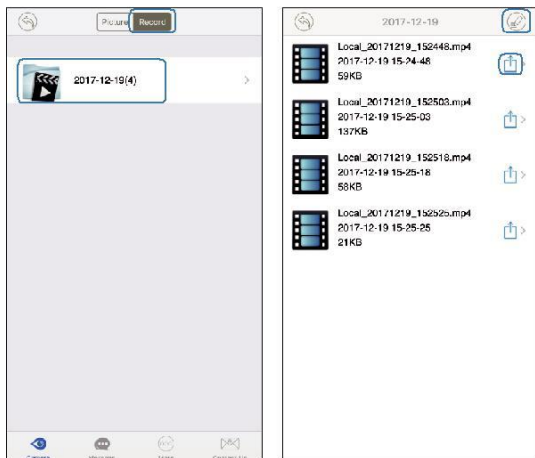

## 2.4 SD/TF Record and Playback

### SD Card recording

If a SD Card is installed in the camera, When the camera shows “Online” on wansview app, tap “>” to enter Edit Camera page, from Advanced Settings>SD/TF Card schedule recording, users can choose to record or not on the SD card by switching the SD/TF Recording button.

Supports max 128GB micro SD card(SD card is not included in the box), 1080p 24 hour video can be saved for almost 4days, 720P can record about 8 days,480P can record 24 days.

The new recorded video will automatically overwrite the old files if the SD card capacity is not enough.

If SD Card is inserted, but cannot read or cannot use, please tap “Format SD/TF card” first.

Note: The SD card recording is for constant recording, record time can be set from 2-15 minutes, if you only need alarm video, please do not enable SD Card recording, and go to Alarm Setting to save alarm Video to SD card.

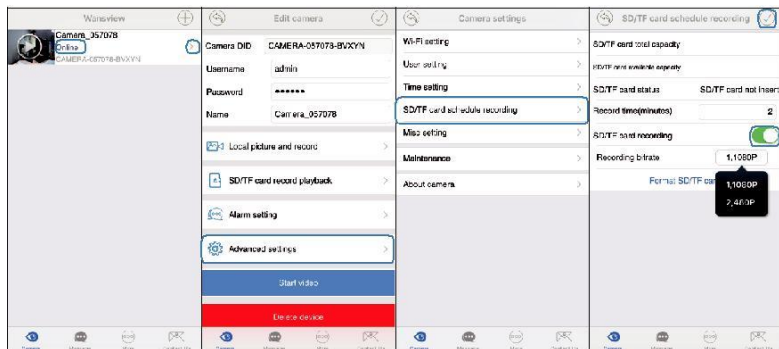

### Playback recorded video

Access to SD/TF Record Playback. Choose a day in the calendar, then select Schedule or Alarm click Done to see the list of recorded video on the SD card.

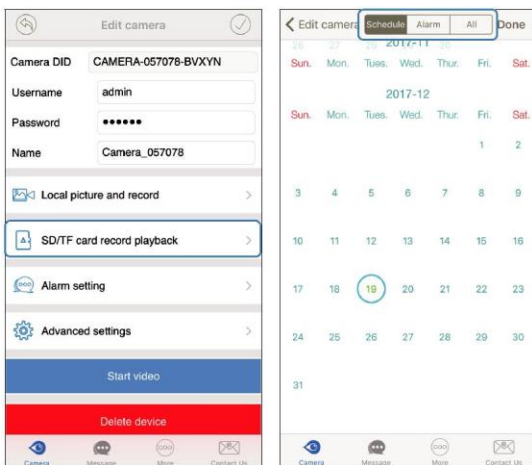

## 2.5 Alarm Setting

The camera is mostly for live video, what we achieve is to make the video more clear and easy set up. it is not a professional security camera, the motion detection is only an add-on feature. So the alarm notification will not be very accurate.

But if you want the motion detection works accurately, you may connect the camera to some professional security software like: Blue Iris, iSpy or Sighthound, the camera alert works great on them.

Follow the below steps to set up alarm.



### Alarm Deployment

**IO Detection:** this is for camera that can connect external source of alert device.

The Q3/Q3S is not available.

**Sensor Type:** For external source of alert device. The external sensor can be always open or always close.

**Motion Detection:** Enable Motion Detection, user can set up camera with motion alarm

**Motion Detection Sensitivity:** User can choose Low/Middle/High sensitivity according to needs.

**Voice Detection:** Enable Voice Detection, user can set up camera with voice alarm

**Voice Detection Sensitivity:** User can choose Low/Middle/High sensitivity according to needs.

**Trigger Alone:** The alarm will be triggered for any kind of active alarm event(Motion/Voice/IO)

**Trigger Link:** The alarm will be triggered for multiple detection at the same time(Motion/Voice/IO).

### Alarm Action:

**Save Picture to Email:** When an alarm is detected, the camera will send pictures to the email box. Users can set up to 2 recipients.

Click Mail Setting to setup the email. Check your email provider for SMTP Server and Port.

For Email Setting, please follow the below parameters:

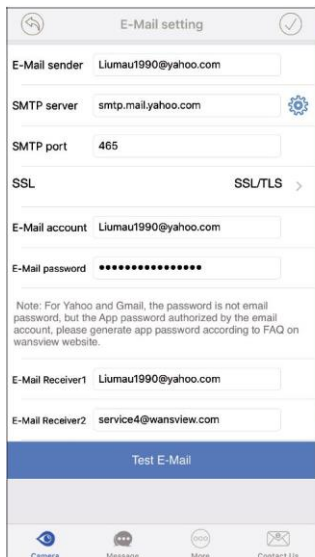

**Sender:** your email address

**Smtp Server:** such as smtp.mail.yahoo.com etc.

**Smtp port:** 465

**SSL:** SSL

**User name:** your email address, the same with sender

**Password:** your email password, if you are using Yahoo and Gmail, please generate an app password, and using the app password. Check the FAQ document on website to generate app password.

**Receiver:** any email address

After you fill in the chart of the email setting page, please Save and Test E-Mail.

**Save Picture to FTP:** When an alarm is detected, the camera will send pictures to your FTP server. Click on FTP Setting to setup FTP.

**Save Record to FTP:** When an alarm is detected, the camera will send a video to your FTP server.

For FTP paramters, please refer to Page 40

**Save Picture to SD/TF:** When an alarm is detected, the camera will send pictures to the SD card.

**Save Record to SD/TF:** When an alarm is detected, the camera will send a video to the SD card.

**Trigger IO Output:** Not available for Q3/Q3S.

**Preset Linkage:** When an alarm is detected, the camera will focus on one of the 8 Preset spots (see above).

**Speaker Linkage:** When an alarm is detected the speaker will act as a siren for the chosen length (5-30sec).

## 2.6 Advanced Settings

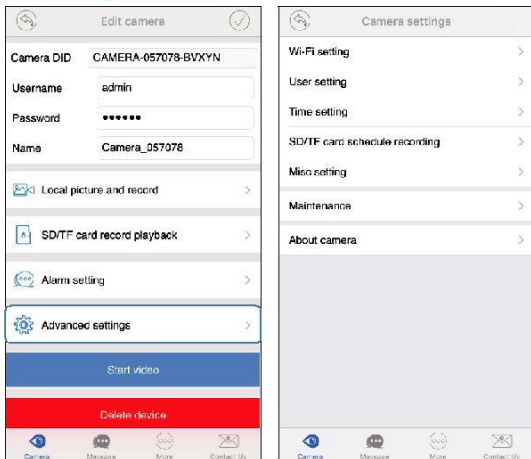

### 2.6.1 WiFi Setting

If camera is connected with ethernet cable, and want to set up WiFi, or change another WiFi network, user can set up WiFi on WiFi Setting.

Tap WiFi Setting, and search the available WiFi, choose the WiFi and manually input the WiFi Password, then tap to save the WiFi information.

User can unplug the ethernet cable when the app appears "WiFi Set Succeed".

**Note: Wansview camera only supports 2.4Ghz WiFi, and wifi password should be no longer than 31 characters.**

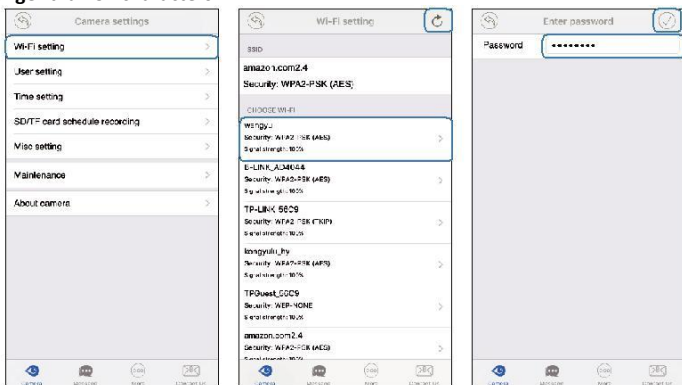

## 2.6.2 User Setting/Management

Under the User Setting/Management, user can change the default username(admin) and password (123456), or create another user account with certain access rights, such as an Operator or Viewer account for other person to view the camera.

### Change Username and password:

Tap User Setting, and choose Administrator>Admin, user can change the username and password, then .

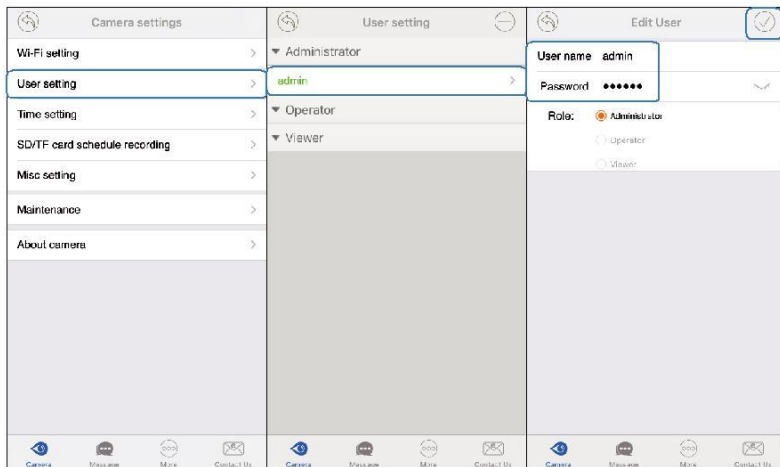

### Add another user account

On User Setting, tap  to add user, manually add the username and password, then choose the Role (Operator or Viewer).

Administrator: Full access rights

Operator: Can operate on the camera live video screen, but not access to other settings like Alarm setting, Advanced Settings etc.

Viewer: only can view camera, no more operations on the camera video screen.

Note: Password shall be no longer than 20 characters.

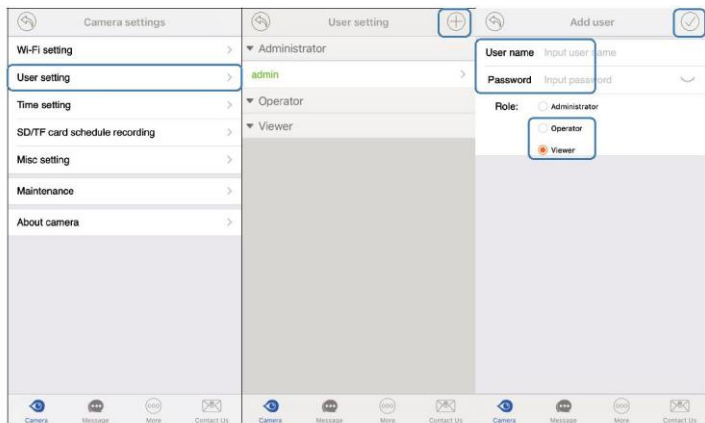

### 2.6.3 Time Setting

Click Time Setting, user can calibrate the time.

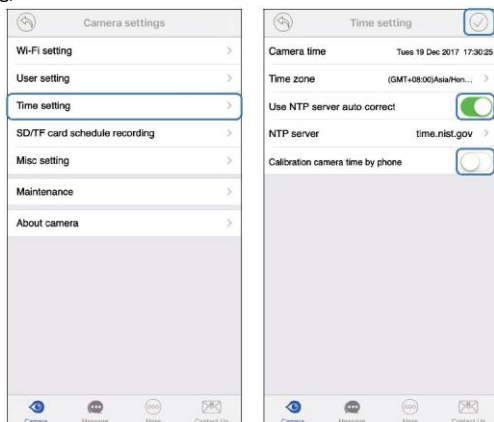

### 2.6.4 SD/TF Setting

Please refer to P16-P17.

### 2.6.5 Misc Setting

On Misc Setting, user can set up OSD (On Screen Display), Microphone/ Speaker Volume and AC Frequency.

#### OSD Setting

Click "OSD Setting" to set:

Overlay time: Camera time in live streaming, recording and pictures  
Temp and humidity is not available for Q3/Q3S

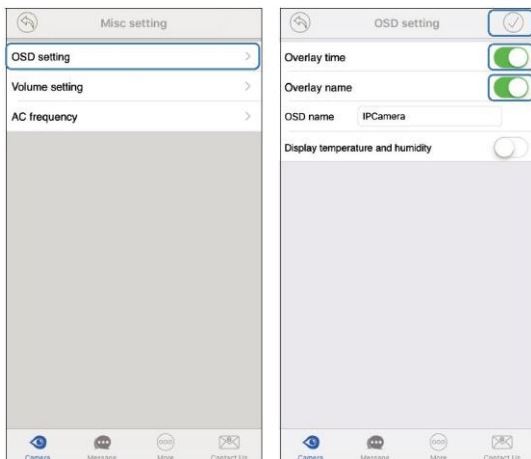

overlay name

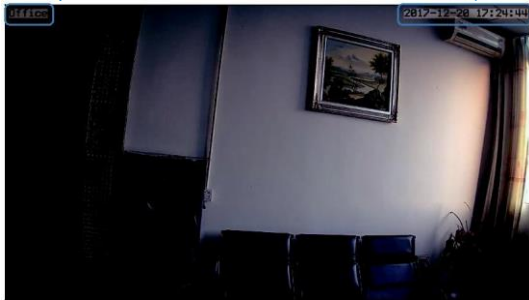

overlay time

### Volume Setting

If volume of the “Talk” and “Listen” is too low, user can adjust it from Volume Setting

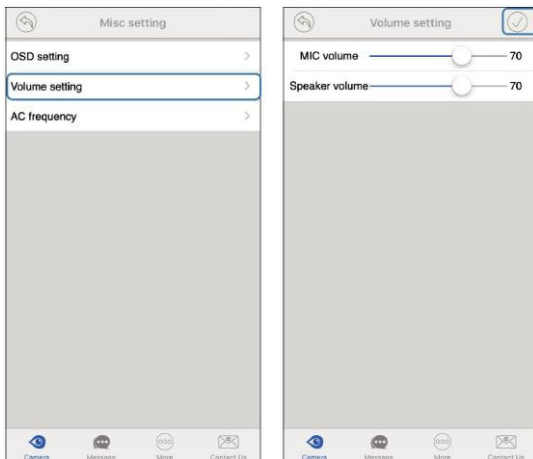

### AC Frequency

User can adjust the power frequency, power frequencies include:50HZ(220V voltage selects 50HZ), 60HZ(110V Voltage selects 60HZ).

For 60HZ, the highest frame rate can be 30fps, and 50HZ is 25fps.

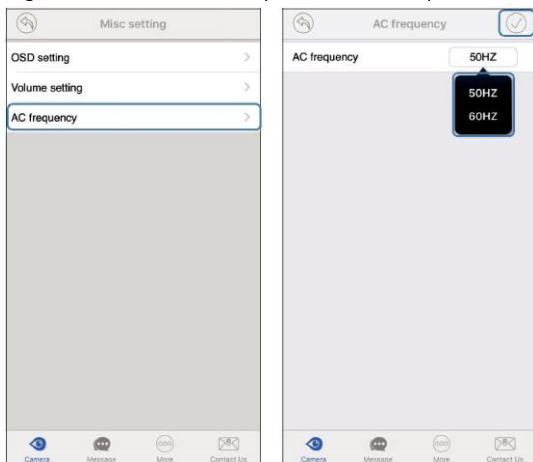

### 2.6.6 Maintenance

Reboot camera if camera is always loading or if the camera/app is frozen. No need to set up again. If camera restores to factory default, the set up procedure needs to be repeated again after reboots.

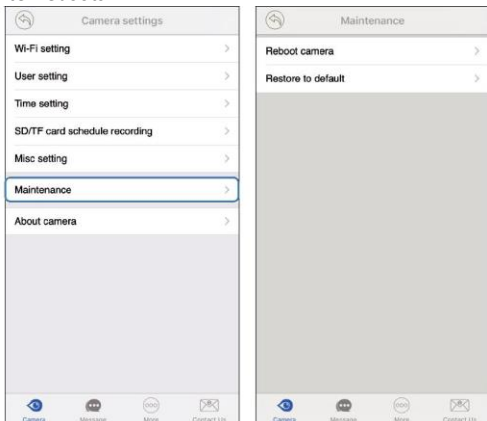

### 2.6.7 About Camera

Here user can check the camera information, such as Firmware, P2P version, IP Address and Mac Address.

For Wan IP address, if the Lan ip address is not port forwarded in router(the camera connected with), it cannot be accessed from outside network.

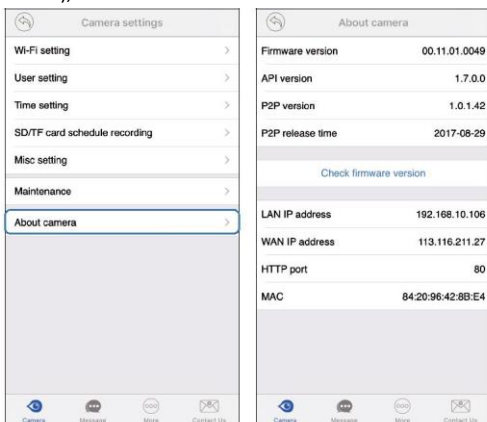

## 2.7 Start Video

Tap "Start Video" to broadcast the camera live streaming.

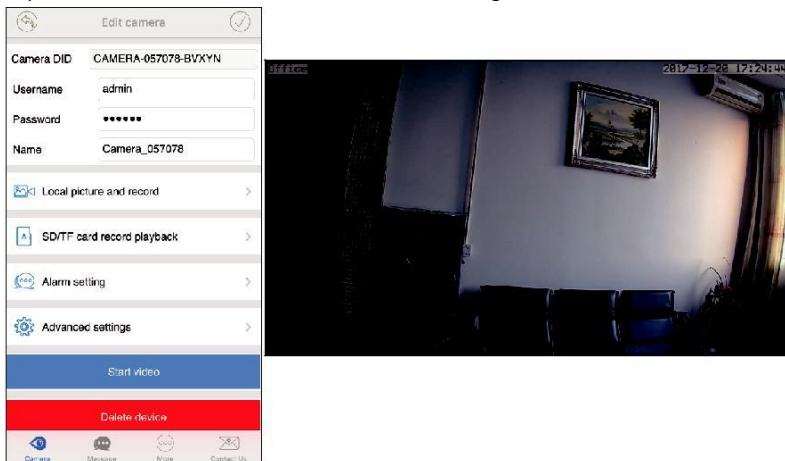

## 2.8 Delete device

Tap "Delete device", user can delete the camera from the app.



## 2.9 Message

On the Message, user can check the alarm message.

## 2.10 More

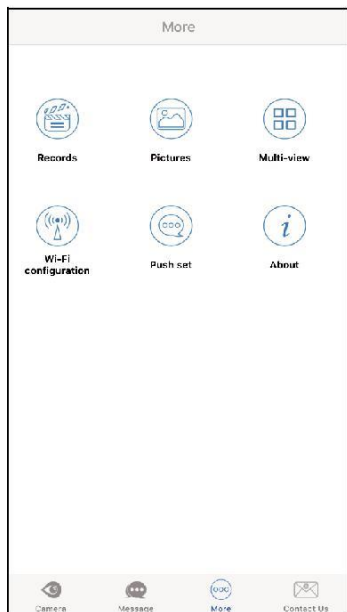

Record and pictures are the local files recorded from the wansview app.

Multi-View: Please refer to P 14

Push Set : Currently not available

About : Can check the wansview app version

### WiFi Configuration

This is another method to connect WiFi.

Make sure your mobile phone is connected with 2.4G WiFi, and follow the below steps to set up WiFi:

1: Tap **More-WiFi configuration**, the wifi name is located, enter your **wifi password** correctly-- tap Configuration for 3 -5 times, if the Blue led is flashing quickly, which means the camera is receiving WiFi information or connecting to the WiFi, and wait for a while, then go back to Camera list page.

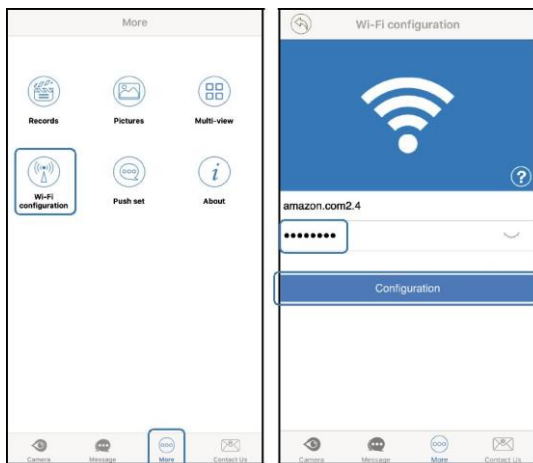

2: Tap "+" to Add Camera by "Add Already Connected Network Camera", then follow P12 to Add camera.

### 3. PC Client Software

#### 3.1 Add Camera

##### 3.1.1 Add camera in Lan

- 1) Tap to add camera
- 2) Search the camera in Lan, DID number will be searched if use DID(P2P) to search, while Search IP will get IP Address
- 3) Click the searched camera, and the camera information will be filled automatically.
- 4) Input the camera's password (default is 123456).
- 5) Hit "Add".
- 6) "Save Success" will appear, click "OK" to close the dialog.

The screenshot displays the Wansview PC Client Software interface. On the left sidebar, the 'Add Camera' button is highlighted with a red box and labeled '1'. The main window shows the 'Add Camera' dialog with fields for Camera name, Username, Password, DID number, Camera type, and Camera group. The 'Add' button is highlighted with a red box and labeled '5'. Below the dialog, a table lists LAN search results with columns for Camera Name, IP Address, Http Port, Mac Address, and Series. The first row is highlighted with a red box and labeled '3'. A 'Success' dialog box is shown in the center, labeled '6'. At the bottom of the main window, the 'Search' button is highlighted with a red box and labeled '2', and the 'Create DID QR Code' button is highlighted with a green circle.

	Camera Name	IP Address	Http Port	Mac Address	Series
1	VIEW-447348-RJSHS	192.168.10.133	8080	78A5DD-115D64	P2P
2	VIEW-394626-R2NEX	192.168.10.121	8081		P2P
3	VIEW-785362-CXGKD	192.168.10.117	80		P2P
4	VIEW-785367-HHTTF	192.168.10.102	80		P2P
5	VIEW-471271-H4HTB	192.168.10.101	80		P2P
6	VIEW-634161-88PFW	192.168.10.131	80	EDB92D767738	P2P

System firmware version: 0.01.01.0046  
Application firmware version: 1.0.1.12  
DID: VIEW-447348-RJSHS  
IP address: 192.168.10.133  
Http port: 8080  
Mac address: 78A5DD-115D64  
Gateway: 192.168.10.1  
DNS1: 192.168.10.1  
DNS2: 8.8.8.8  
Subnet mask: 255.255.255.0  
If the QR Code is lost or unclear to read, tap here to create QR Code

### 3.1.2 Manually add camera (suitable for outside network)

- 1) Tap  to add camera
- 2) Manually input the camera information.

Tips: DID number can be checked from stickers on the back of the camera. You can check the DID from Wansview app If you have already added the camera on the mobile phone “wansview” app.

- 3) Hit “Add”.
- 4) “Save Success” will appear, click “OK” to close the dialog.

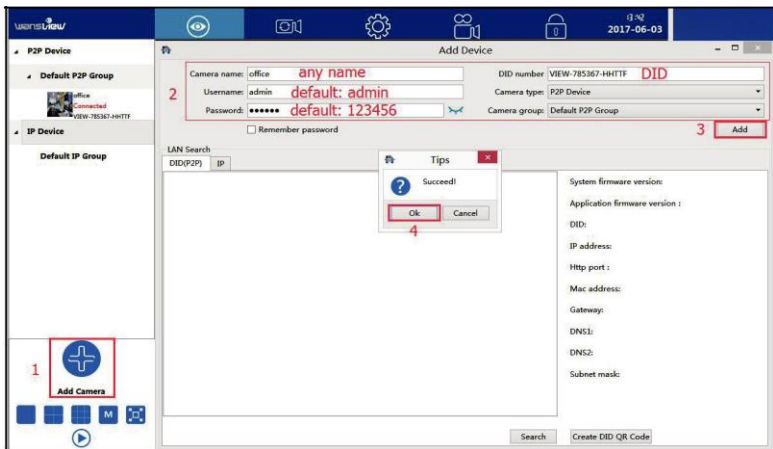

## 3.2 Play/Stop Video

### 3.2.1 Play Video

When the camera is connected, double-click the camera or right-click and choose “Play” to play the video.

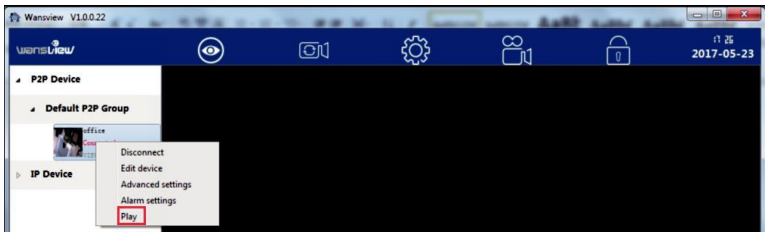

When play the video, but only shows black, please go to Setting  Other Setting to choose the No GPU Display in the Video Display mode.

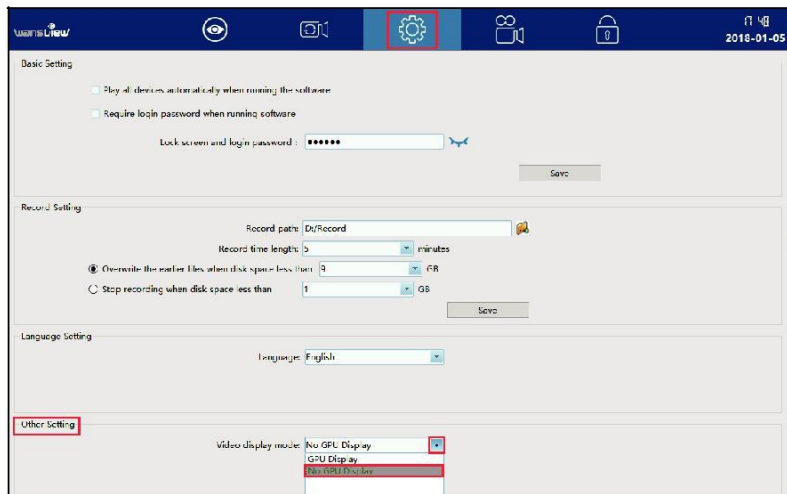

### 3.2.2 Stop Video

Click  to stop the video or right-click the camera and choose "Stop"

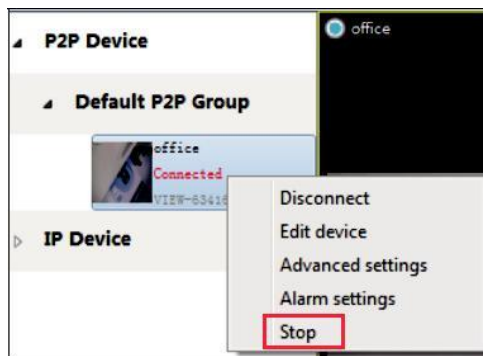

### 3.2.3 Video Interface

Attention: Resolution cannot be adjusted during recording, user needs to stop the recording, then switch the resolution.

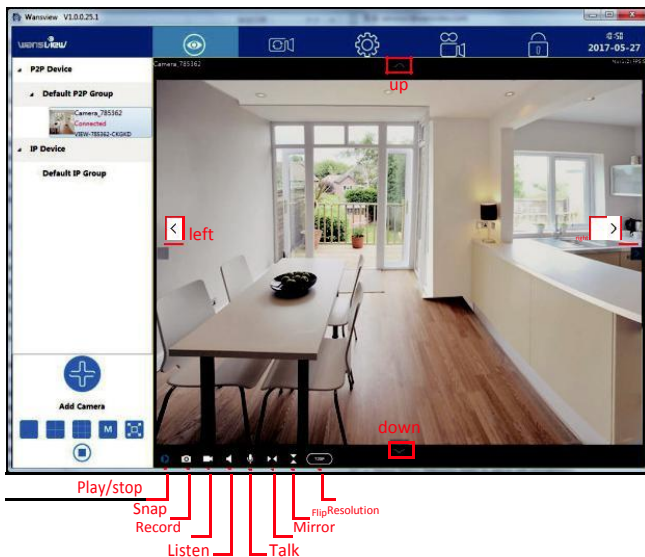

## 3.3 Camera Settings

### 3.3.1 Edit Device

Right-click the camera info and select "Edit Device", here can change the Device Name and Group; and edit the username and password if input wrong or changed; delete the device or Save the parameters you have edited.

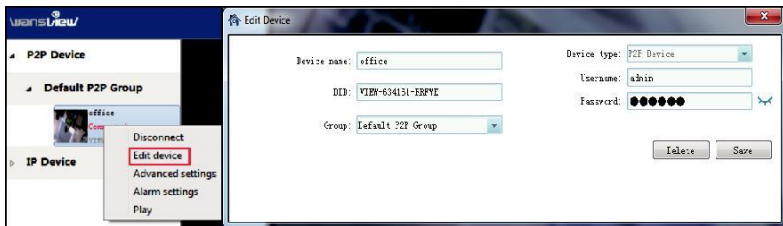

### 3.3.2 Advanced Settings



On the Advanced Settings, user can check camera firmware version, set up time, create other account for operator or Visitor, set up WiFi and SD card recording etc.

#### 3.3.2.1 Device Info

User can check the camera status and Mac address, and check the camera's firmware version.

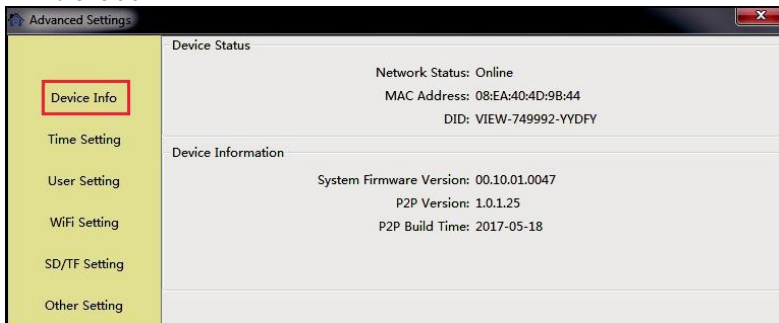

#### 3.3.2.2 Time Setting

User can select a specific time zone, or sync the time to PC or to a NTP Server

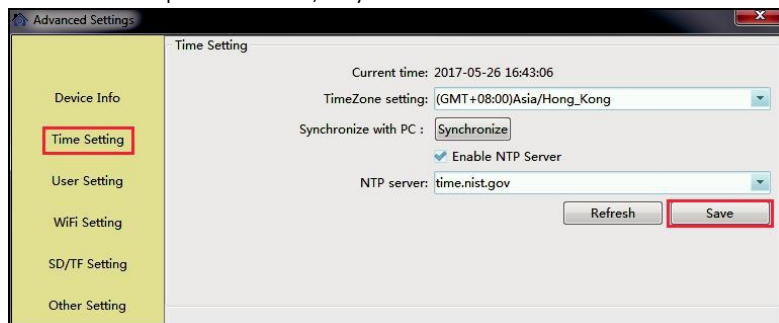

### 3.3.2.3 User Setting

User can create other accounts for family member or friends in User Setting.

Add an account with user name and password, and give a right to this account. Tips:

**Administrator:** All settings can be edited

**Operator:** Can operate all the icons (such as listen, talk, flip/mirror) on the live video page.

**Visitor:** Can only watch live video.

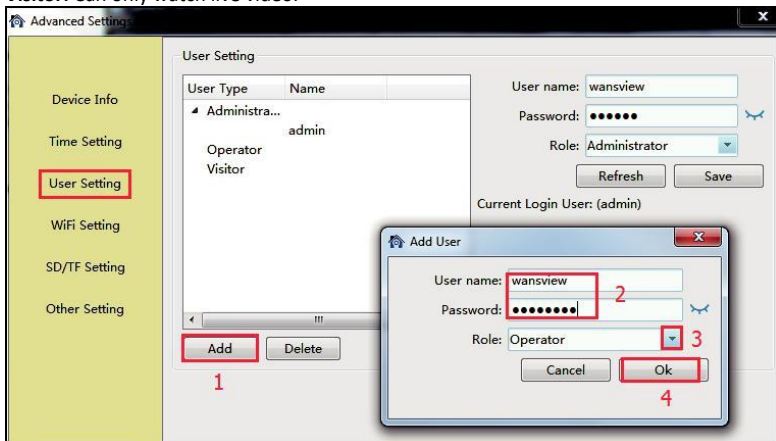

User can also edit the account information, such as change the user name and password and change the role for each account, then Save. And Delete some accounts if you need.

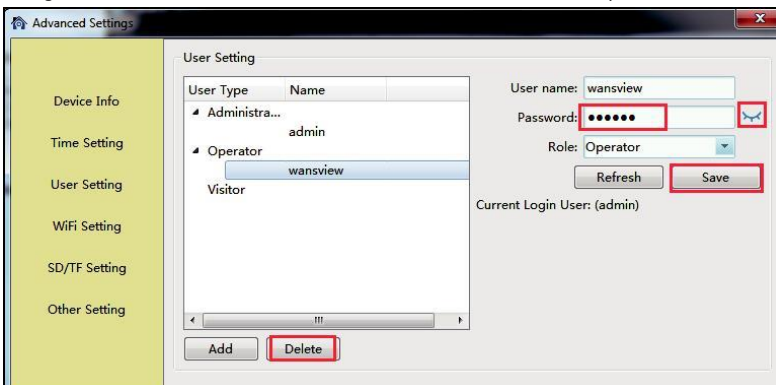

### 3.3.2.4 WiFi Setting

User can set up WiFi for the camera is connected Ethernet cable, or change to other available WiFi.

Search the available WiFi, and choose the one you want to connect, then input the WiFi password (click the icon behind to confirm if the password is correct). Save then Test.

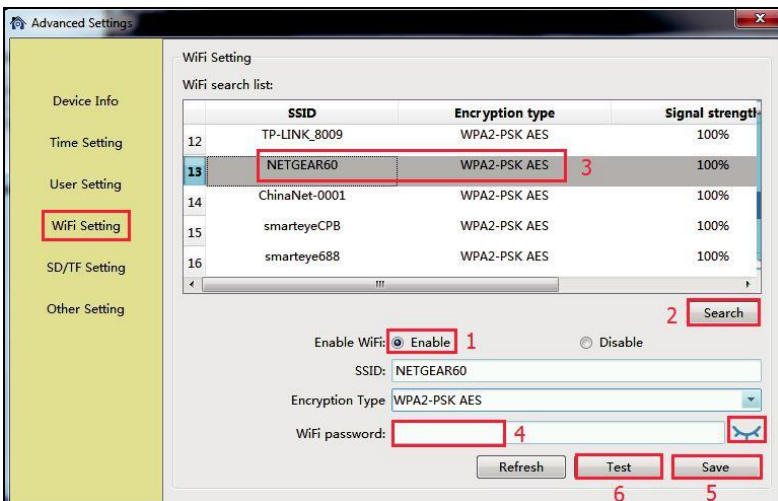

### 3.3.2.5 SD/TF Setting

Open the Plan Record, it will record continuously to SD card, each record length can be set between 2-15 minutes. The video stream can be recorded at 1080p(720p), 480p and 240p.

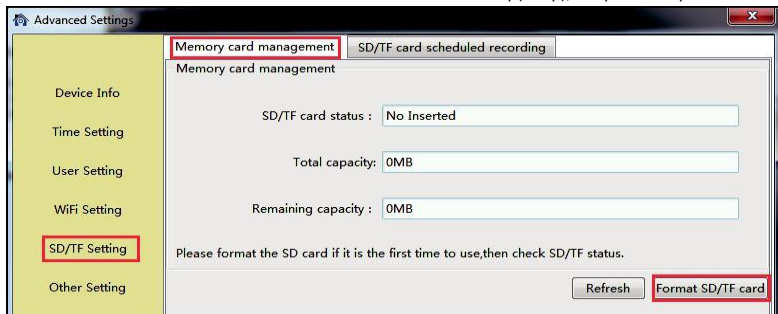

User can record video to SD card.

Before recording, please kindly make sure you have inserted a SD card, and format it.

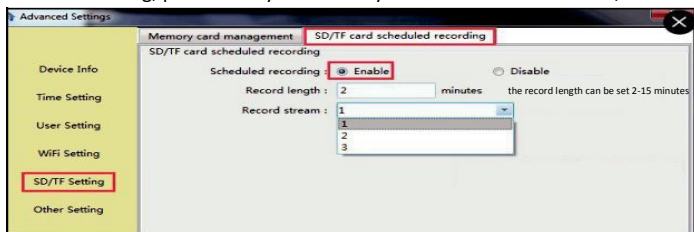

### 3.3.2.6 Other Setting

#### 1) OSD setting

On the OSD setting, users can set up the Overlay name and Overlay time, so user can check name and time on the video screen.

If Overlay name and Overlay time and Display temperature and humidity are checked at the same, the Device name will show Temperature and Humidity. Note: The temperature and humidity are unavailable on this model.

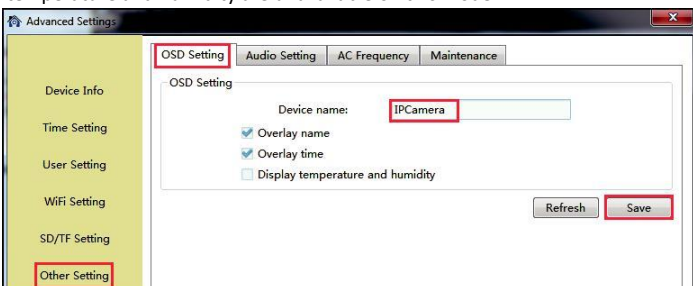

#### 2) Audio

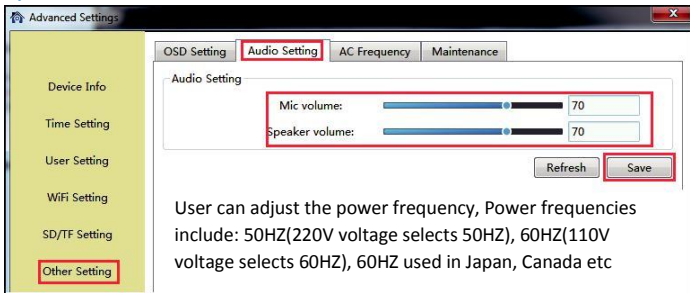

### 3) AC Frequency

User can adjust the power frequency, Power frequencies include: 50HZ(220V voltage selects 50HZ), 60HZ(110V voltage selects 60HZ), 60HZ used in Japan, Canada etc.

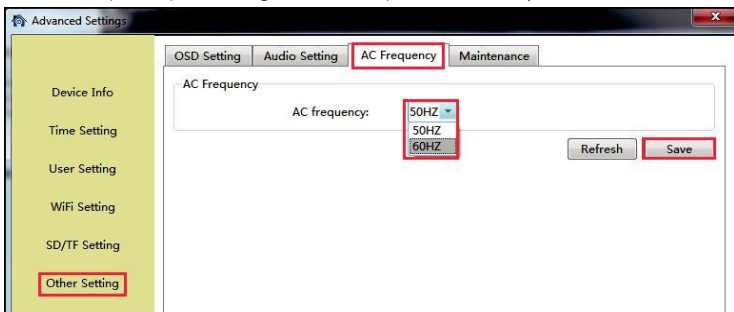

### 4) Maintenance

User can reboot and reset (restore) the camera.

Tips: To reset the camera, the camera will restore to factory setting.

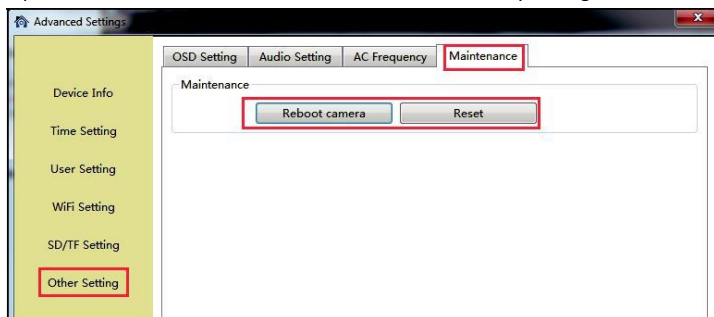

#### 3.3.3 Alarm Setting

In the Alarm Setting, use can set up the Alarm alert.



### 3.3.3.1 Motion Detection

User can set up motion detection area here to narrow the motion detected area to some important places, tick each window, move your mouse to the lower right corner and drag it can adjust the size of the window, and can move it to the needed area.

User can choose the sensitivity from low, middle and high. The high sensitivity will be easy to get alarm.

I/O Detection and Temperature Detection are disabled in this model.

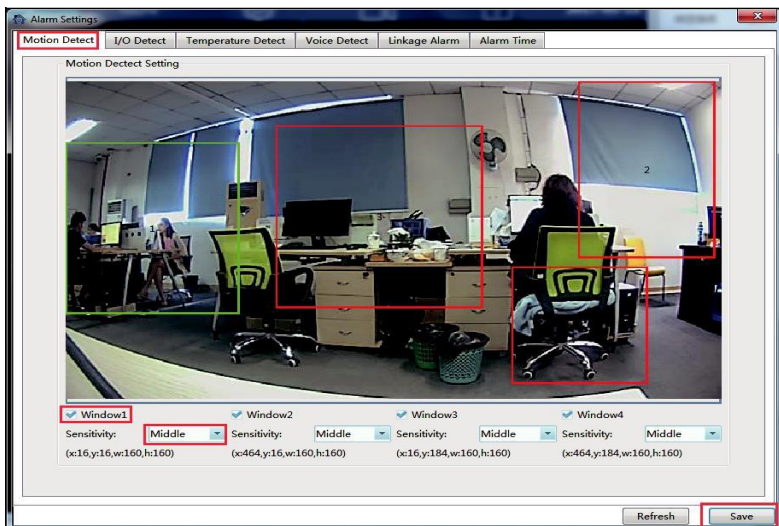

### 3.3.3.2 Audio Detection

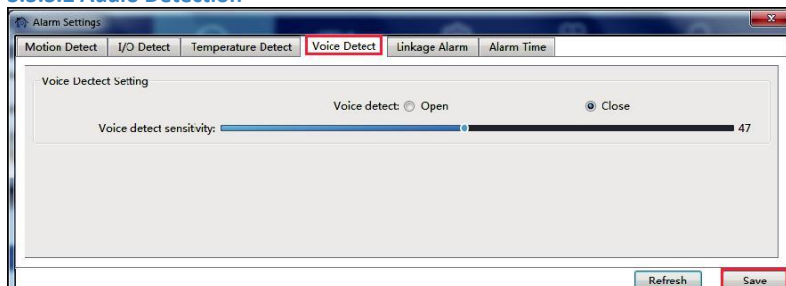

### 3.3.3.3 Linkage Alarm

If user set up alarm, the camera will execute a variety of alarm actions at linkage: snap to email, snapshot and video to FTP, snap and video to SD card.

And if you connect external I/O alarm device, it can trigger alarm too.

Tips: The method of "Trigger Alone" and "Combination Trigger", if the user starts up an audio detection and motion detection, the "Combination Trigger" will be started up.

Only when any abnormality is detected simultaneously by the audio detection and motion detection will the alarm action be triggered.

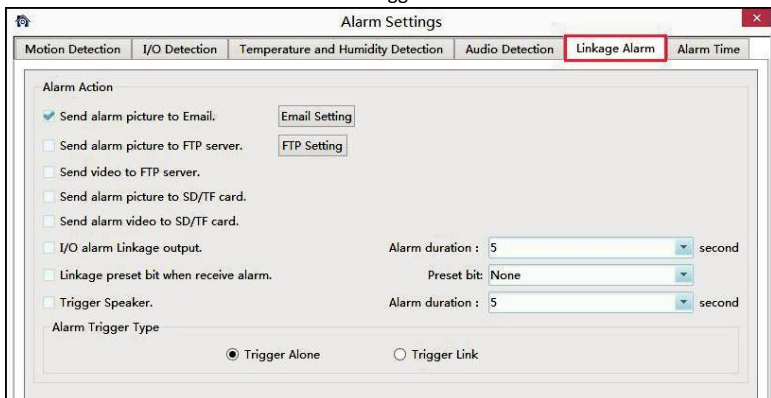

#### 1)Email setting

**Email address:** your email address.

**Email Password:** your email password, if you are using Gmail, please generate an app password, and using the app password. Download a document from our website on how to set up app password.

**Smtp Server:** such as smtp.gmail.com etc.

**Smtp port:** 465 or 587

**Security Type:** SSL

**Sender:** your email address, the same with sender

E-mail subject and content can be any information

**Receiver:** any email address

After all the information are filled in, click "Save" and "Test" the email to see if the email setting is successful or not.

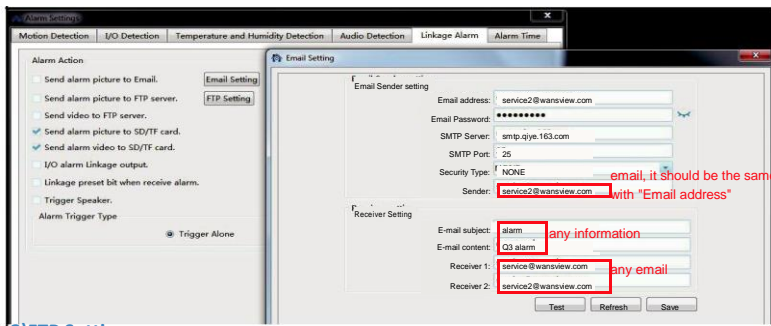

2)FTP Setting  
2)FTP Setting

**FTP Server Address:** This field allows the user to designate an IP address or DDNS address for the FTP server.

**Server Port:** This field allows the user to designate the port number for the FTP server.

**User Name:** Input FTP user name.

**Password:** Input FTP password.

**Path:** Specify a folder for storing video and pictures, for example: ./Q3 alarm

**Note:** If you want to save the alarm picture and video to FTP, you must build an FTP server, then create an FTP account with a password (not an anonymous account) on your FTP server and FTP account must have create and delete file rights.

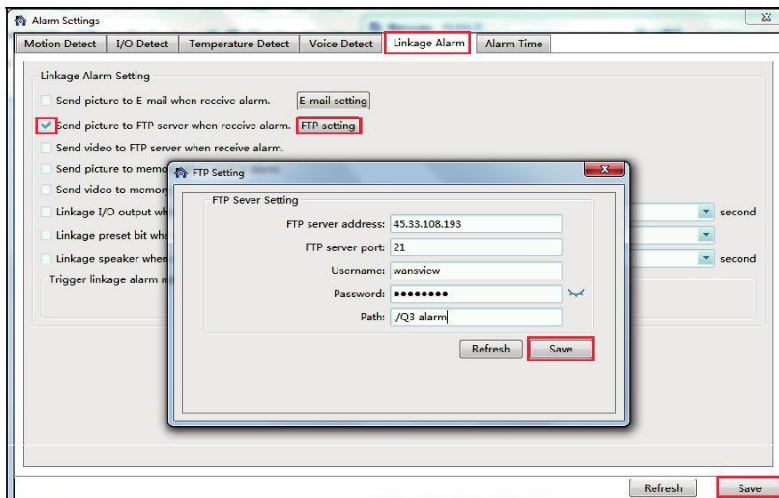

### 3.3.3.4 Alarm Time

After setting the type of alarm and alarm action, please set up the alarm time, the alarm action can only be triggered when armed. The Green color means the time is armed. User can choose "All Time" or "Clear Time", and can also choose a specific time. 15 mintues for a interval. The user can drag the mouse to perform continuous selection of the arming time.

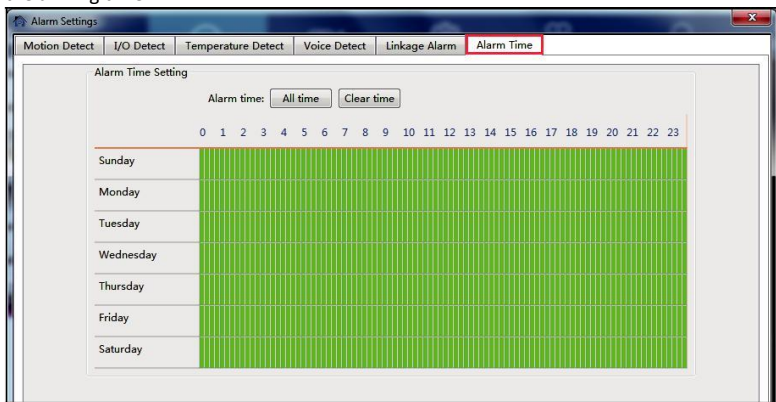

### 3.3.4 Web Access

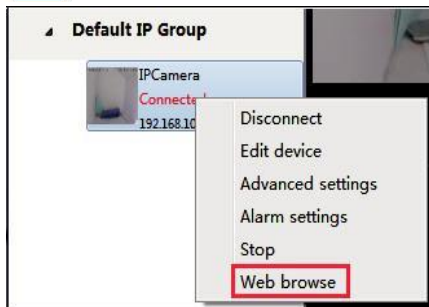

If the camera is added via IP Address, right click and select web access can access the camera with default browser.

Tips: The Edge is not supported, please use Internet Explorer or Firefox or Chrome.

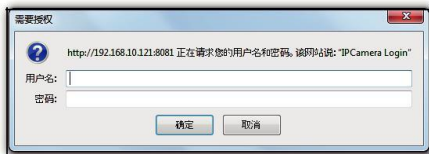

### 3.4 Multi-View

User can monitor multiple cameras at the same time, 4-screen, 9-screen, M(6, 8,16, 25, 36) and full screen can be set up according to different demands

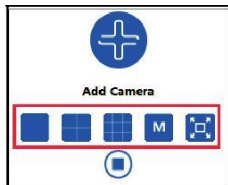

### 3.5 Local Setting

#### About software:

##### Basic setting:

User can set up lock screen password in case you won't let others to see the video.

##### Record setting:

User can set the Record path, and each recorded video can be set from 5-60 minutes.

Recorded video can be overwritten or stopped if the computer disk storage is not enough.

##### Language setting:

The language can be switched from English and Chinese.

More Languages will be added very soon.

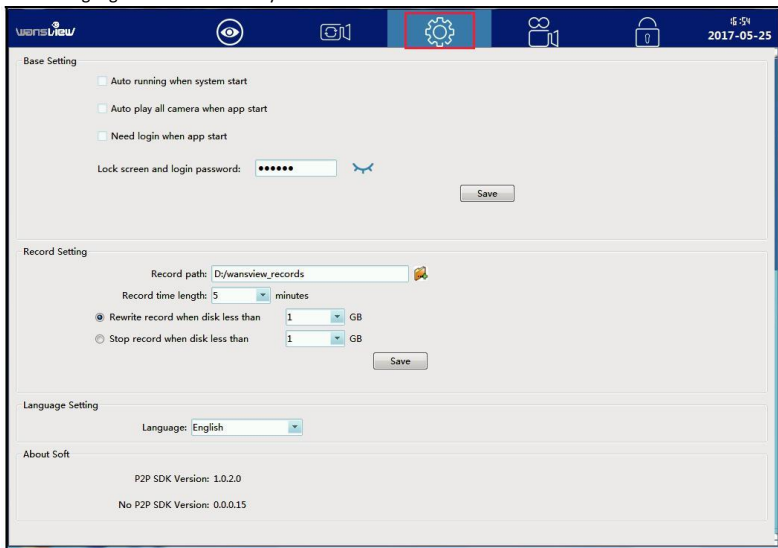

### 3.6 Scheduled Recording

Before recording to your local computer, please make sure you set up the Record Path on the “Local Setting”. Then follow the below steps to set up the recording:

- 1: Click “Create” to create a Record name, it will give you a name automatically (combination of date and time), user can edit the name.
- 2: Select time: User can “select all” if want to record 24/7, and clear it to choose a specific time by dragging or single-click the time interval.
- 3: Save: Save the record name and time interval you set up.
- 4: Double-click the Record name to choose it as the record plan.
- 5: Apply: Click “Apply”, a \* will appear in front of the Record plan, it means the scheduled recording is working.

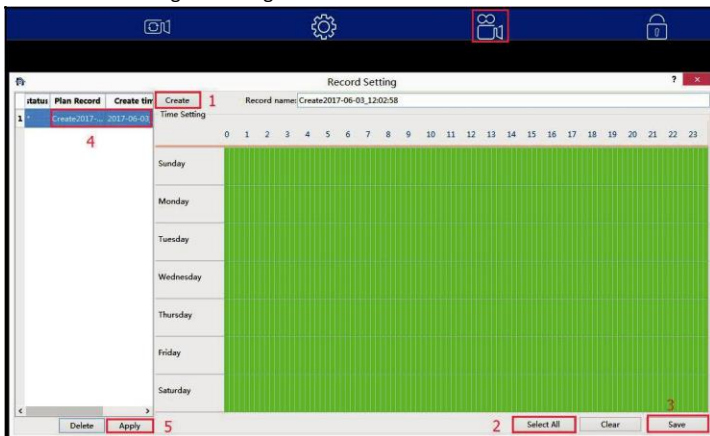

The icon will be shown on live video screen, it means the camera is recording automatically)

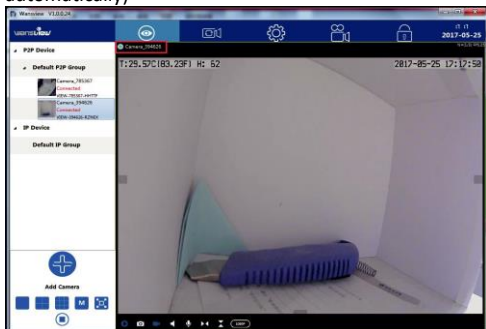

### 3.7 Playback

On “Playback” page, user can playback the recorded videos on the local disk and SD card.

#### 3.7.1 Playback Local Record

- 1) Choose Local Record and selected the camera you want to check.
- 2) Select the Media Type(Video or Image)
- 3) Select the video in an exact date you want to playback
- 4) Recorded video list will be shown (Video starts with “P” for Scheduled Recording, and “H” for Manually Recording)
- 5) Double-click the recorded video name, video will be broadcast.

User can select a certain or all the video and delete it from the list and the record path.

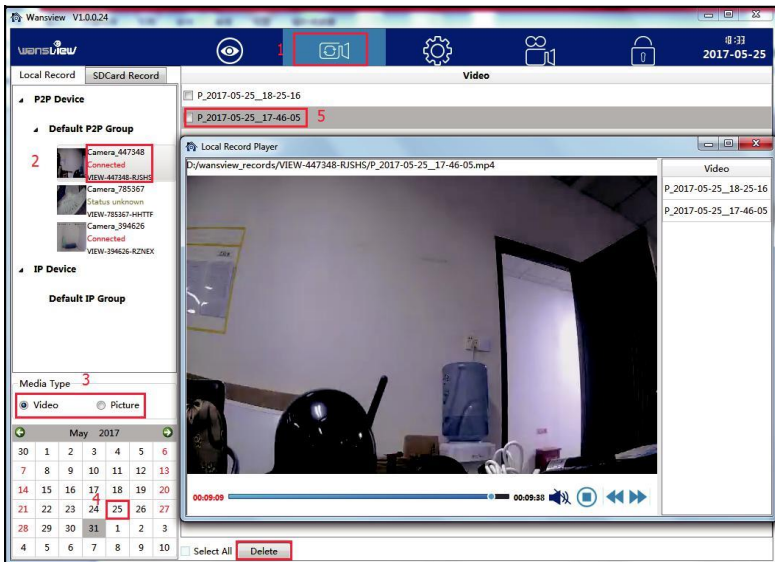

### 3.7.2 SD Card Record

- 1) Choose SD/TF record and selected the camera you want to check.
- 2) Select the Media Type(Plan or Alarm)
- 3) Select the video in an exact date you want to playback
- 4) Recorded video list will be shown, if it is not shown, please tap to show the list (Video starts with “nrc” for Scheduled Recording, and “arc” for alarm Recording)
- 5) Double-click the recorded video name, video will be broadcast.

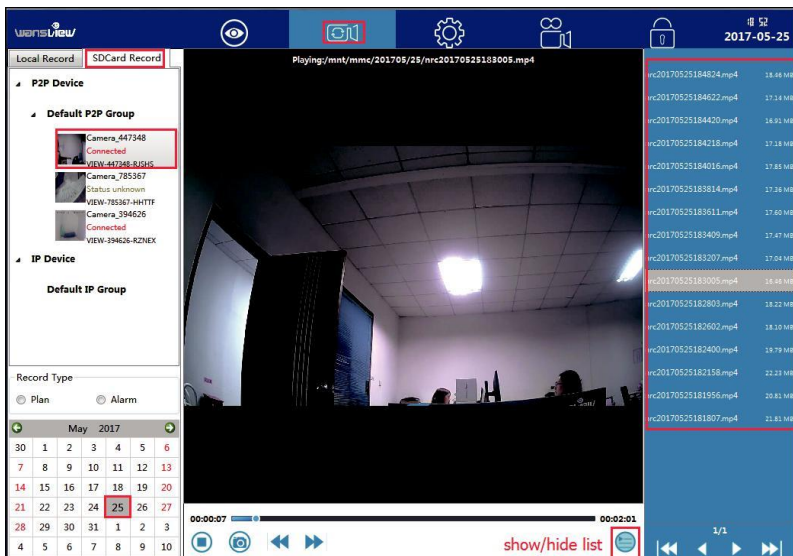

### 3.8 Lock

Lock the screen if you don't want to operate it or prevent others to operate the camera.  
The default lock password is 123456.

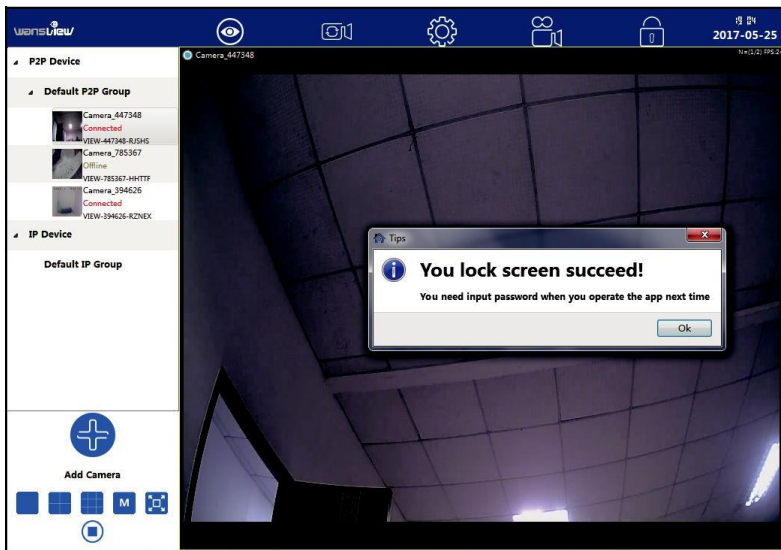

## 4. Manage Camera with other Apps and Software Add Camera to iSpy Connect

### Steps

1. Add IP Camera
2. In the Video Source mask, select the FFMPEG(H2.264) tab
3. In the URL field type: `rtsp://user:password@IP:port/live/ch0` or `ch1` or `ch2`
4. RTSP Mode: select TCP
5. Test
6. Click OK
7. In the following mask, click finish
8. The camera is online

User: your user

Password: your password

IP: your camera's IP (get it from the app)

Port: your camera's port (get it from the app)

### **Add the Camera on Blue Iris**

In IP camera configuration, input:

- IP: the camera's IP address
- HTTP port: camera's port
- RSTP port: default 554
- User
- Password
- Make: Wansview
- Model: K1/K2, NCM GA/GB/630W, Q3S RTSP
- Path: ch0, or ch1 or ch2

Click OK

### **Add the Camera to Sighthound Video**

Set-up with Ethernet Cable - Add Camera by wizard

In camera setup, choose:

Camera Type: network IP Camera

Manufacturer: Other

Click Next

Choose: setup Sighthound video with a network camera that is already working Click Next

Select your camera by the IP

Click next

Input User and Password

Follow the wizard

### **Add Camera by RSTP**

In camera setup, choose:

Camera Type: network IP Camera

Manufacturer: Wansview

Click Next

Select Camera Type: other IP camera

Protocol: RSTP

IP address:

RSTP port: 554

Stream Path: live/ch0

Input user and password

Click Next.

## 5. Web Access

### 5.1 Settings

To view your camera in any web browser you'll need the camera's IP address and camera's Port.

If your computer is in the same network, just type the address in browser address bar: http://IP:PORT for example http://113.116.100.223:80. Users can get these data from the app > advanced settings > about camera.

If your computer is located outside the network where the camera is installed, users need to input manually the camera's IP in the router in the Port Forwarding Section (please consult your router user guide or search on line) to view the camera.



#### 5.1.1 Plugin installation



The Camera has 2 view mode:

**View Mode 1** supported by an OCX Plugin (HYPlayer.exe)

**View Mode 2** supported by an Adobe Flash Player Plugin

### 5.1.2 View Video-Mode 1 - Complete Camera Management



Click on Download Plugin to download and install the OCX Plugin-HYPlayer plugin.

Note: If you use Google Chrome or Firefox you need to install the IE tab:  
 -Firefox > Add-ons > Extensions. Search for IE Tab and install.  
 -Chrome > More Tools > Extensions. Search for IE Tab and install.

### 5.1.3 View Video- Mode 2 – Limited Camera Management

This view is supported by the Adobe Flash Player plugin and if is not installed, the browser will prompt to download and install the plugin.

In the Flash Player mode, users have less functions. Microsoft Edge is not supported.

## 5.2 Live Streaming and Recording on PC

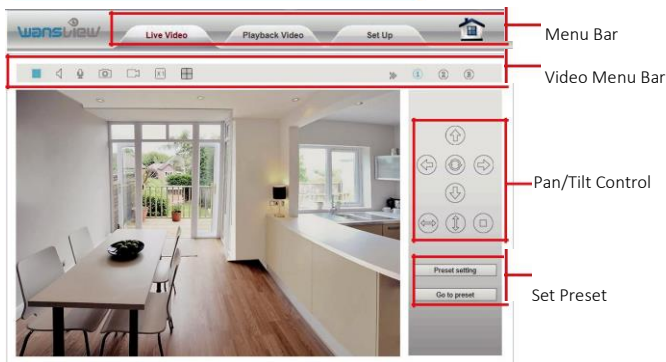

**Play/ Stop:** Play and stop video.

**Listen:** If your PC is equipped with speakers, click here to listen from your camera. (function disabled in this model)

**Talk:** Activate the Talk function. A microphone is needed in your PC. Adjust volume under Set up > Video&Audio >Audio. (function disabled in this model)

**Snapshot:** Capture live images and save to PC. Set folder for the snapshots in Setup > Local Configuration.

Snapshots format is JPG.

Record: Record and save to PC.

Digital Zoom

Show/Hide Control Panel.

Resolution: Choose 3 resolutions 1920x1080 / 640x360 / 320x180



Use the control panel to pan and tilt your camera's head. Click or to move camera's head horizontally or vertically. Stop camera movement and it will go to the initial position.(function disabled in this model)

Preset setting			
1	2	3	4
5	6	7	8

Set up to 8 camera preset spots, as explained above in the App Section.(function disabled in this model)

Go to preset			
1	2	3	4
5	6	7	8

### 5.3 Playback Video(function disabled in this model)

Click "Playback Video" to enter the SD card video file playback page. Click the video date to inquire. Click "Search" to list the video files of the selected day. Click listed files to playback. Download files on PC with the download button.

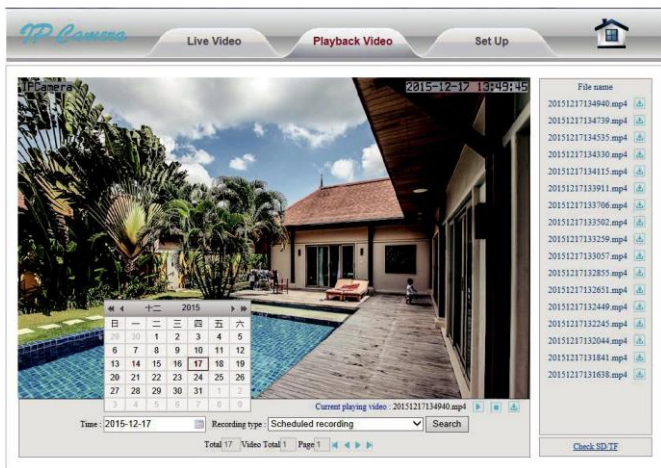

The screenshot shows the 'Playback Video' interface. At the top, there are tabs for 'Live Video', 'Playback Video', and 'Set Up'. The main area features a video player showing a poolside scene. A calendar for December 2015 is displayed over the video, with the 17th highlighted. Below the calendar, the 'Current playing video' is identified as '20151217134940.asp4'. A search bar is present with the text 'Time: 2015-12-17' and 'Recording type: Scheduled recording'. A list of video files is shown on the right, each with a download icon. The files are named with their timestamps, such as '20151217134940.asp4' through '20151217131638.asp4'. At the bottom, there are navigation controls for the video list, including 'Total 17', 'Video Total 1', and 'Page 1'.

## 5.4 Set Up

### 5.4.1 System System > Status

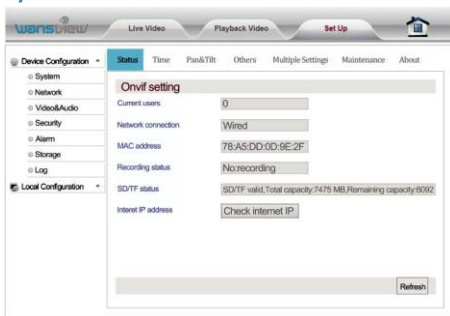

Data about the current Camera Status

### System > Time Setting

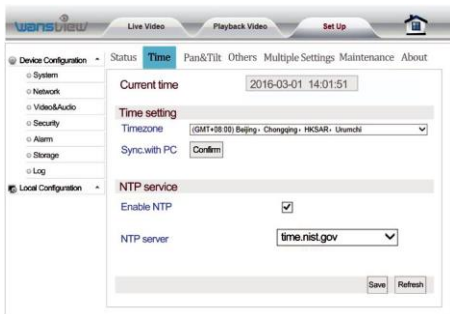

Users can choose to sync time to the PC or to a NTP server.

### System > Pan & Tilt

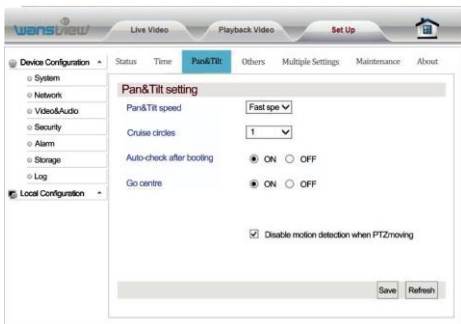

Users can set the pan/tilt speed (fast/medium/slow) and cruise circles.

Users can disable motion detection when the camera pan or tilt.

## System > Other Settings



Turn off Led indicators  
at your choice.

## System > Multiple Settings

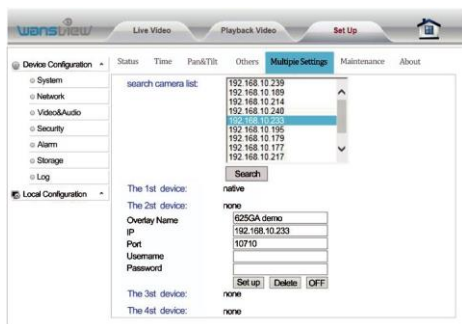

Add up Cameras for multiple 4  
view. Get their IP and Port,  
Input User and Password.  
Name them.

## System > Maintenance

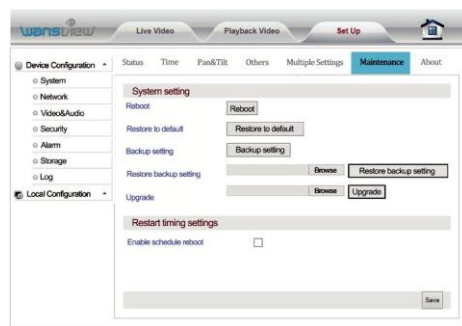

In System Maintenance  
users can reboot /restore  
to default /backup/upgrade  
camera.

## System > About

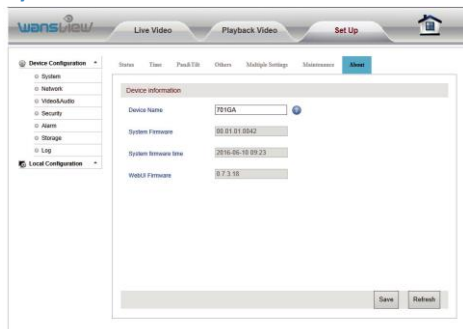

In System About users can check the latest camera's firmware which can be downloaded at [www.wansview.com](http://www.wansview.com).

### 5.4.2 Network

These functions are meant to be managed by technical specialist except for FTP Server Settings and SMTP Settings. Contact our friendly customer service for specific technical **Network > IP setting**

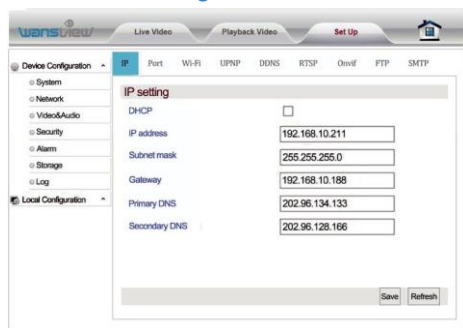

You can set the camera IP address by your router(DHCP) or you can manually set a fixed address.

- IP address (for example 192.168.x.x)
- Subnet mask(for example 255.255.255.0)
- Gateway(IP address of your router; for example 192.168.x.1)
- Primary DNS(IP address of your router; for

example192.168.x.1)

-Secondary DNS(IP address of your router; for example192.168.x.1)

## Network > Port setting

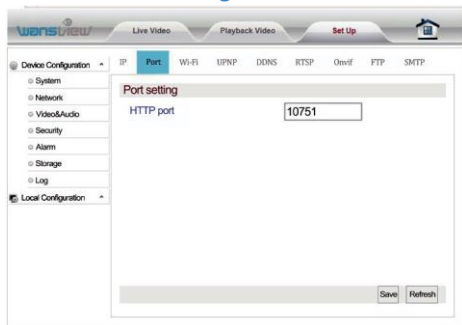

At "Port Setting", the user can change web access port (http port). Port setting range: 80-65535. Pay attention not to conflict with other port values.

## Network > Wi-Fi setting

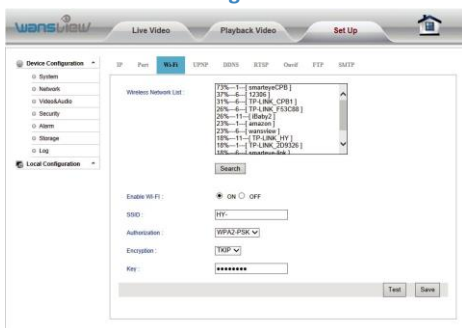

At "Wi-Fi Set Up", click "Search" and start up "Wi-Fi". Choose the wireless router to be connected. Input the password to connect to the router. Click Save to complete Wi-Fi Configuration. After completing the configuration, click Test to confirm whether it is connected to the wireless router.

## Network > UPNP setting

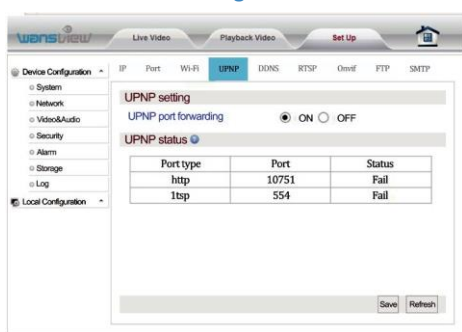

If the user wants to view the camera through the internet, the router and camera UPNP port forwarding function need to be turned on.

Before auto port mapping, please ensure your router supports UPNP and has been enabled.



## Network > Onvif setting

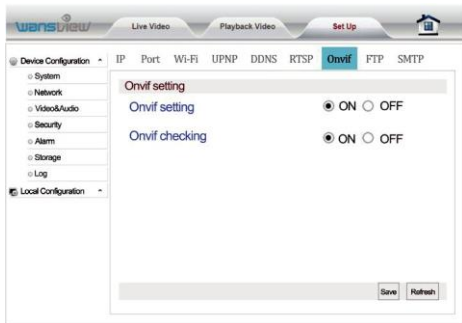

Onvif is a global standard for the interface of IP-based security products. The ONVIF protocol ensures interoperability between products regardless of manufacturer, allowing you to integrate your IP camera as a generic ONVIF camera into existing security systems. Enter Onvif Setting. The user can start up and calibrate Onvif functions. The default setting for Onvif calibration is on.

Note: NVR devices of some manufacturers do not support camera access with Onvif calibration. Our device supports Onvif versions 2.5 and below.

## Network > FTP Settings



**FTP Server Address:** This field allows the user to designate an IP address or DDNS address for the FTP server.

**Server Port:** This field allows the user to designate the port number for the FTP server.

**User Name:** Input FTP user name.

**Password:** Input FTP password.

**Path:** Specify a folder for storing video and pictures, for example: /NCM751GA

Note: If you want to save the alarm picture and video to FTP, you must build an FTP sever, then create an FTP account with a password (not an anonymous account) on your FTP server and FTP account must have create and delete file rights.

## Network >SMTP (E-mail) Setting

To get started, make sure that your e-mail provider supports SMTP. Then input required parameters. Mainstream E-mail suffixes supported by SMTP include: smtp.gmail.com, mail.yahoo.com, smtp.gmx.com, smtp-mail.outlook.com. Take gmail setting as an example. Server address: SMTP stands for Simple Mail Transfer Protocol. This field allows the user to enter

the SMTP server used by the email service.

**Server Port:** This field allows the user to enter the port that corresponds to the selected SMTP server. The SMTP port is usually set at 25 if there is no security. Some SMTP servers have their own ports, such as 587 or 465. Specific port number is determined by mail service provider.

**Security connection:** This dropdown box allows the user to select an encryption type.

**User name:** Input email address.

**Password:** Input APP password. APP password allows 2 steps verification in your Gmail account. Click Profile>Account>Sign-in &Security to create App password.

**Sender Address:** This field allows the user to enter the email address to which alarms are sent. This email address should be consistent with the above Email address for the User name.

**Receiver Address #1&#2:** These fields allow the user to enter the receiver email address which will receive any emails pertaining to alert and alarm emails.

**Mail subject:** This field allows the user to define the subject line of the email.

**Mail content:** This field allows the user to define the mail content.

### 5.4.3 Video and Audio

#### Video and Audio > Video

Users can set the exact AC Frequency.

**Bit stream settings include:** Resolution(1920\*1080 or 1280\*720), Bit rate (256~4096kpbs), Frame rate (1~30fps)

## Video and Audio > Audio Setting (function disabled in this model)

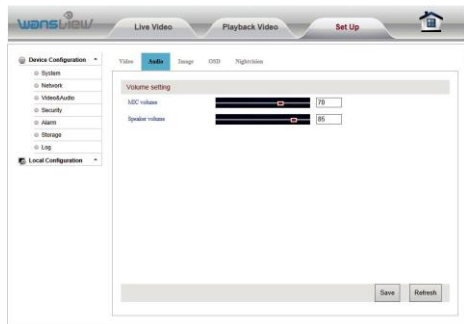

Here you can adjust Microphone and Speaker volume

## Video and Audio > Image Setting

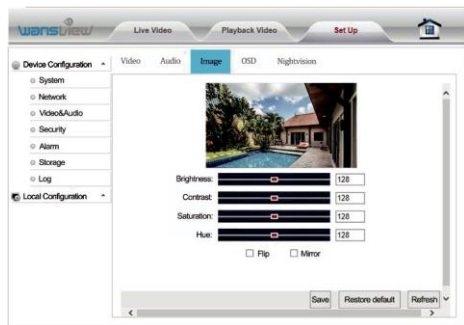

Here you can adjust the image parameters brightness, contrast, saturation and hue. You can also flip and mirror the video image when tick the options.

## Video and Audio > On Screen Display Time and Camera Name

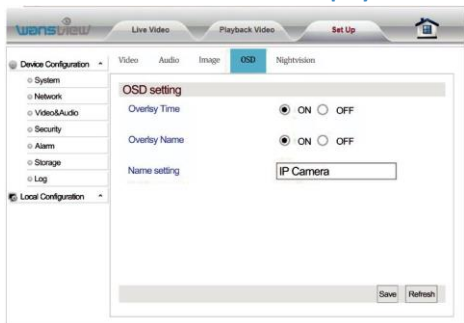

Enter "OSD Setting" to overlay the time and name on the video image.

## Video and Audio > Night Vision

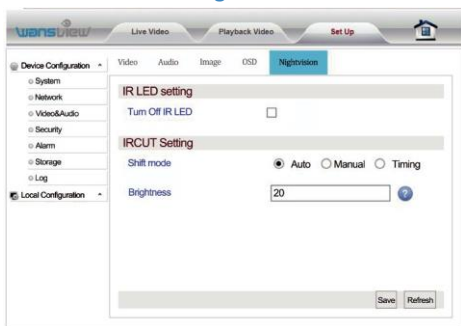

Enter "Night Vision Setting" to set IR LED and IRCUT. Once IR LED is off, the IR LED IR cut will not work any longer.

### 5.4.4 Security

To modify /add /delete administrator operator and viewer can be set in this page. (add up to 8 viewers and set rights in total).

**Reminder:** After the operation, click Save. Then click Refresh so that the edited content will be displayed on the web page.

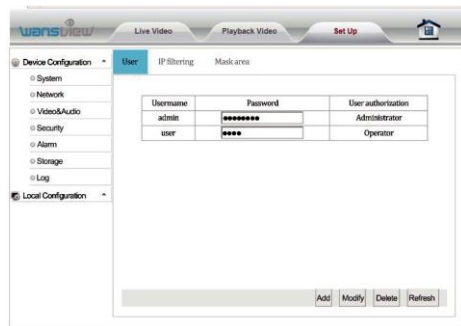

## Security > IP Filtering

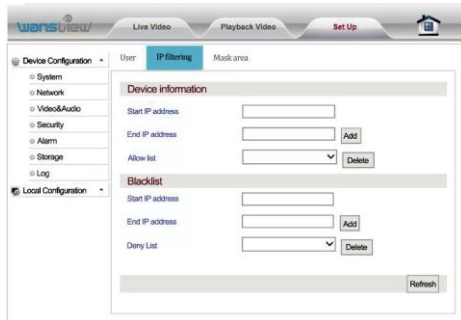

This screen allows for the filtering of IP addresses, either blocking them or granting them access to the camera.

This feature helps make the camera more secure by limiting remote access only to approved users. Below is a Screen shot of the IP Filtering screen.

## Security > Mask Area (not available for MAC users)

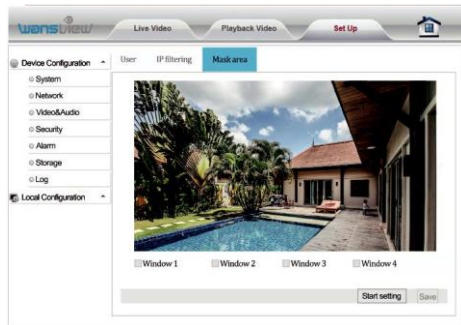

Users exclude up to 4 areas from monitoring.

Click Start Setting and check the windows.

## 5.4.5 Alarm - Motion and Audio Detection Alarm > IO Detector (disabled in this model)

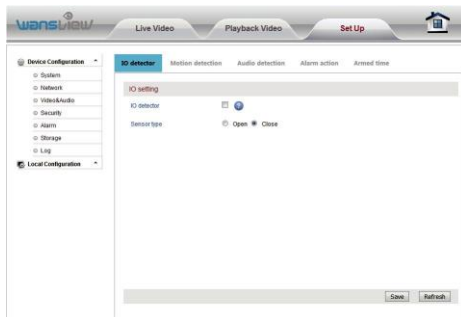

Camera allows user to add an external source of alert (motion sensor or push button). We recommend the Instar IN-500 PIR Sensor as external motion sensor.

The external sensor can be always open or always close. Please check your alarm device setting in the user guide.

## Alarm > Motion Detection (Intruder Monitor)

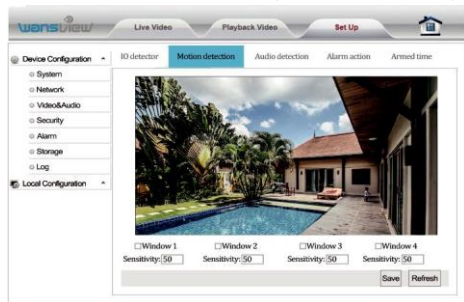

The Motion Detection in the Web Interface is more advanced than in the App. User can set up to 4 detection areas and different sensitivity. 15 corresponds to the lower level and 55 to the mid-level. The IP Camera begins recording when it detects movement/audio and stops recording in 30 sec. In this section, users can customize the motion detection feature. This feature can be set on the app or in the web interface. Motion is detected by changes in the pixels of

the images.

Please note that motion detection doesn't work through windows. In this case we recommend to connect an external motion sensor out of the window using the IO alarm port.

## Alarm > Audio Detection (Baby Monitor)(function disabled in this model)

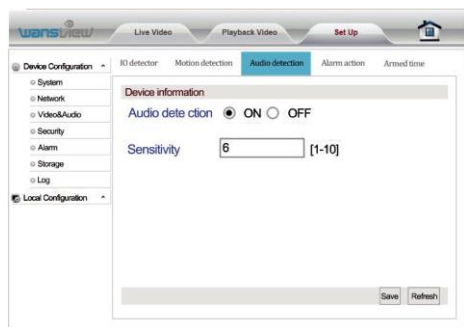

## Alarm > Alarm Action

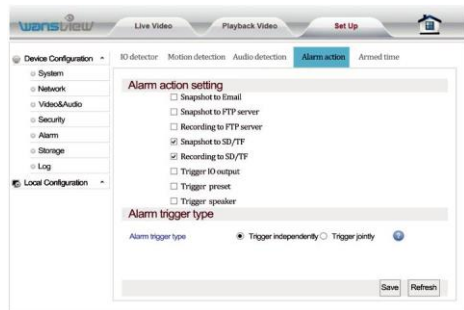

Once the alarm is set, users will receive a notification on the smartphone (only Android) if the app is running on the background and can choose to get:

**Snapshot to Email:** When an alarm is detected, the camera will send three pictures to the email box. Users can set up to 2 recipients.

Click Mail Setting to setup the email. Check your email provider for SMTP Server and

Port. **Snapshot to FTP server:** When an alarm is detected, the camera will send 2 pictures to your FTP server. Click on FTP Setting to setup FTP.

**Recording to FTP server:** When an alarm is detected, the camera will send a 15 sec video to your FTP server.

**Snapshot to SD/TF:** When an alarm is detected, the camera will send 2 pictures to the SD card (function disabled in this model).

**Recording to SD/TF:** When an alarm is detected, the camera will send a 30 sec video to the SD card (function disabled in this model).

**Trigger IO Output:** User can add a siren or another alarm device to the camera (wired). When an alarm is detected, the external IO output will work. Users can choose alarm duration from 5 to 30 sec (function disabled in this model).

**Trigger Preset:** When an alarm is detected, the camera will focus on one of the 8 Preset spots (see above) (function disabled in this model).

**Trigger Speaker:** When an alarm is detected the speaker will act as a siren for the chosen length (5-30sec) (function disabled in this model).

**Trigger independently:** The alarm will be triggered for any kind of active alarm event (Motion/ Voice/IO).

## Alarm > Armed Time

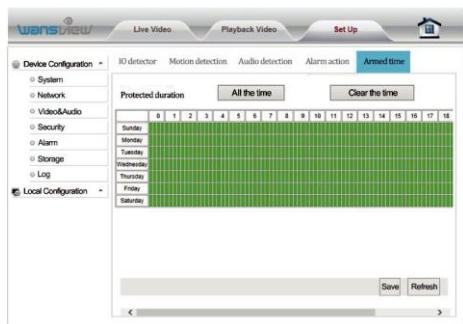

By default alarm is armed 24h/7 days. Users can choose specific days and time ranges.

## 5.4.6 Storage(function disabled in this model) SD Card Management

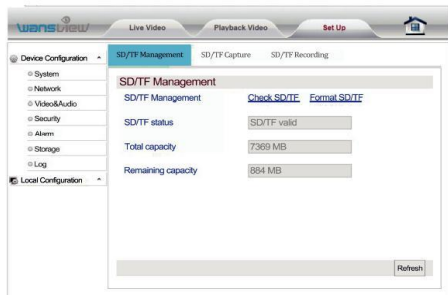

If the card is not readable, please kindly Format the SD card.

### Storage > SD card Capture (Timed Snapshots)

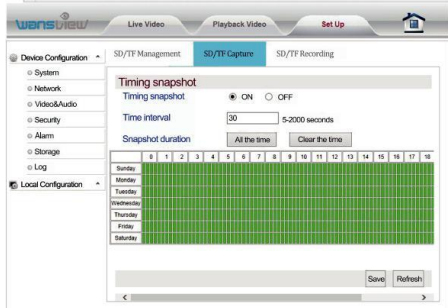

Take Timed snapshots and save them on the SD card

### Storage > SD Card Scheduled Recording



Schedule recording and store them on SD card. Set the time span of each recording. Choose the resolution/bit rate.

Reminder: The system default is automatic overwriting for the SD card video. If the storage space is full, the new video will automatically overwrite the earliest video file.

## 5.4.7 Log

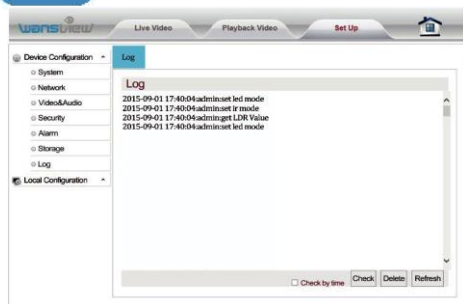

## Log &gt; Local Configuration (not available for MAC users)

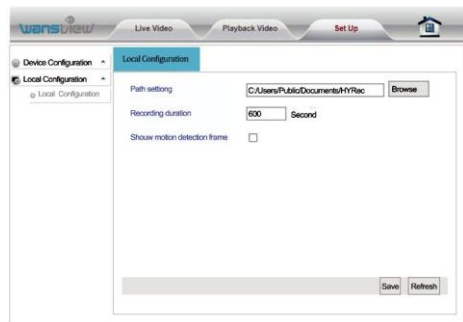

Enter "Local Configuration". You can set the save path for videos and pictures on your PC as well as the recording duration.

Reminders:

6: When using IE9 or higher, please run the browser video path and picture path as "administrator" so that you can save the files successfully. The default video path is "HYRec" on disk C. The default picture path is "HYSnap" on disk C.

7: The user can start up the Motion Detection Alarm and view the flashing box on the screen.



[www.wansview.com](http://www.wansview.com)