

evenflo®

Nurture™ Infant Car Seat

Owner's Manual

Keep for future use

Rear-facing

2.3 to 10 kg
(5 to 22 lbs)

48 to 74 cm
(19 to 29 in.)

* See page 2
for complete
requirements.



Para instrucciones en Español,
llamar al: 1-800-233-5921

! WARNING:

To reduce the risk of serious injury
or death, read this owner's manual prior
to installing and using this child restraint.

More children are killed every year as passengers in car crashes than by any other type of injury.

To reduce the risk of **SERIOUS INJURY** or **DEATH**, read this owner's manual and your vehicle owner's manual before installing and using this child restraint. Using a child restraint makes a big difference. By properly using this child restraint and following these instructions (and the instructions that accompany your vehicle), you will greatly reduce the risk of serious injury or death to your child from a crash. Do not be misled by the commonly used term "safety seat"; no restraint system can prevent all injuries in all crashes. Many properly restrained adults and children are injured in motor vehicle crashes, including relatively minor crashes. A properly used child restraint is the best way to minimize injuries to your child and to increase the chances for your child's survival in most crashes.

U.S. REGULATORY NOTICE

This child restraint meets all the requirements of Federal Motor Vehicle Safety Standard 213.

CANADIAN REGULATORY NOTICE (MODEL NUMBERS ENDING IN "C")

This child restraint meets all the applicable requirements of Canadian Motor Vehicle Safety Standard CMVSS 213.1.

Symbol Legend



Airbag Symbol – Alerts you to important information about airbag safety.



LATCH Symbol – Alerts you to important information about LATCH safety.



Aircraft Symbol – Alerts you to important information about aircraft safety.



Table of Contents (TOC)

PREMATURE INFANT USE.....	3
Warnings	4
LATCH Warnings.....	7
Recall Information for U.S. Customers.....	10
Public Notice for Canadian Customers.....	10
Motor Vehicle/Aircraft Usage	10
Storing Your Instructions.....	11
Visual Glossary	12
Child Restraint Features	14
Using the Nurture Handle.....	16
Proper Installation WITH the Base	
Installing the Convenience Base with the Lower Anchor Connector Assembly System.....	20
Installing the Convenience Base with the Vehicle Seat Belt.....	22
Placing the Carrier in the Base	24
Releasing the Carrier from the Base.....	25
Proper Installation WITHOUT the Base	
Installing the Carrier Without the Convenience Base ...	28
Securing the Child in the Carrier.....	31
Removing the Child from the Carrier	33
Changing the Harness Position	34
Changing the Crotch Strap Position.....	36
Removing the Lower Anchor Connector Assembly System	37
Using the Locking Clip.....	38
Using as an Infant Carrier.....	40
Canopy Installation	41
Securing Your Child Restraint in Aircraft.....	43
Installing Child Restraint Rear-facing in Aircraft	43
Care and Cleaning	46
Replacement Parts	47
Limited Warranty	48

CHILD REQUIREMENTS

Warning: Failure to follow these Child Requirements could result in serious injury or death.

This child restraint is designed for use by children in **rear-facing** orientation only. To use this child restraint properly, children **MUST** meet the size and age requirements below. In addition, Evenflo recommends consulting with your child's physician before allowing your child to transition from a **rear-facing** to **forward-facing** child restraint.

The American Academy of Pediatrics (AAP) recommends keeping children **rear-facing** until 2 years old or until they reach the maximum height or weight for their child restraint in **rear-facing** orientation. Additionally, some states' laws require children to be **rear-facing** until age 2. Accordingly, you will see this guidance reflected in the Child Requirements below. Please review any applicable local, state or provincial laws related to child passenger safety before installing and using this child restraint.

Rear-facing

- 2.3 to 10.0 kg (5 to 22 lbs)
- 48 to 74 cm (19 to 29 in.) and top of child's head is at least 25 mm (1 in.) below the top of the child restraint seat back.

IMPORTANT: Once your child **exceeds** any of the size requirements above, they **MUST** discontinue use of this child restraint.

PREMATURE INFANT USE

Before using this child restraint for preterm or low birth weight infants, ensure the Child Requirements are met and follow the guidelines in this section.

According to the U.S. National Highway Traffic Safety Administration, a properly installed child restraint reduces the risk of death by over 70 percent for infants involved in crashes. Federal Motor Vehicle Safety Standard (FMVSS) 213 establishes design and dynamic performance requirements for child restraint systems. However, the standard has no minimum weight limit and does not address the special medical needs of preterm or low-birth weight infants. To ensure that preterm and low-birth weight infants are transported safely, the guidelines published by the American Academy of Pediatrics (AAP) in Pediatrics 2009; 123:1424–1429 must be followed.

All children should ride rear-facing in the vehicle as long as possible. Preterm and low-birth weight infants are at additional risk of breathing difficulties and heart problems when placed in a child restraint. Evenflo requires that the evaluation recommended by the AAP be conducted for all infants born earlier than 37 weeks and all newborn infants who weigh less than 5 pounds at birth before their first car trip to check for breathing difficulties or heart rate problems when traveling in a rear-facing child restraint.

The AAP recommends that appropriate hospital staff observe your infant in the child restraint for a period of 90 to 120 minutes or the duration of travel, whichever is longer. This period of observation must be performed with the infant properly positioned as described in these instructions and with the child restraint placed at an angle that is approved for use in the vehicle. The hospital staff will check for any breathing difficulties or heart rate problems. Your child's pediatrician will let you know if there are any special considerations for travel. The number of trips and the duration of time the infant is seated in the child restraint should be minimized. A caregiver should ride in the back seat to monitor the infant during travel.

You can learn more about the AAP's recommendations for observation of newborns and the guidelines for safe transportation of preterm and low-birth weight infants, as well as other resources for parents and medical professionals, at

<https://www.healthychildren.org/english/safety-prevention/on-the-go/Pages/default.aspx>

⚠️ WARNING

General Warnings

- Failure to follow the Child Requirements for use of this child restraint could result in serious injury or death. (See page 2 for Child Requirements).
- Child Restraints should be used only for travel. Potential adverse health effects from excessive use of infant child restraints have been documented. You should limit the time spent each day in a child restraint as much as possible. You must never use your child restraint as a sleeping environment in the home. Never leave your infant unattended in a child restraint in or out of the vehicle.
- Failure to follow installation instructions and the instructions and warnings on the product can result in your child striking the vehicle's interior during a sudden stop or crash. Serious injury or death may result. These instructions and the instructions in your vehicle owner's manual must be followed carefully. If there is a conflict between the two, the vehicle owner's manual regarding child restraint installation must be followed.
- This child restraint **MUST ALWAYS** face the rear of the vehicle. Serious injury or death can occur.
- **NEVER** leave child unattended.
- **DO NOT** use child restraint if it is damaged, broken, or missing parts.
- **DO NOT** use this restraint if it has been involved in a crash. It must be replaced.
- **DO NOT** attach additional padding, toys or other devices not made by Evenflo, or described in these instructions, to the child restraint. Items not tested with the child restraint could injure the child.
- Be sure that the handle is firmly locked in *Position 2* (Carry) before lifting the child restraint (see pages 16-17).
- This child restraint must be securely belted to the vehicle at all times, even when unoccupied. An unsecured child restraint may injure someone if a crash occurs.

⚠️ WARNING

Air Bag Warnings

- **DO NOT** use this restraint in the front seat of a vehicle equipped with an air bag. Interaction between a rear facing restraint and air bags may cause serious injury or death. If your vehicle has an air bag, refer to the vehicle owner's manual for child restraint installation.
- If the rear seat of your vehicle is equipped with side air bags, refer to the following information for proper usage:
Vehicles built prior to the 2002 model year:
DO NOT use this restraint in a vehicle seating position equipped with a side air bag unless authorized by the vehicle manufacturer.
Model year 2002 and newer vehicles:
Refer to your vehicle owner's manual before placing this restraint in a seating position equipped with a side air bag.
- **DO NOT** place any objects between the restraint and the side air bag, as an expanding air bag may cause the items to strike your child.

The forward-facing rear seat is the safest place for children 12 and under.

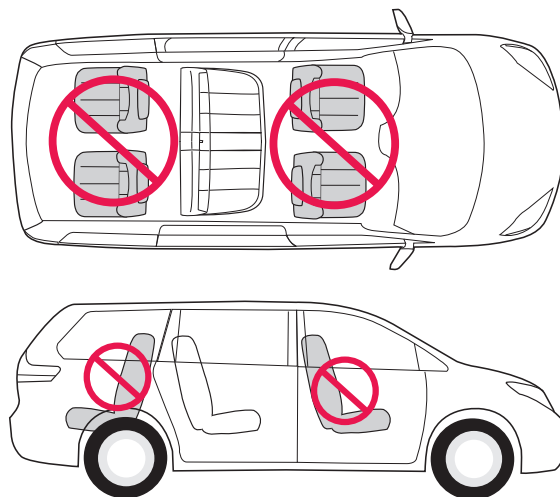

⚠ WARNING

Location Warnings

- **ALWAYS** read and follow exactly the instructions that accompany your vehicle and child restraint.
- According to accident statistics, children are safer when properly restrained in a rear seating position than in a front seating position. Generally, the center rear is safest and should be used if available. Children 12 and under should ride in the back seat of the vehicle.
- If you are unable to use the center rear seating position and have to install this child restraint directly behind a front vehicle seat, ensure that there is at least 38 mm (1.5 in.) of space between any part of the child restraint and the vehicle seat that is closest to the child's head. This space may be necessary for the child restraint to properly perform in certain types of crashes.
- **ONLY** use this child restraint on forward-facing vehicle seats. **DO NOT** use on vehicle seats which face the rear or side.
- **ONLY** use this child restraint on vehicle seats with backs that lock into place.
- Some child restraints do not fit all vehicles or all seating locations. There are thousands of combinations of vehicle makes, models, child restraint configurations, seat belt designs and seat cushion shapes. The easiest way to determine whether your child restraint is suitable for a particular seating position is to check for a tight installation. If the child restraint cannot be properly installed, **DO NOT** use this child restraint. Consult vehicle owner's manual, try a different seating location or call Evenflo at 1-800-233-5921 (U.S), or 1-937-773-3971 (Canada).

Vehicle Seat Belt Warnings

- **DO NOT** use this child restraint in a vehicle seating position with door-mounted seat belts.
- **DO NOT** use this child restraint in a vehicle seating position with seat belts that automatically move along the vehicle frame when the door is opened. These seat belts will not hold a child restraint properly.
- **DO NOT** use this child restraint in a vehicle equipped with seat belts that only lock during a sudden stop or crash (emergency locking retractor – ELR). You must use a seating location with a locking seat belt. Check your vehicle owner's manual to see if you have seat belts with ELR's.

⚠ WARNING

Vehicle Seat Belt Warnings – cont.

- **DO NOT** loosen the vehicle seat belt to provide more leg room as this may keep the child restraint from protecting your child.
- Fold-down armrests could pose a hazard to a rear-facing child in certain types of collisions. Consult your vehicle owner's manual before installing any rear-facing child restraint in front of a fold-down armrest.
- The headrest on the vehicle seat that the child faces should be placed in the lowest position. The vehicle seat back that the child faces must be fully padded and free of any hard objects.
- **DO NOT** use this child restraint if it moves more than 25 mm (1 in.) side-to-side or front to back at the seat belt path. Serious injury or death may occur. Try again or move the child restraint to another seating location.
- If the vehicle seat belts are not routed and fastened correctly, the child restraint may not protect your child in a crash.
- **DO NOT** allow the vehicle seat belt release button to touch the child restraint. Accidental contact may cause the seat belt to release. If necessary, turn the vehicle seat belt release button away from the child restraint or move the child restraint to a different location.
- Failure to adjust the harness snugly around your child may result in your child striking the vehicle's interior during a sudden stop or crash. Serious injury or death may occur.
- Remove locking clip from vehicle seat belt when not used with a child restraint, or the vehicle seat belt will not properly restrain an adult or child. Serious injury or death may occur.

LATCH Warnings

- The LATCH (**L**ower **A**nchors and **T**ethers for **C**hildren) system is intended to be used **ONLY** as described in these instructions. Serious injury or death may result from misuse. LATCH is a system for attaching the child restraint to your vehicle seat. It can be used in place of the seat belts in vehicles with vehicle lower anchor bars. Refer to your vehicle owner's manual for the locations of the vehicle lower anchor bars. **Note:** Your vehicle owner's manual may refer to this system as "Universal Anchorage System (UAS)," "Lower Universal Anchorage System," or "ISOFIX."

⚠ WARNING

LATCH Warnings - cont.

- In addition to these instructions, read and follow your vehicle owner's manual regarding installation of the child restraint and LATCH. If there is a discrepancy, follow your vehicle owner's manual.
- **ONLY** use for securing convenience base to vehicle lower anchor bars.
- **NEVER** attach two lower anchor assembly connectors to one vehicle lower anchor bar.
- **NEVER** use the vehicle seat belts when using the lower anchor connector assembly. Using both together can cause slack in a sudden stop or crash.
- When not in use, the lower anchor connector assembly should be securely stored in the storage area located in the convenience base. Keep out of reach of children.
- **ALWAYS** be sure that the lower anchor connectors are attached to the vehicle lower anchor bars by pulling hard on the lower anchor connectors. If they are not attached, the lower anchor connector assembly will not secure your child restraint. Serious injury or death may result.
- **DO NOT** use this child restraint if it moves more than 25 mm (1 in.) side-to-side or front to back at the vehicle belt path. Serious injury or death may result from poor installation. If you can not tightly secure the child restraint, try again or move it to another location.

Usage Warnings

- Children have **STRANGL**ED in loose or partially buckled harness straps. Fully restrain the child even when carrier is used outside the vehicle.

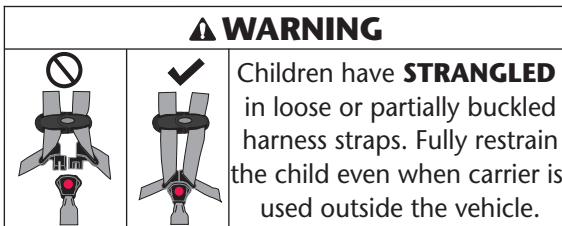

- **ALWAYS** check the restraint and buckle for hot surfaces before putting a child into the restraint. Your child could be burned.

⚠ WARNING

Usage Warnings - cont.

- In cold weather, **DO NOT** dress the child in bulky clothing, like snowsuits, if the child is riding in a child restraint. This clothing makes it difficult to properly tighten the harness to the child, which may allow the child to be ejected from the restraint during a crash.
- **ALWAYS** place the handle in one of the following positions when traveling in a vehicle:
U.S. - *Position 1 or 4*; Canada - **ONLY** *Position 1* (p. 16).
- When using this restraint in *Position 5* (Stand) (p. 16), **ONLY** use on level ground and **NEVER** prop the restraint up with any object.
- **NEVER** place this child restraint on beds, sofas, or other soft surfaces. The child restraint can roll over on soft surfaces and suffocate the child.
- **NEVER** place this child restraint near the edges of counter tops, tables, other high surfaces, or in shopping carts. The child's movements can cause the child restraint to slide and fall.
- The canopy is not intended to provide UV protection.
- **Everyone rides buckled up or the vehicle does not go.** Make no exceptions for adults or children. If someone unbuckles, stop the vehicle. Being firm and consistent right from the start will mean fewer discipline problems as children get older. Besides, an unrestrained child or adult can be thrown into and injure other passengers.
- **NEVER** try to tend to a crying baby's needs while driving. **NEVER** take a baby out of a child restraint for comforting while the vehicle is moving.
- Always place the handle in *Position 4, or 5* before removing infant from carrier (p. 16).
- **DO NOT** allow a child to have objects such as lollipops or ice cream on a stick. The object can injure the child if the vehicle swerves or hits a bump.
- **DO NOT** feed an infant who is riding in a child restraint.
- Anything loose can be deadly in a crash. Put sharp or heavy items in the trunk.
- **DO NOT** dress the child in blanket sleepers or other clothing that would prevent the crotch strap from fitting snugly up against the child.

Recall Information for U.S. Customers

- Child restraints could be recalled for safety reasons. You must register this restraint to be reached in a recall. Send your name, address, e-mail address if available, and the restraint's model number and manufacturing date to:

Evenflo Company, Inc.

1801 Commerce Dr.

Piqua, OH 45356

or call 1-800-233-5921.

or register online at:

www.evenflo.com/registercarseat

- For recall information, call the U.S. Government's Vehicle Safety Hotline at 1-888-327-4236 (TTY:1-800-424-9153), or go to **<http://www.NHTSA.gov>**

Public Notice for Canadian Customers

- Child restraints could be recalled for safety reasons. You must register this restraint to be reached in a public notice. Send your name, address, the restraint's model number, and manufacturing date to

Evenflo Company, Inc.

1801 Commerce Dr.

Piqua, OH 45356

or call 1-937-773-3971 or register online at:

www.evenflo.com/registercarseatcanada

- For public notice information, call Transport Canada at 1-800-333-0510 or go to **www.tc.gc.ca**



Motor Vehicle/Aircraft Usage

When used with the internal harness and properly installed pursuant to these instructions, this restraint is certified

for use only in passenger and multi-purpose passenger motor vehicles, buses and trucks equipped with either lap belts only or lap/shoulder belt systems, and in aircraft.

Refer to pages 43 to 45 for complete instructions on installing your child restraint in aircraft.

TIP!

Check with your airline before departure to make sure this restraint meets their requirements.

Storing Your Instructions

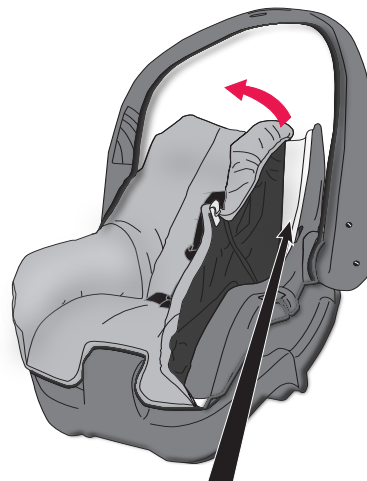

After thoroughly reading and following these instructions, store them in the carrier behind the seat pad, as shown.

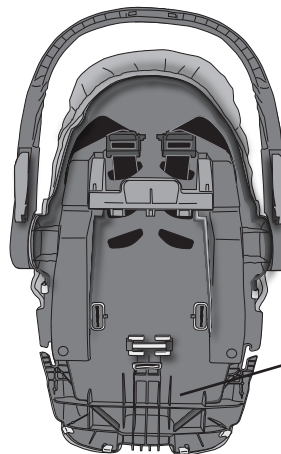

Manufactured in / Fabriqué en
(year-month-day)/(année-mois-jour)
Name / Nom
Model / Modèle
Made in / Fabriqué en
Expires on/Expire le

For future reference, record the **model number** of your child restraint **AND** the **date of manufacture** below.

Model Number: _____

Date of Manufacture: _____

Visual Glossary

Your vehicle components may appear significantly different than pictured. Consult your vehicle owner's manual to help identify your vehicle components.

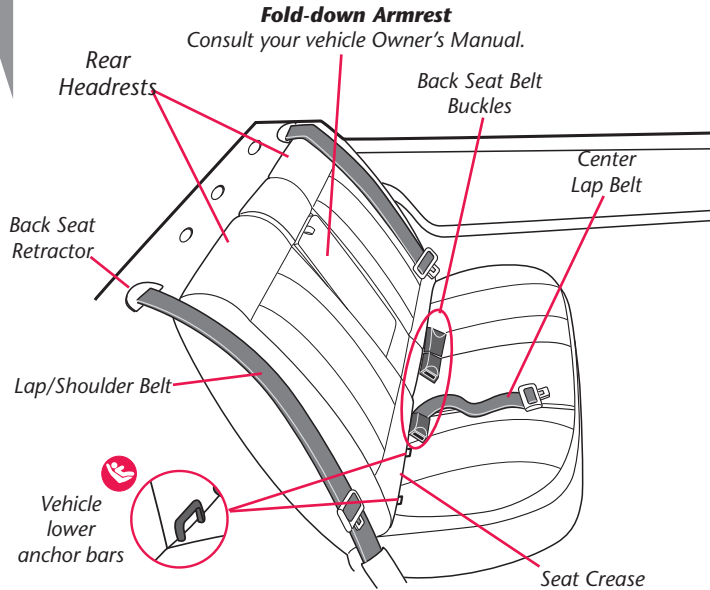

IMPORTANT: If your vehicle has **side air bags**, please refer to the warnings on page 5.

Nurture Convenience Base

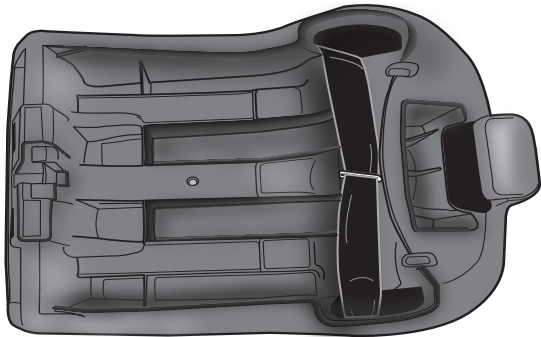

Visual Glossary

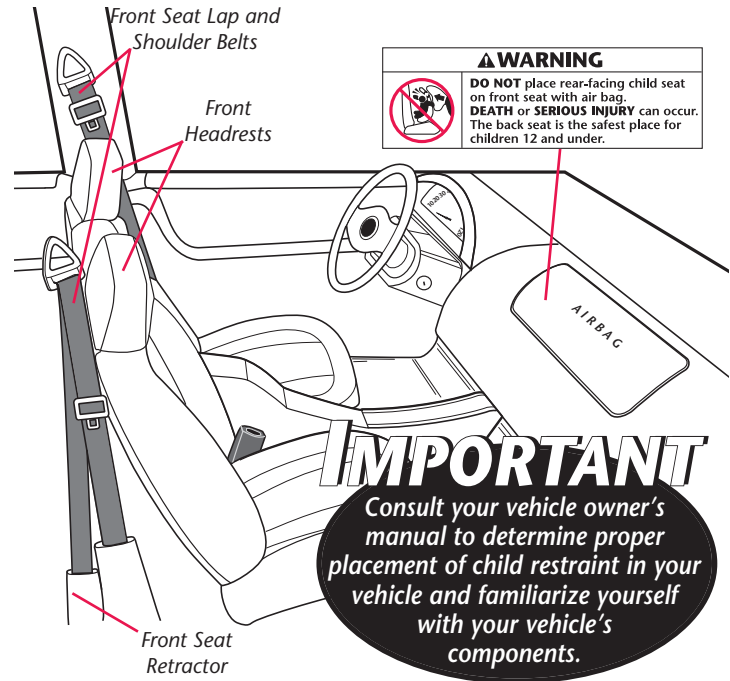

Nurture Convenience Base Bottom

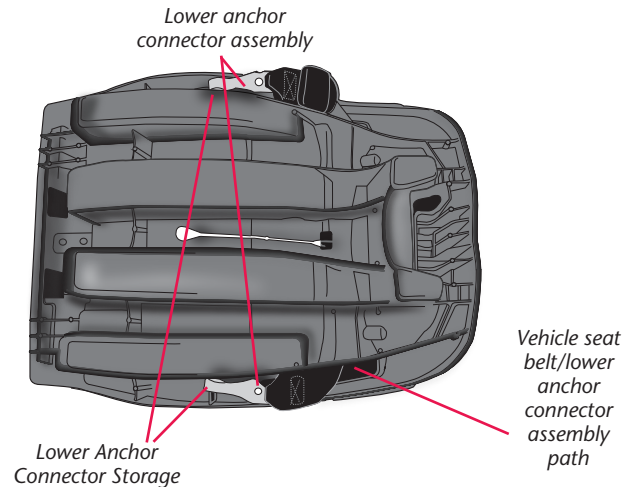

Child Restraint Features

Front View

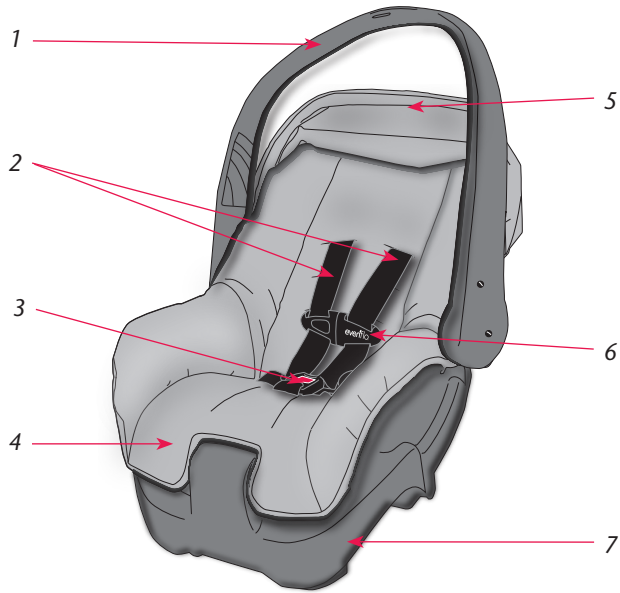

Child Restraint Features

Description

1. Handle
2. Harness Straps
3. Buckle Release
4. Seat Pad
5. Canopy
6. Chest Clip
7. Convenience Base
8. Harness Adjuster
9. Handle Release
10. Seat Release Handle
11. Harness Slots
12. Crotch Strap Slots

Back View

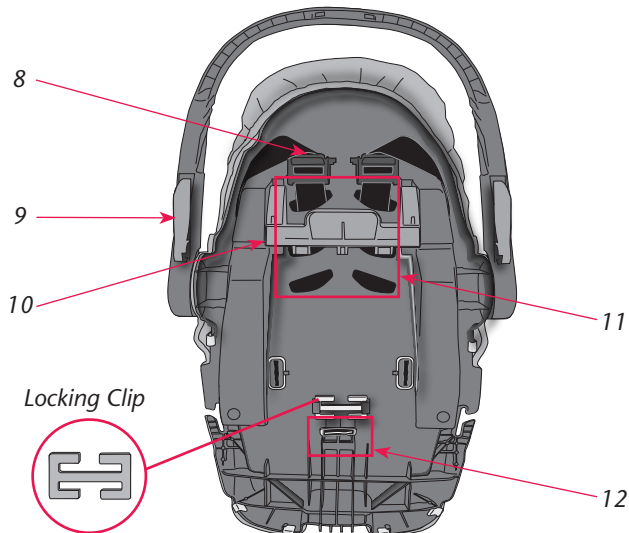

Using the Nurture Handle

To change handle positions, squeeze **both Handle Releases** and rotate the handle to the desired position until it locks into place.

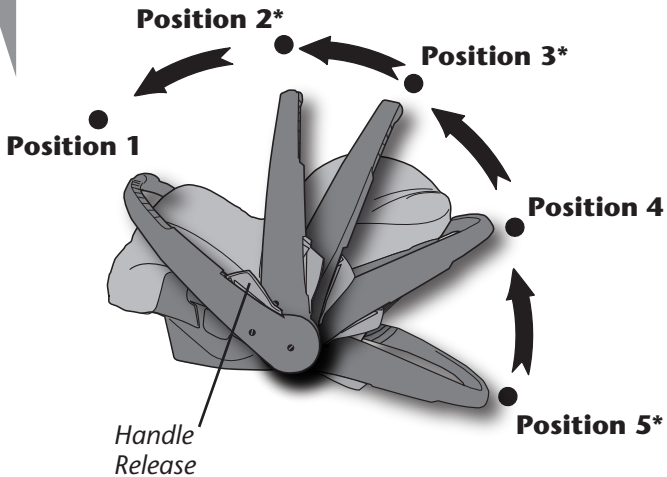

***IMPORTANT: NEVER** use **Positions 2, 3 or 5** when traveling in a vehicle. U.S. and Canadian models differ in acceptable handle positions for travel (see page 17).

Using the Nurture Handle

IMPORTANT: Always secure the child in the carrier. Refer to "Securing the Child in the Carrier" on page 31.

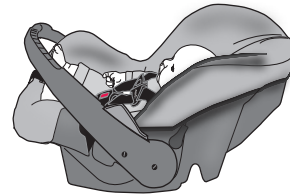

Position 1 (Travel - U.S. and Canada)

This position can be used while traveling in a vehicle. For Canadian Models, you **MUST** place the handle in this position while traveling.

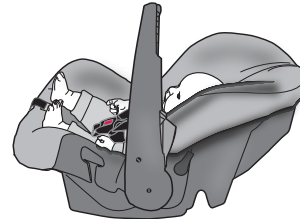

Position 2 (Carry)

This position is **ONLY** to be used to carry your child. **NEVER** use this position in a vehicle.

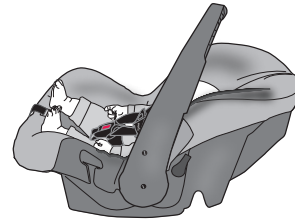

Position 3 (Convenience)

NEVER use this position to carry your child in the carrier. **NEVER** use this position in the vehicle.

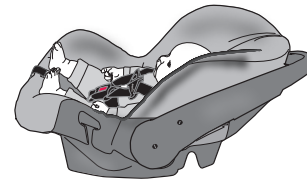

Position 4 (Travel - U.S.)

This position can be used while traveling in a vehicle (U.S.). For Canadian Models, you **MUST** place the handle in **Position 1** while traveling.

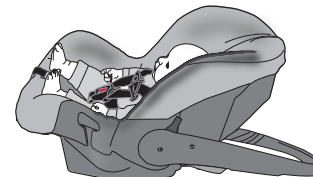

Position 5 (Stand)

Place the handle in this position when you set the carrier on the floor. **NEVER** use this position in a vehicle.

Proper Installation WITH the Convenience Base

Child Requirements

- **Weight:** 2.3 – 10 kg (5 – 22 lbs)
- **Height:** 48 – 74 cm (19 – 29 in.) and top of child's head is at least 25 mm (1 in.) below the top of the child restraint seat back.

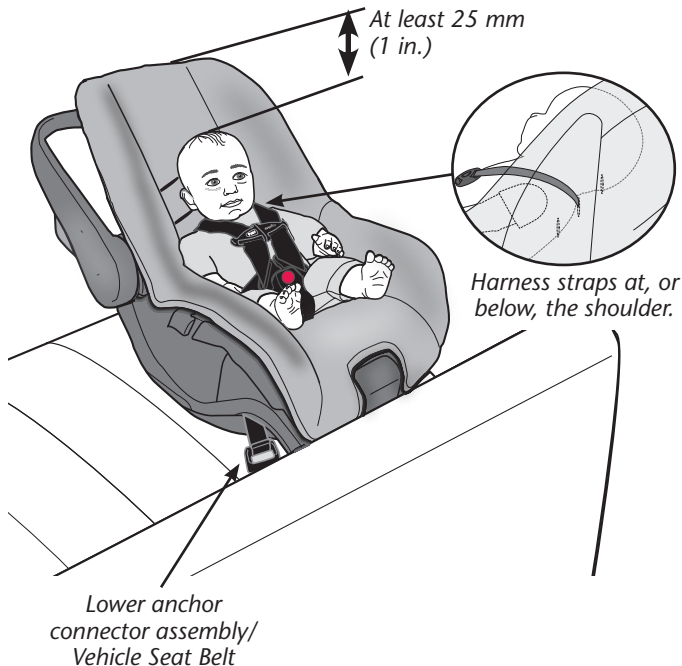

IMPORTANT: Once your child **exceeds** any of the size requirements above, they **MUST** discontinue use of this child restraint.

TIP! To make installation easier, watch the installation video of this child restraint at www.evenflo.com.

Installation Checklist

⚠ WARNING

Child's head **MUST** be at least 25mm (1 in.) below the top of the carrier.

1. Secure the convenience base to the vehicle seat.

- Convenience base is securely installed with lower anchor connector assembly system (shown) (p. 20).

OR

- Convenience base is securely installed with vehicle seat belt (p. 22).

IMPORTANT: A properly secured convenience base does **NOT** move more than 25 mm (1 in.) from side-to-side or from front-to-back **at the lower anchor connector assembly/vehicle belt path.**

- Locking clip is installed, if necessary (p. 38).
- Convenience base is adjusted so that level line is level with ground (p. 24).
- If necessary, a towel/small blanket is rolled up and placed beneath the front edge of the base for additional leveling (p. 24).

2. Secure the child in the carrier (p. 31)

- Harness straps **MUST** start as close as possible to, but **NEVER** above, the child's shoulders (p. 34).
- Both buckle tongues are fastened (p. 32).
- Chest clip is securely fastened and at armpit level (p. 32).
- Harness straps are snug against the child and you should not be able to pinch the harness (p. 32).
- Crotch strap is snug against the child but **NOT** under the child's bottom (p. 36).

3. Check your work.

- The convenience base does **NOT** move more than 25 mm (1 in.) from side-to-side or from front-to-back **at the lower anchor connector assembly/vehicle belt path.**
- The handle is in *Position 1* (Canadian **OR** U.S. models) or *Position 4* (U.S. models **ONLY**) (p. 25). (*Position 4* shown at left.)

Installing the Convenience Base with the Lower Anchor Connector Assembly System

WARNING

- This lower anchor connector assembly system is intended to be used **ONLY** as described in these instructions. Serious injury or death may result from misuse.
- In addition to these instructions, read and follow your vehicle owner's manual regarding installation of the child restraint and LATCH. If there is a discrepancy, follow your vehicle owner's manual.
- **ONLY** use for securing convenience base to vehicle lower anchor bars.
- **NEVER** attach two lower anchor connector hooks to one vehicle lower anchor bar.
- **NEVER** use the vehicle seat belts when using the lower anchor connector. Using both together can cause slack in a sudden stop or crash.
- When not in use, the lower anchor connectors should be securely stored in the storage area located in the convenience base (see page 37). Keep out of reach of children.
- **ALWAYS** be sure that the lower anchor connectors are attached to the vehicle lower anchor bars by pulling hard on the lower anchor connectors. If they are not attached, the lower anchor connector assembly will not secure your child restraint. Serious injury or death may result.
- **DO NOT** use this child restraint if it moves more than 25 mm (1 in.) side-to-side or front to back at the vehicle belt path. Serious injury or death may result from poor installation. If you cannot tightly secure the child restraint, try again or move it to another location.
- This child restraint **MUST** face the rear of the vehicle.
- The carrier **MUST** be locked firmly into the base. Check by lifting up on the carrier.
- **NEVER** use this child restraint in the forward-facing position.

1 Before you begin, be sure the vehicle is on a level surface.

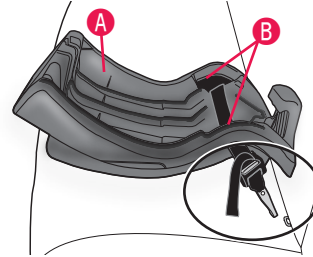

Place the base **A** on the vehicle seat.

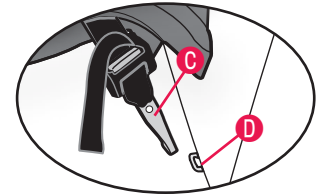

Route the lower anchor connector strap and hook through the lower anchor connector strap openings **B**.

Refer to your owner's manual to locate the lower anchor bars on your vehicle seat.

Attach the right hook **C** to the right anchor bar **D** and the left hook to the left anchor bar. **DOUBLE CHECK** that the hooks are fully engaged by pulling hard on the lower anchor connector strap.

2

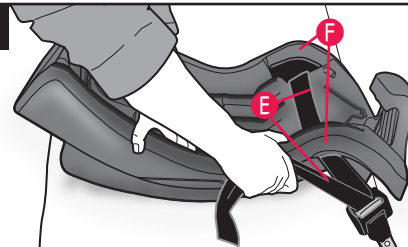

WARNING

DO NOT use this child restraint if it moves more than 25 mm (1 in.) side-to-side or front to back at the vehicle seat belt path. Serious injury or death may occur. Move the child restraint to another seating location or try to tighten the lower anchor assembly again.

Using your full weight, push the base firmly into the vehicle seat, while pulling up on the strap **E** to tighten. **The lower anchor connector assembly strap must be as tight as possible.**

If you can move the child restraint more than 25 mm (1 in.) side-to-side or front to back at the vehicle belt path **F**, the lower anchor connector assembly strap is not tight enough. You will need to try again or find another location for your child restraint.

Installing the Convenience Base with the Vehicle Seat Belt

⚠ WARNING

- The carrier **MUST** be locked firmly into the convenience base. Check by lifting up on the carrier.
- **NEVER** use this child restraint in the forward-facing position.
- **DO NOT** use this child restraint in a vehicle equipped with lap belts that only lock during a sudden stop or crash (emergency locking retractor – ELR). You must use a seating location with a locking seat belt. Check your vehicle owner's manual to see if you have lap belts with ELRs.

1 Before you begin, be sure the vehicle is on a level surface.

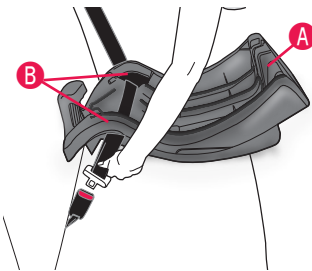

Secure the convenience base **A** to your vehicle seat by routing the vehicle seat belt through the openings **B**, as shown.

LAP BELT

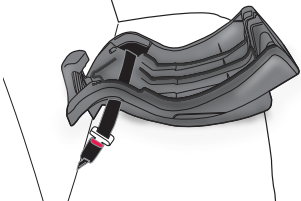

LAP AND SHOULDER BELT

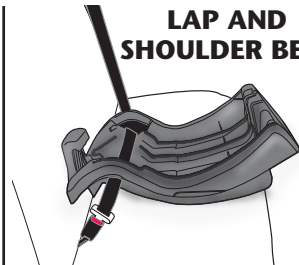

IMPORTANT: Some ELR vehicle belts can be switched into locking mode for child restraint installation. It may not be necessary to use a locking clip in these situations.

To install a locking clip, refer to p. 38.

Refer to the vehicle owner's manual to determine which type of belt retractor is in the vehicle.

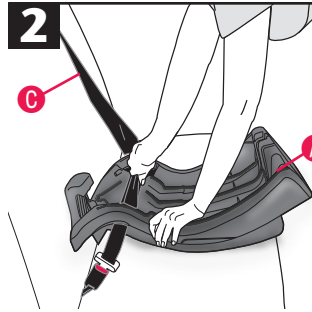

Pull the shoulder belt **C** tightly to remove all slack from the lap portion of the vehicle seat belt and, at the same time, push down on the base **A** using your full weight. Check to be sure the base is secured in the vehicle seat.

⚠ WARNING

DO NOT use this child restraint if it moves more than 25 mm (1 in.) forward or side-to-side at the seat belt path. Serious injury or death may occur. Move the child restraint to another seating location or try to tighten the seat belt again.

Placing the Carrier in the Base

1

Secure the infant restraint to the base by placing the front of the seat under the hook **F** and snapping seat into place.

The carrier MUST be locked firmly into the base. Check by lifting up on the carrier handle or the front of the carrier to make sure it's locked in place.

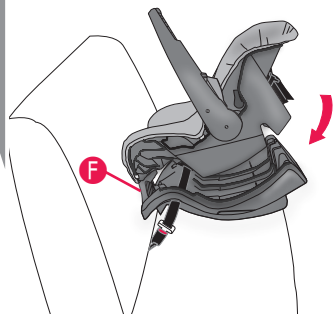

2

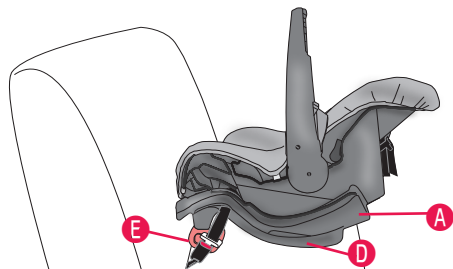

If level line **D** is not level with the ground, use a tightly rolled towel, or small blanket **E**, beneath the front edge of the base **A**, in order to provide enough recline for an infant's head to lie back comfortably.

IMPORTANT: Infants may have difficulty breathing when in a sitting position. Make sure they recline enough for their head to lie back comfortably and safely. Failure to properly recline the child restraint could increase the child's risk of serious injury or death.

Canadian OR
U.S. Models

U.S. Models
ONLY

3

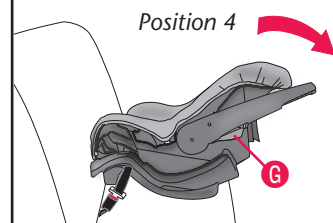
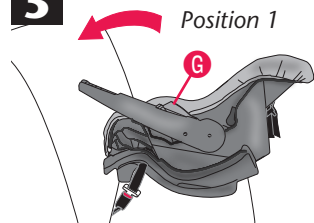

Squeeze both handle releases **G** and move the handle to either *Position 1* (Canadian **OR** U.S. models) or *Position 4* (U.S. models **ONLY**) until it locks into place. Canadian models **MUST** use *Position 1* in vehicle.

Note: Make sure there is at least 38 mm (1.5 in.) of space between any part of the carrier and the vehicle seat that is closest to the child's head. If you need additional clearance, place the handle in *Position 1*.

Releasing the Carrier from the Base

1

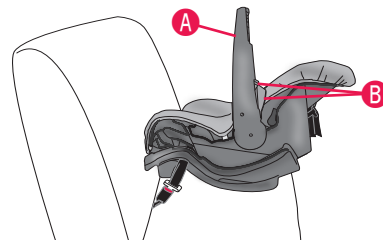

Move the handle **A** to *Position 2* (Carry) by squeezing in on both handle releases **B** and rotating the handle until it locks into place above the carrier.

2

Pull the base release lever **C** on the back of the child restraint outward and lift the child restraint out.

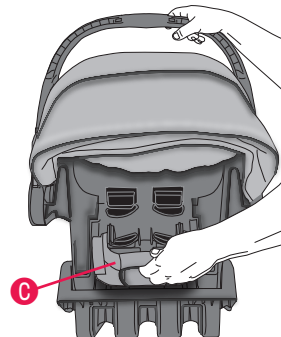

Proper Installation WITHOUT the Convenience Base

Child Requirements

- **Weight:** 2.3 – 10 kg (5 – 22 lbs)
- **Height:** 48 – 74 cm (19 – 29 in.) and top of child's head is at least 25 mm (1 in.) below the top of the child restraint seat back.

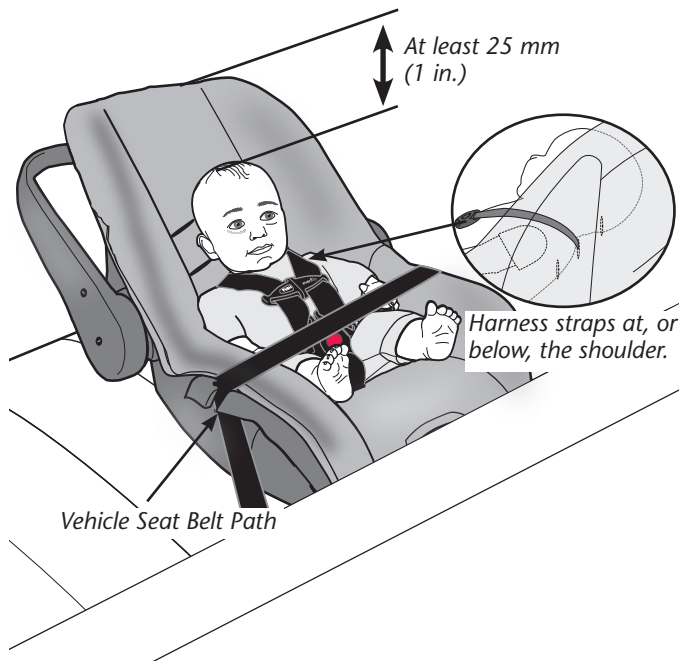

IMPORTANT: Once your child **exceeds** any of the size requirements above, they **MUST** discontinue use of this child restraint.

TIP! To make installation easier, watch the installation video of this child restraint at www.evenflo.com.

Installation Checklist

⚠ WARNING

Child's head **MUST** be at least 25 mm (1 in.) below the top of the carrier.

1. Place the child in the carrier.

- The child's back and bottom are flat against the back and bottom surfaces of the carrier.
- Top of child's head is at least 25 mm (1 in.) below the top of the child restraint seat back.

2. Secure the child in the carrier (p. 31).

- Harness straps **MUST** start as close as possible to, but **NEVER** above, the child's shoulders (p. 34).
- Both buckle tongues are fastened (p. 32).
- Chest clip is securely fastened and at armpit level (p. 32).
- Harness straps **MUST** be snug against the child's shoulders, with no slack (p. 32).
- Crotch strap is snug against the child but **NOT** under the child's bottom (p. 36).

3. Secure child restraint to the vehicle seat.

- Carrier is securely installed with vehicle seat belt (p. 28).
- The shoulder strap portion of the seat belt is lying across the vehicle seat back (p. 29).
- Locking clip is installed, if necessary (p. 38).
- The level line is level with the ground (p. 31).
- If necessary, a towel/small blanket is rolled up and placed beneath the front edge of the carrier so the child's head lies back comfortably (p. 31).

4. Check your work.

- To properly protect your child, the carrier **MUST NOT** move more than 25 mm (1 in.) from side-to-side or from front-to-back at the vehicle belt path.
- The handle is in *Position 1* (Canadian **OR** U.S. models) or *Position 4* (U.S. models **ONLY**) (p. 30). (*Position 4* shown at left.)

Installing the Carrier Without the Convenience Base

1

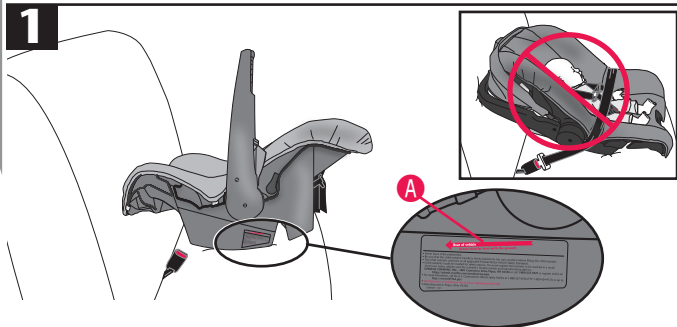

After securing the infant, place the restraint into your vehicle. Adjust the restraint so that the level line **A** is level with the ground.

Note: Generally, the center rear seating position is the safest. **This infant restraint MUST face the rear of the vehicle.**

2

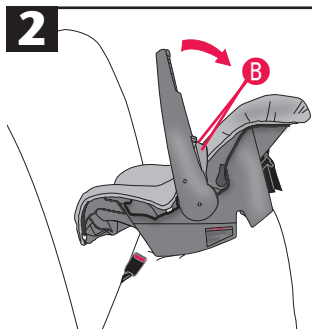

Rotate the handle to *Position 4* by squeezing both handle releases **B** at the same time.

3

LAP BELT

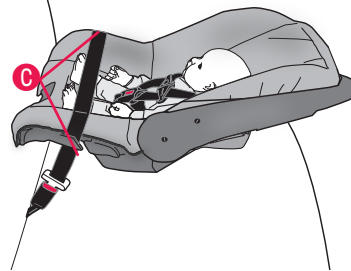

Route **ONLY** the **lap portion** of the vehicle seat belt through the belt slots **C** on the carrier.

LAP AND SHOULDER BELT

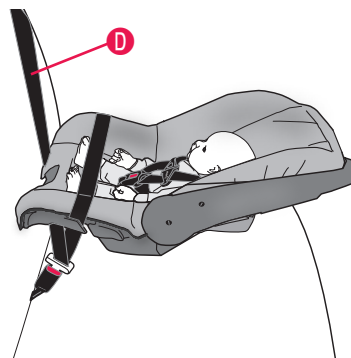

In vehicles with a lap **and** shoulder belt **D**, **DO NOT** route the shoulder belt through the belt slots. Instead, let it lay across the vehicle seat back, as shown.

IMPORTANT: Some ELR vehicle belts can be switched into locking mode for child restraint installation. **It may not be necessary to use a locking clip in these situations.** To install a locking clip, refer to p. 38. Refer to the vehicle owner's manual to determine which type of belt retractor is in the vehicle.

4

**TIP!**

Push down on the bottom of the seat using your full weight.

⚠ WARNING

- **NEVER** use this child restraint in the forward-facing position.
- **DO NOT** use this child restraint if it moves more than 25 mm (1 in.) side-to-side or front to back at the vehicle belt path. Serious injury or death may occur. Move the child restraint to another seating location or try to tighten the seat belt again.

The seat belt **E** must be as tight as possible. Put your full weight onto the seat as you tighten the vehicle belt.

Make sure the vehicle belt is tight. If you can move the child restraint more than 25 mm (1 in.) side-to-side or front to back at the belt path, the vehicle belt is not tight enough, and you need to try again.

5

**Canadian OR
U.S. Models**

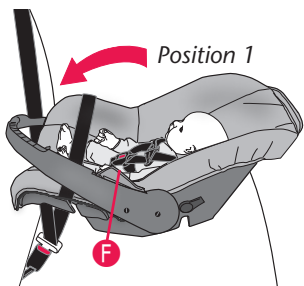

**U.S. Models
ONLY**

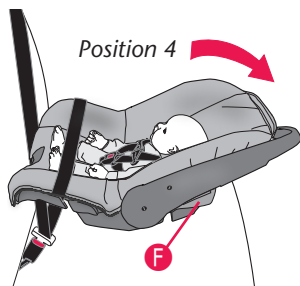

Squeeze both handle releases **F** and move the handle to either *Position 1* (Canadian OR U.S. models) or *Position 4* (U.S. models **ONLY**) until it locks into place.

Note: Make sure there is at least 38 mm (1.5 in.) of space between any part of the carrier and the vehicle seat that is closest to the child's head. If you need additional clearance, place the handle in *Position 1*.

6

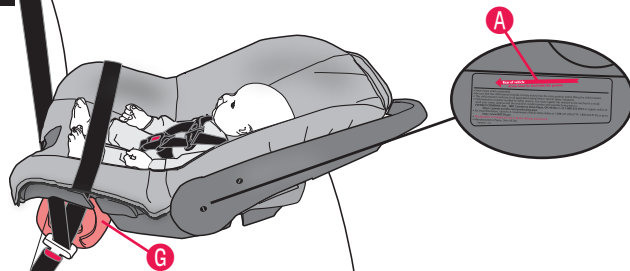

If the level line **A** is not level to the ground, use a tightly rolled towel or small blanket **G** beneath the front edge of the child restraint. You need to provide enough recline for an infant's head to lie back comfortably.

IMPORTANT: Infants may have difficulty breathing when in a sitting position. Make sure they recline enough for their head to lie back comfortably and safely. Failure to properly recline the child restraint could increase the child's risk of serious injury or death.

Securing the Child in the Carrier



Place the baby in the carrier. Baby's bottom and back should be flat against the seat. If there is a gap, baby will not be comfortable.

1

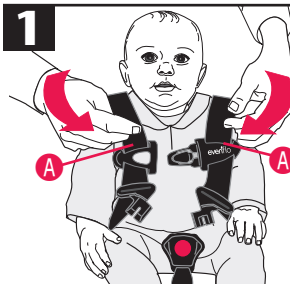

Slide each harness strap **A** over the child's shoulders.

2 Facing the front of the buckle, place the left buckle tongue **B** on top of the right buckle tongue **C**. Then insert both tongues in the nested position, into the buckle opening until you hear an audible click. Pull up on the harness strap to ensure the buckle tongues are engaged.

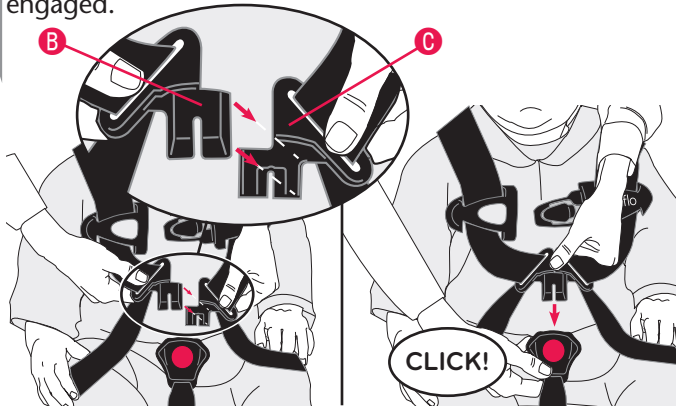

IMPORTANT: The buckle strap should be snug against the baby's crotch but never under the baby's bottom. Adjust the crotch strap if necessary (p. 36).

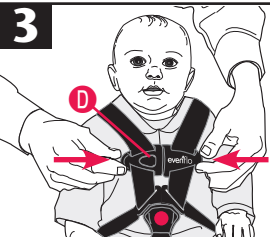

Align the two sides of the chest clip **D** and snap them together. The chest clip must be positioned at armpit level. The harness straps must be snug against the child.

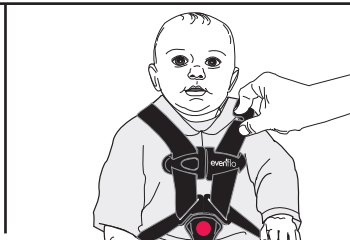

The harness straps must be snug against the child. A snug strap should not allow any slack. It lies in a relatively straight line without sagging. It does not press on the child's flesh or push the child's body into an unnatural position. Check the harness straps near the shoulders for slack. You should **NOT** be able to pinch the harness (see illustration). Adjust as needed.

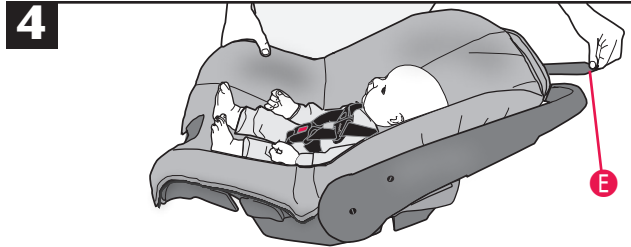

Tighten the harnesses by pulling on the harness straps **E** from the back of the harness adjusters.

Removing the Child from the Carrier

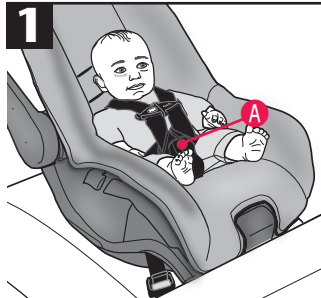

Press the red buckle release **A** and remove the buckle tongues.

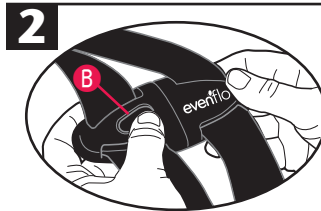

Push the release button **B** and pull the chest clip apart.

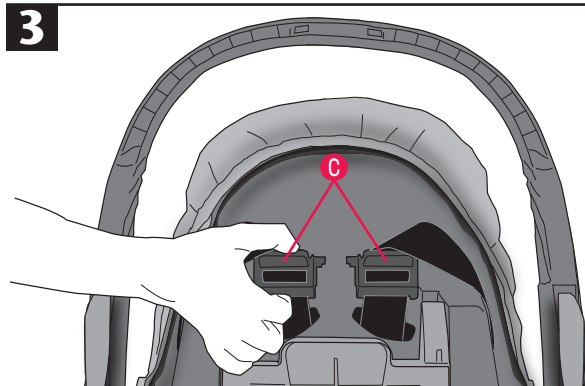

To loosen the harness straps, squeeze the harness adjusters **C** while pulling on the straps from the front of the seat.

Changing the Harness Position

As your child grows, you will need to change the harness strap position so that the harness straps are routed through the slots closest to the child's shoulders. The shoulder harness straps should **ALWAYS** be as close as possible to, but **NEVER** above, the child's shoulders.

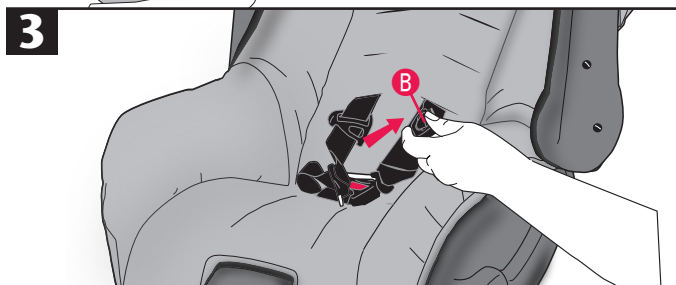
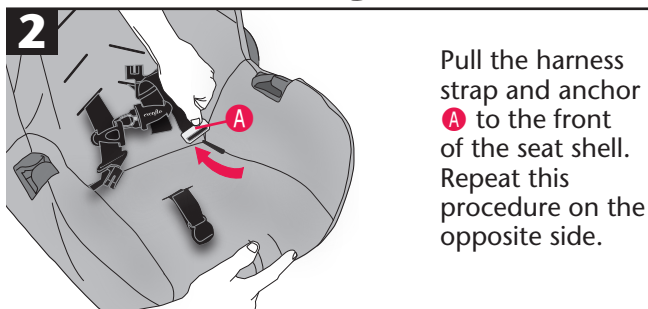
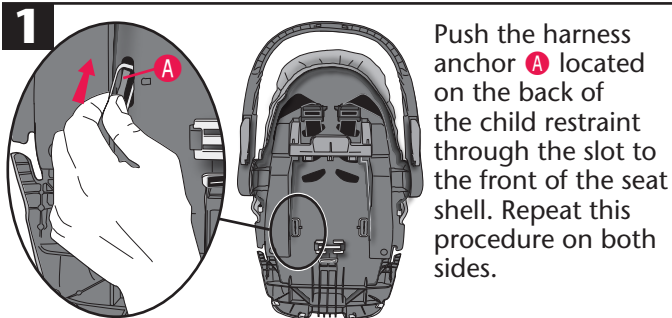

Pull the harness strap from the back of the carrier while pushing the chest clip **B**, buckle tongue, harness anchor, and harness strap through to the back.

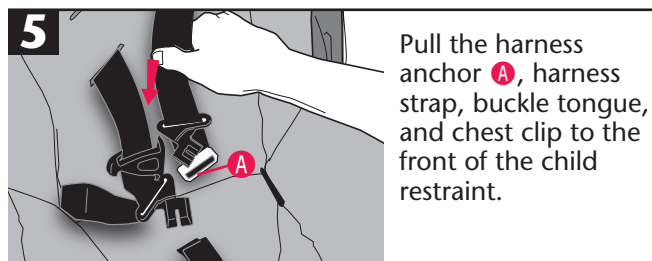
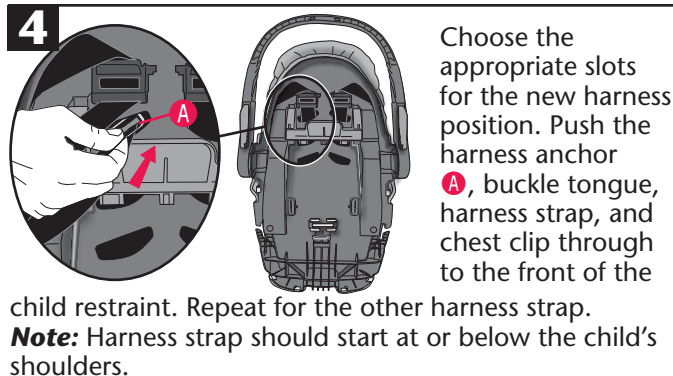

IMPORTANT: When inserting harness straps through the slots in the seat pad, make sure you route them correctly through their corresponding slots in the seat shell.

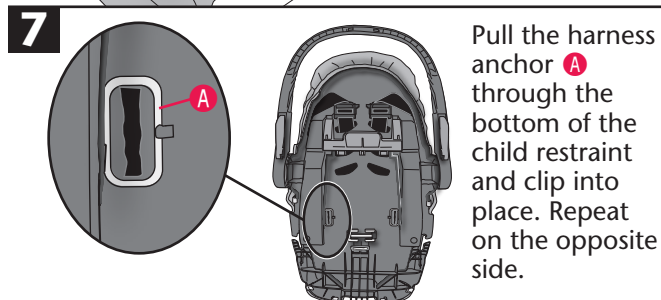
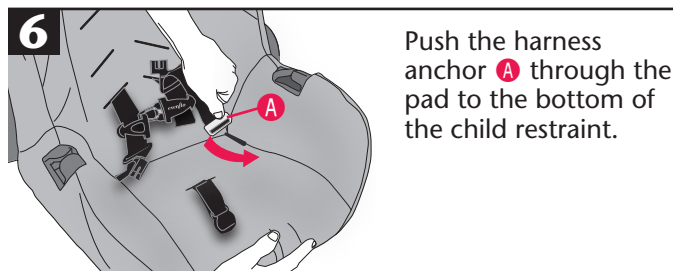

Make certain the harness anchor **A** is properly seated against the seat shell.

Changing the Crotch Strap Position

As your child grows, you will need to change the crotch strap position so that it is in the slot closest to your child. The crotch strap should **ALWAYS** be as close as possible to, but **NEVER** under, the child's bottom.

There are two positions in which to use the crotch strap, based upon your child's comfort.

1

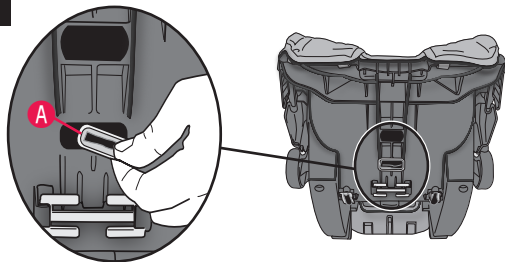

To reposition the crotch strap, turn the harness anchor **A** on the end of the crotch strap sideways and push it through the slot in the restraint seat.

2

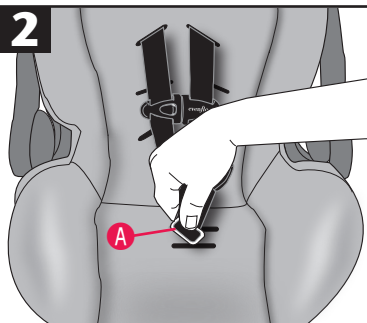

Insert the crotch strap anchor **A** into the slot that is closest to the child **AND** the most comfortable for the child.

3

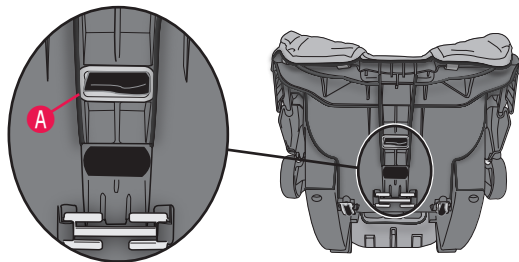

Make certain the harness anchor **A** is properly seated against the seat shell.

Removing the Lower Anchor Connector Assembly System

1 The lower anchor connector assembly system that comes with your child restraint will be one of the two types below.

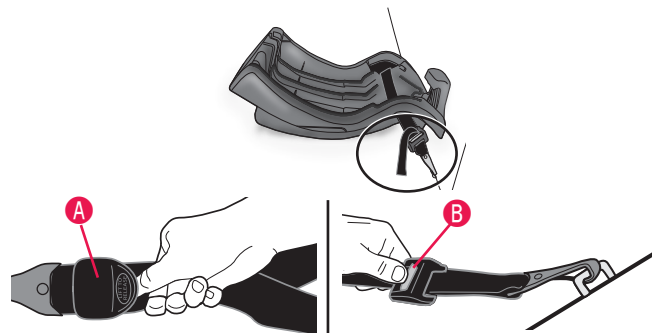

Tilt and slide the adjuster **A** to loosen the lower anchor connector assembly.

Press the adjuster release button **B** to loosen lower anchor connector assembly.

2

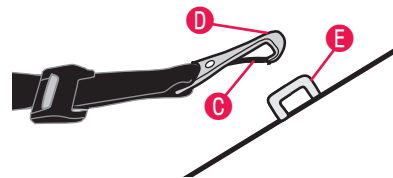

Press the tab **C** and twist, then remove the hook **D** from the anchor **E**.

3

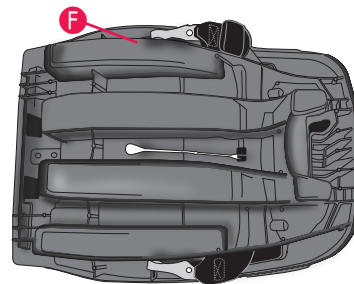

When the lower anchor connector system is not in use, you **MUST** securely store it on the base **F** as shown using the storage bars on the underside of the base. A loose lower anchor connector strap and hook may injure your child.

Using the Locking Clip

To watch a video about installing a locking clip, go to www.evenflo.com.

Locking Clip installed properly.

13 mm
(0.5 in.)

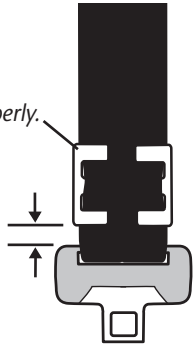

Install Locking Clip, if necessary.

If your vehicle was built **prior to model year 1996**, and has a lap/shoulder belt that is equipped with an emergency locking retractor (ELR) AND sliding latch plate, you **MUST** use a Locking Clip. Check your vehicle owner's manual to identify which vehicle belt system is in your vehicle.

If your vehicle is **model year 1996 or newer**, it likely has a vehicle belt system that can be locked when tightened, and will not require use of a Locking Clip.

Consult your vehicle owner's manual before installing a Locking Clip.

! WARNING

Remove locking clip from vehicle seat belt when not used with a child restraint, or the vehicle seat belt will not properly restrain an adult or child. Serious injury could occur.

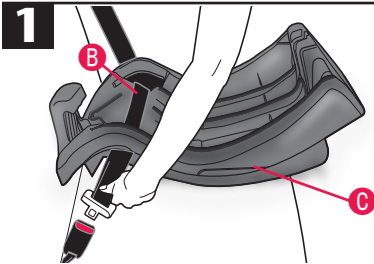

Thread the seat belt **B** through the base **C** (or child restraint) and buckle the seat belt.

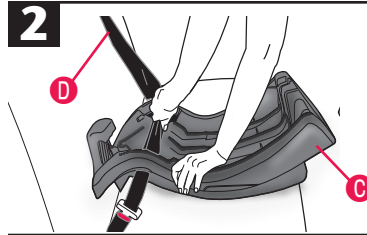

Push down on the base **C** while pulling the shoulder belt **D** tightly to remove all slack from the lap portion of the belt.

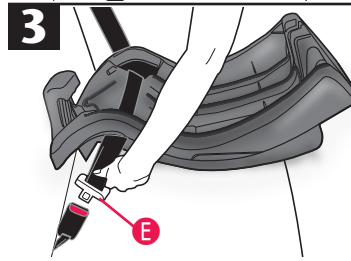

Hold the lap and shoulder belts together just behind the free sliding buckle tongue **E** and unbuckle the seat belt.

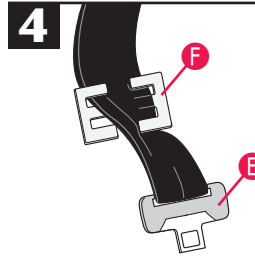

While holding the belts and buckle tongue **E**, thread the locking clip **F** onto the seat belt, and slide it into place.

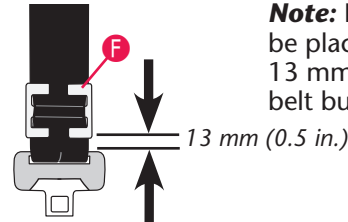

Note: Locking clip must be placed within 13 mm (0.5 in.) of seat belt buckle.

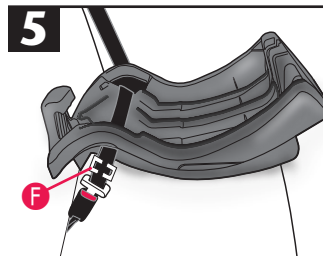

Buckle the seat belt with the locking clip **F** in place.

- If installing the **convenience base** with a vehicle seat belt, return to page 22, Step 1.
- If installing the **carrier** (no convenience base) with a vehicle seat belt, return to page 29, Step 3.

Using as an Infant Carrier

Secure the child in the carrier by following "Securing the Child in the Carrier" on page 31.

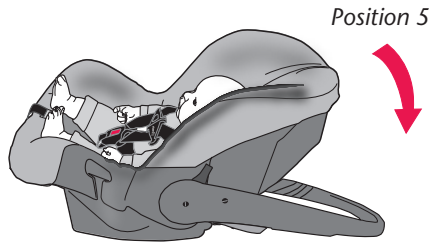

To use as a stand: Squeeze both handle releases and rotate the handle to *Position 5* (Stand) until it locks into place and the carrier rests on a level surface.

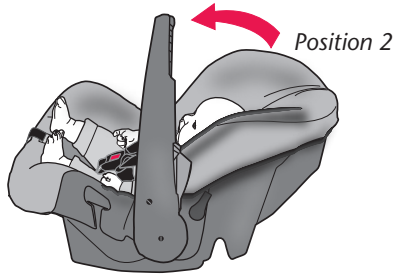

To use as a carrier: Squeeze both handle releases and rotate the handle to *Position 2* (Carry) until it locks into place. Carry at your side, using the handle as shown.

IMPORTANT:

Make sure that the handle is firmly locked on both sides and that the harness is securely buckled before lifting the infant carrier.



⚠ WARNING

- **NEVER** place this child restraint near the edges of counter tops, tables, or other high surfaces. The child's movements can cause the carrier to slide or fall.
- **NEVER** leave the child in this carrier when the harness straps are loose or undone. Children have **STRANGLED** in loose or partially buckled harness straps. Fully restrain the child even when the carrier is used outside the vehicle.



- **NEVER** place the carrier in any position in a shopping cart. The carrier may fall from the cart and injury may occur to your child.



- **DO NOT** carry on your hip.

Canopy Installation

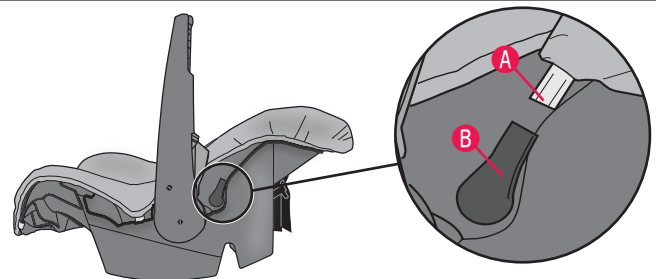

Guide each end of the canopy strip **A** into the canopy holder **B** located on each side of the child restraint.

• IMPORTANT •

- If you decide to obtain an additional base for your Nurture® child restraint, make sure it displays a *sku/part number* beginning with “640.”
- Note that the *sku/part number* will appear on a label on the back of the base and will be printed on the front of the carton, as shown below.



Securing Your Child Restraint in Aircraft

The Federal Aviation Administration (FAA) recommends that you secure your child for air travel in an appropriate child restraint based on your child's weight and size. Turbulence can happen with little or no warning. When turbulence occurs, **the safest place for your child is in a properly installed child restraint, not in an adult's lap or on the aircraft seat with its seat belt.** Keeping your child in a child restraint during the flight will help ensure your family arrives safely at your destination.

The FAA recommends that a child weighing:*

- more than 18 kg (40 lbs) use an aircraft seat belt;
- less than 9 kg (20 lbs) use a rear-facing child restraint; and
- from 9 to 18 kg (20 to 40 lbs) use a forward-facing child restraint.

* **Please note that these FAA recommendations may vary from those applicable to the use of your child restraint in a motor vehicle.**

IMPORTANT

You must use the internal harness when installing the child restraint in aircraft.

Installing Child Restraint in Aircraft

IMPORTANT: Before installing the child restraint, make sure the **aircraft seat is in a fully upright position.**

DO NOT use the convenience base when installing child restraint in aircraft.

1

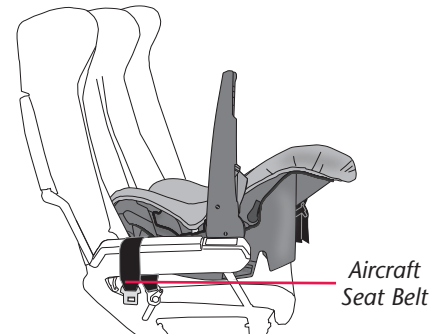

Place the child restraint on the aircraft seat **rear-facing**, as shown above.

✈ Installing Child Restraint in Aircraft

2

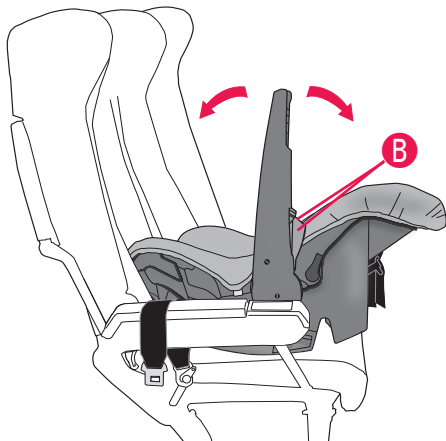

Rotate the handle to *Position 1* or *Position 4* by squeezing both handle releases **B** at the same time.

3

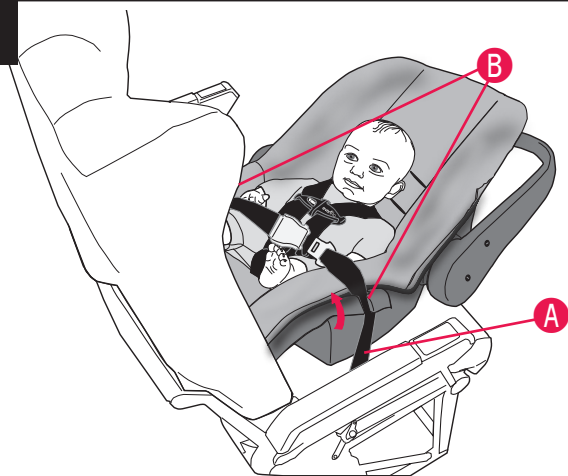

Route the aircraft seat belt **A** through the belt slots **B** on the carrier, as shown above.

✈ Installing Child Restraint in Aircraft

4

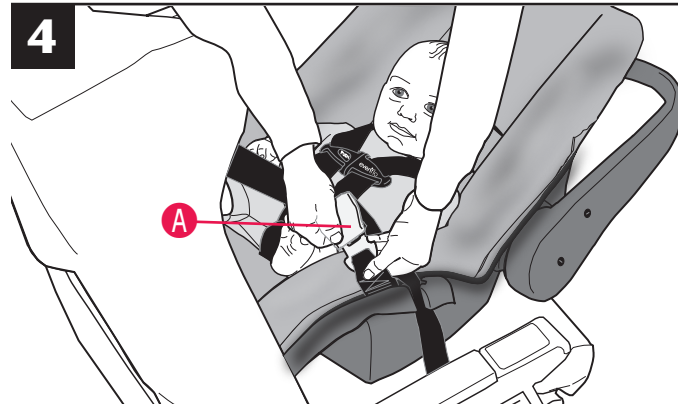

Fasten the aircraft seat belt **A**.

5

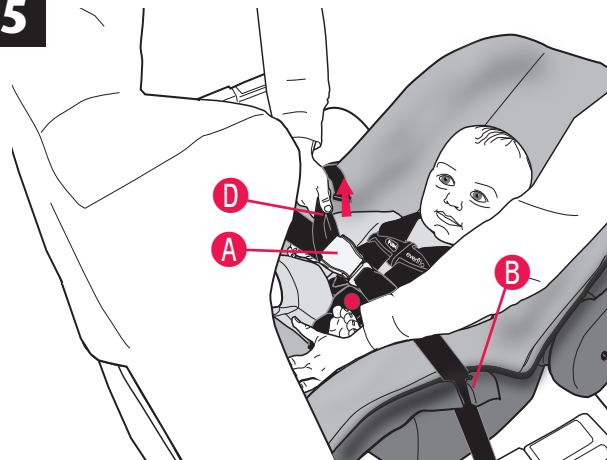

The aircraft seat belt **A** must be as tight as possible. Route the excess seat belt strap **D** back through the belt slots **B**, as shown above. Using your full weight, push the child restraint firmly onto the aircraft seat while pulling on the excess seat belt strap to tighten.

Check your work. Try to move the child restraint in all directions. If you can move the child restraint more than 25 mm (1 in.) side-to-side or front to back at the belt path **B**, the aircraft seat belt **A** is not tight enough, and you **MUST** install again until the seat belt is tight.

Care and Cleaning

- **DO NOT** lubricate or immerse in water the LATCH connectors, the buckle, or any other part of this child restraint, unless rinsing is permitted, as stated on the back of the buckle for your restraint.
- Plastic and metal parts may be wiped clean with mild soap and water and dried with a soft cloth. Do not use abrasive cleaners or solvents.
- Take care not to damage any labels.
- The harness can be wiped clean with mild soap and water. Allow harness to air dry.
- Machine wash the seat pad separately in cold water, delicate cycle. Tumble dry 10 to 15 minutes on low heat.
- **NEVER** use child restraint without the seat pad.
- To protect the child restraint from damage caused by weather, rodents, and other elements common to garages, the outdoors, and other storage locations, remove the seat pad and thoroughly clean the restraint and pad prior to storage. Take care to clean in the areas where crumbs and other debris tend to accumulate.

TIP! To help protect the vehicle upholstery, place a towel beneath and behind the child restraint.

Replacement Parts

Not available on all models. Styles may vary.

To order replacement parts, you can order online at www.evenflo.com or contact Evenflo. When you contact us, please have the product model number and date of manufacture (found on the back of the child restraint).



Locking Clip



Head Foam



Canopy



Harness System

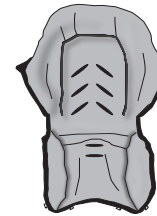

Seat Pad

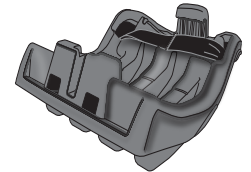

Convenience Base

Proper Disposal of this Child Restraint

At the end of this child restraint's useful life, Evenflo encourages you to dispose of it properly. Most of the components in this child restraint are recyclable.

1. Remove all fabric and padding.
2. Remove all screws and disassemble the restraint.
3. Recycle all plastic/foam parts and discard the rest.

If your local recycling center won't accept the padding, you may dispose of it in the landfill.

Note: Evenflo uses recycled materials in the manufacturing process whenever possible but never for components that are critical for safety.

Limited Warranty

For a period of 90 days from the original purchase of this Product, Evenflo warrants to the original end user (“Purchaser”) this Product (including any accessories) against defects in material or workmanship. Evenflo’s sole obligation under this express limited warranty shall be, at Evenflo’s option, to repair or replace any Product that is determined to be defective by Evenflo and determined to be covered by this warranty.

Repair or replacement as provided under this warranty is the exclusive remedy of the Purchaser. Proof of purchase in the form of a receipted invoice or bill of sale evidencing that the Product is within the warranty period must be presented to obtain warranty service. This express limited warranty is extended by Evenflo ONLY to the original Purchaser of the Product and is not assignable or transferable to subsequent purchasers or end users of the Product. For warranty service, contact Evenflo’s ParentLink Consumer Resource Center

EXCEPT TO THE EXTENT PROHIBITED BY APPLICABLE LAW, ANY IMPLIED WARRANTY OF MERCHANTABILITY OR FITNESS FOR A PARTICULAR PURPOSE ON THIS PRODUCT IS HEREBY DISCLAIMED. EVENFLO SHALL NOT BE LIABLE FOR ANY INCIDENTAL, CONSEQUENTIAL, SPECIAL OR PUNITIVE DAMAGES OF ANY KIND FOR BREACH OF THE EXPRESS LIMITED WARRANTY ON THIS PRODUCT, OR ANY WARRANTY IMPLIED BY OPERATION OF LAW. OTHER THAN THE EXPRESS LIMITED WARRANTY SET FORTH ABOVE, THERE ARE NO OTHER WARRANTIES THAT ACCOMPANY THIS PRODUCT AND ANY ORAL, WRITTEN OR ANY OTHER EXPRESS REPRESENTATION OF ANY KIND IS HEREBY DISCLAIMED.

ParentLink®

answers. advice. affirmation.™

• www.evenflo.com

- USA: 1-800-233-5921 8 AM – 5 PM E.T.
- Canada: 1-937-773-3971
- Mexico: 01-800-706-12-00

ParentLink®

answers. advice. affirmation.™

• www.evenflo.com

- *USA: 1-800-233-5921 8 AM – 5 PM E.T.*
- *Canada: 1-937-773-3971*
- *Mexico: 01-800-706-12-00*