

# Priva II Quick User Guide

- 1 LED indicator
- 2 Battery/DC switch
- 3 3.5mm audio jack
- 4 Multi-Function Button (MFB)
- 5 Micro USB charging socket
- 6 Magnetic base
- 7 3M sticker

## Pair and connect

**1 Set**

Set switch to "Battery"

**2 Pair**

Press 2~4s

**PAIRING MODE\***  
Press & hold 2~4s until LED blinks BLUE & RED together

Get headset or speaker into PAIRING MODE\*

**3 Connect**

Keep the devices close and wait until the LEDs slow down together.

**4 Multi-link**

Repeat above 2 & 3 steps to connect the second device

\*PAIRING MODE: Discoverable mode for Bluetooth device, normally the LED blinks 2 or 3 times per second or blinks 2 colors alternately.

## Connect Priva II to an audio source

TV with 3.5mm headphone jack. Connect Priva II to the TV using the included 3.5mm audio cable

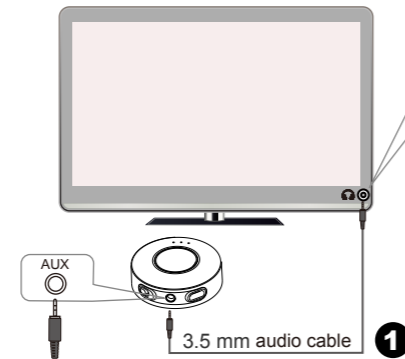

TV with RCA ANALOG\* OUT. Connect Priva II to the TV using the included RCA cable

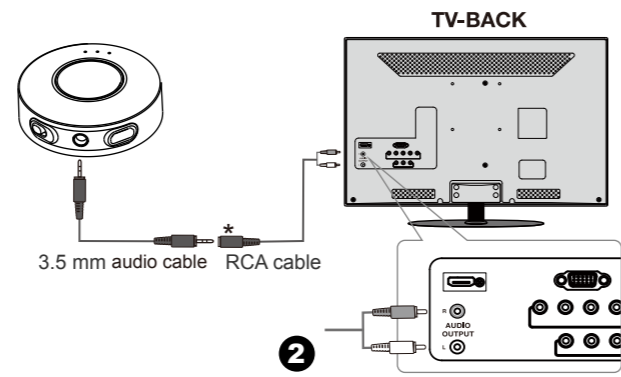

\*Find the correct ANALOG output: You can connect wired earphones with the RCA cable to test whether the sound is normal.

TV WITHOUT RCA analog out or headphone jack. Connect Priva II to the TV with a Digital to Analog Audio Converter (please buy separately)

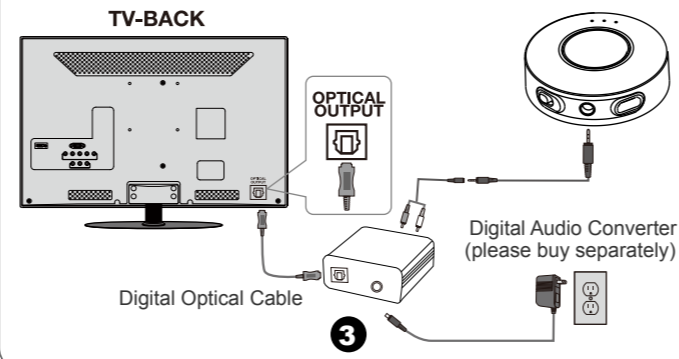

For AVR or other audio source, you can connect Priva II using 3.5mm / 6.35mm audio cable, RCA cable or Digital to Analog Audio Converter.

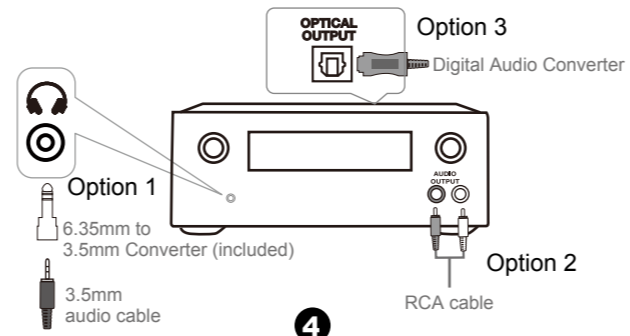

## DC mode

For charge free usage, you can set switch to "DC" and connect it to a DC power source. Then the transmitter will be ON when power is on & OFF when power is off.

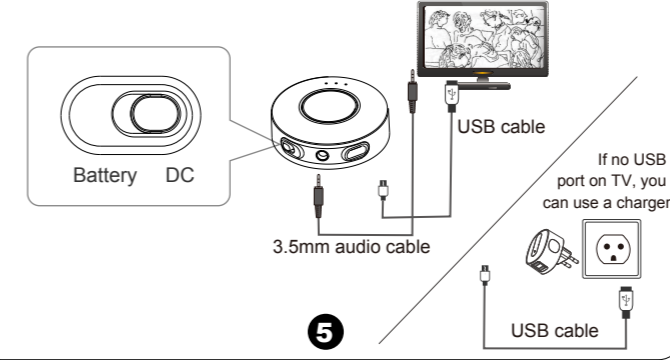

## DC mode VS Battery mode

In Battery mode, Priva II will automatically turn off once disconnected for over 10 minutes. In DC mode, Priva II will stay on standby until reconnected.

## Status of Priva II by the LED indications

Status	LED indicator
Power on	LED flashes BLUE for 1 second
Power off	LED flashes RED for 1 second
Pairing mode	LED blinks BLUE and RED alternately
Connected with SBC codec	LED flashes BLUE once every 5 seconds
Connected with aptX codec	LED flashes BLUE 2 times every 5 seconds
Connected with aptX-LL codec	LED flashes BLUE 3 times every 5 seconds
Disconnected	LED flashes BLUE once every 10 seconds
Restored factory default settings	LEDs flash BLUE and RED together (like PINK) for 2 seconds
Low battery	LED flashes RED 2 times every second

# Priva II FAQs and Tips

## 1. Why is there still a delay?

This could be because your headphone or receiver doesn't support aptX Low Latency Codec.

### Audio delay when paired with different headphones/receiver-

Headphones/receiver support -	The audio delay will be
aptX Low Latency codec	~ 40ms
aptX codec	~ 180ms
SBC codec (most standard Bluetooth audio)	~ 250ms
Dual link mode	~ 180~250ms

## 2. How do you reconnect?

1 Turn both devices on 2 Wait for 5-10s 3 If it does not reconnect, press the 4 MFB on Priva II once or twice.

## 3. What is the range of Priva II?

Up to 10m/30 feet line of sight. Priva II works best if there is a clear path from the antenna to the receiver

## 4. How do you reset (clear paired device info) Priva II?

Step 1. Set Priva II to pairing mode – press and hold 4 for 2~4 seconds until the LED flashes BLUE and RED alternately.  
Step 2. Double click the 4 MFB, then you will see the BLUE and RED LEDs flash together quickly.  
Step 3. Power it off manually and then it will enter pairing mode automatically once power is on.

## 5. How do you charge / power Priva II?

You can connect Priva II via the supplied micro USB cable to your own USB chargers (wall charger/travel charger/mobile phone charger, etc.) with 5V/500mA-1A, or PC/TV USB port.

More FAQs on [support.avantree.com](http://support.avantree.com)  
Video user guide for Priva II on [Youtube.com](https://www.youtube.com)  
Telephone support: booking from [Avantree.com](http://Avantree.com)  
24h Email support: [support@avantree.com](mailto:support@avantree.com)



Scan for video user guide