

Netvue Technologies Co.,Ltd.

Address:

A501-502, Academy of Aerospace Technology,
10th Kejinan Road, Shenzhen Science Park,
Nanshan District, Shenzhen, P.R.China

Customer Service : +1 (866) 749-0567

Fax : +86-755-8660 7322

Email : support@netvue.com

Website : www.netvue.com

©Netvue Technologies Co., Ltd
All rights reserved.

Version 1.1



netvue
Orb Cam

Quick Start Guide

Quick Start Guide

1. Packing list



Orb Cam *1



Quick Start Guide *1



Mounting Bracket *1



Screw Accessories *1



Location label *1

2. Diagram

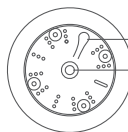

Bottom

- Reset
- Support hole

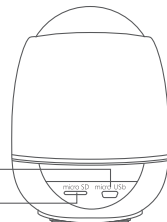

Back

- Power input
- TF card

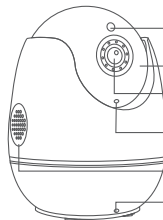

Side

- Light sensor
- Night vision lights
- Lens
- Indicator light
- Speaker
- Microphone

3. App Set-up



App Store



Google Play

Scan QR code to download
netvue app

4. Connect Device

1. Connect with matched adapter (DC 5V, 2A).
2. Depending on the status of the indicator light, check the camera status.

LED Indicator Status

Green:

- A. Flash slowly: Connecting server.
- B. Solid green: Connected server.
- C. Flash rapidly: WiFi configuration mode.

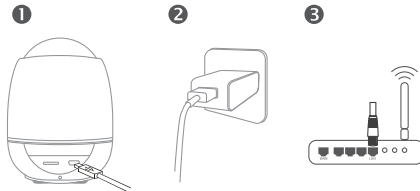

5. Sign in and add device

1. Open the APP, register an account and log in.

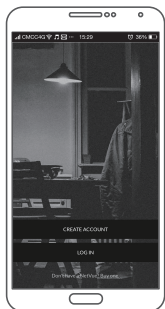

Open the app

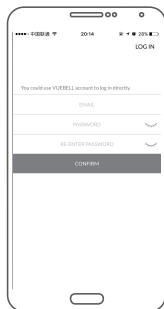

Register account

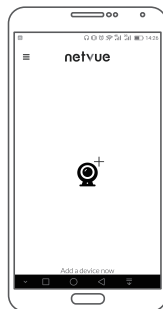

Add device

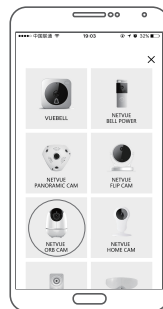

Choose Netvue Orb Cam

2. After logging in, click “+” sign, and choose Netvue Orb Cam.

3. Configure WiFi step by step.

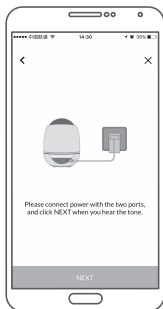

Connect power



Enter password

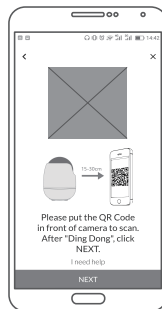

Scan QR code

4. Device added successfully. Return to app home page, your device should appear in the list of devices.

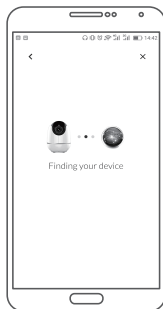

Device added



Device list

1. Use a valid email address to register your account.
2. Keep the device in a 2.4G WiFi environment with good signal.
3. After connecting to power, the device will make a "Di" sound for 3 seconds. Afterwards press the reset button, the indicator light will then flash rapidly.
4. Strong lights may interfere with the ability for the device to read the QR code.
5. After connecting to the router, the device will make a "ding dong" sound effect. After connecting to the server successfully, it will play a cheerful chime; if it fails, it will play a sad sound effect.
6. If the server fails to connect, you may scan the device ID to connect the device.

6. How to use

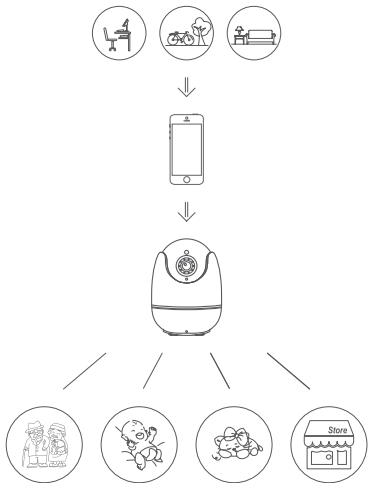

4. Congratulations! You have completed installation of your camera, you can watch your home anywhere and anytime.

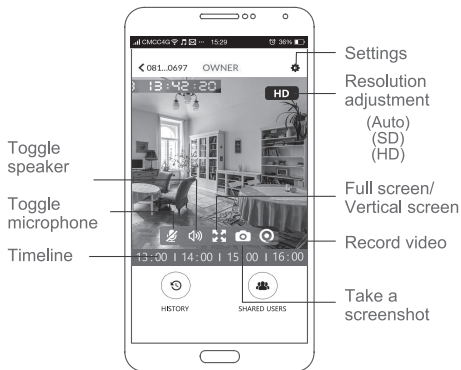

7. Caution

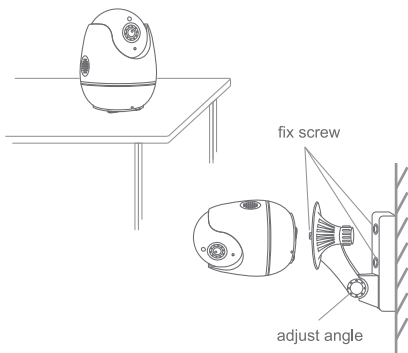

1. The device should be kept in open areas away from metal, avoid placing behind furniture or near microwaves. Keep away from areas with lots of cables if possible. Try to keep your device within range of your WiFi signal. For best results, keep as close to the source of WiFi as possible.

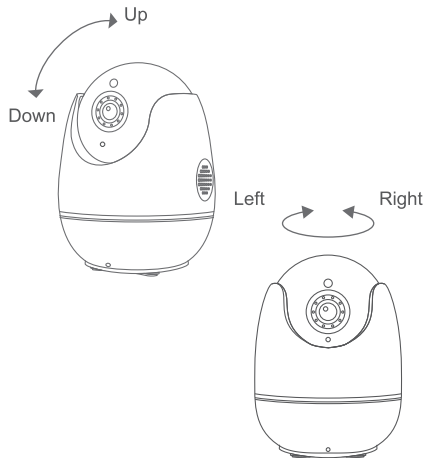

2. When moving your device to a new place with a different WiFi, reconfigure your WiFi settings following the instructions on the app.

8. FCC warning

1. This device complies with Part 15 of the FCC rules. Operation is subject to the following two conditions:

- (1) This device may not cause harmful interference .
- (2) This device must accept any interference received,including interference that may cause undesired operation.

2. Changes or modifications not expressly approved by the party responsible could void the user's authority to operate the equipment.

NOTE:This equipment has been tested and found to comply within the limits for Class B digital device, pursuant to Part 15 of the FCC Rules.These limit a design to provide reasonable protection against harmful interference in residential installation.

This equipment generates uses and can radiate radio frequency energy and, if not installed and used in accordance with the instructions, may cause harmful interference to radio communication. However, there is no guarantee that interference will not occur in a particular installation .If this equipment does cause harmful interference to radio or television reception, which can be determined by turning the equipment off and on .

RF Exposure warning statement

The antennas used for this transmitter must be installed to provide a separation distance of at least 20cm from all persons and must not be collocated or operating in conjunction with any other antenna or transmitter.

CE RED

This product can be used across EU member states.

How to connect to Alexa

Before downloading Amazon Alexa, please change the names of your devices in your Netvue/Vuebell app so that they can be easily recognized by Alexa. For example, you may name your devices front door, back door, living room, office, desk etc.

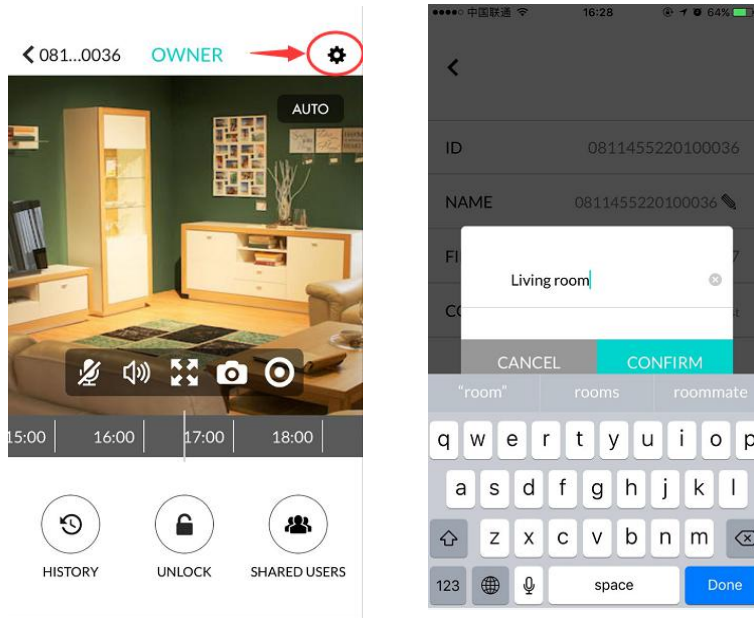

Now we are ready to connect Alexa to your device.

1. Download Amazon Alexa app.

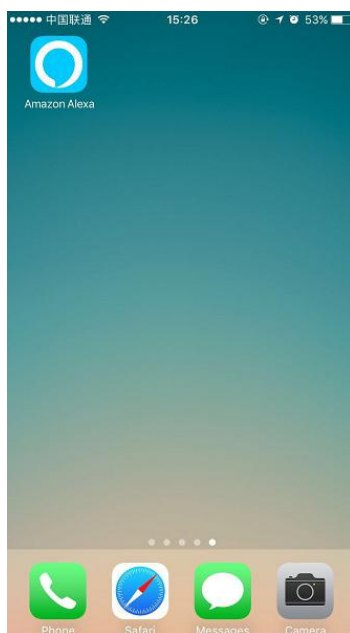

2. Sign in to your Amazon Account.

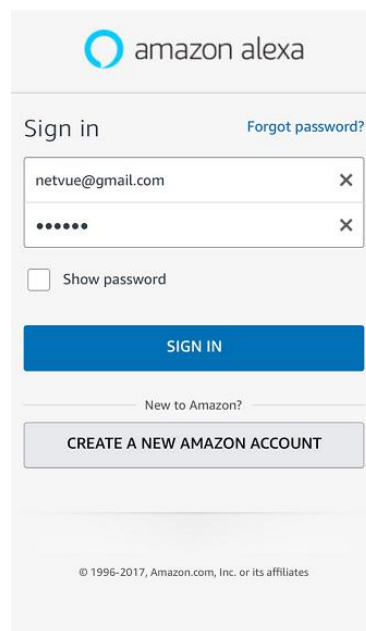

3. To continue with the following steps, please make sure Echo Show or FireTV has been added to your Amazon account and works normally. If there is no Echo Show or FireTV device available under your Amazon account, you will be unable to use this skill to play your Netvue or Vuebell devices.

In regards to how to add Echo Show or FireTV device, please refer to related document or ask the supplier for help.

4. Go to menu and choose skills.

5. Search for “Netvue” or “Vuebell”, choose Netvue Live Video, then click enable.

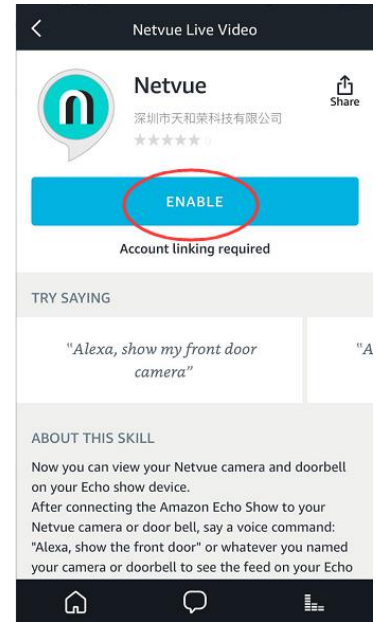
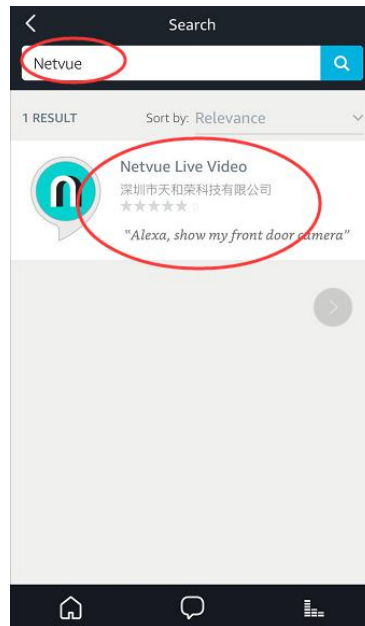
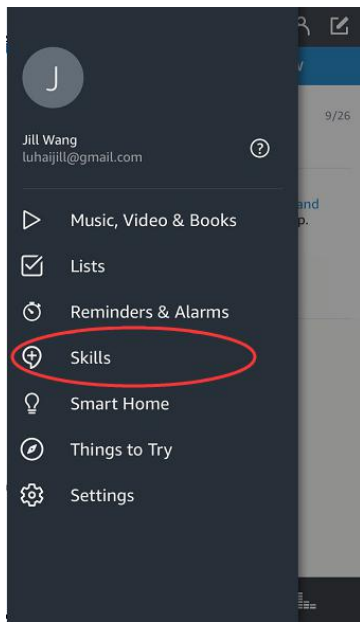

6. Sign in to your Netvue or Vuebell account.

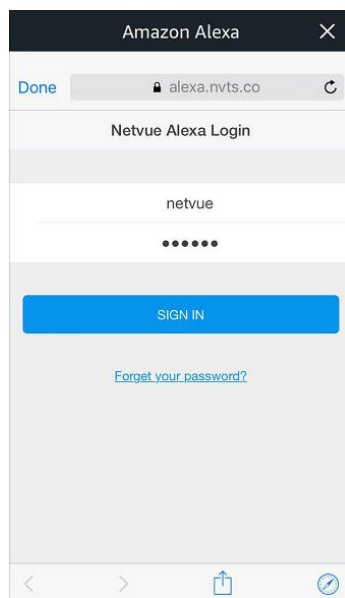

7. Discover devices (please make sure you have already added the devices to your Netvue/Vuebell account). You can discover your devices by clicking "discover devices" or speaking to your Echo Show/FireTV, "Alexa, discover devices".

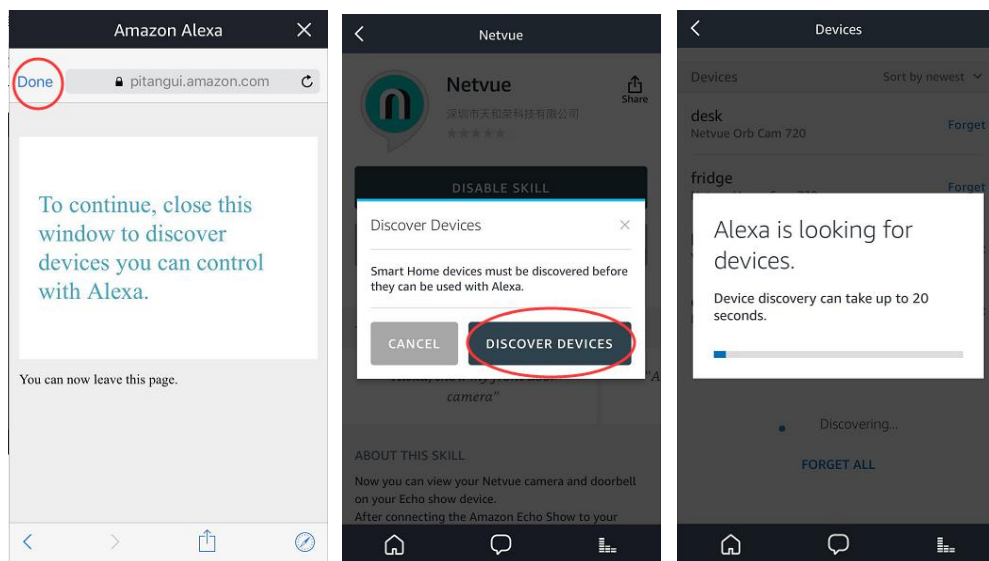

8. You can find your device list in the Amazon Alexa app under the "Smart Home" tab. If no device is shown, try discovering again.

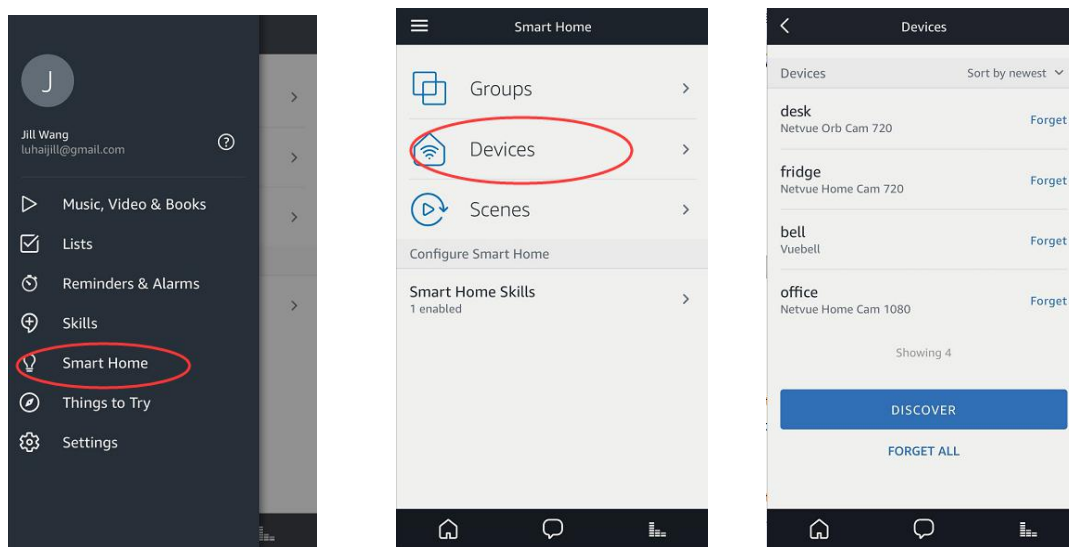

9. After discovering devices, speak to Echo Show/FireTV to view your cameras. For example, you may say "Alexa, show me living room", "Alexa, I wanna see office camera", "Alexa, show desk" and etc.

10. Enjoy your smart home life!

Note: In order to switch to another Netvue/Vuebell account, you need to **disable** Netvue skill first and enable it again.



Size and weight	3.5in x 3.5in x 4.6in (9cm x 9cm x 11.8cm)
	Mass:9.3oz (265g)
Color	White
Camera	1/1.27-inch,2-megapixel color sensor,8x digital zoom on Android and 3x on iOS
Video	Up to 1080p (1920X1080) at 30 frames/sec
Field of view	72°horizontal
Audio	Built-in speaker, high-quality microphone
Lights	Status light and RGB light ring
Night Vision	10 high-pwer 850 nm infrared LEDs
App	Netvue App on iOS and Android system (iOS 7 or later and Anroid 4 or later)
Operating Temperature	-4°F to 122°F (-20°C to 50°C)
Weather resistance	IP40 rating
Power	AC adapter input: 110V
Security	128-bit AES with TLS/SSL
In the box	Orb camera,power adapter,mounting bracket,screws,quick start guide,screw position label
Wireless	802.11b/g/n @ 2.4GHZ
Connectivity requirements	802.11b/g/n @ 2.4GHZ.
Bandwidth requirements	Working internet with at least 1Mbps upload speed. For optimal video experience, working interent with at least 2Mbps upload speed.
Warranty	1-year limited warranty.