



SR2AK9000UG Series

POWERbot

user manual

- * Before operating this unit, please read the instructions carefully.
- * For indoor use only.

English

imagine the possibilities

Thank you for purchasing a Samsung product.

SAMSUNG

Contents

03 Safety information

10 Installation

Accessories

12 Charging

Automatic charging / Recharging / Low battery

14 Using POWERbot

Selecting cleaning modes / Using Energy-saving mode

17 Using the remote control

18 Name of each part

Top / Bottom / Display panel

19 Cleaning and maintaining

Cleaning the dustbin / Cleaning the sensors and the camera / Cleaning the Pet brush / Cleaning the Driving wheel

21 Notes and cautions

Charging / In use / Cleaning and maintenance / About battery

23 Information codes

24 Troubleshooting

25 Open Source Announcement

26 Specifications

Safety information

SAFETY INFORMATION



- Before operating the appliance, please read this manual thoroughly and retain it for your reference.



- Because these following operating instructions cover various models, the characteristics of your vacuum cleaner may differ slightly from those described in this manual.

CAUTION/WARNING SYMBOLS USED



Indicates that a danger of death or serious injury exists.



Indicates that a risk of personal injury or material damage exists.

OTHER SYMBOLS USED



Indicates that the following text contains additional important information.

State of California Proposition 65 Warning (US only)



This product contains chemicals known to the State of California to cause cancer and birth defects or other reproductive harm.



For battery recycling go to call2recycle.org;
or call 1-800-822-8837

Safety information

IMPORTANT SAFETY INSTRUCTIONS

When using an electrical appliance, basic precautions should be observed, including the following:

READ ALL INSTRUCTIONS BEFORE USING YOUR POWERbot.

Unplug from outlet when not in use and before conducting maintenance.

WARNING: to reduce the risk of fire, electric shock, or injury:

GENERAL

- Use only as described in this manual.
- Do not operate POWERbot or the adapter / docking station if it has been damaged in any way.
- If the vacuum cleaner is not working as it should, has been dropped, damaged, left outdoors, or dropped in water, return it to a customer care center.
- Do not handle the adapter / docking station or POWERbot with wet hands.
- Use only on dry, indoor surfaces.
- This appliance can be used by children aged from 8 years and above and persons with reduced physical, sensory or mental capabilities or lack of experience and knowledge if they have been given supervision or instruction concerning use of the appliance in a safe way and understand the hazards involved.
- Children shall not play with the appliance. Cleaning and user maintenance shall not be made by children without supervision.

Adapter / Docking station

- Do not modify the polarized plug to fit a non-polarized outlet or extension cord.
- Do not use outdoors or on wet surfaces.
- Unplug the adapter / docking station from the outlet when not in use and before servicing.
- Use only the adapter / docking station supplied by the manufacturer to recharge.
- Do not use with a damaged cord or plug or a loose power outlet.
- Do not pull or carry by the cord, use the cord as a handle, close the door on the cord, or pull the cord around sharp edges or corners. Keep the cord away from heated surfaces.
- Do not use extension cords or outlets with inadequate current carrying capacity.
- Do not unplug by pulling on the cord. To unplug, grasp the plug, not the cord.
- Do not mutilate or incinerate batteries as they will explode at high temperatures.
- Do not attempt to open the adapter / docking station. Repairs should only be carried out by a qualified customer care center.

- Do not expose the adapter / docking station to high temperatures or allow moisture or humidity of any kind to come into contact with the adapter / docking station.

POWERbot

- Do not pick up hard or sharp objects such as glass, nails, screws, coins, and etc.
- Do not use without a filter in place. When servicing the unit, never put fingers or other objects into the fan chamber in case the unit accidentally turns on.
- Do not put any objects into openings. Do not use with any openings blocked; keep openings free of dust, lint, hair, and anything that may reduce air flow.
- Do not pick up toxic materials (chlorine bleach, ammonia, drain cleaner, etc.).
- Do not pick up anything that is burning or smoke, such as cigarettes, matches, or hot ashes.
- Do not use to pick up flammable or combustible liquids such as gasoline, nor use on areas where they may be present.
- Locations with candles or desk lamps on the floor.
- Locations with unattended fires (fire or embers).
- Locations with distilled alcohol, thinner, ashtrays with burning cigarettes, etc.
- Do not use POWERbot in an enclosed space filled with vapours given off by oil based paint, paint thinner, moth proofing substances, flammable dust, or other explosive or toxic vapours.
- Leaks from battery cells can occur under extreme usage or temperature conditions. If the liquid gets on skin, wash quickly with water. If the liquid gets into the eyes, flush them immediately with clean water for a minimum of 10 minutes. Seek medical attention.

SAVE THESE INSTRUCTIONS

POLARIZED PLUG INSTRUCTIONS

- To reduce the risk of electric shock, this appliance has a polarized plug (one blade is wider than the other). This plug will fit in a polarized outlet only one way. If the plug does not fit fully in the outlet, reverse the plug. If it still does not fit, contact a qualified electrician to install a proper outlet. Do not modify the plug in any way.

Safety information

REGULATORY NOTICE

1. FCC Notice



FCC CAUTION:

- Any changes or modifications not expressly approved by the party responsible for compliance could void the user's authority to operate the equipment.
- This device complies with Part 15 of FCC Rules. Operation is Subject to following two conditions:
 1. This device may not cause harmful interference, and
 2. This device must accept any interference received including interference that cause undesired operation.
- For product available in the USA/Canada market, only channel 1 ~ 11 can be operated. Selection of other channels is not possible.

FCC STATEMENT:

- This equipment has been tested and found to comply within the limits for a Class B digital device, pursuant to part 15 of the FCC Rules. These limits are designed to provide reasonable protection against harmful interference in a residential installation.
- This equipment generates, uses, and can radiate radio frequency energy and, if not installed and used in accordance with the instructions, may cause harmful interference to radio communications. However, there is no guarantee that interference will not occur in a particular installation. If this equipment does cause harmful interference to radio or television reception, which can be determined by turning the equipment off and on, the user is encouraged to try to correct the interference by one or more of the following measures:
 - Reorient or relocate the receiving antenna
 - Increase the separation between the equipment and receiver
 - Connect the equipment into an outlet on a different circuit from that to which the receiver is **connected**
 - Consult the dealer or an experienced radio/TV technician for help.

FCC RADIATION EXPOSURE STATEMENT:

- This equipment complies with FCC radiation exposure limits set forth for an uncontrolled environment. This equipment should be installed and operated with a minimum distance of 20cm between the radiator and your body. This device and its antenna(s) must not be co-located or operation in conjunction with any other antenna or transmitter.

2. IC Notice

- The term “IC” before the radio certification number only signifies that Industry Canada technical specifications were met. Operation is subject to the following two conditions: (1) this device may not cause interference, and (2) this device must accept any interference, including interference that may cause undesired operation of the device.
- This Class B digital apparatus complies with Canadian ICES-003.
- Cet appareil numérique de la classe B est conforme à la norme NMB-003 du Canada.
- For product available in the USA/Canada market, only channel 1 ~ 11 can be operated. Selection of other channels is not possible.

IC RADIATION EXPOSURE STATEMENT:

- This equipment complies with IC RSS-102 radiation exposure limits set forth for an uncontrolled environment. This equipment should be installed and operated with minimum distance 20cm between the radiator & your body. This device and its antenna(s) must not be co-located or operation in conjunction with any other antenna or transmitter.

Open Source License Notice

- This device uses open source software. Open Source Licenses are available on the product menu.
- Tap “Settings > Network > Software Update > Legal Information” on the device for more details.

Safety information

WARNING Power related

- ▶ Please prevent any risk of electric shock or fire.
 - Do not damage the power cord.
 - Do not pull the power cord too hard or touch the power plug with wet hands.
 - Do not use a power source other than 100-240 V~ and also do not use a multi outlet to supply power to number of devices at the same time. (Do not leave the cord carelessly on the floor.)
 - Do not use a damaged power plug, power cord or loose power outlet.
- ▶ Clean dust or any foreign matters on the pin and contact part of the power plug.
 - There is a risk of electric shock or malfunction.

WARNING Before use

- ▶ Do not use POWERbot near combustible materials.
 - Place near candle, desktop lamps, fireplace or near combustible materials such as gasoline, alcohol, thinners etc.
- ▶ The POWERbot is intended for household use therefore do not use it in an attic, basement, storage, industrial building, out of indoor space, places with moisture (such as bathroom, laundry), on the table or shelves.
 - The POWERbot can be damaged or malfunction.
- ▶ Be sure POWERbot does not pass through or touch any kind of liquids.
 - The POWERbot can be severely damaged and it may contaminate other areas if the wheels pass through liquid.
- ▶ Do not spill any liquids on the docking station.
 - There is a risk of fire or electric shock.

- ▶ Do not use the docking station for anything other than its intended purpose.
 - There is a risk of fire or severe damage to the docking station.
- ▶ Always keep the cliff sensor clean for your safety.

WARNING In use

- ▶ If any abnormal sounds, smells or smoke come from POWERbot, immediately shut off the emergency switch at the bottom of POWERbot and contact a service center.

WARNING Cleaning and maintenance

- ▶ When power cord is damaged, contact a service center to get it replaced by a certified repairman.
 - There is a risk of fire or electric shock.
- ▶ Please check with a Samsung Electronics service center when exchanging batteries.
 - Using batteries from other products can cause malfunction.

**CAUTION****Before use**

- ▶ Insert the dustbin before using POWERbot.
- ▶ Be careful with the followings for proper automatic recharging.
 - Always turn on the power of the docking station.
 - Install the docking station where POWERbot can easily find.
 - Do not leave any object in front of the docking station.
- ▶ When installing the docking station, do not leave the cord carelessly on the floor since POWERbot may get tangled by it.
- ▶ Do not use POWERbot on black colored floors.
 - The POWERbot may not be able to operate normally.
- ▶ Do not pick up POWERbot by the dustbin holder.
- ▶ Do not place any objects within 2 ft (0.5 m) to both sides and 4 ft (1 m) to the front of the docking station.
- ▶ Make sure the docking station's charging contact is not damaged or have any foreign matters on it.
- ▶ Do not install the docking station in an area with a dark floor.
 - If the floor around the docking station is dark, recharging is hindered.
- ▶ Move any obstacles that may disturb POWERbot's movement (such as children's indoor swing or slides) before cleaning.

**CAUTION****In use**

- ▶ Using POWERbot on thick carpet may damage both POWERbot and the carpet.
 - The POWERbot cannot pass over carpet that is thicker than 0.4 in (1 cm).
- ▶ Do not use POWERbot on tables or other high surfaces.
 - There is a risk of damage if it falls.
- ▶ The POWERbot may bump into chair, desk legs therefore move them away for faster and efficient cleaning.
- ▶ When POWERbot is operating, do not lift it up or carry it to another area.
- ▶ Do not hold by driving wheels of POWERbot when carrying it to another area.
- ▶ Do not put any objects on top of POWERbot since it may cause malfunction.
- ▶ Remove any large papers or plastic bags immediately when using POWERbot since they may block the intake.
- ▶ Do not aim the red pointer directly at people or animals.

**CAUTION****Cleaning and maintenance**

- ▶ Prevent any damage to POWERbot by complying with the following.
 - Do not clean POWERbot by spraying water directly onto it or use benzene, thinner, acetone or alcohol to clean it.
- ▶ Do not disassemble or repair POWERbot. This should only be done by a certified repairman.
- ▶ Always keep the obstacle sensor and cliff sensor clean.
 - If foreign matter accumulates, sensors may malfunction.

Installation

The docking station must be plugged in and turned on at all times.

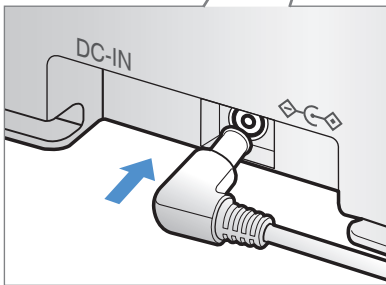
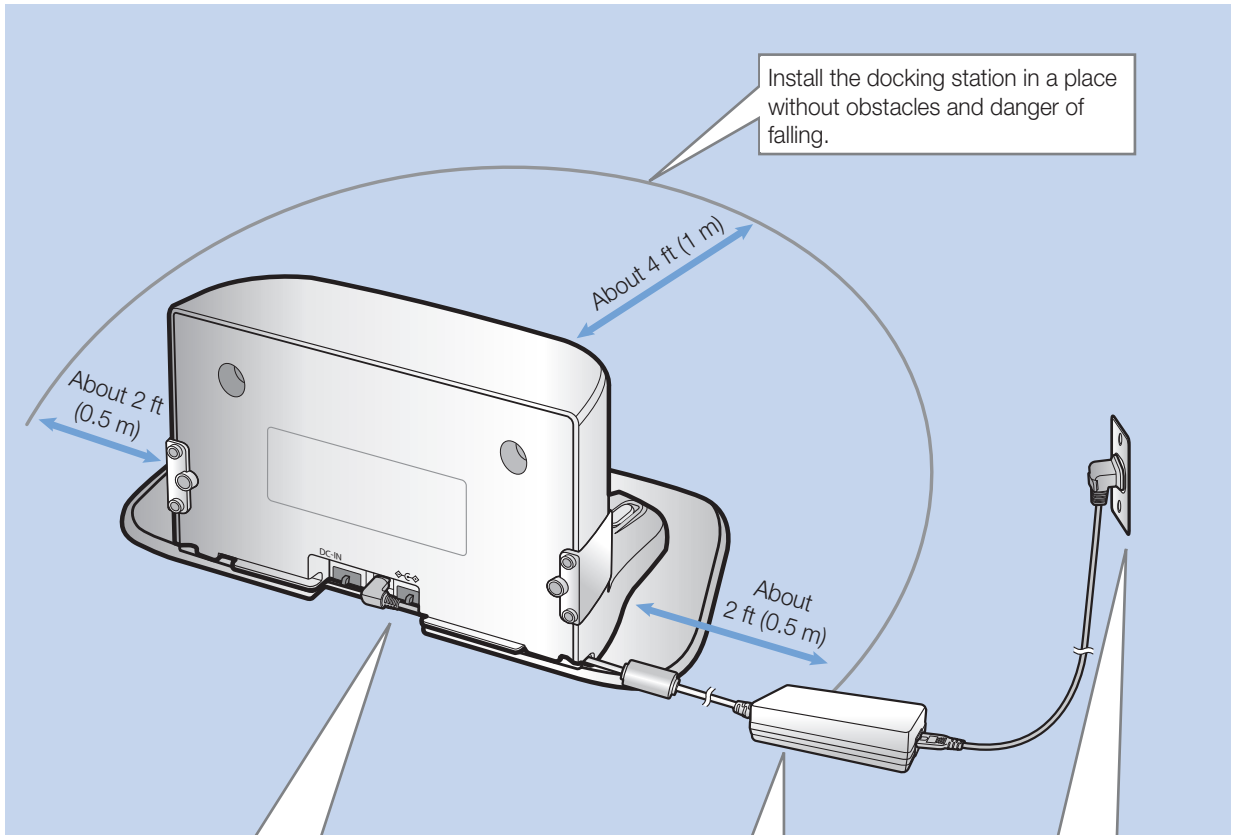

- 1** Connect the adapter jack to the docking station

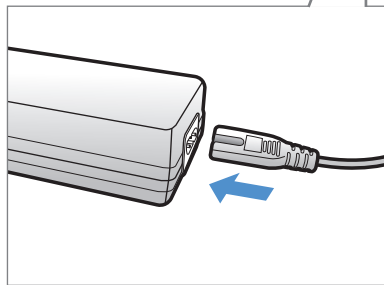

- 2** Connect the power cord to the adapter

When using the adapter, the side with the sticker attached must face down.

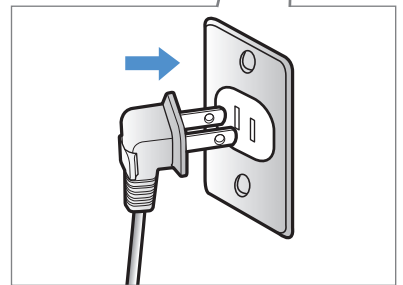

- 3** Connect the power plug to the outlet

Accessories

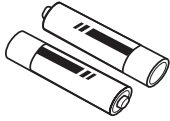
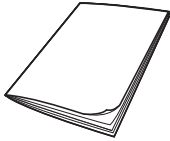
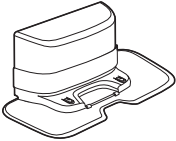
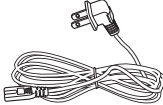
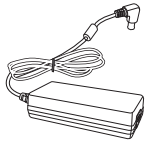
 <p>Remote control</p>	 <p>Batteries (AAA type)</p>	 <p>User manual</p>
 <p>Docking station</p>	 <p>Power cord</p>	 <p>Adapter</p>

Note

- ▶ Install the docking station in a place where the floor and wall are level.
- ▶ It is best to install the docking station along the grain of wooden floors.
- ▶ If the emergency switch is off, the POWERbot will not charge even if it is docked on the docking station.
- ▶ Always turn on the power of the docking station.
 - If power is not supplied to the docking station, the POWERbot cannot find it and cannot automatically recharge.
 - If the POWERbot is left detached from the docking station, the battery will drain naturally.
- ▶ If the POWERbot is in sleep mode, power will not come on even if the emergency switch is turned off and then on. Press and hold the [Start/Stop] button on the POWERbot to turn off the sleep mode.

Charging

It takes approximately 240 minutes to completely charge the POWERbot when charging it for the first time after purchase. Once charged, the POWERbot can be used for approximately 60 minutes.



• Rated input voltage of this product is 100-240 V~.

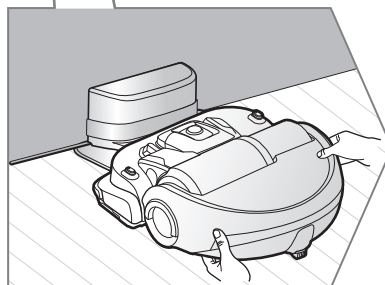
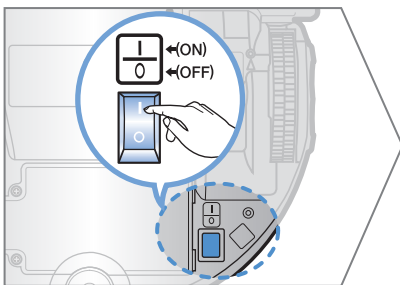
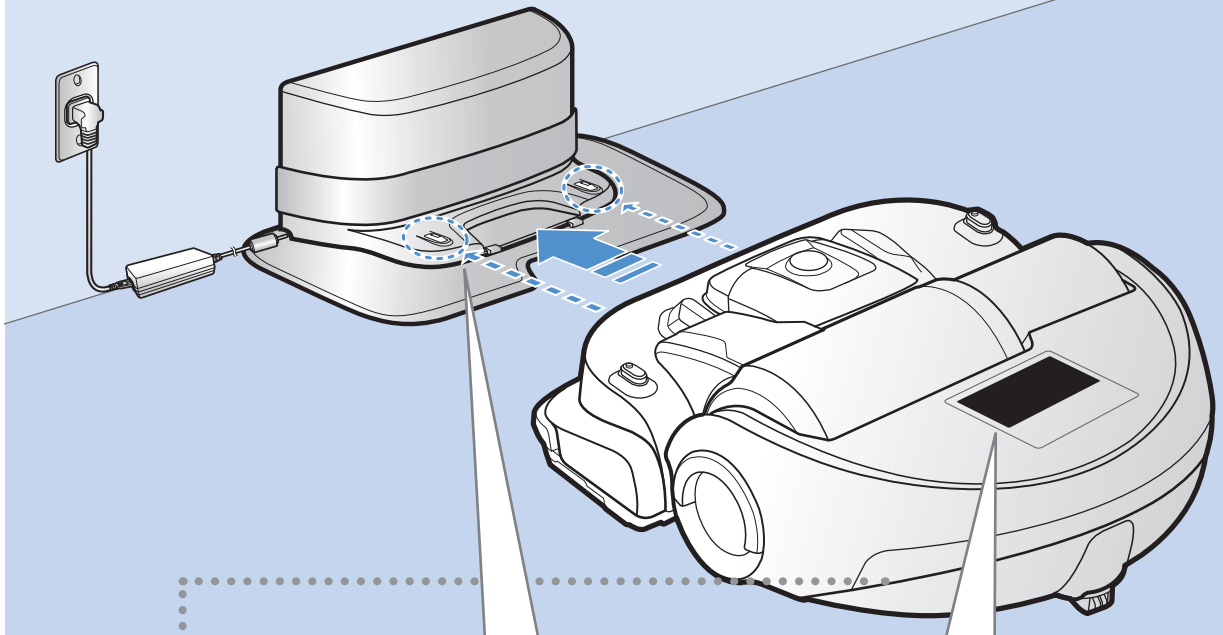







1 Turn on the emergency switch on the bottom

You must turn on the emergency switch to turn on the POWERbot.

2 Manually charge the POWERbot by placing it on the docking station

Make sure the charging pins on the POWERbot and the docking station are aligned.

3 Check the charging status

“      ” appear in the sequence to show charging progress. All the 6 icons appear when charging is complete.

Automatic charging

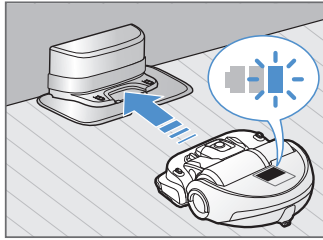

When the battery indicator blinks during cleaning, the POWERbot will return to the docking station to charge itself automatically.

Recharging



You can command the POWERbot to recharge at the docking station while it is in cleaning.

Low battery

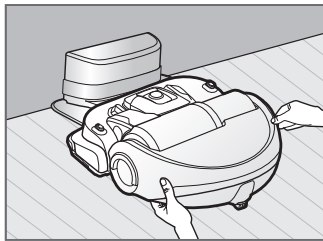

Manually charge the POWERbot by placing it on the docking station.

Steps to take if recharging not occurring:

Check the installation status of the docking station when:

- ▶ the docking station is located in a place where the POWERbot cannot easily access it.
- ▶ the distance between the docking station and POWERbot is over 16.5 ft (5 m).
 - It may take a long time for POWERbot to return to the docking station for recharging

Manually charge the POWERbot when:

- ▶ the docking station is located in a corner
- ▶ the battery is fully exhausted
- ▶ the POWERbot is immobilized by an obstacle (furniture etc.)
- ▶ the POWERbot can't climb a threshold near the docking station (The maximum height of a threshold the POWERbot can climb is about 0.6 inches (1.5 cm).)
- ▶ the battery indicator blinks
- ▶ the POWERbot is set to the Spot clean or Manual clean mode

Using POWERbot

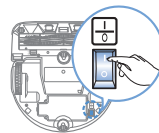

You must turn on the emergency switch on the bottom of the unit before using POWERbot.

Turning the power on/off

Press the  button for more than 3 seconds



- When POWERbot is not used for 30 minutes, power will turn off automatically.

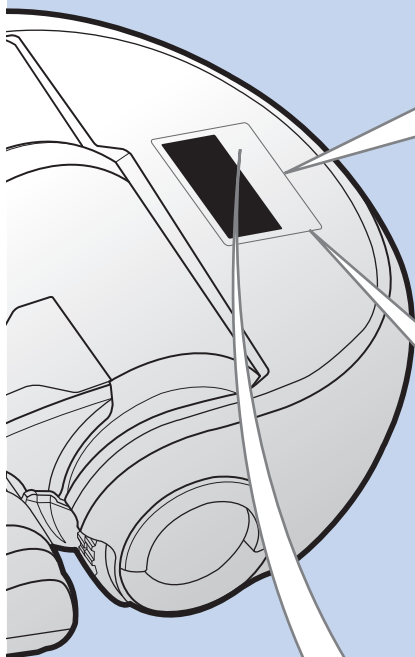

Starting Auto clean mode

Press and release this button. Cleans all set places until the battery is depleted.



* Stop cleaning: Press and release the  button

Starting Spot clean mode

Press and release this button. The POWERbot cleans a localized area intensely.







Recharging

► Recharging

You can command POWERbot to recharge at the docking station automatically while it is cleaning by pressing this button.



Selecting cleaning modes

Cleaning mode	How to select	Displayed icon
Auto clean		
Spot clean		
Manual clean	* The movement and direction of the POWERbot is controlled by the remote control.	

* When the POWERbot is being charged, you can select the Auto clean mode only.

* If the POWERbot fails to return to the charger, it will be turned into the sleep mode. Then the display panel of the main body will be turned off. Press [Start/Stop] or [Power] button to cancel the sleep mode.

* Charging and cleaning times may differ according to conditions of use.



<Displayed icons in the sleep mode>

Cleaning method for each modes

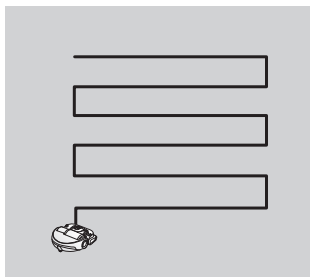

Auto clean

Cleans all set places until the battery is depleted.

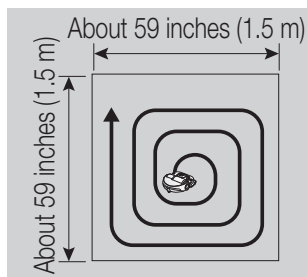

Spot clean

Cleans a localized area intensely. It can be used to clean bread or cookie crumbs.

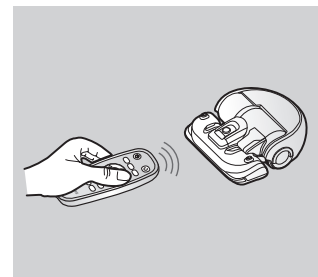



Manual clean

You can control the POWERbot with the remote control and direct it to clean a desired spot.

Using POWERbot

Using Energy-saving mode

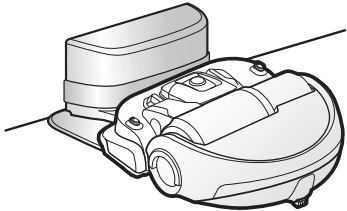
You may select the Energy-saving mode to save energy during battery charging. Energy-saving mode turns off all functions except battery charging. It reduces the power consumption while you are away from home for an extended period of time.

How to select or cancel		Displayed icon
	 Press for 5 sec.	 *: About 3 seconds later, the previous indicator will appear.

*: When the POWERbot is charging in Energy-saving mode, recharging icon (🏠) is turned on and the other icons (AUTO, 📦, 🌀, 🌀, 🏠) blink in order.

Note

- ▶ If you select the Auto/Max/Manual clean mode or press Point cleaning button, the Energy-saving mode will be cancelled.
- ▶ During the Energy-saving mode, setting the schedule will cancel the Energy-saving mode.
 - If you select the Energy-saving mode after setting the schedule, the schedule will not be cancelled.
- ▶ If the power of the docking station is off, the Energy-saving mode will be cancelled.

Using the remote control

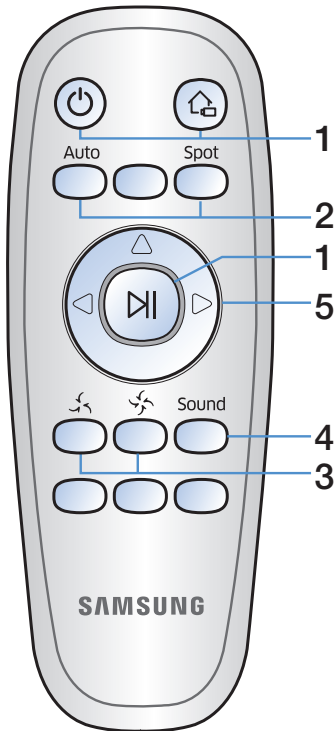

Inserting batteries

Open the battery cover by lifting it up while pressing the locking tab, and then insert the batteries as shown in the illustration. Then, close the cover until it clicks into place.

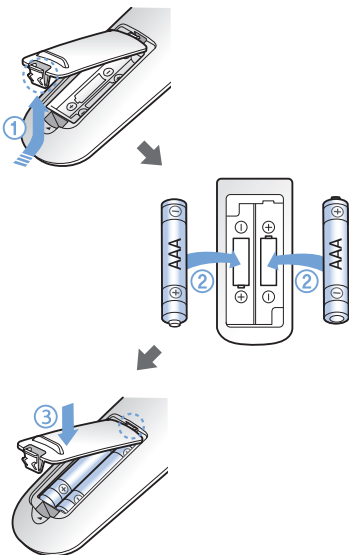

1 Power/Recharging

Power		Turn POWERbot's power on/off
Recharging		Select to recharge POWERbot at the docking station while it is cleaning.
Start/Stop		Select to start or stop cleaning

2 Cleaning modes

Auto clean		Cleans all set places until the battery is depleted.
Spot clean		Select to clean a localized area intensely

3 Suction modes

Normal mode		Select to clean with normal suction power
Turbo mode		Select to clean with turbo suction power

4 Additional functions

Sound		Each time you press this button, Sound Effects → Mute is selected in this sequence.
--------------	--	---

5 Direction control

Forward movement		Select to move forward
Left turn		Select to turn left
Right turn		Select to turn right

* Moving backward is not available

Name of each part

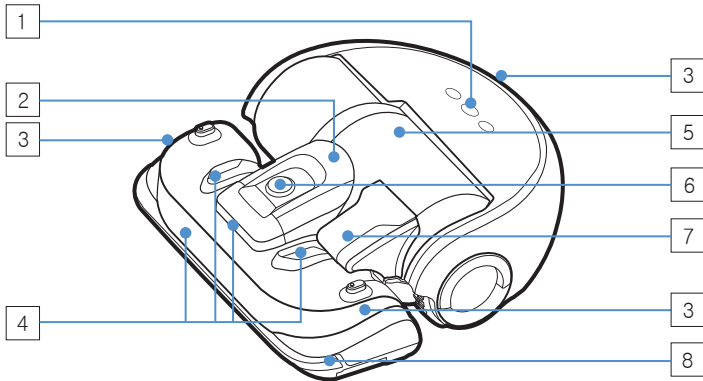

Top

1. Display panel
2. Dustbin holder
3. Remote control signal receiver
4. Obstacle sensor
5. Dustbin
6. Camera
7. Dustbin handle
8. Bumper sensor

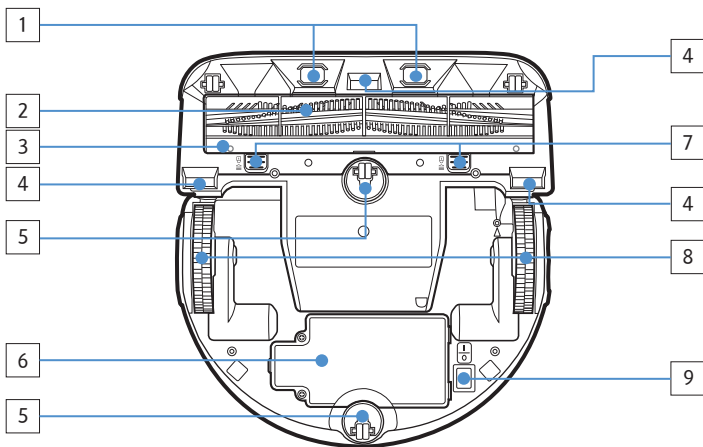

Bottom

1. Charge pins
2. Pet brush
3. Pet brush cover
4. Cliff sensor
5. Roller
6. Battery cover
7. Pet brush cover button
8. Driving wheel
9. Emergency switch

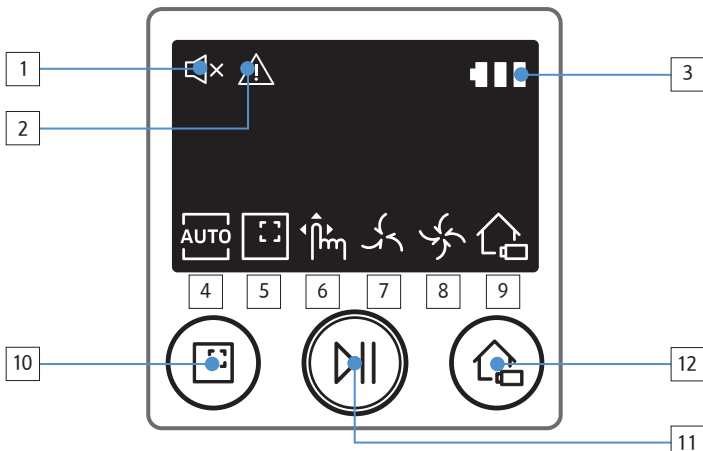

Display panel

1. Mute
2. Information indicator
3. Battery indicator
4. Auto clean
5. Spot clean
6. Manual clean
7. Normal mode
8. Turbo mode
9. Recharging
10. Spot cleaning button
11. Start/Stop button
12. Recharging button

Cleaning and maintaining

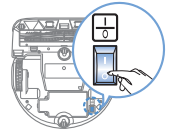

You must turn off the emergency switch before cleaning POWERbot.

Cleaning the dustbin

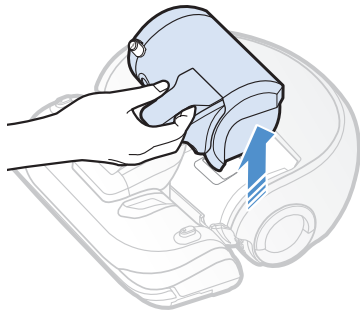

1 Remove the dustbin

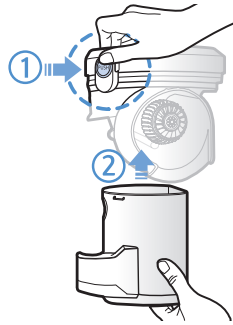

2 Remove the dustbin cover



3 Remove dust in the dustbin and cyclone unit

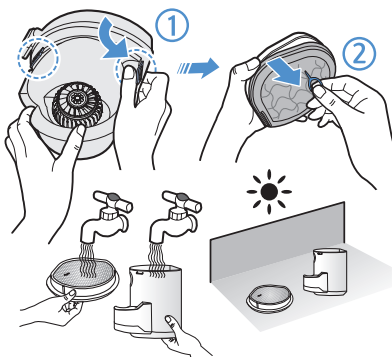

4 Detach the cyclone unit from the dustbin cover, and then wash the dustbin and the filter

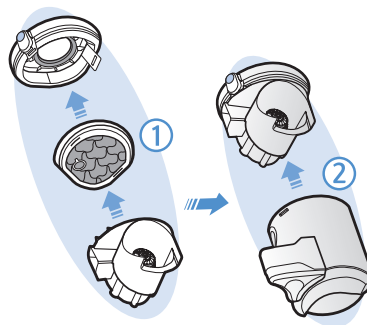

5 Reassemble the dustbin

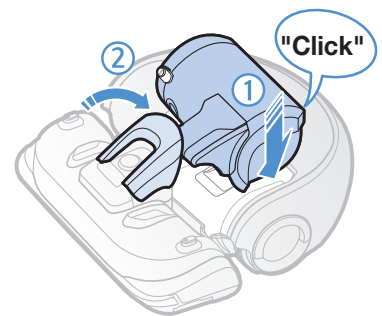

6 Reinsert the dustbin into the main body until it clicks

Cleaning the sensors and the camera

Lightly wipe with soft cloth. Do not use water or cleaning solutions.

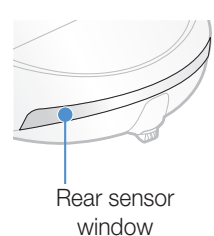
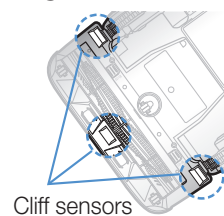
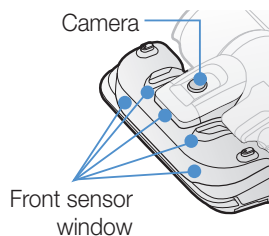
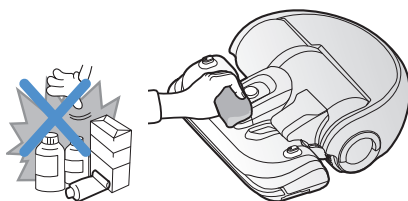

Cleaning and maintaining

Cleaning the Pet brush

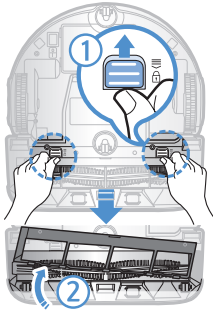

1 Remove the Pet brush cover

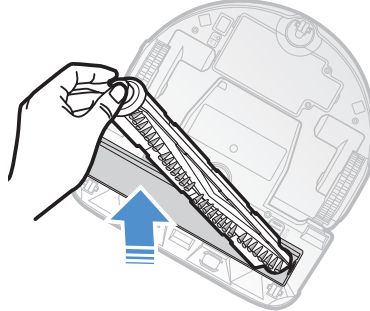

2 Remove the Pet brush



3 Clean the Pet brush

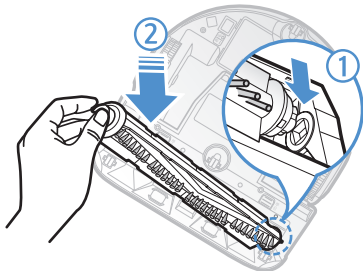

4 Reassemble the Pet brush

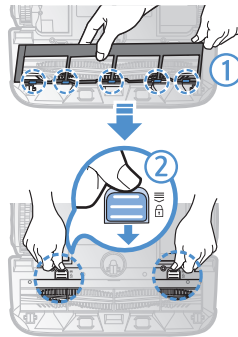

5 Reassemble the Pet brush cover

Cleaning the Driving wheel

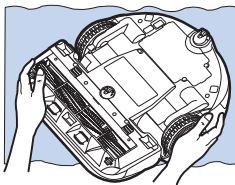

1 Put a soft cloth on the floor and place POWERbot upside-down on the cloth.

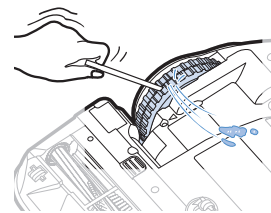

2 Use a blunt rod or tweezers to remove foreign matter.

Notes and cautions

Charging

Note

- ▶ If the battery overheats during charging, it may take longer to charge.
- ▶ When automatic charging is not working, do the following:
 - Turn the emergency switch (on the bottom of POWERbot) off and on again.
 - Unplug the docking station's power plug and then plug it back on.
 - Unplug the docking station, and then check whether there is any foreign matter on the charge pins and clean POWERbot and the charge pins of the docking station with a dry cloth or rag.
 - Check for any obstacles such as reflective objects, chairs, etc. near the docking station.
- ▶ If POWERbot is left detached from the docking station, the battery will drain naturally.
 - Try to keep POWERbot being charged on the docking station. (However, turn off the emergency switch and leave the docking station unplugged when planning to leave the house for long periods of time by going on a business trip or vacation, etc.)

In use

Note

- ▶ The POWERbot may get caught on thresholds, etc. during cleaning.
 - To restart operation, shut off the emergency switch, move the POWERbot to an area where it can move easily, and then turn on the power again.
- ▶ The POWERbot cannot completely clean areas it cannot enter, such as corners, between the wall and sofa, etc.
 - Please use another cleaning tool to clean them regularly.
- ▶ The POWERbot cannot vacuum clumps of dirt, so some may remain on the floor after cleaning.
 - Please use another cleaning tool to clean them regularly.
- ▶ If the battery becomes low during Auto clean mode, POWERbot will recharge and finish cleaning the remaining area after recharging. (Repeat cleaning frequency: 1 time)
- ▶ You cannot select and have the POWERbot execute Spot/Manual clean mode while it is charging.
- ▶ Do not unnecessarily move the POWERbot or press buttons while it is in Auto clean mode. It assumes that cleaning is complete and starts cleaning again from the beginning.
- ▶ Close doors before cleaning with the POWERbot. The POWERbot can enter rooms through thresholds even though the thresholds are below 1.9 in (5 cm).
- ▶ Try not to use the POWERbot at areas near slides, indoor swing, pots, fireplaces, or places with flame or moisture.
 - If not, it may cause the loss of property.
- ▶ Do not lie down around the POWERBOT that is running.
 - Your hair may be caught in the Pet brush, resulting in physical injury.

Notes and cautions

Cleaning and maintenance

Note

- ▶ If you washed the dustbin and filter with water
 - Dustbin: Completely wipe out the water.
 - Filter: Completely dry it in the shade before using.
- ▶ Purchase a filter at authorized Samsung service centers if you need more filters.

Caution

- ▶ Watch your fingers when attaching or detaching the filter, since they may get stuck in the dustbin's intake.
- ▶ To avoid blockages by foreign matter, do not let the POWERbot vacuum up toothpicks, cotton swabs etc.
- ▶ If it is difficult to remove foreign matter from the Pet brush, contact an authorized Samsung service center.
- ▶ Since the Pet brush removes dirt from the floor during cleaning, foreign matter such as thread, long hair, etc. may get caught in it. For the best cleaning results, check and clean it regularly.

About the battery

Note





- ▶ Purchase batteries at authorized Samsung service centers and check for the genuine part symbol (**SAMSUNG**) and model name before purchasing.
- ▶ This battery is exclusively for the Samsung Electronics POWERbot. Do not use it for any other product.
- ▶ Do not disassemble or modify the battery.
- ▶ Do not throw the battery out in fire or heat it.
- ▶ Do not connect any metallic object to the charging contacts (+, -).
- ▶ Store the battery indoors (at 32 °F~104 °F).
- ▶ If the battery malfunctions, do not disassemble it yourself. Contact your nearest Samsung service center.
- ▶ Battery charging time and usage time may decrease the more the battery is used. If the battery's lifespan has been exceeded and it no longer charges properly, have it replaced at a Samsung service center.
- ▶ The battery warranty period is 6 months from the date of purchase.

Information codes

1 The information codes below appear on the display panel

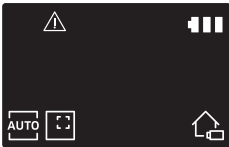
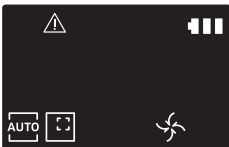
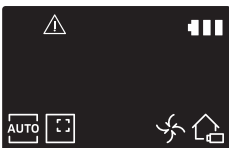
2 If a code appears, turn off the emergency switch and check the instructions below and take appropriate action

3 The information code will disappear when you turn on the emergency switch

Information codes	Checklist
	<p>The POWERbot is caught, stuck, trapped or lifted while moving around.</p> <ul style="list-style-type: none"> ▶ Turn off the emergency switch and move the POWERbot to another area.
	<p>Foreign matter caught in the Power brush.</p> <ul style="list-style-type: none"> ▶ Turn off the emergency switch and remove the foreign matter from the Power brush.
	<p>Foreign matter caught in the left Driving wheel.</p> <ul style="list-style-type: none"> ▶ Turn off the emergency switch and remove the foreign matter from the Driving wheel.
	<p>Foreign matter caught in the right Driving wheel.</p> <ul style="list-style-type: none"> ▶ Turn off the emergency switch and remove the foreign matter from the Driving wheel.
	<p>Bumper sensor needs to be checked.</p> <ul style="list-style-type: none"> ▶ Turn off the emergency switch and turn it back on. ▶ Contact a service center if information code does not disappear.
	<p>Foreign matter accumulated on the obstacle sensor.</p> <ul style="list-style-type: none"> ▶ Turn off the emergency switch and clean the front and rear sensor with a soft cloth.
	<p>Foreign matter accumulated on the cliff sensor.</p> <ul style="list-style-type: none"> ▶ Turn off the emergency switch and clean the cliff sensor with a soft cloth.

Troubleshooting

Symptom	Checklist
The POWERbot is not working at all.	<ul style="list-style-type: none"> ▶ Check if the emergency switch is on. ▶ Check if all the icons are displayed on the display panel. ▶ Check if the POWERbot's battery is depleted. ▶ Replace the batteries (AAA type) if the remote controller is not working.
The POWERbot has stopped during cleaning.	<ul style="list-style-type: none"> ▶ When POWERbot is immobilized by an obstacle such as a cord, threshold etc, pick it up and move it away from the obstacle. <ul style="list-style-type: none"> – If any fabric or string is caught in a drive wheel, turn off the emergency switch and remove the fabric or string before using it again.
Suction power is weak.	<ul style="list-style-type: none"> ▶ When there's too much dust in the dustbin, suction power may get weakened. Turn off the emergency switch and empty the dustbin. ▶ If the intake (on bottom of POWERbot) is blocked by foreign matter, turn off the emergency switch and remove foreign matter from the intake. ▶ When noise suddenly increase, turn off the emergency switch and empty the dustbin. ▶ If the dustbin is assembled incorrectly, suction power may get weakened. Turn off the emergency switch and refer to page 17 for reassembling.
The POWERbot cannot find the docking station.	<ul style="list-style-type: none"> ▶ Check if there's a power failure or whether the power plug is unplugged. ▶ Remove any obstacles around the docking station that may prevent POWERbot from returning to the docking station. ▶ When there's foreign matter on the charge pins, charging can be affected. Clean the foreign matter off the pins.
The POWERbot suddenly cleans diagonally.	<ul style="list-style-type: none"> ▶ Check if the docking station is installed along the grain of wooden floors or tiles. ▶ The POWERbot may clean in a diagonal direction if it is moving to another area using the shortest route. It may also move at a diagonal if it made contact with an obstacles at that angle, if it was charged at the charger at an angle, or if the grain of the wooden/tile floor skewed is in that direction.
POWERbot does not clean a certain area.	<ul style="list-style-type: none"> ▶ Check if the charger is installed near a narrow passage or door, and reinstall it in the other areas. <ul style="list-style-type: none"> – If the charger is installed near a narrow passage or door, the POWERbot cannot pass through the passage or threshold.

Open Source Announcement

The software included in this product contains open source software. You may obtain the complete corresponding source code for a period of three years after the last shipment of this product by sending an email to <mailto:oss.request@samsung.com>.

It is also possible to obtain the complete corresponding source code in a physical medium such as a CD-ROM; a minimal charge will be required.

The following URL <http://opensource.samsung.com/opensource/VR9000H/seq/0> leads to the download page of the source code and open source license information as related to this product. This offer is valid to anyone in receipt of this information.



Specifications

Classification	Item	Detail information
Mechanical specifications (POWERbot)	Size (Depth x Height x Length)	15 in x 5.35 in x 14.25 in
	Weight	9.5 lbs.
	Sensor	Ceiling shape recognition (Visionary mapping plus TM)
	Button type of POWERbot	Touch type
Power specifications	Power voltage	100-240 V~, 50 Hz/60 Hz
	Power consumption	80 W
	Battery specifications	Lithium ion 21.6 V/ 39 Wh
Cleaning	Charging type	Automatic charging/Manual charging
	Cleaning mode	Auto, Spot, Manual
	Charging time	Approximately 240 minutes
	Cleaning time	Approximately 60 minutes (Normal mode/ On the basis of hard floor)

* For product improvement purposes, design and specifications of the product are subject to change without prior notice.

* Charging and cleaning times may differ according to conditions of use.

Memo

If you have any questions or comments relating to Samsung products, please contact the SAMSUNG customer care center.

Country	Customer Care Center	Web Site
CANADA	1-800-SAMSUNG (726-7864)	www.samsung.com/ca/support (English) www.samsung.com/ca_fr/support (French)
U.S.A	1-800-SAMSUNG (726-7864)	www.samsung.com/us/support

