



CareTouch®
Blood Glucose Monitoring System
User Manual

Call Customer Service toll-free,
1866.890.8500

24 hours a day, 7 days a week

If you have questions or need assistance outside the operational
days and times, please contact your health care provider.

Manufactured for:

Future Diagnostics LLC
Brooklyn, NY 11220

Read this User Manual carefully before you start the test and do a quality
control test. If you have any questions about the control test consult with your
healthcare professional. Confirm the measuring unit on the display is correct
with every test result.

Sign of Trouble

If you are experiencing any of the issues below, call customer service at 1866.890.8500

- The meter doesn't power on when the new test strip is inserted into the meter.
- The meter doesn't power on when you replace the batteries.
- The meter doesn't show the test result after the test is completed.
- The LCD does not display correctly or is distorted after changing the batteries.

If you encounter any issues including the ones mentioned above, call customer service at 1866.890.8500

Important Safety Instruction

- The transmission of blood borne pathogens (e.g. Hepatitis B Virus, Hepatitis C, and human Immunodeficiency) has been associated with the shared use of blood glucose meters. Please clean and disinfect meters once per week at a minimum.
- The meter and lancing device are for single patient use. Do not share them with anyone including other family members. Do not use on multiple patients.
- All parts of the kit are considered biohazardous and can potentially transmit infectious diseases, even after you have performed cleaning and disinfection.
- If the meter is being operated by a second person who is providing testing assistance to the user, the meter and lancing device should be cleaned and disinfected prior to use by the second person.

(References)

1. FDA Public Health Notification: Use of Finger stick Devices on More than One Person Poses Risk for Transmitting Blood borne Pathogens: Initial Communication (2010) <http://www.fda.gov/MedicalDevices/Safety/AlertsandNotices/ucm224025.htm>
2. CDC Clinical Reminder: Use of Finger stick Devices on More than One Person Poses Risk for Transmitting Blood borne Pathogens (2010) <http://www.cdc.gov/injectionsafety/Fingerstick-DevicesBGM.html>

Contents

■ About Your New System

Welcome	01
Intended Use	01
Application	02
Test Principle	02
Special Features	03
Usage and storage	04
Important Information	05
System Components	09

■ Testing Your Blood Glucose

Disinfection Before test	13
Performing a Blood Glucose Test	14
Flagging Test Results	22
Handling the Used Test Strips	23
Alternate Site Testing (AST)	24

■ Meter Setup, Memory and Downloading

Setting up Your Meter	28
-----------------------------	----

Reviewing Test Results	34
Downloading Test Results to a PC	36

■ Control Test

Performing a Control Test	37
Understanding Control Test Results	42

■ Maintenance and Troubleshooting

Cleaning and Disinfecting	43
Replacing the Batteries	48
Screen Messages	50
Troubleshooting	54

■ Technical Information and Warranty

Specifications	56
Warranty	58
Disposing of your Meter	59
Additional Supplies Available	61

About Your New System

Welcome

Thank you for selecting the CareTouch® BGMS (Blood Glucose Monitoring System). This user manual is designed to provide you with information on how to use the CareTouch® Glucose Monitoring System. Follow the instructions carefully that are detailed in this manual. Before using your monitoring system for the first time, please read this manual carefully and If you have any questions, contact Customer Service at 1866.890.8500 anytime-24 hours a day.

Intended Use

CareTouch® Glucose Monitoring System is intended for the quantitative measurement of the concentration of glucose in fresh capillary whole blood drawn from fingertip, palm, and forearm by a single patient (lay user) as an aid in the management of diabetes. It is intended for self testing by persons at home, for single patient use only, and should not be shared.

It is intended for use the outside of body (in-vitro diagnostic use) and not for diagnosis of or screening for diabetes, nor for use on neonates. The alternative site testing (palm and forearm) in this system can only be used during steady state blood glucose conditions.

Application

CareTouch® Blood Glucose Test Strips are for in-vitro diagnostic use and for self testing only. CareTouch® Blood Glucose Meter is not a substitute for your physician or Healthcare Professional. Use the CareTouch® Blood Glucose Meter in conjunction with your Healthcare Program.

Test Principle

Glucose in the blood sample reacts with glucose oxidase(GOx) on the test strip and a harmless electrical current is produced. The strength of these currents change with the amount of glucose in the blood sample and the CareTouch® Blood Glucose Meter automatically interprets this reaction.

Glucose measurements are reported as plasma equivalents. This system uses plasma equivalent methodology. Results that use a plasma equivalent method are approximately 11% higher than those obtained with whole-blood equivalent test strips.

Special Features

- Accurate result in 5 seconds using only 0.5µl blood sample.
- The CareTouch® Glucose Meter identifies the test strip code automatically.
- Stores up to 300 test results.
- Blood glucose measurement units are pre-set in mg/dL.

Usage and Storage

- Before using your monitoring system, please place it in the environment of the system's normal operating temperature range of 50-104 for about twenty (20) minutes.
- Do not allow dirt or dust into the test strip port in order to avoid affecting the monitoring system's accuracy.
- Do not attempt to repair or alter your monitoring system.
- Handle your monitoring system with care.

Important Information

- Make sure to use your test strip immediately after retrieving it from the vial, be sure to keep the test strip vial closed tightly at all times.
- For the most accurate results, make sure your hands are clean and dry before removing the test strips from their vial.
- Do not touch test strip slit.
- Do not use test strips that have expired, using expired test strips may cause inaccurate test results.
- Never reuse a test strip that has had either blood or control solution applied. The CareTouch® Test Strip is for single use only.
- This product is not recommended for newborns or if you are severely dehydrated.
- Keep your CareTouch® Blood Glucose Meter, lancing device, lancets and control solutions out of reach of children or pets.

- Be sure to check the glucose measurement unit on the meter before the test.
 - This meter is preset to mg/dL.
 - mg/dL is the unit of measurement used in the US.
- Make sure you close the test strip vial is closed tightly and store at indoor area between 39.2~86°F, 10~90% Do not freeze.
- Keep test strips away from direct sunlight and heat.
- Use this system only for blood glucose test.
- Before using the CareTouch® Blood Glucose Monitoring System, please read this manual carefully.
- The meter and test strips should be handled at the same temperature.
- For accurate test results, keep the CareTouch® Blood Glucose Monitoring System operating temperature at a range between 50-104°F for more than twenty (20) minutes before testing.
- The operating temperature for the CareTouch® Blood Glucose Monitoring System is between 50-104°F.

- Do not reuse the test strips, test strips are single use only.
- You may use this system at altitude up to 10,000 feet.
- Clean and disinfect your CareTouch® Blood Glucose Meter at least once per week.
- The CareTouch® Blood Glucose Monitoring System is for testing outside of the body (in-vitro diagnostic use).
- Inaccurate results may occur for individuals or patient in shock.
- Inaccurate results may occur for individuals experiencing a hyperglycemic-hypersmolar state with or without ketosis. Critically ill patients should not be tested with this blood glucose meter.
- Interferences: Acetaminophen, salicylates, uric acid, ascorbic acid (vitamin C) and other interferent substances in normal blood or normal therapeutic concentrations do not significantly affect results, however abnormally high concentrations in blood may cause inaccurate results.

- Patients undergoing oxygen therapy may yield false low results.
- Lipemic samples (triglycerides) in excess of 1,500 mg/dL may produce elevated results.
- Hematocrit is the percentage of red blood cells in the blood. HCT levels of 30-55% do not affect glucose measurements with this meter. If you do not know your hematocrit level, consult with your healthcare professional.
- This test strip is not for use with arterial, venous, neonatal, serum or plasma samples.
- Testing outside of HCT level range of (30~55%) and recommended storage conditions may cause inaccurate results.
- Dispose of used test strips and lancets according to instructions from your healthcare provider.

CAUTION: Use only CareTouch® Test Strips with your CareTouch® Blood Glucose Meters.

The Complete CareTouch® Blood Glucose Monitoring System

The CareTouch® Blood Glucose Monitoring System includes the CareTouch® Meter, User Manual, Warranty Card and (2) 3.0 Volt CR2032 Lithium Batteries and (10) CareTouch® Test Strip (Test Strips may not be included as your kit contents).

CareTouch® test strips (for 25 Tests or 50 Tests), CareTouch® Glucose Control Solutions (Level 2, Level 3) are required but not included and must be purchased separately.

CareTouch® test strips, control solutions, diabetes management software and data transporting cable are sold separately and can be provided by contacting your supplier, or for additional information you can contact customer service at 1866.890.8500

CareTouch® Blood Glucose Meter

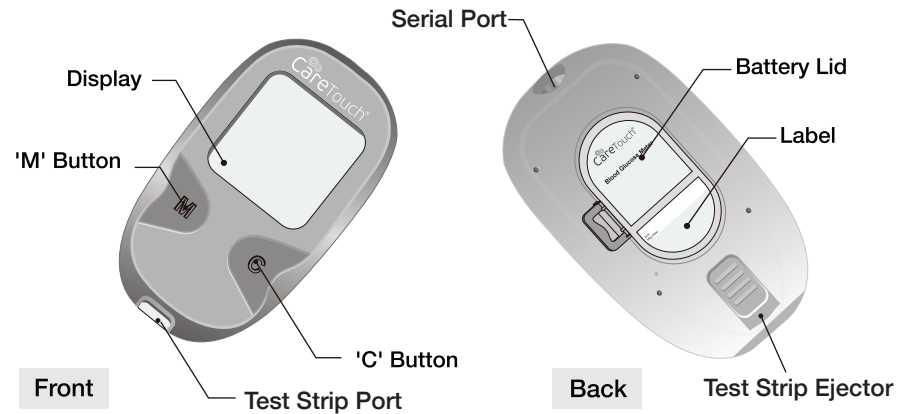

CareTouch® Blood Glucose Test Strip

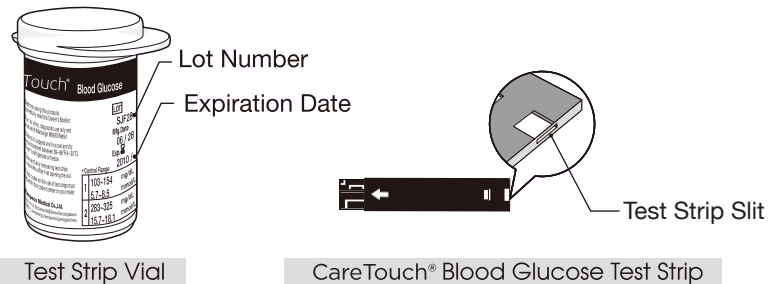

- Use CareTouch® Blood Glucose Test Strips with the CareTouch® Blood Glucose Meter.
- Check the expiration date of your test strips before using.
- Write the opening date of the new test strip vial in order to avoid using any expired products.

Explanation of Display

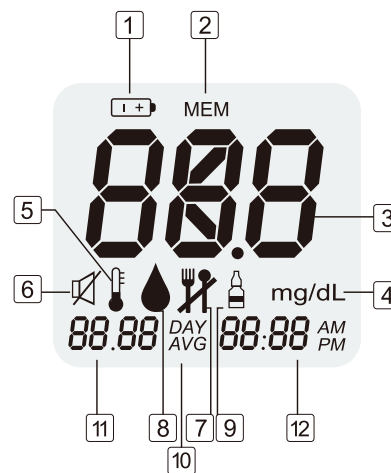

1		Low Battery Warning
2	MEM	Stored Test Results
3	000	Test Results
4	mg/dL	Unit of Measure
5		Temperature Error
6		Beeping Sound Muted
7		Pre Meal/Post Meal Tags
8		Ready to Test
9		Control Solution
10	AVG	Average Result
11	88.88	Month/Date
12	88.88	Time

Testing Your Blood Glucose

Disinfect Before Testing

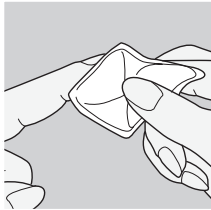
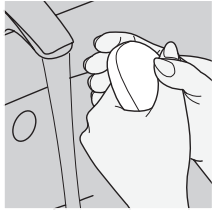

- Before testing, wash your hands with soap and water and dry thoroughly.
- Use an alcohol prep pad to wipe the area before testing.
- Wait until the alcohol dries completely.

Performing a Blood Glucose Test

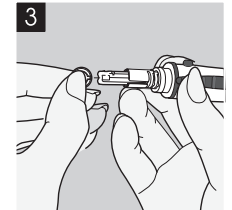
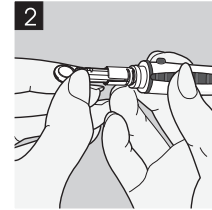
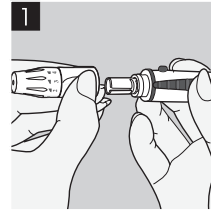

1. Remove your lancing device cap.
2. Install the new lancet into your lancing device.
3. Remove the protective cap from the lancet. Replace the lancing device cap.

NOTICE: Please read the instruction of your lancing device for the detailed usage. The lancing device usage depicted in this manual is for the general lancing device.

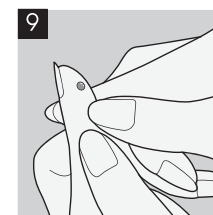
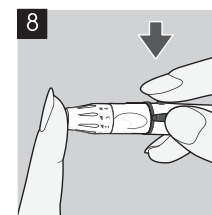
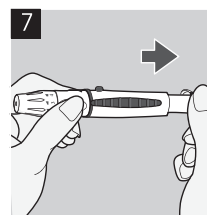
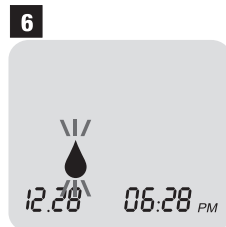
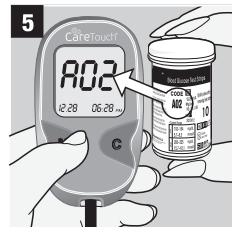
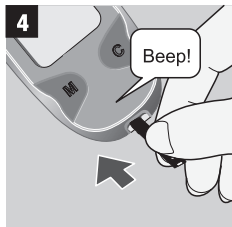

4. Insert a test strip to turn on the meter. Make sure it is inserted completely without bending the test strip.
5. The meter identifies the code number automatically. Compare the code number displayed on the LCD with the code number shown on the test strip vial. If they do not match try again with an another test strip. If the problem persists contact customer support at 1866.890.8500
6. When the blood symbol appears, you can proceed with your test.

7. Adjust the puncture depth setting if necessary by turning the lancing device cap, number 1 is the shallowest depth while number 5 is the deepest. Slide the ejection/cocking control barrel back until it clicks. If it does not click, the lancing device may have been cocked when the lancet was inserted.
8. Hold the lancing device firmly against your finger. Press the release button.
9. Gently squeeze your finger to assist the flow of blood. Do not squeeze excessively on the puncture site.

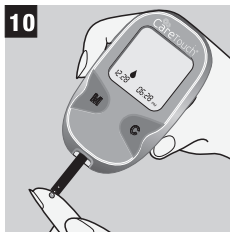

10. Hold the tip of the test strip to the drop of blood, the test strip will automatically draw the blood into the test strip. When the test strip has enough blood the meter will beep and count down from five seconds. After five seconds your test result will appear.

NOTICE: When the blood sample is not sufficient, the display screen will show the message of "Er 4"(Please refer to error messages in this manual.)

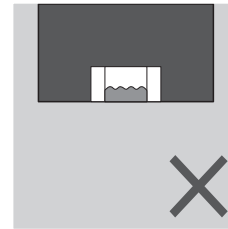
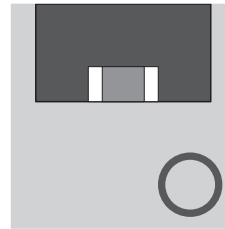
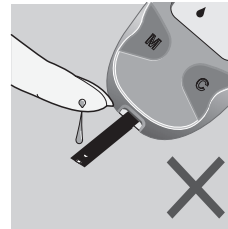
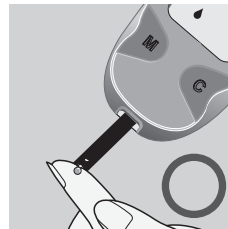

CAUTION:

- Do not drop the blood directly on the end of the test strip.
- The sample channel at the end of the test strip should show full. When you hear the beep sound, you have enough blood in the test strip.
- Inaccurate results may occur for individuals or patient in shock. Inaccurate results may occur for individuals experiencing a hyperglycemic-hypersmolar state, with or without ketosis. Critically ill patients should not be tested with this blood glucose meter.

11

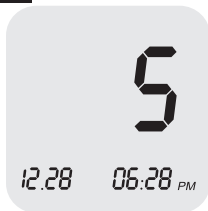

12



11. The test result will appear after the meter counts down from five (5) seconds. Keep the meter still while it is counting down.
12. After five (5) seconds you will hear a second beep sound and your test result will be displayed on the LCD screen. You can remove the test strip by pushing the test strip ejector on the back of the meter and the meter will shut off automatically.

NOTICE:

If the test result is abnormal, please retest with a new test strip. If the test result also has a problem, please refer to the Troubleshooting section in this manual.

CAUTION:

- Do not leave the lancet in the lancing device after use, be sure to dispose of properly.
- If you have taken the cap off of the lancet and the lancet has fallen to the ground, do not use it. Make sure you dispose of it and replace it with a new lancet.
- Always dispose of the used lancets in a biohazard container.
- Keep your Glucose Meter, test strips, control solution, lancing device and lancets out of reach of children or pets at all times.
- Do not reuse lancets, lancets are for single use only.

- The transmission of blood borne pathogens (e.g. Hepatitis B Virus, Hepatitis C, and human Immunodeficiency) has been associated with the shared use of blood glucose meters. Please clean and disinfect meters once per week at a minimum.
- The meter and lancing device are for single patient use. Do not share them with anyone including other family members. Do not use on multiple patients.
- All parts of the kit are considered bio hazardous and can potentially transmit infectious diseases, even after you have performed cleaning and disinfection.
- If the meter is being operated by a second person who is providing testing assistance to the user, the meter and lancing device should be cleaned and disinfected prior to use by the second person.
- User should wash their hands thoroughly with soap and water after handling the meter, lancing device or test strips.
- Please see the section on "Cleaning and Disinfection" to clean and disinfect the meter or lancing device.

Flagging Test Results

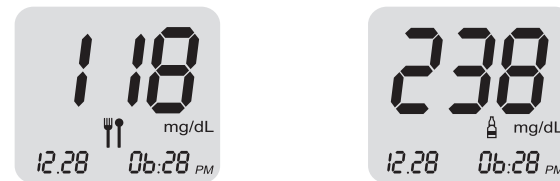

If you want to flag pre-meal, post-meal or control solution readings press the 'M' Button after your test result is displayed. The icon for post-meal (two crossed forks) will be displayed on your screen. Press the 'C' Button to toggle between pre-meal (two crossed forks), post-meal (two crossed forks) and control solution (bottle). After you have identified the activity you would like to flag simply remove the test strip. (see explanation of display on page 12)

NOTICE:

Control Solution Test results are not included in the 14-day average.

Handling Used Test Strips

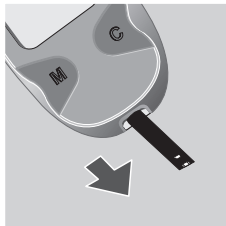
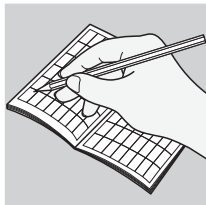

1. Be sure to document your test result by writing it in your logbook after your test. You can then take your logbook to your physician who can review your results.
2. Use the test strip ejector located on the back of the meter to remove the used test strip.
3. The meter will turn off automatically once the test strip is removed.
4. The used test strip should be handled carefully and disposed of properly.

Alternate Site Testing

Contact your Healthcare Professional before using any alternative sites to test your blood glucose.

- Alternative site results may be different from fingertip results when glucose levels are changing rapidly (e.g., after a meal, after taking insulin, or during or after exercise).
- Use alternative site testing only two hours or more after taking insulin, two hours or more after a meal, two hours or more after exercise.
- Do not use alternative site testing if you are aware that your glucose level is not as stable as usual, or if you think you may have hypoglycemia (low blood glucose), or hyperglycemia (high blood glucose), or you think your blood glucose may be rising or falling rapidly.
- Do not use alternative site testing if your alternative site testing results do not match the way you feel.
- AST measurements should never be used to calibrate continuous glucose monitors (CGM).
- AST measurements should never be used in insulin dosing calculations.

Do not rely on test results at an alternative sampling site, but use samples taken from the fingertip, if any of the following applies:

- you think your blood sugar is low
- you are not aware of symptoms when you become hypoglycemic
- the site results do not agree with the way you feel
- after a meal
- after exercise
- during illness
- during times of stress

CAUTION:

- Never change your treatment without first consulting your Physician or a Healthcare Professional.
- Never ignore symptoms of high or low blood glucose.
- If your blood glucose does not match how you feel, perform a fingertip test to confirm your result. If the fingertip result still does not match how you feel, call your Healthcare Professional.

Lancing and Sampling from an Alternate Site

Sampling from your palm or forearm allows you to use your fingertips less often. You may find that obtaining a blood sample from an alternative site is less painful than using a fingertip. Getting a blood sample from your forearm or palm is different than getting a sample from your fingertips.

- **Forearm sampling:** Choose a fleshy area of the forearm away from the bone, visible veins and hair. Sometimes there is less blood flow to the forearm than to the fingertips. To help you get a large enough drop of blood, you may gently massage or apply warmth to the site to increase blood flow.



Forearm

- **Palm sampling:** Choose a fleshy area on the palm below your thumb or little finger. Select an area away from veins or deep creases which may cause your blood sample to smear.



Palm

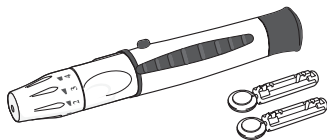

The Lancing Device Clear Cap is used for forearm and palm sampling only. Replace the lancing device cap to the clear cap and follow the same steps as described in the chapter titled "Performing Blood Glucose Test".

NOTICE:

- You may need to wait a little longer to get a large enough drop of blood from the forearm or palm. Do not squeeze the site excessively.
- If the sample drop of blood runs or spreads due to contact with hair or a crease in your palm, do not use that sample. Try puncturing again in a smoother area.
- You may have to adjust the lancing device to a deeper setting to get a large enough drop of blood.

Meter Setup, Memory and Downloading

Setting up Your Meter



1. Press and hold the 'M' button for roughly three seconds, you will hear a beep sound and the LCD Screen will display the screen icons of the meter.
2. Continue to hold the 'M' button and "SET" will appear on the screen.

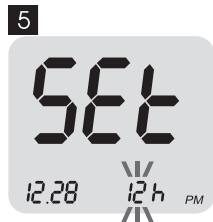
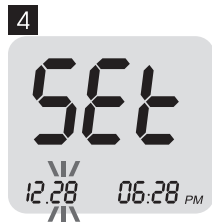

3. Setting the Month : When the month blinks, press and release the 'C' Button until the correct month appears, then press the 'M' Button to set the correct month and move to the date setting.
4. Setting the Date : When the date blinks, press and release the 'C' Button until the correct date appears, then press the 'M' Button to set the correct date and move to the time setting.
5. Setting the Time Format : The meter can be set to show the time in AM/PM 12 hour format or 24 hour "Military Time". With the "12 h" blinking press the 'C' Button to move between 12 h and 24 h, then press the 'M' Button to set and move to the hour setting.

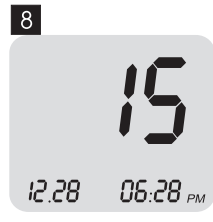

6. Setting the Hour : When the hour blinks, press and release the 'C' Button until the correct hour appears, then press the 'M' Button to set the correct hour and move to the minute setting.
7. Setting the Minute: When the minute blinks, press and release the 'C' Button until the correct minute appears, then press the 'M' Button to set the correct minute and move to the year setting.
8. Setting the Year: The year will appear on the screen, press and release the 'C' Button until the correct year appears, then press the 'M' Button to set the correct year and move to confirming the Measurement Unit Type mode.

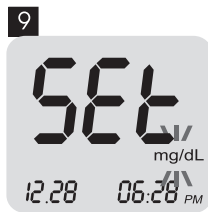

9. Measurement Unit : The glucose measurement unit is defaulted to "mg/dL". Press the 'M' Button to move on to turning the "Beep" sound on or off.

NOTICE: This cannot be changed, if you have any questions concerning the Unit Type contact Customer Service at 1866.890.8500

CAUTION:

- Use of the wrong unit of measure may cause you to misinterpret your blood glucose level, and incorrect treatment.
- Contact your Healthcare Professional if you have any question about measuring units. This meter is preset to mg/dL. mg/dL is the unit of measure used in the U.S.



10. Turning the Beep Sound On or Off: The meter is preset to the beep sound "ON". To turn the beep sound off on the meter press the 'C' Button until "OFF" appears on the screen, then press the 'M' Button to confirm and move to Deleting Your Test Results.

NOTICE: Turning the Beep sound On or Off does not affect your glucose measurement.

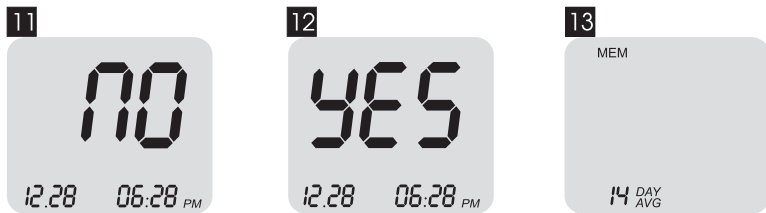

11. Deleting Your Test Result: Select the 'C' Button to toggle between "YES" and "NO". If you want to keep your readings in the memory toggle to "NO" then select the 'M' Button to confirm.
12. If you want to delete all of the readings in the memory toggle to "YES" then select the 'M' Button to confirm.
13. After deleting, the screen will show as pictured above. Press the 'M' Button again and the meter will turn off.

Reviewing Test Results

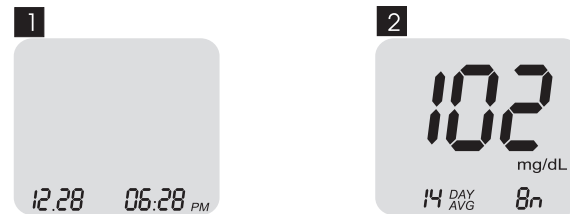

1. Begin with the meter off. Press the 'M' Button, you will hear a beep sound and the meter will turn on.
2. The screen will display the date and time. After 2 seconds, the last 14 days average result will be displayed with a sign "**14^{DAY}**" and the number of test results for 14 days on the display. For example, "**8n**" above the picture means that there are eight (8) test results saved on the memory during the last 14 days.

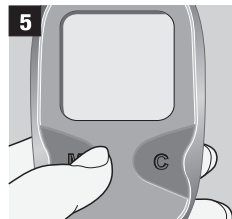

3. Press the 'C' Button once and the screen will show the most recent test result.
4. Each time you continue to press the 'C' Button the screen will show the previous test result.
5. After you are done reviewing your test results, press the 'M' Button to turn off the meter.

NOTICE:

The meter has an automatic shut off and will turn off in roughly two (2) minutes if no changes are detected.

Downloading Test Results to PC

You can transfer test results from the CareTouch® Blood Glucose Meter to a computer where they can be summarized in a report with graphs and tables. To use this feature you will need to download the CareTouch® Link Diabetes Management Software and use the CareTouch® Link Cable.

For more information, please contact Customer Service at 1866.890.8500

Control Solution Test

Performing a Control Solution Test

Performing a control solution test lets you know that your meter and test strips are working properly. You should perform a control test when:

- You open a new box of test strips.
- You left the test strip container open.
- You want to check the meter and test strips.
- Your test strips were stored in extreme temperature or humidity.
- You dropped the meter.
- Your test result does not agree with how you feel.
- You want to check if you are testing correctly.

Performing a Control Solution Test

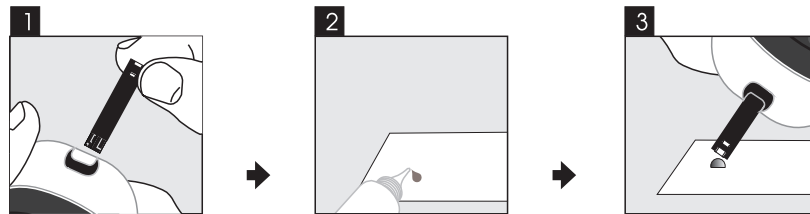

1. Insert the test strip with the arrow facing up and pointing towards the test strip port. The code number will appear on the screen, verify that the code number displayed matches with the code number on the vial of test strips. If the two code numbers do not match, call Customer Service at **1866.890.8500**
2. Shake well before using. Discard the first drop and wipe the dispenser tip. Squeeze a drop of control solution onto a clean, dry, non-absorbent surface. Do not apply control solution to the test strip directly from the vial. Replace the lid on the control solution vial immediately after use.

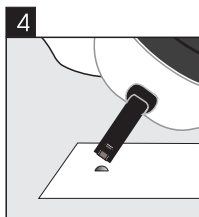

3. Gently touch the drop of the control solution to the tip of the test strip.
4. When the test strip confirmation window is full, the meter will beep. The meter will count down from five seconds and then show the reading. Make sure the reading on the screen is between the ranges displayed on your test strip vial (refer to the "Understanding Control Solution Test Results" section).

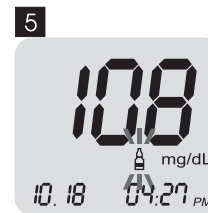

5. Mark all control solution test with '  ' to distinguish them from blood glucose test results in the meter memory. Marked control solution result will not be included in 14 day average. For more detailed information of Flagging Your Test Results refer to the "Flagging Test Results" section for help.

CAUTION:

- If you continue to get control solution results that fall outside of the range printed on the vial, the system may not be working properly. Do not use the meter. Please contact Customer Service at 1866.890.8500
- User should periodically compare the test system to another test system known to be well maintained and monitored by a healthcare provider.
- Use CareTouch® Glucose Control Solution for the CareTouch® System Control Test.

Understanding Control Solution Test Results

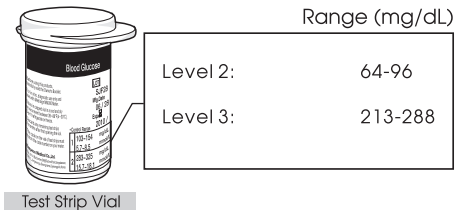

**The Range displayed is for
EXAMPLE PURPOSES ONLY.**

- The example label shown above on the test strip vial shows the acceptable ranges for Levels 2 and Level 3 Control Solutions for the CareTouch® Glucose Meter.
- The result you get should be inside this range. Make sure you compare the result to the correct level of control.
- Each lot of test strips has different acceptable ranges.

Maintenance and Troubleshooting

Cleaning and Disinfecting

The meter should be cleaned and disinfected to prevent the transmission of blood-borne pathogens. Cleaning is done to remove germs, dirt and impurities from your Glucose Meter. Disinfection is done to kill the germs on the surface of your Glucose Meter.

CaviWipes[®] has been validated for use with this meter to clean and disinfect the outside of the meter. The towelette is available for purchase through Medex Supply Company, you can call them at 1-888-433-2300 or visit their website at www.medexsupply.com. This product can also be found through large online retail distribution sites such as www.amazon.com, www.officedepot.com, etc. CaviWipes[®] disinfectant products have been shown to be safe for use with the CareTouch[®] Blood Glucose Monitoring System. Please note, any disinfectant product with the EPA registration number of 46781-8 may be used on the CareTouch[®] Blood Glucose Meter.

Cleaning Instruction:

Cleaning is the removal of visible dirt and debris. Whenever your Glucose Meter is dirty, clean the outside of the meter with a new CaviWipes[®] Towelette. The Cleaning process does not reduce the risk for transmission of infectious diseases.

Clean and disinfect the meter when visible dirty up to ten cycles per day over the 3 years use life of the meter. Please note that the meter should be cleaned and disinfected at least once per week.

Use CaviWipes[®] towelette to wipe the meter exterior of the front, the back and the sides thoroughly.

CAUTION:

Do not use other cleaners or disinfectants as they may damage the meter.

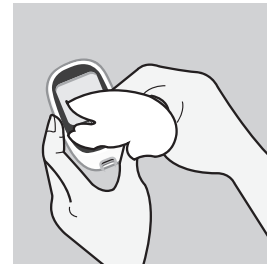

Disinfection Instructions

Your Glucose Meter and Lancing Device should be disinfected once per week or as needed, and be cleaned prior to disinfecting. The Disinfection process reduces the risk of transmitting infectious diseases if it is performed properly.

Before disinfecting, clean the meter as described above in Cleaning Step . Then use a second, fresh towelette to thoroughly wipe the meter exterior of the front, the back and the sides. Allow it to remain wet for two (2) minutes. Allow to air dry when done. Please see below for more details.

Disinfecting Your Meter

STEP1

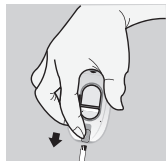

STEP2



STEP3

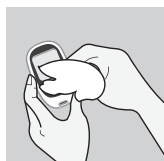

STEP1: Dispose of the used test strip.

STEP2: Prepare the CaviWipes' Towelette. Take out a wipe from the container (please refer to the CaviWipes' labeling for safety instructions). If needed wring the wipe slightly to remove excess liquid.

STEP3: Completely wipe the Glucose Meter including the front, back and sides and a Lancing Device included in the meter kit. Take care not to get any liquid in the test strip, test strip port and serial port until all dirty is removed. Do not wrap the meter in a wipe. Dispose of the wipe when finished.

Disinfecting Your Meter

STEP1: Before disinfecting, clean the meter as described in Cleaning Your Meter process.

STEP2: Prepare the CaviWipes' Towelette. Take out a wipe from the container (please refer to the CaviWipes' labeling for safety instructions). If needed wring the wipe slightly to remove excess liquid.

STEP3: Completely wipe the Glucose Meter including the Meter front, back and sides and

STEP4: Lancing Device included in the meter kit. Take care not to get any liquid in the test strip, test strip port and serial port. Do not wrap the meter in a wipe.

Let the meter and lancing device remain wet for two (2) minutes. Allow to air dry when done. Dispose of wipe when finished.

User should wash hands thoroughly with soap and water after handling the meter, or test strips.

Signs of Deterioration

The life of the device is three (3) years. The Medisign MM1100 meter was demonstrated that there was no change in performance or in the external materials of the meter after 11,000 cleanings with disinfection cycles designed to simulate three (3) years for ten (10) times per day. However, if any of the following physical and functional signs of deterioration appear after cleaning and disinfection of the devices, stop using the device and contact us at 1 866.890.8500 immediately.

- Clouding display window of meter
- Corrosion or erosion of the plastic housing and rubber button
- Any damage including corrosion or erosion of the test strip port, speaker hole and data transport port
- Meter buttons do not function.
- The voice function including volume change does not work.
- Data transfer function from meters to PC does not work.

For more information on cleaning and disinfecting, contact Customer Service at 1 866.890.8500

CAUTION:

- Squeeze the excess liquid from the cloth before you wipe the meter's surface.
- The meter must be off when you clean or disinfect the meter.
- Do not get moisture on the test strip, test strip port and serial port.
- Do not spray any cleaning solution directly onto the meter.
- Do not put the meter under water or liquid.
- Immersing the meter in liquid will cause damage.

Replacing the Batteries

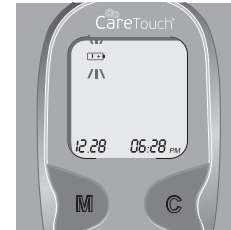



1. When the batteries are low the screen will display and blink the low battery icon in the top left hand corner. This indicates that there is only enough power left in the meter for about fifty more tests and the batteries should be replaced. When replacing the batteries your test results will be stored in the meter, however you may need to reset the date and time. Refer to the "Setting up Your Meter" section for more information.







2. Open the battery compartment lid on the back of the meter and remove the batteries and replace them with two new CR2032 batteries. Make sure to align the + side facing up toward you. Once the new batteries are in place, snap the battery lid back onto the meter.

Screen Messages

Messages	Descriptions	Solutions
	The meter has detected a problem with the test strip. The test strip is either used or damaged.	Repeat the test with a new test strip.
	The blood sample was applied to the test strip before the blood symbol (🩸) appeared on the screen.	Remove and discard the test strip and insert a new one. Apply blood to the test strip after the blood symbol appears on the screen.

Messages	Descriptions	Solutions
	<p>The temperature is above or below the proper range for testing.</p>	<p>The temperature should be 50-104°F. Move the meter and test strips to an area that is within the temperature range to perform the test. Wait about twenty minutes or until the meter has reached the proper range and retest. Do not raise or lower the meter temperature artificially.</p>

Messages	Descriptions	Solutions
	<p>There is not enough blood in the strip to perform a test.</p>	<p>Repeat the test with a new test strip and make sure enough blood has been applied to the strip.</p>
	<p>The wrong strip has been put into the meter.</p>	<p>Make sure you are using an CareTouch® Test Strip and repeat the test.</p>
	<p>There is an internal error with the meter.</p>	<p>Please contact Customer Service at 1866.890.8500</p>

Messages	Descriptions	Solutions
 <p>The image shows a digital display with 'Hi' in large digits, 'mg/dL' below it, and a timestamp '12:28 05:28 PM' at the bottom.</p>	<p>When the test result is higher than 600mg/dL, the screen will show the "Hi" mark. This indicates that the value of your blood glucose is too high.</p>	<p>Retest with a new test strip. If the "Hi" mark appears again, please call your doctor or Healthcare Professional immediately.</p>
 <p>The image shows a digital display with 'Lo' in large digits, 'mg/dL' below it, and a timestamp '12:28 05:28 PM' at the bottom.</p>	<p>When the test result is lower than 20mg/dL, the screen will show the "Lo" mark. This indicates that the value of your blood glucose is too low.</p>	<p>Retest with a new test strip. If the "Lo" mark appears again, please call your doctor or Healthcare Professional immediately.</p>

Troubleshooting

Causes	Solutions
<p>The meter does not work after the blood is applied.</p>	<ul style="list-style-type: none"> • Make sure that the test strip is inserted into the test strip port completely. • See if the test strip is covered in debris or lint. • Make sure the blood is applied to the test strip correctly. • Make sure the test strip is inserted correctly and repeat the test.
<p>The test result is abnormal.</p>	<ul style="list-style-type: none"> • See if the test strip is covered in debris or lint. Also make sure the test strip has not been out of its container for any extended period of time. • Make sure the test strip has not been used before. • Verify the expiration date on the test strip vial.

Causes	Solutions
	<ul style="list-style-type: none"> • Make sure the test strip vial has not been opened for longer than three (3) months. • Make sure the meter code and test strip code match.
The thermometer icon () appears on the screen.	<ul style="list-style-type: none"> • Place the meter and test strip in a temperature environment of 50-104°F. You should use it after about 20 minutes in the appropriate conditions. • If the thermometer icon is constantly showing, contact Customer Service at 1866.890.8500
The meter does not work after the test strip is inserted.	<ul style="list-style-type: none"> • Make sure the test strip is completely inserted into the test strip port. • Make sure the batteries are inserted correctly, with the + sign up and facing the right direction.

Technical Information and Warranty

Specifications

Product Name	CareTouch® Blood Glucose Monitoring System
Test Sample	Fresh capillary whole blood
Calibration	Plasma-equivalent
Sample size	0.5µl
Test Strip Type	CareTouch® Blood Glucose Test Strip
Measuring Range	20 - 600 mg/dL
Measuring Time	5 Seconds
Power	(2) 3.0 Volt CR2032 lithium batteries
Battery Life	Approximately 1000 tests
Memory Capacity	300 test results
Data Transport	USB Data Transfer Cable

Display	LCD
Operating Temp	50 - 104°F
Operating Humidity	10 - 90 % RH
Storage Temp	39.2 - 86°F
Dimensions	18 x 51 x 88 mm
Weight	48g (with batteries)

Warranty

CareTouch® Blood Glucose Meter is guaranteed that the meter shall be free of defects in material and workmanship for a period of three years. This guarantee is valid from the date of purchase. This guarantee extends only to the original purchaser and is not transferable.

The warranty ceases to apply under the following conditions:

- The meter is damaged as a result of incorrect use.
- The meter is damaged as a result of natural disasters (e.g. hurricane, earthquake etc.).
- The meter is damaged due to using incompatible products.
- The meter is damaged as a result of attempting repair.

Disposing of your Meter

During blood glucose measurement the meter itself may come into contact with blood. Used meters therefore carry a risk of infection. Please dispose of your used meter - after removing the batteries - according to the regulations applicable in your area. For information about correct disposal, please contact your local council and authority.

Blood Glucose Target Range

Normal blood glucose reference value for non-diabetics is as follows:

- Before eating : < 100 mg/dL
- 2 hours after meals : <140 mg/dL

In case results are out of reference range, please contact your Healthcare Professional and follow their advice.

Reference: American Diabetes Association, Clinical Practice Recommendations (2015) Diabetes Care, Vol. 38, Supplement 1, p S1 - S93

Additional Supplies Available

The following supplies and accessories are available from your supplier, for more information contact Customer Service at 1866.890.8500

CareTouch® Link Cable

CareTouch® Link Diabetes Management Software

CareTouch® Test Strips

CareTouch® Glucose Control Solution

XP102-0083A Rev.19.06.16