

## 1. Overview

Please check the qualities of contents prior to use. In the case of any shortages, please contact the shop where you bought the product.

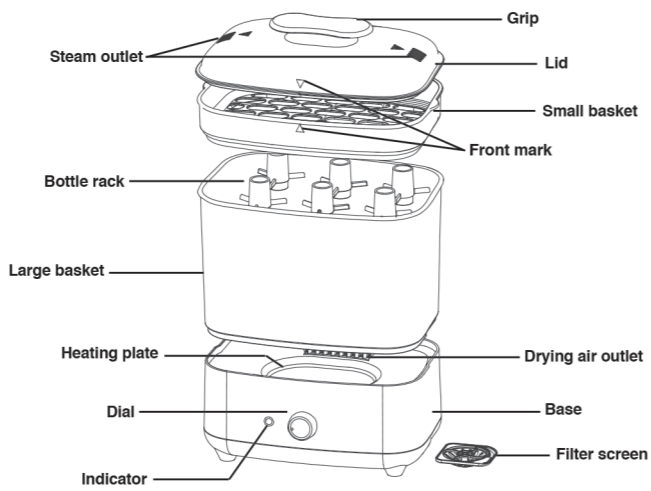

## 2. Precautions

Before use, please read this manual carefully and save it for future reference.

### Danger

- Please do not place it close to fire sources.
- Do not clean the Base, mains cord or plug in water; and prevent any water from entering the appliance through the outlets to avoid any damage to the product or any danger.
- Follow the de-scaling instructions to prevent irreparable damage.
- Never disassemble the base to avoid the risk of electric shock.

### Warning

- This appliance is not intended for use by persons (including children) with reduced physical, sensory or mental capabilities, or lack of experience and knowledge, unless they have been given supervision or instruction concerning use of the appliance by a person responsible for their safety.
- Keep the appliance and the mains cord out of the reach of children.
- Never allow children to play with the PE packing bags of the products to avoid the risk of suffocation.
- Do not place the appliance, mains cord and plug close to a hot surface and sharp edges and corners. If the plug, the mains cord or the appliance itself is damaged, do not use the appliance.
- The components of the sterilizer and dryer are not repairable. Never open, maintain or repair the sterilizer and dryer yourself.
- Check if the voltage indicated on the appliance corresponds to the local mains voltage before you connect the appliance.
- Make sure that the plug of the appliance has been inserted firmly.

EN 1

### Tips

It is recommended that novices choose the 'Sterilize and Dry' mode as the drying effect may be aided by a number of factors such as the quantity of contents (bottles, plates, etc.), materials of contents (PP, glass, etc.), water volume, and ambient temperature and humidity. In case of poor drying effect, select 'Sterilize and Extra Dry' mode.

### Caution

- In case of poor drying effect, rotate the dial clockwise (at any position) to add time for extra drying. See 'Tips: Drying-only' for the specific steps.
- Wash your hands thoroughly before touching any sterilized items.

### Warning

- Be careful, hot steam may come out of the sterilizer and dryer when removing the lid.
- Be careful, the sterilized items may still be hot, please take it out carefully to avoid getting burned.

### Tips: Drying-only

1. Before use, clean the items to be sterilized thoroughly for a more satisfactory sterilization effect.
2. Place the large basket on the base horizontally, adjust it in right place, then place the items to be sterilized in it.
3. Place the small basket on the large basket, then place nipples and other accessories in it, then place the lid on the top.
4. Plug in the appliance (without water in the appliance), rotate the dial clockwise to Sterilize and Dry or Extra Dry (depends on how many items to be sterilized) to sterilize and dry the items. A sterilizing and drying cycle takes 45 minutes and an extra dry cycle takes 65 minutes, after which the dial returns to Off automatically and the indicator lights off.
5. When the sterilizing and drying process finished, wait until the appliance has cooled down completely before you remove the lid and take out the items.

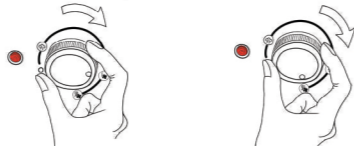

### Caution

For a better drying effect, when the machine is used for drying-only, the heating plate will be preheated for about 50 seconds to ensure a completely dry plate before entering the drying and air-out mode. In case of a poor drying effect, turn the dial clockwise to add time for extra drying.

### Tips: Sterilizing-only

1. Before use, clean the items to be sterilized thoroughly to ensure better sterilization effects.
2. Place the large basket on the base horizontally, adjust it in right place, then place the items to be sterilized in it.
3. Place the small basket on the large basket, then place nipples and other accessories in it, then place the lid on the top.
4. Plug in the appliance, pour 100ml water into the heating plate, rotate the dial clockwise to Sterilize. A sterilizing cycle takes 8 minutes, after which the dial returns to Off and the indicator lights off.



5. When the sterilization process finished, wait until the appliance has cooled down completely before you remove the lid and take out the items.

EN 4

- Do not pour more than 100ml water into the heating plate. Otherwise, water may enter the drying air outlet and damage the appliance.
- During sterilization and drying, beware of hot steam that comes out of the outlet in the lid, do not touch or block the outlet to avoid getting burned.
- During sterilization and drying, or within 10 minutes afterwards, do not touch, move or open the base, large basket, small basket or lid because they are very hot.
- Beware of hot steams when you remove the lid. Only lift the lid by its grip.
- Never place items on the top of the appliance or block the outlet when it is in use.
- To prevent the appliance from being damaged due to overheating, please let the appliance cool down completely for approx. 10 minutes before you use it again.
- To prevent limescale build up, it is better to sterilize items with distilled water.
- Please descale the sterilizer and dryer with vinegar as instructed in the user manual. Do not use bleach or other chemicals.
- Only sterilize baby bottles and other items that are suitable for Papablic sterilizer and dryer. Check the user manual of the items you want to sterilize and dry, to make sure they are suitable for Papablic sterilizer and dryer.
- The product is for household use only.

### Caution

- Never use any accessories or parts from other manufacturers or that Papablic does not specifically recommend. If you use such accessories or parts, your guarantee becomes invalid.
- Do not use the appliance if it has fallen or is damaged in any way.
- Do not sterilize and dry very small items which can fall through the holes in the bottom of the basket.
- Never place items directly on the heating plate when the appliance is switched on.
- Do not expose the appliance to extreme heat or direct sunlight
- Always place and use the appliance on a dry, stable, level and horizontal surface.
- Let the appliance cool down before you move or store it.
- Always unplug the appliance after use or when not in use. Please clean and descale it in time and store it in a dry place.
- Environmental conditions, such as temperatures and altitude, may affect the functioning of this appliance.

## 3. Use methods

### Caution

- It is recommended to sterilize and dry the appliance twice with an empty small basket and large basket before the first use.
- It is better to sterilize with distilled water, if not, please pay attention to cleaning and descaling.
- Make sure all parts that need to be sterilized are completely dissembled and place them in the baskets with their openings pointing down to prevent them from filling up with water.
- Only place items in the sterilizer which are suitable for sterilizing. Do not sterilize items that are filled with liquid, e.g. a teether with cooling fluid.

### Operating instructions for Dial

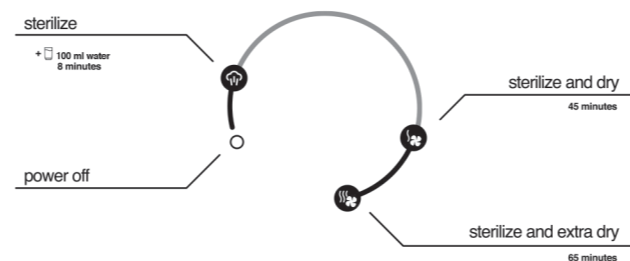

EN 2

## 4. Cleaning

### Warning

- Do not use abrasive or aggressive cleaning agents (e.g. bleach) or a scouring pad to clean this appliance.
- Never immerse the base, the mains cord or the mains plug in water or any other liquid.
- This sterilizer is not dishwasher-proof.

1. Always unplug the appliance and let it cool down before you clean it.
2. Never clean the base under water, please clean the heating plate and base with a moist cloth.
3. The large basket can be disassembled for washing.
4. Clean the other parts in hot water with some washing-up liquid.

### Caution

- Never squirt any water into the drying air outlet when cleaning the appliance.
- After cleaning, store the sterilizer in a clean, dry place.
- To prevent limescale build up, it is better to sterilize and dry items with distilled water. If there is any limescale, please pour acetic acid (or limescale detergent), wait until the limescale has dissolved before you clean it. Do not scrape the heating plate to prevent any electric component inside the base damage.

## 5. Descaling

The sterilization process is extremely important to ensure the most hygienic standards for your baby. Limescale deposits can slow down the sterilization cycle and even impair its effectiveness. Papablic has made the heating plate visible and easier to clean so you can ensure your sterilizer and dryer is free from limescale at all times, for an optimum sterilization cycle.

### What is limescale?

Limescale is the hard, off-white, chalky deposit sometimes found in kettles. Depending on the water type in your area, limescale can have different appearances ranging from snow white looking powder to brownish stains. It builds up in appliances as the residue of minerals naturally contained in water, which fail to evaporate when water is heated. Although it is not harmful as much, it is unsightly, hard to clean and can impair the operation of appliances or damage their components if allowed to build up.

### When should I descale my sterilizer and dryer?

When you use the sterilizer, you may notice small spots ranging from whiter to dark brown appearing on the heating plate. This is a sign that the sterilizer and dryer should be descaled. In any case, the sterilizer and dryer should be descaled at least once a week to ensure that it continues to work effectively.

### Three simple steps to descaling your sterilizer and dryer

1. Pour 80ml/2.7oz of white vinegar (5% acetic acid) and 20ml/0.7oz of water into the heating plate.
  2. Leave the solution in the heating plate until the limescale has dissolved.
  3. Empty the heating plate then wipe the plate with a damp cloth.
- Repeating the process as often as necessary. In severe cases, citric acid or common descaling agents can be used to remove limescale.

### Caution

- Always unplug the appliance and wait until it has cooled down completely before descaling.
- Do not rinse under a tap.
- Never squirt any water into the drying air outlet when pouring out the remaining solution.

## 6. Warranty Service

Email: [service@papablic.com](mailto:service@papablic.com)

Website: [papablic.com](http://papablic.com)

Limited Lifetime Warranty

All Papablic products are covered by a limited LIFETIME guarantee. Papablic will replace or repair, free of charge, any part that is defective or malfunctioning during the effective life of the product. Upon receipt of the product and proof of purchase, the defective part will be immediately repaired or replaced and returned to you free of charge (USA and Canada only). Negligent abuse of the product voids this guarantee.

EN 5

- Sterilize: Pour 100ml water into the heating plate, and then rotate the dial clockwise to Sterilize. A sterilizing cycle takes approx. 6 minutes.
- Sterilize and dry: Pour 100ml water into the heating plate, and then rotate the dial clockwise to Sterilize&Dry or Extra Dry. The mode of sterilizing and drying depends on how many items to be sterilized. A sterilizing and drying cycle takes 45 minutes and an extra dry cycle takes 65 minutes.
- Indicator: When the appliance starts operating, the indicator goes on and will go off until the appliance stops.

### Use Methods

1. Before use, clean the items to be sterilized thoroughly to ensure better sterilization effects.
2. Place the base on a horizontal surface and make sure it is stable, then pour 100ml water into the heating plate (no water needed if only for drying). The water surface can not over the heating plate too much to avoid water entering the drying air outlet and damage the internal electric parts (see Fig. 1).
3. Place the large basket on the base horizontally, adjust it in right place, then place the items to be sterilized in it.
4. Place the small basket on the large basket, then place nipples and other accessories in it, then place the lid on the top (see Fig. 2).

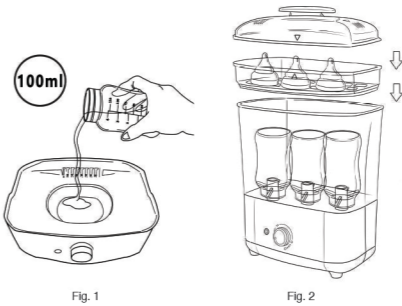

### Tips

- Please position the lid and the small basket properly as indicated by the front mark.
- Please place the nipples and bottles to be sterilized in the baskets with their openings pointing down.
- With only the small basket on the base to sterilize small items (see Fig. 3).
- To sterilize bowls, plates, chopsticks and other large items, you can pull out the bottle rack to make extra room (see Fig. 4).

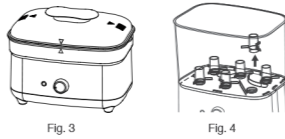

5. Plug in the appliance, rotate the dial clockwise to Sterilize and Dry or Extra Dry (depends on how many items to be sterilized) to sterilize and dry the items. (About 8 minutes later, water will be boiled away completely and the appliance will automatically switch to drying. When the sterilizing and drying process is finished, the dial returns to Off automatically and the indicator lights off.)
6. When the sterilizing and drying process finished, wait until the appliance has cooled down completely before you remove the lid and take out the items.

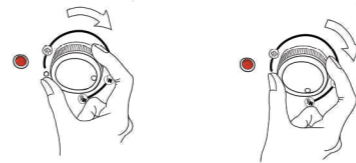

EN 3

This warranty gives you specific legal rights, and you may also have other rights which vary from state to state. Do not return to the place of purchase if the allowed return window has passed. Please contact us directly at [info@papablic.com](mailto:info@papablic.com) and include your proof of purchase. For questions, please email our friendly customer service representatives at [info@papablic.com](mailto:info@papablic.com) (mailto:info@papablic.com).

## 7. FAQ

1. How much voltage is suitable for the appliance?  
110 V.

2. How many bottles can be sterilized at most each time?

10 bottles at most. The appliance is provided with a large space and demountable bottle racks, greatly improving its space utilization, which makes the sterilization of bottles and tableware adequate and easy.

3. What kinds of bottles are suitable for the sterilizer and dryer?

The sterilizer and dryer is suitable for most bottles on the market.

4. Does the appliance have the function of anti-dry?

When the water in the heating plate has boiled away, the sterilizer and dryer will enter drying mode, and after the timer switch turns back to the starting point, the power will be cut off automatically.

5. Why does water flow out from the sterilizer and dryer?

You may have poured too much water into the sterilizer and dryer. Do not pour more than 100 ml of water into the heating plate. Make sure that all parts are properly placed.

6. What kind of water is better for sterilization?

Distilled water is recommended as it is free from impurities and safer for sterilization, while tap water contains more impurities and more readily forms limescale, which makes it difficult to clean.

7. Why is the sterilization time so short?

You may have added too little purified water.

8. Why is the sterilization time so long?

You may have added too much purified water.

9. Are there any bottles attached in addition to the sterilizer and dryer?

No, there is no bottle attached to the appliance. The appliance only contains a sterilizer and dryer.

10. Why is there a lot of steam coming out from the lid?

Please check that the lid is properly placed on the basket.

11. Why does the appliance fail to enter sterilization mode?

The appliance will automatically enter drying mode when there is no water on the heating plate. It is recommended to power on the product 5 minutes after the last operation as the heating plate reaching a high temperature will lead it to automatically enter drying mode.

12. Does the appliance have an automatic power-off function?

After completing the mode you chose, the sterilizer and dryer will automatically power off for safety protection.

EN 6

## 1. Visión de conjunto

Antes de usar el aparato, compruebe la cantidad de los componentes por favor. Si falta alguno, contacte con el vendedor.

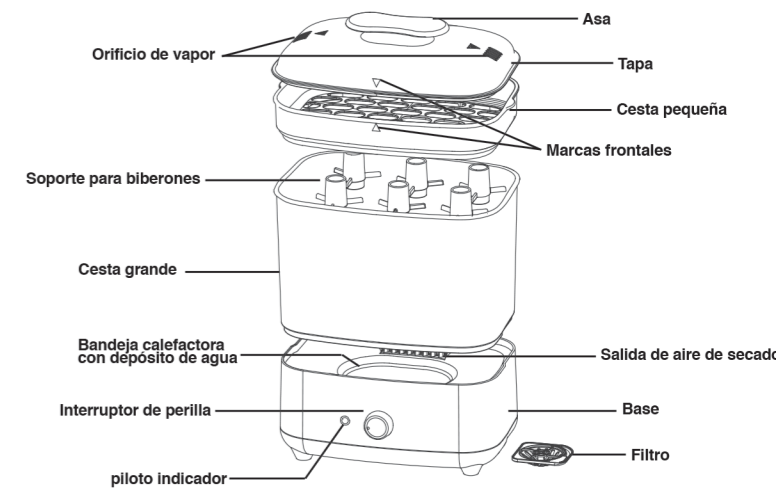

## 2. Precautions

Antes de usar el aparato, lea atentamente este manual de usuario y consérvelo por si necesitara consultarlo en el futuro.

### Peligros

- No lo coloque cerca del fuego.
- Por favor evite que entre agua en la base, el cable de alimentación y la clavija al lavar el producto, y evite que entre agua en la salida de aire de secado, a fin de evitar riesgos o que el producto resulte dañado.
- Si no sigue las instrucciones para la eliminación de los depósitos de cal se pueden provocar daños irreparables.
- No desmonte nunca la base, para evitar el riesgo de descargas eléctricas.

### Warning

- Este aparato no debe ser usado por personas (adultos o niños) con su capacidad física, psíquica o sensorial reducida, ni por quienes no tengan los conocimientos y la experiencia necesarios, a menos que sean supervisados o instruidos acerca del uso del aparato por una persona responsable de su seguridad.
- Mantenga el aparato y el cable de alimentación fuera del alcance de los niños.
- No deje que los niños jueguen con la bolsa de plástico para evitar el riesgo de asfixia.
- No coloque el cable de alimentación y la clavija sobre una superficie caliente o las esquinas afiladas. No utilice el aparato si la clavija, el cable de alimentación o el propio aparato están dañados.
- No hay piezas reemplazables dentro del esterilizador digital con función secador. No intente abrir ni reparar el aparato usted mismo.
- Antes de enchufar el aparato, compruebe si el voltaje indicado en el mismo se corresponde con el voltaje de red local.
- Asegúrese de que la clavija está insertada con firmeza a la toma de corriente.

ES 1

- No vierta más de 100 ml de agua en el depósito de agua de la base, a fin de evitar que demasiada agua penetre en la salida de aire de secado y que pueda resultar dañado el producto.
- Durante el proceso esterilizador-secador tenga cuidado con el vapor caliente que sale del orificio de la tapa o cuando retira la tapa. El vapor puede causar quemaduras.
- No toque, mueva ni abra la base, la cesta grande, la cesta pequeña o la tapa durante el proceso esterilizador-secador o después de éste, ya que están muy calientes.
- Tenga cuidado con el vapor caliente que sale del orificio de la tapa cuando retira la tapa. Levante la tapa sólo por su asa.
- Cuando el aparato esté en funcionamiento, no coloque nunca objetos sobre la tapa, por lo que el vapor caliente quedará obstruido.
- Si necesita usar el aparato de forma seguida, por favor espere 5 minutos antes de volver a encenderlo, a fin de evitar posibles daños debido al sobrecalentamiento.
- Se recomienda usar agua destilada, lave bien biberones, tetinas y otros accesorios que desea esterilizar para disminuir los depósitos de cal.
- Use vinagre blanco para eliminar la cal según lo indicado en el manual de usuario. No ponga lejía u otros productos químicos en el aparato.
- Esterilice sólo los biberones y otros objetos apropiados para Papablic, el esterilizador digital con función secador. Consulte en el manual del usuario los objetos que desea esterilizar para asegurarse de que son apropiados para el dicho aparato.
- Este aparato es sólo para uso doméstico.

### Precaución

- No utilice nunca accesorios o piezas de otros fabricantes o que no hayan sido específicamente recomendados por Papablic.
- No utilice el aparato si se ha caído o si está dañado.
- No esterilice objetos muy pequeños que pueden caerse por los orificios del fondo de la cesta.
- No coloque nunca objetos sobre la bandeja calefactora cuando esté en funcionamiento.
- No exponga el aparato a altas temperaturas o a la luz solar directa.
- Ponga y utilice siempre el aparato sobre una superficie seca, estable, plana y horizontal.
- Deje siempre que el aparato se enfríe antes de moverlo o guardarlo.
- Desenchufe siempre el aparato después de usarlo o cuando no lo use, lávelo, desincrustelo a tiempo y guárdelo en un lugar seco.
- Las condiciones ambientales, como la temperatura y la altitud, pueden afectar al funcionamiento del aparato.

## 3. Modo de empleo

### Precaución

- Cuando utilice el aparato por primera vez, le recomendamos que deje completar dos ciclos de esterilización y secado con las cestas vacías.
- Se recomienda usar agua destilada para la esterilización. Si usa otro tipo de agua deberá prestar atención a la limpieza y desincrustado del producto.
- Asegúrese de que todas las piezas que deben esterilizarse se hayan desmontado completamente y colocadas en la cesta con las aberturas hacia abajo para evitar que se llenen de agua.
- Coloque sólo objetos que sean apropiados para la esterilización en el esterilizador con función secador. No esterilice objetos que estén llenos de líquido, como por ejemplo, un mordedor refrigerante.

### Instrucciones de operación del Interruptor de perilla

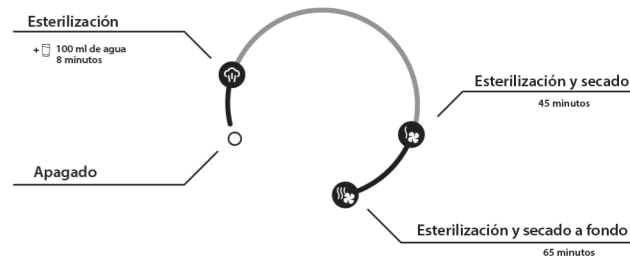

ES 2